



Rogers

Assessment Property Record Card for Tax Year 2026

Data provided by LISA DELOZIER County Assessor

Date 04/17/2026
Time 06:00:31
Page 1

Assessment Data					Primary Image																																																																																																																				
Account 660074032 Parcel ID 21N15E-32-4-00000-000-00007284 Cadastral ID 32-21-15-00730 Property Type REAL - Real Property Property Class RA VI Area 4 Tax Area 4 - VERDIGRIS/VERD FIRE Name ID 338116 MCGUIRE, DEBORAH E REVOCABLE LIVING TRUST 24620 S 4090 RD CLAREMORE OK 74019-0000 Parcel Location Situs 24620 S 4090 RD Subdivision Lot/Block / Parcel Size 7.23 - Acres Sec/Twn/Rng 32 / 21 / 15 / 4 Neighborhood 6090 - UNPLATTED School District S008 - VERDIGRIS SCHOOLS					<p>\\tsclient\C\Users\Randy Necessary\Pictures\101_0705\IMG_0028. 7/5/2022</p>																																																																																																																				
Legal Description Lat/Long: 36.25399895 -95.72397601 TR DESC 2023-015627 AS COMM NE/C E2 NE SE; S 500'; W 355.50' TO POB; S 330'; W 156.50'; S 213.63'; N89.5239E 512'; S 277'; S89.5239W 660.15'; N00.0136E 820.94'; E TO POB.																																																																																																																									
Exemptions <table border="1"> <thead> <tr> <th>Code</th> <th>Type</th> <th>Active</th> <th>Maximum</th> <th>Exemption</th> </tr> </thead> <tbody> <tr> <td>HV</td> <td>Veteran</td> <td>Yes</td> <td>999,999</td> <td>23,872</td> </tr> </tbody> </table>					Code	Type	Active	Maximum	Exemption	HV	Veteran	Yes	999,999	23,872	Building Permits <table border="1"> <thead> <tr> <th>Number</th> <th>Description</th> <th>Opened</th> <th>Closed</th> <th>Amount</th> </tr> </thead> <tbody> <tr> <td>R2009 0512</td> <td>R10-NEW SFR 1769 SQ FT</td> <td>06/2009</td> <td>01/2010</td> <td>159,000</td> </tr> </tbody> </table>					Number	Description	Opened	Closed	Amount	R2009 0512	R10-NEW SFR 1769 SQ FT	06/2009	01/2010	159,000																																																																																												
Code	Type	Active	Maximum	Exemption																																																																																																																					
HV	Veteran	Yes	999,999	23,872																																																																																																																					
Number	Description	Opened	Closed	Amount																																																																																																																					
R2009 0512	R10-NEW SFR 1769 SQ FT	06/2009	01/2010	159,000																																																																																																																					
Parcel Valuation <table border="1"> <thead> <tr> <th>Source</th> <th>REAL</th> <th>Fair Cash</th> <th>Capped</th> <th>Asmnt Level</th> <th>Assessed</th> <th>Levy Rate</th> <th>104.132</th> <th>Current Tax</th> </tr> </thead> <tbody> <tr> <td>Remove Cap</td> <td>2002</td> <td>Land Value 1,181</td> <td>891</td> <td>11%</td> <td>98</td> <td>Assessed</td> <td>23,872</td> <td>2,485.84</td> </tr> <tr> <td>Year Frozen</td> <td>2022</td> <td>Improvements 286,530</td> <td>216,124</td> <td></td> <td>23,774</td> <td>Penalty</td> <td>0</td> <td></td> </tr> <tr> <td>Uncapped Value</td> <td>0</td> <td>Mobile Home 0</td> <td>0</td> <td></td> <td>0</td> <td>Exemption</td> <td>23,872</td> <td>-2,086.00</td> </tr> <tr> <td>TIF Project ID</td> <td>0</td> <td>Total Value 287,711</td> <td>217,015</td> <td></td> <td>23,872</td> <td>Total Taxable</td> <td>0</td> <td>400.00</td> </tr> </tbody> </table>					Source	REAL	Fair Cash	Capped	Asmnt Level	Assessed	Levy Rate	104.132	Current Tax	Remove Cap	2002	Land Value 1,181	891	11%	98	Assessed	23,872	2,485.84	Year Frozen	2022	Improvements 286,530	216,124		23,774	Penalty	0		Uncapped Value	0	Mobile Home 0	0		0	Exemption	23,872	-2,086.00	TIF Project ID	0	Total Value 287,711	217,015		23,872	Total Taxable	0	400.00	Sale History <table border="1"> <thead> <tr> <th>Bk/Pg</th> <th>Grantor</th> <th>Date</th> <th>Price</th> <th>Code</th> </tr> </thead> <tbody> <tr> <td>/</td> <td>MCGUIRE, DEBORAH E</td> <td>11/09/2023</td> <td>0</td> <td>4</td> </tr> <tr> <td>/</td> <td>MCGUIRE, DEBORAH E</td> <td>07/08/2021</td> <td>0</td> <td>4</td> </tr> <tr> <td>1197/763</td> <td>MCGUIRE, MARGIE O TRUSTEE</td> <td>10/20/1999</td> <td>0</td> <td>No</td> </tr> </tbody> </table>					Bk/Pg	Grantor	Date	Price	Code	/	MCGUIRE, DEBORAH E	11/09/2023	0	4	/	MCGUIRE, DEBORAH E	07/08/2021	0	4	1197/763	MCGUIRE, MARGIE O TRUSTEE	10/20/1999	0	No																																															
Source	REAL	Fair Cash	Capped	Asmnt Level	Assessed	Levy Rate	104.132	Current Tax																																																																																																																	
Remove Cap	2002	Land Value 1,181	891	11%	98	Assessed	23,872	2,485.84																																																																																																																	
Year Frozen	2022	Improvements 286,530	216,124		23,774	Penalty	0																																																																																																																		
Uncapped Value	0	Mobile Home 0	0		0	Exemption	23,872	-2,086.00																																																																																																																	
TIF Project ID	0	Total Value 287,711	217,015		23,872	Total Taxable	0	400.00																																																																																																																	
Bk/Pg	Grantor	Date	Price	Code																																																																																																																					
/	MCGUIRE, DEBORAH E	11/09/2023	0	4																																																																																																																					
/	MCGUIRE, DEBORAH E	07/08/2021	0	4																																																																																																																					
1197/763	MCGUIRE, MARGIE O TRUSTEE	10/20/1999	0	No																																																																																																																					
Assessment History <table border="1"> <thead> <tr> <th>Tax Year</th> <th>Statement Number</th> <th>Billed Owner</th> <th>Tax Area</th> <th>Total Value</th> <th>Exemptions</th> <th>Taxable Value</th> <th>Billed Tax</th> </tr> </thead> <tbody> <tr><td>2025</td><td>2025-660074032</td><td>MCGUIRE, DEBORAH E</td><td>4</td><td>266,158</td><td>23872</td><td></td><td>400.00</td></tr> <tr><td>2024</td><td>2024-660074032</td><td>MCGUIRE, DEBORAH E</td><td>4</td><td>271,741</td><td>23871</td><td></td><td>246.00</td></tr> <tr><td>2023</td><td>2023-660074032</td><td>MCGUIRE, DEBORAH E</td><td>4</td><td>217,443</td><td>23918</td><td></td><td>246.00</td></tr> <tr><td>2022</td><td>2022-660074032</td><td>MCGUIRE, DEBORAH E</td><td>4</td><td>268,915</td><td>26674</td><td></td><td>275.00</td></tr> <tr><td>2021</td><td>2021-660074032</td><td>MCGUIRE, WILLIAM R & DEBORAH E</td><td>4</td><td>241,616</td><td>25897</td><td></td><td>267.00</td></tr> <tr><td>2020</td><td>2020-660074032</td><td>MCGUIRE, WILLIAM R & DEBORAH E</td><td>4</td><td>238,036</td><td>25143</td><td></td><td>259.00</td></tr> <tr><td>2019</td><td>2019-660074032</td><td>MCGUIRE, WILLIAM R & DEBORAH E</td><td>4</td><td>221,912</td><td>24411</td><td></td><td>251.00</td></tr> <tr><td>2018</td><td>2018-660074032</td><td>MCGUIRE, WILLIAM R & DEBORAH E</td><td>4</td><td>217,501</td><td>1000</td><td>22,925</td><td>2,195.00</td></tr> <tr><td>2017</td><td>2017-660074032</td><td>MCGUIRE, WILLIAM R & DEBORAH E</td><td>4</td><td>215,020</td><td>1000</td><td>22,652</td><td>2,175.00</td></tr> <tr><td>2016</td><td>2016-660074032</td><td>MCGUIRE, WILLIAM R & DEBORAH E</td><td>4</td><td>210,623</td><td>1000</td><td>22,169</td><td>2,135.00</td></tr> <tr><td>2015</td><td>2015-660074032</td><td>MCGUIRE, WILLIAM R & DEBORAH E</td><td>4</td><td>204,809</td><td>1000</td><td>21,529</td><td>2,089.00</td></tr> <tr><td>2014</td><td>2014-660074032</td><td>MCGUIRE, WILLIAM R & DEBORAH E</td><td>4</td><td>203,992</td><td>1000</td><td>21,439</td><td>1,969.00</td></tr> <tr><td>2013</td><td>2013-660074032</td><td>MCGUIRE, WILLIAM R & DEBORAH E</td><td>4</td><td>204,501</td><td>1000</td><td>21,495</td><td>2,046.00</td></tr> </tbody> </table>										Tax Year	Statement Number	Billed Owner	Tax Area	Total Value	Exemptions	Taxable Value	Billed Tax	2025	2025-660074032	MCGUIRE, DEBORAH E	4	266,158	23872		400.00	2024	2024-660074032	MCGUIRE, DEBORAH E	4	271,741	23871		246.00	2023	2023-660074032	MCGUIRE, DEBORAH E	4	217,443	23918		246.00	2022	2022-660074032	MCGUIRE, DEBORAH E	4	268,915	26674		275.00	2021	2021-660074032	MCGUIRE, WILLIAM R & DEBORAH E	4	241,616	25897		267.00	2020	2020-660074032	MCGUIRE, WILLIAM R & DEBORAH E	4	238,036	25143		259.00	2019	2019-660074032	MCGUIRE, WILLIAM R & DEBORAH E	4	221,912	24411		251.00	2018	2018-660074032	MCGUIRE, WILLIAM R & DEBORAH E	4	217,501	1000	22,925	2,195.00	2017	2017-660074032	MCGUIRE, WILLIAM R & DEBORAH E	4	215,020	1000	22,652	2,175.00	2016	2016-660074032	MCGUIRE, WILLIAM R & DEBORAH E	4	210,623	1000	22,169	2,135.00	2015	2015-660074032	MCGUIRE, WILLIAM R & DEBORAH E	4	204,809	1000	21,529	2,089.00	2014	2014-660074032	MCGUIRE, WILLIAM R & DEBORAH E	4	203,992	1000	21,439	1,969.00	2013	2013-660074032	MCGUIRE, WILLIAM R & DEBORAH E	4	204,501	1000	21,495	2,046.00
Tax Year	Statement Number	Billed Owner	Tax Area	Total Value	Exemptions	Taxable Value	Billed Tax																																																																																																																		
2025	2025-660074032	MCGUIRE, DEBORAH E	4	266,158	23872		400.00																																																																																																																		
2024	2024-660074032	MCGUIRE, DEBORAH E	4	271,741	23871		246.00																																																																																																																		
2023	2023-660074032	MCGUIRE, DEBORAH E	4	217,443	23918		246.00																																																																																																																		
2022	2022-660074032	MCGUIRE, DEBORAH E	4	268,915	26674		275.00																																																																																																																		
2021	2021-660074032	MCGUIRE, WILLIAM R & DEBORAH E	4	241,616	25897		267.00																																																																																																																		
2020	2020-660074032	MCGUIRE, WILLIAM R & DEBORAH E	4	238,036	25143		259.00																																																																																																																		
2019	2019-660074032	MCGUIRE, WILLIAM R & DEBORAH E	4	221,912	24411		251.00																																																																																																																		
2018	2018-660074032	MCGUIRE, WILLIAM R & DEBORAH E	4	217,501	1000	22,925	2,195.00																																																																																																																		
2017	2017-660074032	MCGUIRE, WILLIAM R & DEBORAH E	4	215,020	1000	22,652	2,175.00																																																																																																																		
2016	2016-660074032	MCGUIRE, WILLIAM R & DEBORAH E	4	210,623	1000	22,169	2,135.00																																																																																																																		
2015	2015-660074032	MCGUIRE, WILLIAM R & DEBORAH E	4	204,809	1000	21,529	2,089.00																																																																																																																		
2014	2014-660074032	MCGUIRE, WILLIAM R & DEBORAH E	4	203,992	1000	21,439	1,969.00																																																																																																																		
2013	2013-660074032	MCGUIRE, WILLIAM R & DEBORAH E	4	204,501	1000	21,495	2,046.00																																																																																																																		



Rogers

Assessment Property Record Card for Tax Year 2026

Data provided by LISA DELOZIER County Assessor

Date 04/17/2026
Time 06:00:31
Page 2

Lot Data	Square-Foot - NBHD 6090 #1	Primary Image
Lot Size		
Lot Count	0	
Units Buildable		
Non-Ag Acres	0	
Topography		
Street Access		
Utilities		
Amenities	LAND QUALITY	
Method	Square-Foot	
Base Lot Value		
Factor Value		
Adjustments		
Lot Value		

Residential Data	
Type	1 Single Family Residence
Condition	3 - Average
Quality	3 - Average
Architecture	
Style	100% One Story
Exterior Wall	100% Veneer, Masonry
Base/Total Area	1,752 / 1,752
Style	100% One Story
HVAC	100% Warmed & Cooled Air
Roof Cover	1 Composition Shingle
Area on Slab	1,752
Fixture/RghIn	11 /
Bed/F/H Bath	3 / 2.0 /
Basement Area	
Garage Type	
Remodel	
Year/Eff Age	2009 / 13



\\tsclient\C\Users\Randy Necessary\Pictures\101_0705\IMG_0028. 7/5/2022

GRM Approach	
GRM Code	
Gross Rent	0.00
Indicated Value	

Multiple Regression	
MRA Code	
Adjusted R	
Indicated Value	

Direct Comparables	
Selection Model	1 Res
Adjustment Model	A2 AO Test
Comparables	
Indicated Value	

Cost Approach				Manual : 01/2025			
Base Cost	108.06	Total Misc Impr	+ 30,181				
Roofing Adj	+ 4.72	Garage Cost	+ 0				
Subfloor Adj	+ -2.37	Total RCN	= 261,287				
Heat/Cool Adj	+ 12.64	Depreciation (13%)	- 33,967				
Plumbing Adj	+ 8.86	Lump Sums	+ 0				
Basement Adj	+ 0.00	RCNLD	= 227,320				
Adj Base Cost	= 131.91	Lot Value	+ 0				
Total Area	x 1,752	Indicated Value	= 227,320				
Adjusted Cost	= 231,106	Value Per SqFt	129.75				

Value Reconciliation			
Selected Approach	Cost Approach		
Improvements	227,320		
Lot Value			
Indicated Value	227,320	129.75	Per SqFt
Agland Value	1,181		
Site Improvements	59,210		
Total Value	515,031	293.97	Total Value Per SqFt

Miscellaneous Improvements								
Code	Description	Sketch ID	Size	Year	Units	Unit Cost	Depr	Value
PRCH	SLAB PORCH - COVERED	87481	24x6		144	26.48		3,813
PRCH	SLAB PORCH - COVERED	87482	945		945	24.35		23,011
PATO	SLAB PORCH - OPEN	140216	389		389	8.63		3,357



Rogers
Assessment Property Record Card for Tax Year 2026
 Data provided by LISA DELOZIER County Assessor

Date 04/17/2026
 Time 06:00:31
 Page 3

Sketch Image

660074032

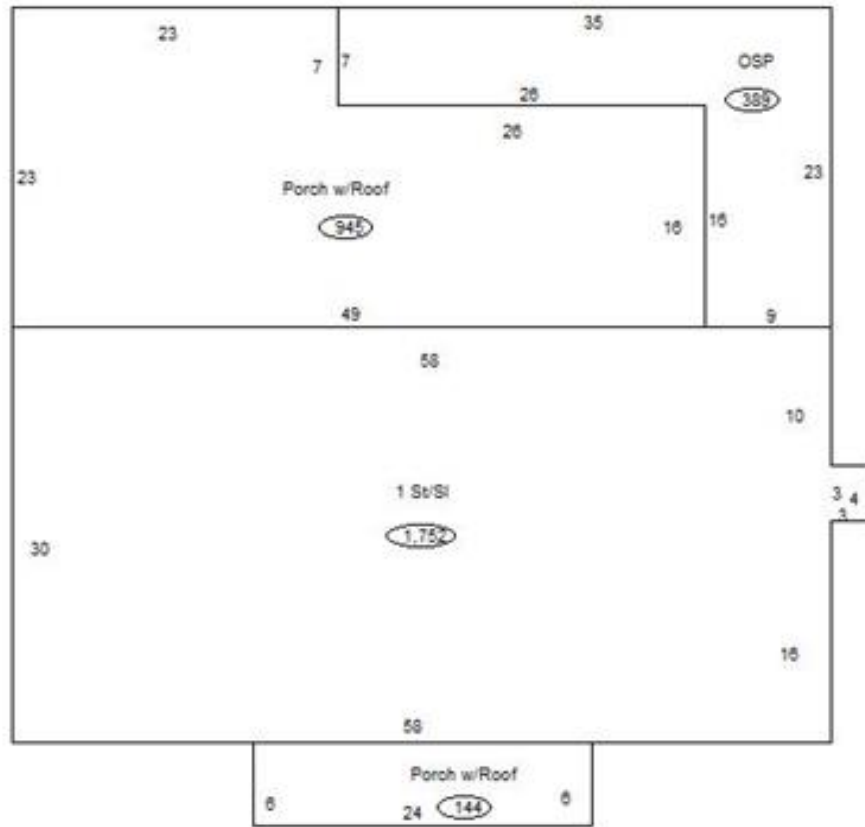

Sketch Vector Information

Sequence	Code	Type	Built Over	Scale	Section Label	Base Area	Multiplier	Total Area
1	R	1	Slab	10	1 St/Sl	1,752	1.000	1,752
2	M	PRCH		10	SLBC	144	1.000	144
3	M	PRCH		10	SLBC	945	1.000	945
4	M	PATO		10	Open Slab	389	1.000	389
Total Building Area						1,752		1,752



Rogers



Assessment Property Record Card for Tax Year 2026

Data provided by LISA DELOZIER County Assessor

Date 04/17/2026
 Time 06:00:31
 Page 4

660074032

Outbuildings/Site Improvements

Building Image	Code	Description	Dimensions	Floor	Roofing	Total Units
	BARN	BARN	30x38x0			1,140
	Qual 3	Cond 3	Year 2018	Eff Age	6	
		Valuation Summary	Modifier Total	RCN	Depr (24% Phys/ % Func)	RCNLD
		Base Cost (10.29 x 1,140)	11,731		11,731	2,815
	LT	LEAN-TO	16x38x0			608
	Qual 3	Cond 3	Year 2018	Eff Age		
		Valuation Summary	Modifier Total	RCN	Depr (0% Phys/ % Func)	RCNLD
		Base Cost (2.92 x 608)	1,775		1,775	1,775
	UTIL	SHOP BUILDING	0x0x0			2,400
	Qual 3	Cond 3	Year	Eff Age		
		Valuation Summary	Modifier Total	RCN	Depr (37% Phys/ % Func)	RCNLD
		Base Cost (26.95 x 2,400)	64,680		64,680	23,932
	UTIL	SHOP BUILDING	0x0x0			207
	Qual 4	Cond 3	Year	Eff Age		
		Valuation Summary	Modifier Total	RCN	Depr (0% Phys/ % Func)	RCNLD
		Base Cost (37.54 x 207)	7,771		7,771	7,771



Rogers

Assessment Property Record Card for Tax Year 2026

Data provided by LISA DELOZIER County Assessor

Date 04/17/2026
Time 06:00:31
Page 5

Agland Inventory

660074032

Soi	Description	Land Use	LPI	Adj Type	Adj Code	Acres	Use/Acre	Mkt/Acre	Use Value	Market Value
CHB	CHOTEAU SILT LOAM 1-3% SL	NTV PST	80			1.052	192	192	202	202
DNC	DENNIS SILT LOAM 3-5% SLO	NTV PST	69			1.249	166	166	207	207
PAA	PARSONS SILT LOAM 0-1% SL	IMP PST	76			2.248	213	213	478	478
RVC	RIVERTON GRAVELLY LOAM 3-	TMBR	61			2.681	110	110	294	294
TMBR Totals						7.230			1,181	1,181
Total Agland						7.230			1,181	1,181