



Rogers

Assessment Property Record Card for Tax Year 2026

Data provided by LISA DELOZIER County Assessor

Date 04/18/2026
Time 07:00:53
Page 1

Assessment Data					Primary Image																																																																																																																				
Account 660074231 Parcel ID 000000-00-0-00152-001-0008 Cadastral ID 25-23-14-02570 Property Type REAL - Real Property Property Class RRP VI Area 2 Tax Area 10 - OOLOGAH RURAL/NW FIRE Name ID 280444 PILCHER, ANGEL R & ELTON D 11955 S BRIDLE LN OOLOGAH OK 74053-0000 Parcel Location Situs 11955 BRIDLE LN Subdivision CHEYENNE ESTATES Lot/Block 0008 / 0001 Parcel Size 1 - Lots Sec/Twn/Rng 25 / 23 / 14 / 5 Neighborhood 1021 - R-V02-NW OOLOGAH School District S004 - OOLOGAH SCHOOLS																																																																																																																									
Legal Description Lot/Long: 36.43978973 -95.76574959																																																																																																																									
Building Permits					<table border="1"> <thead> <tr> <th>Number</th> <th>Description</th> <th>Opened</th> <th>Closed</th> <th>Amount</th> </tr> </thead> <tbody> <tr> <td>R 2016 03 28</td> <td>R17-ENCLOSING PATIO</td> <td>04/2016</td> <td>08/2016</td> <td>4,000</td> </tr> </tbody> </table>					Number	Description	Opened	Closed	Amount	R 2016 03 28	R17-ENCLOSING PATIO	04/2016	08/2016	4,000																																																																																																						
Number	Description	Opened	Closed	Amount																																																																																																																					
R 2016 03 28	R17-ENCLOSING PATIO	04/2016	08/2016	4,000																																																																																																																					
Exemptions					Sale History																																																																																																																				
<table border="1"> <thead> <tr> <th>Code</th> <th>Type</th> <th>Active</th> <th>Maximum</th> <th>Exemption</th> </tr> </thead> <tbody> <tr> <td>H</td> <td>Homestead</td> <td>Yes</td> <td>1,000</td> <td>1,000</td> </tr> </tbody> </table>					Code	Type	Active	Maximum	Exemption	H	Homestead	Yes	1,000	1,000	<table border="1"> <thead> <tr> <th>Bk/Pg</th> <th>Grantor</th> <th>Date</th> <th>Price</th> <th>Code</th> </tr> </thead> <tbody> <tr> <td>/</td> <td>PILCHER, ANGEL R</td> <td>10/01/2018</td> <td>0</td> <td>4</td> </tr> <tr> <td>1397/177</td> <td>AMERISTAR LLC</td> <td>08/02/2002</td> <td>135,000</td> <td>YES</td> </tr> <tr> <td>1363/485</td> <td>JIMCO CONSTRUCTION INC</td> <td>03/08/2002</td> <td>17,500</td> <td>YES</td> </tr> </tbody> </table>					Bk/Pg	Grantor	Date	Price	Code	/	PILCHER, ANGEL R	10/01/2018	0	4	1397/177	AMERISTAR LLC	08/02/2002	135,000	YES	1363/485	JIMCO CONSTRUCTION INC	03/08/2002	17,500	YES																																																																																		
Code	Type	Active	Maximum	Exemption																																																																																																																					
H	Homestead	Yes	1,000	1,000																																																																																																																					
Bk/Pg	Grantor	Date	Price	Code																																																																																																																					
/	PILCHER, ANGEL R	10/01/2018	0	4																																																																																																																					
1397/177	AMERISTAR LLC	08/02/2002	135,000	YES																																																																																																																					
1363/485	JIMCO CONSTRUCTION INC	03/08/2002	17,500	YES																																																																																																																					
Parcel Valuation																																																																																																																									
<table border="1"> <thead> <tr> <th>Source</th> <th>REAL</th> </tr> </thead> <tbody> <tr> <td>Remove Cap</td> <td>2003</td> </tr> <tr> <td>Year Frozen</td> <td>0</td> </tr> <tr> <td>Uncapped Value</td> <td>0</td> </tr> <tr> <td>TIF Project ID</td> <td>0</td> </tr> </tbody> </table>		Source	REAL	Remove Cap	2003	Year Frozen	0	Uncapped Value	0	TIF Project ID	0	<table border="1"> <thead> <tr> <th>Fair Cash</th> <th>Capped</th> <th>Asmnt Level</th> <th>Assessed</th> </tr> </thead> <tbody> <tr> <td>Land Value</td> <td>94,603</td> <td>25,446</td> <td>2,799</td> </tr> <tr> <td>Improvements</td> <td>176,974</td> <td>171,975</td> <td>18,917</td> </tr> <tr> <td>Mobile Home</td> <td>0</td> <td>0</td> <td>0</td> </tr> <tr> <td>Total Value</td> <td>271,577</td> <td>197,421</td> <td>21,716</td> </tr> </tbody> </table>			Fair Cash	Capped	Asmnt Level	Assessed	Land Value	94,603	25,446	2,799	Improvements	176,974	171,975	18,917	Mobile Home	0	0	0	Total Value	271,577	197,421	21,716	<table border="1"> <thead> <tr> <th>Levy Rate</th> <th>Current Tax</th> </tr> </thead> <tbody> <tr> <td>108.182</td> <td>2,349.27</td> </tr> <tr> <td>Assessed</td> <td>21,716</td> </tr> <tr> <td>Penalty</td> <td>0</td> </tr> <tr> <td>Exemption</td> <td>1,000</td> </tr> <tr> <td>Total Taxable</td> <td>20,716</td> </tr> </tbody> </table>		Levy Rate	Current Tax	108.182	2,349.27	Assessed	21,716	Penalty	0	Exemption	1,000	Total Taxable	20,716																																																																									
Source	REAL																																																																																																																								
Remove Cap	2003																																																																																																																								
Year Frozen	0																																																																																																																								
Uncapped Value	0																																																																																																																								
TIF Project ID	0																																																																																																																								
Fair Cash	Capped	Asmnt Level	Assessed																																																																																																																						
Land Value	94,603	25,446	2,799																																																																																																																						
Improvements	176,974	171,975	18,917																																																																																																																						
Mobile Home	0	0	0																																																																																																																						
Total Value	271,577	197,421	21,716																																																																																																																						
Levy Rate	Current Tax																																																																																																																								
108.182	2,349.27																																																																																																																								
Assessed	21,716																																																																																																																								
Penalty	0																																																																																																																								
Exemption	1,000																																																																																																																								
Total Taxable	20,716																																																																																																																								
Assessment History																																																																																																																									
<table border="1"> <thead> <tr> <th>Tax Year</th> <th>Statement Number</th> <th>Billed Owner</th> <th>Tax Area</th> <th>Total Value</th> <th>Exemptions</th> <th>Taxable Value</th> <th>Billed Tax</th> </tr> </thead> <tbody> <tr><td>2025</td><td>2025-660074231</td><td>PILCHER, ANGEL R &</td><td>10</td><td>264,780</td><td>1000</td><td>20,084</td><td>2,186.00</td></tr> <tr><td>2024</td><td>2024-660074231</td><td>PILCHER, ANGEL R &</td><td>10</td><td>272,356</td><td>1000</td><td>19,469</td><td>2,053.00</td></tr> <tr><td>2023</td><td>2023-660074231</td><td>PILCHER, ANGEL R &</td><td>10</td><td>201,708</td><td>1000</td><td>18,874</td><td>1,976.00</td></tr> <tr><td>2022</td><td>2022-660074231</td><td>PILCHER, ANGEL R &</td><td>10</td><td>203,772</td><td>1000</td><td>18,295</td><td>1,907.00</td></tr> <tr><td>2021</td><td>2021-660074231</td><td>PILCHER, ANGEL R &</td><td>10</td><td>176,612</td><td>1000</td><td>17,733</td><td>1,862.00</td></tr> <tr><td>2020</td><td>2020-660074231</td><td>PILCHER, ANGEL R &</td><td>10</td><td>176,402</td><td>1000</td><td>17,187</td><td>1,832.00</td></tr> <tr><td>2019</td><td>2019-660074231</td><td>PILCHER, ANGEL R &</td><td>10</td><td>167,445</td><td>1000</td><td>16,658</td><td>1,743.00</td></tr> <tr><td>2018</td><td>2018-660074231</td><td>PILCHER, ANGEL R</td><td>10</td><td>171,736</td><td>1000</td><td>16,143</td><td>1,747.00</td></tr> <tr><td>2017</td><td>2017-660074231</td><td>PILCHER, ANGEL R</td><td>10</td><td>170,298</td><td>1000</td><td>15,644</td><td>1,792.00</td></tr> <tr><td>2016</td><td>2016-660074231</td><td>PILCHER, ANGEL R</td><td>10</td><td>141,406</td><td>1000</td><td>14,520</td><td>1,518.00</td></tr> <tr><td>2015</td><td>2015-660074231</td><td>PILCHER, ANGEL R</td><td>10</td><td>138,232</td><td>1000</td><td>14,068</td><td>1,391.00</td></tr> <tr><td>2014</td><td>2014-660074231</td><td>PILCHER, ANGEL R</td><td>10</td><td>140,584</td><td>1000</td><td>13,630</td><td>1,345.00</td></tr> <tr><td>2013</td><td>2013-660074231</td><td>PILCHER, ANGEL R</td><td>10</td><td>132,131</td><td>1000</td><td>13,204</td><td>1,261.00</td></tr> </tbody> </table>										Tax Year	Statement Number	Billed Owner	Tax Area	Total Value	Exemptions	Taxable Value	Billed Tax	2025	2025-660074231	PILCHER, ANGEL R &	10	264,780	1000	20,084	2,186.00	2024	2024-660074231	PILCHER, ANGEL R &	10	272,356	1000	19,469	2,053.00	2023	2023-660074231	PILCHER, ANGEL R &	10	201,708	1000	18,874	1,976.00	2022	2022-660074231	PILCHER, ANGEL R &	10	203,772	1000	18,295	1,907.00	2021	2021-660074231	PILCHER, ANGEL R &	10	176,612	1000	17,733	1,862.00	2020	2020-660074231	PILCHER, ANGEL R &	10	176,402	1000	17,187	1,832.00	2019	2019-660074231	PILCHER, ANGEL R &	10	167,445	1000	16,658	1,743.00	2018	2018-660074231	PILCHER, ANGEL R	10	171,736	1000	16,143	1,747.00	2017	2017-660074231	PILCHER, ANGEL R	10	170,298	1000	15,644	1,792.00	2016	2016-660074231	PILCHER, ANGEL R	10	141,406	1000	14,520	1,518.00	2015	2015-660074231	PILCHER, ANGEL R	10	138,232	1000	14,068	1,391.00	2014	2014-660074231	PILCHER, ANGEL R	10	140,584	1000	13,630	1,345.00	2013	2013-660074231	PILCHER, ANGEL R	10	132,131	1000	13,204	1,261.00
Tax Year	Statement Number	Billed Owner	Tax Area	Total Value	Exemptions	Taxable Value	Billed Tax																																																																																																																		
2025	2025-660074231	PILCHER, ANGEL R &	10	264,780	1000	20,084	2,186.00																																																																																																																		
2024	2024-660074231	PILCHER, ANGEL R &	10	272,356	1000	19,469	2,053.00																																																																																																																		
2023	2023-660074231	PILCHER, ANGEL R &	10	201,708	1000	18,874	1,976.00																																																																																																																		
2022	2022-660074231	PILCHER, ANGEL R &	10	203,772	1000	18,295	1,907.00																																																																																																																		
2021	2021-660074231	PILCHER, ANGEL R &	10	176,612	1000	17,733	1,862.00																																																																																																																		
2020	2020-660074231	PILCHER, ANGEL R &	10	176,402	1000	17,187	1,832.00																																																																																																																		
2019	2019-660074231	PILCHER, ANGEL R &	10	167,445	1000	16,658	1,743.00																																																																																																																		
2018	2018-660074231	PILCHER, ANGEL R	10	171,736	1000	16,143	1,747.00																																																																																																																		
2017	2017-660074231	PILCHER, ANGEL R	10	170,298	1000	15,644	1,792.00																																																																																																																		
2016	2016-660074231	PILCHER, ANGEL R	10	141,406	1000	14,520	1,518.00																																																																																																																		
2015	2015-660074231	PILCHER, ANGEL R	10	138,232	1000	14,068	1,391.00																																																																																																																		
2014	2014-660074231	PILCHER, ANGEL R	10	140,584	1000	13,630	1,345.00																																																																																																																		
2013	2013-660074231	PILCHER, ANGEL R	10	132,131	1000	13,204	1,261.00																																																																																																																		



Rogers

Assessment Property Record Card for Tax Year 2026

Data provided by LISA DELOZIER County Assessor

Date 04/18/2026
Time 07:00:54
Page 2

Lot Data	Square-Foot - NBHD 1021 #1	Primary Image
Lot Size		
Lot Count		
Units Buildable	1	
Non-Ag Acres	1.8479	
Topography		
Street Access		
Utilities		
Amenities	LAND QUALITY	
	0	
	0	
Method	Square-Foot	
Base Lot Value	80,496.00 x 1.18 = 94,603	
Factor Value		
Adjustments	1.0000	
Lot Value	94,603	

Residential Data	
Type	1 Single Family Residence
Condition	3 - Average
Quality	2.5 - Fair
Architecture	
Style	100% One Story
Exterior Wall	20% Veneer, Masonry 80% Frame, Siding, Wood
Base/Total Area	1,790 / 1,790
Style	100% One Story
HVAC	100% Warmed & Cooled Air
Roof Cover	1 Composition Shingle
Area on Slab	1,790
Fixture/RghIn	11 /
Bed/F/H Bath	3 / 2.0 /
Basement Area	
Garage Type	462 Attached Garage - Unfinished
Remodel	
Year/Eff Age	2002 / 18



\\tsclient\TCASEY\2020-7-23\IMG_0107.JPG 7/24/2020

GRM Approach	
GRM Code	
Gross Rent	0.00
Indicated Value	

Multiple Regression			
MRA Code	1	Test	
Adjusted R	0.8445		
Indicated Value	202,083	112.90	Per SqFt

Direct Comparables			
Selection Model	A	Adam Test	
Adjustment Model	1	2022 Residential	
Comparables	1		
Indicated Value	22,130		Per SqFt

Cost Approach				Manual : 01/2025			
Base Cost	89.66	Total Misc Impr	+	13,515			
Roofing Adj	+ 4.07	Garage Cost	+	12,931			
Subfloor Adj	+ -1.09	Total RCN	=	226,890			
Heat/Cool Adj	+ 11.47	Depreciation (22%)	-	49,916			
Plumbing Adj	+ 7.87	Lump Sums	+	0			
Basement Adj	+ 0.00	RCNLD	=	176,974			
Adj Base Cost	= 111.98	Lot Value	+	94,603			
Total Area	x 1,790	Indicated Value	=	271,577			
Adjusted Cost	= 200,444	Value Per SqFt		151.72			

Value Reconciliation			
Selected Approach	Cost Approach		
Improvements	176,974		
Lot Value	94,603		
Indicated Value	271,577	151.72	Per SqFt
Agland Value			
Site Improvements			
Total Value	271,577	151.72	Total Value Per SqFt

Miscellaneous Improvements								
Code	Description	Sketch ID	Size	Year	Units	Unit Cost	Depr	Value
PRCH	SLAB PORCH - COVERED	87673	16x8		128	23.84		3,052
EPSW	ENCLOSED PORCH - SOLID WALL	129024	14x12		168	62.28		10,463



Rogers

Assessment Property Record Card for Tax Year 2026

Data provided by LISA DELOZIER County Assessor

Date 04/18/2026
 Time 07:00:54
 Page 3

Sketch Image

660074231

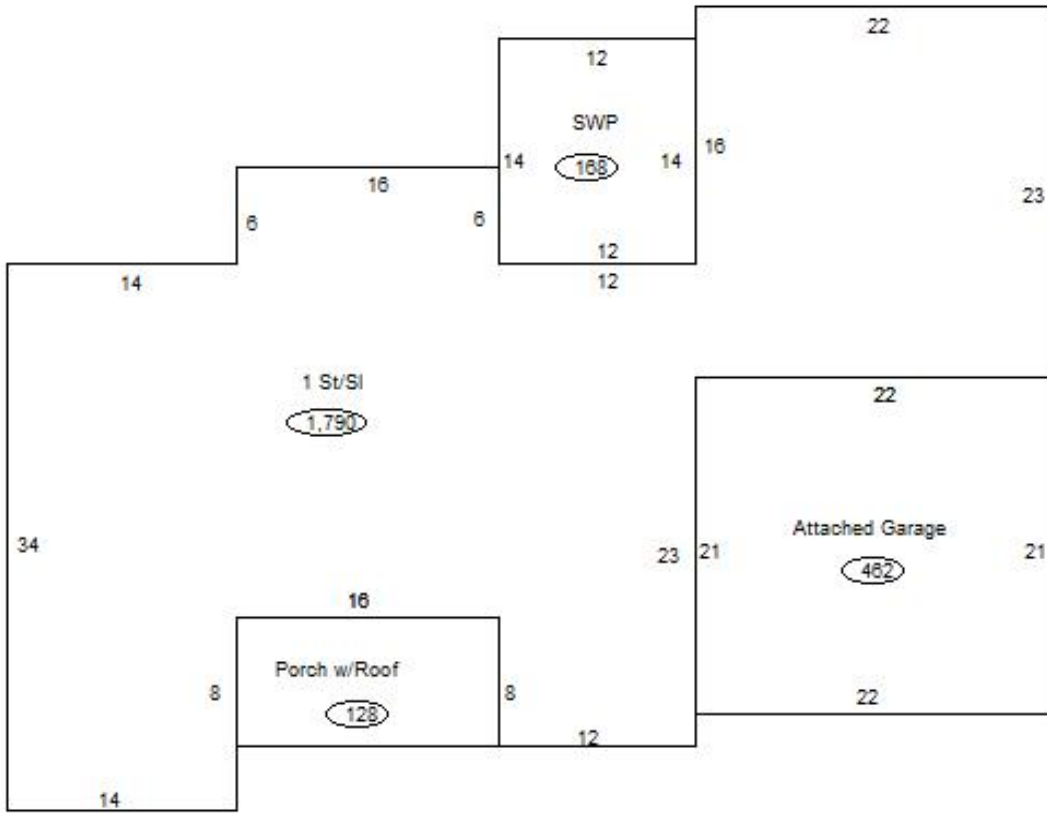

Sketch Vector Information

Sequence	Code	Type	Built Over	Scale	Section Label	Base Area	Multiplier	Total Area
1	R	1	Slab	13	1 St/Sl	1,790	1.000	1,790
2	G	1		13	Attached Garage	462	1.000	462
3	M	PRCH		13	SLBC	128	1.000	128
4	M	EPSW		13	EPSW	168	1.000	168
Total Building Area						1,790		1,790



Rogers

Assessment Property Record Card for Tax Year 2026

Data provided by LISA DELOZIER County Assessor

Date 04/18/2026
Time 07:00:54
Page 4

660074231

Outbuildings/Site Improvements

Building Image	Code	Description	Dimensions	Floor	Roofing	Total Units
	STF	STG FAIR	0x0x0			
	Qual	2	Cond	Year	Eff Age	
Valuation Summary			Modifier Total	RCN	Depr (100% Phys/ % Func)	RCNLD
		Base Cost (4.68 x)				