



# Rogers

## Assessment Property Record Card for Tax Year 2026

Data provided by LISA DELOZIER County Assessor

Date 04/18/2026  
 Time 07:17:02  
 Page 1

Assessment Data					Primary Image																																																																																																																				
<b>Account</b> 660074342 <b>Parcel ID</b> 000000-00-0-00550-004-0003 <b>Cadastral ID</b> 31-21-15-03320 <b>Property Type</b> REAL - Real Property <b>Property Class</b> RRP VI Area 4 <b>Tax Area</b> 7 - OWASSO/LIMESTONE FIRE <b>Name ID</b> 343848 SHAW, DARRELL CRAIG JR & ELIZABETH A  7230 N 198TH E AVE OWASSO OK 74055-0000  <b>Parcel Location</b> <b>Situs</b> 07230 N 198TH E AVE <b>Subdivision</b> OAKRIDGE AT COOPER RANCH <b>Lot/Block</b> 0003 / 0004 <b>Parcel Size</b> 1 - Lots <b>Sec/Twn/Rng</b> 31 / 21 / 15 / 5 <b>Neighborhood</b> 1175 - R-V01-SW CLAREMORE <b>School District</b> S021 - OWASSO SCHOOLS																																																																																																																									
<b>Legal Description</b> Lot/Long: 36.25837680 -95.75184972 LOT 3 BLOCK 4 OAKRIDGE AT COOPER RANCH																																																																																																																									
<b>Exemptions</b> <table border="1"> <thead> <tr> <th>Code</th> <th>Type</th> <th>Active</th> <th>Maximum</th> <th>Exemption</th> </tr> </thead> <tbody> <tr> <td>HV</td> <td>Veteran</td> <td>Yes</td> <td>999,999</td> <td>64,221</td> </tr> </tbody> </table>					Code	Type	Active	Maximum	Exemption	HV	Veteran	Yes	999,999	64,221	<b>Building Permits</b> <table border="1"> <thead> <tr> <th>Number</th> <th>Description</th> <th>Opened</th> <th>Closed</th> <th>Amount</th> </tr> </thead> <tbody> <tr> <td>R2011 0812</td> <td>R12-NEW 900 SQ FT ADDITION</td> <td>08/2011</td> <td>12/2011</td> <td>130,000</td> </tr> </tbody> </table>					Number	Description	Opened	Closed	Amount	R2011 0812	R12-NEW 900 SQ FT ADDITION	08/2011	12/2011	130,000																																																																																												
Code	Type	Active	Maximum	Exemption																																																																																																																					
HV	Veteran	Yes	999,999	64,221																																																																																																																					
Number	Description	Opened	Closed	Amount																																																																																																																					
R2011 0812	R12-NEW 900 SQ FT ADDITION	08/2011	12/2011	130,000																																																																																																																					
<b>Parcel Valuation</b> <table border="1"> <thead> <tr> <th>Source</th> <th>REAL</th> <th>Fair Cash</th> <th>Capped</th> <th>Asmnt Level</th> <th>Assessed</th> <th>Levy Rate</th> <th>108.538</th> <th>Current Tax</th> </tr> </thead> <tbody> <tr> <td>Remove Cap</td> <td>2025</td> <td>Land Value</td> <td>109,226</td> <td>109,226</td> <td>11%</td> <td>12,015</td> <td>Assessed</td> <td>64,221 6,970.42</td> </tr> <tr> <td>Year Frozen</td> <td>0</td> <td>Improvements</td> <td>474,597</td> <td>474,597</td> <td></td> <td>52,206</td> <td>Penalty</td> <td>0</td> </tr> <tr> <td>Uncapped Value</td> <td>0</td> <td>Mobile Home</td> <td>0</td> <td>0</td> <td></td> <td>0</td> <td>Exemption</td> <td>64,221 -6,291.00</td> </tr> <tr> <td>TIF Project ID</td> <td>0</td> <td>Total Value</td> <td>583,823</td> <td>583,823</td> <td></td> <td>64,221</td> <td>Total Taxable</td> <td>0 679.00</td> </tr> </tbody> </table>					Source	REAL	Fair Cash	Capped	Asmnt Level	Assessed	Levy Rate	108.538	Current Tax	Remove Cap	2025	Land Value	109,226	109,226	11%	12,015	Assessed	64,221 6,970.42	Year Frozen	0	Improvements	474,597	474,597		52,206	Penalty	0	Uncapped Value	0	Mobile Home	0	0		0	Exemption	64,221 -6,291.00	TIF Project ID	0	Total Value	583,823	583,823		64,221	Total Taxable	0 679.00	<b>Sale History</b> <table border="1"> <thead> <tr> <th>Bk/Pg</th> <th>Grantor</th> <th>Date</th> <th>Price</th> <th>Code</th> </tr> </thead> <tbody> <tr> <td>/</td> <td>BROOKS, BRANDON CODY &amp;</td> <td>03/08/2024</td> <td>595,000</td> <td>WG</td> </tr> <tr> <td>/</td> <td>JOHNSON, THEODORE E &amp;</td> <td>08/24/2020</td> <td>449,000</td> <td>YES</td> </tr> <tr> <td>2180/533</td> <td>CLARK, DEVAH</td> <td>06/28/2011</td> <td>288,000</td> <td>YES</td> </tr> <tr> <td>1664/462</td> <td>SIMMONS HOMES RESIDENTIAL</td> <td>03/16/2005</td> <td>230,500</td> <td>YES</td> </tr> <tr> <td>1620/873</td> <td>KOURTIS PROPERIES-COOPER-RAN</td> <td>09/15/2004</td> <td>45,500</td> <td>YES</td> </tr> </tbody> </table>					Bk/Pg	Grantor	Date	Price	Code	/	BROOKS, BRANDON CODY &	03/08/2024	595,000	WG	/	JOHNSON, THEODORE E &	08/24/2020	449,000	YES	2180/533	CLARK, DEVAH	06/28/2011	288,000	YES	1664/462	SIMMONS HOMES RESIDENTIAL	03/16/2005	230,500	YES	1620/873	KOURTIS PROPERIES-COOPER-RAN	09/15/2004	45,500	YES																																					
Source	REAL	Fair Cash	Capped	Asmnt Level	Assessed	Levy Rate	108.538	Current Tax																																																																																																																	
Remove Cap	2025	Land Value	109,226	109,226	11%	12,015	Assessed	64,221 6,970.42																																																																																																																	
Year Frozen	0	Improvements	474,597	474,597		52,206	Penalty	0																																																																																																																	
Uncapped Value	0	Mobile Home	0	0		0	Exemption	64,221 -6,291.00																																																																																																																	
TIF Project ID	0	Total Value	583,823	583,823		64,221	Total Taxable	0 679.00																																																																																																																	
Bk/Pg	Grantor	Date	Price	Code																																																																																																																					
/	BROOKS, BRANDON CODY &	03/08/2024	595,000	WG																																																																																																																					
/	JOHNSON, THEODORE E &	08/24/2020	449,000	YES																																																																																																																					
2180/533	CLARK, DEVAH	06/28/2011	288,000	YES																																																																																																																					
1664/462	SIMMONS HOMES RESIDENTIAL	03/16/2005	230,500	YES																																																																																																																					
1620/873	KOURTIS PROPERIES-COOPER-RAN	09/15/2004	45,500	YES																																																																																																																					
<b>Assessment History</b> <table border="1"> <thead> <tr> <th>Tax Year</th> <th>Statement Number</th> <th>Billed Owner</th> <th>Tax Area</th> <th>Total Value</th> <th>Exemptions</th> <th>Taxable Value</th> <th>Billed Tax</th> </tr> </thead> <tbody> <tr> <td>2025</td> <td>2025-660074342</td> <td>SHAW, DARRELL CRAIG JR &amp;</td> <td>7</td> <td>573,022</td> <td>63033</td> <td></td> <td>667.00</td> </tr> <tr> <td>2024</td> <td>2024-660074342</td> <td>SHAW, DARRELL CRAIG JR &amp;</td> <td>7</td> <td>595,170</td> <td>0</td> <td>57,728</td> <td>6,370.00</td> </tr> <tr> <td>2023</td> <td>2023-660074342</td> <td>BROOKS, BRANDON CODY &amp;</td> <td>7</td> <td>667,335</td> <td>0</td> <td>54,979</td> <td>5,937.00</td> </tr> <tr> <td>2022</td> <td>2022-660074342</td> <td>BROOKS, BRANDON CODY &amp;</td> <td>7</td> <td>487,282</td> <td>0</td> <td>52,362</td> <td>5,878.00</td> </tr> <tr> <td>2021</td> <td>2021-660074342</td> <td>BROOKS, BRANDON CODY &amp;</td> <td>7</td> <td>453,349</td> <td>0</td> <td>49,868</td> <td>5,536.00</td> </tr> <tr> <td>2020</td> <td>2020-660074342</td> <td>BROOKS, BRANDON CODY &amp;</td> <td>7</td> <td>427,162</td> <td>1000</td> <td>45,988</td> <td>5,113.00</td> </tr> <tr> <td>2019</td> <td>2019-660074342</td> <td>JOHNSON, THEODORE E &amp;</td> <td>7</td> <td>420,193</td> <td>1000</td> <td>45,221</td> <td>5,032.00</td> </tr> <tr> <td>2018</td> <td>2018-660074342</td> <td>JOHNSON, THEODORE E &amp;</td> <td>7</td> <td>431,041</td> <td>1000</td> <td>46,414</td> <td>4,997.00</td> </tr> <tr> <td>2017</td> <td>2017-660074342</td> <td>JOHNSON, THEODORE E &amp;</td> <td>7</td> <td>427,376</td> <td>1000</td> <td>45,396</td> <td>4,933.00</td> </tr> <tr> <td>2016</td> <td>2016-660074342</td> <td>JOHNSON, THEODORE E &amp;</td> <td>7</td> <td>423,016</td> <td>1000</td> <td>44,045</td> <td>4,790.00</td> </tr> <tr> <td>2015</td> <td>2015-660074342</td> <td>JOHNSON, THEODORE E &amp;</td> <td>7</td> <td>409,828</td> <td>1000</td> <td>42,733</td> <td>4,677.00</td> </tr> <tr> <td>2014</td> <td>2014-660074342</td> <td>JOHNSON, THEODORE E &amp;</td> <td>7</td> <td>412,265</td> <td>1000</td> <td>41,459</td> <td>4,574.00</td> </tr> <tr> <td>2013</td> <td>2013-660074342</td> <td>JOHNSON, THEODORE E &amp;</td> <td>7</td> <td>386,966</td> <td>1000</td> <td>40,222</td> <td>4,357.00</td> </tr> </tbody> </table>										Tax Year	Statement Number	Billed Owner	Tax Area	Total Value	Exemptions	Taxable Value	Billed Tax	2025	2025-660074342	SHAW, DARRELL CRAIG JR &	7	573,022	63033		667.00	2024	2024-660074342	SHAW, DARRELL CRAIG JR &	7	595,170	0	57,728	6,370.00	2023	2023-660074342	BROOKS, BRANDON CODY &	7	667,335	0	54,979	5,937.00	2022	2022-660074342	BROOKS, BRANDON CODY &	7	487,282	0	52,362	5,878.00	2021	2021-660074342	BROOKS, BRANDON CODY &	7	453,349	0	49,868	5,536.00	2020	2020-660074342	BROOKS, BRANDON CODY &	7	427,162	1000	45,988	5,113.00	2019	2019-660074342	JOHNSON, THEODORE E &	7	420,193	1000	45,221	5,032.00	2018	2018-660074342	JOHNSON, THEODORE E &	7	431,041	1000	46,414	4,997.00	2017	2017-660074342	JOHNSON, THEODORE E &	7	427,376	1000	45,396	4,933.00	2016	2016-660074342	JOHNSON, THEODORE E &	7	423,016	1000	44,045	4,790.00	2015	2015-660074342	JOHNSON, THEODORE E &	7	409,828	1000	42,733	4,677.00	2014	2014-660074342	JOHNSON, THEODORE E &	7	412,265	1000	41,459	4,574.00	2013	2013-660074342	JOHNSON, THEODORE E &	7	386,966	1000	40,222	4,357.00
Tax Year	Statement Number	Billed Owner	Tax Area	Total Value	Exemptions	Taxable Value	Billed Tax																																																																																																																		
2025	2025-660074342	SHAW, DARRELL CRAIG JR &	7	573,022	63033		667.00																																																																																																																		
2024	2024-660074342	SHAW, DARRELL CRAIG JR &	7	595,170	0	57,728	6,370.00																																																																																																																		
2023	2023-660074342	BROOKS, BRANDON CODY &	7	667,335	0	54,979	5,937.00																																																																																																																		
2022	2022-660074342	BROOKS, BRANDON CODY &	7	487,282	0	52,362	5,878.00																																																																																																																		
2021	2021-660074342	BROOKS, BRANDON CODY &	7	453,349	0	49,868	5,536.00																																																																																																																		
2020	2020-660074342	BROOKS, BRANDON CODY &	7	427,162	1000	45,988	5,113.00																																																																																																																		
2019	2019-660074342	JOHNSON, THEODORE E &	7	420,193	1000	45,221	5,032.00																																																																																																																		
2018	2018-660074342	JOHNSON, THEODORE E &	7	431,041	1000	46,414	4,997.00																																																																																																																		
2017	2017-660074342	JOHNSON, THEODORE E &	7	427,376	1000	45,396	4,933.00																																																																																																																		
2016	2016-660074342	JOHNSON, THEODORE E &	7	423,016	1000	44,045	4,790.00																																																																																																																		
2015	2015-660074342	JOHNSON, THEODORE E &	7	409,828	1000	42,733	4,677.00																																																																																																																		
2014	2014-660074342	JOHNSON, THEODORE E &	7	412,265	1000	41,459	4,574.00																																																																																																																		
2013	2013-660074342	JOHNSON, THEODORE E &	7	386,966	1000	40,222	4,357.00																																																																																																																		



# Rogers

## Assessment Property Record Card for Tax Year 2026

Data provided by LISA DELOZIER County Assessor

Date 04/18/2026  
 Time 07:17:03  
 Page 2

Lot Data		Square-Foot - NBHD 1175 #1	
Lot Size			
Lot Count	1		
Units Buildable	6395		
Non-Ag Acres	1.041		
Topography			
Street Access			
Utilities			
Amenities	LAND QUALITY	0	0
Method	Square-Foot		
Base Lot Value	45,348.00 x 2.85 = 129,185		
Factor Value			
Adjustments	0.8455		
Lot Value	109,226		



\\tsclient\C\Users\Randy Necessary\Pictures\101\_0630\IMG\_0040. 7/1/2022

Residential Data	
Type	1 Single Family Residence
Condition	3 - Average
Quality	4 - Good
Architecture	
Style	100% 1 1/2 Story Finished
Exterior Wall	100% Veneer, Masonry
Base/Total Area	2,085 / 2,864
Style	100% 1 1/2 Story Finished
HVAC	100% Warmed & Cooled Air
Roof Cover	1 Composition Shingle
Area on Slab	2,085
Fixture/RghIn	14 /
Bed/F/H Bath	5 / 3.5 /
Basement Area	
Garage Type	420 Attached Garage - Unfinished
Remodel	
Year/Eff Age	2005 / 16

### GRM Approach

GRM Code	
Gross Rent	0.00
Indicated Value	

### Multiple Regression

MRA Code	1 Test
Adusted R	0.8445
Indicated Value	373,707 130.48 Per SqFt

### Direct Comparables

Selection Model	A Adam Test
Adjustment Model	1 2022 Residential
Comparables	8
Indicated Value	448,960 Per SqFt

### Value Reconciliation

Selected Approach	Cost Approach
Improvements	338,003
Lot Value	109,226
Indicated Value	447,229 156.16 Per SqFt
Agland Value	
Site Improvements	
Total Value	447,229 156.16 Total Value Per SqFt

### Cost Approach Manual : 01/2025

Base Cost	102.79	Total Misc Impr	+	16,618
Roofing Adj	+ 4.37	Garage Cost	+	21,416
Subfloor Adj	+ -3.36	Total RCN	=	407,232
Heat/Cool Adj	+ 16.31	Depreciation ( 17%)	-	69,229
Plumbing Adj	+ 8.80	Lump Sums	+	0
Basement Adj	+ 0.00	RCNLD	=	338,003
Adj Base Cost	= 128.91	Lot Value	+	109,226
Total Area	x 2,864	Indicated Value	=	447,229
Adjusted Cost	= 369,198	Value Per SqFt		156.16

### Miscellaneous Improvements

Code	Description	Sketch ID	Size	Year	Units	Unit Cost	Depr	Value
FPR1	FIREPLACE - RESIDENTIAL 1 STORY	0		1	1	7,243.87		7,244
PRCH	SLAB PORCH - COVERED	88018		108	108	32.83		3,546
PRCH	SLAB PORCH - COVERED	88019		180	180	32.38		5,828



# Rogers

## Assessment Property Record Card for Tax Year 2026

Data provided by LISA DELOZIER County Assessor

Date 04/18/2026

Time 07:17:03

Page 3

Sketch Image

660074342

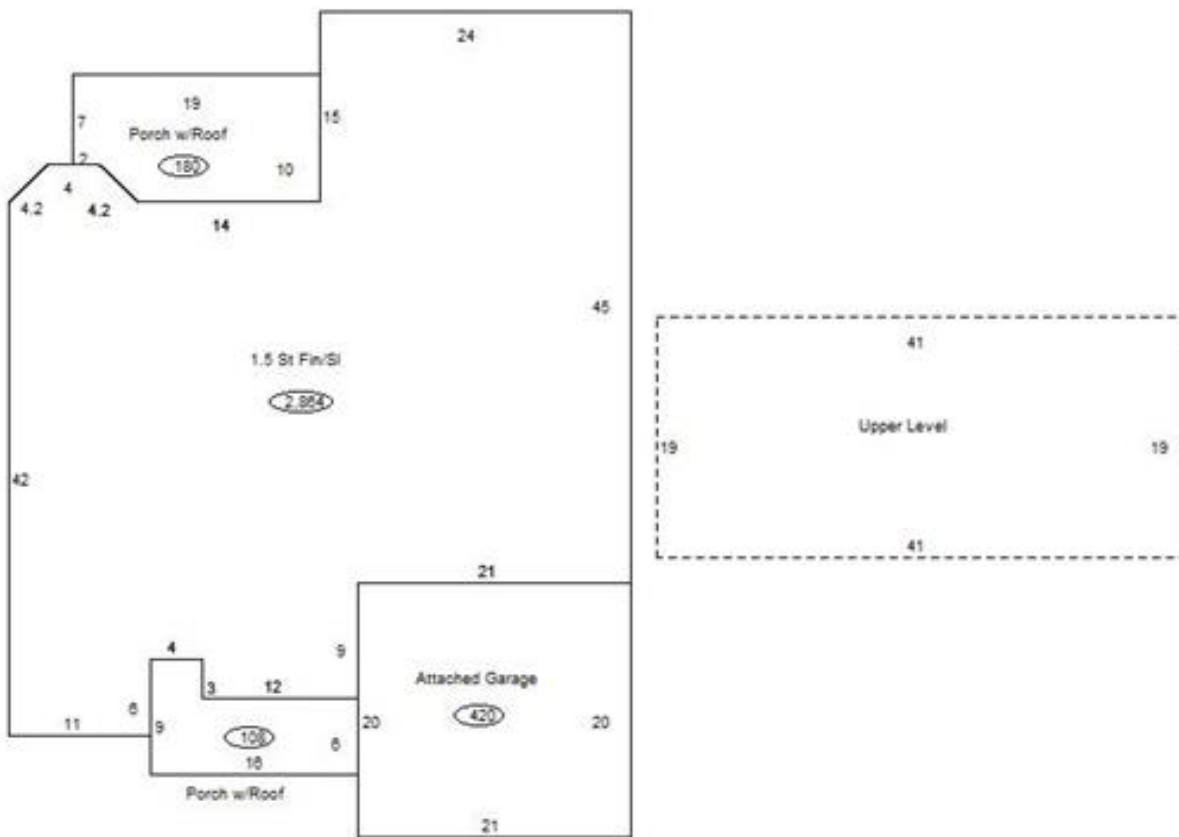

### Sketch Vector Information

Sequence	Code	Type	Built Over	Scale	Section Label	Base Area	Multiplier	Total Area
1	R	5	Slab	13	1.5 St Fin/Sl	2,085	1.374	2,864
2	U	^UL	Overhang	13	Upper Level	779	1.000	779
3	G	1		13	Attached Garage	420	1.000	420
4	M	PRCH		13	SLBC	108	1.000	108
5	M	PRCH		13	SLBC	180	1.000	180
<b>Total Building Area</b>						2,085		2,864





# Rogers

## Assessment Property Record Card for Tax Year 2026

Data provided by LISA DELOZIER County Assessor

Date 04/18/2026  
 Time 07:17:03  
 Page 5

### Sketch Image

660074342

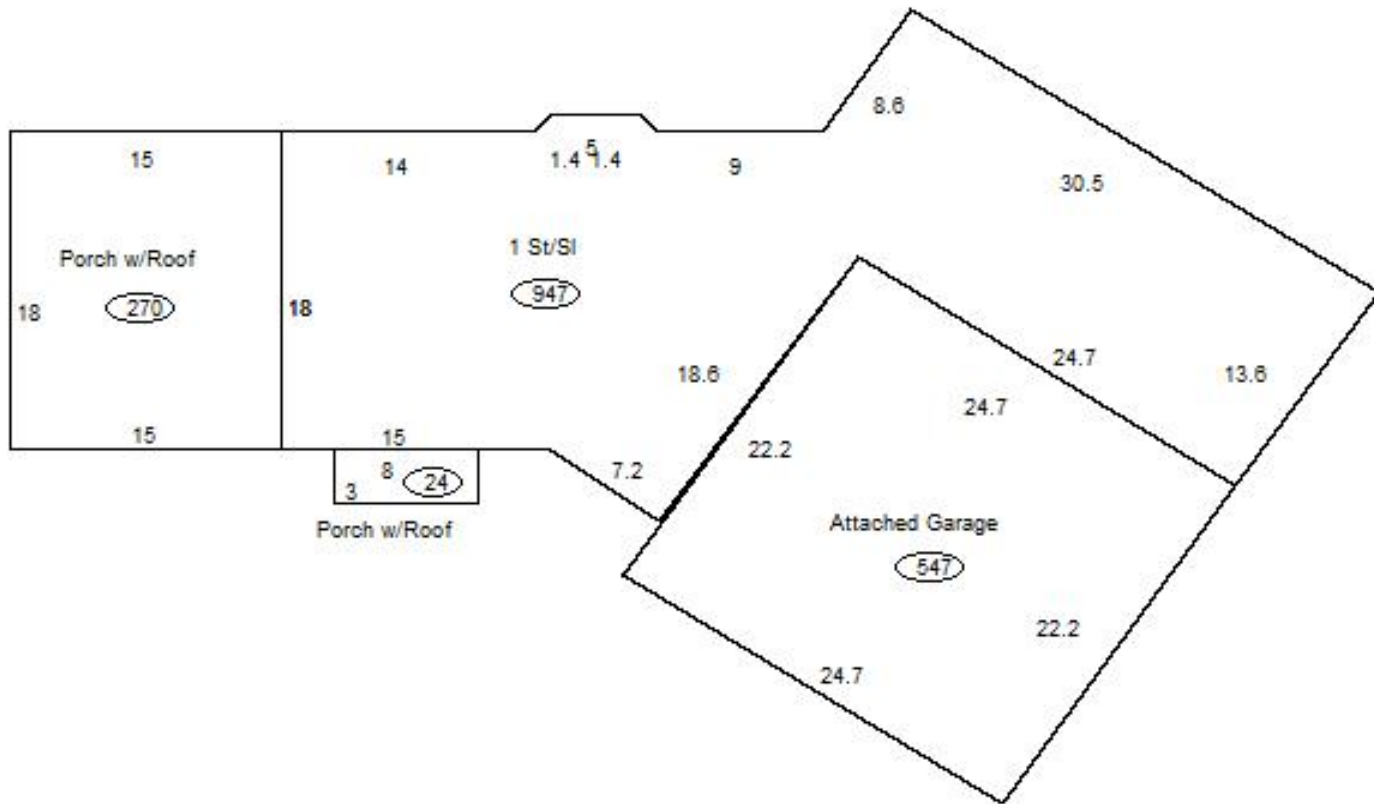

### Sketch Vector Information

Sequence	Code	Type	Built Over	Scale	Section Label	Base Area	Multiplier	Total Area
1	R	1	Slab	13	1 St/Sl	947	1.000	947
2	G	1		13	Attached Garage	547	1.000	547
3	M	PRCH		13	SLBC	24	1.000	24
4	M	PRCH		13	SLBC	270	1.000	270
<b>Total Building Area</b>						947		947