



Rogers

Assessment Property Record Card for Tax Year 2026

Data provided by LISA DELOZIER County Assessor

Date 04/18/2026
 Time 07:38:58
 Page 1

Assessment Data					Primary Image																																																																																																																				
Account 660074777 Parcel ID 000000-00-0-30014-002-0005 Cadastral ID 36-24-17-01280 Property Type REAL - Real Property Property Class UCP VI Area 2 Tax Area 29 - CHELSEA OT Name ID 347437 CARDS NEO LLC 3739 N STEELE BLVD STE 300 FAYETTEVILLE AR 72703-0000 Parcel Location Situs 06082 S INDUSTRIAL RD Subdivision CHELSEA IND/BUS PK Lot/Block 0005 / 0002 Parcel Size 5.02 - Acres Sec/Twn/Rng 36 / 24 / 17 / 5 Neighborhood 30014 - CHELSEA INDUSTRIAL BUS PARK School District S003 - CHELSEA SCHOOLS																																																																																																																									
Legal Description Lot/Long: 36.52042598 -95.44809962 LOT 5 BLOCK 2 CHELSEA IND/BUSINESS PK																																																																																																																									
Exemptions <table border="1"> <thead> <tr> <th>Code</th> <th>Type</th> <th>Active</th> <th>Maximum</th> <th>Exemption</th> </tr> </thead> <tbody> <tr> <td></td> <td></td> <td></td> <td></td> <td></td> </tr> </tbody> </table>					Code	Type	Active	Maximum	Exemption						Building Permits <table border="1"> <thead> <tr> <th>Number</th> <th>Description</th> <th>Opened</th> <th>Closed</th> <th>Amount</th> </tr> </thead> <tbody> <tr> <td></td> <td></td> <td></td> <td></td> <td></td> </tr> </tbody> </table>					Number	Description	Opened	Closed	Amount																																																																																																	
Code	Type	Active	Maximum	Exemption																																																																																																																					
Number	Description	Opened	Closed	Amount																																																																																																																					
Parcel Valuation <table border="1"> <thead> <tr> <th>Source</th> <th>REAL</th> <th>Fair Cash</th> <th>Capped</th> <th>Asmnt Level</th> <th>Assessed</th> <th>Levy Rate</th> <th>82.750</th> <th>Current Tax</th> </tr> </thead> <tbody> <tr> <td>Remove Cap</td> <td>2024</td> <td>Land Value 11,076</td> <td>11,076</td> <td>11%</td> <td>1,218</td> <td>Assessed</td> <td>9,382</td> <td>776.36</td> </tr> <tr> <td>Year Frozen</td> <td>0</td> <td>Improvements 204,478</td> <td>74,216</td> <td></td> <td>8,164</td> <td>Penalty</td> <td>0</td> <td></td> </tr> <tr> <td>Uncapped Value</td> <td>0</td> <td>Mobile Home 0</td> <td>0</td> <td></td> <td>0</td> <td>Exemption</td> <td>0</td> <td>0.00</td> </tr> <tr> <td>TIF Project ID</td> <td>0</td> <td>Total Value 215,554</td> <td>85,292</td> <td></td> <td>9,382</td> <td>Total Taxable</td> <td>9,382</td> <td>776.00</td> </tr> </tbody> </table>					Source	REAL	Fair Cash	Capped	Asmnt Level	Assessed	Levy Rate	82.750	Current Tax	Remove Cap	2024	Land Value 11,076	11,076	11%	1,218	Assessed	9,382	776.36	Year Frozen	0	Improvements 204,478	74,216		8,164	Penalty	0		Uncapped Value	0	Mobile Home 0	0		0	Exemption	0	0.00	TIF Project ID	0	Total Value 215,554	85,292		9,382	Total Taxable	9,382	776.00	Sale History <table border="1"> <thead> <tr> <th>Bk/Pg</th> <th>Grantor</th> <th>Date</th> <th>Price</th> <th>Code</th> </tr> </thead> <tbody> <tr> <td>/</td> <td>CARDS RE HOLDCO LLC</td> <td>10/20/2025</td> <td>0</td> <td>5</td> </tr> <tr> <td>/</td> <td>CARDS NEO LLC</td> <td>12/14/2023</td> <td>300,000</td> <td>WB</td> </tr> <tr> <td>/</td> <td>LEWIS, JOHN C & GLORIA B</td> <td>04/14/2023</td> <td>300,000</td> <td>WG</td> </tr> <tr> <td>1505/824</td> <td>BANK OF COMMERCE</td> <td>07/31/2003</td> <td>226,000</td> <td>YES</td> </tr> <tr> <td>1393/435</td> <td>OKLAHOMA TRASH CONTROL INC</td> <td>07/01/2002</td> <td>0</td> <td>3</td> </tr> <tr> <td>1213/861</td> <td>CHELSEA ECONOMIC-DEVELOPMEN</td> <td>02/04/2000</td> <td>20,000</td> <td>No</td> </tr> </tbody> </table>					Bk/Pg	Grantor	Date	Price	Code	/	CARDS RE HOLDCO LLC	10/20/2025	0	5	/	CARDS NEO LLC	12/14/2023	300,000	WB	/	LEWIS, JOHN C & GLORIA B	04/14/2023	300,000	WG	1505/824	BANK OF COMMERCE	07/31/2003	226,000	YES	1393/435	OKLAHOMA TRASH CONTROL INC	07/01/2002	0	3	1213/861	CHELSEA ECONOMIC-DEVELOPMEN	02/04/2000	20,000	No																																
Source	REAL	Fair Cash	Capped	Asmnt Level	Assessed	Levy Rate	82.750	Current Tax																																																																																																																	
Remove Cap	2024	Land Value 11,076	11,076	11%	1,218	Assessed	9,382	776.36																																																																																																																	
Year Frozen	0	Improvements 204,478	74,216		8,164	Penalty	0																																																																																																																		
Uncapped Value	0	Mobile Home 0	0		0	Exemption	0	0.00																																																																																																																	
TIF Project ID	0	Total Value 215,554	85,292		9,382	Total Taxable	9,382	776.00																																																																																																																	
Bk/Pg	Grantor	Date	Price	Code																																																																																																																					
/	CARDS RE HOLDCO LLC	10/20/2025	0	5																																																																																																																					
/	CARDS NEO LLC	12/14/2023	300,000	WB																																																																																																																					
/	LEWIS, JOHN C & GLORIA B	04/14/2023	300,000	WG																																																																																																																					
1505/824	BANK OF COMMERCE	07/31/2003	226,000	YES																																																																																																																					
1393/435	OKLAHOMA TRASH CONTROL INC	07/01/2002	0	3																																																																																																																					
1213/861	CHELSEA ECONOMIC-DEVELOPMEN	02/04/2000	20,000	No																																																																																																																					
Assessment History <table border="1"> <thead> <tr> <th>Tax Year</th> <th>Statement Number</th> <th>Billed Owner</th> <th>Tax Area</th> <th>Total Value</th> <th>Exemptions</th> <th>Taxable Value</th> <th>Billed Tax</th> </tr> </thead> <tbody> <tr><td>2025</td><td>2025-660074777</td><td>CARDS RE HOLDCO LLC</td><td>29</td><td>221,944</td><td>0</td><td>8,935</td><td>739.00</td></tr> <tr><td>2024</td><td>2024-660074777</td><td>CARDS RE HOLDCO LLC</td><td>29</td><td>77,363</td><td>0</td><td>8,510</td><td>718.00</td></tr> <tr><td>2023</td><td>2023-660074777</td><td>CARDS NEO LLC</td><td>29</td><td>199,932</td><td>0</td><td>21,992</td><td>1,875.00</td></tr> <tr><td>2022</td><td>2022-660074777</td><td>LEWIS, JOHN C & GLORIA B</td><td>29</td><td>199,932</td><td>0</td><td>21,110</td><td>1,786.00</td></tr> <tr><td>2021</td><td>2021-660074777</td><td>LEWIS, JOHN C & GLORIA B</td><td>29</td><td>182,776</td><td>0</td><td>20,105</td><td>1,704.00</td></tr> <tr><td>2020</td><td>2020-660074777</td><td>LEWIS, JOHN C & GLORIA B</td><td>29</td><td>301,792</td><td>0</td><td>28,078</td><td>2,381.00</td></tr> <tr><td>2019</td><td>2019-660074777</td><td>LEWIS, JOHN C & GLORIA B</td><td>29</td><td>301,659</td><td>0</td><td>26,741</td><td>2,297.00</td></tr> <tr><td>2018</td><td>2018-660074777</td><td>LEWIS, JOHN C & GLORIA B</td><td>29</td><td>299,591</td><td>0</td><td>25,467</td><td>2,175.00</td></tr> <tr><td>2017</td><td>2017-660074777</td><td>LEWIS, JOHN C & GLORIA B</td><td>29</td><td>299,591</td><td>0</td><td>24,255</td><td>2,080.00</td></tr> <tr><td>2016</td><td>2016-660074777</td><td>LEWIS, JOHN C & GLORIA B</td><td>29</td><td>299,591</td><td>0</td><td>23,100</td><td>2,013.00</td></tr> <tr><td>2015</td><td>2015-660074777</td><td>LEWIS, JOHN C & GLORIA B</td><td>29</td><td>200,000</td><td>0</td><td>22,000</td><td>1,895.00</td></tr> <tr><td>2014</td><td>2014-660074777</td><td>LEWIS, JOHN C & GLORIA B</td><td>29</td><td>200,000</td><td>0</td><td>22,000</td><td>1,960.00</td></tr> <tr><td>2013</td><td>2013-660074777</td><td>LEWIS, JOHN C & GLORIA B</td><td>29</td><td>200,000</td><td>0</td><td>22,000</td><td>1,952.00</td></tr> </tbody> </table>										Tax Year	Statement Number	Billed Owner	Tax Area	Total Value	Exemptions	Taxable Value	Billed Tax	2025	2025-660074777	CARDS RE HOLDCO LLC	29	221,944	0	8,935	739.00	2024	2024-660074777	CARDS RE HOLDCO LLC	29	77,363	0	8,510	718.00	2023	2023-660074777	CARDS NEO LLC	29	199,932	0	21,992	1,875.00	2022	2022-660074777	LEWIS, JOHN C & GLORIA B	29	199,932	0	21,110	1,786.00	2021	2021-660074777	LEWIS, JOHN C & GLORIA B	29	182,776	0	20,105	1,704.00	2020	2020-660074777	LEWIS, JOHN C & GLORIA B	29	301,792	0	28,078	2,381.00	2019	2019-660074777	LEWIS, JOHN C & GLORIA B	29	301,659	0	26,741	2,297.00	2018	2018-660074777	LEWIS, JOHN C & GLORIA B	29	299,591	0	25,467	2,175.00	2017	2017-660074777	LEWIS, JOHN C & GLORIA B	29	299,591	0	24,255	2,080.00	2016	2016-660074777	LEWIS, JOHN C & GLORIA B	29	299,591	0	23,100	2,013.00	2015	2015-660074777	LEWIS, JOHN C & GLORIA B	29	200,000	0	22,000	1,895.00	2014	2014-660074777	LEWIS, JOHN C & GLORIA B	29	200,000	0	22,000	1,960.00	2013	2013-660074777	LEWIS, JOHN C & GLORIA B	29	200,000	0	22,000	1,952.00
Tax Year	Statement Number	Billed Owner	Tax Area	Total Value	Exemptions	Taxable Value	Billed Tax																																																																																																																		
2025	2025-660074777	CARDS RE HOLDCO LLC	29	221,944	0	8,935	739.00																																																																																																																		
2024	2024-660074777	CARDS RE HOLDCO LLC	29	77,363	0	8,510	718.00																																																																																																																		
2023	2023-660074777	CARDS NEO LLC	29	199,932	0	21,992	1,875.00																																																																																																																		
2022	2022-660074777	LEWIS, JOHN C & GLORIA B	29	199,932	0	21,110	1,786.00																																																																																																																		
2021	2021-660074777	LEWIS, JOHN C & GLORIA B	29	182,776	0	20,105	1,704.00																																																																																																																		
2020	2020-660074777	LEWIS, JOHN C & GLORIA B	29	301,792	0	28,078	2,381.00																																																																																																																		
2019	2019-660074777	LEWIS, JOHN C & GLORIA B	29	301,659	0	26,741	2,297.00																																																																																																																		
2018	2018-660074777	LEWIS, JOHN C & GLORIA B	29	299,591	0	25,467	2,175.00																																																																																																																		
2017	2017-660074777	LEWIS, JOHN C & GLORIA B	29	299,591	0	24,255	2,080.00																																																																																																																		
2016	2016-660074777	LEWIS, JOHN C & GLORIA B	29	299,591	0	23,100	2,013.00																																																																																																																		
2015	2015-660074777	LEWIS, JOHN C & GLORIA B	29	200,000	0	22,000	1,895.00																																																																																																																		
2014	2014-660074777	LEWIS, JOHN C & GLORIA B	29	200,000	0	22,000	1,960.00																																																																																																																		
2013	2013-660074777	LEWIS, JOHN C & GLORIA B	29	200,000	0	22,000	1,952.00																																																																																																																		



Rogers

Assessment Property Record Card for Tax Year 2026

Data provided by LISA DELOZIER County Assessor

Date 04/18/2026
 Time 07:38:58
 Page 2

Lot Data		Primary Image	
Lot Size	0 x 0		
Lot Count	0		
Units Buildable	22500		
Non-Ag Acres	5.085		
Topography			
Street Access			
Utilities			
Amenities	0		
	0		
Value Model	1904 CHELSEA INDUST. SF		
Value Method	Square-Foot		
Base Lot Value	221,515.00 x .05 = 11,076		
Factor Value	0		
Adjustments			
Lot Value	11,076		
Cost Approach		Image Information	
Manual Date	01/2025	Image ID	925639
Total Building Area	4,800	Image Date	3/23/2020
Total Base Value	326,208	Name	IMG_0055.JPG
Modifier Value		Description	REVAL 2021
Misc Improvements			
Replacement Cost New	326,208		
Phys/Func Depreciation Loss	()		
RCN Less Phys/Func	198,987		
Economic Depreciation			
RCNLD (All Sources)	198,987		
Depreciated Improvements			
Outbuilding Value	5,491		
Total Improvement Value	204,478		
Land Value	11,076		
Cost Approach Value	215,554 44.91/SqFt		
Income Approach		Value Reconciliation	
Potential Gross Income (PGI)		Selected Valuation Method	Cost Approach
Vacancy & Collection Loss		Total Improvement Value	5,491
Miscellaneous Income		Land Value	11,076
Effective Gross Income (EGI)		Total Appraised Value	215,554 44.91/SqFt
Total Expenses			
Net Operating Income (NOI)			
Income Capitalization Rate			
Indicated Value	0.00		



Rogers

Assessment Property Record Card for Tax Year 2026

Data provided by LISA DELOZIER County Assessor

Date 04/18/2026

Time 07:38:58

Page 3

Sketch Image

660074777

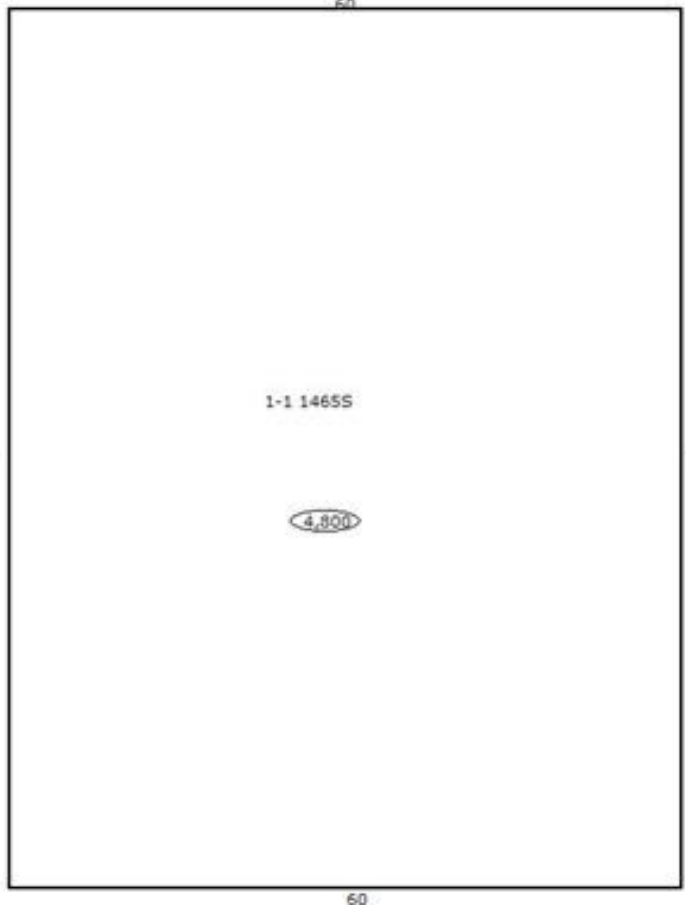

Sketch Vector Information

Sequence	Code	Type	Built Over	Scale	Section Label	Base Area	Multiplier	Total Area
1	C	406		13	1-1 1465S	4,800	1.000	4,800
Total Building Area						4,800		4,800



Rogers

Assessment Property Record Card for Tax Year 2026

Data provided by LISA DELOZIER County Assessor

Date 04/18/2026
Time 07:38:58
Page 4

Account 660074777
Parcel ID 000000-00-0-30014-002-0005
Cadastral ID 36-24-17-01280

Tax Area Code 29
Property Class UCP
Owners Name CARDS NEO LLC

Building Data

Building ID 472
Building Sequence 1
Occupancy 1 406 Storage Warehouse 100%
Occupancy 2
Occupancy 3
Total Floor Area 4,800
Average Perimeter 280
Number Of Storys 1.00
Average Wall Ht 12.00
Year Built 1995
Effective Age 20
Construction Class 7 - Pre-Engineered Steel Frame
Quality 2 - Fair
Condition 2 - Fair
Exterior Wall 88 - Stud Metal Siding
Heating/Cooling 8 - Warmed and Cooled Air
Roof Type Gable
Roof Cover

Basement Area
Basement Levels
Basement Finish
Finish Code - 1
Finish Area - 1
Finish Code - 2
Finish Area - 2

Building Image

Image Information

Image Name
Image Date
Image Name
Description

Cost Calculations

Appraisal Zone 2
Zone Description
Base Cost 42.59
Wall Cost 13.45
HVAC Cost 11.92
Basement Cost 0.00
Total Base Cost 67.96
Total Area 4,800
Base RCN 326,208
Misc Impr Value

Manual Date 01/2025
Base Year 2026
Modifier Value
Total Replacement Cost 326,208
Physical Depreciation 39%
Functional Depreciation
Total Depreciation 39% (127,221)
Total RCNLD 198,987
Lump Sums
Total Building Value 198,987 \$ 41.46 Per SqFt



Rogers

Assessment Property Record Card for Tax Year 2026

Data provided by LISA DELOZIER County Assessor

Date 04/18/2026

Time 07:38:58

Page 5

660074777

Outbuildings/Site Improvements

Building Image	Code	Description	Dimensions	Floor	Roofing	Total Units
	PACN	PAVING - CONCRETE	0x0x0			1,520
	Qual 3	Cond 3	Year	Eff Age	1013	
Valuation Summary		Modifier Total	RCN	Depr (% Phys/ % Func)		RCNLD
Base Cost (4.69 x 1,520)				7,129	1,782	5,347
FLV1	CANOPY		6x6x0			36
	Qual	Cond	Year	Eff Age		
Valuation Summary		Modifier Total	RCN	Depr (% Phys/ % Func)		RCNLD
Base Cost (5.00 x 36)				180	36	144
Total Site Improvement Value						5,491