



# Rogers

## Assessment Property Record Card for Tax Year 2026

Data provided by LISA DELOZIER County Assessor

Date 04/16/2026  
Time 21:21:31  
Page 1

Assessment Data					Primary Image																																																																																																																				
<b>Account</b> 660074898 <b>Parcel ID</b> 000000-00-0-21628-001-0030 <b>Cadastral ID</b> 22-21-14-03450 <b>Property Type</b> REAL - Real Property <b>Property Class</b> URP VI Area 4 <b>Tax Area</b> 40 - OWASSO CITY <b>Name ID</b> 290608 MIZE, DAMON A  14903 E 88TH ST N OWASSO OK 74055-0000  <b>Parcel Location</b> <b>Situs</b> 14903 E 88TH ST <b>Subdivision</b> PRESTON LAKES <b>Lot/Block</b> 0030 / 0001 <b>Parcel Size</b> 1 - Lots <b>Sec/Twn/Rng</b> 22 / 21 / 14 / 5 <b>Neighborhood</b> 1059 - R-V04-SW OWASSO <b>School District</b> S021 - OWASSO SCHOOLS					<p>\\tsclient\TCASEY\CASEY BOOTH RESIDENTIAL VI\2022-8-23\ 8/24/2022</p>																																																																																																																				
<b>Legal Description</b> Lot/Long: 36.28200050 -95.80573025																																																																																																																									
<b>Building Permits</b>					<table border="1"> <thead> <tr> <th>Number</th> <th>Description</th> <th>Opened</th> <th>Closed</th> <th>Amount</th> </tr> </thead> <tbody> <tr> <td colspan="5"> </td> </tr> </tbody> </table>					Number	Description	Opened	Closed	Amount																																																																																																											
Number	Description	Opened	Closed	Amount																																																																																																																					
<b>Exemptions</b>					<b>Sale History</b>																																																																																																																				
<table border="1"> <thead> <tr> <th>Code</th> <th>Type</th> <th>Active</th> <th>Maximum</th> <th>Exemption</th> </tr> </thead> <tbody> <tr> <td>HV</td> <td>Veteran</td> <td>Yes</td> <td>999,999</td> <td>26,729</td> </tr> </tbody> </table>					Code	Type	Active	Maximum	Exemption	HV	Veteran	Yes	999,999	26,729	<table border="1"> <thead> <tr> <th>Bk/Pg</th> <th>Grantor</th> <th>Date</th> <th>Price</th> <th>Code</th> </tr> </thead> <tbody> <tr> <td>1733/736</td> <td>HEWITT ASSOCIATES LLC</td> <td>11/09/2005</td> <td>167,500</td> <td>YES</td> </tr> <tr> <td>1733/735</td> <td>SMITH, KELLY R &amp; MICHELLE-R</td> <td>10/25/2005</td> <td>167,500</td> <td>YES</td> </tr> <tr> <td>1299/913</td> <td>SIMMONS HOMES RESIDENTIAL</td> <td>06/15/2001</td> <td>145,829</td> <td>YES</td> </tr> <tr> <td>1280/792</td> <td>PRESTON LAKES, LLC</td> <td>03/29/2001</td> <td>82,000</td> <td>No</td> </tr> </tbody> </table>					Bk/Pg	Grantor	Date	Price	Code	1733/736	HEWITT ASSOCIATES LLC	11/09/2005	167,500	YES	1733/735	SMITH, KELLY R & MICHELLE-R	10/25/2005	167,500	YES	1299/913	SIMMONS HOMES RESIDENTIAL	06/15/2001	145,829	YES	1280/792	PRESTON LAKES, LLC	03/29/2001	82,000	No																																																																													
Code	Type	Active	Maximum	Exemption																																																																																																																					
HV	Veteran	Yes	999,999	26,729																																																																																																																					
Bk/Pg	Grantor	Date	Price	Code																																																																																																																					
1733/736	HEWITT ASSOCIATES LLC	11/09/2005	167,500	YES																																																																																																																					
1733/735	SMITH, KELLY R & MICHELLE-R	10/25/2005	167,500	YES																																																																																																																					
1299/913	SIMMONS HOMES RESIDENTIAL	06/15/2001	145,829	YES																																																																																																																					
1280/792	PRESTON LAKES, LLC	03/29/2001	82,000	No																																																																																																																					
<b>Parcel Valuation</b>																																																																																																																									
<table border="1"> <thead> <tr> <th>Source</th> <th>REAL</th> <th>Fair Cash</th> <th>Capped</th> <th>Asmnt Level</th> <th>Assessed</th> <th>Levy Rate</th> <th>97.960</th> <th>Current Tax</th> </tr> </thead> <tbody> <tr> <td>Remove Cap</td> <td>2006</td> <td>Land Value 74,545</td> <td>44,621</td> <td>11%</td> <td>4,908</td> <td>Assessed</td> <td>26,729</td> <td>2,618.37</td> </tr> <tr> <td>Year Frozen</td> <td>0</td> <td>Improvements 224,730</td> <td>198,372</td> <td></td> <td>21,821</td> <td>Penalty</td> <td>0</td> <td></td> </tr> <tr> <td>Uncapped Value</td> <td>0</td> <td>Mobile Home 0</td> <td>0</td> <td></td> <td>0</td> <td>Exemption</td> <td>26,729</td> <td>-2,618.00</td> </tr> <tr> <td>TIF Project ID</td> <td>0</td> <td>Total Value 299,275</td> <td>242,993</td> <td></td> <td>26,729</td> <td>Total Taxable</td> <td>0</td> <td>0.00</td> </tr> </tbody> </table>		Source	REAL	Fair Cash	Capped	Asmnt Level	Assessed	Levy Rate	97.960	Current Tax	Remove Cap	2006	Land Value 74,545	44,621	11%	4,908	Assessed	26,729	2,618.37	Year Frozen	0	Improvements 224,730	198,372		21,821	Penalty	0		Uncapped Value	0	Mobile Home 0	0		0	Exemption	26,729	-2,618.00	TIF Project ID	0	Total Value 299,275	242,993		26,729	Total Taxable	0	0.00																																																																											
Source	REAL	Fair Cash	Capped	Asmnt Level	Assessed	Levy Rate	97.960	Current Tax																																																																																																																	
Remove Cap	2006	Land Value 74,545	44,621	11%	4,908	Assessed	26,729	2,618.37																																																																																																																	
Year Frozen	0	Improvements 224,730	198,372		21,821	Penalty	0																																																																																																																		
Uncapped Value	0	Mobile Home 0	0		0	Exemption	26,729	-2,618.00																																																																																																																	
TIF Project ID	0	Total Value 299,275	242,993		26,729	Total Taxable	0	0.00																																																																																																																	
<b>Assessment History</b>																																																																																																																									
<table border="1"> <thead> <tr> <th>Tax Year</th> <th>Statement Number</th> <th>Billed Owner</th> <th>Tax Area</th> <th>Total Value</th> <th>Exemptions</th> <th>Taxable Value</th> <th>Billed Tax</th> </tr> </thead> <tbody> <tr><td>2025</td><td>2025-660074898</td><td>MIZE, DAMON A</td><td>40</td><td>296,088</td><td>25950</td><td></td><td>.00</td></tr> <tr><td>2024</td><td>2024-660074898</td><td>MIZE, DAMON A</td><td>40</td><td>315,216</td><td>25194</td><td></td><td>.00</td></tr> <tr><td>2023</td><td>2023-660074898</td><td>MIZE, DAMON A</td><td>40</td><td>256,129</td><td>24461</td><td></td><td>.00</td></tr> <tr><td>2022</td><td>2022-660074898</td><td>MIZE, DAMON A</td><td>40</td><td>238,033</td><td>23749</td><td></td><td>.00</td></tr> <tr><td>2021</td><td>2021-660074898</td><td>MIZE, DAMON A</td><td>40</td><td>214,053</td><td>23057</td><td></td><td>.00</td></tr> <tr><td>2020</td><td>2020-660074898</td><td>MIZE, MELISSA K &amp;</td><td>40</td><td>205,744</td><td>22386</td><td></td><td>.00</td></tr> <tr><td>2019</td><td>2019-660074898</td><td>MIZE, MELISSA K &amp;</td><td>40</td><td>197,578</td><td>21734</td><td></td><td>.00</td></tr> <tr><td>2018</td><td>2018-660074898</td><td>MIZE, MELISSA K &amp;</td><td>40</td><td>195,957</td><td>1000</td><td>20,555</td><td>1,917.00</td></tr> <tr><td>2017</td><td>2017-660074898</td><td>MIZE, MELISSA K &amp;</td><td>40</td><td>194,321</td><td>1000</td><td>20,375</td><td>1,917.00</td></tr> <tr><td>2016</td><td>2016-660074898</td><td>MIZE, MELISSA K &amp;</td><td>40</td><td>189,268</td><td>1000</td><td>19,760</td><td>1,868.00</td></tr> <tr><td>2015</td><td>2015-660074898</td><td>MIZE, MELISSA K &amp;</td><td>40</td><td>183,227</td><td>1000</td><td>19,155</td><td>1,826.00</td></tr> <tr><td>2014</td><td>2014-660074898</td><td>MIZE, MELISSA K &amp;</td><td>40</td><td>184,717</td><td>1000</td><td>19,226</td><td>1,852.00</td></tr> <tr><td>2013</td><td>2013-660074898</td><td>MIZE, MELISSA K &amp;</td><td>40</td><td>178,519</td><td>1000</td><td>18,637</td><td>1,756.00</td></tr> </tbody> </table>										Tax Year	Statement Number	Billed Owner	Tax Area	Total Value	Exemptions	Taxable Value	Billed Tax	2025	2025-660074898	MIZE, DAMON A	40	296,088	25950		.00	2024	2024-660074898	MIZE, DAMON A	40	315,216	25194		.00	2023	2023-660074898	MIZE, DAMON A	40	256,129	24461		.00	2022	2022-660074898	MIZE, DAMON A	40	238,033	23749		.00	2021	2021-660074898	MIZE, DAMON A	40	214,053	23057		.00	2020	2020-660074898	MIZE, MELISSA K &	40	205,744	22386		.00	2019	2019-660074898	MIZE, MELISSA K &	40	197,578	21734		.00	2018	2018-660074898	MIZE, MELISSA K &	40	195,957	1000	20,555	1,917.00	2017	2017-660074898	MIZE, MELISSA K &	40	194,321	1000	20,375	1,917.00	2016	2016-660074898	MIZE, MELISSA K &	40	189,268	1000	19,760	1,868.00	2015	2015-660074898	MIZE, MELISSA K &	40	183,227	1000	19,155	1,826.00	2014	2014-660074898	MIZE, MELISSA K &	40	184,717	1000	19,226	1,852.00	2013	2013-660074898	MIZE, MELISSA K &	40	178,519	1000	18,637	1,756.00
Tax Year	Statement Number	Billed Owner	Tax Area	Total Value	Exemptions	Taxable Value	Billed Tax																																																																																																																		
2025	2025-660074898	MIZE, DAMON A	40	296,088	25950		.00																																																																																																																		
2024	2024-660074898	MIZE, DAMON A	40	315,216	25194		.00																																																																																																																		
2023	2023-660074898	MIZE, DAMON A	40	256,129	24461		.00																																																																																																																		
2022	2022-660074898	MIZE, DAMON A	40	238,033	23749		.00																																																																																																																		
2021	2021-660074898	MIZE, DAMON A	40	214,053	23057		.00																																																																																																																		
2020	2020-660074898	MIZE, MELISSA K &	40	205,744	22386		.00																																																																																																																		
2019	2019-660074898	MIZE, MELISSA K &	40	197,578	21734		.00																																																																																																																		
2018	2018-660074898	MIZE, MELISSA K &	40	195,957	1000	20,555	1,917.00																																																																																																																		
2017	2017-660074898	MIZE, MELISSA K &	40	194,321	1000	20,375	1,917.00																																																																																																																		
2016	2016-660074898	MIZE, MELISSA K &	40	189,268	1000	19,760	1,868.00																																																																																																																		
2015	2015-660074898	MIZE, MELISSA K &	40	183,227	1000	19,155	1,826.00																																																																																																																		
2014	2014-660074898	MIZE, MELISSA K &	40	184,717	1000	19,226	1,852.00																																																																																																																		
2013	2013-660074898	MIZE, MELISSA K &	40	178,519	1000	18,637	1,756.00																																																																																																																		



# Rogers

## Assessment Property Record Card for Tax Year 2026

Data provided by LISA DELOZIER County Assessor

Date 04/16/2026  
Time 21:21:31  
Page 2

Lot Data	Square-Foot - NBHD 1059 #1	Primary Image
Lot Size		
Lot Count	1	
Units Buildable	1	
Non-Ag Acres	0.3229	
Topography		
Street Access		
Utilities		
Amenities	0	
	0	
Method	Square-Foot	
Base Lot Value	14,065.00 x 5.30 = 74,545	
Factor Value		
Adjustments	1.0000	
Lot Value	74,545	

Residential Data	
Type	1 Single Family Residence
Condition	3 - Average
Quality	3 - Average
Architecture	
Style	100% One Story
Exterior Wall	100% Veneer, Masonry
Base/Total Area	2,102 / 2,102
Style	100% One Story
HVAC	100% Warmed & Cooled Air
Roof Cover	1 Composition Shingle
Area on Slab	2,102
Fixture/RghIn	11 /
Bed/F/H Bath	4 / 2.0 /
Basement Area	
Garage Type	400 Attached Garage - Unfinished 2 Stalls
Remodel	
Year/Eff Age	2001 / 19

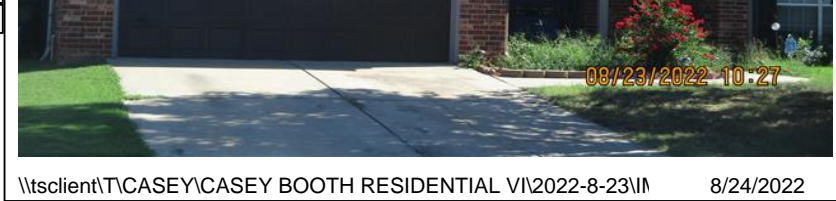

\\tsclient\TCASEY\CASEY BOOTH RESIDENTIAL VI\2022-8-23\ 8/24/2022

GRM Approach	
GRM Code	
Gross Rent	0.00
Indicated Value	

Multiple Regression			
MRA Code	1	Test	
Adjusted R	0.8445		
Indicated Value	240,171	114.26	Per SqFt

Direct Comparables			
Selection Model	A	Adam Test	
Adjustment Model	1	2022 Residential	
Comparables	8		
Indicated Value	270,970		Per SqFt

Cost Approach				Manual : 01/2025	
Base Cost	106.27	Total Misc Impr	+	3,920	
Roofing Adj	+ 4.64	Garage Cost	+	13,584	
Subfloor Adj	+ -2.19	Total RCN	=	288,115	
Heat/Cool Adj	+ 12.64	Depreciation ( 22%)	-	63,385	
Plumbing Adj	+ 7.38	Lump Sums	+	0	
Basement Adj	+ 0.00	RCNLD	=	224,730	
Adj Base Cost	= 128.74	Lot Value	+	74,545	
Total Area	x 2,102	Indicated Value	=	299,275	
Adjusted Cost	= 270,611	Value Per SqFt		142.38	

Value Reconciliation			
Selected Approach	Cost Approach		
Improvements	224,730		
Lot Value	74,545		
Indicated Value	299,275	142.38	Per SqFt
Agland Value			
Site Improvements			
Total Value	299,275	142.38	Total Value Per SqFt

Miscellaneous Improvements								
Code	Description	Sketch ID	Size	Year	Units	Unit Cost	Depr	Value
PRCH	SLAB PORCH - COVERED	89625	94		94	26.64		2,504
PATO	SLAB PORCH - OPEN	89626	126		126	11.24		1,416

