



# Rogers

## Assessment Property Record Card for Tax Year 2026

Data provided by LISA DELOZIER County Assessor

Date 04/16/2026  
 Time 23:35:33  
 Page 1

Assessment Data				Primary Image															
Account	660075045																		
Parcel ID	000000-00-0-21628-004-0008																		
Cadastral ID	22-21-14-04910																		
Property Type	REAL - Real Property																		
Property Class	CNTU	VI Area	4																
Tax Area	40 - OWASSO CITY																		
Name ID	11734																		
HOUSING AUTHORITY OF																			
CHEROKEE NATION																			
PO BOX 1007																			
TAHLEQUAH OK 74465-1007																			
Parcel Location				<p>\\tsclient\TCASEY\CASEY BOOTH RESIDENTIAL VI\2022-8-23\ 8/24/2022</p>															
Situs	14904 E 90TH ST N																		
Subdivision	PRESTON LAKES																		
Lot/Block	0008 / 0004	Parcel Size	1 - Lots																
Sec/Twn/Rng	22 / 21 / 14 / 5																		
Neighborhood	5559 - TRIBAL OWNED PROPERTY																		
School District	S021 - OWASSO SCHOOLS																		
Legal Description				Building Permits															
Lot/Long: 36.28451307 -95.80785716				<table border="1"> <thead> <tr> <th>Number</th> <th>Description</th> <th>Opened</th> <th>Closed</th> <th>Amount</th> </tr> </thead> <tbody> <tr> <td colspan="5"> </td> </tr> </tbody> </table>						Number	Description	Opened	Closed	Amount					
Number	Description	Opened	Closed	Amount															
LOT 8 BLOCK 4 PRESTON LAKES				Sale History															
Code	Type	Active	Maximum	Exemption	Bk/Pg	Grantor	Date	Price	Code										
					1278/808	CHUMLEY & ASSOCIATES INC	03/29/2001	78,500	No										
					1243/425	COMMUNITY DEVELOPERS LLC	08/22/2000	0	No										
					1209/139	PRESTON LAKES, LLC	12/30/1999	1,590,000	No										
Parcel Valuation																			
Source	REAL	Fair Cash	Capped	Asmnt Level	Assessed	Levy Rate	97.960	Current Tax											
Remove Cap	2002	Land Value	39,315	0	11%	Assessed	0	0.00											
Year Frozen	0	Improvements	111,577	0		Penalty	0												
Uncapped Value	0	Mobile Home	0	0		Exemption	0	0.00											
TIF Project ID	0	Total Value	150,892	0		Total Taxable	0	0.00											
Assessment History																			
Tax Year	Statement Number	Billed Owner	Tax Area	Total Value	Exemptions	Taxable Value	Billed Tax												
2025	2025-660075045	HOUSING AUTHORITY OF	40	149,624	0		.00												
2024	2024-660075045	HOUSING AUTHORITY OF	40	159,200	0		.00												
2023	2023-660075045	HOUSING AUTHORITY OF	40	157,962	0		.00												
2022	2022-660075045	HOUSING AUTHORITY OF	40	125,032	0		.00												
2021	2021-660075045	HOUSING AUTHORITY OF	40	125,032	0		.00												
2020	2020-660075045	HOUSING AUTHORITY OF	40	118,372	0		.00												
2019	2019-660075045	HOUSING AUTHORITY OF	40	114,309	0		.00												
2018	2018-660075045	HOUSING AUTHORITY OF	40	110,847	0		.00												
2017	2017-660075045	HOUSING AUTHORITY OF	40	110,031	0		.00												
2016	2016-660075045	HOUSING AUTHORITY OF	40	105,968	0		.00												
2015	2015-660075045	HOUSING AUTHORITY OF	40	105,968	0		.00												
2014	2014-660075045	HOUSING AUTHORITY OF	40	105,968	0		.00												
2013	2013-660075045	HOUSING AUTHORITY OF	40	105,348	0		.00												



# Rogers

## Assessment Property Record Card for Tax Year 2026

Data provided by LISA DELOZIER County Assessor

Date 04/16/2026  
 Time 23:35:33  
 Page 2

Lot Data		Square-Foot - NBHD 1059 #1	
Lot Size			
Lot Count	1		
Units Buildable	1		
Non-Ag Acres	0.1703		
Topography			
Street Access			
Utilities			
Amenities		0	
		0	
Method	Square-Foot		
Base Lot Value	7,418.00 x 5.30 = 39,315		
Factor Value			
Adjustments	1.0000		
Lot Value	39,315		



\\tsclient\TCASEY\CASEY BOOTH RESIDENTIAL VI\2022-8-23\ 8/24/2022

Residential Data	
Type	1 Single Family Residence
Condition	3 - Average
Quality	2 - Fair
Architecture	
Style	100% One Story
Exterior Wall	80% Frame, Siding, Vinyl 20% Veneer, Masonry
Base/Total Area	1,159 / 1,159
Style	100% One Story
HVAC	100% Warmed & Cooled Air
Roof Cover	1 Composition Shingle
Area on Slab	1,159
Fixture/RghIn	11 /
Bed/F/H Bath	3 / 2.0 /
Basement Area	
Garage Type	209 Attached Garage - Unfinished
Remodel	
Year/Eff Age	2001 / 19

### GRM Approach

GRM Code	
Gross Rent	0.00
Indicated Value	

### Multiple Regression

MRA Code	1 Test
Adjusted R	0.8445
Indicated Value	125,242 108.06 Per SqFt

### Direct Comparables

Selection Model	DEFAULT	DEFAULT SELECTION MODEL
Adjustment Model	DEFAULT	DEFAULT ADJUSTMENTS TABLE
Comparables	8	
Indicated Value	163,190	Per SqFt

### Value Reconciliation

Selected Approach	Cost Approach		
Improvements	111,577		
Lot Value	39,315		
Indicated Value	150,892	130.19	Per SqFt
Agland Value			
Site Improvements			
Total Value	150,892	130.19	Total Value Per SqFt

Cost Approach		Manual : 01/2025	
Base Cost	97.73	Total Misc Impr	+ 1,683
Roofing Adj	+ 4.32	Garage Cost	+ 6,239
Subfloor Adj	+ 0.00	Total RCN	= 150,780
Heat/Cool Adj	+ 10.30	Depreciation ( 26%)	- 39,203
Plumbing Adj	+ 10.91	Lump Sums	+ 0
Basement Adj	+ 0.00	RCNLD	= 111,577
Adj Base Cost	= 123.26	Lot Value	+ 39,315
Total Area	x 1,159	Indicated Value	= 150,892
Adjusted Cost	= 142,858	Value Per SqFt	130.19

### Miscellaneous Improvements

Code	Description	Sketch ID	Size	Year	Units	Unit Cost	Depr	Value
PRCH	SLAB PORCH - COVERED	90114	20x4		80	21.04		1,683



# Rogers

## Assessment Property Record Card for Tax Year 2026

Data provided by LISA DELOZIER County Assessor

Date 04/16/2026  
 Time 23:35:33  
 Page 3

Sketch Image

660075045

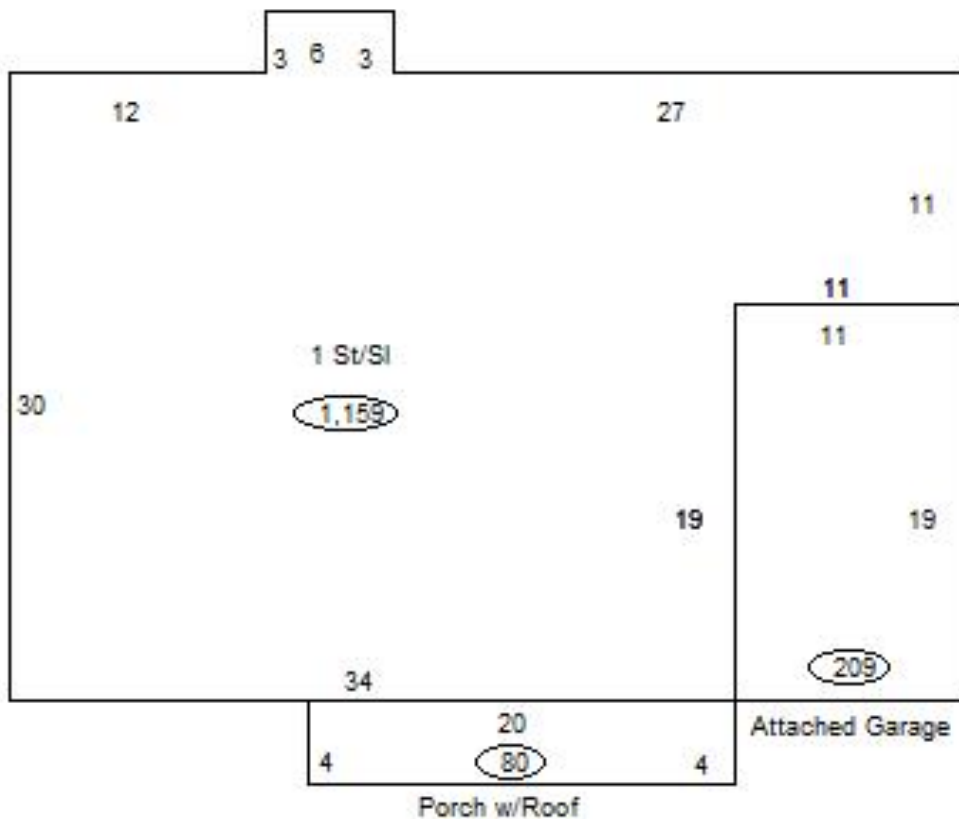

### Sketch Vector Information

Sequence	Code	Type	Built Over	Scale	Section Label	Base Area	Multiplier	Total Area
1	R	1	Slab	13	1 St/Sl	1,159	1.000	1,159
2	G	1		13	Attached Garage	209	1.000	209
3	M	PRCH		13	SLBC	80	1.000	80
<b>Total Building Area</b>						1,159		1,159