



Rogers

Assessment Property Record Card for Tax Year 2026

Data provided by LISA DELOZIER County Assessor

Date 04/16/2026
Time 22:22:18
Page 1

| Assessment Data | | | | | Primary Image | | | | |
|--|----------------------------|--------------------|-----------|-------------|---------------|-------------------------------|---------------|---------|-------------|
| Account | 660075093 | | | | | | | | |
| Parcel ID | 000000-00-0-21628-007-0002 | | | | | | | | |
| Cadastral ID | 22-21-14-05380 | | | | | | | | |
| Property Type | REAL - Real Property | | | | | | | | |
| Property Class | URP | VI Area | 4 | | | | | | |
| Tax Area | 40 - OWASSO CITY | | | | | | | | |
| Name ID | 298686 | | | | | | | | |
| HEASLET, LADONNA | | | | | | | | | |
| 15201 E 89TH CT N OWASSO OK 74055-0000 | | | | | | | | | |
| Parcel Location | | | | | | | | | |
| Situs | 15201 E 89TH CT N | | | | | | | | |
| Subdivision | PRESTON LAKES | | | | | | | | |
| Lot/Block | 0002 / 0007 | Parcel Size | 1 - Lots | | | | | | |
| Sec/Twn/Rng | 22 / 21 / 14 / 5 | | | | | | | | |
| Neighborhood | 1059 - R-V04-SW OWASSO | | | | | | | | |
| School District | S021 - OWASSO SCHOOLS | | | | | | | | |
| Legal Description Lat/Long: 36.28228507 -95.80458704 | | | | | | | | | |
| Building Permits | | | | | | | | | |
| LOT 2 BLOCK 7 PRESTON LAKES | | | | | | | | | |
| Exemptions | | | | | | | | | |
| Code | Type | Active | Maximum | Exemption | Bk/Pg | Grantor | Date | Price | Code |
| H | Homestead | Yes | 1,000 | 1,000 | / | JARRED, JUSTIN T | 01/15/2019 | 170,000 | YES |
| | | | | | 2619/535 | JARRED, JUSTIN T & MADELINE A | 03/17/2017 | | 4 |
| | | | | | 2594/446 | SMITH, RICHARD A & | 11/18/2016 | 165,000 | YES |
| | | | | | 2047/353 | MOSEBY, JOEY & KRISTEN | 07/31/2009 | 148,000 | YES |
| | | | | | 1293/751 | SIMMONS HOMES RESIDENTIAL | 05/24/2001 | 123,000 | YES |
| | | | | | 1277/159 | PRESTON LAKES, LLC | 03/05/2001 | 41,000 | No |
| Parcel Valuation | | | | | Sale History | | | | |
| Source | REAL | | Fair Cash | Capped | Asmnt Level | Assessed | Levy Rate | 97.960 | Current Tax |
| Remove Cap | 2020 | Land Value | 55,178 | 43,124 | 11% | 4,744 | Assessed | 22,800 | 2,233.49 |
| Year Frozen | 0 | Improvements | 196,498 | 164,144 | | 18,056 | Penalty | 0 | |
| Uncapped Value | 0 | Mobile Home | 0 | 0 | | 0 | Exemption | 1,000 | -97.00 |
| TIF Project ID | 0 | Total Value | 251,676 | 207,268 | | 22,800 | Total Taxable | 21,800 | 2,136.00 |
| Assessment History | | | | | | | | | |
| Tax Year | Statement Number | Billed Owner | Tax Area | Total Value | Exemptions | Taxable Value | Billed Tax | | |
| 2025 | 2025-660075093 | HEASLET, LADONNA | 40 | 248,562 | 1000 | 21,135 | 2,070.00 | | |
| 2024 | 2024-660075093 | HEASLET, LADONNA | 40 | 261,259 | 1000 | 20,490 | 1,968.00 | | |
| 2023 | 2023-660075093 | HEASLET, LADONNA | 40 | 222,640 | 1000 | 19,865 | 1,862.00 | | |
| 2022 | 2022-660075093 | HEASLET, LADONNA | 40 | 203,858 | 1000 | 19,257 | 1,887.00 | | |
| 2021 | 2021-660075093 | HEASLET, LADONNA | 40 | 181,281 | 1000 | 18,667 | 1,806.00 | | |
| 2020 | 2020-660075093 | HEASLET, LADONNA | 40 | 173,587 | 1000 | 18,095 | 1,750.00 | | |
| 2019 | 2019-660075093 | HEASLET, LADONNA | 40 | 172,314 | 0 | 18,955 | 1,835.00 | | |
| 2018 | 2018-660075093 | JARRED, JUSTIN T | 40 | 170,070 | 0 | 18,708 | 1,745.00 | | |
| 2017 | 2017-660075093 | JARRED, JUSTIN T | 40 | 168,673 | 0 | 18,554 | 1,746.00 | | |
| 2016 | 2016-660075093 | SMITH, RICHARD A & | 40 | 172,213 | 0 | 18,943 | 1,790.00 | | |
| 2015 | 2015-660075093 | SMITH, RICHARD A & | 40 | 166,837 | 0 | 18,352 | 1,750.00 | | |
| 2014 | 2014-660075093 | SMITH, RICHARD A & | 40 | 168,179 | 0 | 18,500 | 1,782.00 | | |
| 2013 | 2013-660075093 | SMITH, RICHARD A & | 40 | 163,495 | 0 | 17,984 | 1,695.00 | | |



Rogers

Assessment Property Record Card for Tax Year 2026

Data provided by LISA DELOZIER County Assessor

Date 04/16/2026
Time 22:22:18
Page 2

| Lot Data | Square-Foot - NBHD 1059 #1 | Primary Image |
|-----------------|----------------------------|---------------|
| Lot Size | | |
| Lot Count | 1 | |
| Units Buildable | 1 | |
| Non-Ag Acres | 0.239 | |
| Topography | | |
| Street Access | | |
| Utilities | | |
| Amenities | 0 | |
| | 0 | |
| Method | Square-Foot | |
| Base Lot Value | 10,411.00 x 5.30 = 55,178 | |
| Factor Value | | |
| Adjustments | 1.0000 | |
| Lot Value | 55,178 | |

| Residential Data | |
|------------------|---|
| Type | 1 Single Family Residence |
| Condition | 3 - Average |
| Quality | 3 - Average |
| Architecture | |
| Style | 100% One Story |
| Exterior Wall | 100% Veneer, Masonry |
| Base/Total Area | 1,656 / 1,656 |
| Style | 100% One Story |
| HVAC | 100% Warmed & Cooled Air |
| Roof Cover | 1 Composition Shingle |
| Area on Slab | 1,656 |
| Fixture/RghIn | 6 / |
| Bed/F/H Bath | 3 / 2.0 / |
| Basement Area | |
| Garage Type | 441 Attached Garage - Unfinished 2 Stalls |
| Remodel | |
| Year/Eff Age | 2001 / 19 |



\\tsclient\TCASEY\CASEY BOOTH RESIDENTIAL VI\2022-8-24\ 8/29/2022

| GRM Approach | |
|-----------------|------|
| GRM Code | |
| Gross Rent | 0.00 |
| Indicated Value | |

| Multiple Regression | | | |
|---------------------|---------|--------|----------|
| MRA Code | 1 | Test | |
| Adusted R | 0.8445 | | |
| Indicated Value | 211,003 | 127.42 | Per SqFt |

| Direct Comparables | |
|--------------------|--------------------|
| Selection Model | A Adam Test |
| Adjustment Model | 1 2022 Residential |
| Comparables | 8 |
| Indicated Value | 227,560 Per SqFt |

| Value Reconciliation | | | |
|----------------------|---------------|--------|----------------------|
| Selected Approach | Cost Approach | | |
| Improvements | 196,498 | | |
| Lot Value | 55,178 | | |
| Indicated Value | 251,676 | 151.98 | Per SqFt |
| Agland Value | | | |
| Site Improvements | | | |
| Total Value | 251,676 | 151.98 | Total Value Per SqFt |

| Cost Approach | | | | Manual : 01/2025 | | | |
|---------------|-----------|---------------------|---|------------------|--|--|--|
| Base Cost | 111.77 | Total Misc Impr | + | 18,294 | | | |
| Roofing Adj | + 4.88 | Garage Cost | + | 14,522 | | | |
| Subfloor Adj | + -2.31 | Total RCN | = | 251,921 | | | |
| Heat/Cool Adj | + 12.64 | Depreciation (22%) | - | 55,423 | | | |
| Plumbing Adj | + 5.33 | Lump Sums | + | 0 | | | |
| Basement Adj | + 0.00 | RCNLD | = | 196,498 | | | |
| Adj Base Cost | = 132.31 | Lot Value | + | 55,178 | | | |
| Total Area | x 1,656 | Indicated Value | = | 251,676 | | | |
| Adjusted Cost | = 219,105 | Value Per SqFt | | 151.98 | | | |

| Miscellaneous Improvements | | | | | | | | |
|----------------------------|---------------------------------|-----------|-------|------|-------|-----------|------|-------|
| Code | Description | Sketch ID | Size | Year | Units | Unit Cost | Depr | Value |
| FPR1 | FIREPLACE - RESIDENTIAL 1 STORY | 0 | | 1 | 1 | 5,615.40 | | 5,615 |
| PRCH | SLAB PORCH - COVERED | 90290 | | 164 | 164 | 26.42 | | 4,333 |
| PRCH | SLAB PORCH - COVERED | 90291 | 23x14 | | 322 | 25.92 | | 8,346 |



Rogers

Assessment Property Record Card for Tax Year 2026

Data provided by LISA DELOZIER County Assessor

Date 04/16/2026
 Time 22:22:18
 Page 3

Sketch Image

660075093

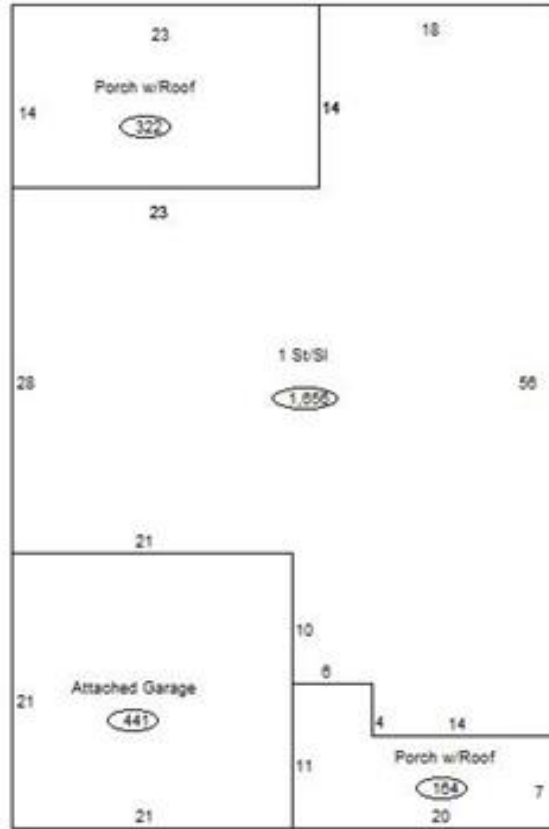

Sketch Vector Information

| Sequence | Code | Type | Built Over | Scale | Section Label | Base Area | Multiplier | Total Area |
|----------------------------|------|------|------------|-------|-----------------|-----------|------------|------------|
| 1 | R | 1 | Slab | 13 | 1 St/Sl | 1,656 | 1.000 | 1,656 |
| 2 | G | 1 | | 13 | Attached Garage | 441 | 1.000 | 441 |
| 3 | M | PRCH | | 13 | SLBC | 164 | 1.000 | 164 |
| 4 | M | PRCH | | 13 | SLBC | 322 | 1.000 | 322 |
| Total Building Area | | | | | | 1,656 | | 1,656 |