



Rogers

Assessment Property Record Card for Tax Year 2026

Data provided by LISA DELOZIER County Assessor

Date 04/17/2026
Time 18:18:03
Page 1

Assessment Data					Primary Image				
Account	660077335								
Parcel ID	19N17E-05-1-00000-000-0000								
Cadastral ID	05-19-17-01210								
Property Type	REAL - Real Property								
Property Class	UC	VI Area	3						
Tax Area	19 - INOLA OT								
Name ID	316362								
G & G ENTERPRISES LLC									
PO BOX 1072 INOLA OK 74036-0000									
Parcel Location									
Situs	31560 S 4210 RD								
Subdivision									
Lot/Block	/	Parcel Size	.85 - Acres						
Sec/Twn/Rng	5 / 19 / 17 / 1								
Neighborhood	5001 - TASC 2016								
School District	S005 - INOLA SCHOOLS								
Legal Description Lat/Long: 36.15772159 -95.51192082									
TR IN NE SE NE DESC AS; COMM NE/C NE SE NE, TH S00-07-03E 251' TO POB, TH CONT S00-07- 03E 349.79' TO ELY ROW/L RR, TH N31-26 05W ALG ELY ROW 409.59', TH N89-54-57E 212.89' TO POB									
Building Permits									
Number	Description	Opened	Closed	Amount					
795079	R-18 5,400 SQ FT. STORAGE BLDG.	01/2018	01/2019	90,000					
Exemptions									
Code	Type	Active	Maximum	Exemption					
Sale History									
Bk/Pg	Grantor	Date	Price	Code					
2502/839	INOLA STORAGE LLC	09/30/2015	800,000	YES					
1896/216	INOLA HOME CENTER, INC	08/31/2007	530,000	11					
1581/455	G & G MINI STORAGE	04/22/2004	122,500	YES					
1261/668	INOLA HOME CENTER, INC	04/15/1997	4,000	No					
Parcel Valuation									
Source	REAL	Fair Cash	Capped	Asmnt Level	Assessed	Levy Rate	80.060	Current Tax	
Remove Cap	2016	Land Value	47,305	47,305	11%	5,204	Assessed	24,586 1,968.36	
Year Frozen	0	Improvements	439,854	176,196		19,382	Penalty	0	
Uncapped Value	0	Mobile Home	0	0		0	Exemption	0 0.00	
TIF Project ID	0	Total Value	487,159	223,501		24,586	Total Taxable	24,586 1,968.00	
Assessment History									
Tax Year	Statement Number	Billed Owner	Tax Area	Total Value	Exemptions	Taxable Value	Billed Tax		
2025	2025-660077335	G & G ENTERPRISES LLC	19	474,793	0	23,415	1,875.00		
2024	2024-660077335	G & G ENTERPRISES LLC	19	202,723	0	22,300	1,793.00		
2023	2023-660077335	G & G ENTERPRISES LLC	19	354,227	0	34,565	2,784.00		
2022	2022-660077335	G & G ENTERPRISES LLC	19	351,585	0	32,919	2,670.00		
2021	2021-660077335	G & G ENTERPRISES LLC	19	285,013	0	31,352	2,512.00		
2020	2020-660077335	G & G ENTERPRISES LLC	19	285,013	0	30,062	2,428.00		
2019	2019-660077335	G & G ENTERPRISES LLC	19	291,423	0	28,630	2,365.00		
2018	2018-660077335	G & G ENTERPRISES LLC	19	283,776	0	27,267	2,276.00		
2017	2017-660077335	G & G ENTERPRISES LLC	19	236,076	0	25,969	2,185.00		
2016	2016-660077335	G & G ENTERPRISES LLC	19	236,076	0	25,969	2,209.00		
2015	2015-660077335	G & G ENTERPRISES LLC	19	185,891	0	20,448	1,774.00		
2014	2014-660077335	INOLA STORAGE LLC	19	185,891	0	20,448	1,836.00		
2013	2013-660077335	INOLA STORAGE LLC	19	191,761	0	21,093	1,777.00		



Rogers

Assessment Property Record Card for Tax Year 2026

Data provided by LISA DELOZIER County Assessor

Date 04/17/2026
 Time 18:18:03
 Page 2

Lot Data		Primary Image	
Lot Size	0 x 0		
Lot Count	0		
Units Buildable	0.85		
Non-Ag Acres	0.869		
Topography			
Street Access			
Utilities			
Amenities	0		
	0		
Value Model	1835 COMM		
Value Method	Square-Foot		
Base Lot Value	37,844.00 x 1.25 = 47,305		
Factor Value	0		
Adjustments			
Lot Value	47,305		
Cost Approach		Image Information	
Manual Date	01/2025	Image ID	804391
Total Building Area	10,889	Image Date	1/5/2016
Total Base Value	730,268	Name	660077335.JPG
Modifier Value		Description	
Misc Improvements			
Replacement Cost New	730,268		
Phys/Func Depreciation Loss	()		
RCN Less Phys/Func	439,854		
Economic Depreciation			
RCNLD (All Sources)	439,854		
Depreciated Improvements			
Outbuilding Value			
Total Improvement Value	439,854		
Land Value	47,305		
Cost Approach Value	487,159 44.74/SqFt		
Income Approach		Value Reconciliation	
Potential Gross Income (PGI)		Selected Valuation Method	Cost Approach
Vacancy & Collection Loss		Total Improvement Value	
Miscellaneous Income		Land Value	47,305
Effective Gross Income (EGI)		Total Appraised Value	487,159 44.74/SqFt
Total Expenses			
Net Operating Income (NOI)			
Income Capitalization Rate			
Indicated Value	0.00		



Rogers
Assessment Property Record Card for Tax Year 2026

Data provided by LISA DELOZIER County Assessor

Date 04/17/2026
 Time 18:18:03
 Page 3

Sketch Image

660077335

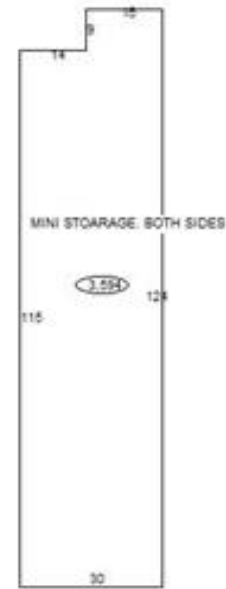
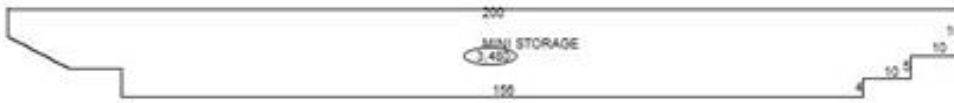

Sketch Vector Information

Sequence	Code	Type	Built Over	Scale	Section Label	Base Area	Multiplier	Total Area
1	C	386		30	MINI STORAGE	3,480	1.000	3,480
2	C	386		30	MINI STOARAGE. BOTH SIDES	3,594	1.000	3,594
3	C	386		30	386	1,505	1.000	1,505
4	C	386		30	386	2,310	1.000	2,310
Total Building Area						10,889		10,889



Rogers

Assessment Property Record Card for Tax Year 2026

Data provided by LISA DELOZIER County Assessor

Date 04/17/2026
Time 18:18:03
Page 4

Account 660077335
Parcel ID 19N17E-05-1-00000-000-0000
Cadastral ID 05-19-17-01210

Tax Area Code 19
Property Class UC
Owners Name G & G ENTERPRISES LLC

Building Data

Building ID 4211
Building Sequence 1
Occupancy 1 386 Mini-Warehouse 100%
Occupancy 2
Occupancy 3
Total Floor Area 2,310
Average Perimeter 338
Number Of Storys 1.00
Average Wall Ht 10.00
Year Built 2006
Effective Age 10
Construction Class 7 - Pre-Engineered Steel Frame
Quality 3 - Average
Condition 3 - Average
Exterior Wall 116 - Single Metal on Steel Frame
Heating/Cooling 15 - No HVAC
Roof Type Gable
Roof Cover Metal

Basement Area
Basement Levels
Basement Finish
Finish Code - 1
Finish Area - 1
Finish Code - 2
Finish Area - 2

Building Image

Image Information

Image Name
Image Date
Image Name
Description

Cost Calculations

Appraisal Zone 3
Zone Description
Base Cost 54.16
Wall Cost 31.68
HVAC Cost 0.00
Basement Cost 0.00
Total Base Cost 85.84
Total Area 2,310
Base RCN 198,290
Misc Impr Value

Manual Date 01/2025
Base Year 2026
Modifier Value
Total Replacement Cost 198,290
Physical Depreciation 15%
Functional Depreciation
Total Depreciation 15% (29,744)
Total RCNLD 168,546
Lump Sums
Total Building Value 168,546 \$ 72.96 Per SqFt



Rogers

Assessment Property Record Card for Tax Year 2026

Data provided by LISA DELOZIER County Assessor

Date 04/17/2026
Time 18:18:03
Page 5

Account 660077335
Parcel ID 19N17E-05-1-00000-000-0000
Cadastral ID 05-19-17-01210

Tax Area Code 19
Property Class UC
Owners Name G & G ENTERPRISES LLC

Building Data

Building ID 1755
Building Sequence 2
Occupancy 1 386 Mini-Warehouse 100%
Occupancy 2
Occupancy 3
Total Floor Area 3,480
Average Perimeter 433
Number Of Storys 1.00
Average Wall Ht 10.00
Year Built 1997
Effective Age 19
Construction Class 7 - Pre-Engineered Steel Frame
Quality 1 - Low
Condition 2 - Fair
Exterior Wall 88 - Stud Metal Siding
Heating/Cooling 15 - No HVAC
Roof Type
Roof Cover

Basement Area
Basement Levels
Basement Finish
Finish Code - 1
Finish Area - 1
Finish Code - 2
Finish Area - 2

Building Image



Image Information

Image Name 77335A.JPG
Image Date 1/2/2014
Image Name 77335A.JPG
Description

Cost Calculations

Appraisal Zone 3
Zone Description
Base Cost 41.95
Wall Cost 22.63
HVAC Cost 0.00
Basement Cost 0.00
Total Base Cost 64.58
Total Area 3,480
Base RCN 224,738
Misc Impr Value

Manual Date 01/2025
Base Year 2026
Modifier Value
Total Replacement Cost 224,738
Physical Depreciation 49%
Functional Depreciation
Total Depreciation 49% (110,122)
Total RCNLD 114,616
Lump Sums
Total Building Value 114,616 \$ 32.94 Per SqFt



Rogers

Assessment Property Record Card for Tax Year 2026

Data provided by LISA DELOZIER County Assessor

Date 04/17/2026
Time 18:18:03
Page 6

Account 660077335
Parcel ID 19N17E-05-1-00000-000-0000
Cadastral ID 05-19-17-01210

Tax Area Code 19
Property Class UC
Owners Name G & G ENTERPRISES LLC

Building Data

Building ID 1756
Building Sequence 3
Occupancy 1 386 Mini-Warehouse 100%
Occupancy 2
Occupancy 3
Total Floor Area 3,594
Average Perimeter 308
Number Of Storys 1.00
Average Wall Ht 10.00
Year Built 1997
Effective Age 19
Construction Class 7 - Pre-Engineered Steel Frame
Quality 1 - Low
Condition 2 - Fair
Exterior Wall 88 - Stud Metal Siding
Heating/Cooling 15 - No HVAC
Roof Type
Roof Cover

Basement Area
Basement Levels
Basement Finish
Finish Code - 1
Finish Area - 1
Finish Code - 2
Finish Area - 2

Building Image

Image Information

Image Name
Image Date
Image Name
Description

Cost Calculations

Appraisal Zone 3
Zone Description
Base Cost 42.60
Wall Cost 15.58
HVAC Cost 0.00
Basement Cost 0.00
Total Base Cost 58.18
Total Area 3,594
Base RCN 209,099
Misc Impr Value

Manual Date 01/2025
Base Year 2026
Modifier Value
Total Replacement Cost 209,099
Physical Depreciation 49%
Functional Depreciation
Total Depreciation 49% (102,459)
Total RCNLD 106,640
Lump Sums
Total Building Value 106,640 \$ 29.67 Per SqFt



Rogers

Assessment Property Record Card for Tax Year 2026

Data provided by LISA DELOZIER County Assessor

Date 04/17/2026
Time 18:18:04
Page 7

Account 660077335
Parcel ID 19N17E-05-1-00000-000-0000
Cadastral ID 05-19-17-01210

Tax Area Code 19
Property Class UC
Owners Name G & G ENTERPRISES LLC

Building Data

Building ID 1757
Building Sequence 4
Occupancy 1 386 Mini-Warehouse 100%
Occupancy 2
Occupancy 3
Total Floor Area 1,505
Average Perimeter 193
Number Of Storys 1.00
Average Wall Ht 10.00
Year Built 1997
Effective Age 19
Construction Class 7 - Pre-Engineered Steel Frame
Quality 1 - Low
Condition 2 - Fair
Exterior Wall 88 - Stud Metal Siding
Heating/Cooling 15 - No HVAC
Roof Type
Roof Cover
Basement Area
Basement Levels
Basement Finish
Finish Code - 1
Finish Area - 1
Finish Code - 2
Finish Area - 2

Building Image



Image Information

Image Name 77335B.JPG
Image Date 1/2/2014
Image Name 77335B.JPG
Description

Cost Calculations

Appraisal Zone 3
Zone Description
Base Cost 41.89
Wall Cost 23.32
HVAC Cost 0.00
Basement Cost 0.00
Total Base Cost 65.21
Total Area 1,505
Base RCN 98,141
Misc Impr Value

Manual Date 01/2025
Base Year 2026
Modifier Value
Total Replacement Cost 98,141
Physical Depreciation 49%
Functional Depreciation
Total Depreciation 49% (48,089)
Total RCNLD 50,052
Lump Sums
Total Building Value 50,052 \$ 33.26 Per SqFt