



Rogers

Assessment Property Record Card for Tax Year 2026

Data provided by LISA DELOZIER County Assessor

Date 04/17/2026
Time 16:31:04
Page 1

| Assessment Data | | | | | Primary Image | | | | | | | | | | | | | | |
|--|-------------------------|-----------------------------|------------------|------------------|--|--------------------|----------------------|----------------------|--------------------|--------|-------------|--------|--------|--------|--|--|--|--|--|
| Account 660078610 Parcel ID 23N17E-28-2-00000-000-0000 Cadastral ID 28-23-17-01110 Property Type REAL - Real Property Property Class RA VI Area 2 Tax Area 70 - FOYIL RURAL/FOYIL FIRE Name ID 263150 PITTS, PAULA S 18235 E 394 RD CLAREMORE OK 74017-3306 Parcel Location Situs 18235 394 RD UNIT Subdivision Lot/Block / Parcel Size 10.24 - Acres Sec/Twn/Rng 28 / 23 / 17 / 2 Neighborhood 4070 - FOYIL SEQUOYAH AREA School District S007 - FOYIL SCHOOLS | | | | | <p>\\tsclient\C\Users\Randy Necessary\Pictures\2020-10-15\IMG_005! 10/22/2020</p> | | | | | | | | | | | | | | |
| Legal Description Lat/Long: 36.44637024 -95.50074138 | | | | | | | | | | | | | | | | | | | |
| N 330.50' OF S 676.50' OF SE NW & W 30' OF S 346' OF SE NW | | | | | Building Permits <table border="1"> <thead> <tr> <th>Number</th> <th>Description</th> <th>Opened</th> <th>Closed</th> <th>Amount</th> </tr> </thead> <tbody> <tr> <td colspan="5" style="height: 100px;"> </td> </tr> </tbody> </table> | | | | | Number | Description | Opened | Closed | Amount | | | | | |
| Number | Description | Opened | Closed | Amount | | | | | | | | | | | | | | | |
| | | | | | | | | | | | | | | | | | | | |
| Exemptions | | | | | Sale History | | | | | | | | | | | | | | |
| Code | Type | Active | Maximum | Exemption | Bk/Pg | Grantor | Date | Price | Code | | | | | | | | | | |
| H | Homestead | Yes | 1,000 | 1,000 | 1313/453 | PITTS, B L | 08/23/2001 | 0 | 11 | | | | | | | | | | |
| Parcel Valuation | | | | | | | | | | | | | | | | | | | |
| Source | REAL | | Fair Cash | Capped | Asmnt Level | Assessed | Levy Rate | 101.660 | Current Tax | | | | | | | | | | |
| Remove Cap | 2002 | Land Value | 1,920 | 1,920 | 11% | 211 | Assessed | 5,164 | 524.97 | | | | | | | | | | |
| Year Frozen | 0 | Improvements | 13,060 | 10,099 | | 1,111 | Penalty | 0 | | | | | | | | | | | |
| Uncapped Value | 0 | Mobile Home | 35,404 | 34,924 | | 3,842 | Exemption | 1,000 | -89.00 | | | | | | | | | | |
| TIF Project ID | 0 | Total Value | 50,384 | 46,943 | | 5,164 | Total Taxable | 4,164 | 436.00 | | | | | | | | | | |
| Assessment History | | | | | | | | | | | | | | | | | | | |
| Tax Year | Statement Number | Billed Owner | | | Tax Area | Total Value | Exemptions | Taxable Value | Billed Tax | | | | | | | | | | |
| 2025 | 2025-660078610 | PITTS, PAULA S | | | 70 | 51,051 | 1000 | 4,014 | 421.00 | | | | | | | | | | |
| 2024 | 2024-660078610 | PITTS, PAULA S | | | 70 | 51,211 | 1000 | 3,867 | 416.00 | | | | | | | | | | |
| 2023 | 2023-660078610 | PITTS, BOBBY L JR & PAULA S | | | 70 | 44,586 | 1000 | 3,725 | 402.00 | | | | | | | | | | |
| 2022 | 2022-660078610 | PITTS, BOBBY L JR & PAULA S | | | 70 | 41,710 | 1000 | 3,587 | 389.00 | | | | | | | | | | |
| 2021 | 2021-660078610 | PITTS, BOBBY L JR & PAULA S | | | 70 | 50,137 | 1000 | 3,859 | 408.00 | | | | | | | | | | |
| 2020 | 2020-660078610 | PITTS, BOBBY L JR & PAULA S | | | 70 | 43,546 | 1000 | 3,718 | 410.00 | | | | | | | | | | |
| 2019 | 2019-660078610 | PITTS, BOBBY L JR & PAULA S | | | 70 | 41,645 | 1000 | 3,580 | 397.00 | | | | | | | | | | |
| 2018 | 2018-660078610 | PITTS, BOBBY L JR & PAULA S | | | 70 | 44,339 | 1000 | 3,877 | 420.00 | | | | | | | | | | |
| 2017 | 2017-660078610 | PITTS, BOBBY L & PAULA S | | | 70 | 43,917 | 1000 | 3,831 | 418.00 | | | | | | | | | | |
| 2016 | 2016-660078610 | PITTS, BOBBY L & PAULA S | | | 70 | 45,305 | 1000 | 3,984 | 448.00 | | | | | | | | | | |
| 2015 | 2015-660078610 | PITTS, BOBBY L & PAULA S | | | 70 | 44,325 | 1000 | 3,876 | 432.00 | | | | | | | | | | |
| 2014 | 2014-660078610 | PITTS, BOBBY L & PAULA S | | | 70 | 44,638 | 1000 | 3,880 | 427.00 | | | | | | | | | | |
| 2013 | 2013-660078610 | PITTS, BOBBY L & PAULA S | | | 70 | 44,324 | 1000 | 3,738 | 402.00 | | | | | | | | | | |



Rogers

Assessment Property Record Card for Tax Year 2026

Data provided by LISA DELOZIER County Assessor

Date 04/17/2026
Time 16:31:05
Page 2

| | |
|---|-----------------|
| Lot Data - FOYIL SEQUOYAH AREA (UNITS BUILDABLE) | |
| Lot Size | |
| Lot Count | |
| Units Buildable | |
| Non-Ag Acres | |
| Topography | |
| Street Access | |
| Utilities | |
| Amenities | LAND QUALITY |
| Method | Units-Buildable |
| Base Lot Value | |
| Factor Value | |
| Adjustments | |
| Lot Value | |



\\tsclient\C\Users\Randy Necessary\Pictures\2020-10-15\IMG_005! 10/22/2020

| | |
|-------------------------|--------------------------|
| Residential Data | |
| Type | 6 Mobile Home 56 x 28 |
| Condition | 3 - Average |
| Quality | 3 - Average |
| Architecture | 6 MS ADJ |
| Style | 100% Double Wide |
| Exterior Wall | 100% Lap |
| Base/Total Area | 1,568 / 1,568 |
| Style | 100% Double Wide |
| HVAC | 100% Warmed & Cooled Air |
| Roof Cover | 1 Composition Shingle |
| Area on Slab | 0 |
| Fixture/RghIn | / |
| Bed/F/H Bath | / / |
| Basement Area | |
| Garage Type | |
| Remodel | |
| Year/Eff Age | 2001 / 19 |

| | |
|---------------------|------|
| GRM Approach | |
| GRM Code | |
| Gross Rent | 0.00 |
| Indicated Value | |

| | |
|----------------------------|--|
| Multiple Regression | |
| MRA Code | |
| Adjusted R | |
| Indicated Value | |

| | |
|---------------------------|------------|
| Direct Comparables | |
| Selection Model | 1 Res |
| Adjustment Model | A2 AO Test |
| Comparables | |
| Indicated Value | |

| | | | |
|----------------------|----------|-------------------------|----------|
| Cost Approach | | Manual : 01/2025 | |
| Base Cost | 33.90 | Total Misc Impr | + 0 |
| Roofing Adj | + 2.62 | Garage Cost | + 0 |
| Subfloor Adj | + 0.00 | Total RCN | = 72,253 |
| Heat/Cool Adj | + 2.77 | Depreciation (51%) | - 36,849 |
| Plumbing Adj | + 6.79 | Lump Sums | + 9,166 |
| Basement Adj | + 0.00 | RCNLD | = 44,570 |
| Adj Base Cost | = 46.08 | Lot Value | + 44,570 |
| Total Area | x 1,568 | Indicated Value | = 44,570 |
| Adjusted Cost | = 72,253 | Value Per SqFt | 28.42 |

| | | | |
|-----------------------------|---------------|-------|----------------------|
| Value Reconciliation | | | |
| Selected Approach | Cost Approach | | |
| Improvements | 44,570 | | |
| Lot Value | | | |
| Indicated Value | 44,570 | 28.42 | Per SqFt |
| Agland Value | 1,920 | | |
| Site Improvements | | | |
| Total Value | 46,490 | 29.65 | Total Value Per SqFt |

| Miscellaneous Improvements | | | | | | | | |
|-----------------------------------|------------------|-----------|-------|------|-------|-----------|------|-------|
| Code | Description | Sketch ID | Size | Year | Units | Unit Cost | Depr | Value |
| WODO | WOOD DECK - OPEN | 131873 | 10x8 | | 80 | 28.11 | 10% | 2,024 |
| WODO | WOOD DECK - OPEN | 131874 | 20x12 | | 240 | 20.02 | 10% | 4,324 |
| WODO | WOOD DECK - OPEN | 147990 | 12x10 | | 120 | 26.09 | 10% | 2,818 |



Rogers
Assessment Property Record Card for Tax Year 2026

Data provided by LISA DELOZIER County Assessor

Date 04/17/2026
 Time 16:31:05
 Page 3

Sketch Image

660078610

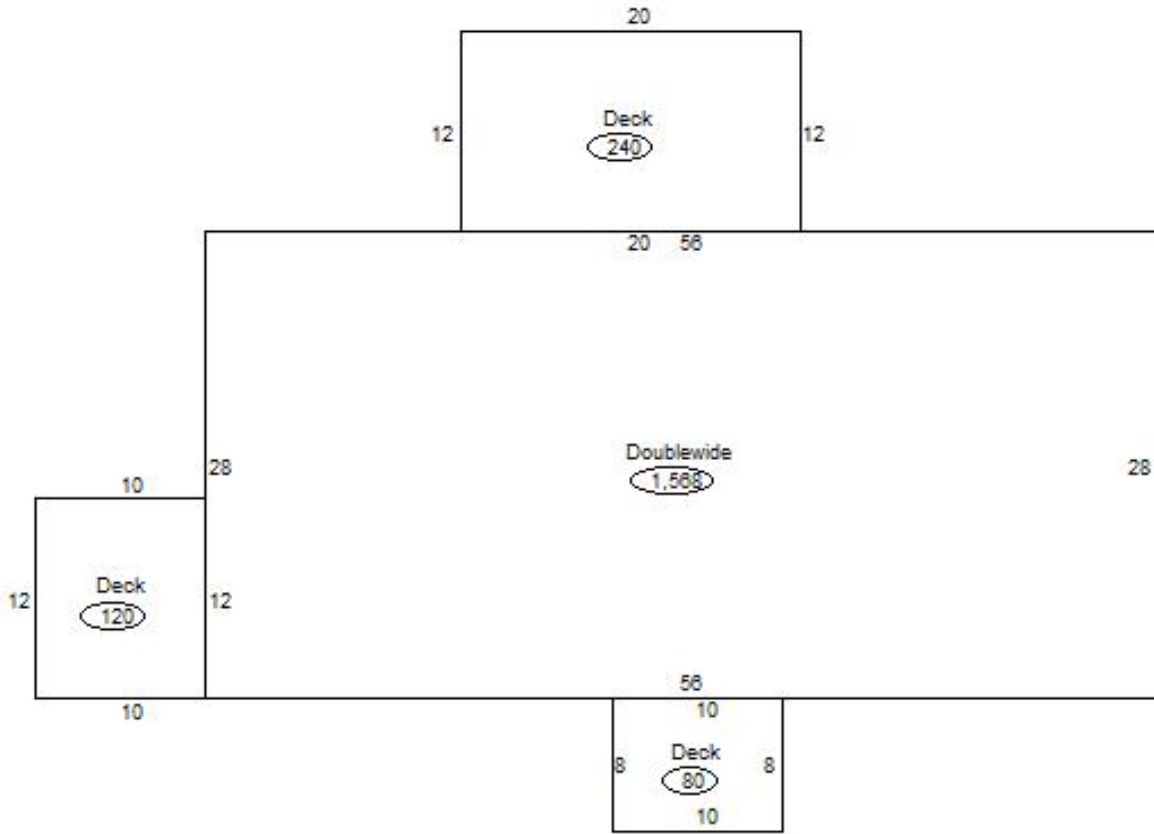

Sketch Vector Information

| Sequence | Code | Type | Built Over | Scale | Section Label | Base Area | Multiplier | Total Area |
|----------------------------|------|------|------------|-------|---------------|-----------|------------|------------|
| 1 | R | 14 | | 13 | Doublewide | 1,568 | 1.000 | 1,568 |
| 2 | M | WODO | | 13 | WODO | 80 | 1.000 | 80 |
| 3 | M | WODO | | 13 | WODO | 240 | 1.000 | 240 |
| 4 | M | WODO | | 13 | WODO | 120 | 1.000 | 120 |
| Total Building Area | | | | | | 1,568 | | 1,568 |



Rogers

Assessment Property Record Card for Tax Year 2026

Data provided by LISA DELOZIER County Assessor

Date 04/17/2026
 Time 16:31:05
 Page 4

| | | | | | | | | |
|--|--|----------------------|-------------|-------------|--------------|------------------|-------------|--------------|
| Lot Data - FOYIL SEQUOYAH AREA (UNITS BUILDABLE) | | Primary Image | | | | | | |
| Lot Size Lot Count Units Buildable Non-Ag Acres 0 Topography Street Access Utilities Amenities LAND QUALITY Method Units-Buildable Base Lot Value Factor Value Adjustments Lot Value | | | | | | | | |
| Residential Data | | | | | | | | |
| Type Condition - Quality - Architecture Style Exterior Wall Base/Total Area / Style HVAC Roof Cover Area on Slab Fixture/RghIn / Bed/F/H Bath / / Basement Area Garage Type Remodel Year/Eff Age / | | | | | | | | |
| GRM Approach | | | | | | | | |
| GRM Code Gross Rent 0.00 Indicated Value | | | | | | | | |
| Multiple Regression | | | | | | | | |
| MRA Code Adjusted R Indicated Value | | | | | | | | |
| Direct Comparables | | | | | | | | |
| Selection Model 1 Res Adjustment Model A2 AO Test Comparables Indicated Value | | | | | | | | |
| Value Reconciliation | | | | | | | | |
| Selected Approach Cost Approach Improvements Lot Value Indicated Value 0.00 Per SqFt Aground Value Site Improvements 3,894 Total Value 3,894 0.00 Total Value Per SqFt | | | | | | | | |
| Cost Approach Manual : 01/2025 | | | | | | | | |
| Base Cost 0.00 Roofing Adj + 0.00 Subfloor Adj + 0.00 Heat/Cool Adj + 0.00 Plumbing Adj + 0.00 Basement Adj + 0.00 Adj Base Cost = 0.00 Total Area x Adjusted Cost = 0 | Total Misc Impr + 0 Garage Cost + Total RCN = 0 Depreciation (0%) - 0 Lump Sums + 0 RCNLD = Lot Value + Indicated Value = Value Per SqFt 0.00 | | | | | | | |
| Miscellaneous Improvements | | | | | | | | |
| Code | Description | Sketch ID | Size | Year | Units | Unit Cost | Depr | Value |
| SHLT | STORM SHELTER | | 1 | 2016 | 1 | 0.00 | | |



Rogers

Assessment Property Record Card for Tax Year 2026

Data provided by LISA DELOZIER County Assessor

Date 04/17/2026
Time 16:31:05
Page 5

660078610

Outbuildings/Site Improvements

| Building Image | Code | Description | Dimensions | Floor | Roofing | Total Units |
|----------------|---------------|---------------|------------------|-------------------|------------------|-------------|
| | SHDS | Shed - Small | 8x10x6 | Plank | Galvanized Metal | 80 |
| | Qual 2 | Cond 2 | Year 2010 | Eff Age 16 | | |

| | | | | |
|--------------------------|-----------------------|------------|-----------------------------------|--------------|
| Valuation Summary | Modifier Total | RCN | Depr (52% Phys/ 100% Func) | RCNLD |
| Base Cost (24.08 x 80) | 1,926 | | 1,926 | 1,926 |



| | | | | | |
|---------------|---------------|------------------|-------------------|------------------|-----|
| EQSH | Equip Shd | 16x40x8 | Dirt | Galvanized Metal | 640 |
| Qual 2 | Cond 2 | Year 2000 | Eff Age 26 | | |

| | | | | |
|--------------------------|-----------------------|------------|---------------------------------|--------------|
| Valuation Summary | Modifier Total | RCN | Depr (60% Phys/ 0% Func) | RCNLD |
| Base Cost (15.21 x 640) | 9,734 | | 9,734 | 5,840 |
| | | | | 3,894 |



Rogers

Assessment Property Record Card for Tax Year 2026

Data provided by LISA DELOZIER County Assessor

Date 04/17/2026
Time 16:31:05
Page 6

Agland Inventory

660078610

| Soi | Description | Land Use | LPI | Adj Type | Adj Code | Acres | Use/Acre | Mkt/Acre | Use Value | Market Value |
|-----------------------|---------------------------|----------|-----|----------|----------|--------|----------|----------|-----------|--------------|
| DNB | DENNIS SILT LOAM 1-3% SLO | NTV PST | 80 | | | 10.000 | 192 | 192 | 1,920 | 1,920 |
| NTV PST Totals | | | | | | 10.000 | | | 1,920 | 1,920 |
| Total Agland | | | | | | 10.000 | | | 1,920 | 1,920 |