



# Rogers

## Assessment Property Record Card for Tax Year 2026

Data provided by LISA DELOZIER County Assessor

Date 04/17/2026  
Time 01:30:12  
Page 1

Assessment Data					Primary Image																																																																																																																				
<b>Account</b> 660078903 <b>Parcel ID</b> 21N16E-23-1-00000-000-0000 <b>Cadastral ID</b> 23-21-16-00620 <b>Property Type</b> REAL - Real Property <b>Property Class</b> RR VI Area 1 <b>Tax Area</b> 5 - JUSTUS RURAL/NO FIRE <b>Name ID</b> 320933 WINKLE, CLIFTON A & LEE A  14900 E 500 RD CLAREMORE OK 74019-0000  <b>Parcel Location</b> <b>Situs</b> 14900 E 500 RD <b>Subdivision</b> <b>Lot/Block</b> / <b>Parcel Size</b> 4.65 - Acres <b>Sec/Twn/Rng</b> 23 / 21 / 16 / 1 <b>Neighborhood</b> 2116 - UNPLATTED <b>School District</b> S009 - JUSTUS-TIAWAH SCHOOLS																																																																																																																									
<b>Legal Description</b> Lat/Long: 36.29220955 -95.56184689																																																																																																																									
<b>Legal Description</b> N 440' OF E2 NE NE LESS W 200'					<b>Building Permits</b>																																																																																																																				
					<table border="1"> <thead> <tr> <th>Number</th> <th>Description</th> <th>Opened</th> <th>Closed</th> <th>Amount</th> </tr> </thead> <tbody> <tr> <td>R 2017 08 6</td> <td>R18-NEW POLE BARN 30X40</td> <td>08/2017</td> <td>11/2017</td> <td>25,000</td> </tr> </tbody> </table>					Number	Description	Opened	Closed	Amount	R 2017 08 6	R18-NEW POLE BARN 30X40	08/2017	11/2017	25,000																																																																																																						
Number	Description	Opened	Closed	Amount																																																																																																																					
R 2017 08 6	R18-NEW POLE BARN 30X40	08/2017	11/2017	25,000																																																																																																																					
<b>Exemptions</b>					<b>Sale History</b>																																																																																																																				
<table border="1"> <thead> <tr> <th>Code</th> <th>Type</th> <th>Active</th> <th>Maximum</th> <th>Exemption</th> </tr> </thead> <tbody> <tr> <td>H</td> <td>Homestead</td> <td>Yes</td> <td>1,000</td> <td>1,000</td> </tr> <tr> <td>H</td> <td>Homestead</td> <td>No</td> <td>1,000</td> <td></td> </tr> </tbody> </table>					Code	Type	Active	Maximum	Exemption	H	Homestead	Yes	1,000	1,000	H	Homestead	No	1,000		<table border="1"> <thead> <tr> <th>Bk/Pg</th> <th>Grantor</th> <th>Date</th> <th>Price</th> <th>Code</th> </tr> </thead> <tbody> <tr> <td>2620/17</td> <td>WALDEN, RONALD DAVID &amp;</td> <td>03/20/2017</td> <td>315,000</td> <td>17</td> </tr> <tr> <td>1869/865</td> <td>MAYNARD, VON W &amp; CAROLYN G</td> <td>04/23/2007</td> <td>297,000</td> <td>11</td> </tr> <tr> <td>1329/244</td> <td>LAWSON, JERRY E &amp;</td> <td>11/02/2001</td> <td>270,000</td> <td>11</td> </tr> </tbody> </table>					Bk/Pg	Grantor	Date	Price	Code	2620/17	WALDEN, RONALD DAVID &	03/20/2017	315,000	17	1869/865	MAYNARD, VON W & CAROLYN G	04/23/2007	297,000	11	1329/244	LAWSON, JERRY E &	11/02/2001	270,000	11																																																																													
Code	Type	Active	Maximum	Exemption																																																																																																																					
H	Homestead	Yes	1,000	1,000																																																																																																																					
H	Homestead	No	1,000																																																																																																																						
Bk/Pg	Grantor	Date	Price	Code																																																																																																																					
2620/17	WALDEN, RONALD DAVID &	03/20/2017	315,000	17																																																																																																																					
1869/865	MAYNARD, VON W & CAROLYN G	04/23/2007	297,000	11																																																																																																																					
1329/244	LAWSON, JERRY E &	11/02/2001	270,000	11																																																																																																																					
<b>Parcel Valuation</b>																																																																																																																									
<table border="1"> <thead> <tr> <th>Source</th> <th>REAL</th> <th>Fair Cash</th> <th>Capped</th> <th>Asmnt Level</th> <th>Assessed</th> <th>Levy Rate</th> <th>83.050</th> <th>Current Tax</th> </tr> </thead> <tbody> <tr> <td>Remove Cap</td> <td>2018</td> <td>Land Value</td> <td>80,560</td> <td>74,488</td> <td>11%</td> <td>8,194</td> <td>Assessed</td> <td>43,541</td> <td>3,616.08</td> </tr> <tr> <td>Year Frozen</td> <td>0</td> <td>Improvements</td> <td>346,793</td> <td>321,335</td> <td></td> <td>35,347</td> <td>Penalty</td> <td>0</td> <td></td> </tr> <tr> <td>Uncapped Value</td> <td>0</td> <td>Mobile Home</td> <td>0</td> <td>0</td> <td></td> <td>0</td> <td>Exemption</td> <td>1,000</td> <td>-83.00</td> </tr> <tr> <td>TIF Project ID</td> <td>0</td> <td>Total Value</td> <td>427,353</td> <td>395,823</td> <td></td> <td>43,541</td> <td>Total Taxable</td> <td>42,541</td> <td>3,533.00</td> </tr> </tbody> </table>		Source	REAL	Fair Cash	Capped	Asmnt Level	Assessed	Levy Rate	83.050	Current Tax	Remove Cap	2018	Land Value	80,560	74,488	11%	8,194	Assessed	43,541	3,616.08	Year Frozen	0	Improvements	346,793	321,335		35,347	Penalty	0		Uncapped Value	0	Mobile Home	0	0		0	Exemption	1,000	-83.00	TIF Project ID	0	Total Value	427,353	395,823		43,541	Total Taxable	42,541	3,533.00																																																																							
Source	REAL	Fair Cash	Capped	Asmnt Level	Assessed	Levy Rate	83.050	Current Tax																																																																																																																	
Remove Cap	2018	Land Value	80,560	74,488	11%	8,194	Assessed	43,541	3,616.08																																																																																																																
Year Frozen	0	Improvements	346,793	321,335		35,347	Penalty	0																																																																																																																	
Uncapped Value	0	Mobile Home	0	0		0	Exemption	1,000	-83.00																																																																																																																
TIF Project ID	0	Total Value	427,353	395,823		43,541	Total Taxable	42,541	3,533.00																																																																																																																
<b>Assessment History</b>																																																																																																																									
<table border="1"> <thead> <tr> <th>Tax Year</th> <th>Statement Number</th> <th>Billed Owner</th> <th>Tax Area</th> <th>Total Value</th> <th>Exemptions</th> <th>Taxable Value</th> <th>Billed Tax</th> </tr> </thead> <tbody> <tr><td>2025</td><td>2025-660078903</td><td>WINKLE, CLIFTON A &amp; LEE A</td><td>5</td><td>413,331</td><td>1000</td><td>41,273</td><td>3,428.00</td></tr> <tr><td>2024</td><td>2024-660078903</td><td>WINKLE, CLIFTON A &amp; LEE A</td><td>5</td><td>430,958</td><td>1000</td><td>40,041</td><td>3,341.00</td></tr> <tr><td>2023</td><td>2023-660078903</td><td>WINKLE, CLIFTON A &amp; LEE A</td><td>5</td><td>362,235</td><td>1000</td><td>38,845</td><td>3,235.00</td></tr> <tr><td>2022</td><td>2022-660078903</td><td>WINKLE, CLIFTON A &amp; LEE A</td><td>5</td><td>363,465</td><td>1000</td><td>38,466</td><td>3,200.00</td></tr> <tr><td>2021</td><td>2021-660078903</td><td>WINKLE, CLIFTON A &amp; LEE A</td><td>5</td><td>350,143</td><td>1000</td><td>37,317</td><td>3,166.00</td></tr> <tr><td>2020</td><td>2020-660078903</td><td>WINKLE, CLIFTON A &amp; LEE A</td><td>5</td><td>342,254</td><td>1000</td><td>36,201</td><td>3,065.00</td></tr> <tr><td>2019</td><td>2019-660078903</td><td>WINKLE, CLIFTON A &amp; LEE A</td><td>5</td><td>328,337</td><td>1000</td><td>35,117</td><td>3,041.00</td></tr> <tr><td>2018</td><td>2018-660078903</td><td>WINKLE, CLIFTON A &amp; LEE A</td><td>5</td><td>336,339</td><td>1000</td><td>35,997</td><td>3,121.00</td></tr> <tr><td>2017</td><td>2017-660078903</td><td>WINKLE, CLIFTON A &amp; LEE A</td><td>5</td><td>351,155</td><td>1000</td><td>37,063</td><td>3,023.00</td></tr> <tr><td>2016</td><td>2016-660078903</td><td>WALDEN, RONALD DAVID &amp;</td><td>5</td><td>312,344</td><td>1000</td><td>32,644</td><td>2,785.00</td></tr> <tr><td>2015</td><td>2015-660078903</td><td>WALDEN, RONALD DAVID &amp;</td><td>5</td><td>302,343</td><td>1000</td><td>31,664</td><td>2,675.00</td></tr> <tr><td>2014</td><td>2014-660078903</td><td>WALDEN, RONALD DAVID &amp;</td><td>5</td><td>304,952</td><td>1000</td><td>30,713</td><td>2,636.00</td></tr> <tr><td>2013</td><td>2013-660078903</td><td>WALDEN, RONALD DAVID &amp;</td><td>5</td><td>286,074</td><td>1000</td><td>29,789</td><td>2,595.00</td></tr> </tbody> </table>										Tax Year	Statement Number	Billed Owner	Tax Area	Total Value	Exemptions	Taxable Value	Billed Tax	2025	2025-660078903	WINKLE, CLIFTON A & LEE A	5	413,331	1000	41,273	3,428.00	2024	2024-660078903	WINKLE, CLIFTON A & LEE A	5	430,958	1000	40,041	3,341.00	2023	2023-660078903	WINKLE, CLIFTON A & LEE A	5	362,235	1000	38,845	3,235.00	2022	2022-660078903	WINKLE, CLIFTON A & LEE A	5	363,465	1000	38,466	3,200.00	2021	2021-660078903	WINKLE, CLIFTON A & LEE A	5	350,143	1000	37,317	3,166.00	2020	2020-660078903	WINKLE, CLIFTON A & LEE A	5	342,254	1000	36,201	3,065.00	2019	2019-660078903	WINKLE, CLIFTON A & LEE A	5	328,337	1000	35,117	3,041.00	2018	2018-660078903	WINKLE, CLIFTON A & LEE A	5	336,339	1000	35,997	3,121.00	2017	2017-660078903	WINKLE, CLIFTON A & LEE A	5	351,155	1000	37,063	3,023.00	2016	2016-660078903	WALDEN, RONALD DAVID &	5	312,344	1000	32,644	2,785.00	2015	2015-660078903	WALDEN, RONALD DAVID &	5	302,343	1000	31,664	2,675.00	2014	2014-660078903	WALDEN, RONALD DAVID &	5	304,952	1000	30,713	2,636.00	2013	2013-660078903	WALDEN, RONALD DAVID &	5	286,074	1000	29,789	2,595.00
Tax Year	Statement Number	Billed Owner	Tax Area	Total Value	Exemptions	Taxable Value	Billed Tax																																																																																																																		
2025	2025-660078903	WINKLE, CLIFTON A & LEE A	5	413,331	1000	41,273	3,428.00																																																																																																																		
2024	2024-660078903	WINKLE, CLIFTON A & LEE A	5	430,958	1000	40,041	3,341.00																																																																																																																		
2023	2023-660078903	WINKLE, CLIFTON A & LEE A	5	362,235	1000	38,845	3,235.00																																																																																																																		
2022	2022-660078903	WINKLE, CLIFTON A & LEE A	5	363,465	1000	38,466	3,200.00																																																																																																																		
2021	2021-660078903	WINKLE, CLIFTON A & LEE A	5	350,143	1000	37,317	3,166.00																																																																																																																		
2020	2020-660078903	WINKLE, CLIFTON A & LEE A	5	342,254	1000	36,201	3,065.00																																																																																																																		
2019	2019-660078903	WINKLE, CLIFTON A & LEE A	5	328,337	1000	35,117	3,041.00																																																																																																																		
2018	2018-660078903	WINKLE, CLIFTON A & LEE A	5	336,339	1000	35,997	3,121.00																																																																																																																		
2017	2017-660078903	WINKLE, CLIFTON A & LEE A	5	351,155	1000	37,063	3,023.00																																																																																																																		
2016	2016-660078903	WALDEN, RONALD DAVID &	5	312,344	1000	32,644	2,785.00																																																																																																																		
2015	2015-660078903	WALDEN, RONALD DAVID &	5	302,343	1000	31,664	2,675.00																																																																																																																		
2014	2014-660078903	WALDEN, RONALD DAVID &	5	304,952	1000	30,713	2,636.00																																																																																																																		
2013	2013-660078903	WALDEN, RONALD DAVID &	5	286,074	1000	29,789	2,595.00																																																																																																																		



# Rogers

## Assessment Property Record Card for Tax Year 2026

Data provided by LISA DELOZIER County Assessor

Date 04/17/2026  
 Time 01:30:12  
 Page 2

Lot Data		Square-Foot - NBHD 2116 #1	
Lot Size			
Lot Count	0		
Units Buildable	2		
Non-Ag Acres	4.647		
Topography			
Street Access			
Utilities			
Amenities	LAND QUALITY	0	0
Method	Square-Foot		
Base Lot Value	202,424.00 x .40 = 80,560		
Factor Value			
Adjustments	1.0000		
Lot Value	80,560		



\\tsclient\T\LOGAN\LOGAN RESIDENTIAL VI\2023-10-17\IMG\_00; 10/17/2023

Residential Data	
Type	1 Single Family Residence
Condition	3 - Average
Quality	4 - Good
Architecture	
Style	100% 1 1/2 Story Finished
Exterior Wall	100% Veneer, Masonry
Base/Total Area	2,248 / 2,770
Style	100% 1 1/2 Story Finished
HVAC	100% Warmed & Cooled Air
Roof Cover	1 Composition Shingle
Area on Slab	2,248
Fixture/RghIn	14 /
Bed/F/H Bath	4 / 2.5 /
Basement Area	
Garage Type	746 Attached Garage - Unfinished
Remodel	
Year/Eff Age	1997 / 22

### GRM Approach

GRM Code	
Gross Rent	0.00
Indicated Value	

### Multiple Regression

MRA Code	1 Test
Adusted R	0.8445
Indicated Value	423,187 152.78 Per SqFt

### Direct Comparables

Selection Model	A Adam Test
Adjustment Model	NewTest
Comparables	
Indicated Value	

### Value Reconciliation

Selected Approach	Cost Approach
Improvements	306,885
Lot Value	80,560
Indicated Value	387,445 139.87 Per SqFt
Agland Value	
Site Improvements	39,908
Total Value	427,353 154.28 Total Value Per SqFt

Cost Approach		Manual : 01/2025	
Base Cost	103.63	Total Misc Impr	+ 20,532
Roofing Adj	+ 4.79	Garage Cost	+ 33,883
Subfloor Adj	+ -3.75	Total RCN	= 414,709
Heat/Cool Adj	+ 16.31	Depreciation ( 26%)	- 107,824
Plumbing Adj	+ 9.09	Lump Sums	+ 0
Basement Adj	+ 0.00	RCNLD	= 306,885
Adj Base Cost	= 130.07	Lot Value	+ 80,560
Total Area	x 2,770	Indicated Value	= 387,445
Adjusted Cost	= 360,294	Value Per SqFt	139.87

### Miscellaneous Improvements

Code	Description	Sketch ID	Size	Year	Units	Unit Cost	Depr	Value
FPR1	FIREPLACE - RESIDENTIAL 1 STORY	0		1	1	7,243.87		7,244
PRCH	SLAB PORCH - COVERED	93930		113	113	32.80		3,706
PRCH	SLAB PORCH - COVERED	93931	30x10		300	31.94		9,582



# Rogers

## Assessment Property Record Card for Tax Year 2026

Data provided by LISA DELOZIER County Assessor

Date 04/17/2026  
 Time 01:30:12  
 Page 3

### Sketch Image

660078903

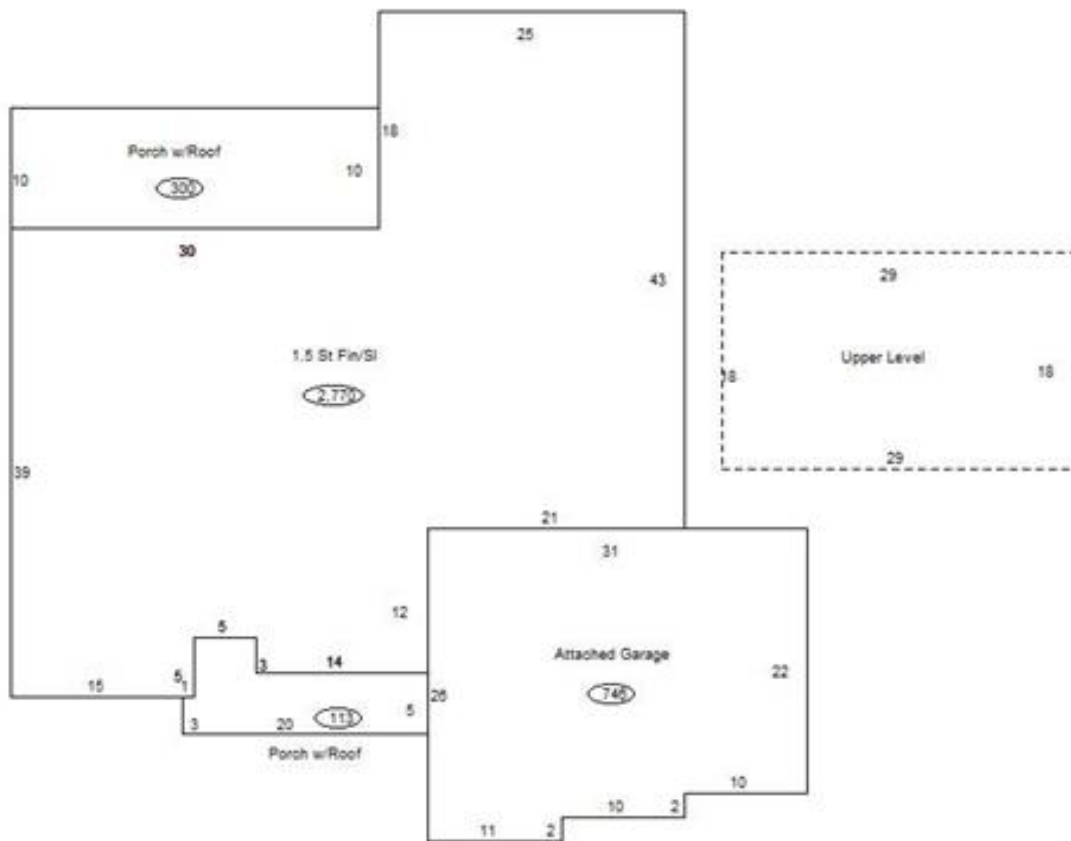

### Sketch Vector Information

Sequence	Code	Type	Built Over	Scale	Section Label	Base Area	Multiplier	Total Area
1	R	5	Slab	13	1.5 St Fin/Sl	2,248	1.232	2,770
2	G	1		13	Attached Garage	746	1.000	746
3	M	PRCH		13	SLBC	113	1.000	113
4	M	PRCH		13	SLBC	300	1.000	300
5	U	^UL	Overhang	13	Upper Level	522	1.000	522
<b>Total Building Area</b>						<b>2,248</b>		<b>2,770</b>



# Rogers



## Assessment Property Record Card for Tax Year 2026

Data provided by LISA DELOZIER County Assessor

Date 04/17/2026  
Time 01:30:12  
Page 4

660078903

### Outbuildings/Site Improvements

Building Image	Code	Description	Dimensions	Floor	Roofing	Total Units	
	UTIL	SHOP BUILDING	40x30x0			1,200	
	Qual	2	Cond	Year	2017	Eff Age	
	<b>Valuation Summary</b>		<b>Modifier Total</b>		<b>RCN</b>	<b>Depr (5% Phys/ % Func)</b>	<b>RCNLD</b>
	Base Cost (31.84 x 1,200)		38,208		38,208	1,910	36,298
	LNT0	LEAN TO - ATTACHED	40x10x0			400	
	Qual		Cond	Year	2017	Eff Age	
	<b>Valuation Summary</b>		<b>Modifier Total</b>		<b>RCN</b>	<b>Depr (5% Phys/ % Func)</b>	<b>RCNLD</b>
	Base Cost (9.50 x 400)		3,800		3,800	190	3,610