



Rogers

Assessment Property Record Card for Tax Year 2026

Data provided by LISA DELOZIER County Assessor

Date 04/18/2026
 Time 08:07:36
 Page 1

Assessment Data					Primary Image																																																																																																																				
Account 660078921 Parcel ID 23N15E-19-2-00000-000-0000 Cadastral ID 19-23-15-02311 Property Type REAL - Real Property Property Class RR VI Area 2 Tax Area 10 - OOLOGAH RURAL/NW FIRE Name ID 346413 SHOOK, ALYSSA & DALTON 10020 S 4072 RD TALALA OK 74080-0000 Parcel Location Situs 10020 S 4072 RD Subdivision Lot/Block / Parcel Size 2.42 - Acres Sec/Twn/Rng 19 / 23 / 15 / 2 Neighborhood 4020 - OOLOGAH School District S004 - OOLOGAH SCHOOLS					<p>\\tsclient\C\Users\CB\Pictures\2020-06-01\IMG_0211.JPG 6/2/2020</p>																																																																																																																				
Legal Description Lat/Long: 36.46656737 -95.75639920																																																																																																																									
Legal Description TR IN GO'VT LOT 1 BEG NW/C GOV'T LOT 1; E 400' S 25' TO POB; S 280'; E 375'; N 280'; W 375' TO POB.					Building Permits <table border="1"> <thead> <tr> <th>Number</th> <th>Description</th> <th>Opened</th> <th>Closed</th> <th>Amount</th> </tr> </thead> <tbody> <tr> <td> </td> <td> </td> <td> </td> <td> </td> <td> </td> </tr> </tbody> </table>					Number	Description	Opened	Closed	Amount																																																																																																											
Number	Description	Opened	Closed	Amount																																																																																																																					
Exemptions <table border="1"> <thead> <tr> <th>Code</th> <th>Type</th> <th>Active</th> <th>Maximum</th> <th>Exemption</th> </tr> </thead> <tbody> <tr> <td>H</td> <td>Homestead</td> <td>No</td> <td>1,000</td> <td> </td> </tr> <tr> <td>H</td> <td>Homestead</td> <td>No</td> <td>1,000</td> <td> </td> </tr> </tbody> </table>					Code	Type	Active	Maximum	Exemption	H	Homestead	No	1,000		H	Homestead	No	1,000		Sale History <table border="1"> <thead> <tr> <th>Bk/Pg</th> <th>Grantor</th> <th>Date</th> <th>Price</th> <th>Code</th> </tr> </thead> <tbody> <tr> <td>/</td> <td>MITCHELL, TODD BLAINE</td> <td>02/14/2025</td> <td>340,000</td> <td>YES</td> </tr> <tr> <td>/</td> <td>BROOKS, JEFFERY M</td> <td>10/20/2022</td> <td>252,500</td> <td>YES</td> </tr> <tr> <td>2600/553</td> <td>NELSON, STEVEN A</td> <td>12/16/2016</td> <td>182,000</td> <td>YES</td> </tr> <tr> <td>2248/820</td> <td>LAKESIDE STATE BANK</td> <td>06/04/2012</td> <td>75,000</td> <td>3</td> </tr> <tr> <td>2219/840</td> <td>BANKES, DORIS</td> <td>01/11/2012</td> <td>0</td> <td>10</td> </tr> <tr> <td>1336/912</td> <td>WOFFORD, DONALD R &-BEVERLY J</td> <td>11/30/2001</td> <td>7,500</td> <td>11</td> </tr> </tbody> </table>					Bk/Pg	Grantor	Date	Price	Code	/	MITCHELL, TODD BLAINE	02/14/2025	340,000	YES	/	BROOKS, JEFFERY M	10/20/2022	252,500	YES	2600/553	NELSON, STEVEN A	12/16/2016	182,000	YES	2248/820	LAKESIDE STATE BANK	06/04/2012	75,000	3	2219/840	BANKES, DORIS	01/11/2012	0	10	1336/912	WOFFORD, DONALD R &-BEVERLY J	11/30/2001	7,500	11																																																														
Code	Type	Active	Maximum	Exemption																																																																																																																					
H	Homestead	No	1,000																																																																																																																						
H	Homestead	No	1,000																																																																																																																						
Bk/Pg	Grantor	Date	Price	Code																																																																																																																					
/	MITCHELL, TODD BLAINE	02/14/2025	340,000	YES																																																																																																																					
/	BROOKS, JEFFERY M	10/20/2022	252,500	YES																																																																																																																					
2600/553	NELSON, STEVEN A	12/16/2016	182,000	YES																																																																																																																					
2248/820	LAKESIDE STATE BANK	06/04/2012	75,000	3																																																																																																																					
2219/840	BANKES, DORIS	01/11/2012	0	10																																																																																																																					
1336/912	WOFFORD, DONALD R &-BEVERLY J	11/30/2001	7,500	11																																																																																																																					
Parcel Valuation <table border="1"> <thead> <tr> <th>Source</th> <th>REAL</th> <th>Fair Cash</th> <th>Capped</th> <th>Asmnt Level</th> <th>Assessed</th> <th>Levy Rate</th> <th>108.182</th> <th>Current Tax</th> </tr> </thead> <tbody> <tr> <td>Remove Cap</td> <td>2026</td> <td>Land Value 96,470</td> <td>96,470</td> <td>11%</td> <td>10,612</td> <td>Assessed</td> <td>37,482</td> <td>4,054.86</td> </tr> <tr> <td>Year Frozen</td> <td>0</td> <td>Improvements 244,275</td> <td>244,275</td> <td> </td> <td>26,870</td> <td>Penalty</td> <td>0</td> <td> </td> </tr> <tr> <td>Uncapped Value</td> <td>0</td> <td>Mobile Home 0</td> <td>0</td> <td> </td> <td>0</td> <td>Exemption</td> <td>0</td> <td>0.00</td> </tr> <tr> <td>TIF Project ID</td> <td>0</td> <td>Total Value 340,745</td> <td>340,745</td> <td> </td> <td>37,482</td> <td>Total Taxable</td> <td>37,482</td> <td>4,055.00</td> </tr> </tbody> </table>										Source	REAL	Fair Cash	Capped	Asmnt Level	Assessed	Levy Rate	108.182	Current Tax	Remove Cap	2026	Land Value 96,470	96,470	11%	10,612	Assessed	37,482	4,054.86	Year Frozen	0	Improvements 244,275	244,275		26,870	Penalty	0		Uncapped Value	0	Mobile Home 0	0		0	Exemption	0	0.00	TIF Project ID	0	Total Value 340,745	340,745		37,482	Total Taxable	37,482	4,055.00																																																																			
Source	REAL	Fair Cash	Capped	Asmnt Level	Assessed	Levy Rate	108.182	Current Tax																																																																																																																	
Remove Cap	2026	Land Value 96,470	96,470	11%	10,612	Assessed	37,482	4,054.86																																																																																																																	
Year Frozen	0	Improvements 244,275	244,275		26,870	Penalty	0																																																																																																																		
Uncapped Value	0	Mobile Home 0	0		0	Exemption	0	0.00																																																																																																																	
TIF Project ID	0	Total Value 340,745	340,745		37,482	Total Taxable	37,482	4,055.00																																																																																																																	
Assessment History <table border="1"> <thead> <tr> <th>Tax Year</th> <th>Statement Number</th> <th>Billed Owner</th> <th>Tax Area</th> <th>Total Value</th> <th>Exemptions</th> <th>Taxable Value</th> <th>Billed Tax</th> </tr> </thead> <tbody> <tr><td>2025</td><td>2025-660078921</td><td>SHOOK, ALYSSA & DALTON</td><td>10</td><td>254,585</td><td>1000</td><td>27,004</td><td>2,935.00</td></tr> <tr><td>2024</td><td>2024-660078921</td><td>MITCHELL, TODD BLAINE</td><td>10</td><td>265,766</td><td>1000</td><td>27,608</td><td>2,906.00</td></tr> <tr><td>2023</td><td>2023-660078921</td><td>MITCHELL, TODD BLAINE</td><td>10</td><td>252,500</td><td>1000</td><td>26,775</td><td>2,798.00</td></tr> <tr><td>2022</td><td>2022-660078921</td><td>BROOKS, JEFFERY M</td><td>10</td><td>210,156</td><td>1000</td><td>21,255</td><td>2,214.00</td></tr> <tr><td>2021</td><td>2021-660078921</td><td>BROOKS, JEFFERY M</td><td>10</td><td>199,602</td><td>1000</td><td>20,606</td><td>2,162.00</td></tr> <tr><td>2020</td><td>2020-660078921</td><td>BROOKS, JEFFERY M</td><td>10</td><td>193,039</td><td>1000</td><td>19,978</td><td>2,128.00</td></tr> <tr><td>2019</td><td>2019-660078921</td><td>BROOKS, JEFFERY M & JAMIE L</td><td>10</td><td>185,149</td><td>1000</td><td>19,367</td><td>2,024.00</td></tr> <tr><td>2018</td><td>2018-660078921</td><td>BROOKS, JEFFERY M & JAMIE L</td><td>10</td><td>189,895</td><td>1000</td><td>19,775</td><td>2,138.00</td></tr> <tr><td>2017</td><td>2017-660078921</td><td>BROOKS, JEFFERY M & JAMIE L</td><td>10</td><td>183,365</td><td>1000</td><td>19,170</td><td>2,193.00</td></tr> <tr><td>2016</td><td>2016-660078921</td><td>NELSON, STEVEN A</td><td>10</td><td>85,682</td><td>0</td><td>9,425</td><td>976.00</td></tr> <tr><td>2015</td><td>2015-660078921</td><td>NELSON, STEVEN A</td><td>10</td><td>84,215</td><td>0</td><td>9,264</td><td>907.00</td></tr> <tr><td>2014</td><td>2014-660078921</td><td>NELSON, STEVEN A</td><td>10</td><td>85,337</td><td>0</td><td>9,387</td><td>918.00</td></tr> <tr><td>2013</td><td>2013-660078921</td><td>NELSON, STEVEN A</td><td>10</td><td>83,469</td><td>0</td><td>9,182</td><td>868.00</td></tr> </tbody> </table>										Tax Year	Statement Number	Billed Owner	Tax Area	Total Value	Exemptions	Taxable Value	Billed Tax	2025	2025-660078921	SHOOK, ALYSSA & DALTON	10	254,585	1000	27,004	2,935.00	2024	2024-660078921	MITCHELL, TODD BLAINE	10	265,766	1000	27,608	2,906.00	2023	2023-660078921	MITCHELL, TODD BLAINE	10	252,500	1000	26,775	2,798.00	2022	2022-660078921	BROOKS, JEFFERY M	10	210,156	1000	21,255	2,214.00	2021	2021-660078921	BROOKS, JEFFERY M	10	199,602	1000	20,606	2,162.00	2020	2020-660078921	BROOKS, JEFFERY M	10	193,039	1000	19,978	2,128.00	2019	2019-660078921	BROOKS, JEFFERY M & JAMIE L	10	185,149	1000	19,367	2,024.00	2018	2018-660078921	BROOKS, JEFFERY M & JAMIE L	10	189,895	1000	19,775	2,138.00	2017	2017-660078921	BROOKS, JEFFERY M & JAMIE L	10	183,365	1000	19,170	2,193.00	2016	2016-660078921	NELSON, STEVEN A	10	85,682	0	9,425	976.00	2015	2015-660078921	NELSON, STEVEN A	10	84,215	0	9,264	907.00	2014	2014-660078921	NELSON, STEVEN A	10	85,337	0	9,387	918.00	2013	2013-660078921	NELSON, STEVEN A	10	83,469	0	9,182	868.00
Tax Year	Statement Number	Billed Owner	Tax Area	Total Value	Exemptions	Taxable Value	Billed Tax																																																																																																																		
2025	2025-660078921	SHOOK, ALYSSA & DALTON	10	254,585	1000	27,004	2,935.00																																																																																																																		
2024	2024-660078921	MITCHELL, TODD BLAINE	10	265,766	1000	27,608	2,906.00																																																																																																																		
2023	2023-660078921	MITCHELL, TODD BLAINE	10	252,500	1000	26,775	2,798.00																																																																																																																		
2022	2022-660078921	BROOKS, JEFFERY M	10	210,156	1000	21,255	2,214.00																																																																																																																		
2021	2021-660078921	BROOKS, JEFFERY M	10	199,602	1000	20,606	2,162.00																																																																																																																		
2020	2020-660078921	BROOKS, JEFFERY M	10	193,039	1000	19,978	2,128.00																																																																																																																		
2019	2019-660078921	BROOKS, JEFFERY M & JAMIE L	10	185,149	1000	19,367	2,024.00																																																																																																																		
2018	2018-660078921	BROOKS, JEFFERY M & JAMIE L	10	189,895	1000	19,775	2,138.00																																																																																																																		
2017	2017-660078921	BROOKS, JEFFERY M & JAMIE L	10	183,365	1000	19,170	2,193.00																																																																																																																		
2016	2016-660078921	NELSON, STEVEN A	10	85,682	0	9,425	976.00																																																																																																																		
2015	2015-660078921	NELSON, STEVEN A	10	84,215	0	9,264	907.00																																																																																																																		
2014	2014-660078921	NELSON, STEVEN A	10	85,337	0	9,387	918.00																																																																																																																		
2013	2013-660078921	NELSON, STEVEN A	10	83,469	0	9,182	868.00																																																																																																																		



Rogers

Assessment Property Record Card for Tax Year 2026

Data provided by LISA DELOZIER County Assessor

Date 04/18/2026
 Time 08:07:36
 Page 2

Lot Data		Square-Foot - NBHD 4020 #1
Lot Size		
Lot Count		
Units Buildable		
Non-Ag Acres	2.4317	
Topography	1	
Street Access		
Utilities		
Amenities	LAND QUALITY	0
		0
Method	Square-Foot	
Base Lot Value	105,926.00 x .61 = 64,893	
Factor Value		
Adjustments	1.4866	
Lot Value	96,470	



\\tsclient\C\Users\CB\Pictures\2020-06-01\IMG_0211.JPG 6/2/2020

Residential Data	
Type	1 Single Family Residence
Condition	3.5 - Average
Quality	3.5 - Average
Architecture	MTL METAL HOME
Style	100% 1 1/2 Story Finished
Exterior Wall	100% Frame, Siding, Metal
Base/Total Area	1,596 / 2,226
Style	100% 1 1/2 Story Finished
HVAC	100% Warmed & Cooled Air
Roof Cover	4 Metal, Preformed
Area on Slab	1,596
Fixture/RghIn	4 /
Bed/F/H Bath	3 / 2.0 /
Basement Area	
Garage Type	924 Attached Garage - Finished 2 Stalls
Remodel	
Year/Eff Age	2003 / 16

GRM Approach

GRM Code	
Gross Rent	0.00
Indicated Value	

Multiple Regression

MRA Code	1 Test
Adjusted R	0.8445
Indicated Value	326,069 146.48 Per SqFt

Direct Comparables

Selection Model	1 Res
Adjustment Model	A2 AO Test
Comparables	
Indicated Value	

Value Reconciliation

Selected Approach	Cost Approach
Improvements	244,275
Lot Value	96,470
Indicated Value	340,745 153.08 Per SqFt
Agland Value	
Site Improvements	
Total Value	340,745 153.08 Total Value Per SqFt

Cost Approach				Manual : 01/2025			
Base Cost	88.66	Total Misc Impr	+ 10,181				
Roofing Adj	+ 4.43	Garage Cost	+ 43,095				
Subfloor Adj	+ -2.44	Total RCN	= 294,307				
Heat/Cool Adj	+ 14.47	Depreciation (17%)	- 50,032				
Plumbing Adj	+ 3.16	Lump Sums	+ 0				
Basement Adj	+ 0.00	RCNLD	= 244,275				
Adj Base Cost	= 108.28	Lot Value	+ 96,470				
Total Area	x 2,226	Indicated Value	= 340,745				
Adjusted Cost	= 241,031	Value Per SqFt	153.08				

Miscellaneous Improvements

Code	Description	Sketch ID	Size	Year	Units	Unit Cost	Depr	Value
PRCH	SLAB PORCH - COVERED	131371	45x8		360	28.28		10,181



Rogers

Assessment Property Record Card for Tax Year 2026

Data provided by LISA DELOZIER County Assessor

Date 04/18/2026
 Time 08:07:36
 Page 3

Sketch Image

660078921

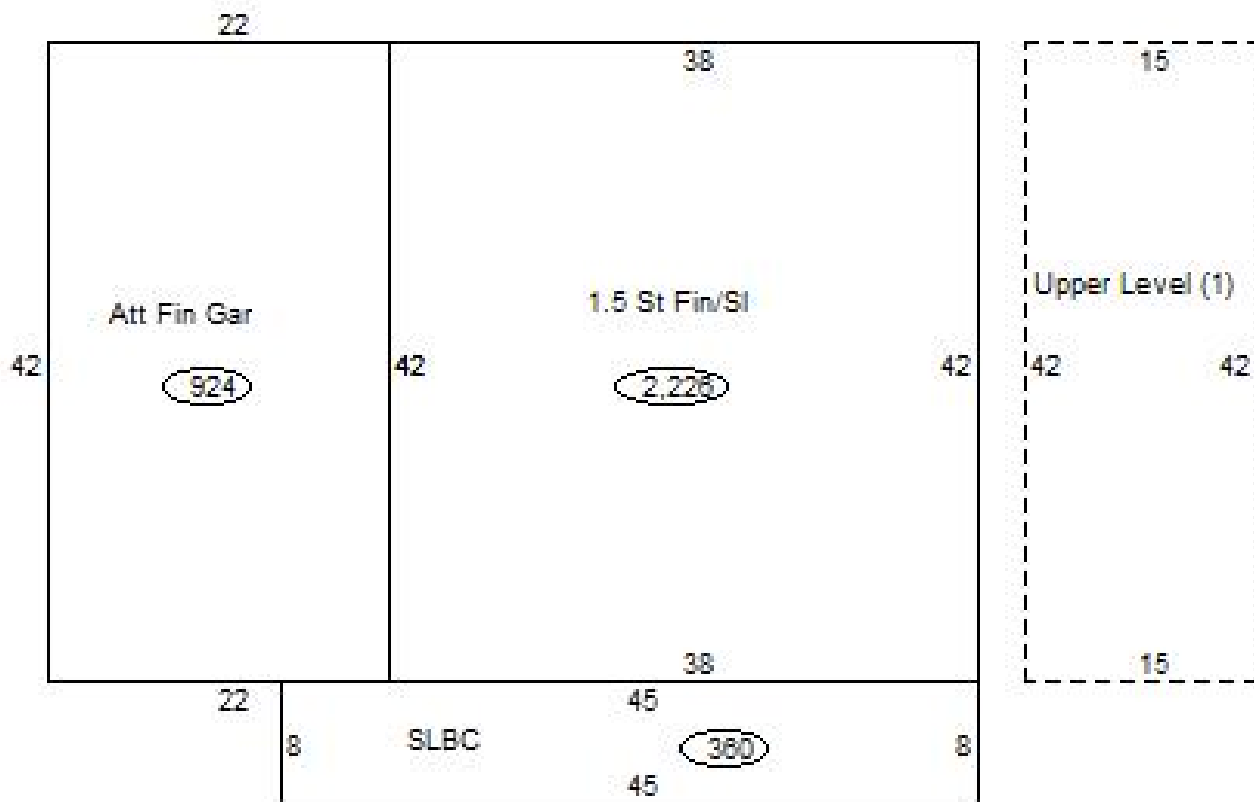

Sketch Vector Information

Sequence	Code	Type	Built Over	Scale	Section Label	Base Area	Multiplier	Total Area
1	R	5	Slab	20	1.5 St Fin/Sl	1,596	1.395	2,226
2	G	5		20	Att Fin Gar	924	1.000	924
3	M	PRCH		20	SLBC	360	1.000	360
4	U	^UL		20	Upper Level (1)	630	1.000	630
Total Building Area						1,596		2,226



Rogers

Assessment Property Record Card for Tax Year 2026

Data provided by LISA DELOZIER County Assessor

Date 04/18/2026
Time 08:07:36
Page 4

660078921

Outbuildings/Site Improvements

Building Image	Code	Description	Dimensions	Floor	Roofing	Total Units
	SHDS	Shed - Small	6x12x6	Plank	Formed Metal	72
	Qual	3	Cond 2	Year 2010	Eff Age 16	
Valuation Summary		Modifier Total		RCN Depr (52% Phys/ 100% Func) RCNLD		
Base Cost (32.07 x 72)		2,309		2,309		2,309