



# Rogers

## Assessment Property Record Card for Tax Year 2026

Data provided by LISA DELOZIER County Assessor

Date 04/18/2026  
Time 05:56:26  
Page 1

Assessment Data					Primary Image																																																																																																																				
<b>Account</b> 660078976 <b>Parcel ID</b> 000000-00-0-00811-001-0037 <b>Cadastral ID</b> 02-21-14-00748 <b>Property Type</b> REAL - Real Property <b>Property Class</b> RRP VI Area 4 <b>Tax Area</b> 7 - OWASSO/LIMESTONE FIRE <b>Name ID</b> 303258 DUFFIELD, BILL ZACHERY &  SAMI LYNN 16350 E 120TH ST N COLLINSVILLE OK 74021-0000																																																																																																																									
<b>Parcel Location</b> <b>Situs</b> 16350 E 120TH ST N <b>Subdivision</b> TALLGRASS TRAILS <b>Lot/Block</b> 0037 / 0001 <b>Parcel Size</b> 1 - Lots <b>Sec/Twn/Rng</b> 2 / 21 / 14 / 5 <b>Neighborhood</b> 1082 - R-V04-SW OWASSO <b>School District</b> S021 - OWASSO SCHOOLS																																																																																																																									
<b>Legal Description</b> Lot/Long: 36.32594824 -95.79111982					<b>Building Permits</b> <table border="1"> <thead> <tr> <th>Number</th> <th>Description</th> <th>Opened</th> <th>Closed</th> <th>Amount</th> </tr> </thead> <tbody> <tr> <td>WP2015 1 19</td> <td>R16-NEW POOL</td> <td>02/2015</td> <td>07/2015</td> <td></td> </tr> <tr> <td>9095</td> <td>R6 FOR NEW GARAGE/SHOP</td> <td>01/2005</td> <td>10/2005</td> <td>44,000</td> </tr> </tbody> </table>					Number	Description	Opened	Closed	Amount	WP2015 1 19	R16-NEW POOL	02/2015	07/2015		9095	R6 FOR NEW GARAGE/SHOP	01/2005	10/2005	44,000																																																																																																	
Number	Description	Opened	Closed	Amount																																																																																																																					
WP2015 1 19	R16-NEW POOL	02/2015	07/2015																																																																																																																						
9095	R6 FOR NEW GARAGE/SHOP	01/2005	10/2005	44,000																																																																																																																					
<b>Exemptions</b> <table border="1"> <thead> <tr> <th>Code</th> <th>Type</th> <th>Active</th> <th>Maximum</th> <th>Exemption</th> </tr> </thead> <tbody> <tr> <td>H</td> <td>Homestead</td> <td>Yes</td> <td>1,000</td> <td>1,000</td> </tr> </tbody> </table>					Code	Type	Active	Maximum	Exemption	H	Homestead	Yes	1,000	1,000	<b>Sale History</b> <table border="1"> <thead> <tr> <th>Bk/Pg</th> <th>Grantor</th> <th>Date</th> <th>Price</th> <th>Code</th> </tr> </thead> <tbody> <tr> <td>2116/846</td> <td>RANDALL, DAVID M</td> <td>07/27/2010</td> <td>375,000</td> <td>YES</td> </tr> <tr> <td>1709/925</td> <td>XITE CUSTOM HOMES II LLC</td> <td>09/07/2005</td> <td>329,000</td> <td>YES</td> </tr> <tr> <td>1684/174</td> <td>XITE HOMES LLC</td> <td>05/31/2005</td> <td>0</td> <td>5</td> </tr> <tr> <td>1628/119</td> <td>O L T DEVELOPMENT LLC</td> <td>10/12/2004</td> <td>30,000</td> <td>YES</td> </tr> </tbody> </table>					Bk/Pg	Grantor	Date	Price	Code	2116/846	RANDALL, DAVID M	07/27/2010	375,000	YES	1709/925	XITE CUSTOM HOMES II LLC	09/07/2005	329,000	YES	1684/174	XITE HOMES LLC	05/31/2005	0	5	1628/119	O L T DEVELOPMENT LLC	10/12/2004	30,000	YES																																																																													
Code	Type	Active	Maximum	Exemption																																																																																																																					
H	Homestead	Yes	1,000	1,000																																																																																																																					
Bk/Pg	Grantor	Date	Price	Code																																																																																																																					
2116/846	RANDALL, DAVID M	07/27/2010	375,000	YES																																																																																																																					
1709/925	XITE CUSTOM HOMES II LLC	09/07/2005	329,000	YES																																																																																																																					
1684/174	XITE HOMES LLC	05/31/2005	0	5																																																																																																																					
1628/119	O L T DEVELOPMENT LLC	10/12/2004	30,000	YES																																																																																																																					
<b>Parcel Valuation</b> <table border="1"> <thead> <tr> <th>Source</th> <th>REAL</th> <th>Fair Cash</th> <th>Capped</th> <th>Asmnt Level</th> <th>Assessed</th> <th>Levy Rate</th> <th>108.538</th> <th>Current Tax</th> </tr> </thead> <tbody> <tr> <td>Remove Cap</td> <td>2011</td> <td>Land Value 96,189</td> <td>68,826</td> <td>11%</td> <td>7,571</td> <td>Assessed</td> <td>53,237</td> <td>5,778.24</td> </tr> <tr> <td>Year Frozen</td> <td>0</td> <td>Improvements 416,787</td> <td>415,147</td> <td></td> <td>45,666</td> <td>Penalty</td> <td>0</td> <td></td> </tr> <tr> <td>Uncapped Value</td> <td>0</td> <td>Mobile Home 0</td> <td>0</td> <td></td> <td>0</td> <td>Exemption</td> <td>1,000</td> <td>-97.00</td> </tr> <tr> <td>TIF Project ID</td> <td>0</td> <td>Total Value 512,976</td> <td>483,973</td> <td></td> <td>53,237</td> <td>Total Taxable</td> <td>52,237</td> <td>5,681.00</td> </tr> </tbody> </table>										Source	REAL	Fair Cash	Capped	Asmnt Level	Assessed	Levy Rate	108.538	Current Tax	Remove Cap	2011	Land Value 96,189	68,826	11%	7,571	Assessed	53,237	5,778.24	Year Frozen	0	Improvements 416,787	415,147		45,666	Penalty	0		Uncapped Value	0	Mobile Home 0	0		0	Exemption	1,000	-97.00	TIF Project ID	0	Total Value 512,976	483,973		53,237	Total Taxable	52,237	5,681.00																																																																			
Source	REAL	Fair Cash	Capped	Asmnt Level	Assessed	Levy Rate	108.538	Current Tax																																																																																																																	
Remove Cap	2011	Land Value 96,189	68,826	11%	7,571	Assessed	53,237	5,778.24																																																																																																																	
Year Frozen	0	Improvements 416,787	415,147		45,666	Penalty	0																																																																																																																		
Uncapped Value	0	Mobile Home 0	0		0	Exemption	1,000	-97.00																																																																																																																	
TIF Project ID	0	Total Value 512,976	483,973		53,237	Total Taxable	52,237	5,681.00																																																																																																																	
<b>Assessment History</b> <table border="1"> <thead> <tr> <th>Tax Year</th> <th>Statement Number</th> <th>Billed Owner</th> <th>Tax Area</th> <th>Total Value</th> <th>Exemptions</th> <th>Taxable Value</th> <th>Billed Tax</th> </tr> </thead> <tbody> <tr><td>2025</td><td>2025-660078976</td><td>DUFFIELD, BILL ZACHERY &amp;</td><td>7</td><td>507,645</td><td>1000</td><td>50,687</td><td>5,512.00</td></tr> <tr><td>2024</td><td>2024-660078976</td><td>DUFFIELD, BILL ZACHERY &amp;</td><td>7</td><td>527,747</td><td>1000</td><td>49,181</td><td>5,442.00</td></tr> <tr><td>2023</td><td>2023-660078976</td><td>DUFFIELD, BILL ZACHERY &amp;</td><td>7</td><td>489,740</td><td>1000</td><td>47,720</td><td>5,168.00</td></tr> <tr><td>2022</td><td>2022-660078976</td><td>DUFFIELD, BILL ZACHERY &amp;</td><td>7</td><td>461,172</td><td>1000</td><td>46,301</td><td>5,211.00</td></tr> <tr><td>2021</td><td>2021-660078976</td><td>DUFFIELD, BILL ZACHERY &amp;</td><td>7</td><td>419,421</td><td>1000</td><td>44,923</td><td>5,002.00</td></tr> <tr><td>2020</td><td>2020-660078976</td><td>DUFFIELD, BILL ZACHERY &amp;</td><td>7</td><td>412,187</td><td>1000</td><td>43,585</td><td>4,847.00</td></tr> <tr><td>2019</td><td>2019-660078976</td><td>DUFFIELD, BILL ZACHERY &amp;</td><td>7</td><td>393,517</td><td>1000</td><td>42,287</td><td>4,706.00</td></tr> <tr><td>2018</td><td>2018-660078976</td><td>DUFFIELD, BILL ZACHERY &amp;</td><td>7</td><td>401,397</td><td>1000</td><td>43,154</td><td>4,648.00</td></tr> <tr><td>2017</td><td>2017-660078976</td><td>DUFFIELD, BILL ZACHERY &amp;</td><td>7</td><td>395,706</td><td>1000</td><td>42,281</td><td>4,595.00</td></tr> <tr><td>2016</td><td>2016-660078976</td><td>DUFFIELD, BILL ZACHERY &amp;</td><td>7</td><td>396,932</td><td>1000</td><td>41,021</td><td>4,462.00</td></tr> <tr><td>2015</td><td>2015-660078976</td><td>DUFFIELD, BILL ZACHERY &amp;</td><td>7</td><td>370,880</td><td>1000</td><td>39,797</td><td>4,357.00</td></tr> <tr><td>2014</td><td>2014-660078976</td><td>DUFFIELD, BILL ZACHERY &amp;</td><td>7</td><td>373,907</td><td>1000</td><td>39,154</td><td>4,321.00</td></tr> <tr><td>2013</td><td>2013-660078976</td><td>DUFFIELD, BILL ZACHERY &amp;</td><td>7</td><td>354,402</td><td>1000</td><td>37,984</td><td>4,115.00</td></tr> </tbody> </table>										Tax Year	Statement Number	Billed Owner	Tax Area	Total Value	Exemptions	Taxable Value	Billed Tax	2025	2025-660078976	DUFFIELD, BILL ZACHERY &	7	507,645	1000	50,687	5,512.00	2024	2024-660078976	DUFFIELD, BILL ZACHERY &	7	527,747	1000	49,181	5,442.00	2023	2023-660078976	DUFFIELD, BILL ZACHERY &	7	489,740	1000	47,720	5,168.00	2022	2022-660078976	DUFFIELD, BILL ZACHERY &	7	461,172	1000	46,301	5,211.00	2021	2021-660078976	DUFFIELD, BILL ZACHERY &	7	419,421	1000	44,923	5,002.00	2020	2020-660078976	DUFFIELD, BILL ZACHERY &	7	412,187	1000	43,585	4,847.00	2019	2019-660078976	DUFFIELD, BILL ZACHERY &	7	393,517	1000	42,287	4,706.00	2018	2018-660078976	DUFFIELD, BILL ZACHERY &	7	401,397	1000	43,154	4,648.00	2017	2017-660078976	DUFFIELD, BILL ZACHERY &	7	395,706	1000	42,281	4,595.00	2016	2016-660078976	DUFFIELD, BILL ZACHERY &	7	396,932	1000	41,021	4,462.00	2015	2015-660078976	DUFFIELD, BILL ZACHERY &	7	370,880	1000	39,797	4,357.00	2014	2014-660078976	DUFFIELD, BILL ZACHERY &	7	373,907	1000	39,154	4,321.00	2013	2013-660078976	DUFFIELD, BILL ZACHERY &	7	354,402	1000	37,984	4,115.00
Tax Year	Statement Number	Billed Owner	Tax Area	Total Value	Exemptions	Taxable Value	Billed Tax																																																																																																																		
2025	2025-660078976	DUFFIELD, BILL ZACHERY &	7	507,645	1000	50,687	5,512.00																																																																																																																		
2024	2024-660078976	DUFFIELD, BILL ZACHERY &	7	527,747	1000	49,181	5,442.00																																																																																																																		
2023	2023-660078976	DUFFIELD, BILL ZACHERY &	7	489,740	1000	47,720	5,168.00																																																																																																																		
2022	2022-660078976	DUFFIELD, BILL ZACHERY &	7	461,172	1000	46,301	5,211.00																																																																																																																		
2021	2021-660078976	DUFFIELD, BILL ZACHERY &	7	419,421	1000	44,923	5,002.00																																																																																																																		
2020	2020-660078976	DUFFIELD, BILL ZACHERY &	7	412,187	1000	43,585	4,847.00																																																																																																																		
2019	2019-660078976	DUFFIELD, BILL ZACHERY &	7	393,517	1000	42,287	4,706.00																																																																																																																		
2018	2018-660078976	DUFFIELD, BILL ZACHERY &	7	401,397	1000	43,154	4,648.00																																																																																																																		
2017	2017-660078976	DUFFIELD, BILL ZACHERY &	7	395,706	1000	42,281	4,595.00																																																																																																																		
2016	2016-660078976	DUFFIELD, BILL ZACHERY &	7	396,932	1000	41,021	4,462.00																																																																																																																		
2015	2015-660078976	DUFFIELD, BILL ZACHERY &	7	370,880	1000	39,797	4,357.00																																																																																																																		
2014	2014-660078976	DUFFIELD, BILL ZACHERY &	7	373,907	1000	39,154	4,321.00																																																																																																																		
2013	2013-660078976	DUFFIELD, BILL ZACHERY &	7	354,402	1000	37,984	4,115.00																																																																																																																		



# Rogers

## Assessment Property Record Card for Tax Year 2026

Data provided by LISA DELOZIER County Assessor

Date 04/18/2026  
Time 05:56:26  
Page 2

Lot Data		Square-Foot - NBHD 1082 #1		Primary Image				
Lot Size								
Lot Count								
Units Buildable	1							
Non-Ag Acres	1.1164							
Topography								
Street Access								
Utilities								
Amenities	LAND QUALITY					0		
						0		
Method	Square-Foot							
Base Lot Value	48,630.00 x 1.98 = 96,189							
Factor Value								
Adjustments	1.0000							
Lot Value	96,189							
<b>Residential Data</b>				\\tsclient\C\TOMS PC PICS\2018-02-13 02-13-2018\02-13-2018 09 2/14/2018				
Type	1 Single Family Residence							
Condition	3 - Average							
Quality	3.5 - Average							
Architecture								
Style	100% 1 1/2 Story Finished							
Exterior Wall	100% Veneer, Masonry							
Base/Total Area	1,868 / 2,950							
Style	100% 1 1/2 Story Finished							
HVAC	100% Warmed & Cooled Air							
Roof Cover	1 Composition Shingle							
Area on Slab	1,868							
Fixture/RghIn	14 /							
Bed/F/H Bath	3 / 2.5 /							
Basement Area								
Garage Type	552 Attached Garage - Unfinished							
Remodel								
Year/Eff Age	2005 / 16							
<b>Cost Approach</b>		<b>Manual : 01/2025</b>						
Base Cost	97.33	Total Misc Impr	+ 14,473					
Roofing Adj	+ 3.46	Garage Cost	+ 21,495					
Subfloor Adj	+ -2.20	Total RCN	= 391,856					
Heat/Cool Adj	+ 14.47	Depreciation ( 17%)	- 66,616					
Plumbing Adj	+ 7.58	Lump Sums	+ 3,828					
Basement Adj	+ 0.00	RCNLD	= 329,068					
Adj Base Cost	= 120.64	Lot Value	+ 96,189					
Total Area	x 2,950	Indicated Value	= 425,257					
Adjusted Cost	= 355,888	Value Per SqFt	144.15					
<b>Miscellaneous Improvements</b>				<b>Value Reconciliation</b>				
Code	Description	Sketch ID	Size	Year	Units	Unit Cost	Depr	Value
FPR1	FIREPLACE - RESIDENTIAL 1 STORY	0		1	1	6,429.63		6,430
BALW	BALCONY - WOOD	94170	11x11		121	31.64		3,828
PRCH	SLAB PORCH - COVERED	94171	161		161	28.96		4,663
PRCH	SLAB PORCH - COVERED	94172	116		116	29.14		3,380
				<b>GRM Approach</b>				
				GRM Code				
				Gross Rent				
				Indicated Value				
				0.00				
				<b>Multiple Regression</b>				
				MRA Code				
				Adusted R				
				Indicated Value				
				445,470 151.01 Per SqFt				
				<b>Direct Comparables</b>				
				Selection Model				
				Adjustment Model				
				Comparables				
				Indicated Value				
				533,200 Per SqFt				
				<b>Value Reconciliation</b>				
				Selected Approach				
				Improvements				
				Lot Value				
				Indicated Value				
				425,257 144.15 Per SqFt				
				Agland Value				
				Site Improvements				
				Total Value				
				512,976 173.89 Total Value Per SqFt				



# Rogers

## Assessment Property Record Card for Tax Year 2026

Data provided by LISA DELOZIER County Assessor

Date 04/18/2026

Time 05:56:27

Page 3

### Sketch Image

660078976

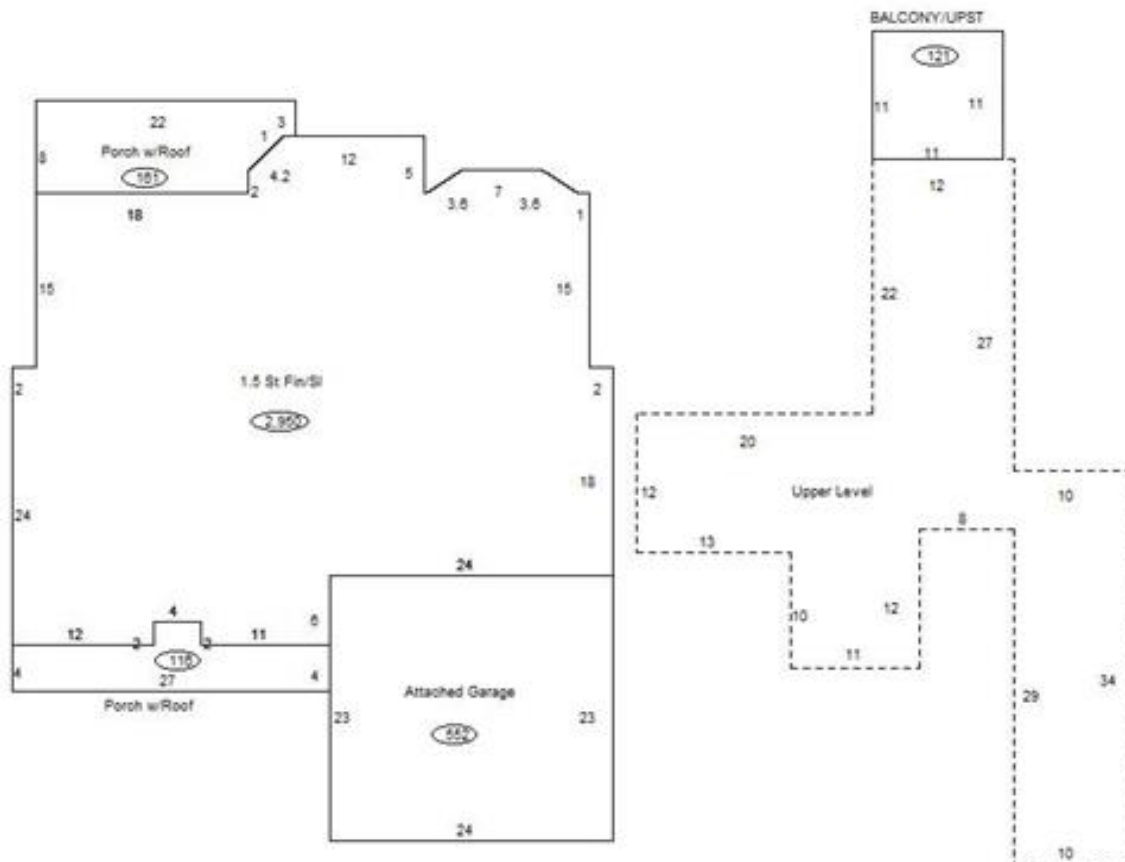

### Sketch Vector Information

Sequence	Code	Type	Built Over	Scale	Section Label	Base Area	Multiplier	Total Area
1	R	5	Slab	13	1.5 St Fin/SI	1,868	1.579	2,950
2	U	^UL	Overhang	13	Upper Level	1,082	1.000	1,082
3	G	1		13	Attached Garage	552	1.000	552
4	M	BALW		13	Balcony	121	1.000	121
5	M	PRCH		13	SLBC	161	1.000	161
6	M	PRCH		13	SLBC	116	1.000	116
<b>Total Building Area</b>						1,868		2,950



# Rogers



## Assessment Property Record Card for Tax Year 2026

Data provided by LISA DELOZIER County Assessor

Date 04/18/2026  
 Time 05:56:27  
 Page 4

660078976

### Outbuildings/Site Improvements

Building Image	Code	Description	Dimensions	Floor	Roofing	Total Units	
	SG	SWIM-GUNITE	0x0x0			1	
	Qual	3	Cond 4	Year	Eff Age 7		
	<b>Valuation Summary</b>		<b>Modifier Total</b>	<b>RCN</b>	<b>Depr (39% Phys/ % Func)</b>	<b>RCNLD</b>	
		Base Cost (30,000.00 x 1)	30,000		30,000	11,700	18,300
	GRDT	GARAGE - DETACHED	0x0x0			1,925	
	Qual	4	Cond 3	Year	Eff Age		
	<b>Valuation Summary</b>		<b>Modifier Total</b>	<b>RCN</b>	<b>Depr (5% Phys/ % Func)</b>	<b>RCNLD</b>	
		Base Cost (37.96 x 1,925)	73,073		73,073	3,654	69,419
	STF	STG FAIR	0x0x0				
	Qual		Cond	Year	Eff Age		
	<b>Valuation Summary</b>		<b>Modifier Total</b>	<b>RCN</b>	<b>Depr (100% Phys/ % Func)</b>	<b>RCNLD</b>	
		Base Cost (4.68 x )					