



Rogers

Assessment Property Record Card for Tax Year 2026

Data provided by LISA DELOZIER County Assessor

Date 04/18/2026
 Time 07:20:51
 Page 1

Assessment Data					Primary Image																																																																																																																				
Account 660079710 Parcel ID 000000-00-0-20112-001-0018 Cadastral ID 20-20-15-05780 Property Type REAL - Real Property Property Class URP VI Area 3 Tax Area 1 - CATOOSA OT Name ID 308499 KUNDYSEK, CLINT & TRACI 2926 WINDSOR ST CATOOSA OK 74015-0000 Parcel Location Situs 02926 WINDSOR ST Subdivision RIDGEWOOD VILLAGE Lot/Block 0018 / 0001 Parcel Size 1 - Lots Sec/Twn/Rng 20 / 20 / 15 / 5 Neighborhood 1188 - R-V03-SW CATOOSA School District S002 - CATOOSA SCHOOLS					<p>660079710_001.JPG 11/3/2025</p>																																																																																																																				
Legal Description Lot/Long: 36.20000696 -95.73504936																																																																																																																									
Building Permits					<table border="1"> <thead> <tr> <th>Number</th> <th>Description</th> <th>Opened</th> <th>Closed</th> <th>Amount</th> </tr> </thead> <tbody> <tr> <td>2028</td> <td>R6-NEW SFR</td> <td>11/2004</td> <td>12/2005</td> <td>275,000</td> </tr> </tbody> </table>					Number	Description	Opened	Closed	Amount	2028	R6-NEW SFR	11/2004	12/2005	275,000																																																																																																						
Number	Description	Opened	Closed	Amount																																																																																																																					
2028	R6-NEW SFR	11/2004	12/2005	275,000																																																																																																																					
Exemptions					Sale History																																																																																																																				
<table border="1"> <thead> <tr> <th>Code</th> <th>Type</th> <th>Active</th> <th>Maximum</th> <th>Exemption</th> </tr> </thead> <tbody> <tr> <td>H</td> <td>Homestead</td> <td>Yes</td> <td>1,000</td> <td>1,000</td> </tr> </tbody> </table>					Code	Type	Active	Maximum	Exemption	H	Homestead	Yes	1,000	1,000	<table border="1"> <thead> <tr> <th>Bk/Pg</th> <th>Grantor</th> <th>Date</th> <th>Price</th> <th>Code</th> </tr> </thead> <tbody> <tr> <td>2282/828</td> <td>DEUTSCHE BANK NATIONAL TRUST C</td> <td>09/28/2012</td> <td>237,500</td> <td>3</td> </tr> <tr> <td>2183/20</td> <td>HENSLEY, BRIAN P</td> <td>07/07/2011</td> <td>0</td> <td>10</td> </tr> <tr> <td>1741/91</td> <td>HISEL, RANDAL R &</td> <td>12/21/2005</td> <td>357,000</td> <td>YES</td> </tr> <tr> <td>1634/691</td> <td>TRINITY DEVELOPMENT CO LLC</td> <td>11/09/2004</td> <td>45,000</td> <td>YES</td> </tr> </tbody> </table>					Bk/Pg	Grantor	Date	Price	Code	2282/828	DEUTSCHE BANK NATIONAL TRUST C	09/28/2012	237,500	3	2183/20	HENSLEY, BRIAN P	07/07/2011	0	10	1741/91	HISEL, RANDAL R &	12/21/2005	357,000	YES	1634/691	TRINITY DEVELOPMENT CO LLC	11/09/2004	45,000	YES																																																																													
Code	Type	Active	Maximum	Exemption																																																																																																																					
H	Homestead	Yes	1,000	1,000																																																																																																																					
Bk/Pg	Grantor	Date	Price	Code																																																																																																																					
2282/828	DEUTSCHE BANK NATIONAL TRUST C	09/28/2012	237,500	3																																																																																																																					
2183/20	HENSLEY, BRIAN P	07/07/2011	0	10																																																																																																																					
1741/91	HISEL, RANDAL R &	12/21/2005	357,000	YES																																																																																																																					
1634/691	TRINITY DEVELOPMENT CO LLC	11/09/2004	45,000	YES																																																																																																																					
Parcel Valuation																																																																																																																									
<table border="1"> <thead> <tr> <th>Source</th> <th>REAL</th> <th>Fair Cash</th> <th>Capped</th> <th>Asmnt Level</th> <th>Assessed</th> <th>Levy Rate</th> <th>106.660</th> <th>Current Tax</th> </tr> </thead> <tbody> <tr> <td>Remove Cap</td> <td>2013</td> <td>Land Value</td> <td>31,847</td> <td>21,500</td> <td>11%</td> <td>2,365</td> <td>Assessed</td> <td>34,900</td> <td>3,722.43</td> </tr> <tr> <td>Year Frozen</td> <td>0</td> <td>Improvements</td> <td>314,096</td> <td>295,777</td> <td></td> <td>32,535</td> <td>Penalty</td> <td>0</td> <td></td> </tr> <tr> <td>Uncapped Value</td> <td>0</td> <td>Mobile Home</td> <td>0</td> <td>0</td> <td></td> <td>0</td> <td>Exemption</td> <td>1,000</td> <td>-106.00</td> </tr> <tr> <td>TIF Project ID</td> <td>0</td> <td>Total Value</td> <td>345,943</td> <td>317,277</td> <td></td> <td>34,900</td> <td>Total Taxable</td> <td>33,900</td> <td>3,616.00</td> </tr> </tbody> </table>		Source	REAL	Fair Cash	Capped	Asmnt Level	Assessed	Levy Rate	106.660	Current Tax	Remove Cap	2013	Land Value	31,847	21,500	11%	2,365	Assessed	34,900	3,722.43	Year Frozen	0	Improvements	314,096	295,777		32,535	Penalty	0		Uncapped Value	0	Mobile Home	0	0		0	Exemption	1,000	-106.00	TIF Project ID	0	Total Value	345,943	317,277		34,900	Total Taxable	33,900	3,616.00																																																																							
Source	REAL	Fair Cash	Capped	Asmnt Level	Assessed	Levy Rate	106.660	Current Tax																																																																																																																	
Remove Cap	2013	Land Value	31,847	21,500	11%	2,365	Assessed	34,900	3,722.43																																																																																																																
Year Frozen	0	Improvements	314,096	295,777		32,535	Penalty	0																																																																																																																	
Uncapped Value	0	Mobile Home	0	0		0	Exemption	1,000	-106.00																																																																																																																
TIF Project ID	0	Total Value	345,943	317,277		34,900	Total Taxable	33,900	3,616.00																																																																																																																
Assessment History																																																																																																																									
<table border="1"> <thead> <tr> <th>Tax Year</th> <th>Statement Number</th> <th>Billed Owner</th> <th>Tax Area</th> <th>Total Value</th> <th>Exemptions</th> <th>Taxable Value</th> <th>Billed Tax</th> </tr> </thead> <tbody> <tr><td>2025</td><td>2025-660079710</td><td>KUNDYSEK, CLINT & TRACI</td><td>1</td><td>330,349</td><td>1000</td><td>32,884</td><td>3,507.00</td></tr> <tr><td>2024</td><td>2024-660079710</td><td>KUNDYSEK, CLINT & TRACI</td><td>1</td><td>337,386</td><td>1000</td><td>31,897</td><td>3,365.00</td></tr> <tr><td>2023</td><td>2023-660079710</td><td>KUNDYSEK, CLINT & TRACI</td><td>1</td><td>315,232</td><td>1000</td><td>30,939</td><td>3,175.00</td></tr> <tr><td>2022</td><td>2022-660079710</td><td>KUNDYSEK, CLINT & TRACI</td><td>1</td><td>289,688</td><td>1000</td><td>30,009</td><td>3,012.00</td></tr> <tr><td>2021</td><td>2021-660079710</td><td>KUNDYSEK, CLINT & TRACI</td><td>1</td><td>273,689</td><td>1000</td><td>29,106</td><td>2,561.00</td></tr> <tr><td>2020</td><td>2020-660079710</td><td>KUNDYSEK, CLINT & TRACI</td><td>1</td><td>269,192</td><td>1000</td><td>28,611</td><td>2,534.00</td></tr> <tr><td>2019</td><td>2019-660079710</td><td>KUNDYSEK, CLINT & TRACI</td><td>1</td><td>267,410</td><td>1000</td><td>28,415</td><td>2,552.00</td></tr> <tr><td>2018</td><td>2018-660079710</td><td>KUNDYSEK, CLINT & TRACI</td><td>1</td><td>274,863</td><td>1000</td><td>29,235</td><td>2,610.00</td></tr> <tr><td>2017</td><td>2017-660079710</td><td>KUNDYSEK, CLINT & TRACI</td><td>1</td><td>272,570</td><td>1000</td><td>28,970</td><td>2,616.00</td></tr> <tr><td>2016</td><td>2016-660079710</td><td>KUNDYSEK, CLINT & TRACI</td><td>1</td><td>265,353</td><td>1000</td><td>28,098</td><td>2,499.00</td></tr> <tr><td>2015</td><td>2015-660079710</td><td>KUNDYSEK, CLINT & TRACI</td><td>1</td><td>256,820</td><td>1000</td><td>27,250</td><td>2,436.00</td></tr> <tr><td>2014</td><td>2014-660079710</td><td>KUNDYSEK, CLINT & TRACI</td><td>1</td><td>259,408</td><td>1000</td><td>27,535</td><td>2,491.00</td></tr> <tr><td>2013</td><td>2013-660079710</td><td>KUNDYSEK, CLINT & TRACI</td><td>1</td><td>279,804</td><td>1000</td><td>29,778</td><td>2,665.00</td></tr> </tbody> </table>										Tax Year	Statement Number	Billed Owner	Tax Area	Total Value	Exemptions	Taxable Value	Billed Tax	2025	2025-660079710	KUNDYSEK, CLINT & TRACI	1	330,349	1000	32,884	3,507.00	2024	2024-660079710	KUNDYSEK, CLINT & TRACI	1	337,386	1000	31,897	3,365.00	2023	2023-660079710	KUNDYSEK, CLINT & TRACI	1	315,232	1000	30,939	3,175.00	2022	2022-660079710	KUNDYSEK, CLINT & TRACI	1	289,688	1000	30,009	3,012.00	2021	2021-660079710	KUNDYSEK, CLINT & TRACI	1	273,689	1000	29,106	2,561.00	2020	2020-660079710	KUNDYSEK, CLINT & TRACI	1	269,192	1000	28,611	2,534.00	2019	2019-660079710	KUNDYSEK, CLINT & TRACI	1	267,410	1000	28,415	2,552.00	2018	2018-660079710	KUNDYSEK, CLINT & TRACI	1	274,863	1000	29,235	2,610.00	2017	2017-660079710	KUNDYSEK, CLINT & TRACI	1	272,570	1000	28,970	2,616.00	2016	2016-660079710	KUNDYSEK, CLINT & TRACI	1	265,353	1000	28,098	2,499.00	2015	2015-660079710	KUNDYSEK, CLINT & TRACI	1	256,820	1000	27,250	2,436.00	2014	2014-660079710	KUNDYSEK, CLINT & TRACI	1	259,408	1000	27,535	2,491.00	2013	2013-660079710	KUNDYSEK, CLINT & TRACI	1	279,804	1000	29,778	2,665.00
Tax Year	Statement Number	Billed Owner	Tax Area	Total Value	Exemptions	Taxable Value	Billed Tax																																																																																																																		
2025	2025-660079710	KUNDYSEK, CLINT & TRACI	1	330,349	1000	32,884	3,507.00																																																																																																																		
2024	2024-660079710	KUNDYSEK, CLINT & TRACI	1	337,386	1000	31,897	3,365.00																																																																																																																		
2023	2023-660079710	KUNDYSEK, CLINT & TRACI	1	315,232	1000	30,939	3,175.00																																																																																																																		
2022	2022-660079710	KUNDYSEK, CLINT & TRACI	1	289,688	1000	30,009	3,012.00																																																																																																																		
2021	2021-660079710	KUNDYSEK, CLINT & TRACI	1	273,689	1000	29,106	2,561.00																																																																																																																		
2020	2020-660079710	KUNDYSEK, CLINT & TRACI	1	269,192	1000	28,611	2,534.00																																																																																																																		
2019	2019-660079710	KUNDYSEK, CLINT & TRACI	1	267,410	1000	28,415	2,552.00																																																																																																																		
2018	2018-660079710	KUNDYSEK, CLINT & TRACI	1	274,863	1000	29,235	2,610.00																																																																																																																		
2017	2017-660079710	KUNDYSEK, CLINT & TRACI	1	272,570	1000	28,970	2,616.00																																																																																																																		
2016	2016-660079710	KUNDYSEK, CLINT & TRACI	1	265,353	1000	28,098	2,499.00																																																																																																																		
2015	2015-660079710	KUNDYSEK, CLINT & TRACI	1	256,820	1000	27,250	2,436.00																																																																																																																		
2014	2014-660079710	KUNDYSEK, CLINT & TRACI	1	259,408	1000	27,535	2,491.00																																																																																																																		
2013	2013-660079710	KUNDYSEK, CLINT & TRACI	1	279,804	1000	29,778	2,665.00																																																																																																																		



Rogers

Assessment Property Record Card for Tax Year 2026

Data provided by LISA DELOZIER County Assessor

Date 04/18/2026
Time 07:20:51
Page 2

Lot Data		Square-Foot - NBHD 1188 #1		Primary Image				
Lot Size								
Lot Count	1							
Units Buildable	1							
Non-Ag Acres	0.3323							
Topography								
Street Access								
Utilities								
Amenities		0						
		0						
Method	Square-Foot							
Base Lot Value	14,476.00 x 2.20 = 31,847			660079710_001.JPG 11/3/2025				
Factor Value				GRM Approach				
Adjustments	1.0000			GRM Code				
Lot Value	31,847			Gross Rent 0.00				
Residential Data				Indicated Value				
Type	1 Single Family Residence			Multiple Regression				
Condition	3 - Average			MRA Code 1 Test				
Quality	3.5 - Average			Adusted R 0.8445				
Architecture	TRAD TRADITIONAL			Indicated Value 358,604 125.43 Per SqFt				
Style	100% 1 1/2 Story Finished			Direct Comparables				
Exterior Wall	10% Veneer, Stone 90% Frame, Stucco			Selection Model A Adam Test				
Base/Total Area	2,196 / 2,859			Adjustment Model 1 2022 Residential				
Style	100% 1 1/2 Story Finished			Comparables 8				
HVAC	100% Warmed & Cooled Air			Indicated Value 354,010 Per SqFt				
Roof Cover	1 Composition Shingle			Value Reconciliation				
Area on Slab	2,196			Selected Approach Cost Approach				
Fixture/RghIn	16 /			Improvements 314,096				
Bed/F/H Bath	4 / 3.0 /			Lot Value 31,847				
Basement Area				Indicated Value 345,943 121.00 Per SqFt				
Garage Type	649 Attached Garage - Finished 2 Stalls			Agland Value				
Remodel				Site Improvements				
Year/Eff Age	2005 / 16			Total Value 345,943 121.00 Total Value Per SqFt				
Cost Approach		Manual : 01/2025						
Base Cost	93.91	Total Misc Impr	+ 17,651					
Roofing Adj	+ 4.04	Garage Cost	+ 30,730					
Subfloor Adj	+ -2.61	Total RCN	= 387,773					
Heat/Cool Adj	+ 14.47	Depreciation (19%)	- 73,677					
Plumbing Adj	+ 8.90	Lump Sums	+ 0					
Basement Adj	+ 0.00	RCNLD	= 314,096					
Adj Base Cost	= 118.71	Lot Value	+ 31,847					
Total Area	x 2,859	Indicated Value	= 345,943					
Adjusted Cost	= 339,392	Value Per SqFt	121.00					
Miscellaneous Improvements								
Code	Description	Sketch ID	Size	Year	Units	Unit Cost	Depr	Value
FPR1	FIREPLACE - RESIDENTIAL 1 STORY	0		1	1	6,429.63		6,430
PRCH	SLAB PORCH - COVERED	96203	7x3		21	29.46		619
PRCH	SLAB PORCH - COVERED	96204	21x13		273	28.56		7,797
PRCH	SLAB PORCH - COVERED	96205	12x8		96	29.22		2,805



Rogers
Assessment Property Record Card for Tax Year 2026
 Data provided by LISA DELOZIER County Assessor

Date 04/18/2026
 Time 07:20:51
 Page 3

Sketch Image

660079710

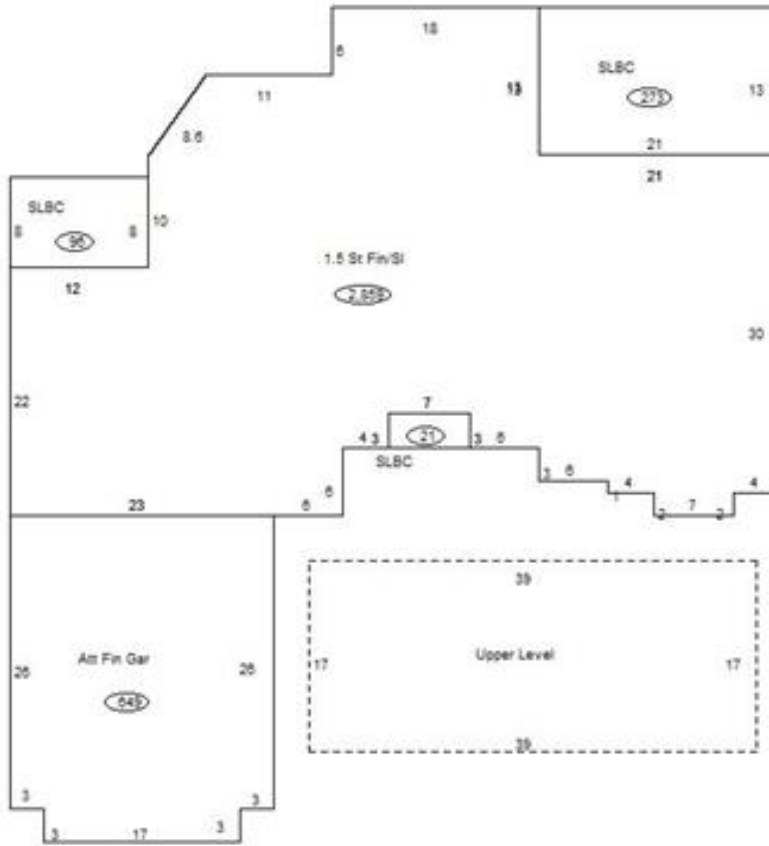

Sketch Vector Information

Sequence	Code	Type	Built Over	Scale	Section Label	Base Area	Multiplier	Total Area
1	R	5	Slab	13	1.5 St Fin/SI	2,196	1.302	2,859
2	U	^UL	Overhang	13	Upper Level	663	1.000	663
3	G	5		13	Att Fin Gar	649	1.000	649
4	M	PRCH		13	SLBC	21	1.000	21
5	M	PRCH		13	SLBC	273	1.000	273
6	M	PRCH		13	SLBC	96	1.000	96
Total Building Area						2,196		2,859