



Rogers

Assessment Property Record Card for Tax Year 2026

Data provided by LISA DELOZIER County Assessor

Date 04/16/2026
Time 21:07:00
Page 1

Assessment Data					Primary Image																																																																																																																				
Account 660079774 Parcel ID 000000-00-0-21630-005-0022 Cadastral ID 22-21-14-06310 Property Type REAL - Real Property Property Class URP VI Area 4 Tax Area 40 - OWASSO CITY Name ID 309231 SHERMAN, AUSTIN L 15215 E 90TH PL N OWASSO OK 74055-0000 Parcel Location Situs 15215 E 90TH PL N Subdivision PRESTON LAKES II Lot/Block 0022 / 0005 Parcel Size 1 - Lots Sec/Twn/Rng 22 / 21 / 14 / 5 Neighborhood 1059 - R-V04-SW OWASSO School District S021 - OWASSO SCHOOLS																																																																																																																									
Legal Description Lot/Long: 36.28514892 -95.80407193																																																																																																																									
Building Permits					\\tsclient\TCASEY\CASEY BOOTH RESIDENTIAL VI\2022-8-24\ 8/29/2022																																																																																																																				
Exemptions					Sale History																																																																																																																				
<table border="1"> <thead> <tr> <th>Code</th> <th>Type</th> <th>Active</th> <th>Maximum</th> <th>Exemption</th> </tr> </thead> <tbody> <tr> <td colspan="5">LOT 22 BLOCK 5 PRESTON LAKES II</td> </tr> </tbody> </table>					Code	Type	Active	Maximum	Exemption	LOT 22 BLOCK 5 PRESTON LAKES II					<table border="1"> <thead> <tr> <th>Number</th> <th>Description</th> <th>Opened</th> <th>Closed</th> <th>Amount</th> </tr> </thead> <tbody> <tr> <td colspan="5"> </td> </tr> </tbody> </table>					Number	Description	Opened	Closed	Amount																																																																																																	
Code	Type	Active	Maximum	Exemption																																																																																																																					
LOT 22 BLOCK 5 PRESTON LAKES II																																																																																																																									
Number	Description	Opened	Closed	Amount																																																																																																																					
<table border="1"> <thead> <tr> <th>Code</th> <th>Type</th> <th>Active</th> <th>Maximum</th> <th>Exemption</th> </tr> </thead> <tbody> <tr> <td colspan="5"> </td> </tr> </tbody> </table>					Code	Type	Active	Maximum	Exemption						<table border="1"> <thead> <tr> <th>Bk/Pg</th> <th>Grantor</th> <th>Date</th> <th>Price</th> <th>Code</th> </tr> </thead> <tbody> <tr> <td>2309/303</td> <td>CARDER, STEVEN</td> <td>02/15/2013</td> <td>154,000</td> <td>YES</td> </tr> <tr> <td>1555/279</td> <td>SIMMONS HOMES RESIDENTIAL</td> <td>12/29/2003</td> <td>144,500</td> <td>YES</td> </tr> <tr> <td>1361/127</td> <td>PRESTON LAKES DEVELOPMENT-GR</td> <td>03/06/2002</td> <td>0</td> <td>11</td> </tr> <tr> <td>1361/129</td> <td>SIMMONS PROPERTY-MANAGEMENT</td> <td>03/06/2002</td> <td>0</td> <td>11</td> </tr> </tbody> </table>					Bk/Pg	Grantor	Date	Price	Code	2309/303	CARDER, STEVEN	02/15/2013	154,000	YES	1555/279	SIMMONS HOMES RESIDENTIAL	12/29/2003	144,500	YES	1361/127	PRESTON LAKES DEVELOPMENT-GR	03/06/2002	0	11	1361/129	SIMMONS PROPERTY-MANAGEMENT	03/06/2002	0	11																																																																													
Code	Type	Active	Maximum	Exemption																																																																																																																					
Bk/Pg	Grantor	Date	Price	Code																																																																																																																					
2309/303	CARDER, STEVEN	02/15/2013	154,000	YES																																																																																																																					
1555/279	SIMMONS HOMES RESIDENTIAL	12/29/2003	144,500	YES																																																																																																																					
1361/127	PRESTON LAKES DEVELOPMENT-GR	03/06/2002	0	11																																																																																																																					
1361/129	SIMMONS PROPERTY-MANAGEMENT	03/06/2002	0	11																																																																																																																					
Parcel Valuation																																																																																																																									
<table border="1"> <thead> <tr> <th>Source</th> <th>REAL</th> </tr> </thead> <tbody> <tr> <td>Remove Cap</td> <td>2014</td> </tr> <tr> <td>Year Frozen</td> <td>0</td> </tr> <tr> <td>Uncapped Value</td> <td>0</td> </tr> <tr> <td>TIF Project ID</td> <td>0</td> </tr> </tbody> </table>		Source	REAL	Remove Cap	2014	Year Frozen	0	Uncapped Value	0	TIF Project ID	0	<table border="1"> <thead> <tr> <th>Fair Cash</th> <th>Capped</th> <th>Asmnt Level</th> <th>Assessed</th> </tr> </thead> <tbody> <tr> <td>Land Value</td> <td>53,413</td> <td>47,206</td> <td>5,193</td> </tr> <tr> <td>Improvements</td> <td>185,868</td> <td>172,217</td> <td>18,944</td> </tr> <tr> <td>Mobile Home</td> <td>0</td> <td>0</td> <td>0</td> </tr> <tr> <td>Total Value</td> <td>239,281</td> <td>219,423</td> <td>24,137</td> </tr> </tbody> </table>			Fair Cash	Capped	Asmnt Level	Assessed	Land Value	53,413	47,206	5,193	Improvements	185,868	172,217	18,944	Mobile Home	0	0	0	Total Value	239,281	219,423	24,137	<table border="1"> <thead> <tr> <th>Levy Rate</th> <th>Current Tax</th> </tr> </thead> <tbody> <tr> <td>97.960</td> <td>2,364.46</td> </tr> <tr> <td>Assessed</td> <td>24,137</td> </tr> <tr> <td>Penalty</td> <td>0</td> </tr> <tr> <td>Exemption</td> <td>0</td> </tr> <tr> <td>Total Taxable</td> <td>24,137</td> </tr> </tbody> </table>		Levy Rate	Current Tax	97.960	2,364.46	Assessed	24,137	Penalty	0	Exemption	0	Total Taxable	24,137																																																																									
Source	REAL																																																																																																																								
Remove Cap	2014																																																																																																																								
Year Frozen	0																																																																																																																								
Uncapped Value	0																																																																																																																								
TIF Project ID	0																																																																																																																								
Fair Cash	Capped	Asmnt Level	Assessed																																																																																																																						
Land Value	53,413	47,206	5,193																																																																																																																						
Improvements	185,868	172,217	18,944																																																																																																																						
Mobile Home	0	0	0																																																																																																																						
Total Value	239,281	219,423	24,137																																																																																																																						
Levy Rate	Current Tax																																																																																																																								
97.960	2,364.46																																																																																																																								
Assessed	24,137																																																																																																																								
Penalty	0																																																																																																																								
Exemption	0																																																																																																																								
Total Taxable	24,137																																																																																																																								
Assessment History																																																																																																																									
<table border="1"> <thead> <tr> <th>Tax Year</th> <th>Statement Number</th> <th>Billed Owner</th> <th>Tax Area</th> <th>Total Value</th> <th>Exemptions</th> <th>Taxable Value</th> <th>Billed Tax</th> </tr> </thead> <tbody> <tr><td>2025</td><td>2025-660079774</td><td>SHERMAN, AUSTIN L</td><td>40</td><td>234,224</td><td>0</td><td>22,987</td><td>2,252.00</td></tr> <tr><td>2024</td><td>2024-660079774</td><td>SHERMAN, AUSTIN L</td><td>40</td><td>249,317</td><td>0</td><td>21,893</td><td>2,103.00</td></tr> <tr><td>2023</td><td>2023-660079774</td><td>SHERMAN, AUSTIN L</td><td>40</td><td>221,994</td><td>0</td><td>20,851</td><td>1,954.00</td></tr> <tr><td>2022</td><td>2022-660079774</td><td>SHERMAN, AUSTIN L</td><td>40</td><td>190,675</td><td>0</td><td>19,857</td><td>1,945.00</td></tr> <tr><td>2021</td><td>2021-660079774</td><td>SHERMAN, AUSTIN L</td><td>40</td><td>171,925</td><td>0</td><td>18,912</td><td>1,830.00</td></tr> <tr><td>2020</td><td>2020-660079774</td><td>SHERMAN, AUSTIN L</td><td>40</td><td>164,359</td><td>0</td><td>18,079</td><td>1,749.00</td></tr> <tr><td>2019</td><td>2019-660079774</td><td>SHERMAN, AUSTIN L</td><td>40</td><td>164,893</td><td>0</td><td>18,138</td><td>1,756.00</td></tr> <tr><td>2018</td><td>2018-660079774</td><td>SHERMAN, AUSTIN L</td><td>40</td><td>164,279</td><td>0</td><td>18,071</td><td>1,685.00</td></tr> <tr><td>2017</td><td>2017-660079774</td><td>SHERMAN, AUSTIN L</td><td>40</td><td>162,916</td><td>0</td><td>17,921</td><td>1,686.00</td></tr> <tr><td>2016</td><td>2016-660079774</td><td>SHERMAN, AUSTIN L</td><td>40</td><td>158,855</td><td>0</td><td>17,474</td><td>1,651.00</td></tr> <tr><td>2015</td><td>2015-660079774</td><td>SHERMAN, AUSTIN L</td><td>40</td><td>153,957</td><td>0</td><td>16,935</td><td>1,615.00</td></tr> <tr><td>2014</td><td>2014-660079774</td><td>SHERMAN, AUSTIN L</td><td>40</td><td>155,200</td><td>0</td><td>17,072</td><td>1,645.00</td></tr> <tr><td>2013</td><td>2013-660079774</td><td>SHERMAN, AUSTIN L</td><td>40</td><td>154,493</td><td>0</td><td>16,994</td><td>1,601.00</td></tr> </tbody> </table>										Tax Year	Statement Number	Billed Owner	Tax Area	Total Value	Exemptions	Taxable Value	Billed Tax	2025	2025-660079774	SHERMAN, AUSTIN L	40	234,224	0	22,987	2,252.00	2024	2024-660079774	SHERMAN, AUSTIN L	40	249,317	0	21,893	2,103.00	2023	2023-660079774	SHERMAN, AUSTIN L	40	221,994	0	20,851	1,954.00	2022	2022-660079774	SHERMAN, AUSTIN L	40	190,675	0	19,857	1,945.00	2021	2021-660079774	SHERMAN, AUSTIN L	40	171,925	0	18,912	1,830.00	2020	2020-660079774	SHERMAN, AUSTIN L	40	164,359	0	18,079	1,749.00	2019	2019-660079774	SHERMAN, AUSTIN L	40	164,893	0	18,138	1,756.00	2018	2018-660079774	SHERMAN, AUSTIN L	40	164,279	0	18,071	1,685.00	2017	2017-660079774	SHERMAN, AUSTIN L	40	162,916	0	17,921	1,686.00	2016	2016-660079774	SHERMAN, AUSTIN L	40	158,855	0	17,474	1,651.00	2015	2015-660079774	SHERMAN, AUSTIN L	40	153,957	0	16,935	1,615.00	2014	2014-660079774	SHERMAN, AUSTIN L	40	155,200	0	17,072	1,645.00	2013	2013-660079774	SHERMAN, AUSTIN L	40	154,493	0	16,994	1,601.00
Tax Year	Statement Number	Billed Owner	Tax Area	Total Value	Exemptions	Taxable Value	Billed Tax																																																																																																																		
2025	2025-660079774	SHERMAN, AUSTIN L	40	234,224	0	22,987	2,252.00																																																																																																																		
2024	2024-660079774	SHERMAN, AUSTIN L	40	249,317	0	21,893	2,103.00																																																																																																																		
2023	2023-660079774	SHERMAN, AUSTIN L	40	221,994	0	20,851	1,954.00																																																																																																																		
2022	2022-660079774	SHERMAN, AUSTIN L	40	190,675	0	19,857	1,945.00																																																																																																																		
2021	2021-660079774	SHERMAN, AUSTIN L	40	171,925	0	18,912	1,830.00																																																																																																																		
2020	2020-660079774	SHERMAN, AUSTIN L	40	164,359	0	18,079	1,749.00																																																																																																																		
2019	2019-660079774	SHERMAN, AUSTIN L	40	164,893	0	18,138	1,756.00																																																																																																																		
2018	2018-660079774	SHERMAN, AUSTIN L	40	164,279	0	18,071	1,685.00																																																																																																																		
2017	2017-660079774	SHERMAN, AUSTIN L	40	162,916	0	17,921	1,686.00																																																																																																																		
2016	2016-660079774	SHERMAN, AUSTIN L	40	158,855	0	17,474	1,651.00																																																																																																																		
2015	2015-660079774	SHERMAN, AUSTIN L	40	153,957	0	16,935	1,615.00																																																																																																																		
2014	2014-660079774	SHERMAN, AUSTIN L	40	155,200	0	17,072	1,645.00																																																																																																																		
2013	2013-660079774	SHERMAN, AUSTIN L	40	154,493	0	16,994	1,601.00																																																																																																																		



Rogers

Assessment Property Record Card for Tax Year 2026

Data provided by LISA DELOZIER County Assessor

Date 04/16/2026
Time 21:07:00
Page 2

Lot Data	Square-Foot - NBHD 1059 #1	Primary Image
Lot Size Lot Count 1 Units Buildable 1 Non-Ag Acres 0.2314 Topography Street Access Utilities Amenities 0 Method Square-Foot Base Lot Value 10,078.00 x 5.30 = 53,413 Factor Value Adjustments 1.0000 Lot Value 53,413		

Residential Data	
Type	1 Single Family Residence
Condition	3 - Average
Quality	2.5 - Fair
Architecture	
Style	100% One Story
Exterior Wall	100% Veneer, Masonry
Base/Total Area	1,681 / 1,681
Style	100% One Story
HVAC	100% Warmed & Cooled Air
Roof Cover	1 Composition Shingle
Area on Slab	1,681
Fixture/RghIn	11 /
Bed/F/H Bath	3 / 2.0 /
Basement Area	
Garage Type	562 Attached Garage - Unfinished 2 Stalls
Remodel	
Year/Eff Age	2003 / 17

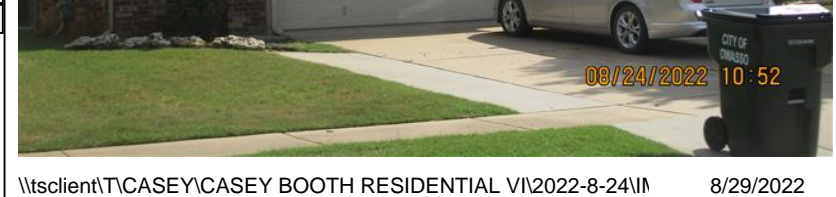

\\tsclient\TCASEY\CASEY BOOTH RESIDENTIAL VI\2022-8-24\ 8/29/2022

Cost Approach		Manual : 01/2025	
Base Cost	104,50	Total Misc Impr	+ 5,736
Roofing Adj	+ 4.42	Garage Cost	+ 15,028
Subfloor Adj	+ -1.15	Total RCN	= 235,276
Heat/Cool Adj	+ 11.47	Depreciation (21%)	- 49,408
Plumbing Adj	+ 8.37	Lump Sums	+ 0
Basement Adj	+ 0.00	RCNLD	= 185,868
Adj Base Cost	= 127.61	Lot Value	+ 53,413
Total Area	x 1,681	Indicated Value	= 239,281
Adjusted Cost	= 214,512	Value Per SqFt	142.34

GRM Approach	
GRM Code	
Gross Rent	0.00
Indicated Value	

Multiple Regression			
MRA Code	1	Test	
Adusted R	0.8445		
Indicated Value	205,662	122.35	Per SqFt

Direct Comparables	
Selection Model	A Adam Test
Adjustment Model	1 2022 Residential
Comparables	8
Indicated Value	254,990 Per SqFt

Value Reconciliation			
Selected Approach	Cost Approach		
Improvements	185,868		
Lot Value	53,413		
Indicated Value	239,281	142.34	Per SqFt
Agland Value			
Site Improvements			
Total Value	239,281	142.34	Total Value Per SqFt

Miscellaneous Improvements								
Code	Description	Sketch ID	Size	Year	Units	Unit Cost	Depr	Value
PRCH	SLAB PORCH - COVERED	96404	144		144	23.78		3,424
PATO	SLAB PORCH - OPEN	96405	23x11		253	9.14		2,312



Rogers
Assessment Property Record Card for Tax Year 2026

Data provided by LISA DELOZIER County Assessor

Date 04/16/2026
 Time 21:07:00
 Page 3

Sketch Image

660079774

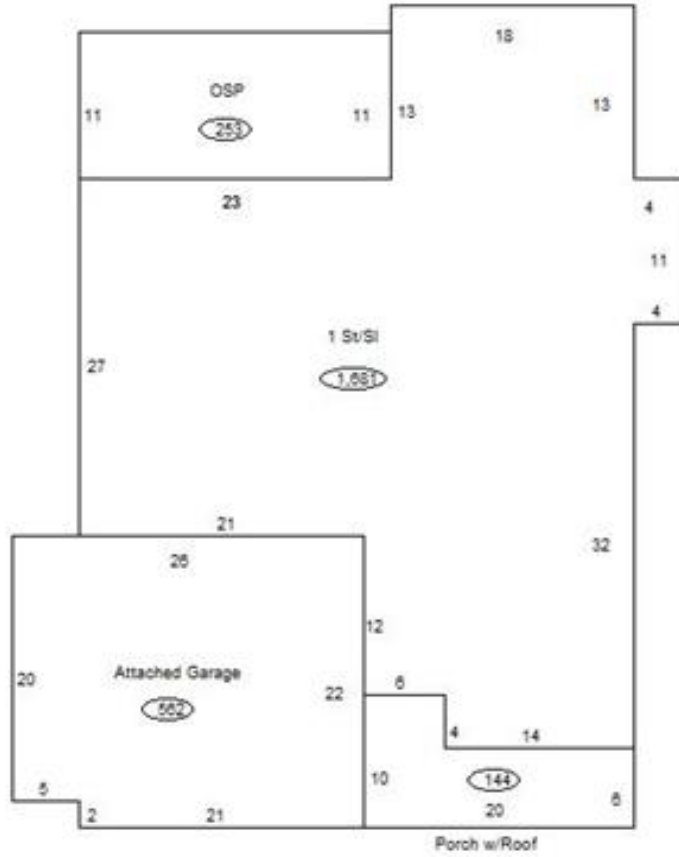

Sketch Vector Information

Sequence	Code	Type	Built Over	Scale	Section Label	Base Area	Multiplier	Total Area
1	R	1	Slab	13	1 St/SI	1,681	1.000	1,681
2	G	1		13	Attached Garage	562	1.000	562
3	M	PRCH		13	SLBC	144	1.000	144
4	M	PATO		13	Open Slab	253	1.000	253
Total Building Area						1,681		1,681