



# Rogers

## Assessment Property Record Card for Tax Year 2026

Data provided by LISA DELOZIER County Assessor

Date 04/17/2026  
Time 04:08:48  
Page 1

Assessment Data					Primary Image																																																																																																																				
<b>Account</b> 660082890 <b>Parcel ID</b> 21N15E-02-2-00000-000-0000 <b>Cadastral ID</b> 02-21-15-00520 <b>Property Type</b> REAL - Real Property <b>Property Class</b> RA VI Area 4 <b>Tax Area</b> 8 - CLAREMORE/ NW FIRE <b>Name ID</b> 283067 BICKEL, KIRBY M II &  JENNIFER M 8452 E 470 RD CLAREMORE OK 74017-0000																																																																																																																									
<b>Parcel Location</b> <b>Situs</b> 08452 E 470 RD <b>Subdivision</b> <b>Lot/Block</b> / <b>Parcel Size</b> 2.5 - Acres <b>Sec/Twn/Rng</b> 2 / 21 / 15 / 2 <b>Neighborhood</b> 6080 - UNPLATTED <b>School District</b> S001 - CLAREMORE SCHOOLS																																																																																																																									
<b>Legal Description</b> Lat/Long: 36.33312746 -95.67840132 S 274' OF N 1307' OF E 398' OF E2 E2 NW					<b>Building Permits</b> <table border="1"> <thead> <tr> <th>Number</th> <th>Description</th> <th>Opened</th> <th>Closed</th> <th>Amount</th> </tr> </thead> <tbody> <tr> <td>R23 089</td> <td>R24 NEW POOL</td> <td>11/2023</td> <td>03/2024</td> <td>70,000</td> </tr> </tbody> </table>					Number	Description	Opened	Closed	Amount	R23 089	R24 NEW POOL	11/2023	03/2024	70,000																																																																																																						
Number	Description	Opened	Closed	Amount																																																																																																																					
R23 089	R24 NEW POOL	11/2023	03/2024	70,000																																																																																																																					
<b>Exemptions</b> <table border="1"> <thead> <tr> <th>Code</th> <th>Type</th> <th>Active</th> <th>Maximum</th> <th>Exemption</th> </tr> </thead> <tbody> <tr> <td>SHLT</td> <td>Other</td> <td>Yes</td> <td>137</td> <td>137</td> </tr> <tr> <td>H</td> <td>Homestead</td> <td>Yes</td> <td>1,000</td> <td>1,000</td> </tr> </tbody> </table>					Code	Type	Active	Maximum	Exemption	SHLT	Other	Yes	137	137	H	Homestead	Yes	1,000	1,000	<b>Sale History</b> <table border="1"> <thead> <tr> <th>Bk/Pg</th> <th>Grantor</th> <th>Date</th> <th>Price</th> <th>Code</th> </tr> </thead> <tbody> <tr> <td>1495/594</td> <td>HUMPHREY, TED W</td> <td>06/30/2003</td> <td>0</td> <td>11</td> </tr> </tbody> </table>					Bk/Pg	Grantor	Date	Price	Code	1495/594	HUMPHREY, TED W	06/30/2003	0	11																																																																																							
Code	Type	Active	Maximum	Exemption																																																																																																																					
SHLT	Other	Yes	137	137																																																																																																																					
H	Homestead	Yes	1,000	1,000																																																																																																																					
Bk/Pg	Grantor	Date	Price	Code																																																																																																																					
1495/594	HUMPHREY, TED W	06/30/2003	0	11																																																																																																																					
<b>Parcel Valuation</b> <table border="1"> <thead> <tr> <th>Source</th> <th>REAL</th> <th>Fair Cash</th> <th>Capped</th> <th>Asmnt Level</th> <th>Assessed</th> <th>Levy Rate</th> <th>106.442</th> <th>Current Tax</th> </tr> </thead> <tbody> <tr> <td>Remove Cap</td> <td>0</td> <td>Land Value 149</td> <td>149</td> <td>11%</td> <td>16</td> <td>Assessed</td> <td>46,032</td> <td>4,899.72</td> </tr> <tr> <td>Year Frozen</td> <td>0</td> <td>Improvements 461,966</td> <td>418,328</td> <td></td> <td>46,016</td> <td>Penalty</td> <td>0</td> <td></td> </tr> <tr> <td>Uncapped Value</td> <td>36,074</td> <td>Mobile Home 0</td> <td>0</td> <td></td> <td>0</td> <td>Exemption</td> <td>1,137</td> <td>-107.00</td> </tr> <tr> <td>TIF Project ID</td> <td>0</td> <td>Total Value 462,115</td> <td>418,477</td> <td></td> <td>46,032</td> <td>Total Taxable</td> <td>44,895</td> <td>4,793.00</td> </tr> </tbody> </table>										Source	REAL	Fair Cash	Capped	Asmnt Level	Assessed	Levy Rate	106.442	Current Tax	Remove Cap	0	Land Value 149	149	11%	16	Assessed	46,032	4,899.72	Year Frozen	0	Improvements 461,966	418,328		46,016	Penalty	0		Uncapped Value	36,074	Mobile Home 0	0		0	Exemption	1,137	-107.00	TIF Project ID	0	Total Value 462,115	418,477		46,032	Total Taxable	44,895	4,793.00																																																																			
Source	REAL	Fair Cash	Capped	Asmnt Level	Assessed	Levy Rate	106.442	Current Tax																																																																																																																	
Remove Cap	0	Land Value 149	149	11%	16	Assessed	46,032	4,899.72																																																																																																																	
Year Frozen	0	Improvements 461,966	418,328		46,016	Penalty	0																																																																																																																		
Uncapped Value	36,074	Mobile Home 0	0		0	Exemption	1,137	-107.00																																																																																																																	
TIF Project ID	0	Total Value 462,115	418,477		46,032	Total Taxable	44,895	4,793.00																																																																																																																	
<b>Assessment History</b> <table border="1"> <thead> <tr> <th>Tax Year</th> <th>Statement Number</th> <th>Billed Owner</th> <th>Tax Area</th> <th>Total Value</th> <th>Exemptions</th> <th>Taxable Value</th> <th>Billed Tax</th> </tr> </thead> <tbody> <tr><td>2025</td><td>2025-660082890</td><td>BICKEL, KIRBY M II &amp;</td><td>8</td><td>435,994</td><td>1137</td><td>39,702</td><td>4,240.00</td></tr> <tr><td>2024</td><td>2024-660082890</td><td>BICKEL, KIRBY M II &amp;</td><td>8</td><td>232,748</td><td>1000</td><td>19,245</td><td>2,063.00</td></tr> <tr><td>2023</td><td>2023-660082890</td><td>BICKEL, KIRBY M II &amp;</td><td>8</td><td>196,302</td><td>1000</td><td>18,656</td><td>1,984.00</td></tr> <tr><td>2022</td><td>2022-660082890</td><td>BICKEL, KIRBY M II &amp;</td><td>8</td><td>200,972</td><td>1000</td><td>18,083</td><td>1,935.00</td></tr> <tr><td>2021</td><td>2021-660082890</td><td>BICKEL, KIRBY M II &amp;</td><td>8</td><td>169,886</td><td>1000</td><td>17,528</td><td>1,800.00</td></tr> <tr><td>2020</td><td>2020-660082890</td><td>BICKEL, KIRBY M II &amp;</td><td>8</td><td>166,709</td><td>1000</td><td>16,988</td><td>1,809.00</td></tr> <tr><td>2019</td><td>2019-660082890</td><td>BICKEL, KIRBY M II &amp;</td><td>8</td><td>158,768</td><td>1000</td><td>16,464</td><td>1,771.00</td></tr> <tr><td>2018</td><td>2018-660082890</td><td>BICKEL, KIRBY M II &amp;</td><td>8</td><td>163,443</td><td>1000</td><td>16,773</td><td>1,801.00</td></tr> <tr><td>2017</td><td>2017-660082890</td><td>BICKEL, KIRBY M II &amp;</td><td>8</td><td>161,860</td><td>1000</td><td>16,255</td><td>1,717.00</td></tr> <tr><td>2016</td><td>2016-660082890</td><td>BICKEL, KIRBY M II &amp;</td><td>8</td><td>157,041</td><td>1000</td><td>15,753</td><td>1,713.00</td></tr> <tr><td>2015</td><td>2015-660082890</td><td>BICKEL, KIRBY M II &amp;</td><td>8</td><td>151,216</td><td>1000</td><td>15,265</td><td>1,584.00</td></tr> <tr><td>2014</td><td>2014-660082890</td><td>BICKEL, KIRBY M II &amp;</td><td>8</td><td>152,662</td><td>1000</td><td>14,791</td><td>1,558.00</td></tr> <tr><td>2013</td><td>2013-660082890</td><td>BICKEL, KIRBY M II &amp;</td><td>8</td><td>142,095</td><td>1000</td><td>14,331</td><td>1,487.00</td></tr> </tbody> </table>										Tax Year	Statement Number	Billed Owner	Tax Area	Total Value	Exemptions	Taxable Value	Billed Tax	2025	2025-660082890	BICKEL, KIRBY M II &	8	435,994	1137	39,702	4,240.00	2024	2024-660082890	BICKEL, KIRBY M II &	8	232,748	1000	19,245	2,063.00	2023	2023-660082890	BICKEL, KIRBY M II &	8	196,302	1000	18,656	1,984.00	2022	2022-660082890	BICKEL, KIRBY M II &	8	200,972	1000	18,083	1,935.00	2021	2021-660082890	BICKEL, KIRBY M II &	8	169,886	1000	17,528	1,800.00	2020	2020-660082890	BICKEL, KIRBY M II &	8	166,709	1000	16,988	1,809.00	2019	2019-660082890	BICKEL, KIRBY M II &	8	158,768	1000	16,464	1,771.00	2018	2018-660082890	BICKEL, KIRBY M II &	8	163,443	1000	16,773	1,801.00	2017	2017-660082890	BICKEL, KIRBY M II &	8	161,860	1000	16,255	1,717.00	2016	2016-660082890	BICKEL, KIRBY M II &	8	157,041	1000	15,753	1,713.00	2015	2015-660082890	BICKEL, KIRBY M II &	8	151,216	1000	15,265	1,584.00	2014	2014-660082890	BICKEL, KIRBY M II &	8	152,662	1000	14,791	1,558.00	2013	2013-660082890	BICKEL, KIRBY M II &	8	142,095	1000	14,331	1,487.00
Tax Year	Statement Number	Billed Owner	Tax Area	Total Value	Exemptions	Taxable Value	Billed Tax																																																																																																																		
2025	2025-660082890	BICKEL, KIRBY M II &	8	435,994	1137	39,702	4,240.00																																																																																																																		
2024	2024-660082890	BICKEL, KIRBY M II &	8	232,748	1000	19,245	2,063.00																																																																																																																		
2023	2023-660082890	BICKEL, KIRBY M II &	8	196,302	1000	18,656	1,984.00																																																																																																																		
2022	2022-660082890	BICKEL, KIRBY M II &	8	200,972	1000	18,083	1,935.00																																																																																																																		
2021	2021-660082890	BICKEL, KIRBY M II &	8	169,886	1000	17,528	1,800.00																																																																																																																		
2020	2020-660082890	BICKEL, KIRBY M II &	8	166,709	1000	16,988	1,809.00																																																																																																																		
2019	2019-660082890	BICKEL, KIRBY M II &	8	158,768	1000	16,464	1,771.00																																																																																																																		
2018	2018-660082890	BICKEL, KIRBY M II &	8	163,443	1000	16,773	1,801.00																																																																																																																		
2017	2017-660082890	BICKEL, KIRBY M II &	8	161,860	1000	16,255	1,717.00																																																																																																																		
2016	2016-660082890	BICKEL, KIRBY M II &	8	157,041	1000	15,753	1,713.00																																																																																																																		
2015	2015-660082890	BICKEL, KIRBY M II &	8	151,216	1000	15,265	1,584.00																																																																																																																		
2014	2014-660082890	BICKEL, KIRBY M II &	8	152,662	1000	14,791	1,558.00																																																																																																																		
2013	2013-660082890	BICKEL, KIRBY M II &	8	142,095	1000	14,331	1,487.00																																																																																																																		



# Rogers

## Assessment Property Record Card for Tax Year 2026

Data provided by LISA DELOZIER County Assessor

Date 04/17/2026  
Time 04:08:48  
Page 2

Lot Data	Primary Image
Lot Size Lot Count Units Buildable Non-Ag Acres 0 Topography Street Access Utilities Amenities LAND QUALITY  Method Base Lot Value Factor Value Adjustments Lot Value	

Residential Data	
Type	1 Single Family Residence
Condition	3 - Average
Quality	3 - Average
Architecture	
Style	100% 1 1/2 Story Finished
Exterior Wall	100% Veneer, Masonry
Base/Total Area	1,857 / 2,073
Style	100% 1 1/2 Story Finished
HVAC	100% Warmed & Cooled Air
Roof Cover	1 Composition Shingle
Area on Slab	1,857
Fixture/RghIn	11 /
Bed/F/H Bath	3 / 2.0 /
Basement Area	
Garage Type	525 Attached Garage - Unfinished
Remodel	
Year/Eff Age	2003 / 17

\\tsclient\C\Users\Randy Necessary\Pictures\101\_0324\IMG\_0010. 3/25/2022

GRM Approach	
GRM Code	
Gross Rent	0.00
Indicated Value	

Multiple Regression	
MRA Code	
Adjusted R	
Indicated Value	

Direct Comparables	
Selection Model	1 Res
Adjustment Model	A2 AO Test
Comparables	
Indicated Value	

Cost Approach				Manual : 01/2025	
Base Cost	99.39	Total Misc Impr	+	9,062	
Roofing Adj	+ 4.28	Garage Cost	+	16,559	
Subfloor Adj	+ -2.04	Total RCN	=	278,009	
Heat/Cool Adj	+ 12.64	Depreciation ( 19%)	-	52,822	
Plumbing Adj	+ 7.48	Lump Sums	+	0	
Basement Adj	+ 0.00	RCNLD	=	225,187	
Adj Base Cost	= 121.75	Lot Value	+		
Total Area	x 2,073	Indicated Value	=	225,187	
Adjusted Cost	= 252,388	Value Per SqFt		108.63	

Value Reconciliation			
Selected Approach	Cost Approach		
Improvements	225,187		
Lot Value			
Indicated Value	225,187	108.63	Per SqFt
Agland Value	149		
Site Improvements	36,074		
Total Value	261,410	126.10	Total Value Per SqFt

Miscellaneous Improvements								
Code	Description	Sketch ID	Size	Year	Units	Unit Cost	Depr	Value
PRCH	SLAB PORCH - COVERED	100436	6x6		36	26.82		966
PRCH	SLAB PORCH - COVERED	100437	312		312	25.95		8,096
SHLT	STORM SHELTER - AG IN GARAGE		1	2025	1	0.00		



# Rogers

## Assessment Property Record Card for Tax Year 2026

Data provided by LISA DELOZIER County Assessor

Date 04/17/2026

Time 04:08:48

Page 3

### Sketch Image

660082890

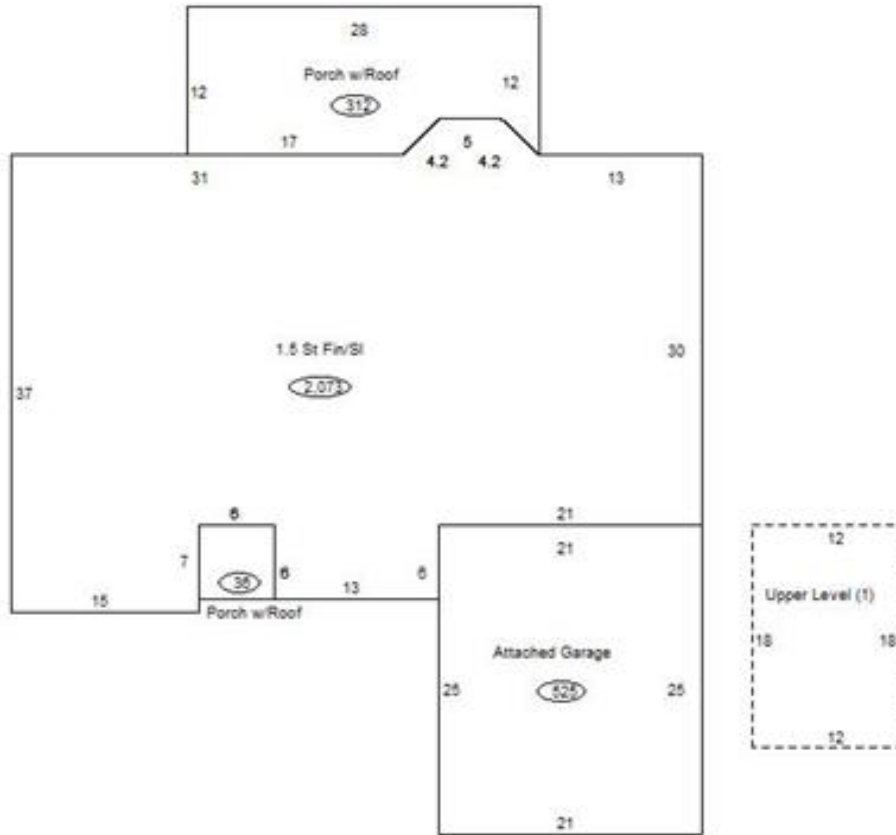

### Sketch Vector Information

Sequence	Code	Type	Built Over	Scale	Section Label	Base Area	Multiplier	Total Area
1	R	5	Slab	13	1.5 St Fin/Sl	1,857	1.116	2,073
2	G	1		13	Attached Garage	525	1.000	525
3	M	PRCH		13	SLBC	36	1.000	36
4	M	PRCH		13	SLBC	312	1.000	312
5	U	^UL		13	Upper Level (1)	216	1.000	216
<b>Total Building Area</b>						<b>1,857</b>		<b>2,073</b>



# Rogers



## Assessment Property Record Card for Tax Year 2026

Data provided by LISA DELOZIER County Assessor

Date 04/17/2026  
 Time 04:08:48  
 Page 4

660082890

### Outbuildings/Site Improvements

Building Image	Code	Description	Dimensions	Floor	Roofing	Total Units
	ODFP	Outdoor Fireplace/Firepit	0x0x0			1
	Qual 3	Cond 3	Year 2025	Eff Age	1	
	<b>Valuation Summary</b>		<b>Modifier Total</b>	<b>RCN</b>	<b>Depr (6% Phys/ % Func)</b>	<b>RCNLD</b>
	Base Cost (2,751.55 x 1) 2,752			2,752	165	2,587
	SPLG	Swimming Pool - In Ground	0x0x0		Reinforced-Concrete	600
	Qual 5	Cond 6	Year 2024	Eff Age	1	
	<b>Valuation Summary</b>		<b>Modifier Total</b>	<b>RCN</b>	<b>Depr (5% Phys/ % Func)</b>	<b>RCNLD</b>
	Base Cost (58.75 x 600) 35,250			35,250	1,763	33,487
	STF	STG FAIR	0x0x0			
	Qual 2	Cond 3	Year	Eff Age	1520	
	<b>Valuation Summary</b>		<b>Modifier Total</b>	<b>RCN</b>	<b>Depr (100% Phys/ % Func)</b>	<b>RCNLD</b>
	Base Cost (4.68 x )					



# Rogers

## Assessment Property Record Card for Tax Year 2026

Data provided by LISA DELOZIER County Assessor

Date 04/17/2026  
 Time 04:08:48  
 Page 5

Lot Data	
Lot Size	-
Lot Count	
Units Buildable	
Non-Ag Acres	
Topography	
Street Access	
Utilities	
Amenities	LAND QUALITY
Method	
Base Lot Value	
Factor Value	
Adjustments	
Lot Value	



Residential Data	
Type	1 Single Family Residence
Condition	3 - Average
Quality	2.5 - Fair
Architecture	
Style	100% One Story
Exterior Wall	100% Frame, Siding, Wood
Base/Total Area	1,750 / 1,750
Style	100% One Story
HVAC	100% Warmed & Cooled Air
Roof Cover	1 Composition Shingle
Area on Slab	1,750
Fixture/RghIn	/
Bed/F/H Bath	2 / 2.0 /
Basement Area	
Garage Type	
Remodel	
Year/Eff Age	2024 / 2

T:\Appraisers\ROB STUFF\004.JPG 1/21/2025

GRM Approach	
GRM Code	
Gross Rent	0.00
Indicated Value	

Multiple Regression	
MRA Code	
Adusted R	
Indicated Value	

Direct Comparables	
Selection Model	1 Res
Adjustment Model	A2 AO Test
Comparables	
Indicated Value	

Cost Approach		Manual : 01/2025	
Base Cost	88.56	Total Misc Impr	+ 14,051
Roofing Adj	+ 4.09	Garage Cost	+
Subfloor Adj	+ -1.09	Total RCN	= 204,801
Heat/Cool Adj	+ 11.47	Depreciation ( 2%)	- 4,096
Plumbing Adj	+ 5.97	Lump Sums	+ 0
Basement Adj	+ 0.00	RCNLD	= 200,705
Adj Base Cost	= 109.00	Lot Value	+
Total Area	x 1,750	Indicated Value	= 200,705
Adjusted Cost	= 190,750	Value Per SqFt	114.69

Value Reconciliation			
Selected Approach	Cost Approach		
Improvements	200,705		
Lot Value			
Indicated Value	200,705	114.69	Per SqFt
Agland Value			
Site Improvements			
Total Value	200,705	114.69	Total Value Per SqFt

Miscellaneous Improvements								
Code	Description	Sketch ID	Size	Year	Units	Unit Cost	Depr	Value
PRCH	Porch	163234	388		388	23.08		8,955
FPR1	Fireplace - Residential 1 Story		1	2024	1	5,095.98		5,096



# Rogers

## Assessment Property Record Card for Tax Year 2026

Data provided by LISA DELOZIER County Assessor

Date 04/17/2026

Time 04:08:48

Page 6

### Sketch Image

660082890

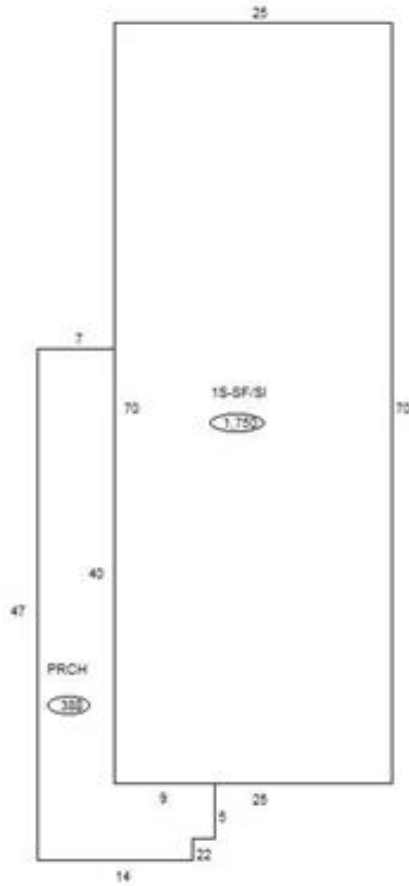

### Sketch Vector Information

Sequence	Code	Type	Built Over	Scale	Section Label	Base Area	Multiplier	Total Area
1	R	1	Slab	13	1S-SF/SI	1,750	1.000	1,750
2	M	PRCH		13	PRCH	388	1.000	388
<b>Total Building Area</b>						<b>1,750</b>		<b>1,750</b>



# Rogers

## Assessment Property Record Card for Tax Year 2026

Data provided by LISA DELOZIER County Assessor

Date 04/17/2026  
Time 04:08:49  
Page 7

### Agland Inventory

660082890

Soi	Description	Land Use	LPI	Adj Type	Adj Code	Acres	Use/Acre	Mkt/Acre	Use Value	Market Value
CMB	CLAREMORE SILT LOAM 0-3%	TMBR	45			.520	81	81	42	42
OS	OSAGE CLAY	TMBR	58			.520	104	104	54	54
RS	ROUGH STONY LAND	TMBR	20			1.460	36	36	53	53
<b>TMBR Totals</b>						2.500			149	149
<b>Total Agland</b>						2.500			149	149