



Rogers

Assessment Property Record Card for Tax Year 2026

Data provided by LISA DELOZIER County Assessor

Date 04/17/2026
Time 17:54:09
Page 1

Assessment Data					Primary Image				
Account	660083142								
Parcel ID	20N17E-31-4-00000-000-0000								
Cadastral ID	31-20-17-00171								
Property Type	REAL - Real Property								
Property Class	UC	VI Area	3						
Tax Area	19 - INOLA OT								
Name ID	316324								
CADILLAC PROPERTIES LLC									
C/O LARRY ROGERS									
11063 - D S MEMORIAL DR # 251									
TULSA OK 74133-0000									
Parcel Location									
Situs	30640 S 4200 RD								
Subdivision									
Lot/Block	/	Parcel Size	1 - Acres						
Sec/Twn/Rng	31 / 20 / 17 / 4								
Neighborhood	5001 - TASC 2016								
School District	S005 - INOLA SCHOOLS								
Legal Description Lat/Long: 36.16716356 -95.53008071									
COMM AT NW/C OF E/2 SE/4; TH S01-22-09E 1022.63'; TH N88-36-54E 1008.44' TO POB; TH N88-36-54E 252.08'; TH N01-21-30W 172.8'; TH S88-36-54W 252.08'; TH S01-21-30E 172.8' TO THE POB.									
Building Permits									
Number	Description	Opened	Closed	Amount					
R17	R17-REMODEL	10/2016	01/2019						
Exemptions									
Code	Type	Active	Maximum	Exemption					
Sale History									
Bk/Pg	Grantor	Date	Price	Code					
2502/126	ALMY, JIM R & VICTORIA R	09/28/2015	230,000	YES					
1537/431	O'NEAL, HERBERT PAUL JR &	10/22/2003	21,500	YES					
Parcel Valuation									
Source	REAL	Fair Cash	Capped	Asmnt Level	Assessed	Levy Rate	80.060	Current Tax	
Remove Cap	2016	Land Value	60,944	60,944	11%	6,704	Assessed	26,316	
Year Frozen	0	Improvements	311,956	178,291		19,612	Penalty	0	
Uncapped Value	0	Mobile Home	0	0		0	Exemption	0	
TIF Project ID	0	Total Value	372,900	239,235		26,316	Total Taxable	26,316	
Assessment History									
Tax Year	Statement Number	Billed Owner	Tax Area	Total Value	Exemptions	Taxable Value	Billed Tax		
2025	2025-660083142	CADILLAC PROPERTIES LLC	19	421,530	0	25,063	2,007.00		
2024	2024-660083142	CADILLAC PROPERTIES LLC	19	216,994	0	23,869	1,919.00		
2023	2023-660083142	CADILLAC PROPERTIES LLC	19	347,577	0	37,528	3,023.00		
2022	2022-660083142	CADILLAC PROPERTIES LLC	19	352,778	0	35,741	2,899.00		
2021	2021-660083142	CADILLAC PROPERTIES LLC	19	309,441	0	34,039	2,728.00		
2020	2020-660083142	CADILLAC PROPERTIES LLC	19	309,441	0	34,039	2,750.00		
2019	2019-660083142	CADILLAC PROPERTIES LLC	19	309,441	0	34,039	2,812.00		
2018	2018-660083142	CADILLAC PROPERTIES LLC	19	297,731	0	32,751	2,734.00		
2017	2017-660083142	CADILLAC PROPERTIES LLC	19	297,731	0	32,751	2,756.00		
2016	2016-660083142	CADILLAC PROPERTIES LLC	2	218,415	0	24,026	2,044.00		
2015	2015-660083142	CADILLAC PROPERTIES LLC	2	184,201	0	18,928	1,642.00		
2014	2014-660083142	ALMY, JIM R & VICTORIA R	2	184,201	0	18,027	1,619.00		
2013	2013-660083142	ALMY, JIM R & VICTORIA R	2	156,075	0	17,168	1,446.00		



Rogers

Assessment Property Record Card for Tax Year 2026

Data provided by LISA DELOZIER County Assessor

Date 04/17/2026
 Time 17:54:09
 Page 2

Lot Data	Primary Image																																						
<table border="0"> <tr><td>Lot Size</td><td>0 x 0</td></tr> <tr><td>Lot Count</td><td>0</td></tr> <tr><td>Units Buildable</td><td>58929</td></tr> <tr><td>Non-Ag Acres</td><td>1.298</td></tr> <tr><td>Topography</td><td></td></tr> <tr><td>Street Access</td><td></td></tr> <tr><td>Utilities</td><td></td></tr> <tr><td>Amenities</td><td>0</td></tr> <tr><td></td><td>0</td></tr> <tr><td>Value Model</td><td>1835 COMM</td></tr> <tr><td>Value Method</td><td>Square-Foot</td></tr> <tr><td>Base Lot Value</td><td>56,548.00 x 1.08 = 60,944</td></tr> <tr><td>Factor Value</td><td>0</td></tr> <tr><td>Adjustments</td><td></td></tr> <tr><td>Lot Value</td><td>60,944</td></tr> </table>	Lot Size	0 x 0	Lot Count	0	Units Buildable	58929	Non-Ag Acres	1.298	Topography		Street Access		Utilities		Amenities	0		0	Value Model	1835 COMM	Value Method	Square-Foot	Base Lot Value	56,548.00 x 1.08 = 60,944	Factor Value	0	Adjustments		Lot Value	60,944									
Lot Size	0 x 0																																						
Lot Count	0																																						
Units Buildable	58929																																						
Non-Ag Acres	1.298																																						
Topography																																							
Street Access																																							
Utilities																																							
Amenities	0																																						
	0																																						
Value Model	1835 COMM																																						
Value Method	Square-Foot																																						
Base Lot Value	56,548.00 x 1.08 = 60,944																																						
Factor Value	0																																						
Adjustments																																							
Lot Value	60,944																																						
Cost Approach	Image Information																																						
<table border="0"> <tr><td>Manual Date</td><td>01/2025</td></tr> <tr><td>Total Building Area</td><td>3,600</td></tr> <tr><td>Total Base Value</td><td>354,636</td></tr> <tr><td>Modifier Value</td><td></td></tr> <tr><td>Misc Improvements</td><td>17,488</td></tr> <tr><td>Replacement Cost New</td><td>372,124</td></tr> <tr><td>Phys/Func Depreciation Loss</td><td>()</td></tr> <tr><td>RCN Less Phys/Func</td><td>256,822</td></tr> <tr><td>Economic Depreciation</td><td></td></tr> <tr><td>RCNLD (All Sources)</td><td>256,822</td></tr> <tr><td>Depreciated Improvements</td><td></td></tr> <tr><td>Outbuilding Value</td><td>55,134</td></tr> <tr><td>Total Improvement Value</td><td>311,956</td></tr> <tr><td>Land Value</td><td>60,944</td></tr> <tr><td>Cost Approach Value</td><td>372,900 103.58/SqFt</td></tr> </table>	Manual Date	01/2025	Total Building Area	3,600	Total Base Value	354,636	Modifier Value		Misc Improvements	17,488	Replacement Cost New	372,124	Phys/Func Depreciation Loss	()	RCN Less Phys/Func	256,822	Economic Depreciation		RCNLD (All Sources)	256,822	Depreciated Improvements		Outbuilding Value	55,134	Total Improvement Value	311,956	Land Value	60,944	Cost Approach Value	372,900 103.58/SqFt	<table border="0"> <tr><td>Image ID</td><td>953628</td></tr> <tr><td>Image Date</td><td>3/25/2021</td></tr> <tr><td>Name</td><td>IMG_0024.JPG</td></tr> <tr><td>Description</td><td>\\tsclient\T\TOM\COMMERCIAL PICS\2021-02-26\IMG_0024.JPG</td></tr> </table>	Image ID	953628	Image Date	3/25/2021	Name	IMG_0024.JPG	Description	\\tsclient\T\TOM\COMMERCIAL PICS\2021-02-26\IMG_0024.JPG
Manual Date	01/2025																																						
Total Building Area	3,600																																						
Total Base Value	354,636																																						
Modifier Value																																							
Misc Improvements	17,488																																						
Replacement Cost New	372,124																																						
Phys/Func Depreciation Loss	()																																						
RCN Less Phys/Func	256,822																																						
Economic Depreciation																																							
RCNLD (All Sources)	256,822																																						
Depreciated Improvements																																							
Outbuilding Value	55,134																																						
Total Improvement Value	311,956																																						
Land Value	60,944																																						
Cost Approach Value	372,900 103.58/SqFt																																						
Image ID	953628																																						
Image Date	3/25/2021																																						
Name	IMG_0024.JPG																																						
Description	\\tsclient\T\TOM\COMMERCIAL PICS\2021-02-26\IMG_0024.JPG																																						
Income Approach	Value Reconciliation																																						
<table border="0"> <tr><td>Potential Gross Income (PGI)</td><td></td></tr> <tr><td>Vacancy & Collection Loss</td><td></td></tr> <tr><td>Miscellaneous Income</td><td></td></tr> <tr><td>Effective Gross Income (EGI)</td><td></td></tr> <tr><td>Total Expenses</td><td></td></tr> <tr><td>Net Operating Income (NOI)</td><td></td></tr> <tr><td>Income Capitalization Rate</td><td></td></tr> <tr><td>Indicated Value</td><td>0.00</td></tr> </table>	Potential Gross Income (PGI)		Vacancy & Collection Loss		Miscellaneous Income		Effective Gross Income (EGI)		Total Expenses		Net Operating Income (NOI)		Income Capitalization Rate		Indicated Value	0.00	<table border="0"> <tr><td>Selected Valuation Method</td><td>Cost Approach</td></tr> <tr><td>Total Improvement Value</td><td>55,134</td></tr> <tr><td>Land Value</td><td>60,944</td></tr> <tr><td>Total Appraised Value</td><td>372,900 103.58/SqFt</td></tr> </table>	Selected Valuation Method	Cost Approach	Total Improvement Value	55,134	Land Value	60,944	Total Appraised Value	372,900 103.58/SqFt														
Potential Gross Income (PGI)																																							
Vacancy & Collection Loss																																							
Miscellaneous Income																																							
Effective Gross Income (EGI)																																							
Total Expenses																																							
Net Operating Income (NOI)																																							
Income Capitalization Rate																																							
Indicated Value	0.00																																						
Selected Valuation Method	Cost Approach																																						
Total Improvement Value	55,134																																						
Land Value	60,944																																						
Total Appraised Value	372,900 103.58/SqFt																																						



Rogers

Assessment Property Record Card for Tax Year 2026

Data provided by LISA DELOZIER County Assessor

Date 04/17/2026
 Time 17:54:09
 Page 3

Sketch Image

660083142

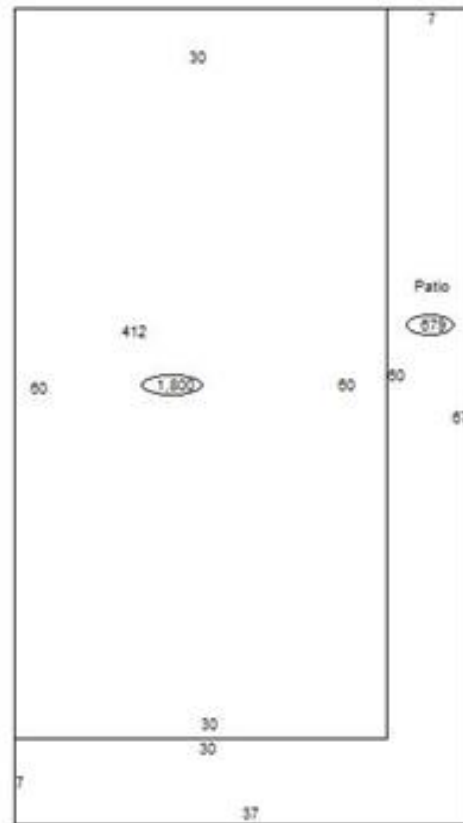

Sketch Vector Information

Sequence	Code	Type	Built Over	Scale	Section Label	Base Area	Multiplier	Total Area
1	C	412		13	412	1,800	1.000	1,800
2	C	412		13	NBHD SHOPPING CENTER	1,800	1.000	1,800
3	M	PATC		13	Patio	679	1.000	679
4	M	PATC		13	Patio	483	1.000	483
Total Building Area						3,600		3,600



Rogers

Assessment Property Record Card for Tax Year 2026

Data provided by LISA DELOZIER County Assessor

Date 04/17/2026
 Time 17:54:09
 Page 4

Account 660083142
 Parcel ID 20N17E-31-4-00000-000-0000
 Cadastral ID 31-20-17-00171

Tax Area Code 19
 Property Class UC
 Owners Name CADILLAC PROPERTIES LLC

Building Data

Building ID 3077
 Building Sequence 1
 Occupancy 1 412 Neighborhood Shopping Ctr 100%
 Occupancy 2
 Occupancy 3
 Total Floor Area 1,800
 Average Perimeter 180
 Number Of Storys 1.00
 Average Wall Ht 10.00
 Year Built 1990
 Effective Age 18
 Construction Class 2 - Heavier Wood or Steel Stud Frame
 Quality 3 - Average
 Condition 3 - Average
 Exterior Wall 71 - Invalid ExteriorWall Code
 Heating/Cooling 8 - Warmed and Cooled Air
 Roof Type Flat
 Roof Cover Tar & Gravel

Basement Area
 Basement Levels
 Basement Finish
 Finish Code - 1
 Finish Area - 1
 Finish Code - 2
 Finish Area - 2

Building Image



Image Information

Image Name 660083142-03.jpg
 Image Date 7/7/2009
 Image Name 660083142-03.jpg
 Description D:\Convert\Photos\660\083\142-03.jpg

Cost Calculations

Appraisal Zone 3
 Zone Description
 Base Cost 79.89
 Wall Cost 5.22
 HVAC Cost 13.70
 Basement Cost 0.00
 Total Base Cost 98.81
 Total Area 1,800
 Base RCN 177,858
 Misc Impr Value 7,269

Manual Date 01/2025
 Base Year 2026
 Modifier Value
 Total Replacement Cost 185,127
 Physical Depreciation 34%
 Functional Depreciation
 Total Depreciation 34% (62,943)
 Total RCNLD 122,184
 Lump Sums
 Total Building Value 122,184 \$ 67.88 Per SqFt

Miscellaneous Improvements

Code	Description	Year	Size	Units	Unit Cost	Depr	Value
PATC	Patio - Covered		69x7	483	15.05		7,269
Total Misc Improvement							7,269

Building Modifiers

Code	Description	Units - 1	Units - 2	Units - 3	Modifier Value
	Stud Brick Veneer	Area/Percent	10%		9,392
Total Modifier Value					9,392



Rogers

Assessment Property Record Card for Tax Year 2026

Data provided by LISA DELOZIER County Assessor

Date 04/17/2026
 Time 17:54:09
 Page 5

Account 660083142
 Parcel ID 20N17E-31-4-00000-000-0000
 Cadastral ID 31-20-17-00171

Tax Area Code 19
 Property Class UC
 Owners Name CADILLAC PROPERTIES LLC

Building Data

Building ID 1818
 Building Sequence 2
 Occupancy 1 412 Neighborhood Shopping Ctr 100%
 Occupancy 2
 Occupancy 3
 Total Floor Area 1,800
 Average Perimeter 180
 Number Of Storys 1.00
 Average Wall Ht 8.00
 Year Built 1995
 Effective Age 16
 Construction Class 2 - Heavier Wood or Steel Stud Frame
 Quality 3 - Average
 Condition 3 - Average
 Exterior Wall 71 - Invalid ExteriorWall Code
 Heating/Cooling 8 - Warmed and Cooled Air
 Roof Type Flat
 Roof Cover Tar & Gravel

Basement Area
 Basement Levels
 Basement Finish
 Finish Code - 1
 Finish Area - 1
 Finish Code - 2
 Finish Area - 2

Building Image



Image Information

Image Name 660083142-01.jpg
 Image Date 7/7/2009
 Image Name 660083142-01.jpg
 Description D:\Convert\Photos\660\083\142-01.jpg

Cost Calculations

Appraisal Zone 3
 Zone Description
 Base Cost 79.89
 Wall Cost 4.62
 HVAC Cost 13.70
 Basement Cost 0.00
 Total Base Cost 98.21
 Total Area 1,800
 Base RCN 176,778
 Misc Impr Value 10,219

Manual Date 01/2025
 Base Year 2026
 Modifier Value
 Total Replacement Cost 186,997
 Physical Depreciation 28%
 Functional Depreciation
 Total Depreciation 28% (52,359)
 Total RCNLD 134,638
 Lump Sums
 Total Building Value 134,638 \$ 74.80 Per SqFt

Miscellaneous Improvements

Code	Description	Year	Size	Units	Unit Cost	Depr	Value
PATC	Patio - Covered		679	679	15.05		10,219
Total Misc Improvement							10,219

Building Modifiers

Code	Description	Units - 1	Units - 2	Units - 3	Modifier Value
	Stud Brick Veneer	Area/Percent	10%		8,321
Total Modifier Value					8,321



Rogers

Assessment Property Record Card for Tax Year 2026

Data provided by LISA DELOZIER County Assessor

Date 04/17/2026

Time 17:54:09

Page 6

660083142

Outbuildings/Site Improvements

Building Image	Code	Description	Dimensions	Floor	Roofing	Total Units
	PAVA	Paving - Asphalt	0x0x0			9,100
	Qual 4	Cond 4	Year 2010	Eff Age	6	
Valuation Summary		Modifier Total		RCN	Depr (% Phys/ % Func)	RCNLD
Base Cost (3.48 x 9,100)				31,668	16,151	15,517
COL	EXT WALKIN COOLER 7X16		0x0x0			112
Qual 3	Cond 3	Year 2000	Eff Age			
Valuation Summary		Modifier Total		RCN	Depr (% Phys/ % Func)	RCNLD
Base Cost (184.42 x 112)				20,655		20,655
COL	EXT WALKIN COLLER 6X10		0x0x0			60
Qual 3	Cond 3	Year 2000	Eff Age			
Valuation Summary		Modifier Total		RCN	Depr (% Phys/ % Func)	RCNLD
Base Cost (225.46 x 60)				13,528		13,528
BBRD	Billboard		0x0x0			20
Qual	Cond	Year	Eff Age			
Valuation Summary		Modifier Total		RCN	Depr (% Phys/ % Func)	RCNLD
Base Cost (61.74 x 20)				1,235		1,235
BBRD	Billboard		0x0x0			28
Qual	Cond	Year	Eff Age			
Valuation Summary		Modifier Total		RCN	Depr (% Phys/ % Func)	RCNLD
Base Cost (61.74 x 28)				1,729		1,729
BBRD	Billboard		0x0x0			40
Qual	Cond	Year	Eff Age			
Valuation Summary		Modifier Total		RCN	Depr (% Phys/ % Func)	RCNLD
Base Cost (61.74 x 40)				2,470		2,470
Total Site Improvement Value						55,134