



Rogers

Assessment Property Record Card for Tax Year 2026

Data provided by LISA DELOZIER County Assessor

Date 04/18/2026
 Time 07:25:36
 Page 1

Assessment Data					Primary Image																																																																																																																				
Account 660083226 Parcel ID 23N17E-16-3-00000-000-0000 Cadastral ID 16-23-17-01061 Property Type REAL - Real Property Property Class RA VI Area 2 Tax Area 71 - CHELSEA RURAL/FOYIL FIRE Name ID 305362 BICKELL, JERRY L & KRISTA R 9721 S 4210 RD CHELSEA OK 74016-0000 Parcel Location Situs 09721 S 4210 RD Subdivision Lot/Block / Parcel Size 5 - Acres Sec/Twn/Rng 16 / 23 / 17 / 3 Neighborhood 4050 - CHELSEA FOYIL RURAL School District S003 - CHELSEA SCHOOLS																																																																																																																									
Legal Description S/2 SW/4 NW/4 SW/4 Lat/Long: 36.47078918 -95.50633469																																																																																																																									
					Building Permits <table border="1"> <thead> <tr> <th>Number</th> <th>Description</th> <th>Opened</th> <th>Closed</th> <th>Amount</th> </tr> </thead> <tbody> <tr> <td>R4</td> <td>R5 FOR IMPROVEMENTS</td> <td>02/2004</td> <td>01/2005</td> <td></td> </tr> </tbody> </table>					Number	Description	Opened	Closed	Amount	R4	R5 FOR IMPROVEMENTS	02/2004	01/2005																																																																																																							
Number	Description	Opened	Closed	Amount																																																																																																																					
R4	R5 FOR IMPROVEMENTS	02/2004	01/2005																																																																																																																						
Exemptions <table border="1"> <thead> <tr> <th>Code</th> <th>Type</th> <th>Active</th> <th>Maximum</th> <th>Exemption</th> </tr> </thead> <tbody> <tr> <td>H</td> <td>Homestead</td> <td>Yes</td> <td>1,000</td> <td>1,000</td> </tr> </tbody> </table>					Code	Type	Active	Maximum	Exemption	H	Homestead	Yes	1,000	1,000	Sale History <table border="1"> <thead> <tr> <th>Bk/Pg</th> <th>Grantor</th> <th>Date</th> <th>Price</th> <th>Code</th> </tr> </thead> <tbody> <tr> <td>2188/567</td> <td>BICKELL, JERRY L</td> <td>08/17/2011</td> <td>0</td> <td>4</td> </tr> <tr> <td>1552/282</td> <td>BICKELL, JERRY L</td> <td>12/24/2003</td> <td>0</td> <td>11</td> </tr> </tbody> </table>					Bk/Pg	Grantor	Date	Price	Code	2188/567	BICKELL, JERRY L	08/17/2011	0	4	1552/282	BICKELL, JERRY L	12/24/2003	0	11																																																																																							
Code	Type	Active	Maximum	Exemption																																																																																																																					
H	Homestead	Yes	1,000	1,000																																																																																																																					
Bk/Pg	Grantor	Date	Price	Code																																																																																																																					
2188/567	BICKELL, JERRY L	08/17/2011	0	4																																																																																																																					
1552/282	BICKELL, JERRY L	12/24/2003	0	11																																																																																																																					
Parcel Valuation <table border="1"> <thead> <tr> <th>Source</th> <th>REAL</th> <th>Fair Cash</th> <th>Capped</th> <th>Asmnt Level</th> <th>Assessed</th> <th>Levy Rate</th> <th>95.740</th> <th>Current Tax</th> </tr> </thead> <tbody> <tr> <td>Remove Cap</td> <td>0</td> <td>Land Value 960</td> <td>960</td> <td>11%</td> <td>106</td> <td>Assessed</td> <td>7,321</td> <td>700.91</td> </tr> <tr> <td>Year Frozen</td> <td>0</td> <td>Improvements 135,178</td> <td>65,590</td> <td></td> <td>7,215</td> <td>Penalty</td> <td>0</td> <td></td> </tr> <tr> <td>Uncapped Value</td> <td>0</td> <td>Mobile Home 0</td> <td>0</td> <td></td> <td>0</td> <td>Exemption</td> <td>1,000</td> <td>-83.00</td> </tr> <tr> <td>TIF Project ID</td> <td>0</td> <td>Total Value 136,138</td> <td>66,550</td> <td></td> <td>7,321</td> <td>Total Taxable</td> <td>6,321</td> <td>618.00</td> </tr> </tbody> </table>										Source	REAL	Fair Cash	Capped	Asmnt Level	Assessed	Levy Rate	95.740	Current Tax	Remove Cap	0	Land Value 960	960	11%	106	Assessed	7,321	700.91	Year Frozen	0	Improvements 135,178	65,590		7,215	Penalty	0		Uncapped Value	0	Mobile Home 0	0		0	Exemption	1,000	-83.00	TIF Project ID	0	Total Value 136,138	66,550		7,321	Total Taxable	6,321	618.00																																																																			
Source	REAL	Fair Cash	Capped	Asmnt Level	Assessed	Levy Rate	95.740	Current Tax																																																																																																																	
Remove Cap	0	Land Value 960	960	11%	106	Assessed	7,321	700.91																																																																																																																	
Year Frozen	0	Improvements 135,178	65,590		7,215	Penalty	0																																																																																																																		
Uncapped Value	0	Mobile Home 0	0		0	Exemption	1,000	-83.00																																																																																																																	
TIF Project ID	0	Total Value 136,138	66,550		7,321	Total Taxable	6,321	618.00																																																																																																																	
Assessment History <table border="1"> <thead> <tr> <th>Tax Year</th> <th>Statement Number</th> <th>Billed Owner</th> <th>Tax Area</th> <th>Total Value</th> <th>Exemptions</th> <th>Taxable Value</th> <th>Billed Tax</th> </tr> </thead> <tbody> <tr><td>2025</td><td>2025-660083226</td><td>BICKELL, JERRY L &</td><td>71</td><td>135,811</td><td>1000</td><td>6,108</td><td>597.00</td></tr> <tr><td>2024</td><td>2024-660083226</td><td>BICKELL, JERRY L &</td><td>71</td><td>91,836</td><td>1000</td><td>5,901</td><td>589.00</td></tr> <tr><td>2023</td><td>2023-660083226</td><td>BICKELL, JERRY L &</td><td>71</td><td>77,698</td><td>1000</td><td>5,700</td><td>576.00</td></tr> <tr><td>2022</td><td>2022-660083226</td><td>BICKELL, JERRY L &</td><td>71</td><td>78,691</td><td>1000</td><td>5,505</td><td>560.00</td></tr> <tr><td>2021</td><td>2021-660083226</td><td>BICKELL, JERRY L &</td><td>71</td><td>76,657</td><td>1000</td><td>5,315</td><td>545.00</td></tr> <tr><td>2020</td><td>2020-660083226</td><td>BICKELL, JERRY L &</td><td>71</td><td>81,518</td><td>1000</td><td>5,131</td><td>533.00</td></tr> <tr><td>2019</td><td>2019-660083226</td><td>BICKELL, JERRY L &</td><td>71</td><td>78,662</td><td>1000</td><td>4,953</td><td>524.00</td></tr> <tr><td>2018</td><td>2018-660083226</td><td>BICKELL, JERRY L &</td><td>71</td><td>85,413</td><td>1000</td><td>4,780</td><td>501.00</td></tr> <tr><td>2017</td><td>2017-660083226</td><td>BICKELL, JERRY L &</td><td>71</td><td>84,578</td><td>1000</td><td>4,611</td><td>489.00</td></tr> <tr><td>2016</td><td>2016-660083226</td><td>BICKELL, JERRY L &</td><td>71</td><td>82,952</td><td>1000</td><td>4,448</td><td>480.00</td></tr> <tr><td>2015</td><td>2015-660083226</td><td>BICKELL, JERRY L &</td><td>71</td><td>80,944</td><td>1000</td><td>4,289</td><td>457.00</td></tr> <tr><td>2014</td><td>2014-660083226</td><td>BICKELL, JERRY L &</td><td>71</td><td>82,977</td><td>1000</td><td>4,135</td><td>455.00</td></tr> <tr><td>2013</td><td>2013-660083226</td><td>BICKELL, JERRY L &</td><td>71</td><td>79,822</td><td>1000</td><td>3,986</td><td>433.00</td></tr> </tbody> </table>										Tax Year	Statement Number	Billed Owner	Tax Area	Total Value	Exemptions	Taxable Value	Billed Tax	2025	2025-660083226	BICKELL, JERRY L &	71	135,811	1000	6,108	597.00	2024	2024-660083226	BICKELL, JERRY L &	71	91,836	1000	5,901	589.00	2023	2023-660083226	BICKELL, JERRY L &	71	77,698	1000	5,700	576.00	2022	2022-660083226	BICKELL, JERRY L &	71	78,691	1000	5,505	560.00	2021	2021-660083226	BICKELL, JERRY L &	71	76,657	1000	5,315	545.00	2020	2020-660083226	BICKELL, JERRY L &	71	81,518	1000	5,131	533.00	2019	2019-660083226	BICKELL, JERRY L &	71	78,662	1000	4,953	524.00	2018	2018-660083226	BICKELL, JERRY L &	71	85,413	1000	4,780	501.00	2017	2017-660083226	BICKELL, JERRY L &	71	84,578	1000	4,611	489.00	2016	2016-660083226	BICKELL, JERRY L &	71	82,952	1000	4,448	480.00	2015	2015-660083226	BICKELL, JERRY L &	71	80,944	1000	4,289	457.00	2014	2014-660083226	BICKELL, JERRY L &	71	82,977	1000	4,135	455.00	2013	2013-660083226	BICKELL, JERRY L &	71	79,822	1000	3,986	433.00
Tax Year	Statement Number	Billed Owner	Tax Area	Total Value	Exemptions	Taxable Value	Billed Tax																																																																																																																		
2025	2025-660083226	BICKELL, JERRY L &	71	135,811	1000	6,108	597.00																																																																																																																		
2024	2024-660083226	BICKELL, JERRY L &	71	91,836	1000	5,901	589.00																																																																																																																		
2023	2023-660083226	BICKELL, JERRY L &	71	77,698	1000	5,700	576.00																																																																																																																		
2022	2022-660083226	BICKELL, JERRY L &	71	78,691	1000	5,505	560.00																																																																																																																		
2021	2021-660083226	BICKELL, JERRY L &	71	76,657	1000	5,315	545.00																																																																																																																		
2020	2020-660083226	BICKELL, JERRY L &	71	81,518	1000	5,131	533.00																																																																																																																		
2019	2019-660083226	BICKELL, JERRY L &	71	78,662	1000	4,953	524.00																																																																																																																		
2018	2018-660083226	BICKELL, JERRY L &	71	85,413	1000	4,780	501.00																																																																																																																		
2017	2017-660083226	BICKELL, JERRY L &	71	84,578	1000	4,611	489.00																																																																																																																		
2016	2016-660083226	BICKELL, JERRY L &	71	82,952	1000	4,448	480.00																																																																																																																		
2015	2015-660083226	BICKELL, JERRY L &	71	80,944	1000	4,289	457.00																																																																																																																		
2014	2014-660083226	BICKELL, JERRY L &	71	82,977	1000	4,135	455.00																																																																																																																		
2013	2013-660083226	BICKELL, JERRY L &	71	79,822	1000	3,986	433.00																																																																																																																		



Rogers

Assessment Property Record Card for Tax Year 2026

Data provided by LISA DELOZIER County Assessor

Date 04/18/2026
 Time 07:25:36
 Page 2

Lot Data	Primary Image
Lot Size Lot Count Units Buildable Non-Ag Acres 0 Topography Street Access Utilities Amenities LAND QUALITY Method Base Lot Value Factor Value Adjustments Lot Value	

Residential Data	
Type	1 Single Family Residence
Condition	3 - Average
Quality	3.5 - Average
Architecture	TRAD TRADITIONAL
Style	100% One Story
Exterior Wall	100% Frame, Siding, Vinyl
Base/Total Area	2,544 / 2,544
Style	100% One Story
HVAC	100% Warmed & Cooled Air
Roof Cover	4 Metal, Preformed
Area on Slab	0
Fixture/RghIn	4 /
Bed/F/H Bath	3 / 1.0 /
Basement Area	
Garage Type	
Remodel	RMA -
Year/Eff Age	1950 / 57

\\tsclient\C\Users\Randy Necessary\Pictures\2020-09-08\IMG_005: 9/10/2020	
---	--

GRM Approach	
GRM Code	
Gross Rent	0.00
Indicated Value	

Multiple Regression	
MRA Code	
Adusted R	
Indicated Value	

Direct Comparables	
Selection Model	1 Res
Adjustment Model	A2 AO Test
Comparables	
Indicated Value	

Cost Approach				Manual : 01/2025			
Base Cost	93.02	Total Misc Impr	+	6,693			
Roofing Adj	+ 5.66	Garage Cost	+				
Subfloor Adj	+ 0.00	Total RCN	=	300,703			
Heat/Cool Adj	+ 14.18	Depreciation (60%)	-	180,422			
Plumbing Adj	+ 2.70	Lump Sums	+	0			
Basement Adj	+ 0.00	RCNLD	=	120,281			
Adj Base Cost	= 115.57	Lot Value	+				
Total Area	x 2,544	Indicated Value	=	120,281			
Adjusted Cost	= 294,010	Value Per SqFt		47.28			

Value Reconciliation			
Selected Approach	Cost Approach		
Improvements	120,281		
Lot Value			
Indicated Value	120,281	47.28	Per SqFt
Agland Value	960		
Site Improvements	14,897		
Total Value	136,138	53.51	Total Value Per SqFt

Miscellaneous Improvements								
Code	Description	Sketch ID	Size	Year	Units	Unit Cost	Depr	Value
PRCH	SLAB PORCH - COVERED	100730	13x8		104	28.61		2,975
PRCH	SLAB PORCH - COVERED	116403	10x8		80	28.68		2,294
LTW	LEAN-TO (WD FRAME)	116404	42x10		420	3.39		1,424



Rogers
Assessment Property Record Card for Tax Year 2026

Data provided by LISA DELOZIER County Assessor

Date 04/18/2026
 Time 07:25:36
 Page 3

Sketch Image

660083226

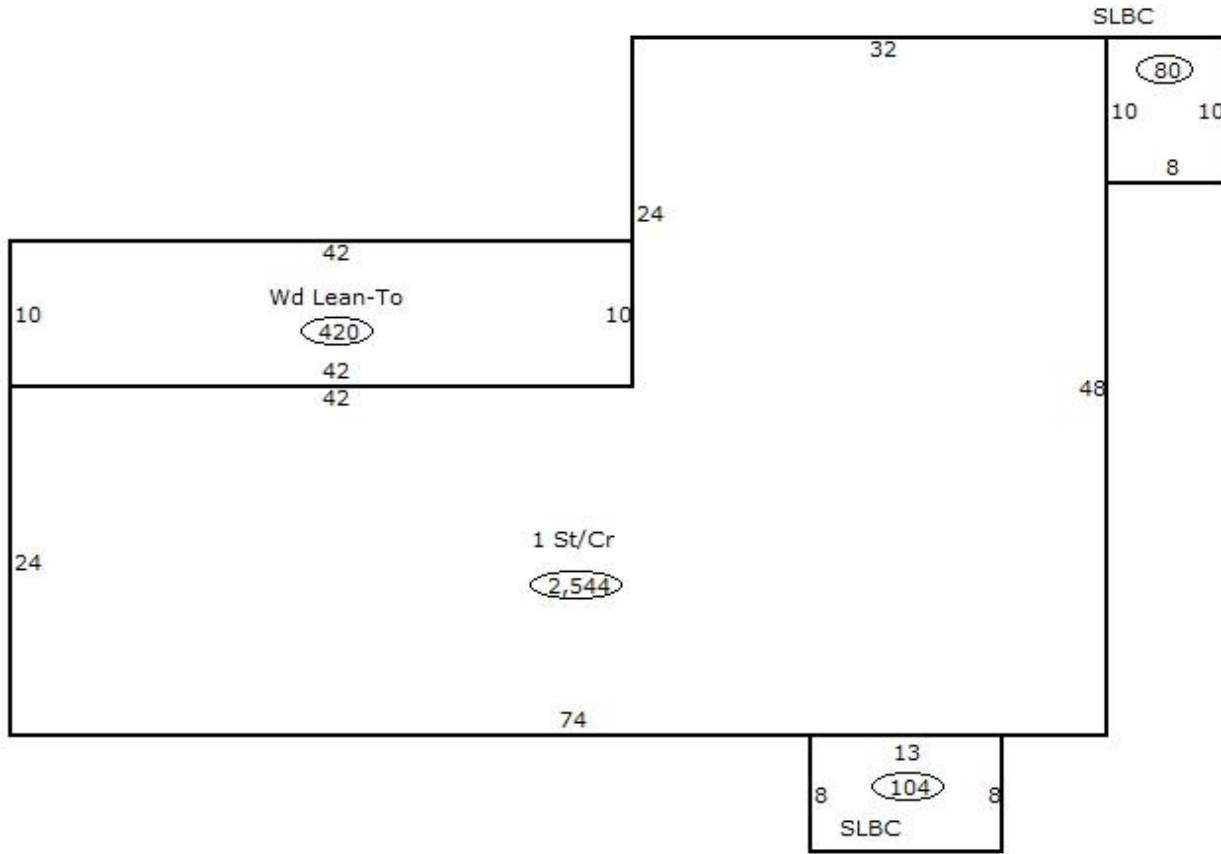

Sketch Vector Information

Sequence	Code	Type	Built Over	Scale	Section Label	Base Area	Multiplier	Total Area
1	R	1	Crawl	13	1 St/Cr	2,544	1.000	2,544
2	M	PRCH		13	SLBC	104	1.000	104
3	M	PRCH		13	SLBC	80	1.000	80
4	M	LTW		13	Wd Lean-To	420	1.000	420
Total Building Area						2,544		2,544



Rogers

Assessment Property Record Card for Tax Year 2026

Data provided by LISA DELOZIER County Assessor

Date 04/18/2026
 Time 07:25:36
 Page 4

660083226

Outbuildings/Site Improvements

Building Image	Code	Description	Dimensions	Floor	Roofing	Total Units	
	UTIL	SHOP BUILDING	42x26x8	Dirt	Formed Metal	1,092	
	Qual	2	Cond 2	Year 2000	Eff Age 26		
	Valuation Summary		Modifier Total	RCN	Depr (54% Phys/ % Func)		RCNLD
	Base Cost (24.32 x 1,092)		26,557		26,557	14,341	12,216
	LNT0	LEAN-TO	42x18x8	Dirt	Formed Metal	756	
	Qual	2	Cond 2	Year 2000	Eff Age 26		
	Valuation Summary		Modifier Total	RCN	Depr (80% Phys/ % Func)		RCNLD
	Base Cost (6.90 x 756)		5,216		5,216	4,173	1,043
	CPDT	Carport Dirt	12x14x8	Dirt	Formed Metal	168	
	Qual	2	Cond 2	Year 2000	Eff Age 26		
	Valuation Summary		Modifier Total	RCN	Depr (80% Phys/ % Func)		RCNLD
	Base Cost (4.83 x 168)		811		811	649	162
	LNT0	LEAN-TO	42x18x8	Dirt	Formed Metal	756	
	Qual	2	Cond 2	Year 1980	Eff Age 46		
	Valuation Summary		Modifier Total	RCN	Depr (80% Phys/ % Func)		RCNLD
	Base Cost (6.90 x 756)		5,216		5,216	4,173	1,043
	LOAF	LOAFING SHED	12x30x8	Dirt	Formed Metal	360	
	Qual	2	Cond 2	Year 1980	Eff Age 46		
	Valuation Summary		Modifier Total	RCN	Depr (80% Phys/ % Func)		RCNLD
	Base Cost (6.01 x 360)		2,164		2,164	1,731	433



Rogers

Assessment Property Record Card for Tax Year 2026

Data provided by LISA DELOZIER County Assessor

Date 04/18/2026
Time 07:25:36
Page 5

Agland Inventory

660083226

Soi	Description	Land Use	LPI	Adj Type	Adj Code	Acres	Use/Acre	Mkt/Acre	Use Value	Market Value
OKB	OKEMAH SILTY CLAY LOAM 1-	NTV PST	80			5.000	192	192	960	960
NTV PST Totals						5.000			960	960
Total Agland						5.000			960	960