



Rogers

Assessment Property Record Card for Tax Year 2026

Data provided by LISA DELOZIER County Assessor

Date 04/18/2026
Time 07:16:06
Page 1

Assessment Data					Primary Image																																																																																																																				
Account 660083541 Parcel ID 000000-00-0-00796-001-0007 Cadastral ID 14-21-15-03580 Property Type REAL - Real Property Property Class RRP VI Area 4 Tax Area 18 - CLAREMORE RURAL/W/O FIRE Name ID 305680 DUNLAP, JAMES R & DEBRA H REVOCABLE LIVING TRUST 21500 S CALEN DR CLAREMORE OK 74019-0000 Parcel Location Situs 21500 S CALEN DR Subdivision SUNNY SIDE Lot/Block 0007 / 0001 Parcel Size 1 - Lots Sec/Twn/Rng 14 / 21 / 15 / 5 Neighborhood 1089 - R-V03,4-SE CLAREMORE School District S001 - CLAREMORE SCHOOLS																																																																																																																									
Legal Description Lot/Long: 36.29977862 -95.67308975																																																																																																																									
Building Permits					<table border="1"> <thead> <tr> <th>Number</th> <th>Description</th> <th>Opened</th> <th>Closed</th> <th>Amount</th> </tr> </thead> <tbody> <tr> <td> </td> <td> </td> <td> </td> <td> </td> <td> </td> </tr> </tbody> </table>					Number	Description	Opened	Closed	Amount																																																																																																											
Number	Description	Opened	Closed	Amount																																																																																																																					
Exemptions					Sale History																																																																																																																				
<table border="1"> <thead> <tr> <th>Code</th> <th>Type</th> <th>Active</th> <th>Maximum</th> <th>Exemption</th> </tr> </thead> <tbody> <tr> <td>H</td> <td>Homestead</td> <td>Yes</td> <td>1,000</td> <td>1,000</td> </tr> </tbody> </table>					Code	Type	Active	Maximum	Exemption	H	Homestead	Yes	1,000	1,000	<table border="1"> <thead> <tr> <th>Bk/Pg</th> <th>Grantor</th> <th>Date</th> <th>Price</th> <th>Code</th> </tr> </thead> <tbody> <tr> <td>2198/830</td> <td>FEDERAL HOME LOAN MORT-CORP</td> <td>09/23/2011</td> <td>179,000</td> <td>YES</td> </tr> <tr> <td>2179/888</td> <td>TURNHAM, TERESA E</td> <td>06/23/2011</td> <td>0</td> <td>10</td> </tr> <tr> <td>1712/390</td> <td>BLUEBIRD CONTRACTORS, LLC</td> <td>09/19/2005</td> <td>0</td> <td>4</td> </tr> </tbody> </table>					Bk/Pg	Grantor	Date	Price	Code	2198/830	FEDERAL HOME LOAN MORT-CORP	09/23/2011	179,000	YES	2179/888	TURNHAM, TERESA E	06/23/2011	0	10	1712/390	BLUEBIRD CONTRACTORS, LLC	09/19/2005	0	4																																																																																		
Code	Type	Active	Maximum	Exemption																																																																																																																					
H	Homestead	Yes	1,000	1,000																																																																																																																					
Bk/Pg	Grantor	Date	Price	Code																																																																																																																					
2198/830	FEDERAL HOME LOAN MORT-CORP	09/23/2011	179,000	YES																																																																																																																					
2179/888	TURNHAM, TERESA E	06/23/2011	0	10																																																																																																																					
1712/390	BLUEBIRD CONTRACTORS, LLC	09/19/2005	0	4																																																																																																																					
Parcel Valuation																																																																																																																									
<table border="1"> <thead> <tr> <th>Source</th> <th>REAL</th> <th>Fair Cash</th> <th>Capped</th> <th>Asmnt Level</th> <th>Assessed</th> <th>Levy Rate</th> <th>92.430</th> <th>Current Tax</th> </tr> </thead> <tbody> <tr> <td>Remove Cap</td> <td>0</td> <td>Land Value 74,339</td> <td>42,793</td> <td>11%</td> <td>4,707</td> <td>Assessed</td> <td>21,199</td> <td>1,959.42</td> </tr> <tr> <td>Year Frozen</td> <td>2018</td> <td>Improvements 260,447</td> <td>149,926</td> <td></td> <td>16,492</td> <td>Penalty</td> <td>0</td> <td></td> </tr> <tr> <td>Uncapped Value</td> <td>0</td> <td>Mobile Home 0</td> <td>0</td> <td></td> <td>0</td> <td>Exemption</td> <td>1,000</td> <td>-92.00</td> </tr> <tr> <td>TIF Project ID</td> <td>0</td> <td>Total Value 334,786</td> <td>192,719</td> <td></td> <td>21,199</td> <td>Total Taxable</td> <td>20,199</td> <td>1,867.00</td> </tr> </tbody> </table>		Source	REAL	Fair Cash	Capped	Asmnt Level	Assessed	Levy Rate	92.430	Current Tax	Remove Cap	0	Land Value 74,339	42,793	11%	4,707	Assessed	21,199	1,959.42	Year Frozen	2018	Improvements 260,447	149,926		16,492	Penalty	0		Uncapped Value	0	Mobile Home 0	0		0	Exemption	1,000	-92.00	TIF Project ID	0	Total Value 334,786	192,719		21,199	Total Taxable	20,199	1,867.00																																																																											
Source	REAL	Fair Cash	Capped	Asmnt Level	Assessed	Levy Rate	92.430	Current Tax																																																																																																																	
Remove Cap	0	Land Value 74,339	42,793	11%	4,707	Assessed	21,199	1,959.42																																																																																																																	
Year Frozen	2018	Improvements 260,447	149,926		16,492	Penalty	0																																																																																																																		
Uncapped Value	0	Mobile Home 0	0		0	Exemption	1,000	-92.00																																																																																																																	
TIF Project ID	0	Total Value 334,786	192,719		21,199	Total Taxable	20,199	1,867.00																																																																																																																	
Assessment History																																																																																																																									
<table border="1"> <thead> <tr> <th>Tax Year</th> <th>Statement Number</th> <th>Billed Owner</th> <th>Tax Area</th> <th>Total Value</th> <th>Exemptions</th> <th>Taxable Value</th> <th>Billed Tax</th> </tr> </thead> <tbody> <tr><td>2025</td><td>2025-660083541</td><td>DUNLAP, JAMES R & DEBRA H</td><td>18</td><td>330,661</td><td>1000</td><td>20,199</td><td>1,867.00</td></tr> <tr><td>2024</td><td>2024-660083541</td><td>DUNLAP, JAMES R & DEBRA H</td><td>18</td><td>349,219</td><td>1000</td><td>20,200</td><td>1,867.00</td></tr> <tr><td>2023</td><td>2023-660083541</td><td>DUNLAP, JAMES R & DEBRA H</td><td>18</td><td>229,803</td><td>1000</td><td>20,199</td><td>1,850.00</td></tr> <tr><td>2022</td><td>2022-660083541</td><td>DUNLAP, JAMES R & DEBRA H</td><td>18</td><td>229,793</td><td>1000</td><td>20,199</td><td>1,870.00</td></tr> <tr><td>2021</td><td>2021-660083541</td><td>DUNLAP, JAMES R & DEBRA H</td><td>18</td><td>204,530</td><td>1000</td><td>20,199</td><td>1,784.00</td></tr> <tr><td>2020</td><td>2020-660083541</td><td>DUNLAP, JAMES &</td><td>18</td><td>201,155</td><td>1000</td><td>20,199</td><td>1,850.00</td></tr> <tr><td>2019</td><td>2019-660083541</td><td>DUNLAP, JAMES &</td><td>18</td><td>192,892</td><td>1000</td><td>20,200</td><td>1,871.00</td></tr> <tr><td>2018</td><td>2018-660083541</td><td>DUNLAP, JAMES &</td><td>18</td><td>192,719</td><td>1000</td><td>20,199</td><td>1,866.00</td></tr> <tr><td>2017</td><td>2017-660083541</td><td>DUNLAP, JAMES &</td><td>18</td><td>191,075</td><td>1000</td><td>20,018</td><td>1,836.00</td></tr> <tr><td>2016</td><td>2016-660083541</td><td>DUNLAP, JAMES &</td><td>18</td><td>186,069</td><td>1000</td><td>19,468</td><td>1,825.00</td></tr> <tr><td>2015</td><td>2015-660083541</td><td>DUNLAP, JAMES &</td><td>18</td><td>181,602</td><td>1000</td><td>18,976</td><td>1,708.00</td></tr> <tr><td>2014</td><td>2014-660083541</td><td>DUNLAP, JAMES &</td><td>18</td><td>202,284</td><td>1000</td><td>20,032</td><td>1,858.00</td></tr> <tr><td>2013</td><td>2013-660083541</td><td>DUNLAP, JAMES &</td><td>18</td><td>189,815</td><td>1000</td><td>19,420</td><td>1,777.00</td></tr> </tbody> </table>										Tax Year	Statement Number	Billed Owner	Tax Area	Total Value	Exemptions	Taxable Value	Billed Tax	2025	2025-660083541	DUNLAP, JAMES R & DEBRA H	18	330,661	1000	20,199	1,867.00	2024	2024-660083541	DUNLAP, JAMES R & DEBRA H	18	349,219	1000	20,200	1,867.00	2023	2023-660083541	DUNLAP, JAMES R & DEBRA H	18	229,803	1000	20,199	1,850.00	2022	2022-660083541	DUNLAP, JAMES R & DEBRA H	18	229,793	1000	20,199	1,870.00	2021	2021-660083541	DUNLAP, JAMES R & DEBRA H	18	204,530	1000	20,199	1,784.00	2020	2020-660083541	DUNLAP, JAMES &	18	201,155	1000	20,199	1,850.00	2019	2019-660083541	DUNLAP, JAMES &	18	192,892	1000	20,200	1,871.00	2018	2018-660083541	DUNLAP, JAMES &	18	192,719	1000	20,199	1,866.00	2017	2017-660083541	DUNLAP, JAMES &	18	191,075	1000	20,018	1,836.00	2016	2016-660083541	DUNLAP, JAMES &	18	186,069	1000	19,468	1,825.00	2015	2015-660083541	DUNLAP, JAMES &	18	181,602	1000	18,976	1,708.00	2014	2014-660083541	DUNLAP, JAMES &	18	202,284	1000	20,032	1,858.00	2013	2013-660083541	DUNLAP, JAMES &	18	189,815	1000	19,420	1,777.00
Tax Year	Statement Number	Billed Owner	Tax Area	Total Value	Exemptions	Taxable Value	Billed Tax																																																																																																																		
2025	2025-660083541	DUNLAP, JAMES R & DEBRA H	18	330,661	1000	20,199	1,867.00																																																																																																																		
2024	2024-660083541	DUNLAP, JAMES R & DEBRA H	18	349,219	1000	20,200	1,867.00																																																																																																																		
2023	2023-660083541	DUNLAP, JAMES R & DEBRA H	18	229,803	1000	20,199	1,850.00																																																																																																																		
2022	2022-660083541	DUNLAP, JAMES R & DEBRA H	18	229,793	1000	20,199	1,870.00																																																																																																																		
2021	2021-660083541	DUNLAP, JAMES R & DEBRA H	18	204,530	1000	20,199	1,784.00																																																																																																																		
2020	2020-660083541	DUNLAP, JAMES &	18	201,155	1000	20,199	1,850.00																																																																																																																		
2019	2019-660083541	DUNLAP, JAMES &	18	192,892	1000	20,200	1,871.00																																																																																																																		
2018	2018-660083541	DUNLAP, JAMES &	18	192,719	1000	20,199	1,866.00																																																																																																																		
2017	2017-660083541	DUNLAP, JAMES &	18	191,075	1000	20,018	1,836.00																																																																																																																		
2016	2016-660083541	DUNLAP, JAMES &	18	186,069	1000	19,468	1,825.00																																																																																																																		
2015	2015-660083541	DUNLAP, JAMES &	18	181,602	1000	18,976	1,708.00																																																																																																																		
2014	2014-660083541	DUNLAP, JAMES &	18	202,284	1000	20,032	1,858.00																																																																																																																		
2013	2013-660083541	DUNLAP, JAMES &	18	189,815	1000	19,420	1,777.00																																																																																																																		



Rogers

Assessment Property Record Card for Tax Year 2026

Data provided by LISA DELOZIER County Assessor

Date 04/18/2026
 Time 07:16:06
 Page 2

Lot Data		Square-Foot - NBHD 1089 #1	
Lot Size			
Lot Count			
Units Buildable	1		
Non-Ag Acres	1.4184		
Topography			
Street Access			
Utilities			
Amenities	LAND QUALITY	0	
		0	
Method	Square-Foot		
Base Lot Value	61,785.00 x 1.20 =	74,339	
Factor Value			
Adjustments	1.0000		
Lot Value		74,339	



\\tsclient\C\Users\Randy Necessary\Pictures\101_0728\IMG_0076. 7/29/2022

Residential Data	
Type	1 Single Family Residence
Condition	3 - Average
Quality	3 - Average
Architecture	
Style	100% One Story
Exterior Wall	20% Veneer, Masonry 80% Frame, Siding, Vinyl
Base/Total Area	2,213 / 2,213
Style	100% One Story
HVAC	100% Warmed & Cooled Air
Roof Cover	1 Composition Shingle
Area on Slab	2,213
Fixture/RghIn	14 /
Bed/F/H Bath	3 / 2.5 /
Basement Area	
Garage Type	670 Attached Garage - Unfinished
Remodel	
Year/Eff Age	2005 / 16

GRM Approach

GRM Code	
Gross Rent	0.00
Indicated Value	

Multiple Regression

MRA Code	1 Test
Adjusted R	0.8445
Indicated Value	283,475 128.10 Per SqFt

Direct Comparables

Selection Model	A Adam Test
Adjustment Model	1 2022 Residential
Comparables	8
Indicated Value	292,420 Per SqFt

Value Reconciliation

Selected Approach	Cost Approach
Improvements	254,820
Lot Value	74,339
Indicated Value	329,159 148.74 Per SqFt
Agland Value	
Site Improvements	5,627
Total Value	334,786 151.28 Total Value Per SqFt

Cost Approach		Manual : 01/2025	
Base Cost	97.95	Total Misc Impr	+ 8,726
Roofing Adj	+ 4.59	Garage Cost	+ 20,174
Subfloor Adj	+ -2.19	Total RCN	= 298,466
Heat/Cool Adj	+ 12.64	Depreciation (17%)	- 50,739
Plumbing Adj	+ 8.82	Lump Sums	+ 7,093
Basement Adj	+ 0.00	RCNLD	= 254,820
Adj Base Cost	= 121.81	Lot Value	+ 74,339
Total Area	x 2,213	Indicated Value	= 329,159
Adjusted Cost	= 269,566	Value Per SqFt	148.74

Miscellaneous Improvements

Code	Description	Sketch ID	Size	Year	Units	Unit Cost	Depr	Value
EPKS	ENCLOSED PORCH - KNEEWALL SCREEN	101691	18x15		270	28.84		7,787
PRCH	SLAB PORCH - COVERED	101693	7x5		35	26.82		939
WODO	WOOD DECK - OPEN	101694	440		440	16.97	5%	7,093



Rogers
Assessment Property Record Card for Tax Year 2026

Data provided by LISA DELOZIER County Assessor

Date 04/18/2026
 Time 07:16:06
 Page 3

Sketch Image

660083541

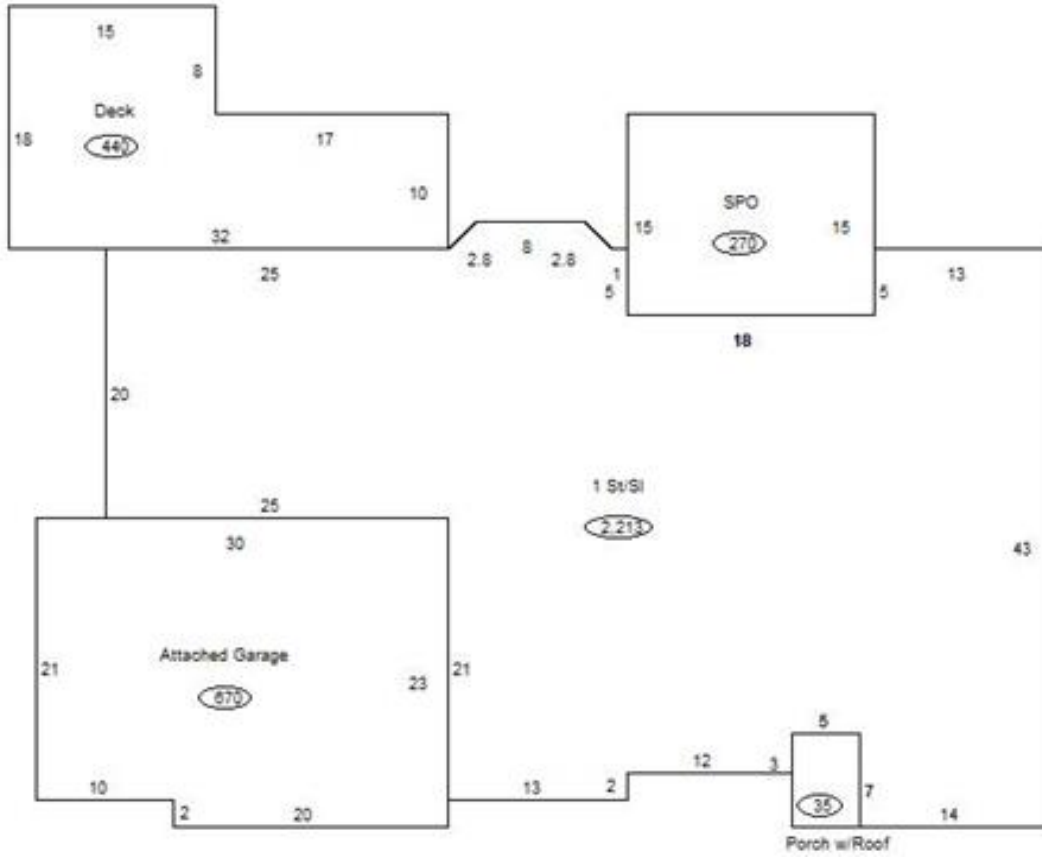

Sketch Vector Information

Sequence	Code	Type	Built Over	Scale	Section Label	Base Area	Multiplier	Total Area
1	R	1	Slab	13	1 St/Sl	2,213	1.000	2,213
2	M	EPKS		13	Screen Porch	270	1.000	270
3	G	1		13	Attached Garage	670	1.000	670
4	M	PRCH		13	SLBC	35	1.000	35
5	M	WODO		13	WODO	440	1.000	440
Total Building Area						2,213		2,213



Rogers



Assessment Property Record Card for Tax Year 2026

Data provided by LISA DELOZIER County Assessor

Date 04/18/2026
 Time 07:16:06
 Page 4

660083541

Outbuildings/Site Improvements

Building Image	Code	Description	Dimensions	Floor	Roofing	Total Units	
	STA	STG AVG	12x20x0			240	
	Qual	3	Cond 3	Year	Eff Age		
	Valuation Summary		Modifier Total		RCN	Depr (10% Phys/ % Func)	RCNLD
Base Cost (7.02 x 240)		1,685			1,685	169	1,516
	CPS	CARPORT SLAB	24x26x0			624	
	Qual	2	Cond 3	Year	Eff Age		
	Valuation Summary		Modifier Total		RCN	Depr (10% Phys/ % Func)	RCNLD
Base Cost (7.32 x 624)		4,568			4,568	457	4,111