



# Rogers

## Assessment Property Record Card for Tax Year 2026

Data provided by LISA DELOZIER County Assessor

Date 04/18/2026  
 Time 08:07:18  
 Page 1

Assessment Data					Primary Image																																																																																																																				
<b>Account</b> 660083546 <b>Parcel ID</b> 000000-00-0-00796-001-0012 <b>Cadastral ID</b> 14-21-15-03630 <b>Property Type</b> REAL - Real Property <b>Property Class</b> RRP VI Area 4 <b>Tax Area</b> 18 - CLAREMORE RURAL/W/O FIRE <b>Name ID</b> 347715 DOWNUM, CARSON OAKLEY & ABBY JO WALKER  21700 S CALEN DR CLAREMORE OK 74019-0000  <b>Parcel Location</b> <b>Situs</b> 21700 S CALEN DR <b>Subdivision</b> SUNNY SIDE <b>Lot/Block</b> 0012 / 0001 <b>Parcel Size</b> 1 - Lots <b>Sec/Twn/Rng</b> 14 / 21 / 15 / 5 <b>Neighborhood</b> 1089 - R-V03,4-SE CLAREMORE <b>School District</b> S001 - CLAREMORE SCHOOLS																																																																																																																									
<b>Legal Description</b> Lot/Long: 36.29705273 -95.67238888																																																																																																																									
<b>Legal Description</b> LOT 12 BLOCK 1 SUNNY SIDE					<b>Building Permits</b> <table border="1"> <thead> <tr> <th>Number</th> <th>Description</th> <th>Opened</th> <th>Closed</th> <th>Amount</th> </tr> </thead> <tbody> <tr> <td> </td> <td> </td> <td> </td> <td> </td> <td> </td> </tr> </tbody> </table>					Number	Description	Opened	Closed	Amount																																																																																																											
Number	Description	Opened	Closed	Amount																																																																																																																					
<b>Exemptions</b> <table border="1"> <thead> <tr> <th>Code</th> <th>Type</th> <th>Active</th> <th>Maximum</th> <th>Exemption</th> </tr> </thead> <tbody> <tr> <td>H</td> <td>Homestead</td> <td>No</td> <td>1,000</td> <td> </td> </tr> </tbody> </table>					Code	Type	Active	Maximum	Exemption	H	Homestead	No	1,000		<b>Sale History</b> <table border="1"> <thead> <tr> <th>Bk/Pg</th> <th>Grantor</th> <th>Date</th> <th>Price</th> <th>Code</th> </tr> </thead> <tbody> <tr> <td>/</td> <td>HERNDON, ANDREW R &amp;</td> <td>07/29/2025</td> <td>260,000</td> <td>YES</td> </tr> <tr> <td>/</td> <td>BRUNS, MICHAEL J</td> <td>09/25/2019</td> <td>150,000</td> <td>YES</td> </tr> <tr> <td>2316/177</td> <td>DAKE PROPERTIES INC</td> <td>03/27/2013</td> <td>135,000</td> <td>YES</td> </tr> <tr> <td>2291/276</td> <td>UNITED STATE OF AMERICA</td> <td>12/07/2012</td> <td>0</td> <td>1</td> </tr> <tr> <td>2219/650</td> <td>GRAHAM, LONNIE W</td> <td>11/10/2011</td> <td>0</td> <td>10</td> </tr> <tr> <td>1751/29</td> <td>BLUEBIRD CONTRACTORS, LLC</td> <td>02/13/2006</td> <td>119,000</td> <td>YES</td> </tr> </tbody> </table>					Bk/Pg	Grantor	Date	Price	Code	/	HERNDON, ANDREW R &	07/29/2025	260,000	YES	/	BRUNS, MICHAEL J	09/25/2019	150,000	YES	2316/177	DAKE PROPERTIES INC	03/27/2013	135,000	YES	2291/276	UNITED STATE OF AMERICA	12/07/2012	0	1	2219/650	GRAHAM, LONNIE W	11/10/2011	0	10	1751/29	BLUEBIRD CONTRACTORS, LLC	02/13/2006	119,000	YES																																																																			
Code	Type	Active	Maximum	Exemption																																																																																																																					
H	Homestead	No	1,000																																																																																																																						
Bk/Pg	Grantor	Date	Price	Code																																																																																																																					
/	HERNDON, ANDREW R &	07/29/2025	260,000	YES																																																																																																																					
/	BRUNS, MICHAEL J	09/25/2019	150,000	YES																																																																																																																					
2316/177	DAKE PROPERTIES INC	03/27/2013	135,000	YES																																																																																																																					
2291/276	UNITED STATE OF AMERICA	12/07/2012	0	1																																																																																																																					
2219/650	GRAHAM, LONNIE W	11/10/2011	0	10																																																																																																																					
1751/29	BLUEBIRD CONTRACTORS, LLC	02/13/2006	119,000	YES																																																																																																																					
<b>Parcel Valuation</b> <table border="1"> <thead> <tr> <th>Source</th> <th>REAL</th> <th>Fair Cash</th> <th>Capped</th> <th>Asmnt Level</th> <th>Assessed</th> <th>Levy Rate</th> <th>92.430</th> <th>Current Tax</th> </tr> </thead> <tbody> <tr> <td>Remove Cap</td> <td>2026</td> <td>Land Value 87,325</td> <td>87,325</td> <td>11%</td> <td>9,606</td> <td>Assessed</td> <td>28,600</td> <td>2,643.50</td> </tr> <tr> <td>Year Frozen</td> <td>0</td> <td>Improvements 172,675</td> <td>172,675</td> <td> </td> <td>18,994</td> <td>Penalty</td> <td>0</td> <td> </td> </tr> <tr> <td>Uncapped Value</td> <td>0</td> <td>Mobile Home 0</td> <td>0</td> <td> </td> <td>0</td> <td>Exemption</td> <td>0</td> <td>0.00</td> </tr> <tr> <td>TIF Project ID</td> <td>0</td> <td>Total Value 260,000</td> <td>260,000</td> <td> </td> <td>28,600</td> <td>Total Taxable</td> <td>28,600</td> <td>2,643.00</td> </tr> </tbody> </table>										Source	REAL	Fair Cash	Capped	Asmnt Level	Assessed	Levy Rate	92.430	Current Tax	Remove Cap	2026	Land Value 87,325	87,325	11%	9,606	Assessed	28,600	2,643.50	Year Frozen	0	Improvements 172,675	172,675		18,994	Penalty	0		Uncapped Value	0	Mobile Home 0	0		0	Exemption	0	0.00	TIF Project ID	0	Total Value 260,000	260,000		28,600	Total Taxable	28,600	2,643.00																																																																			
Source	REAL	Fair Cash	Capped	Asmnt Level	Assessed	Levy Rate	92.430	Current Tax																																																																																																																	
Remove Cap	2026	Land Value 87,325	87,325	11%	9,606	Assessed	28,600	2,643.50																																																																																																																	
Year Frozen	0	Improvements 172,675	172,675		18,994	Penalty	0																																																																																																																		
Uncapped Value	0	Mobile Home 0	0		0	Exemption	0	0.00																																																																																																																	
TIF Project ID	0	Total Value 260,000	260,000		28,600	Total Taxable	28,600	2,643.00																																																																																																																	
<b>Assessment History</b> <table border="1"> <thead> <tr> <th>Tax Year</th> <th>Statement Number</th> <th>Billed Owner</th> <th>Tax Area</th> <th>Total Value</th> <th>Exemptions</th> <th>Taxable Value</th> <th>Billed Tax</th> </tr> </thead> <tbody> <tr> <td>2025</td> <td>2025-660083546</td> <td>DOWNUM, CARSON OAKLEY &amp;</td> <td>18</td> <td>228,662</td> <td>1000</td> <td>17,795</td> <td>1,645.00</td> </tr> <tr> <td>2024</td> <td>2024-660083546</td> <td>HERNDON, ANDREW R &amp;</td> <td>18</td> <td>240,413</td> <td>1000</td> <td>17,248</td> <td>1,594.00</td> </tr> <tr> <td>2023</td> <td>2023-660083546</td> <td>HERNDON, ANDREW R &amp;</td> <td>18</td> <td>176,261</td> <td>1000</td> <td>16,717</td> <td>1,531.00</td> </tr> <tr> <td>2022</td> <td>2022-660083546</td> <td>HERNDON, ANDREW R &amp;</td> <td>18</td> <td>177,992</td> <td>1000</td> <td>16,201</td> <td>1,500.00</td> </tr> <tr> <td>2021</td> <td>2021-660083546</td> <td>HERNDON, ANDREW R &amp;</td> <td>18</td> <td>151,816</td> <td>1000</td> <td>15,700</td> <td>1,386.00</td> </tr> <tr> <td>2020</td> <td>2020-660083546</td> <td>HERNDON, ANDREW R &amp;</td> <td>18</td> <td>150,773</td> <td>1000</td> <td>15,585</td> <td>1,427.00</td> </tr> <tr> <td>2019</td> <td>2019-660083546</td> <td>BRUNS, MICHAEL J</td> <td>18</td> <td>134,881</td> <td>0</td> <td>14,837</td> <td>1,374.00</td> </tr> <tr> <td>2018</td> <td>2018-660083546</td> <td>BRUNS, MICHAEL J</td> <td>18</td> <td>139,597</td> <td>0</td> <td>15,356</td> <td>1,419.00</td> </tr> <tr> <td>2017</td> <td>2017-660083546</td> <td>BRUNS, MICHAEL J</td> <td>18</td> <td>138,465</td> <td>0</td> <td>15,231</td> <td>1,397.00</td> </tr> <tr> <td>2016</td> <td>2016-660083546</td> <td>BRUNS, MICHAEL J</td> <td>18</td> <td>135,048</td> <td>0</td> <td>14,855</td> <td>1,392.00</td> </tr> <tr> <td>2015</td> <td>2015-660083546</td> <td>BRUNS, MICHAEL J</td> <td>18</td> <td>132,344</td> <td>0</td> <td>14,558</td> <td>1,311.00</td> </tr> <tr> <td>2014</td> <td>2014-660083546</td> <td>BRUNS, MICHAEL J</td> <td>18</td> <td>134,450</td> <td>0</td> <td>14,790</td> <td>1,371.00</td> </tr> <tr> <td>2013</td> <td>2013-660083546</td> <td>BRUNS, MICHAEL J</td> <td>18</td> <td>124,721</td> <td>0</td> <td>13,719</td> <td>1,255.00</td> </tr> </tbody> </table>										Tax Year	Statement Number	Billed Owner	Tax Area	Total Value	Exemptions	Taxable Value	Billed Tax	2025	2025-660083546	DOWNUM, CARSON OAKLEY &	18	228,662	1000	17,795	1,645.00	2024	2024-660083546	HERNDON, ANDREW R &	18	240,413	1000	17,248	1,594.00	2023	2023-660083546	HERNDON, ANDREW R &	18	176,261	1000	16,717	1,531.00	2022	2022-660083546	HERNDON, ANDREW R &	18	177,992	1000	16,201	1,500.00	2021	2021-660083546	HERNDON, ANDREW R &	18	151,816	1000	15,700	1,386.00	2020	2020-660083546	HERNDON, ANDREW R &	18	150,773	1000	15,585	1,427.00	2019	2019-660083546	BRUNS, MICHAEL J	18	134,881	0	14,837	1,374.00	2018	2018-660083546	BRUNS, MICHAEL J	18	139,597	0	15,356	1,419.00	2017	2017-660083546	BRUNS, MICHAEL J	18	138,465	0	15,231	1,397.00	2016	2016-660083546	BRUNS, MICHAEL J	18	135,048	0	14,855	1,392.00	2015	2015-660083546	BRUNS, MICHAEL J	18	132,344	0	14,558	1,311.00	2014	2014-660083546	BRUNS, MICHAEL J	18	134,450	0	14,790	1,371.00	2013	2013-660083546	BRUNS, MICHAEL J	18	124,721	0	13,719	1,255.00
Tax Year	Statement Number	Billed Owner	Tax Area	Total Value	Exemptions	Taxable Value	Billed Tax																																																																																																																		
2025	2025-660083546	DOWNUM, CARSON OAKLEY &	18	228,662	1000	17,795	1,645.00																																																																																																																		
2024	2024-660083546	HERNDON, ANDREW R &	18	240,413	1000	17,248	1,594.00																																																																																																																		
2023	2023-660083546	HERNDON, ANDREW R &	18	176,261	1000	16,717	1,531.00																																																																																																																		
2022	2022-660083546	HERNDON, ANDREW R &	18	177,992	1000	16,201	1,500.00																																																																																																																		
2021	2021-660083546	HERNDON, ANDREW R &	18	151,816	1000	15,700	1,386.00																																																																																																																		
2020	2020-660083546	HERNDON, ANDREW R &	18	150,773	1000	15,585	1,427.00																																																																																																																		
2019	2019-660083546	BRUNS, MICHAEL J	18	134,881	0	14,837	1,374.00																																																																																																																		
2018	2018-660083546	BRUNS, MICHAEL J	18	139,597	0	15,356	1,419.00																																																																																																																		
2017	2017-660083546	BRUNS, MICHAEL J	18	138,465	0	15,231	1,397.00																																																																																																																		
2016	2016-660083546	BRUNS, MICHAEL J	18	135,048	0	14,855	1,392.00																																																																																																																		
2015	2015-660083546	BRUNS, MICHAEL J	18	132,344	0	14,558	1,311.00																																																																																																																		
2014	2014-660083546	BRUNS, MICHAEL J	18	134,450	0	14,790	1,371.00																																																																																																																		
2013	2013-660083546	BRUNS, MICHAEL J	18	124,721	0	13,719	1,255.00																																																																																																																		



# Rogers

## Assessment Property Record Card for Tax Year 2026

Data provided by LISA DELOZIER County Assessor

Date 04/18/2026  
 Time 08:07:18  
 Page 2

Lot Data		Square-Foot - NBHD 1089 #1	
Lot Size			
Lot Count			
Units Buildable	1		
Non-Ag Acres	0.9981		
Topography			
Street Access			
Utilities			
Amenities	LAND QUALITY	0	
		0	
Method	Square-Foot		
Base Lot Value	43,479.00 x 1.39 = 60,609		
Factor Value			
Adjustments	1.4408		
Lot Value	87,325		



\\tsclient\C\Users\Randy Necessary\Pictures\101\_0728\IMG\_0069. 7/29/2022

Residential Data	
Type	1 Single Family Residence
Condition	3 - Average
Quality	3 - Average
Architecture	
Style	100% One Story
Exterior Wall	90% Frame, Siding, Vinyl 10% Veneer, Masonry
Base/Total Area	1,374 / 1,374
Style	100% One Story
HVAC	100% Warmed & Cooled Air
Roof Cover	1 Composition Shingle
Area on Slab	1,374
Fixture/RghIn	14 /
Bed/F/H Bath	3 / 2.0 /
Basement Area	
Garage Type	400 Attached Garage - Unfinished
Remodel	
Year/Eff Age	2006 / 15

GRM Approach	
GRM Code	
Gross Rent	0.00
Indicated Value	

Multiple Regression			
MRA Code	1	Test	
Adjusted R	0.8445		
Indicated Value	193,377	140.74	Per SqFt

Direct Comparables			
Selection Model	A	Adam Test	
Adjustment Model	1	2022 Residential	
Comparables	8		
Indicated Value	198,790		Per SqFt

Cost Approach		Manual : 01/2025	
Base Cost	107.73	Total Misc Impr	+ 3,414
Roofing Adj	+ 5.09	Garage Cost	+ 13,584
Subfloor Adj	+ -2.43	Total RCN	= 205,566
Heat/Cool Adj	+ 12.64	Depreciation ( 16%)	- 32,891
Plumbing Adj	+ 14.21	Lump Sums	+ 0
Basement Adj	+ 0.00	RCNLD	= 172,675
Adj Base Cost	= 137.24	Lot Value	+ 87,325
Total Area	x 1,374	Indicated Value	= 260,000
Adjusted Cost	= 188,568	Value Per SqFt	189.23

Value Reconciliation			
Selected Approach	Cost Approach		
Improvements	172,675		
Lot Value	87,325		
Indicated Value	260,000	189.23	Per SqFt
Agland Value			
Site Improvements			
Total Value	260,000	189.23	Total Value Per SqFt

Miscellaneous Improvements								
Code	Description	Sketch ID	Size	Year	Units	Unit Cost	Depr	Value
PRCH	SLAB PORCH - COVERED	101708	10x10		100	26.62		2,662
PRCH	SLAB PORCH - COVERED	101710	7x4		28	26.84		752



# Rogers

## Assessment Property Record Card for Tax Year 2026

Data provided by LISA DELOZIER County Assessor

Date 04/18/2026

Time 08:07:18

Page 3

### Sketch Image

660083546

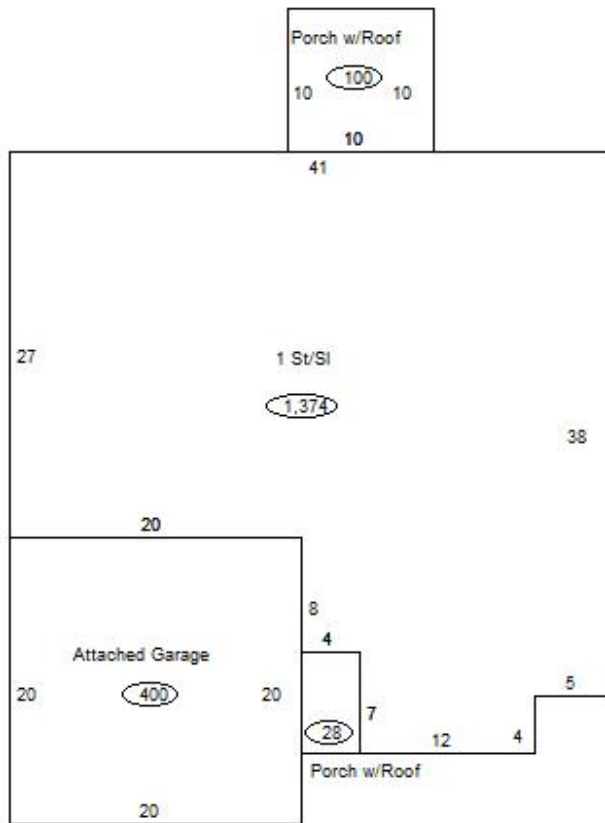

### Sketch Vector Information

Sequence	Code	Type	Built Over	Scale	Section Label	Base Area	Multiplier	Total Area
1	R	1	Slab	13	1 St/Sl	1,374	1.000	1,374
2	M	PRCH		13	SLBC	100	1.000	100
3	G	1		13	Attached Garage	400	1.000	400
4	M	PRCH		13	SLBC	28	1.000	28
<b>Total Building Area</b>						<b>1,374</b>		<b>1,374</b>



# Rogers

## Assessment Property Record Card for Tax Year 2026

Data provided by LISA DELOZIER County Assessor

Date 04/18/2026  
Time 08:07:19  
Page 4

660083546

### Outbuildings/Site Improvements

Building Image	Code	Description	Dimensions	Floor	Roofing	Total Units
	STF	STG FAIR	0x0x0			
	Qual	2	Cond 3	Year	Eff Age	1520
<b>Valuation Summary</b>		<b>Modifier Total</b>		<b>RCN</b>	<b>Depr (100% Phys/ % Func)</b>	<b>RCNLD</b>
Base Cost (4.68 x )						