



Rogers

Assessment Property Record Card for Tax Year 2026

Data provided by LISA DELOZIER County Assessor

Date 04/18/2026
Time 07:19:38
Page 1

Assessment Data					Primary Image																																																																																																																				
Account 660083646 Parcel ID 000000-00-0-00362-004-0023 Cadastral ID 20-20-15-06760 Property Type REAL - Real Property Property Class URP VI Area 3 Tax Area 1 - CATOOSA OT Name ID 304515 SIX HUNDRED FIFTY HOLDINGS LLC 7040 S YALE STE 100 TULSA OK 74136-0000 Parcel Location Situs 03044 SPRING ST Subdivision HAMILTON CROSSING Lot/Block 0023 / 0004 Parcel Size 1 - Lots Sec/Twn/Rng 20 / 20 / 15 / 5 Neighborhood 1124 - R-V03-SW CATOOSA School District S002 - CATOOSA SCHOOLS																																																																																																																									
Legal Description Lot/Long: 36.19869599 -95.72850169																																																																																																																									
Building Permits <table border="1"> <thead> <tr> <th>Number</th> <th>Description</th> <th>Opened</th> <th>Closed</th> <th>Amount</th> </tr> </thead> <tbody> <tr> <td colspan="5"> </td> </tr> </tbody> </table>					Number	Description	Opened	Closed	Amount																																																																																																																
Number	Description	Opened	Closed	Amount																																																																																																																					
Exemptions <table border="1"> <thead> <tr> <th>Code</th> <th>Type</th> <th>Active</th> <th>Maximum</th> <th>Exemption</th> </tr> </thead> <tbody> <tr> <td colspan="5"> </td> </tr> </tbody> </table>					Code	Type	Active	Maximum	Exemption						Sale History <table border="1"> <thead> <tr> <th>Bk/Pg</th> <th>Grantor</th> <th>Date</th> <th>Price</th> <th>Code</th> </tr> </thead> <tbody> <tr> <td>2182/792</td> <td>SIX HUNDRED HOLDINGS LLC</td> <td>06/28/2011</td> <td>0</td> <td>4</td> </tr> <tr> <td>2158/248</td> <td>PEREZ, EDGARDO A &</td> <td>02/16/2011</td> <td>145,000</td> <td>10</td> </tr> <tr> <td>1865/308</td> <td>DORSEY INC</td> <td>04/27/2007</td> <td>195,500</td> <td>YES</td> </tr> <tr> <td>1618/596</td> <td>VANTAGE POINT DEV LLC</td> <td>09/09/2004</td> <td>40,000</td> <td>5</td> </tr> </tbody> </table>					Bk/Pg	Grantor	Date	Price	Code	2182/792	SIX HUNDRED HOLDINGS LLC	06/28/2011	0	4	2158/248	PEREZ, EDGARDO A &	02/16/2011	145,000	10	1865/308	DORSEY INC	04/27/2007	195,500	YES	1618/596	VANTAGE POINT DEV LLC	09/09/2004	40,000	5																																																																													
Code	Type	Active	Maximum	Exemption																																																																																																																					
Bk/Pg	Grantor	Date	Price	Code																																																																																																																					
2182/792	SIX HUNDRED HOLDINGS LLC	06/28/2011	0	4																																																																																																																					
2158/248	PEREZ, EDGARDO A &	02/16/2011	145,000	10																																																																																																																					
1865/308	DORSEY INC	04/27/2007	195,500	YES																																																																																																																					
1618/596	VANTAGE POINT DEV LLC	09/09/2004	40,000	5																																																																																																																					
Parcel Valuation <table border="1"> <thead> <tr> <th>Source</th> <th>REAL</th> <th>Fair Cash</th> <th>Capped</th> <th>Asmnt Level</th> <th>Assessed</th> <th>Levy Rate</th> <th>106.660</th> <th>Current Tax</th> </tr> </thead> <tbody> <tr> <td>Remove Cap</td> <td>0</td> <td>Land Value 27,588</td> <td>27,588</td> <td>11%</td> <td>3,035</td> <td>Assessed</td> <td>21,638</td> <td>2,307.91</td> </tr> <tr> <td>Year Frozen</td> <td>0</td> <td>Improvements 249,259</td> <td>169,114</td> <td></td> <td>18,603</td> <td>Penalty</td> <td>0</td> <td></td> </tr> <tr> <td>Uncapped Value</td> <td>0</td> <td>Mobile Home 0</td> <td>0</td> <td></td> <td>0</td> <td>Exemption</td> <td>0</td> <td>0.00</td> </tr> <tr> <td>TIF Project ID</td> <td>0</td> <td>Total Value 276,847</td> <td>196,702</td> <td></td> <td>21,638</td> <td>Total Taxable</td> <td>21,638</td> <td>2,308.00</td> </tr> </tbody> </table>										Source	REAL	Fair Cash	Capped	Asmnt Level	Assessed	Levy Rate	106.660	Current Tax	Remove Cap	0	Land Value 27,588	27,588	11%	3,035	Assessed	21,638	2,307.91	Year Frozen	0	Improvements 249,259	169,114		18,603	Penalty	0		Uncapped Value	0	Mobile Home 0	0		0	Exemption	0	0.00	TIF Project ID	0	Total Value 276,847	196,702		21,638	Total Taxable	21,638	2,308.00																																																																			
Source	REAL	Fair Cash	Capped	Asmnt Level	Assessed	Levy Rate	106.660	Current Tax																																																																																																																	
Remove Cap	0	Land Value 27,588	27,588	11%	3,035	Assessed	21,638	2,307.91																																																																																																																	
Year Frozen	0	Improvements 249,259	169,114		18,603	Penalty	0																																																																																																																		
Uncapped Value	0	Mobile Home 0	0		0	Exemption	0	0.00																																																																																																																	
TIF Project ID	0	Total Value 276,847	196,702		21,638	Total Taxable	21,638	2,308.00																																																																																																																	
Assessment History <table border="1"> <thead> <tr> <th>Tax Year</th> <th>Statement Number</th> <th>Billed Owner</th> <th>Tax Area</th> <th>Total Value</th> <th>Exemptions</th> <th>Taxable Value</th> <th>Billed Tax</th> </tr> </thead> <tbody> <tr><td>2025</td><td>2025-660083646</td><td>SIX HUNDRED FIFTY HOLDINGS LLC</td><td>1</td><td>269,859</td><td>0</td><td>20,607</td><td>2,198.00</td></tr> <tr><td>2024</td><td>2024-660083646</td><td>SIX HUNDRED FIFTY HOLDINGS LLC</td><td>1</td><td>279,331</td><td>0</td><td>19,626</td><td>2,070.00</td></tr> <tr><td>2023</td><td>2023-660083646</td><td>SIX HUNDRED FIFTY HOLDINGS LLC</td><td>1</td><td>253,731</td><td>0</td><td>18,691</td><td>1,918.00</td></tr> <tr><td>2022</td><td>2022-660083646</td><td>SIX HUNDRED FIFTY HOLDINGS LLC</td><td>1</td><td>265,781</td><td>0</td><td>17,801</td><td>1,787.00</td></tr> <tr><td>2021</td><td>2021-660083646</td><td>SIX HUNDRED FIFTY HOLDINGS LLC</td><td>1</td><td>201,341</td><td>0</td><td>16,954</td><td>1,492.00</td></tr> <tr><td>2020</td><td>2020-660083646</td><td>SIX HUNDRED FIFTY HOLDINGS LLC</td><td>1</td><td>173,109</td><td>0</td><td>16,146</td><td>1,430.00</td></tr> <tr><td>2019</td><td>2019-660083646</td><td>SIX HUNDRED FIFTY HOLDINGS LLC</td><td>1</td><td>139,795</td><td>0</td><td>15,377</td><td>1,381.00</td></tr> <tr><td>2018</td><td>2018-660083646</td><td>SIX HUNDRED FIFTY HOLDINGS LLC</td><td>1</td><td>144,002</td><td>0</td><td>15,840</td><td>1,414.00</td></tr> <tr><td>2017</td><td>2017-660083646</td><td>SIX HUNDRED FIFTY HOLDINGS LLC</td><td>1</td><td>142,789</td><td>0</td><td>15,707</td><td>1,418.00</td></tr> <tr><td>2016</td><td>2016-660083646</td><td>SIX HUNDRED FIFTY HOLDINGS LLC</td><td>1</td><td>136,911</td><td>0</td><td>15,060</td><td>1,339.00</td></tr> <tr><td>2015</td><td>2015-660083646</td><td>SIX HUNDRED FIFTY HOLDINGS LLC</td><td>1</td><td>133,130</td><td>0</td><td>14,644</td><td>1,309.00</td></tr> <tr><td>2014</td><td>2014-660083646</td><td>SIX HUNDRED FIFTY HOLDINGS LLC</td><td>1</td><td>133,608</td><td>0</td><td>14,697</td><td>1,329.00</td></tr> <tr><td>2013</td><td>2013-660083646</td><td>SIX HUNDRED FIFTY HOLDINGS LLC</td><td>1</td><td>134,998</td><td>0</td><td>14,850</td><td>1,329.00</td></tr> </tbody> </table>										Tax Year	Statement Number	Billed Owner	Tax Area	Total Value	Exemptions	Taxable Value	Billed Tax	2025	2025-660083646	SIX HUNDRED FIFTY HOLDINGS LLC	1	269,859	0	20,607	2,198.00	2024	2024-660083646	SIX HUNDRED FIFTY HOLDINGS LLC	1	279,331	0	19,626	2,070.00	2023	2023-660083646	SIX HUNDRED FIFTY HOLDINGS LLC	1	253,731	0	18,691	1,918.00	2022	2022-660083646	SIX HUNDRED FIFTY HOLDINGS LLC	1	265,781	0	17,801	1,787.00	2021	2021-660083646	SIX HUNDRED FIFTY HOLDINGS LLC	1	201,341	0	16,954	1,492.00	2020	2020-660083646	SIX HUNDRED FIFTY HOLDINGS LLC	1	173,109	0	16,146	1,430.00	2019	2019-660083646	SIX HUNDRED FIFTY HOLDINGS LLC	1	139,795	0	15,377	1,381.00	2018	2018-660083646	SIX HUNDRED FIFTY HOLDINGS LLC	1	144,002	0	15,840	1,414.00	2017	2017-660083646	SIX HUNDRED FIFTY HOLDINGS LLC	1	142,789	0	15,707	1,418.00	2016	2016-660083646	SIX HUNDRED FIFTY HOLDINGS LLC	1	136,911	0	15,060	1,339.00	2015	2015-660083646	SIX HUNDRED FIFTY HOLDINGS LLC	1	133,130	0	14,644	1,309.00	2014	2014-660083646	SIX HUNDRED FIFTY HOLDINGS LLC	1	133,608	0	14,697	1,329.00	2013	2013-660083646	SIX HUNDRED FIFTY HOLDINGS LLC	1	134,998	0	14,850	1,329.00
Tax Year	Statement Number	Billed Owner	Tax Area	Total Value	Exemptions	Taxable Value	Billed Tax																																																																																																																		
2025	2025-660083646	SIX HUNDRED FIFTY HOLDINGS LLC	1	269,859	0	20,607	2,198.00																																																																																																																		
2024	2024-660083646	SIX HUNDRED FIFTY HOLDINGS LLC	1	279,331	0	19,626	2,070.00																																																																																																																		
2023	2023-660083646	SIX HUNDRED FIFTY HOLDINGS LLC	1	253,731	0	18,691	1,918.00																																																																																																																		
2022	2022-660083646	SIX HUNDRED FIFTY HOLDINGS LLC	1	265,781	0	17,801	1,787.00																																																																																																																		
2021	2021-660083646	SIX HUNDRED FIFTY HOLDINGS LLC	1	201,341	0	16,954	1,492.00																																																																																																																		
2020	2020-660083646	SIX HUNDRED FIFTY HOLDINGS LLC	1	173,109	0	16,146	1,430.00																																																																																																																		
2019	2019-660083646	SIX HUNDRED FIFTY HOLDINGS LLC	1	139,795	0	15,377	1,381.00																																																																																																																		
2018	2018-660083646	SIX HUNDRED FIFTY HOLDINGS LLC	1	144,002	0	15,840	1,414.00																																																																																																																		
2017	2017-660083646	SIX HUNDRED FIFTY HOLDINGS LLC	1	142,789	0	15,707	1,418.00																																																																																																																		
2016	2016-660083646	SIX HUNDRED FIFTY HOLDINGS LLC	1	136,911	0	15,060	1,339.00																																																																																																																		
2015	2015-660083646	SIX HUNDRED FIFTY HOLDINGS LLC	1	133,130	0	14,644	1,309.00																																																																																																																		
2014	2014-660083646	SIX HUNDRED FIFTY HOLDINGS LLC	1	133,608	0	14,697	1,329.00																																																																																																																		
2013	2013-660083646	SIX HUNDRED FIFTY HOLDINGS LLC	1	134,998	0	14,850	1,329.00																																																																																																																		



Rogers

Assessment Property Record Card for Tax Year 2026

Data provided by LISA DELOZIER County Assessor

Date 04/18/2026
 Time 07:19:38
 Page 2

Lot Data	Square-Foot - NBHD 1124 #1	Primary Image
Lot Size Lot Count Units Buildable 1 Non-Ag Acres 0.2027 Topography Street Access Utilities Amenities 0 Method Square-Foot Base Lot Value 8,828.00 x 3.13 = 27,588 Factor Value Adjustments 1.0000 Lot Value 27,588		

Residential Data	
Type	5 Duplex
Condition	3 - Average
Quality	3 - Average
Architecture	TRAD TRADITIONAL
Style	100% 1 1/2 Story Finished
Exterior Wall	20% Veneer, Masonry 80% Frame, Siding, Wood
Base/Total Area	1,048 / 2,344
Style	100% 1 1/2 Story Finished
HVAC	100% Warmed & Cooled Air
Roof Cover	1 Composition Shingle
Area on Slab	1,048
Fixture/RghIn	17 /
Bed/F/H Bath	4 / 4.0 /
Basement Area	
Garage Type	456 Attached Garage - Finished 2 Stalls
Remodel	
Year/Eff Age	2005 / 16

660083646_001.JPG	11/3/2025
-------------------	-----------

GRM Approach	
GRM Code	
Gross Rent	0.00
Indicated Value	

Multiple Regression	
MRA Code	
Adusted R	
Indicated Value	

Direct Comparables	
Selection Model	A Adam Test
Adjustment Model	1 2022 Residential
Comparables	
Indicated Value	

Cost Approach		Manual : 01/2025	
Base Cost	101.36	Total Misc Impr	+ 3,352
Roofing Adj	+ 2.01	Garage Cost	+ 21,674
Subfloor Adj	+ -0.42	Total RCN	= 315,518
Heat/Cool Adj	+ 11.69	Depreciation (21%)	- 66,259
Plumbing Adj	+ 9.29	Lump Sums	+ 0
Basement Adj	+ 0.00	RCNLD	= 249,259
Adj Base Cost	= 123.93	Lot Value	+ 27,588
Total Area	x 2,344	Indicated Value	= 276,847
Adjusted Cost	= 290,492	Value Per SqFt	118.11

Value Reconciliation			
Selected Approach	Cost Approach		
Improvements	249,259		
Lot Value	27,588		
Indicated Value	276,847	118.11	Per SqFt
Agland Value			
Site Improvements			
Total Value	276,847	118.11	Total Value Per SqFt

Miscellaneous Improvements								
Code	Description	Sketch ID	Size	Year	Units	Unit Cost	Depr	Value
PRCH	SLAB PORCH - COVERED	102175	8x8		64	26.18		1,676
PRCH	SLAB PORCH - COVERED	102176	8x8		64	26.18		1,676



Rogers

Assessment Property Record Card for Tax Year 2026

Data provided by LISA DELOZIER County Assessor

Date 04/18/2026
 Time 07:19:38
 Page 3

Sketch Image

660083646

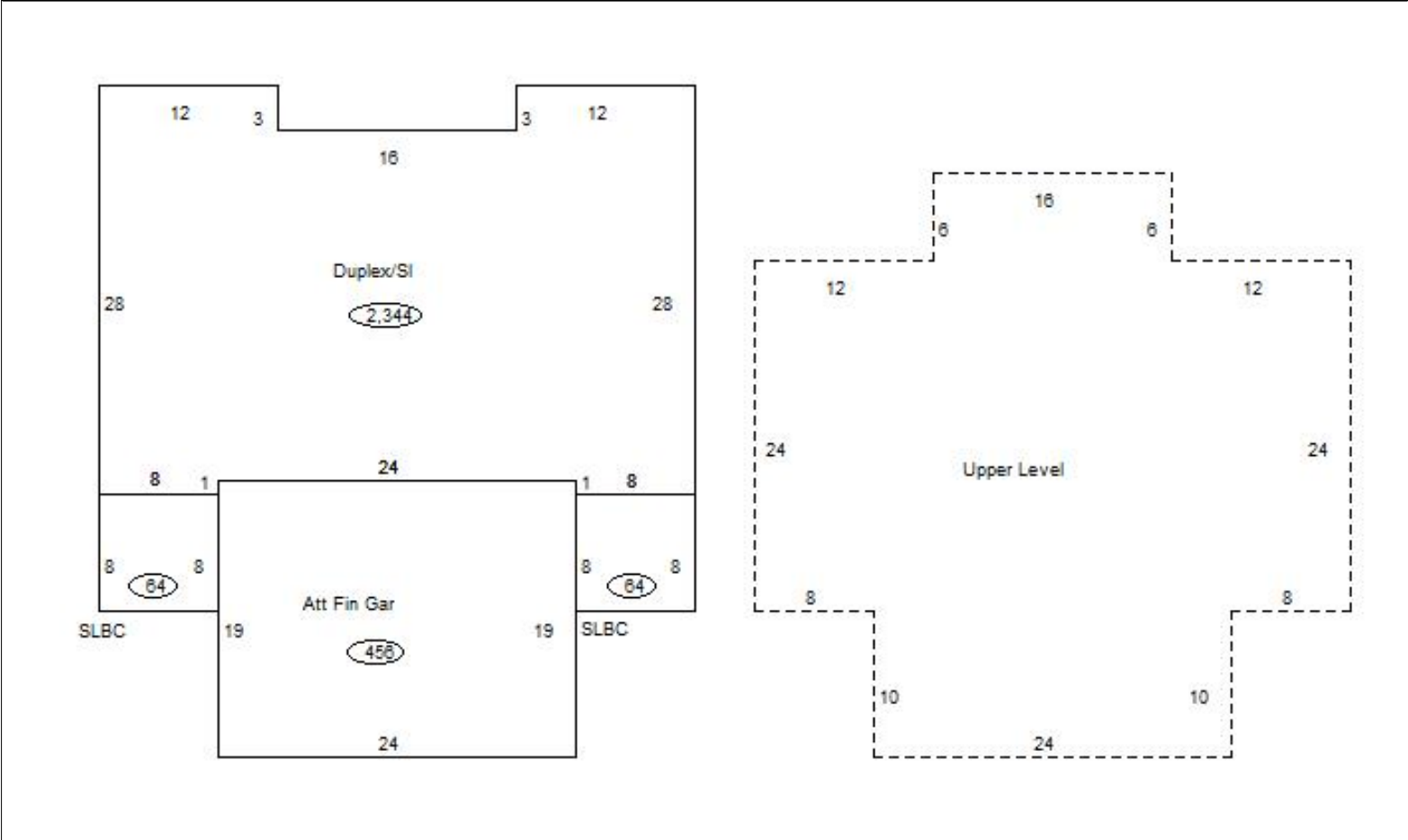

Sketch Vector Information

Sequence	Code	Type	Built Over	Scale	Section Label	Base Area	Multiplier	Total Area
1	R	5	Slab	13	Duplex/SI	1,048	2.237	2,344
2	G	5		13	Att Fin Gar	456	1.000	456
3	M	PRCH		13	SLBC	64	1.000	64
4	M	PRCH		13	SLBC	64	1.000	64
5	U	^UL	Overhang	13	Upper Level	1,296	1.000	1,296
Total Building Area						1,048		2,344