



# Rogers

## Assessment Property Record Card for Tax Year 2026

Data provided by LISA DELOZIER County Assessor

Date 04/17/2026  
Time 07:04:21  
Page 1

Assessment Data					Primary Image																																																																																																																			
<b>Account</b> 660085079 <b>Parcel ID</b> 000000-00-0-00686-001-0019 <b>Cadastral ID</b> 23-21-15-01380 <b>Property Type</b> REAL - Real Property <b>Property Class</b> RRP VI Area 4 <b>Tax Area</b> 18 - CLAREMORE RURAL/W/O FIRE <b>Name ID</b> 292248 <b>SPEER, GARY W</b>  & JANET L 22544 RIVERWOOD CT CLAREMORE OK 74017-0000  <b>Parcel Location</b> <b>Situs</b> 22544 RIVERWOOD CT <b>Subdivision</b> RIVERWOOD ESTATES <b>Lot/Block</b> 0019 / 0001 <b>Parcel Size</b> 1 - Lots <b>Sec/Twn/Rng</b> 23 / 21 / 15 / 5 <b>Neighborhood</b> 1089 - R-V03,4-SE CLAREMORE <b>School District</b> S001 - CLAREMORE SCHOOLS					 <p>\\tsclient\C\Users\rln\Pictures\2018-09-25\IMG_0051.JPG 9/26/2018</p>																																																																																																																			
<b>Legal Description</b> Lot/Long: 36.28603415 -95.67626206 LOT 19 BLOCK 1 RIVERWOOD ESTATES																																																																																																																								
<b>Exemptions</b> <table border="1"> <thead> <tr> <th>Code</th> <th>Type</th> <th>Active</th> <th>Maximum</th> <th>Exemption</th> </tr> </thead> <tbody> <tr> <td>H</td> <td>Homestead</td> <td>Yes</td> <td>1,000</td> <td>1,000</td> </tr> </tbody> </table>					Code	Type	Active	Maximum	Exemption	H	Homestead	Yes	1,000	1,000	<b>Building Permits</b> <table border="1"> <thead> <tr> <th>Number</th> <th>Description</th> <th>Opened</th> <th>Closed</th> <th>Amount</th> </tr> </thead> <tbody> <tr> <td></td> <td></td> <td></td> <td></td> <td></td> </tr> </tbody> </table>					Number	Description	Opened	Closed	Amount																																																																																																
Code	Type	Active	Maximum	Exemption																																																																																																																				
H	Homestead	Yes	1,000	1,000																																																																																																																				
Number	Description	Opened	Closed	Amount																																																																																																																				
<b>Parcel Valuation</b> <table border="1"> <thead> <tr> <th>Source</th> <th>REAL</th> <th>Fair Cash</th> <th>Capped</th> <th>Asmnt Level</th> <th>Assessed</th> <th>Levy Rate</th> <th>92.430</th> <th>Current Tax</th> </tr> </thead> <tbody> <tr> <td>Remove Cap</td> <td>2007</td> <td>Land Value 49,957</td> <td>45,141</td> <td>11%</td> <td>4,966</td> <td>Assessed</td> <td>40,008</td> <td>3,697.94</td> </tr> <tr> <td>Year Frozen</td> <td>0</td> <td>Improvements 318,561</td> <td>318,561</td> <td></td> <td>35,042</td> <td>Penalty</td> <td>0</td> <td></td> </tr> <tr> <td>Uncapped Value</td> <td>0</td> <td>Mobile Home 0</td> <td>0</td> <td></td> <td>0</td> <td>Exemption</td> <td>1,000</td> <td>-92.00</td> </tr> <tr> <td>TIF Project ID</td> <td>0</td> <td>Total Value 368,518</td> <td>363,702</td> <td></td> <td>40,008</td> <td>Total Taxable</td> <td>39,008</td> <td>3,606.00</td> </tr> </tbody> </table>					Source	REAL	Fair Cash	Capped	Asmnt Level	Assessed	Levy Rate	92.430	Current Tax	Remove Cap	2007	Land Value 49,957	45,141	11%	4,966	Assessed	40,008	3,697.94	Year Frozen	0	Improvements 318,561	318,561		35,042	Penalty	0		Uncapped Value	0	Mobile Home 0	0		0	Exemption	1,000	-92.00	TIF Project ID	0	Total Value 368,518	363,702		40,008	Total Taxable	39,008	3,606.00	<b>Sale History</b> <table border="1"> <thead> <tr> <th>Bk/Pg</th> <th>Grantor</th> <th>Date</th> <th>Price</th> <th>Code</th> </tr> </thead> <tbody> <tr> <td>1782/333</td> <td>WISH, CLAUDE M</td> <td>06/12/2006</td> <td>327,500</td> <td>11</td> </tr> <tr> <td>1714/411</td> <td>HIGHFILL PROPERTIES LLC</td> <td>08/22/2005</td> <td>30,000</td> <td>YES</td> </tr> </tbody> </table>					Bk/Pg	Grantor	Date	Price	Code	1782/333	WISH, CLAUDE M	06/12/2006	327,500	11	1714/411	HIGHFILL PROPERTIES LLC	08/22/2005	30,000	YES																																																			
Source	REAL	Fair Cash	Capped	Asmnt Level	Assessed	Levy Rate	92.430	Current Tax																																																																																																																
Remove Cap	2007	Land Value 49,957	45,141	11%	4,966	Assessed	40,008	3,697.94																																																																																																																
Year Frozen	0	Improvements 318,561	318,561		35,042	Penalty	0																																																																																																																	
Uncapped Value	0	Mobile Home 0	0		0	Exemption	1,000	-92.00																																																																																																																
TIF Project ID	0	Total Value 368,518	363,702		40,008	Total Taxable	39,008	3,606.00																																																																																																																
Bk/Pg	Grantor	Date	Price	Code																																																																																																																				
1782/333	WISH, CLAUDE M	06/12/2006	327,500	11																																																																																																																				
1714/411	HIGHFILL PROPERTIES LLC	08/22/2005	30,000	YES																																																																																																																				
<b>Assessment History</b> <table border="1"> <thead> <tr> <th>Tax Year</th> <th>Statement Number</th> <th>Billed Owner</th> <th>Tax Area</th> <th>Total Value</th> <th>Exemptions</th> <th>Taxable Value</th> <th>Billed Tax</th> </tr> </thead> <tbody> <tr><td>2025</td><td>2025-660085079</td><td>SPEER, GARY W</td><td>18</td><td>359,273</td><td>1000</td><td>37,842</td><td>3,498.00</td></tr> <tr><td>2024</td><td>2024-660085079</td><td>SPEER, GARY W</td><td>18</td><td>374,235</td><td>1000</td><td>36,711</td><td>3,393.00</td></tr> <tr><td>2023</td><td>2023-660085079</td><td>SPEER, GARY W</td><td>18</td><td>362,679</td><td>1000</td><td>35,612</td><td>3,262.00</td></tr> <tr><td>2022</td><td>2022-660085079</td><td>SPEER, GARY W</td><td>18</td><td>366,501</td><td>1000</td><td>34,546</td><td>3,198.00</td></tr> <tr><td>2021</td><td>2021-660085079</td><td>SPEER, GARY W</td><td>18</td><td>314,476</td><td>1000</td><td>33,511</td><td>2,959.00</td></tr> <tr><td>2020</td><td>2020-660085079</td><td>SPEER, GARY W</td><td>18</td><td>312,057</td><td>1000</td><td>32,506</td><td>2,977.00</td></tr> <tr><td>2019</td><td>2019-660085079</td><td>SPEER, GARY W</td><td>18</td><td>295,726</td><td>1000</td><td>31,530</td><td>2,920.00</td></tr> <tr><td>2018</td><td>2018-660085079</td><td>SPEER, GARY W</td><td>18</td><td>304,276</td><td>1000</td><td>32,231</td><td>2,978.00</td></tr> <tr><td>2017</td><td>2017-660085079</td><td>SPEER, GARY W</td><td>18</td><td>301,658</td><td>1000</td><td>31,263</td><td>2,868.00</td></tr> <tr><td>2016</td><td>2016-660085079</td><td>SPEER, GARY W</td><td>18</td><td>293,555</td><td>1000</td><td>30,323</td><td>2,842.00</td></tr> <tr><td>2015</td><td>2015-660085079</td><td>SPEER, GARY W</td><td>18</td><td>283,969</td><td>1000</td><td>29,411</td><td>2,648.00</td></tr> <tr><td>2014</td><td>2014-660085079</td><td>SPEER, GARY W</td><td>18</td><td>289,592</td><td>1000</td><td>28,526</td><td>2,645.00</td></tr> <tr><td>2013</td><td>2013-660085079</td><td>SPEER, GARY W</td><td>18</td><td>271,298</td><td>1000</td><td>27,666</td><td>2,532.00</td></tr> </tbody> </table>									Tax Year	Statement Number	Billed Owner	Tax Area	Total Value	Exemptions	Taxable Value	Billed Tax	2025	2025-660085079	SPEER, GARY W	18	359,273	1000	37,842	3,498.00	2024	2024-660085079	SPEER, GARY W	18	374,235	1000	36,711	3,393.00	2023	2023-660085079	SPEER, GARY W	18	362,679	1000	35,612	3,262.00	2022	2022-660085079	SPEER, GARY W	18	366,501	1000	34,546	3,198.00	2021	2021-660085079	SPEER, GARY W	18	314,476	1000	33,511	2,959.00	2020	2020-660085079	SPEER, GARY W	18	312,057	1000	32,506	2,977.00	2019	2019-660085079	SPEER, GARY W	18	295,726	1000	31,530	2,920.00	2018	2018-660085079	SPEER, GARY W	18	304,276	1000	32,231	2,978.00	2017	2017-660085079	SPEER, GARY W	18	301,658	1000	31,263	2,868.00	2016	2016-660085079	SPEER, GARY W	18	293,555	1000	30,323	2,842.00	2015	2015-660085079	SPEER, GARY W	18	283,969	1000	29,411	2,648.00	2014	2014-660085079	SPEER, GARY W	18	289,592	1000	28,526	2,645.00	2013	2013-660085079	SPEER, GARY W	18	271,298	1000	27,666	2,532.00
Tax Year	Statement Number	Billed Owner	Tax Area	Total Value	Exemptions	Taxable Value	Billed Tax																																																																																																																	
2025	2025-660085079	SPEER, GARY W	18	359,273	1000	37,842	3,498.00																																																																																																																	
2024	2024-660085079	SPEER, GARY W	18	374,235	1000	36,711	3,393.00																																																																																																																	
2023	2023-660085079	SPEER, GARY W	18	362,679	1000	35,612	3,262.00																																																																																																																	
2022	2022-660085079	SPEER, GARY W	18	366,501	1000	34,546	3,198.00																																																																																																																	
2021	2021-660085079	SPEER, GARY W	18	314,476	1000	33,511	2,959.00																																																																																																																	
2020	2020-660085079	SPEER, GARY W	18	312,057	1000	32,506	2,977.00																																																																																																																	
2019	2019-660085079	SPEER, GARY W	18	295,726	1000	31,530	2,920.00																																																																																																																	
2018	2018-660085079	SPEER, GARY W	18	304,276	1000	32,231	2,978.00																																																																																																																	
2017	2017-660085079	SPEER, GARY W	18	301,658	1000	31,263	2,868.00																																																																																																																	
2016	2016-660085079	SPEER, GARY W	18	293,555	1000	30,323	2,842.00																																																																																																																	
2015	2015-660085079	SPEER, GARY W	18	283,969	1000	29,411	2,648.00																																																																																																																	
2014	2014-660085079	SPEER, GARY W	18	289,592	1000	28,526	2,645.00																																																																																																																	
2013	2013-660085079	SPEER, GARY W	18	271,298	1000	27,666	2,532.00																																																																																																																	



# Rogers

## Assessment Property Record Card for Tax Year 2026

Data provided by LISA DELOZIER County Assessor

Date 04/17/2026  
 Time 07:04:21  
 Page 2

Lot Data	Square-Foot - NBHD 1089 #1	Primary Image
Lot Size		
Lot Count		
Units Buildable	1	
Non-Ag Acres	0.7909	
Topography		
Street Access		
Utilities		
Amenities	LAND QUALITY	
	0	
	0	
Method	Square-Foot	
Base Lot Value	34,453.00 x 1.45 = 49,957	
Factor Value		
Adjustments	1.0000	
Lot Value	49,957	

\\tsclient\C\Users\rln\Pictures\2018-09-25\IMG\_0051.JPG 9/26/2018

Residential Data	
Type	1 Single Family Residence
Condition	3 - Average
Quality	3 - Average
Architecture	
Style	100% 1 1/2 Story Finished
Exterior Wall	100% Veneer, Masonry
Base/Total Area	1,978 / 2,898
Style	100% 1 1/2 Story Finished
HVAC	100% Warmed & Cooled Air
Roof Cover	1 Composition Shingle
Area on Slab	1,978
Fixture/RghIn	14 /
Bed/F/H Bath	4 / 3.0 /
Basement Area	
Garage Type	750 Attached Garage - Unfinished
Remodel	
Year/Eff Age	2006 / 15

GRM Approach	
GRM Code	
Gross Rent	0.00
Indicated Value	

Multiple Regression			
MRA Code	1	Test	
Adusted R	0.8445		
Indicated Value	336,846	116.23	Per SqFt

Direct Comparables			
Selection Model	A	Adam Test	
Adjustment Model	1	2022 Residential	
Comparables	8		
Indicated Value	377,930		Per SqFt

Cost Approach				Manual : 01/2025			
Base Cost	92.45	Total Misc Impr	+	27,857			
Roofing Adj	+ 3.21	Garage Cost	+	22,343			
Subfloor Adj	+ -1.50	Total RCN	=	379,239			
Heat/Cool Adj	+ 12.64	Depreciation ( 16%)	-	60,678			
Plumbing Adj	+ 6.74	Lump Sums	+	0			
Basement Adj	+ 0.00	RCNLD	=	318,561			
Adj Base Cost	= 113.54	Lot Value	+	49,957			
Total Area	x 2,898	Indicated Value	=	368,518			
Adjusted Cost	= 329,039	Value Per SqFt		127.16			

Value Reconciliation			
Selected Approach	Cost Approach		
Improvements	318,561		
Lot Value	49,957		
Indicated Value	368,518	127.16	Per SqFt
Agland Value			
Site Improvements			
Total Value	368,518	127.16	Total Value Per SqFt

Miscellaneous Improvements								
Code	Description	Sketch ID	Size	Year	Units	Unit Cost	Depr	Value
FPR1	FIREPLACE - RESIDENTIAL 1 STORY	0		1	1	5,615.40		5,615
PRCH	SLAB PORCH - COVERED	103487	60x6		360	25.80		9,288
PRCH	SLAB PORCH - COVERED	103488	511		511	25.35		12,954



# Rogers

## Assessment Property Record Card for Tax Year 2026

Data provided by LISA DELOZIER County Assessor

Date 04/17/2026

Time 07:04:21

Page 3

### Sketch Image

660085079

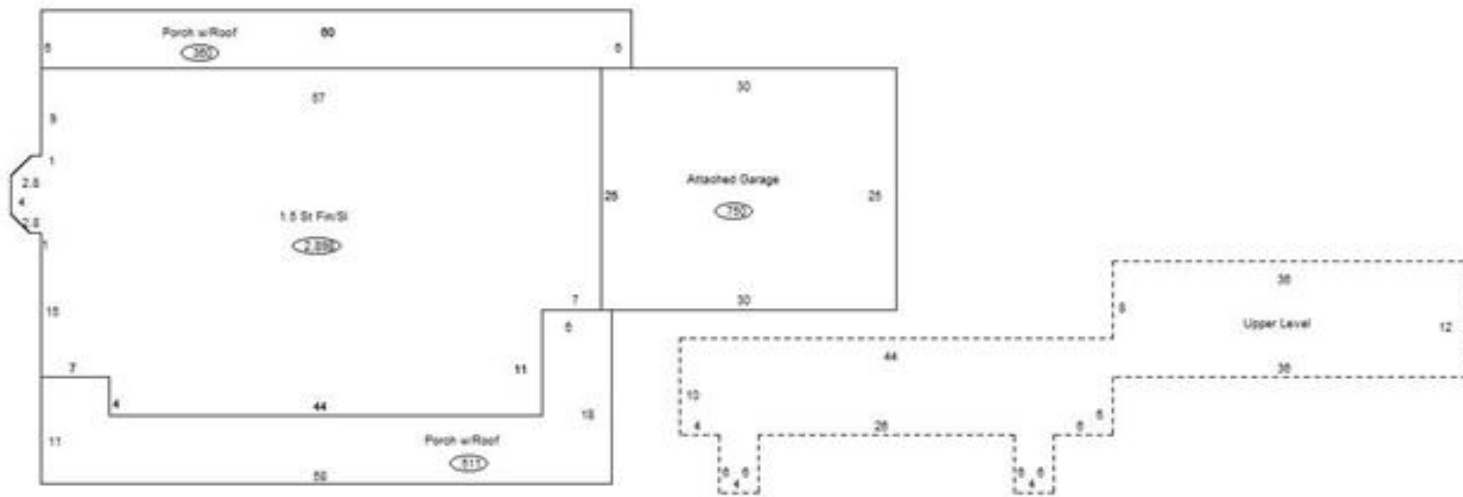

### Sketch Vector Information

Sequence	Code	Type	Built Over	Scale	Section Label	Base Area	Multiplier	Total Area
1	R	5	Slab	13	1.5 St Fin/SI	1,978	1.465	2,898
2	G	1		13	Attached Garage	750	1.000	750
3	M	PRCH		13	SLBC	360	1.000	360
4	M	PRCH		13	SLBC	511	1.000	511
5	U	^UL	Overhang	13	Upper Level	920	1.000	920
<b>Total Building Area</b>						<b>1,978</b>		<b>2,898</b>



# Rogers

## Assessment Property Record Card for Tax Year 2026

Data provided by LISA DELOZIER County Assessor

Date 04/17/2026  
Time 07:04:21  
Page 4

660085079

### Outbuildings/Site Improvements

Building Image	Code	Description	Dimensions	Floor	Roofing	Total Units
	STF	STG FAIR	0x0x0			
	Qual	2	Cond 3	Year	Eff Age	1520
Valuation Summary		Modifier Total		RCN	Depr (100% Phys/ % Func)	RCNLD
Base Cost (4.68 x )						