



Rogers

Assessment Property Record Card for Tax Year 2026

Data provided by LISA DELOZIER County Assessor

Date 04/18/2026
Time 07:24:43
Page 1

Assessment Data					Primary Image																																																																																																																				
Account 660085099 Parcel ID 000000-00-0-00686-001-0039 Cadastral ID 23-21-15-01580 Property Type REAL - Real Property Property Class RRP VI Area 4 Tax Area 18 - CLAREMORE RURAL/W/O FIRE Name ID 315411 ILYUSHENKO, RUSLAN & PEPPER 22305 RIVERWOOD DR CLAREMORE OK 74019-0000 Parcel Location Situs 22305 RIVERWOOD DR Subdivision RIVERWOOD ESTATES Lot/Block 0039 / 0001 Parcel Size 1 - Lots Sec/Twn/Rng 23 / 21 / 15 / 5 Neighborhood 1089 - R-V03,4-SE CLAREMORE School District S001 - CLAREMORE SCHOOLS																																																																																																																									
Legal Description Lot/Long: 36.28873254 -95.67381991 LOT 39 BLOCK 1 RIVERWOOD ESTATES																																																																																																																									
Exemptions <table border="1"> <thead> <tr> <th>Code</th> <th>Type</th> <th>Active</th> <th>Maximum</th> <th>Exemption</th> </tr> </thead> <tbody> <tr> <td>H</td> <td>Homestead</td> <td>Yes</td> <td>1,000</td> <td>1,000</td> </tr> </tbody> </table>					Code	Type	Active	Maximum	Exemption	H	Homestead	Yes	1,000	1,000	Building Permits <table border="1"> <thead> <tr> <th>Number</th> <th>Description</th> <th>Opened</th> <th>Closed</th> <th>Amount</th> </tr> </thead> <tbody> <tr> <td>P19 000012</td> <td>R20- NEW POOL</td> <td>03/2019</td> <td>07/2019</td> <td>50,000</td> </tr> </tbody> </table>					Number	Description	Opened	Closed	Amount	P19 000012	R20- NEW POOL	03/2019	07/2019	50,000																																																																																												
Code	Type	Active	Maximum	Exemption																																																																																																																					
H	Homestead	Yes	1,000	1,000																																																																																																																					
Number	Description	Opened	Closed	Amount																																																																																																																					
P19 000012	R20- NEW POOL	03/2019	07/2019	50,000																																																																																																																					
Parcel Valuation <table border="1"> <thead> <tr> <th>Source</th> <th>REAL</th> <th>Fair Cash</th> <th>Capped</th> <th>Asmnt Level</th> <th>Assessed</th> <th>Levy Rate</th> <th>92.430</th> <th>Current Tax</th> </tr> </thead> <tbody> <tr> <td>Remove Cap</td> <td>2016</td> <td>Land Value</td> <td>61,723</td> <td>56,557</td> <td>11%</td> <td>6,221</td> <td>Assessed</td> <td>47,428 4,383.77</td> </tr> <tr> <td>Year Frozen</td> <td>0</td> <td>Improvements</td> <td>374,611</td> <td>374,611</td> <td></td> <td>41,207</td> <td>Penalty</td> <td>0</td> </tr> <tr> <td>Uncapped Value</td> <td>0</td> <td>Mobile Home</td> <td>0</td> <td>0</td> <td></td> <td>0</td> <td>Exemption</td> <td>1,000 -93.00</td> </tr> <tr> <td>TIF Project ID</td> <td>0</td> <td>Total Value</td> <td>436,334</td> <td>431,168</td> <td></td> <td>47,428</td> <td>Total Taxable</td> <td>46,428 4,291.00</td> </tr> </tbody> </table>					Source	REAL	Fair Cash	Capped	Asmnt Level	Assessed	Levy Rate	92.430	Current Tax	Remove Cap	2016	Land Value	61,723	56,557	11%	6,221	Assessed	47,428 4,383.77	Year Frozen	0	Improvements	374,611	374,611		41,207	Penalty	0	Uncapped Value	0	Mobile Home	0	0		0	Exemption	1,000 -93.00	TIF Project ID	0	Total Value	436,334	431,168		47,428	Total Taxable	46,428 4,291.00	Sale History <table border="1"> <thead> <tr> <th>Bk/Pg</th> <th>Grantor</th> <th>Date</th> <th>Price</th> <th>Code</th> </tr> </thead> <tbody> <tr> <td>2478/667</td> <td>BOWEN, MELODY D</td> <td>06/05/2015</td> <td>298,500</td> <td>YES</td> </tr> <tr> <td>2187/824</td> <td>LEACH, RONALD &</td> <td>08/10/2011</td> <td>284,000</td> <td>YES</td> </tr> <tr> <td>1694/457</td> <td>HIGHFILL PROPERTIES LLC</td> <td>07/14/2005</td> <td>29,000</td> <td>YES</td> </tr> </tbody> </table>					Bk/Pg	Grantor	Date	Price	Code	2478/667	BOWEN, MELODY D	06/05/2015	298,500	YES	2187/824	LEACH, RONALD &	08/10/2011	284,000	YES	1694/457	HIGHFILL PROPERTIES LLC	07/14/2005	29,000	YES																																															
Source	REAL	Fair Cash	Capped	Asmnt Level	Assessed	Levy Rate	92.430	Current Tax																																																																																																																	
Remove Cap	2016	Land Value	61,723	56,557	11%	6,221	Assessed	47,428 4,383.77																																																																																																																	
Year Frozen	0	Improvements	374,611	374,611		41,207	Penalty	0																																																																																																																	
Uncapped Value	0	Mobile Home	0	0		0	Exemption	1,000 -93.00																																																																																																																	
TIF Project ID	0	Total Value	436,334	431,168		47,428	Total Taxable	46,428 4,291.00																																																																																																																	
Bk/Pg	Grantor	Date	Price	Code																																																																																																																					
2478/667	BOWEN, MELODY D	06/05/2015	298,500	YES																																																																																																																					
2187/824	LEACH, RONALD &	08/10/2011	284,000	YES																																																																																																																					
1694/457	HIGHFILL PROPERTIES LLC	07/14/2005	29,000	YES																																																																																																																					
Assessment History <table border="1"> <thead> <tr> <th>Tax Year</th> <th>Statement Number</th> <th>Billed Owner</th> <th>Tax Area</th> <th>Total Value</th> <th>Exemptions</th> <th>Taxable Value</th> <th>Billed Tax</th> </tr> </thead> <tbody> <tr><td>2025</td><td>2025-660085099</td><td>ILYUSHENKO, RUSLAN & PEPPER</td><td>18</td><td>426,329</td><td>0</td><td>46,047</td><td>4,256.00</td></tr> <tr><td>2024</td><td>2024-660085099</td><td>ILYUSHENKO, RUSLAN & PEPPER</td><td>18</td><td>448,637</td><td>0</td><td>43,854</td><td>4,053.00</td></tr> <tr><td>2023</td><td>2023-660085099</td><td>ILYUSHENKO, RUSLAN & PEPPER</td><td>18</td><td>382,347</td><td>0</td><td>41,766</td><td>3,826.00</td></tr> <tr><td>2022</td><td>2022-660085099</td><td>ILYUSHENKO, RUSLAN & PEPPER</td><td>18</td><td>372,222</td><td>0</td><td>39,777</td><td>3,682.00</td></tr> <tr><td>2021</td><td>2021-660085099</td><td>ILYUSHENKO, RUSLAN & PEPPER</td><td>18</td><td>344,394</td><td>0</td><td>37,883</td><td>3,345.00</td></tr> <tr><td>2020</td><td>2020-660085099</td><td>ILYUSHENKO, RUSLAN & PEPPER</td><td>18</td><td>341,462</td><td>0</td><td>37,387</td><td>3,424.00</td></tr> <tr><td>2019</td><td>2019-660085099</td><td>ILYUSHENKO, RUSLAN & PEPPER</td><td>18</td><td>303,997</td><td>0</td><td>33,440</td><td>3,097.00</td></tr> <tr><td>2018</td><td>2018-660085099</td><td>ILYUSHENKO, RUSLAN & PEPPER</td><td>18</td><td>312,296</td><td>0</td><td>34,353</td><td>3,174.00</td></tr> <tr><td>2017</td><td>2017-660085099</td><td>ILYUSHENKO, RUSLAN & PEPPER</td><td>18</td><td>309,594</td><td>0</td><td>34,055</td><td>3,124.00</td></tr> <tr><td>2016</td><td>2016-660085099</td><td>ILYUSHENKO, RUSLAN & PEPPER</td><td>18</td><td>301,209</td><td>0</td><td>33,133</td><td>3,106.00</td></tr> <tr><td>2015</td><td>2015-660085099</td><td>ILYUSHENKO, RUSLAN & PEPPER</td><td>18</td><td>291,369</td><td>0</td><td>32,051</td><td>2,886.00</td></tr> <tr><td>2014</td><td>2014-660085099</td><td>BOWEN, MELODY D</td><td>18</td><td>299,073</td><td>0</td><td>32,047</td><td>2,972.00</td></tr> <tr><td>2013</td><td>2013-660085099</td><td>BOWEN, MELODY D</td><td>18</td><td>277,462</td><td>0</td><td>30,521</td><td>2,793.00</td></tr> </tbody> </table>										Tax Year	Statement Number	Billed Owner	Tax Area	Total Value	Exemptions	Taxable Value	Billed Tax	2025	2025-660085099	ILYUSHENKO, RUSLAN & PEPPER	18	426,329	0	46,047	4,256.00	2024	2024-660085099	ILYUSHENKO, RUSLAN & PEPPER	18	448,637	0	43,854	4,053.00	2023	2023-660085099	ILYUSHENKO, RUSLAN & PEPPER	18	382,347	0	41,766	3,826.00	2022	2022-660085099	ILYUSHENKO, RUSLAN & PEPPER	18	372,222	0	39,777	3,682.00	2021	2021-660085099	ILYUSHENKO, RUSLAN & PEPPER	18	344,394	0	37,883	3,345.00	2020	2020-660085099	ILYUSHENKO, RUSLAN & PEPPER	18	341,462	0	37,387	3,424.00	2019	2019-660085099	ILYUSHENKO, RUSLAN & PEPPER	18	303,997	0	33,440	3,097.00	2018	2018-660085099	ILYUSHENKO, RUSLAN & PEPPER	18	312,296	0	34,353	3,174.00	2017	2017-660085099	ILYUSHENKO, RUSLAN & PEPPER	18	309,594	0	34,055	3,124.00	2016	2016-660085099	ILYUSHENKO, RUSLAN & PEPPER	18	301,209	0	33,133	3,106.00	2015	2015-660085099	ILYUSHENKO, RUSLAN & PEPPER	18	291,369	0	32,051	2,886.00	2014	2014-660085099	BOWEN, MELODY D	18	299,073	0	32,047	2,972.00	2013	2013-660085099	BOWEN, MELODY D	18	277,462	0	30,521	2,793.00
Tax Year	Statement Number	Billed Owner	Tax Area	Total Value	Exemptions	Taxable Value	Billed Tax																																																																																																																		
2025	2025-660085099	ILYUSHENKO, RUSLAN & PEPPER	18	426,329	0	46,047	4,256.00																																																																																																																		
2024	2024-660085099	ILYUSHENKO, RUSLAN & PEPPER	18	448,637	0	43,854	4,053.00																																																																																																																		
2023	2023-660085099	ILYUSHENKO, RUSLAN & PEPPER	18	382,347	0	41,766	3,826.00																																																																																																																		
2022	2022-660085099	ILYUSHENKO, RUSLAN & PEPPER	18	372,222	0	39,777	3,682.00																																																																																																																		
2021	2021-660085099	ILYUSHENKO, RUSLAN & PEPPER	18	344,394	0	37,883	3,345.00																																																																																																																		
2020	2020-660085099	ILYUSHENKO, RUSLAN & PEPPER	18	341,462	0	37,387	3,424.00																																																																																																																		
2019	2019-660085099	ILYUSHENKO, RUSLAN & PEPPER	18	303,997	0	33,440	3,097.00																																																																																																																		
2018	2018-660085099	ILYUSHENKO, RUSLAN & PEPPER	18	312,296	0	34,353	3,174.00																																																																																																																		
2017	2017-660085099	ILYUSHENKO, RUSLAN & PEPPER	18	309,594	0	34,055	3,124.00																																																																																																																		
2016	2016-660085099	ILYUSHENKO, RUSLAN & PEPPER	18	301,209	0	33,133	3,106.00																																																																																																																		
2015	2015-660085099	ILYUSHENKO, RUSLAN & PEPPER	18	291,369	0	32,051	2,886.00																																																																																																																		
2014	2014-660085099	BOWEN, MELODY D	18	299,073	0	32,047	2,972.00																																																																																																																		
2013	2013-660085099	BOWEN, MELODY D	18	277,462	0	30,521	2,793.00																																																																																																																		



Rogers

Assessment Property Record Card for Tax Year 2026

Data provided by LISA DELOZIER County Assessor

Date 04/18/2026
Time 07:24:44
Page 2

Lot Data	Square-Foot - NBHD 1089 #1	Primary Image
Lot Size		
Lot Count		
Units Buildable	1	
Non-Ag Acres	1.0322	
Topography		
Street Access		
Utilities		
Amenities	LAND QUALITY	
	0	
	0	
Method	Square-Foot	
Base Lot Value	44,964.00 x 1.37 = 61,723	
Factor Value		
Adjustments	1.0000	
Lot Value	61,723	

Residential Data	
Type	1 Single Family Residence
Condition	3 - Average
Quality	3 - Average
Architecture	
Style	100% One Story
Exterior Wall	100% Veneer, Masonry
Base/Total Area	2,967 / 2,967
Style	100% One Story
HVAC	100% Warmed & Cooled Air
Roof Cover	1 Composition Shingle
Area on Slab	2,967
Fixture/RghIn	16 /
Bed/F/H Bath	4 / 3.5 /
Basement Area	
Garage Type	820 Attached Garage - Unfinished
Remodel	
Year/Eff Age	2008 / 14

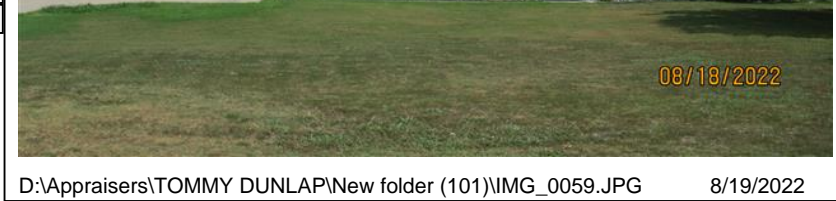

D:\Appraisers\TOMMY DUNLAP\New folder (101)\IMG_0059.JPG 8/19/2022

Cost Approach		Manual : 01/2025	
Base Cost	100.34	Total Misc Impr	+ 10,505
Roofing Adj	+ 4.38	Garage Cost	+ 24,428
Subfloor Adj	+ -2.06	Total RCN	= 399,221
Heat/Cool Adj	+ 12.64	Depreciation (14%)	- 55,891
Plumbing Adj	+ 7.48	Lump Sums	+ 0
Basement Adj	+ 0.00	RCNLD	= 343,330
Adj Base Cost	= 122.78	Lot Value	+ 61,723
Total Area	x 2,967	Indicated Value	= 405,053
Adjusted Cost	= 364,288	Value Per SqFt	136.52

GRM Approach	
GRM Code	
Gross Rent	0.00
Indicated Value	

Multiple Regression			
MRA Code	1	Test	
Adusted R	0.8445		
Indicated Value	382,418	128.89	Per SqFt

Direct Comparables	
Selection Model	A Adam Test
Adjustment Model	1 2022 Residential
Comparables	7
Indicated Value	413,590 Per SqFt

Value Reconciliation			
Selected Approach	Cost Approach		
Improvements	343,330		
Lot Value	61,723		
Indicated Value	405,053	136.52	Per SqFt
Agland Value			
Site Improvements	31,281		
Total Value	436,334	147.06	Total Value Per SqFt

Miscellaneous Improvements								
Code	Description	Sketch ID	Size	Year	Units	Unit Cost	Depr	Value
PRCH	SLAB PORCH - COVERED	103583	152		152	26.45		4,020
PRCH	SLAB PORCH - COVERED	103584	248		248	26.15		6,485



Rogers



Assessment Property Record Card for Tax Year 2026

Data provided by LISA DELOZIER County Assessor

Date 04/18/2026
 Time 07:24:44
 Page 4

660085099

Outbuildings/Site Improvements

Building Image	Code	Description	Dimensions	Floor	Roofing	Total Units	
	SG	SWIM-GUNITE	0x0x0			1	
	Qual	Cond	Year	2019	Eff Age		
	Valuation Summary Base Cost (30,000.00 x 1) 30,000		Modifier Total	RCN 30,000	Depr (0% Phys/ % Func)	RCNLD 30,000	
	STA	STG AVG	12x16x0			192	
	Qual	3	Cond	3	Year	2014	Eff Age
	Valuation Summary Base Cost (7.02 x 192) 1,348		Modifier Total	RCN 1,348	Depr (5% Phys/ % Func) 67	RCNLD 1,281	