



# Rogers

## Assessment Property Record Card for Tax Year 2026

Data provided by LISA DELOZIER County Assessor

Date 04/18/2026  
 Time 07:02:13  
 Page 1

Assessment Data					Primary Image																																																																																																																				
<b>Account</b> 660085493 <b>Parcel ID</b> 000000-00-0-10134-007-0013 <b>Cadastral ID</b> 05-21-16-16460 <b>Property Type</b> REAL - Real Property <b>Property Class</b> URP VI Area 1 <b>Tax Area</b> 17 - CLAREMORE OT <b>Name ID</b> 313686 MORTON, CINDY J  1004 W 24TH ST N CLAREMORE OK 74017-0000  <b>Parcel Location</b> <b>Situs</b> 01004 W 24TH ST N <b>Subdivision</b> GREEN BRIER PARK III <b>Lot/Block</b> 0013 / 0007 <b>Parcel Size</b> 1 - Lots <b>Sec/Twn/Rng</b> 5 / 21 / 16 / 5 <b>Neighborhood</b> 1183 - R-V01-SW CLAREMORE <b>School District</b> S001 - CLAREMORE SCHOOLS																																																																																																																									
<b>Legal Description</b> Lot/Long: 36.33253145 -95.62020111																																																																																																																									
<b>Legal Description</b> LOT 13 BLOCK 7 GREENBRIER PARK III					<b>Building Permits</b> <table border="1"> <thead> <tr> <th>Number</th> <th>Description</th> <th>Opened</th> <th>Closed</th> <th>Amount</th> </tr> </thead> <tbody> <tr> <td>3557</td> <td>R6 FOR NEW 1,101 SQ FT SFR</td> <td>07/2005</td> <td>12/2005</td> <td></td> </tr> </tbody> </table>					Number	Description	Opened	Closed	Amount	3557	R6 FOR NEW 1,101 SQ FT SFR	07/2005	12/2005																																																																																																							
Number	Description	Opened	Closed	Amount																																																																																																																					
3557	R6 FOR NEW 1,101 SQ FT SFR	07/2005	12/2005																																																																																																																						
<b>Exemptions</b> <table border="1"> <thead> <tr> <th>Code</th> <th>Type</th> <th>Active</th> <th>Maximum</th> <th>Exemption</th> </tr> </thead> <tbody> <tr> <td>H</td> <td>Homestead</td> <td>Yes</td> <td>1,000</td> <td>1,000</td> </tr> <tr> <td>H</td> <td>Homestead</td> <td>No</td> <td>1,000</td> <td></td> </tr> </tbody> </table>					Code	Type	Active	Maximum	Exemption	H	Homestead	Yes	1,000	1,000	H	Homestead	No	1,000		<b>Sale History</b> <table border="1"> <thead> <tr> <th>Bk/Pg</th> <th>Grantor</th> <th>Date</th> <th>Price</th> <th>Code</th> </tr> </thead> <tbody> <tr> <td>2436/91</td> <td>TODHUNTER, ANDREW N</td> <td>10/30/2014</td> <td>98,500</td> <td>YES</td> </tr> <tr> <td>2171/113</td> <td>FANNIE MAE</td> <td>05/02/2011</td> <td>81,000</td> <td>3</td> </tr> <tr> <td>2162/397</td> <td>MASTERS, NICHOLAS K</td> <td>03/07/2011</td> <td>0</td> <td>10</td> </tr> <tr> <td>1763/155</td> <td>CHUMLEY &amp; ASSOCIATES INC</td> <td>03/17/2006</td> <td>89,500</td> <td>YES</td> </tr> <tr> <td>1728/569</td> <td>GRECO PROPERTIES INC</td> <td>08/12/2005</td> <td>665,000</td> <td>5</td> </tr> </tbody> </table>					Bk/Pg	Grantor	Date	Price	Code	2436/91	TODHUNTER, ANDREW N	10/30/2014	98,500	YES	2171/113	FANNIE MAE	05/02/2011	81,000	3	2162/397	MASTERS, NICHOLAS K	03/07/2011	0	10	1763/155	CHUMLEY & ASSOCIATES INC	03/17/2006	89,500	YES	1728/569	GRECO PROPERTIES INC	08/12/2005	665,000	5																																																																			
Code	Type	Active	Maximum	Exemption																																																																																																																					
H	Homestead	Yes	1,000	1,000																																																																																																																					
H	Homestead	No	1,000																																																																																																																						
Bk/Pg	Grantor	Date	Price	Code																																																																																																																					
2436/91	TODHUNTER, ANDREW N	10/30/2014	98,500	YES																																																																																																																					
2171/113	FANNIE MAE	05/02/2011	81,000	3																																																																																																																					
2162/397	MASTERS, NICHOLAS K	03/07/2011	0	10																																																																																																																					
1763/155	CHUMLEY & ASSOCIATES INC	03/17/2006	89,500	YES																																																																																																																					
1728/569	GRECO PROPERTIES INC	08/12/2005	665,000	5																																																																																																																					
<b>Parcel Valuation</b> <table border="1"> <thead> <tr> <th>Source</th> <th>REAL</th> <th>Fair Cash</th> <th>Capped</th> <th>Asmnt Level</th> <th>Assessed</th> <th>Levy Rate</th> <th>92.430</th> <th>Current Tax</th> </tr> </thead> <tbody> <tr> <td>Remove Cap</td> <td>2015</td> <td>Land Value 35,900</td> <td>26,892</td> <td>11%</td> <td>2,958</td> <td>Assessed</td> <td>14,018</td> <td>1,295.68</td> </tr> <tr> <td>Year Frozen</td> <td>0</td> <td>Improvements 110,128</td> <td>100,545</td> <td></td> <td>11,060</td> <td>Penalty</td> <td>0</td> <td></td> </tr> <tr> <td>Uncapped Value</td> <td>0</td> <td>Mobile Home 0</td> <td>0</td> <td></td> <td>0</td> <td>Exemption</td> <td>1,000</td> <td>-93.00</td> </tr> <tr> <td>TIF Project ID</td> <td>0</td> <td>Total Value 146,028</td> <td>127,437</td> <td></td> <td>14,018</td> <td>Total Taxable</td> <td>13,018</td> <td>1,203.00</td> </tr> </tbody> </table>										Source	REAL	Fair Cash	Capped	Asmnt Level	Assessed	Levy Rate	92.430	Current Tax	Remove Cap	2015	Land Value 35,900	26,892	11%	2,958	Assessed	14,018	1,295.68	Year Frozen	0	Improvements 110,128	100,545		11,060	Penalty	0		Uncapped Value	0	Mobile Home 0	0		0	Exemption	1,000	-93.00	TIF Project ID	0	Total Value 146,028	127,437		14,018	Total Taxable	13,018	1,203.00																																																																			
Source	REAL	Fair Cash	Capped	Asmnt Level	Assessed	Levy Rate	92.430	Current Tax																																																																																																																	
Remove Cap	2015	Land Value 35,900	26,892	11%	2,958	Assessed	14,018	1,295.68																																																																																																																	
Year Frozen	0	Improvements 110,128	100,545		11,060	Penalty	0																																																																																																																		
Uncapped Value	0	Mobile Home 0	0		0	Exemption	1,000	-93.00																																																																																																																	
TIF Project ID	0	Total Value 146,028	127,437		14,018	Total Taxable	13,018	1,203.00																																																																																																																	
<b>Assessment History</b> <table border="1"> <thead> <tr> <th>Tax Year</th> <th>Statement Number</th> <th>Billed Owner</th> <th>Tax Area</th> <th>Total Value</th> <th>Exemptions</th> <th>Taxable Value</th> <th>Billed Tax</th> </tr> </thead> <tbody> <tr><td>2025</td><td>2025-660085493</td><td>MORTON, CINDY J</td><td>17</td><td>144,632</td><td>1000</td><td>12,610</td><td>1,166.00</td></tr> <tr><td>2024</td><td>2024-660085493</td><td>MORTON, CINDY J</td><td>17</td><td>146,763</td><td>1000</td><td>12,213</td><td>1,129.00</td></tr> <tr><td>2023</td><td>2023-660085493</td><td>MORTON, CINDY J</td><td>17</td><td>130,690</td><td>1000</td><td>11,829</td><td>1,084.00</td></tr> <tr><td>2022</td><td>2022-660085493</td><td>MORTON, CINDY J</td><td>17</td><td>124,186</td><td>1000</td><td>11,455</td><td>1,060.00</td></tr> <tr><td>2021</td><td>2021-660085493</td><td>MORTON, CINDY J</td><td>17</td><td>113,407</td><td>1000</td><td>11,093</td><td>980.00</td></tr> <tr><td>2020</td><td>2020-660085493</td><td>MORTON, CINDY J</td><td>17</td><td>108,728</td><td>1000</td><td>10,740</td><td>983.00</td></tr> <tr><td>2019</td><td>2019-660085493</td><td>MORTON, CINDY J</td><td>17</td><td>103,623</td><td>1000</td><td>10,399</td><td>963.00</td></tr> <tr><td>2018</td><td>2018-660085493</td><td>MORTON, CINDY J</td><td>17</td><td>106,404</td><td>1000</td><td>10,704</td><td>989.00</td></tr> <tr><td>2017</td><td>2017-660085493</td><td>MORTON, CINDY J</td><td>17</td><td>105,565</td><td>1000</td><td>10,612</td><td>975.00</td></tr> <tr><td>2016</td><td>2016-660085493</td><td>MORTON, CINDY J</td><td>17</td><td>103,000</td><td>0</td><td>11,330</td><td>1,063.00</td></tr> <tr><td>2015</td><td>2015-660085493</td><td>MORTON, CINDY J</td><td>17</td><td>100,801</td><td>0</td><td>11,088</td><td>1,000.00</td></tr> <tr><td>2014</td><td>2014-660085493</td><td>TODHUNTER, ANDREW N</td><td>17</td><td>105,156</td><td>1000</td><td>10,080</td><td>935.00</td></tr> <tr><td>2013</td><td>2013-660085493</td><td>TODHUNTER, ANDREW N</td><td>17</td><td>101,299</td><td>1000</td><td>9,757</td><td>893.00</td></tr> </tbody> </table>										Tax Year	Statement Number	Billed Owner	Tax Area	Total Value	Exemptions	Taxable Value	Billed Tax	2025	2025-660085493	MORTON, CINDY J	17	144,632	1000	12,610	1,166.00	2024	2024-660085493	MORTON, CINDY J	17	146,763	1000	12,213	1,129.00	2023	2023-660085493	MORTON, CINDY J	17	130,690	1000	11,829	1,084.00	2022	2022-660085493	MORTON, CINDY J	17	124,186	1000	11,455	1,060.00	2021	2021-660085493	MORTON, CINDY J	17	113,407	1000	11,093	980.00	2020	2020-660085493	MORTON, CINDY J	17	108,728	1000	10,740	983.00	2019	2019-660085493	MORTON, CINDY J	17	103,623	1000	10,399	963.00	2018	2018-660085493	MORTON, CINDY J	17	106,404	1000	10,704	989.00	2017	2017-660085493	MORTON, CINDY J	17	105,565	1000	10,612	975.00	2016	2016-660085493	MORTON, CINDY J	17	103,000	0	11,330	1,063.00	2015	2015-660085493	MORTON, CINDY J	17	100,801	0	11,088	1,000.00	2014	2014-660085493	TODHUNTER, ANDREW N	17	105,156	1000	10,080	935.00	2013	2013-660085493	TODHUNTER, ANDREW N	17	101,299	1000	9,757	893.00
Tax Year	Statement Number	Billed Owner	Tax Area	Total Value	Exemptions	Taxable Value	Billed Tax																																																																																																																		
2025	2025-660085493	MORTON, CINDY J	17	144,632	1000	12,610	1,166.00																																																																																																																		
2024	2024-660085493	MORTON, CINDY J	17	146,763	1000	12,213	1,129.00																																																																																																																		
2023	2023-660085493	MORTON, CINDY J	17	130,690	1000	11,829	1,084.00																																																																																																																		
2022	2022-660085493	MORTON, CINDY J	17	124,186	1000	11,455	1,060.00																																																																																																																		
2021	2021-660085493	MORTON, CINDY J	17	113,407	1000	11,093	980.00																																																																																																																		
2020	2020-660085493	MORTON, CINDY J	17	108,728	1000	10,740	983.00																																																																																																																		
2019	2019-660085493	MORTON, CINDY J	17	103,623	1000	10,399	963.00																																																																																																																		
2018	2018-660085493	MORTON, CINDY J	17	106,404	1000	10,704	989.00																																																																																																																		
2017	2017-660085493	MORTON, CINDY J	17	105,565	1000	10,612	975.00																																																																																																																		
2016	2016-660085493	MORTON, CINDY J	17	103,000	0	11,330	1,063.00																																																																																																																		
2015	2015-660085493	MORTON, CINDY J	17	100,801	0	11,088	1,000.00																																																																																																																		
2014	2014-660085493	TODHUNTER, ANDREW N	17	105,156	1000	10,080	935.00																																																																																																																		
2013	2013-660085493	TODHUNTER, ANDREW N	17	101,299	1000	9,757	893.00																																																																																																																		



# Rogers

## Assessment Property Record Card for Tax Year 2026

Data provided by LISA DELOZIER County Assessor

Date 04/18/2026  
Time 07:02:13  
Page 2

Lot Data	Square-Foot - NBHD 1183 #1	Primary Image
<b>Lot Size</b> <b>Lot Count</b> 1 <b>Units Buildable</b> 1 <b>Non-Ag Acres</b> 0.1648 <b>Topography</b> <b>Street Access</b> <b>Utilities</b> <b>Amenities</b> LOT SIZE ADJUSTMENT 0 0 <b>Method</b> Square-Foot <b>Base Lot Value</b> 7,180.00 x 5.00 = 35,900 <b>Factor Value</b> <b>Adjustments</b> 1.0000 <b>Lot Value</b> 35,900		 <p>\\tsclient\T\LOGAN\LOGAN RESIDENTIAL VI\2023-4-11\IMG_004 4/11/2023</p>

Residential Data	
<b>Type</b>	1 Single Family Residence
<b>Condition</b>	3 - Average
<b>Quality</b>	2 - Fair
<b>Architecture</b>	R3 Res Nbhd 3
<b>Style</b>	100% One Story
<b>Exterior Wall</b>	10% Veneer, Masonry 90% Frame, Siding, Vinyl
<b>Base/Total Area</b>	1,100 / 1,100
<b>Style</b>	100% One Story
<b>HVAC</b>	100% Warmed & Cooled Air
<b>Roof Cover</b>	1 Composition Shingle
<b>Area on Slab</b>	1,100
<b>Fixture/RghIn</b>	11 /
<b>Bed/F/H Bath</b>	3 / 2.0 /
<b>Basement Area</b>	
<b>Garage Type</b>	440 Attached Garage - Unfinished
<b>Remodel</b>	
<b>Year/Eff Age</b>	2004 / 17

Cost Approach				Manual : 01/2025			
<b>Base Cost</b>	93.25	<b>Total Misc Impr</b>	+ 5,071				
<b>Roofing Adj</b>	+ 4.18	<b>Garage Cost</b>	+ 10,613				
<b>Subfloor Adj</b>	+ 0.00	<b>Total RCN</b>	= 146,837				
<b>Heat/Cool Adj</b>	+ 10.30	<b>Depreciation ( 25%)</b>	- 36,709				
<b>Plumbing Adj</b>	+ 11.50	<b>Lump Sums</b>	+ 0				
<b>Basement Adj</b>	+ 0.00	<b>RCNLD</b>	= 110,128				
<b>Adj Base Cost</b>	= 119.23	<b>Lot Value</b>	+ 35,900				
<b>Total Area</b>	x 1,100	<b>Indicated Value</b>	= 146,028				
<b>Adjusted Cost</b>	= 131,153	<b>Value Per SqFt</b>	132.75				

GRM Approach	
<b>GRM Code</b>	
<b>Gross Rent</b>	0.00
<b>Indicated Value</b>	

Multiple Regression			
<b>MRA Code</b>	1	Test	
<b>Adusted R</b>	0.8445		
<b>Indicated Value</b>	146,978	133.62	Per SqFt

Direct Comparables			
<b>Selection Model</b>	A	Adam Test	
<b>Adjustment Model</b>	1	2022 Residential	
<b>Comparables</b>	6		
<b>Indicated Value</b>	140,770		Per SqFt

Value Reconciliation			
<b>Selected Approach</b>	Cost Approach		
<b>Improvements</b>	110,128		
<b>Lot Value</b>	35,900		
<b>Indicated Value</b>	146,028	132.75	Per SqFt
<b>Agland Value</b>			
<b>Site Improvements</b>			
<b>Total Value</b>	146,028	132.75	Total Value Per SqFt

Miscellaneous Improvements								
Code	Description	Sketch ID	Size	Year	Units	Unit Cost	Depr	Value
PRCH	SLAB PORCH - COVERED	104339	13x4		52	21.13		1,099
PRCH	SLAB PORCH - COVERED	104341	16x12		192	20.69		3,972



# Rogers

## Assessment Property Record Card for Tax Year 2026

Data provided by LISA DELOZIER County Assessor

Date 04/18/2026  
 Time 07:02:13  
 Page 3

### Sketch Image

660085493

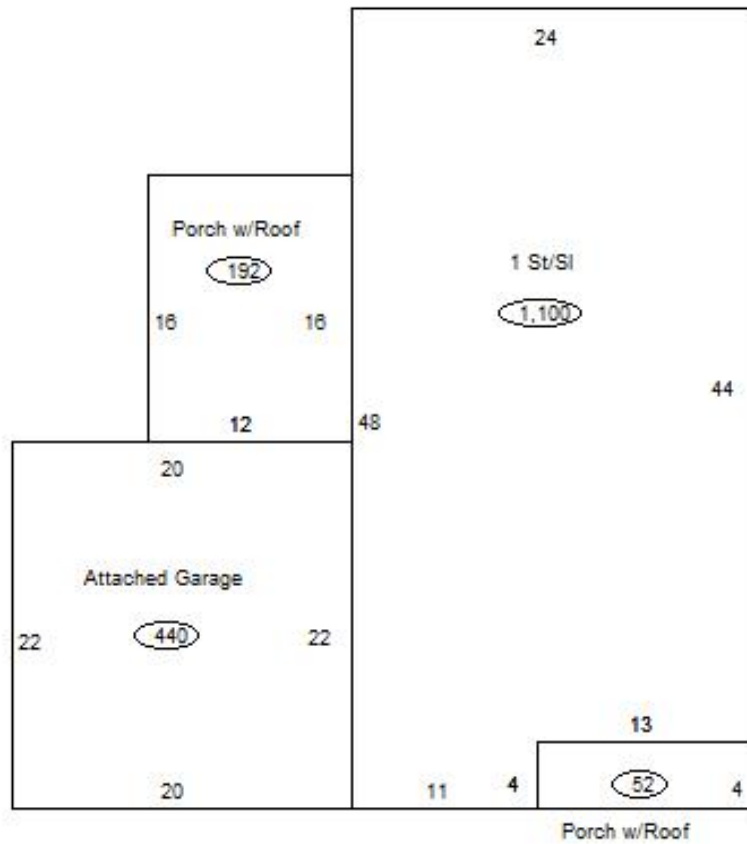

### Sketch Vector Information

Sequence	Code	Type	Built Over	Scale	Section Label	Base Area	Multiplier	Total Area
1	R	1	Slab	13	1 St/SI	1,100	1.000	1,100
2	M	PRCH		13	SLBC	52	1.000	52
3	G	1		13	Attached Garage	440	1.000	440
4	M	PRCH		13	SLBC	192	1.000	192
<b>Total Building Area</b>						1,100		1,100