



Rogers

Assessment Property Record Card for Tax Year 2026

Data provided by LISA DELOZIER County Assessor

Date 04/18/2026
Time 07:23:49
Page 1

Assessment Data					Primary Image																																																																																																																				
Account 660085515 Parcel ID 000000-00-0-10134-008-0036 Cadastral ID 05-21-16-16680 Property Type REAL - Real Property Property Class URP VI Area 1 Tax Area 17 - CLAREMORE OT Name ID 344476 HAMES, TANA & GAIL TRUE 2106 GREENBRIER CT CLAREMORE OK 74017-0000 Parcel Location Situs 02106 GREENBRIER CT Subdivision GREEN BRIER PARK III Lot/Block 0036 / 0008 Parcel Size 1 - Lots Sec/Twn/Rng 5 / 21 / 16 / 5 Neighborhood 1183 - R-V01-SW CLAREMORE School District S001 - CLAREMORE SCHOOLS																																																																																																																									
Legal Description Lot/Long: 36.33191994 -95.62171132																																																																																																																									
Legal Description LOT 36 BLOCK 8 GREENBRIER PARK III					Building Permits <table border="1"> <thead> <tr> <th>Number</th> <th>Description</th> <th>Opened</th> <th>Closed</th> <th>Amount</th> </tr> </thead> <tbody> <tr> <td>3446</td> <td>R6 FOR NEW SFR</td> <td>03/2005</td> <td>09/2005</td> <td>51,660</td> </tr> </tbody> </table>					Number	Description	Opened	Closed	Amount	3446	R6 FOR NEW SFR	03/2005	09/2005	51,660																																																																																																						
Number	Description	Opened	Closed	Amount																																																																																																																					
3446	R6 FOR NEW SFR	03/2005	09/2005	51,660																																																																																																																					
Exemptions <table border="1"> <thead> <tr> <th>Code</th> <th>Type</th> <th>Active</th> <th>Maximum</th> <th>Exemption</th> </tr> </thead> <tbody> <tr> <td></td> <td></td> <td></td> <td></td> <td></td> </tr> </tbody> </table>					Code	Type	Active	Maximum	Exemption						Sale History <table border="1"> <thead> <tr> <th>Bk/Pg</th> <th>Grantor</th> <th>Date</th> <th>Price</th> <th>Code</th> </tr> </thead> <tbody> <tr> <td>/</td> <td>ORBECK, JEREMY L &</td> <td>05/29/2024</td> <td>188,000</td> <td>YES</td> </tr> <tr> <td>2482/463</td> <td>SIQUEIRA, DAVI &</td> <td>06/25/2015</td> <td>107,000</td> <td>YES</td> </tr> <tr> <td>2186/583</td> <td>BLALOCK, TERALL</td> <td>08/04/2011</td> <td>95,000</td> <td>YES</td> </tr> <tr> <td>1687/75</td> <td>CHUMLEY & ASSOCIATES INC</td> <td>06/13/2005</td> <td>97,500</td> <td>12</td> </tr> <tr> <td>1660/274</td> <td>GRECO PROPERTIES INC</td> <td>03/02/2005</td> <td>17,500</td> <td>5</td> </tr> </tbody> </table>					Bk/Pg	Grantor	Date	Price	Code	/	ORBECK, JEREMY L &	05/29/2024	188,000	YES	2482/463	SIQUEIRA, DAVI &	06/25/2015	107,000	YES	2186/583	BLALOCK, TERALL	08/04/2011	95,000	YES	1687/75	CHUMLEY & ASSOCIATES INC	06/13/2005	97,500	12	1660/274	GRECO PROPERTIES INC	03/02/2005	17,500	5																																																																								
Code	Type	Active	Maximum	Exemption																																																																																																																					
Bk/Pg	Grantor	Date	Price	Code																																																																																																																					
/	ORBECK, JEREMY L &	05/29/2024	188,000	YES																																																																																																																					
2482/463	SIQUEIRA, DAVI &	06/25/2015	107,000	YES																																																																																																																					
2186/583	BLALOCK, TERALL	08/04/2011	95,000	YES																																																																																																																					
1687/75	CHUMLEY & ASSOCIATES INC	06/13/2005	97,500	12																																																																																																																					
1660/274	GRECO PROPERTIES INC	03/02/2005	17,500	5																																																																																																																					
Parcel Valuation <table border="1"> <thead> <tr> <th>Source</th> <th>REAL</th> <th>Fair Cash</th> <th>Capped</th> <th>Asmnt Level</th> <th>Assessed</th> <th>Levy Rate</th> <th>92.430</th> <th>Current Tax</th> </tr> </thead> <tbody> <tr> <td>Remove Cap</td> <td>2025</td> <td>Land Value 63,266</td> <td>63,266</td> <td>11%</td> <td>6,959</td> <td>Assessed</td> <td>20,875</td> <td>1,929.48</td> </tr> <tr> <td>Year Frozen</td> <td>0</td> <td>Improvements 126,505</td> <td>126,505</td> <td></td> <td>13,916</td> <td>Penalty</td> <td>0</td> <td></td> </tr> <tr> <td>Uncapped Value</td> <td>0</td> <td>Mobile Home 0</td> <td>0</td> <td></td> <td>0</td> <td>Exemption</td> <td>0</td> <td>0.00</td> </tr> <tr> <td>TIF Project ID</td> <td>0</td> <td>Total Value 189,771</td> <td>189,771</td> <td></td> <td>20,875</td> <td>Total Taxable</td> <td>20,875</td> <td>1,929.00</td> </tr> </tbody> </table>										Source	REAL	Fair Cash	Capped	Asmnt Level	Assessed	Levy Rate	92.430	Current Tax	Remove Cap	2025	Land Value 63,266	63,266	11%	6,959	Assessed	20,875	1,929.48	Year Frozen	0	Improvements 126,505	126,505		13,916	Penalty	0		Uncapped Value	0	Mobile Home 0	0		0	Exemption	0	0.00	TIF Project ID	0	Total Value 189,771	189,771		20,875	Total Taxable	20,875	1,929.00																																																																			
Source	REAL	Fair Cash	Capped	Asmnt Level	Assessed	Levy Rate	92.430	Current Tax																																																																																																																	
Remove Cap	2025	Land Value 63,266	63,266	11%	6,959	Assessed	20,875	1,929.48																																																																																																																	
Year Frozen	0	Improvements 126,505	126,505		13,916	Penalty	0																																																																																																																		
Uncapped Value	0	Mobile Home 0	0		0	Exemption	0	0.00																																																																																																																	
TIF Project ID	0	Total Value 189,771	189,771		20,875	Total Taxable	20,875	1,929.00																																																																																																																	
Assessment History <table border="1"> <thead> <tr> <th>Tax Year</th> <th>Statement Number</th> <th>Billed Owner</th> <th>Tax Area</th> <th>Total Value</th> <th>Exemptions</th> <th>Taxable Value</th> <th>Billed Tax</th> </tr> </thead> <tbody> <tr><td>2025</td><td>2025-660085515</td><td>HAMES, TANA &</td><td>17</td><td>188,000</td><td>0</td><td>20,680</td><td>1,911.00</td></tr> <tr><td>2024</td><td>2024-660085515</td><td>HAMES, TANA &</td><td>17</td><td>167,267</td><td>0</td><td>15,411</td><td>1,424.00</td></tr> <tr><td>2023</td><td>2023-660085515</td><td>ORBECK, JEREMY L &</td><td>17</td><td>142,223</td><td>0</td><td>14,677</td><td>1,344.00</td></tr> <tr><td>2022</td><td>2022-660085515</td><td>ORBECK, JEREMY L &</td><td>17</td><td>134,454</td><td>0</td><td>13,978</td><td>1,294.00</td></tr> <tr><td>2021</td><td>2021-660085515</td><td>ORBECK, JEREMY L &</td><td>17</td><td>122,101</td><td>0</td><td>13,312</td><td>1,175.00</td></tr> <tr><td>2020</td><td>2020-660085515</td><td>ORBECK, JEREMY L &</td><td>17</td><td>115,262</td><td>0</td><td>12,679</td><td>1,161.00</td></tr> <tr><td>2019</td><td>2019-660085515</td><td>ORBECK, JEREMY L &</td><td>17</td><td>110,767</td><td>0</td><td>12,184</td><td>1,128.00</td></tr> <tr><td>2018</td><td>2018-660085515</td><td>ORBECK, JEREMY L &</td><td>17</td><td>113,612</td><td>0</td><td>12,497</td><td>1,155.00</td></tr> <tr><td>2017</td><td>2017-660085515</td><td>ORBECK, JEREMY L &</td><td>17</td><td>112,698</td><td>0</td><td>12,397</td><td>1,139.00</td></tr> <tr><td>2016</td><td>2016-660085515</td><td>ORBECK, JEREMY L &</td><td>17</td><td>109,901</td><td>0</td><td>12,089</td><td>1,135.00</td></tr> <tr><td>2015</td><td>2015-660085515</td><td>ORBECK, JEREMY L &</td><td>17</td><td>107,652</td><td>0</td><td>11,842</td><td>1,068.00</td></tr> <tr><td>2014</td><td>2014-660085515</td><td>SIQUEIRA, DAVI &</td><td>17</td><td>108,494</td><td>0</td><td>11,852</td><td>1,099.00</td></tr> <tr><td>2013</td><td>2013-660085515</td><td>SIQUEIRA, DAVI &</td><td>17</td><td>104,271</td><td>0</td><td>11,288</td><td>1,033.00</td></tr> </tbody> </table>										Tax Year	Statement Number	Billed Owner	Tax Area	Total Value	Exemptions	Taxable Value	Billed Tax	2025	2025-660085515	HAMES, TANA &	17	188,000	0	20,680	1,911.00	2024	2024-660085515	HAMES, TANA &	17	167,267	0	15,411	1,424.00	2023	2023-660085515	ORBECK, JEREMY L &	17	142,223	0	14,677	1,344.00	2022	2022-660085515	ORBECK, JEREMY L &	17	134,454	0	13,978	1,294.00	2021	2021-660085515	ORBECK, JEREMY L &	17	122,101	0	13,312	1,175.00	2020	2020-660085515	ORBECK, JEREMY L &	17	115,262	0	12,679	1,161.00	2019	2019-660085515	ORBECK, JEREMY L &	17	110,767	0	12,184	1,128.00	2018	2018-660085515	ORBECK, JEREMY L &	17	113,612	0	12,497	1,155.00	2017	2017-660085515	ORBECK, JEREMY L &	17	112,698	0	12,397	1,139.00	2016	2016-660085515	ORBECK, JEREMY L &	17	109,901	0	12,089	1,135.00	2015	2015-660085515	ORBECK, JEREMY L &	17	107,652	0	11,842	1,068.00	2014	2014-660085515	SIQUEIRA, DAVI &	17	108,494	0	11,852	1,099.00	2013	2013-660085515	SIQUEIRA, DAVI &	17	104,271	0	11,288	1,033.00
Tax Year	Statement Number	Billed Owner	Tax Area	Total Value	Exemptions	Taxable Value	Billed Tax																																																																																																																		
2025	2025-660085515	HAMES, TANA &	17	188,000	0	20,680	1,911.00																																																																																																																		
2024	2024-660085515	HAMES, TANA &	17	167,267	0	15,411	1,424.00																																																																																																																		
2023	2023-660085515	ORBECK, JEREMY L &	17	142,223	0	14,677	1,344.00																																																																																																																		
2022	2022-660085515	ORBECK, JEREMY L &	17	134,454	0	13,978	1,294.00																																																																																																																		
2021	2021-660085515	ORBECK, JEREMY L &	17	122,101	0	13,312	1,175.00																																																																																																																		
2020	2020-660085515	ORBECK, JEREMY L &	17	115,262	0	12,679	1,161.00																																																																																																																		
2019	2019-660085515	ORBECK, JEREMY L &	17	110,767	0	12,184	1,128.00																																																																																																																		
2018	2018-660085515	ORBECK, JEREMY L &	17	113,612	0	12,497	1,155.00																																																																																																																		
2017	2017-660085515	ORBECK, JEREMY L &	17	112,698	0	12,397	1,139.00																																																																																																																		
2016	2016-660085515	ORBECK, JEREMY L &	17	109,901	0	12,089	1,135.00																																																																																																																		
2015	2015-660085515	ORBECK, JEREMY L &	17	107,652	0	11,842	1,068.00																																																																																																																		
2014	2014-660085515	SIQUEIRA, DAVI &	17	108,494	0	11,852	1,099.00																																																																																																																		
2013	2013-660085515	SIQUEIRA, DAVI &	17	104,271	0	11,288	1,033.00																																																																																																																		



Rogers

Assessment Property Record Card for Tax Year 2026

Data provided by LISA DELOZIER County Assessor

Date 04/18/2026
Time 07:23:49
Page 2

Lot Data		Square-Foot - NBHD 1183 #1	
Lot Size			
Lot Count	1		
Units Buildable	1		
Non-Ag Acres	0.1794		
Topography			
Street Access			
Utilities			
Amenities	LOT SIZE ADJUSTMENT	0	0
Method	Square-Foot		
Base Lot Value	7,814.00 x 5.00 = 39,070		
Factor Value			
Adjustments	1.6193		
Lot Value	63,266		



\\tsclient\T\LOGAN\LOGAN RESIDENTIAL VI\2023-4-11\IMG_006: 4/11/2023

Residential Data	
Type	1 Single Family Residence
Condition	3 - Average
Quality	2.5 - Fair
Architecture	R3 Res Nbhd 3
Style	100% One Story
Exterior Wall	5% Veneer, Masonry 95% Frame, Siding, Vinyl
Base/Total Area	1,120 / 1,120
Style	100% One Story
HVAC	100% Warmed & Cooled Air
Roof Cover	1 Composition Shingle
Area on Slab	1,120
Fixture/RghIn	11 /
Bed/F/H Bath	3 / 2.0 /
Basement Area	
Garage Type	400 Attached Garage - Unfinished
Remodel	
Year/Eff Age	2005 / 16

GRM Approach	
GRM Code	
Gross Rent	0.00
Indicated Value	

Multiple Regression			
MRA Code	1	Test	
Adusted R	0.8445		
Indicated Value	159,515	142.42	Per SqFt

Direct Comparables			
Selection Model	A	Adam Test	
Adjustment Model	1	2022 Residential	
Comparables	3		
Indicated Value	130,700		Per SqFt

Cost Approach				Manual : 01/2025			
Base Cost	100.38	Total Misc Impr	+	1,276			
Roofing Adj	+ 4.64	Garage Cost	+	11,700			
Subfloor Adj	+ -1.20	Total RCN	=	156,179			
Heat/Cool Adj	+ 11.47	Depreciation (19%)	-	29,674			
Plumbing Adj	+ 12.57	Lump Sums	+	0			
Basement Adj	+ 0.00	RCNLD	=	126,505			
Adj Base Cost	= 127.86	Lot Value	+	63,266			
Total Area	x 1,120	Indicated Value	=	189,771			
Adjusted Cost	= 143,203	Value Per SqFt		169.44			

Value Reconciliation			
Selected Approach	Cost Approach		
Improvements	126,505		
Lot Value	63,266		
Indicated Value	189,771	169.44	Per SqFt
Agland Value			
Site Improvements			
Total Value	189,771	169.44	Total Value Per SqFt

Miscellaneous Improvements								
Code	Description	Sketch ID	Size	Year	Units	Unit Cost	Depr	Value
PATO	SLAB PORCH - OPEN	104423	8x8		64	10.86		695
PRCH	SLAB PORCH - COVERED	104424	6x4		24	24.19		581



Rogers
Assessment Property Record Card for Tax Year 2026

Data provided by LISA DELOZIER County Assessor

Date 04/18/2026
 Time 07:23:49
 Page 3

Sketch Image

660085515

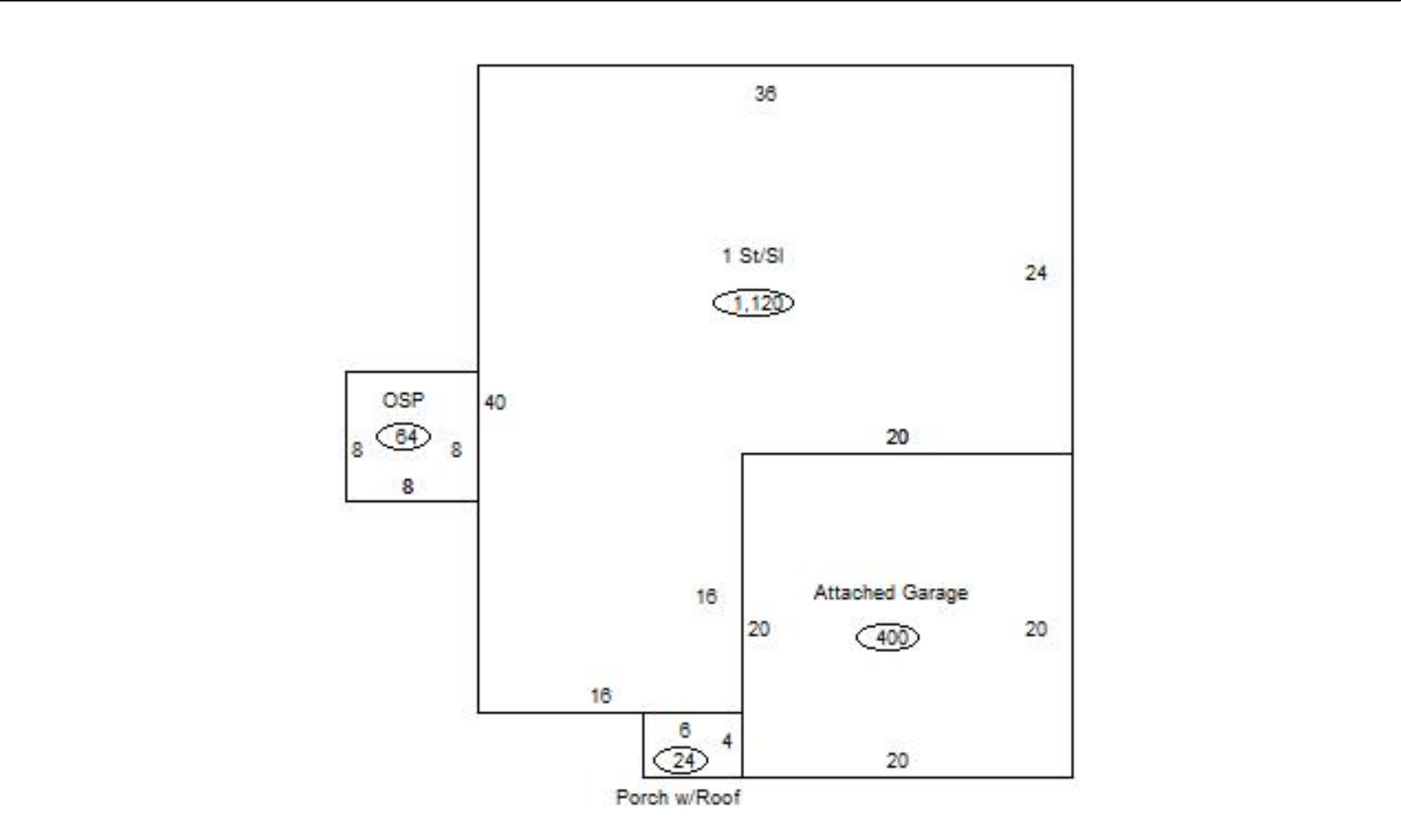

Sketch Vector Information

Sequence	Code	Type	Built Over	Scale	Section Label	Base Area	Multiplier	Total Area
1	R	1	Slab	13	1 St/Sl	1,120	1.000	1,120
2	G	1		13	Attached Garage	400	1.000	400
3	M	PATO		13	Open Slab	64	1.000	64
4	M	PRCH		13	SLBC	24	1.000	24
Total Building Area						1,120		1,120