



Rogers

Assessment Property Record Card for Tax Year 2026

Data provided by LISA DELOZIER County Assessor

Date 04/18/2026
Time 07:12:59
Page 1

| Assessment Data | | | | Primary Image | | | | | | |
|------------------------------------|----------------------------|----------------------|-----------|---|----------------|------------------------------|---------------|---------------|-------------|--|
| Account | 660085658 | | | | | | | | | |
| Parcel ID | 000000-00-0-21637-004-0012 | | | | | | | | | |
| Cadastral ID | 22-21-14-08570 | | | | | | | | | |
| Property Type | REAL - Real Property | | | | | | | | | |
| Property Class | URP | VI Area | 4 | | | | | | | |
| Tax Area | 40 - OWASSO CITY | | | | | | | | | |
| Name ID | 305034 | | | | | | | | | |
| TURNBOUGH, TYLER K & | | | | | | | | | | |
| ANGELA K | | | | | | | | | | |
| 9003 N 156TH E PL | | | | | | | | | | |
| OWASSO OK 74055-0000 | | | | | | | | | | |
| Parcel Location | | | | \\tsclient\TCASEY\CASEY BOOTH RESIDENTIAL VI\2022-8-25\ 8/29/2022 | | | | | | |
| Situs | 09003 156TH E PL | | | | | | | | | |
| Subdivision | PRESTON LAKES III | | | | | | | | | |
| Lot/Block | 0012 / 0004 | Parcel Size | 1 - Lots | | | | | | | |
| Sec/Twn/Rng | 22 / 21 / 14 / 5 | | | | | | | | | |
| Neighborhood | 1059 - R-V04-SW OWASSO | | | | | | | | | |
| School District | S021 - OWASSO SCHOOLS | | | | | | | | | |
| Legal Description | | | | Building Permits | | | | | | |
| Lot/Long: 36.28508623 -95.80023922 | | | | Number | Description | Opened | Closed | Amount | | |
| LOT 12 BLOCK 4 PRESTON LAKES III | | | | 05-0639-X | R6 FOR NEW SFR | 06/2005 | 11/2005 | 95,340 | | |
| Exemptions | | | | Sale History | | | | | | |
| Code | Type | Active | Maximum | Exemption | Bk/Pg | Grantor | Date | Price | Code | |
| | | | | | 2178/144 | LOGAN, JEARL L & | 06/17/2011 | 187,000 | YES | |
| | | | | | 1721/60 | CAPITAL HOMES RES GROUP-LLC | 10/07/2005 | 172,000 | YES | |
| | | | | | 1666/760 | PRESTON LAKES DEVLEOPMENT-GR | 03/30/2005 | 440,000 | 11 | |
| Parcel Valuation | | | | | | | | | | |
| Source | REAL | | Fair Cash | Capped | Asmnt Level | Assessed | Levy Rate | 97.960 | Current Tax | |
| Remove Cap | 0 | Land Value | 48,739 | 43,274 | 11% | 4,760 | Assessed | 32,051 | 3,139.72 | |
| Year Frozen | 0 | Improvements | 255,398 | 248,096 | | 27,291 | Penalty | 0 | | |
| Uncapped Value | 0 | Mobile Home | 0 | 0 | | 0 | Exemption | 0 | 0.00 | |
| TIF Project ID | 0 | Total Value | 304,137 | 291,370 | | 32,051 | Total Taxable | 32,051 | 3,140.00 | |
| Assessment History | | | | | | | | | | |
| Tax Year | Statement Number | Billed Owner | | | Tax Area | Total Value | Exemptions | Taxable Value | Billed Tax | |
| 2025 | 2025-660085658 | TURNBOUGH, TYLER K & | | | 40 | 300,430 | 0 | 30,524 | 2,990.00 | |
| 2024 | 2024-660085658 | TURNBOUGH, TYLER K & | | | 40 | 319,276 | 0 | 29,072 | 2,793.00 | |
| 2023 | 2023-660085658 | TURNBOUGH, TYLER K & | | | 40 | 284,010 | 0 | 27,686 | 2,594.00 | |
| 2022 | 2022-660085658 | TURNBOUGH, TYLER K & | | | 40 | 254,607 | 0 | 26,368 | 2,583.00 | |
| 2021 | 2021-660085658 | TURNBOUGH, TYLER K & | | | 40 | 228,299 | 0 | 25,113 | 2,429.00 | |
| 2020 | 2020-660085658 | TURNBOUGH, TYLER K & | | | 40 | 221,545 | 0 | 24,370 | 2,357.00 | |
| 2019 | 2019-660085658 | TURNBOUGH, TYLER K & | | | 40 | 212,154 | 0 | 23,337 | 2,260.00 | |
| 2018 | 2018-660085658 | TURNBOUGH, TYLER K & | | | 40 | 217,966 | 0 | 23,976 | 2,236.00 | |
| 2017 | 2017-660085658 | TURNBOUGH, TYLER K & | | | 40 | 216,139 | 0 | 23,775 | 2,237.00 | |
| 2016 | 2016-660085658 | TURNBOUGH, TYLER K & | | | 40 | 210,470 | 0 | 23,152 | 2,188.00 | |
| 2015 | 2015-660085658 | TURNBOUGH, TYLER K & | | | 40 | 203,694 | 0 | 22,406 | 2,136.00 | |
| 2014 | 2014-660085658 | TURNBOUGH, TYLER K & | | | 40 | 205,439 | 0 | 22,598 | 2,177.00 | |
| 2013 | 2013-660085658 | TURNBOUGH, TYLER K & | | | 40 | 197,728 | 0 | 21,750 | 2,050.00 | |



Rogers

Assessment Property Record Card for Tax Year 2026

Data provided by LISA DELOZIER County Assessor

Date 04/18/2026
 Time 07:13:00
 Page 2

| Lot Data | Square-Foot - NBHD 1059 #1 | Primary Image |
|-----------------|----------------------------|---------------|
| Lot Size | | |
| Lot Count | 1 | |
| Units Buildable | 1 | |
| Non-Ag Acres | 0.2111 | |
| Topography | | |
| Street Access | | |
| Utilities | | |
| Amenities | 0 | |
| | 0 | |
| Method | Square-Foot | |
| Base Lot Value | 9,196.00 x 5.30 = 48,739 | |
| Factor Value | | |
| Adjustments | 1.0000 | |
| Lot Value | 48,739 | |

| Residential Data | |
|------------------|----------------------------------|
| Type | 1 Single Family Residence |
| Condition | 3 - Average |
| Quality | 3.5 - Average |
| Architecture | |
| Style | 100% 1 1/2 Story Finished |
| Exterior Wall | 100% Veneer, Masonry |
| Base/Total Area | 1,872 / 2,130 |
| Style | 100% 1 1/2 Story Finished |
| HVAC | 100% Warmed & Cooled Air |
| Roof Cover | 1 Composition Shingle |
| Area on Slab | 1,872 |
| Fixture/RghIn | 14 / |
| Bed/F/H Bath | 3 / 2.5 / |
| Basement Area | |
| Garage Type | 441 Attached Garage - Unfinished |
| Remodel | |
| Year/Eff Age | 2005 / 16 |



\\tsclient\TCASEY\CASEY BOOTH RESIDENTIAL VI\2022-8-25\ 8/29/2022

| GRM Approach | |
|-----------------|------|
| GRM Code | |
| Gross Rent | 0.00 |
| Indicated Value | |

| Multiple Regression | | | |
|---------------------|---------|--------|----------|
| MRA Code | 1 | Test | |
| Adjusted R | 0.8445 | | |
| Indicated Value | 277,406 | 130.24 | Per SqFt |

| Direct Comparables | | | |
|--------------------|---------|------------------|----------|
| Selection Model | A | Adam Test | |
| Adjustment Model | 1 | 2022 Residential | |
| Comparables | 8 | | |
| Indicated Value | 316,030 | | Per SqFt |

| Value Reconciliation | | | |
|----------------------|---------------|--------|----------------------|
| Selected Approach | Cost Approach | | |
| Improvements | 255,398 | | |
| Lot Value | 48,739 | | |
| Indicated Value | 304,137 | 142.79 | Per SqFt |
| Agland Value | | | |
| Site Improvements | | | |
| Total Value | 304,137 | 142.79 | Total Value Per SqFt |

| Cost Approach | | | | Manual : 01/2025 | | | |
|---------------|-----------|---------------------|-----------|------------------|--|--|--|
| Base Cost | 103.86 | Total Misc Impr | + 11,482 | | | | |
| Roofing Adj | + 4.80 | Garage Cost | + 18,134 | | | | |
| Subfloor Adj | + -3.06 | Total RCN | = 307,709 | | | | |
| Heat/Cool Adj | + 14.47 | Depreciation (17%) | - 52,311 | | | | |
| Plumbing Adj | + 10.49 | Lump Sums | + 0 | | | | |
| Basement Adj | + 0.00 | RCNLD | = 255,398 | | | | |
| Adj Base Cost | = 130.56 | Lot Value | + 48,739 | | | | |
| Total Area | x 2,130 | Indicated Value | = 304,137 | | | | |
| Adjusted Cost | = 278,093 | Value Per SqFt | 142.79 | | | | |

| Miscellaneous Improvements | | | | | | | | |
|----------------------------|---------------------------------|-----------|------|------|-------|-----------|------|-------|
| Code | Description | Sketch ID | Size | Year | Units | Unit Cost | Depr | Value |
| FPR1 | FIREPLACE - RESIDENTIAL 1 STORY | 0 | | 1 | 1 | 6,429.63 | | 6,430 |
| PRCH | SLAB PORCH - COVERED | 104960 | 20x6 | | 120 | 29.13 | | 3,496 |
| PRCH | SLAB PORCH - COVERED | 104961 | 53 | | 53 | 29.36 | | 1,556 |



Rogers

Assessment Property Record Card for Tax Year 2026

Data provided by LISA DELOZIER County Assessor

Date 04/18/2026
 Time 07:13:00
 Page 3

Sketch Image

660085658

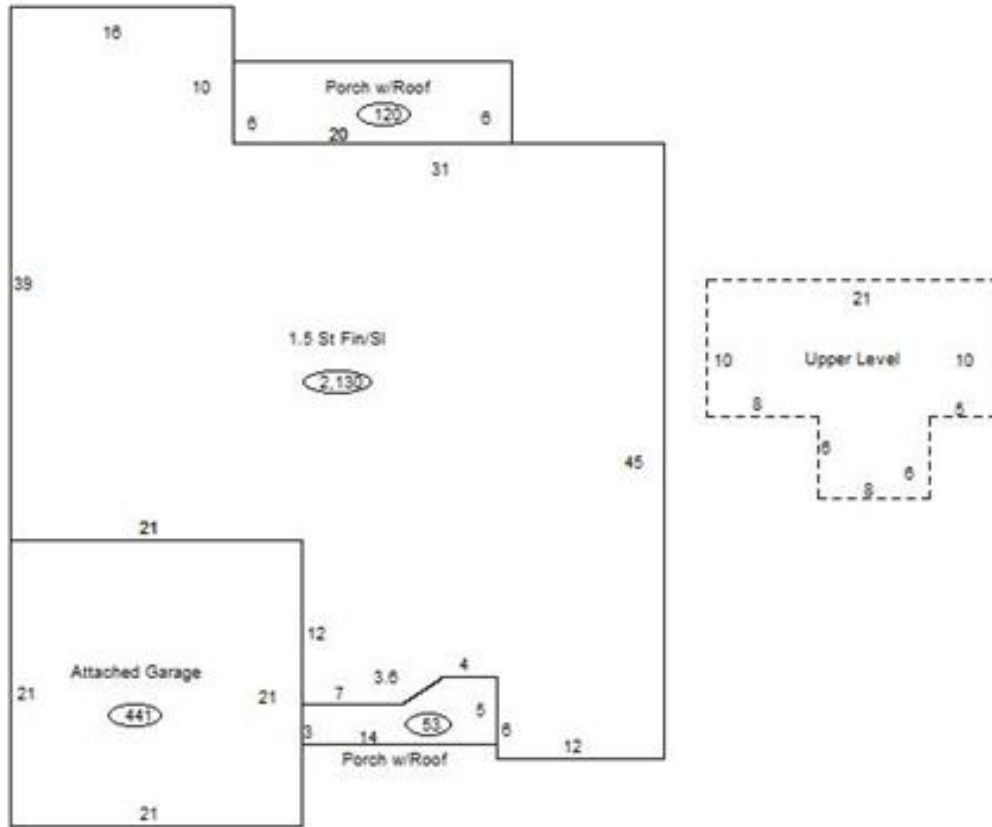

Sketch Vector Information

| Sequence | Code | Type | Built Over | Scale | Section Label | Base Area | Multiplier | Total Area |
|----------------------------|------|------|------------|-------|-----------------|-----------|------------|------------|
| 1 | R | 5 | Slab | 13 | 1.5 St Fin/SI | 1,872 | 1.138 | 2,130 |
| 2 | U | ^UL | Overhang | 13 | Upper Level | 258 | 1.000 | 258 |
| 3 | G | 1 | | 13 | Attached Garage | 441 | 1.000 | 441 |
| 4 | M | PRCH | | 13 | SLBC | 120 | 1.000 | 120 |
| 5 | M | PRCH | | 13 | SLBC | 53 | 1.000 | 53 |
| Total Building Area | | | | | | 1,872 | | 2,130 |