



Rogers

Assessment Property Record Card for Tax Year 2026

Data provided by LISA DELOZIER County Assessor

Date 04/18/2026
Time 07:34:08
Page 1

Assessment Data					Primary Image																																																																																																																				
Account 660087492 Parcel ID 000000-00-0-00814-001-0003 Cadastral ID 01-21-15-03913 Property Type REAL - Real Property Property Class URP VI Area 4 Tax Area 17 - CLAREMORE OT Name ID 303530 CLARKE, MICHAEL THOMAS & KATHLEEN ANNE REVOCABLE TRUST 3204 COVEY TRL CIR CLAREMORE OK 74019-0242																																																																																																																									
Parcel Location Situs 03204 COVEY TRL CIR Subdivision MEADOWS AT HERITAGE II Lot/Block 0003 / 0001 Parcel Size 1 - Lots Sec/Twn/Rng 1 / 21 / 15 / 5 Neighborhood 1168 - R-V01,4-SW CLAREMORE School District S001 - CLAREMORE SCHOOLS																																																																																																																									
Legal Description Lat/Long: 36.32374885 -95.65444031					Building Permits <table border="1"> <thead> <tr> <th>Number</th> <th>Description</th> <th>Opened</th> <th>Closed</th> <th>Amount</th> </tr> </thead> <tbody> <tr> <td>4106</td> <td>R12-NEW SFR 2765 SQ FT</td> <td>10/2010</td> <td>05/2011</td> <td></td> </tr> </tbody> </table>					Number	Description	Opened	Closed	Amount	4106	R12-NEW SFR 2765 SQ FT	10/2010	05/2011																																																																																																							
Number	Description	Opened	Closed	Amount																																																																																																																					
4106	R12-NEW SFR 2765 SQ FT	10/2010	05/2011																																																																																																																						
MEADOWS AT HERITAGE HILLS II W2 LOT 2 & LOT 3 BLOCK 1					Sale History <table border="1"> <thead> <tr> <th>Bk/Pg</th> <th>Grantor</th> <th>Date</th> <th>Price</th> <th>Code</th> </tr> </thead> <tbody> <tr> <td>2702/649</td> <td>CLARKE, MICHAEL THOMAS &</td> <td>04/05/2018</td> <td>0</td> <td>4</td> </tr> <tr> <td>2124/705</td> <td>THE MEADOWS AT HERITAGE-HILLS,</td> <td>09/02/2010</td> <td>50,000</td> <td>YES</td> </tr> </tbody> </table>					Bk/Pg	Grantor	Date	Price	Code	2702/649	CLARKE, MICHAEL THOMAS &	04/05/2018	0	4	2124/705	THE MEADOWS AT HERITAGE-HILLS,	09/02/2010	50,000	YES																																																																																																	
Bk/Pg	Grantor	Date	Price	Code																																																																																																																					
2702/649	CLARKE, MICHAEL THOMAS &	04/05/2018	0	4																																																																																																																					
2124/705	THE MEADOWS AT HERITAGE-HILLS,	09/02/2010	50,000	YES																																																																																																																					
Exemptions <table border="1"> <thead> <tr> <th>Code</th> <th>Type</th> <th>Active</th> <th>Maximum</th> <th>Exemption</th> </tr> </thead> <tbody> <tr> <td>HV</td> <td>Veteran</td> <td>Yes</td> <td>999,999</td> <td>44,178</td> </tr> </tbody> </table>					Code	Type	Active	Maximum	Exemption	HV	Veteran	Yes	999,999	44,178																																																																																																											
Code	Type	Active	Maximum	Exemption																																																																																																																					
HV	Veteran	Yes	999,999	44,178																																																																																																																					
Parcel Valuation <table border="1"> <thead> <tr> <th>Source</th> <th>REAL</th> <th>Fair Cash</th> <th>Capped</th> <th>Asmnt Level</th> <th>Assessed</th> <th>Levy Rate</th> <th>92.430</th> <th>Current Tax</th> </tr> </thead> <tbody> <tr> <td>Remove Cap</td> <td>2011</td> <td>Land Value 18,860</td> <td>18,860</td> <td>11%</td> <td>2,075</td> <td>Assessed</td> <td>44,178</td> <td>4,083.37</td> </tr> <tr> <td>Year Frozen</td> <td>0</td> <td>Improvements 386,126</td> <td>382,753</td> <td></td> <td>42,103</td> <td>Penalty</td> <td>0</td> <td></td> </tr> <tr> <td>Uncapped Value</td> <td>0</td> <td>Mobile Home 0</td> <td>0</td> <td></td> <td>0</td> <td>Exemption</td> <td>44,178</td> <td>-4,083.00</td> </tr> <tr> <td>TIF Project ID</td> <td>0</td> <td>Total Value 404,986</td> <td>401,613</td> <td></td> <td>44,178</td> <td>Total Taxable</td> <td>0</td> <td>0.00</td> </tr> </tbody> </table>										Source	REAL	Fair Cash	Capped	Asmnt Level	Assessed	Levy Rate	92.430	Current Tax	Remove Cap	2011	Land Value 18,860	18,860	11%	2,075	Assessed	44,178	4,083.37	Year Frozen	0	Improvements 386,126	382,753		42,103	Penalty	0		Uncapped Value	0	Mobile Home 0	0		0	Exemption	44,178	-4,083.00	TIF Project ID	0	Total Value 404,986	401,613		44,178	Total Taxable	0	0.00																																																																			
Source	REAL	Fair Cash	Capped	Asmnt Level	Assessed	Levy Rate	92.430	Current Tax																																																																																																																	
Remove Cap	2011	Land Value 18,860	18,860	11%	2,075	Assessed	44,178	4,083.37																																																																																																																	
Year Frozen	0	Improvements 386,126	382,753		42,103	Penalty	0																																																																																																																		
Uncapped Value	0	Mobile Home 0	0		0	Exemption	44,178	-4,083.00																																																																																																																	
TIF Project ID	0	Total Value 404,986	401,613		44,178	Total Taxable	0	0.00																																																																																																																	
Assessment History <table border="1"> <thead> <tr> <th>Tax Year</th> <th>Statement Number</th> <th>Billed Owner</th> <th>Tax Area</th> <th>Total Value</th> <th>Exemptions</th> <th>Taxable Value</th> <th>Billed Tax</th> </tr> </thead> <tbody> <tr><td>2025</td><td>2025-660087492</td><td>CLARKE, MICHAEL THOMAS &</td><td>17</td><td>389,916</td><td>42891</td><td></td><td>.00</td></tr> <tr><td>2024</td><td>2024-660087492</td><td>CLARKE, MICHAEL THOMAS &</td><td>17</td><td>407,218</td><td>44242</td><td></td><td>.00</td></tr> <tr><td>2023</td><td>2023-660087492</td><td>CLARKE, MICHAEL THOMAS &</td><td>17</td><td>426,733</td><td>42953</td><td></td><td>.00</td></tr> <tr><td>2022</td><td>2022-660087492</td><td>CLARKE, MICHAEL THOMAS &</td><td>17</td><td>426,424</td><td>41702</td><td></td><td>.00</td></tr> <tr><td>2021</td><td>2021-660087492</td><td>CLARKE, MICHAEL THOMAS &</td><td>17</td><td>368,064</td><td>40487</td><td></td><td>.00</td></tr> <tr><td>2020</td><td>2020-660087492</td><td>CLARKE, MICHAEL THOMAS &</td><td>17</td><td>362,111</td><td>39359</td><td></td><td>.00</td></tr> <tr><td>2019</td><td>2019-660087492</td><td>CLARKE, MICHAEL THOMAS &</td><td>17</td><td>347,390</td><td>38213</td><td></td><td>.00</td></tr> <tr><td>2018</td><td>2018-660087492</td><td>CLARKE, MICHAEL THOMAS &</td><td>17</td><td>353,245</td><td>38186</td><td></td><td>.00</td></tr> <tr><td>2017</td><td>2017-660087492</td><td>CLARKE, MICHAEL THOMAS &</td><td>17</td><td>350,349</td><td>37074</td><td></td><td>.00</td></tr> <tr><td>2016</td><td>2016-660087492</td><td>CLARKE, MICHAEL THOMAS &</td><td>17</td><td>341,407</td><td>35994</td><td></td><td>.00</td></tr> <tr><td>2015</td><td>2015-660087492</td><td>CLARKE, MICHAEL THOMAS &</td><td>17</td><td>331,254</td><td>34946</td><td></td><td>.00</td></tr> <tr><td>2014</td><td>2014-660087492</td><td>CLARKE, MICHAEL THOMAS &</td><td>17</td><td>333,008</td><td>33928</td><td></td><td>.00</td></tr> <tr><td>2013</td><td>2013-660087492</td><td>CLARKE, MICHAEL THOMAS &</td><td>17</td><td>313,089</td><td>32940</td><td></td><td>.00</td></tr> </tbody> </table>										Tax Year	Statement Number	Billed Owner	Tax Area	Total Value	Exemptions	Taxable Value	Billed Tax	2025	2025-660087492	CLARKE, MICHAEL THOMAS &	17	389,916	42891		.00	2024	2024-660087492	CLARKE, MICHAEL THOMAS &	17	407,218	44242		.00	2023	2023-660087492	CLARKE, MICHAEL THOMAS &	17	426,733	42953		.00	2022	2022-660087492	CLARKE, MICHAEL THOMAS &	17	426,424	41702		.00	2021	2021-660087492	CLARKE, MICHAEL THOMAS &	17	368,064	40487		.00	2020	2020-660087492	CLARKE, MICHAEL THOMAS &	17	362,111	39359		.00	2019	2019-660087492	CLARKE, MICHAEL THOMAS &	17	347,390	38213		.00	2018	2018-660087492	CLARKE, MICHAEL THOMAS &	17	353,245	38186		.00	2017	2017-660087492	CLARKE, MICHAEL THOMAS &	17	350,349	37074		.00	2016	2016-660087492	CLARKE, MICHAEL THOMAS &	17	341,407	35994		.00	2015	2015-660087492	CLARKE, MICHAEL THOMAS &	17	331,254	34946		.00	2014	2014-660087492	CLARKE, MICHAEL THOMAS &	17	333,008	33928		.00	2013	2013-660087492	CLARKE, MICHAEL THOMAS &	17	313,089	32940		.00
Tax Year	Statement Number	Billed Owner	Tax Area	Total Value	Exemptions	Taxable Value	Billed Tax																																																																																																																		
2025	2025-660087492	CLARKE, MICHAEL THOMAS &	17	389,916	42891		.00																																																																																																																		
2024	2024-660087492	CLARKE, MICHAEL THOMAS &	17	407,218	44242		.00																																																																																																																		
2023	2023-660087492	CLARKE, MICHAEL THOMAS &	17	426,733	42953		.00																																																																																																																		
2022	2022-660087492	CLARKE, MICHAEL THOMAS &	17	426,424	41702		.00																																																																																																																		
2021	2021-660087492	CLARKE, MICHAEL THOMAS &	17	368,064	40487		.00																																																																																																																		
2020	2020-660087492	CLARKE, MICHAEL THOMAS &	17	362,111	39359		.00																																																																																																																		
2019	2019-660087492	CLARKE, MICHAEL THOMAS &	17	347,390	38213		.00																																																																																																																		
2018	2018-660087492	CLARKE, MICHAEL THOMAS &	17	353,245	38186		.00																																																																																																																		
2017	2017-660087492	CLARKE, MICHAEL THOMAS &	17	350,349	37074		.00																																																																																																																		
2016	2016-660087492	CLARKE, MICHAEL THOMAS &	17	341,407	35994		.00																																																																																																																		
2015	2015-660087492	CLARKE, MICHAEL THOMAS &	17	331,254	34946		.00																																																																																																																		
2014	2014-660087492	CLARKE, MICHAEL THOMAS &	17	333,008	33928		.00																																																																																																																		
2013	2013-660087492	CLARKE, MICHAEL THOMAS &	17	313,089	32940		.00																																																																																																																		



Rogers

Assessment Property Record Card for Tax Year 2026

Data provided by LISA DELOZIER County Assessor

Date 04/18/2026
Time 07:34:08
Page 2

Lot Data	Square-Foot - NBHD 1168 #1	Primary Image
Lot Size	75 x 120	
Lot Count	1	
Units Buildable	1.5	
Non-Ag Acres	0.1064	
Topography	LEVEL	
Street Access	PAVED	
Utilities	ALL	
Amenities	0	
	0	
Method	Square-Foot	
Base Lot Value	4,634.00 x 4.07 = 18,860	
Factor Value		
Adjustments	1.0000	
Lot Value	18,860	

Residential Data	
Type	1 Single Family Residence
Condition	3 - Average
Quality	4 - Good
Architecture	
Style	100% 1 1/2 Story Finished
Exterior Wall	100% Veneer, Masonry
Base/Total Area	2,386 / 2,761
Style	100% 1 1/2 Story Finished
HVAC	100% Warmed & Cooled Air
Roof Cover	1 Composition Shingle
Area on Slab	2,386
Fixture/RghIn	14 /
Bed/F/H Bath	4 / 3.0 /
Basement Area	
Garage Type	1,200 Attached Garage - Unfinished
Remodel	
Year/Eff Age	2011 / 11

\\tsclient\T\TOMMY DUNLAP\New folder (23)\IMG_0041.JPG 3/16/2022

GRM Approach	
GRM Code	
Gross Rent	0.00
Indicated Value	

Multiple Regression			
MRA Code	1	Test	
Adusted R	0.8445		
Indicated Value	442,444	160.25	Per SqFt

Direct Comparables			
Selection Model	A	Adam Test	
Adjustment Model	1	2022 Residential	
Comparables	2		
Indicated Value	458,210		Per SqFt

Value Reconciliation			
Selected Approach	Cost Approach		
Improvements	386,126		
Lot Value	18,860		
Indicated Value	404,986	146.68	Per SqFt
Agland Value			
Site Improvements			
Total Value	404,986	146.68	Total Value Per SqFt

Cost Approach				Manual : 01/2025			
Base Cost	103.79	Total Misc Impr	+	19,615			
Roofing Adj	+ 5.06	Garage Cost	+	54,504			
Subfloor Adj	+ -3.99	Total RCN	=	433,850			
Heat/Cool Adj	+ 16.31	Depreciation (11%)	-	47,724			
Plumbing Adj	+ 9.12	Lump Sums	+	0			
Basement Adj	+ 0.00	RCNLD	=	386,126			
Adj Base Cost	= 130.29	Lot Value	+	18,860			
Total Area	x 2,761	Indicated Value	=	404,986			
Adjusted Cost	= 359,731	Value Per SqFt		146.68			

Miscellaneous Improvements								
Code	Description	Sketch ID	Size	Year	Units	Unit Cost	Depr	Value
FPR1	FIREPLACE - RESIDENTIAL 1 STORY	0		1	1	7,243.87		7,244
PRCH	SLAB PORCH - COVERED	107334	18x5		90	32.91		2,962
PRCH	SLAB PORCH - COVERED	107335	40x6		240	32.13		7,711
PATO	SLAB PORCH - OPEN	107337	20x6		120	14.15		1,698



Rogers

Assessment Property Record Card for Tax Year 2026

Data provided by LISA DELOZIER County Assessor

Date 04/18/2026

Time 07:34:08

Page 3

Sketch Image

660087492

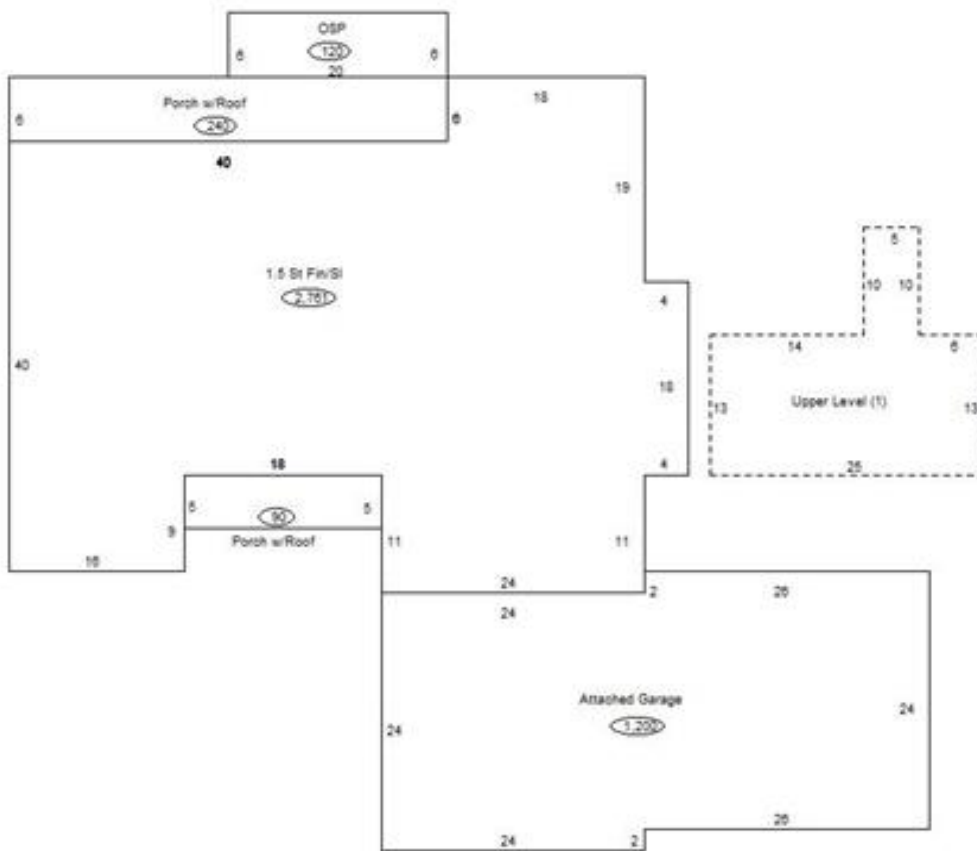

Sketch Vector Information

Sequence	Code	Type	Built Over	Scale	Section Label	Base Area	Multiplier	Total Area
1	R	5	Slab	13	1.5 St Fin/Sl	2,386	1.157	2,761
2	M	PRCH		13	SLBC	90	1.000	90
3	M	PRCH		13	SLBC	240	1.000	240
4	G	1		13	Attached Garage	1,200	1.000	1,200
5	M	PATO		13	Open Slab	120	1.000	120
6	U	^UL		13	Upper Level (1)	375	1.000	375
Total Building Area						2,386		2,761