



Rogers

Assessment Property Record Card for Tax Year 2026

Data provided by LISA DELOZIER County Assessor

Date 04/17/2026
 Time 17:43:27
 Page 1

Assessment Data					Primary Image																																																																																																																				
Account 660087797 Parcel ID 24N18E-34-4-00000-000-0000 Cadastral ID 34-24-18-00520 Property Type REAL - Real Property Property Class RA VI Area 2 Tax Area 14 - CHELSEA RURAL Name ID 300507 FIELDER, MICHAEL DEAN & CATHY J 6150 S 4290 RD CHELSEA OK 74016-0000 Parcel Location Situs 06150 S 4290 RD Subdivision Lot/Block / Parcel Size 10 - Acres Sec/Twn/Rng 34 / 24 / 18 / 4 Neighborhood 4050 - CHELSEA FOYIL RURAL School District S003 - CHELSEA SCHOOLS																																																																																																																									
Legal Description Lat/Long: 36.52003636 -95.36632166 COMM AT NW/C N/2 SE/4 NE/4; TH S 206.2' TO POB; TH S 330'; TH E 1320'; TH N 330'; TH W 1320' TO POB.																																																																																																																									
Exemptions <table border="1"> <thead> <tr> <th>Code</th> <th>Type</th> <th>Active</th> <th>Maximum</th> <th>Exemption</th> </tr> </thead> <tbody> <tr> <td>H</td> <td>Homestead</td> <td>Yes</td> <td>1,000</td> <td>1,000</td> </tr> </tbody> </table>					Code	Type	Active	Maximum	Exemption	H	Homestead	Yes	1,000	1,000	Building Permits <table border="1"> <thead> <tr> <th>Number</th> <th>Description</th> <th>Opened</th> <th>Closed</th> <th>Amount</th> </tr> </thead> <tbody> <tr> <td>R7</td> <td>SPLIT - CHECK FOR IMPROV.</td> <td>03/2006</td> <td>11/2006</td> <td></td> </tr> </tbody> </table>					Number	Description	Opened	Closed	Amount	R7	SPLIT - CHECK FOR IMPROV.	03/2006	11/2006																																																																																													
Code	Type	Active	Maximum	Exemption																																																																																																																					
H	Homestead	Yes	1,000	1,000																																																																																																																					
Number	Description	Opened	Closed	Amount																																																																																																																					
R7	SPLIT - CHECK FOR IMPROV.	03/2006	11/2006																																																																																																																						
Parcel Valuation <table border="1"> <thead> <tr> <th>Source</th> <th>REAL</th> <th>Fair Cash</th> <th>Capped</th> <th>Asmnt Level</th> <th>Assessed</th> <th>Levy Rate</th> <th>82.750</th> <th>Current Tax</th> </tr> </thead> <tbody> <tr> <td>Remove Cap</td> <td>0</td> <td>Land Value 528</td> <td>528</td> <td>11%</td> <td>58</td> <td>Assessed</td> <td>15,380</td> <td>1,272.70</td> </tr> <tr> <td>Year Frozen</td> <td>0</td> <td>Improvements 179,233</td> <td>139,290</td> <td></td> <td>15,322</td> <td>Penalty</td> <td>0</td> <td></td> </tr> <tr> <td>Uncapped Value</td> <td>0</td> <td>Mobile Home 0</td> <td>0</td> <td></td> <td>0</td> <td>Exemption</td> <td>1,000</td> <td>-83.00</td> </tr> <tr> <td>TIF Project ID</td> <td>0</td> <td>Total Value 179,761</td> <td>139,818</td> <td></td> <td>15,380</td> <td>Total Taxable</td> <td>14,380</td> <td>1,190.00</td> </tr> </tbody> </table>					Source	REAL	Fair Cash	Capped	Asmnt Level	Assessed	Levy Rate	82.750	Current Tax	Remove Cap	0	Land Value 528	528	11%	58	Assessed	15,380	1,272.70	Year Frozen	0	Improvements 179,233	139,290		15,322	Penalty	0		Uncapped Value	0	Mobile Home 0	0		0	Exemption	1,000	-83.00	TIF Project ID	0	Total Value 179,761	139,818		15,380	Total Taxable	14,380	1,190.00	Sale History <table border="1"> <thead> <tr> <th>Bk/Pg</th> <th>Grantor</th> <th>Date</th> <th>Price</th> <th>Code</th> </tr> </thead> <tbody> <tr> <td>2029/581</td> <td>LEWIS, CATHY J</td> <td>05/19/2009</td> <td>0</td> <td>4</td> </tr> <tr> <td>1744/843</td> <td>LEWIS, GEORGE K & ETAL</td> <td>01/01/2006</td> <td>20,000</td> <td>11</td> </tr> </tbody> </table>					Bk/Pg	Grantor	Date	Price	Code	2029/581	LEWIS, CATHY J	05/19/2009	0	4	1744/843	LEWIS, GEORGE K & ETAL	01/01/2006	20,000	11																																																				
Source	REAL	Fair Cash	Capped	Asmnt Level	Assessed	Levy Rate	82.750	Current Tax																																																																																																																	
Remove Cap	0	Land Value 528	528	11%	58	Assessed	15,380	1,272.70																																																																																																																	
Year Frozen	0	Improvements 179,233	139,290		15,322	Penalty	0																																																																																																																		
Uncapped Value	0	Mobile Home 0	0		0	Exemption	1,000	-83.00																																																																																																																	
TIF Project ID	0	Total Value 179,761	139,818		15,380	Total Taxable	14,380	1,190.00																																																																																																																	
Bk/Pg	Grantor	Date	Price	Code																																																																																																																					
2029/581	LEWIS, CATHY J	05/19/2009	0	4																																																																																																																					
1744/843	LEWIS, GEORGE K & ETAL	01/01/2006	20,000	11																																																																																																																					
Assessment History <table border="1"> <thead> <tr> <th>Tax Year</th> <th>Statement Number</th> <th>Billed Owner</th> <th>Tax Area</th> <th>Total Value</th> <th>Exemptions</th> <th>Taxable Value</th> <th>Billed Tax</th> </tr> </thead> <tbody> <tr><td>2025</td><td>2025-660087797</td><td>FIELDER, MICHAEL DEAN &</td><td>14</td><td>165,501</td><td>1000</td><td>13,932</td><td>1,153.00</td></tr> <tr><td>2024</td><td>2024-660087797</td><td>FIELDER, MICHAEL DEAN &</td><td>14</td><td>175,389</td><td>1000</td><td>13,497</td><td>1,139.00</td></tr> <tr><td>2023</td><td>2023-660087797</td><td>FIELDER, MICHAEL DEAN &</td><td>14</td><td>146,862</td><td>1000</td><td>13,075</td><td>1,115.00</td></tr> <tr><td>2022</td><td>2022-660087797</td><td>FIELDER, MICHAEL DEAN &</td><td>14</td><td>147,445</td><td>1000</td><td>12,665</td><td>1,072.00</td></tr> <tr><td>2021</td><td>2021-660087797</td><td>FIELDER, MICHAEL DEAN &</td><td>14</td><td>123,989</td><td>1000</td><td>12,267</td><td>1,040.00</td></tr> <tr><td>2020</td><td>2020-660087797</td><td>FIELDER, MICHAEL DEAN &</td><td>14</td><td>122,337</td><td>1000</td><td>11,881</td><td>1,008.00</td></tr> <tr><td>2019</td><td>2019-660087797</td><td>FIELDER, MICHAEL DEAN &</td><td>14</td><td>117,923</td><td>1000</td><td>11,506</td><td>988.00</td></tr> <tr><td>2018</td><td>2018-660087797</td><td>FIELDER, MICHAEL DEAN &</td><td>14</td><td>121,404</td><td>1000</td><td>11,142</td><td>952.00</td></tr> <tr><td>2017</td><td>2017-660087797</td><td>FIELDER, MICHAEL DEAN &</td><td>14</td><td>120,163</td><td>1000</td><td>10,788</td><td>925.00</td></tr> <tr><td>2016</td><td>2016-660087797</td><td>FIELDER, MICHAEL DEAN &</td><td>14</td><td>109,963</td><td>1000</td><td>10,445</td><td>910.00</td></tr> <tr><td>2015</td><td>2015-660087797</td><td>FIELDER, MICHAEL DEAN &</td><td>14</td><td>107,421</td><td>1000</td><td>10,111</td><td>871.00</td></tr> <tr><td>2014</td><td>2014-660087797</td><td>FIELDER, MICHAEL DEAN &</td><td>14</td><td>109,527</td><td>1000</td><td>9,788</td><td>872.00</td></tr> <tr><td>2013</td><td>2013-660087797</td><td>FIELDER, MICHAEL DEAN &</td><td>14</td><td>102,838</td><td>1000</td><td>9,473</td><td>840.00</td></tr> </tbody> </table>										Tax Year	Statement Number	Billed Owner	Tax Area	Total Value	Exemptions	Taxable Value	Billed Tax	2025	2025-660087797	FIELDER, MICHAEL DEAN &	14	165,501	1000	13,932	1,153.00	2024	2024-660087797	FIELDER, MICHAEL DEAN &	14	175,389	1000	13,497	1,139.00	2023	2023-660087797	FIELDER, MICHAEL DEAN &	14	146,862	1000	13,075	1,115.00	2022	2022-660087797	FIELDER, MICHAEL DEAN &	14	147,445	1000	12,665	1,072.00	2021	2021-660087797	FIELDER, MICHAEL DEAN &	14	123,989	1000	12,267	1,040.00	2020	2020-660087797	FIELDER, MICHAEL DEAN &	14	122,337	1000	11,881	1,008.00	2019	2019-660087797	FIELDER, MICHAEL DEAN &	14	117,923	1000	11,506	988.00	2018	2018-660087797	FIELDER, MICHAEL DEAN &	14	121,404	1000	11,142	952.00	2017	2017-660087797	FIELDER, MICHAEL DEAN &	14	120,163	1000	10,788	925.00	2016	2016-660087797	FIELDER, MICHAEL DEAN &	14	109,963	1000	10,445	910.00	2015	2015-660087797	FIELDER, MICHAEL DEAN &	14	107,421	1000	10,111	871.00	2014	2014-660087797	FIELDER, MICHAEL DEAN &	14	109,527	1000	9,788	872.00	2013	2013-660087797	FIELDER, MICHAEL DEAN &	14	102,838	1000	9,473	840.00
Tax Year	Statement Number	Billed Owner	Tax Area	Total Value	Exemptions	Taxable Value	Billed Tax																																																																																																																		
2025	2025-660087797	FIELDER, MICHAEL DEAN &	14	165,501	1000	13,932	1,153.00																																																																																																																		
2024	2024-660087797	FIELDER, MICHAEL DEAN &	14	175,389	1000	13,497	1,139.00																																																																																																																		
2023	2023-660087797	FIELDER, MICHAEL DEAN &	14	146,862	1000	13,075	1,115.00																																																																																																																		
2022	2022-660087797	FIELDER, MICHAEL DEAN &	14	147,445	1000	12,665	1,072.00																																																																																																																		
2021	2021-660087797	FIELDER, MICHAEL DEAN &	14	123,989	1000	12,267	1,040.00																																																																																																																		
2020	2020-660087797	FIELDER, MICHAEL DEAN &	14	122,337	1000	11,881	1,008.00																																																																																																																		
2019	2019-660087797	FIELDER, MICHAEL DEAN &	14	117,923	1000	11,506	988.00																																																																																																																		
2018	2018-660087797	FIELDER, MICHAEL DEAN &	14	121,404	1000	11,142	952.00																																																																																																																		
2017	2017-660087797	FIELDER, MICHAEL DEAN &	14	120,163	1000	10,788	925.00																																																																																																																		
2016	2016-660087797	FIELDER, MICHAEL DEAN &	14	109,963	1000	10,445	910.00																																																																																																																		
2015	2015-660087797	FIELDER, MICHAEL DEAN &	14	107,421	1000	10,111	871.00																																																																																																																		
2014	2014-660087797	FIELDER, MICHAEL DEAN &	14	109,527	1000	9,788	872.00																																																																																																																		
2013	2013-660087797	FIELDER, MICHAEL DEAN &	14	102,838	1000	9,473	840.00																																																																																																																		



Rogers

Assessment Property Record Card for Tax Year 2026

Data provided by LISA DELOZIER County Assessor

Date 04/17/2026
Time 17:43:27
Page 2

Units Buildable - CHELSEA FOYIL RURAL (UNITS BUILDABLE)	
Lot Size	
Lot Count	
Units Buildable	
Non-Ag Acres	0
Topography	
Street Access	
Utilities	
Amenities	LAND QUALITY
Method	Units-Buildable
Base Lot Value	
Factor Value	
Adjustments	
Lot Value	



Residential Data	
Type	1 Single Family Residence
Condition	3 - Average
Quality	2 - Fair
Architecture	
Style	100% One Story
Exterior Wall	100% Veneer, Masonry
Base/Total Area	1,182 / 1,182
Style	100% One Story
HVAC	100% Warmed & Cooled Air
Roof Cover	1 Composition Shingle
Area on Slab	1,182
Fixture/RghIn	11 /
Bed/F/H Bath	3 / 2.0 /
Basement Area	
Garage Type	572 Attached Garage - Unfinished
Remodel	
Year/Eff Age	2006 / 15

GRM Approach	
GRM Code	
Gross Rent	0.00
Indicated Value	

Multiple Regression	
MRA Code	
Adjusted R	
Indicated Value	

Direct Comparables	
Selection Model	1 Res
Adjustment Model	A2 AO Test
Comparables	
Indicated Value	

Cost Approach		Manual : 01/2025	
Base Cost	98.90	Total Misc Impr	+ 9,766
Roofing Adj	+ 4.03	Garage Cost	+ 12,685
Subfloor Adj	+ 0.00	Total RCN	= 168,428
Heat/Cool Adj	+ 10.09	Depreciation (20%)	- 33,686
Plumbing Adj	+ 10.48	Lump Sums	+ 0
Basement Adj	+ 0.00	RCNLD	= 134,742
Adj Base Cost	= 123.50	Lot Value	+ 134,742
Total Area	x 1,182	Indicated Value	= 134,742
Adjusted Cost	= 145,977	Value Per SqFt	113.99

Value Reconciliation			
Selected Approach	Cost Approach		
Improvements	134,742		
Lot Value			
Indicated Value	134,742	113.99	Per SqFt
Agland Value	528		
Site Improvements	44,491		
Total Value	179,761	152.08	Total Value Per SqFt

Miscellaneous Improvements								
Code	Description	Sketch ID	Size	Year	Units	Unit Cost	Depr	Value
SHLT	STORM SHELTER	0		1 2016	1	0.00		
PRCH	SLAB PORCH - COVERED	107741	27x6		162	20.36		3,298
EPSW	ENCLOSED PORCH - SOLID WALL	115345	12x10		120	53.90		6,468



Rogers

Assessment Property Record Card for Tax Year 2026

Data provided by LISA DELOZIER County Assessor

Date 04/17/2026
 Time 17:43:27
 Page 3

Sketch Image

660087797

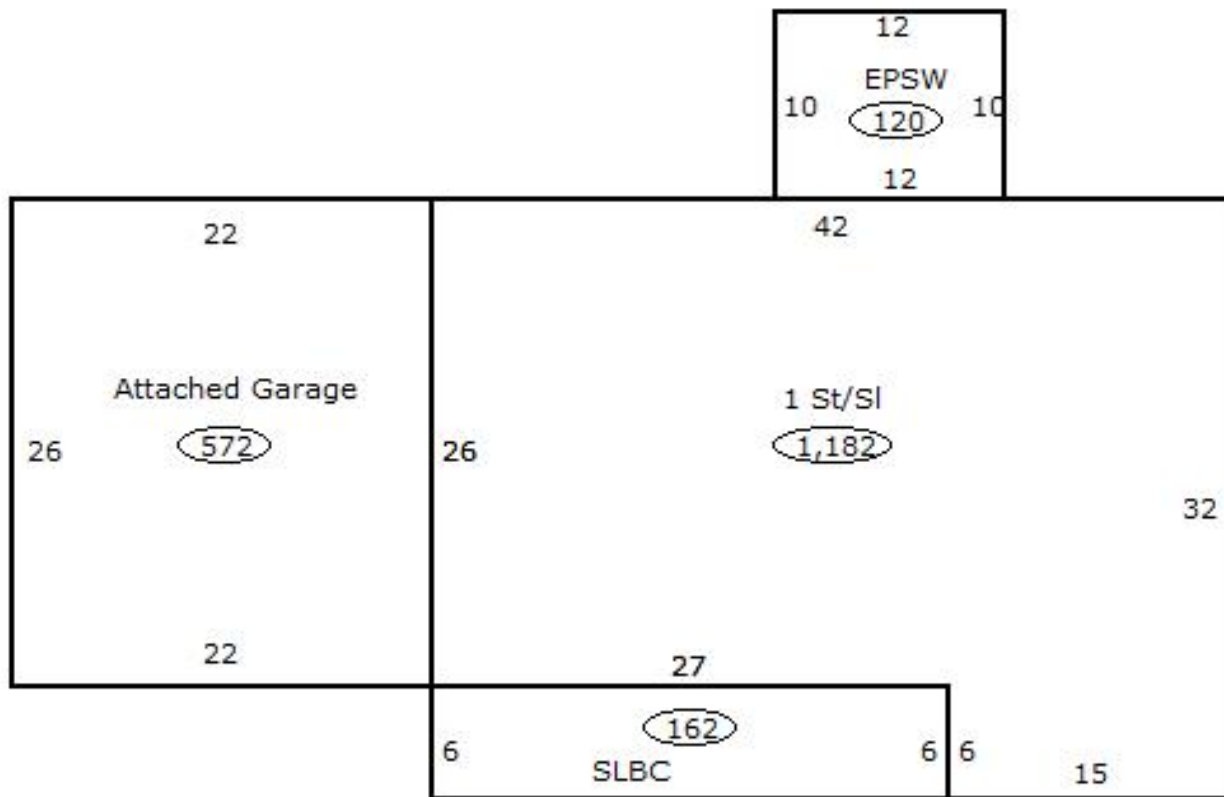

Sketch Vector Information

Sequence	Code	Type	Built Over	Scale	Section Label	Base Area	Multiplier	Total Area
1	R	1	Slab	13	1 St/Sl	1,182	1.000	1,182
2	G	1		13	Attached Garage	572	1.000	572
3	M	PRCH		13	SLBC	162	1.000	162
4	M	EPSW		13	EPSW	120	1.000	120
Total Building Area						1,182		1,182



Rogers

Assessment Property Record Card for Tax Year 2026

Data provided by LISA DELOZIER County Assessor

Date 04/17/2026
 Time 17:43:27
 Page 4

660087797

Outbuildings/Site Improvements

Building Image	Code	Description	Dimensions	Floor	Roofing	Total Units	
	UTIL	SHOP BUILDING	0x0x0			1,200	
	Qual 2	Cond 3	Year	Eff Age			
		Valuation Summary	Modifier Total	RCN	Depr (5% Phys/ % Func)	RCNLD	
		Base Cost (30.25 x 1,200)	36,300		36,300	1,815	34,485
	BARN	BARN	0x0x0			864	
	Qual 3	Cond 3	Year	Eff Age			
		Valuation Summary	Modifier Total	RCN	Depr (10% Phys/ % Func)	RCNLD	
		Base Cost (10.48 x 864)	9,055		9,055	906	8,149
	LT	LEAN-TO	0x0x0			440	
	Qual 3	Cond 3	Year	Eff Age			
		Valuation Summary	Modifier Total	RCN	Depr (0% Phys/ % Func)	RCNLD	
		Base Cost (2.92 x 440)	1,285		1,285		1,285
	LF	LOAFING SHED	8x12x0			96	
	Qual 2	Cond 3	Year	Eff Age			
		Valuation Summary	Modifier Total	RCN	Depr (30% Phys/ % Func)	RCNLD	
		Base Cost (4.26 x 96)	409		409	123	286
	LF	LOAFING SHED	8x12x0			96	
	Qual 2	Cond 3	Year	Eff Age			
		Valuation Summary	Modifier Total	RCN	Depr (30% Phys/ % Func)	RCNLD	
		Base Cost (4.26 x 96)	409		409	123	286



Rogers

Assessment Property Record Card for Tax Year 2026

Data provided by LISA DELOZIER County Assessor

Date 04/17/2026
Time 17:43:27
Page 5

Agland Inventory

660087797

Soi	Description	Land Use	LPI	Adj Type	Adj Code	Acres	Use/Acre	Mkt/Acre	Use Value	Market Value
CO	COLLINSVILLE STONY LOAM	NTV PST	22			10.000	53	53	528	528
NTV PST Totals						10.000			528	528
Total Agland						10.000			528	528