



# Rogers

## Assessment Property Record Card for Tax Year 2026

Data provided by LISA DELOZIER County Assessor

Date 04/18/2026  
Time 06:41:36  
Page 1

Assessment Data					Primary Image																																																																																																																				
<b>Account</b> 660090350 <b>Parcel ID</b> 000000-00-0-00856-003-0004 <b>Cadastral ID</b> 22-22-14-09240 <b>Property Type</b> REAL - Real Property <b>Property Class</b> RRP VI Area 2 <b>Tax Area</b> 27 - COLLINSVILLE/COLL FIRE <b>Name ID</b> 347817 BOOMER, KURT & ASHLEY  14701 E 150TH ST N COLLINSVILLE OK 74021-0000  <b>Parcel Location</b> <b>Situs</b> 14701 E 150TH ST N <b>Subdivision</b> TYLER CROSSING <b>Lot/Block</b> 0004 / 0003 <b>Parcel Size</b> .89 - Lots <b>Sec/Twn/Rng</b> 22 / 22 / 14 / 5 <b>Neighborhood</b> 1096 - R-V02-NW COLLINSVILLE <b>School District</b> S026 - COLLINSVILLE SCHOOLS																																																																																																																									
<b>Legal Description</b> Lat/Long: 36.37040994 -95.81013615																																																																																																																									
<b>Legal Description</b> LOT 4 BLOCK 3 TYLER CROSSING LESS & EXCEPT BEG AT NE/C LOT 4; TH N46-43-36W 223.05' TO PT ON NWLY LINE; TH N45.14.22E 28.31' TO NW/C; TH S39-28-01E 223.87' TO POB.					<b>Building Permits</b> <table border="1"> <thead> <tr> <th>Number</th> <th>Description</th> <th>Opened</th> <th>Closed</th> <th>Amount</th> </tr> </thead> <tbody> <tr> <td></td> <td></td> <td></td> <td></td> <td></td> </tr> </tbody> </table>					Number	Description	Opened	Closed	Amount																																																																																																											
Number	Description	Opened	Closed	Amount																																																																																																																					
<b>Exemptions</b> <table border="1"> <thead> <tr> <th>Code</th> <th>Type</th> <th>Active</th> <th>Maximum</th> <th>Exemption</th> </tr> </thead> <tbody> <tr> <td>H</td> <td>Homestead</td> <td>No</td> <td>1,000</td> <td></td> </tr> </tbody> </table>					Code	Type	Active	Maximum	Exemption	H	Homestead	No	1,000		<b>Sale History</b> <table border="1"> <thead> <tr> <th>Bk/Pg</th> <th>Grantor</th> <th>Date</th> <th>Price</th> <th>Code</th> </tr> </thead> <tbody> <tr> <td>/</td> <td>YOUNG, KADE A &amp; ELISABETH J</td> <td>08/07/2025</td> <td>460,000</td> <td>YES</td> </tr> <tr> <td>2640/307</td> <td>PHILLIPS, CORY D &amp;</td> <td>06/07/2017</td> <td>270,000</td> <td>YES</td> </tr> <tr> <td>2139/344</td> <td>DENHAM HOMES LLC</td> <td>10/29/2010</td> <td>242,000</td> <td>YES</td> </tr> <tr> <td>2116/602</td> <td>TYLER CROSSING DEV LLC</td> <td>07/21/2010</td> <td>90,000</td> <td></td> </tr> </tbody> </table>					Bk/Pg	Grantor	Date	Price	Code	/	YOUNG, KADE A & ELISABETH J	08/07/2025	460,000	YES	2640/307	PHILLIPS, CORY D &	06/07/2017	270,000	YES	2139/344	DENHAM HOMES LLC	10/29/2010	242,000	YES	2116/602	TYLER CROSSING DEV LLC	07/21/2010	90,000																																																																														
Code	Type	Active	Maximum	Exemption																																																																																																																					
H	Homestead	No	1,000																																																																																																																						
Bk/Pg	Grantor	Date	Price	Code																																																																																																																					
/	YOUNG, KADE A & ELISABETH J	08/07/2025	460,000	YES																																																																																																																					
2640/307	PHILLIPS, CORY D &	06/07/2017	270,000	YES																																																																																																																					
2139/344	DENHAM HOMES LLC	10/29/2010	242,000	YES																																																																																																																					
2116/602	TYLER CROSSING DEV LLC	07/21/2010	90,000																																																																																																																						
<b>Parcel Valuation</b> <table border="1"> <thead> <tr> <th>Source</th> <th>REAL</th> <th>Fair Cash</th> <th>Capped</th> <th>Asmnt Level</th> <th>Assessed</th> <th>Levy Rate</th> <th>102.120</th> <th>Current Tax</th> </tr> </thead> <tbody> <tr> <td>Remove Cap</td> <td>2026</td> <td>Land Value 122,905</td> <td>122,905</td> <td>11%</td> <td>13,520</td> <td>Assessed</td> <td>50,600</td> <td>5,167.27</td> </tr> <tr> <td>Year Frozen</td> <td>0</td> <td>Improvements 337,095</td> <td>337,095</td> <td></td> <td>37,080</td> <td>Penalty</td> <td>0</td> <td></td> </tr> <tr> <td>Uncapped Value</td> <td>0</td> <td>Mobile Home 0</td> <td>0</td> <td></td> <td>0</td> <td>Exemption</td> <td>0</td> <td>0.00</td> </tr> <tr> <td>TIF Project ID</td> <td>0</td> <td>Total Value 460,000</td> <td>460,000</td> <td></td> <td>50,600</td> <td>Total Taxable</td> <td>50,600</td> <td>5,167.00</td> </tr> </tbody> </table>										Source	REAL	Fair Cash	Capped	Asmnt Level	Assessed	Levy Rate	102.120	Current Tax	Remove Cap	2026	Land Value 122,905	122,905	11%	13,520	Assessed	50,600	5,167.27	Year Frozen	0	Improvements 337,095	337,095		37,080	Penalty	0		Uncapped Value	0	Mobile Home 0	0		0	Exemption	0	0.00	TIF Project ID	0	Total Value 460,000	460,000		50,600	Total Taxable	50,600	5,167.00																																																																			
Source	REAL	Fair Cash	Capped	Asmnt Level	Assessed	Levy Rate	102.120	Current Tax																																																																																																																	
Remove Cap	2026	Land Value 122,905	122,905	11%	13,520	Assessed	50,600	5,167.27																																																																																																																	
Year Frozen	0	Improvements 337,095	337,095		37,080	Penalty	0																																																																																																																		
Uncapped Value	0	Mobile Home 0	0		0	Exemption	0	0.00																																																																																																																	
TIF Project ID	0	Total Value 460,000	460,000		50,600	Total Taxable	50,600	5,167.00																																																																																																																	
<b>Assessment History</b> <table border="1"> <thead> <tr> <th>Tax Year</th> <th>Statement Number</th> <th>Billed Owner</th> <th>Tax Area</th> <th>Total Value</th> <th>Exemptions</th> <th>Taxable Value</th> <th>Billed Tax</th> </tr> </thead> <tbody> <tr><td>2025</td><td>2025-660090350</td><td>BOOMER, KURT &amp; ASHLEY</td><td>27</td><td>353,326</td><td>1000</td><td>34,969</td><td>3,571.00</td></tr> <tr><td>2024</td><td>2024-660090350</td><td>YOUNG, KADE A &amp; ELISABETH J</td><td>27</td><td>368,404</td><td>1000</td><td>33,921</td><td>3,399.00</td></tr> <tr><td>2023</td><td>2023-660090350</td><td>YOUNG, KADE A &amp; ELISABETH J</td><td>27</td><td>341,157</td><td>1000</td><td>32,904</td><td>3,236.00</td></tr> <tr><td>2022</td><td>2022-660090350</td><td>YOUNG, KADE A &amp; ELISABETH J</td><td>27</td><td>344,338</td><td>1000</td><td>31,917</td><td>3,118.00</td></tr> <tr><td>2021</td><td>2021-660090350</td><td>YOUNG, KADE A &amp; ELISABETH J</td><td>27</td><td>290,530</td><td>1000</td><td>30,958</td><td>3,071.00</td></tr> <tr><td>2020</td><td>2020-660090350</td><td>YOUNG, KADE A &amp; ELISABETH J</td><td>27</td><td>288,376</td><td>1000</td><td>30,080</td><td>2,992.00</td></tr> <tr><td>2019</td><td>2019-660090350</td><td>YOUNG, KADE A &amp; ELISABETH J</td><td>27</td><td>274,319</td><td>1000</td><td>29,175</td><td>2,869.00</td></tr> <tr><td>2018</td><td>2018-660090350</td><td>YOUNG, KADE A &amp; ELISABETH J</td><td>27</td><td>272,278</td><td>1000</td><td>28,951</td><td>2,879.00</td></tr> <tr><td>2017</td><td>2017-660090350</td><td>YOUNG, KADE A &amp; ELISABETH J</td><td>27</td><td>270,031</td><td>1000</td><td>28,703</td><td>2,808.00</td></tr> <tr><td>2016</td><td>2016-660090350</td><td>PHILLIPS, CORY D &amp;</td><td>27</td><td>263,125</td><td>1000</td><td>27,877</td><td>2,659.00</td></tr> <tr><td>2015</td><td>2015-660090350</td><td>PHILLIPS, CORY D &amp;</td><td>27</td><td>254,868</td><td>1000</td><td>27,035</td><td>2,610.00</td></tr> <tr><td>2014</td><td>2014-660090350</td><td>PHILLIPS, CORY D &amp;</td><td>27</td><td>257,417</td><td>1000</td><td>26,384</td><td>2,470.00</td></tr> <tr><td>2013</td><td>2013-660090350</td><td>PHILLIPS, CORY D &amp;</td><td>27</td><td>241,691</td><td>1000</td><td>25,586</td><td>2,389.00</td></tr> </tbody> </table>										Tax Year	Statement Number	Billed Owner	Tax Area	Total Value	Exemptions	Taxable Value	Billed Tax	2025	2025-660090350	BOOMER, KURT & ASHLEY	27	353,326	1000	34,969	3,571.00	2024	2024-660090350	YOUNG, KADE A & ELISABETH J	27	368,404	1000	33,921	3,399.00	2023	2023-660090350	YOUNG, KADE A & ELISABETH J	27	341,157	1000	32,904	3,236.00	2022	2022-660090350	YOUNG, KADE A & ELISABETH J	27	344,338	1000	31,917	3,118.00	2021	2021-660090350	YOUNG, KADE A & ELISABETH J	27	290,530	1000	30,958	3,071.00	2020	2020-660090350	YOUNG, KADE A & ELISABETH J	27	288,376	1000	30,080	2,992.00	2019	2019-660090350	YOUNG, KADE A & ELISABETH J	27	274,319	1000	29,175	2,869.00	2018	2018-660090350	YOUNG, KADE A & ELISABETH J	27	272,278	1000	28,951	2,879.00	2017	2017-660090350	YOUNG, KADE A & ELISABETH J	27	270,031	1000	28,703	2,808.00	2016	2016-660090350	PHILLIPS, CORY D &	27	263,125	1000	27,877	2,659.00	2015	2015-660090350	PHILLIPS, CORY D &	27	254,868	1000	27,035	2,610.00	2014	2014-660090350	PHILLIPS, CORY D &	27	257,417	1000	26,384	2,470.00	2013	2013-660090350	PHILLIPS, CORY D &	27	241,691	1000	25,586	2,389.00
Tax Year	Statement Number	Billed Owner	Tax Area	Total Value	Exemptions	Taxable Value	Billed Tax																																																																																																																		
2025	2025-660090350	BOOMER, KURT & ASHLEY	27	353,326	1000	34,969	3,571.00																																																																																																																		
2024	2024-660090350	YOUNG, KADE A & ELISABETH J	27	368,404	1000	33,921	3,399.00																																																																																																																		
2023	2023-660090350	YOUNG, KADE A & ELISABETH J	27	341,157	1000	32,904	3,236.00																																																																																																																		
2022	2022-660090350	YOUNG, KADE A & ELISABETH J	27	344,338	1000	31,917	3,118.00																																																																																																																		
2021	2021-660090350	YOUNG, KADE A & ELISABETH J	27	290,530	1000	30,958	3,071.00																																																																																																																		
2020	2020-660090350	YOUNG, KADE A & ELISABETH J	27	288,376	1000	30,080	2,992.00																																																																																																																		
2019	2019-660090350	YOUNG, KADE A & ELISABETH J	27	274,319	1000	29,175	2,869.00																																																																																																																		
2018	2018-660090350	YOUNG, KADE A & ELISABETH J	27	272,278	1000	28,951	2,879.00																																																																																																																		
2017	2017-660090350	YOUNG, KADE A & ELISABETH J	27	270,031	1000	28,703	2,808.00																																																																																																																		
2016	2016-660090350	PHILLIPS, CORY D &	27	263,125	1000	27,877	2,659.00																																																																																																																		
2015	2015-660090350	PHILLIPS, CORY D &	27	254,868	1000	27,035	2,610.00																																																																																																																		
2014	2014-660090350	PHILLIPS, CORY D &	27	257,417	1000	26,384	2,470.00																																																																																																																		
2013	2013-660090350	PHILLIPS, CORY D &	27	241,691	1000	25,586	2,389.00																																																																																																																		



# Rogers

## Assessment Property Record Card for Tax Year 2026

Data provided by LISA DELOZIER County Assessor

Date 04/18/2026  
Time 06:41:36  
Page 2

Lot Data	Square-Foot - NBHD 1096 #1	Primary Image
Lot Size		
Lot Count		
Units Buildable	0.89	
Non-Ag Acres	0.617	
Topography		
Street Access		
Utilities		
Amenities	LAND QUALITY	
	0	
	0	
Method	Square-Foot	
Base Lot Value	26,878.00 x 1.90 = 51,068	
Factor Value		
Adjustments	2.4067	
Lot Value	122,905	

Residential Data	
Type	1 Single Family Residence
Condition	3 - Average
Quality	4 - Good
Architecture	TRAD TRADITIONAL
Style	100% 1 1/2 Story Finished
Exterior Wall	100% Veneer, Masonry
Base/Total Area	2,106 / 2,524
Style	100% 1 1/2 Story Finished
HVAC	100% Warmed & Cooled Air
Roof Cover	1 Composition Shingle
Area on Slab	2,106
Fixture/RghIn	11 /
Bed/F/H Bath	4 / 2.0 /
Basement Area	
Garage Type	571 Attached Garage - Finished
Remodel	
Year/Eff Age	2010 / 12



\\tsclient\TCASEY\CASEY BOOTH VISUAL INSPECTION\2020-8- 8/26/2020

GRM Approach	
GRM Code	
Gross Rent	0.00
Indicated Value	

Multiple Regression			
MRA Code	1	Test	
Adusted R	0.8445		
Indicated Value	361,333	143.16	Per SqFt

Direct Comparables			
Selection Model	A	Adam Test	
Adjustment Model	1	2022 Residential	
Comparables	2		
Indicated Value	333,640		Per SqFt

Value Reconciliation			
Selected Approach	Cost Approach		
Improvements	337,095		
Lot Value	122,905		
Indicated Value	460,000	182.25	Per SqFt
Agland Value			
Site Improvements			
Total Value	460,000	182.25	Total Value Per SqFt

Cost Approach				Manual : 01/2025			
Base Cost	105.93	Total Misc Impr	+	17,896			
Roofing Adj	+ 4.99	Garage Cost	+	33,740			
Subfloor Adj	+ -3.85	Total RCN	=	383,062			
Heat/Cool Adj	+ 16.31	Depreciation ( 12%)	-	45,967			
Plumbing Adj	+ 7.93	Lump Sums	+	0			
Basement Adj	+ 0.00	RCNLD	=	337,095			
Adj Base Cost	= 131.31	Lot Value	+	122,905			
Total Area	x 2,524	Indicated Value	=	460,000			
Adjusted Cost	= 331,426	Value Per SqFt		182.25			

Miscellaneous Improvements								
Code	Description	Sketch ID	Size	Year	Units	Unit Cost	Depr	Value
FPR1	FIREPLACE - RESIDENTIAL 1 STORY	0		1	1	7,243.87		7,244
PRCH	SLAB PORCH - COVERED	110339	20x10		200	32.25		6,450
PATO	SLAB PORCH - OPEN	110340	12x10		120	14.15		1,698
PRCH	SLAB PORCH - COVERED	110342	76		76	32.95		2,504



Sketch Image

660090350

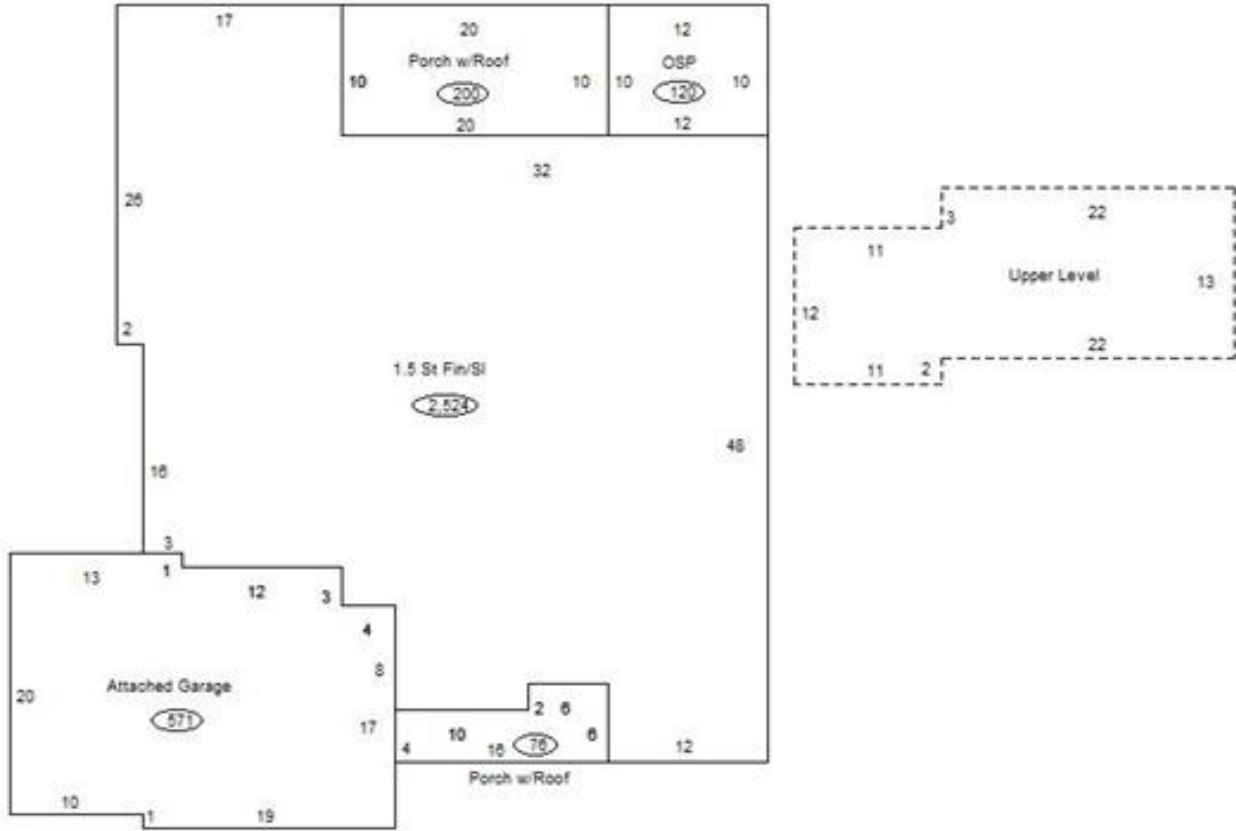

Sketch Vector Information

Sequence	Code	Type	Built Over	Scale	Section Label	Base Area	Multiplier	Total Area
1	R	5	Slab	13	1.5 St Fin/SI	2,106	1.198	2,524
2	M	PRCH		13	SLBC	200	1.000	200
3	M	PATO		13	Open Slab	120	1.000	120
4	G	1		13	Attached Garage	571	1.000	571
5	M	PRCH		13	SLBC	76	1.000	76
6	U	^UL		13	Upper Level	418	1.000	418
<b>Total Building Area</b>						<b>2,106</b>		<b>2,524</b>