



Rogers

Assessment Property Record Card for Tax Year 2026

Data provided by LISA DELOZIER County Assessor

Date 04/18/2026
Time 06:56:21
Page 1

Assessment Data					Primary Image																																																																																																																				
Account 660091197 Parcel ID 21N15E-18-2-00000-000-0000 Cadastral ID 18-21-15-00525 Property Type REAL - Real Property Property Class RR VI Area 4 Tax Area 7 - OWASSO/LIMESTONE FIRE Name ID 299004 WARD, CHRISTOPHER & MELISSA 4370 E 490 RD CLAREMORE OK 74019-0000																																																																																																																									
Parcel Location Situs 04370 E 490 RD Subdivision Lot/Block / Parcel Size 10.98 - Acres Sec/Twn/Rng 18 / 21 / 15 / 2 Neighborhood 6110 - UNPLATTED School District S021 - OWASSO SCHOOLS																																																																																																																									
Legal Description Lat/Long: 36.30472883 -95.75266084 W 637' S 669.5' NE NW & E 30' W 637' NE NW LESS S 669.5' THEREOF, & W 637' N 50' SE NW.					Building Permits <table border="1"> <thead> <tr> <th>Number</th> <th>Description</th> <th>Opened</th> <th>Closed</th> <th>Amount</th> </tr> </thead> <tbody> <tr> <td>8461</td> <td>R12-NEW POOL</td> <td>08/2011</td> <td>08/2011</td> <td></td> </tr> <tr> <td>R2010 09 8</td> <td>R12-NEW 4960 SQ FT SFR</td> <td>10/2010</td> <td>08/2011</td> <td>550,000</td> </tr> </tbody> </table>					Number	Description	Opened	Closed	Amount	8461	R12-NEW POOL	08/2011	08/2011		R2010 09 8	R12-NEW 4960 SQ FT SFR	10/2010	08/2011	550,000																																																																																																	
Number	Description	Opened	Closed	Amount																																																																																																																					
8461	R12-NEW POOL	08/2011	08/2011																																																																																																																						
R2010 09 8	R12-NEW 4960 SQ FT SFR	10/2010	08/2011	550,000																																																																																																																					
Exemptions <table border="1"> <thead> <tr> <th>Code</th> <th>Type</th> <th>Active</th> <th>Maximum</th> <th>Exemption</th> </tr> </thead> <tbody> <tr> <td>H</td> <td>Homestead</td> <td>Yes</td> <td>1,000</td> <td>1,000</td> </tr> </tbody> </table>					Code	Type	Active	Maximum	Exemption	H	Homestead	Yes	1,000	1,000	Sale History <table border="1"> <thead> <tr> <th>Bk/Pg</th> <th>Grantor</th> <th>Date</th> <th>Price</th> <th>Code</th> </tr> </thead> <tbody> <tr> <td>1960/129</td> <td>WARREN, KENNETH RAY &</td> <td>06/05/2008</td> <td>218,000</td> <td>11</td> </tr> </tbody> </table>					Bk/Pg	Grantor	Date	Price	Code	1960/129	WARREN, KENNETH RAY &	06/05/2008	218,000	11																																																																																												
Code	Type	Active	Maximum	Exemption																																																																																																																					
H	Homestead	Yes	1,000	1,000																																																																																																																					
Bk/Pg	Grantor	Date	Price	Code																																																																																																																					
1960/129	WARREN, KENNETH RAY &	06/05/2008	218,000	11																																																																																																																					
Parcel Valuation <table border="1"> <thead> <tr> <th>Source</th> <th>REAL</th> <th>Fair Cash</th> <th>Capped</th> <th>Asmnt Level</th> <th>Assessed</th> <th>Levy Rate</th> <th>108.538</th> <th>Current Tax</th> </tr> </thead> <tbody> <tr> <td>Remove Cap</td> <td>2009</td> <td>Land Value 157,984</td> <td>124,318</td> <td>11%</td> <td>13,675</td> <td>Assessed</td> <td>43,534</td> <td>4,725.09</td> </tr> <tr> <td>Year Frozen</td> <td>0</td> <td>Improvements 932,383</td> <td>271,445</td> <td></td> <td>29,859</td> <td>Penalty</td> <td>0</td> <td></td> </tr> <tr> <td>Uncapped Value</td> <td>0</td> <td>Mobile Home 0</td> <td>0</td> <td></td> <td>0</td> <td>Exemption</td> <td>1,000</td> <td>-97.00</td> </tr> <tr> <td>TIF Project ID</td> <td>0</td> <td>Total Value 1,090,367</td> <td>395,763</td> <td></td> <td>43,534</td> <td>Total Taxable</td> <td>42,534</td> <td>4,628.00</td> </tr> </tbody> </table>										Source	REAL	Fair Cash	Capped	Asmnt Level	Assessed	Levy Rate	108.538	Current Tax	Remove Cap	2009	Land Value 157,984	124,318	11%	13,675	Assessed	43,534	4,725.09	Year Frozen	0	Improvements 932,383	271,445		29,859	Penalty	0		Uncapped Value	0	Mobile Home 0	0		0	Exemption	1,000	-97.00	TIF Project ID	0	Total Value 1,090,367	395,763		43,534	Total Taxable	42,534	4,628.00																																																																			
Source	REAL	Fair Cash	Capped	Asmnt Level	Assessed	Levy Rate	108.538	Current Tax																																																																																																																	
Remove Cap	2009	Land Value 157,984	124,318	11%	13,675	Assessed	43,534	4,725.09																																																																																																																	
Year Frozen	0	Improvements 932,383	271,445		29,859	Penalty	0																																																																																																																		
Uncapped Value	0	Mobile Home 0	0		0	Exemption	1,000	-97.00																																																																																																																	
TIF Project ID	0	Total Value 1,090,367	395,763		43,534	Total Taxable	42,534	4,628.00																																																																																																																	
Assessment History <table border="1"> <thead> <tr> <th>Tax Year</th> <th>Statement Number</th> <th>Billed Owner</th> <th>Tax Area</th> <th>Total Value</th> <th>Exemptions</th> <th>Taxable Value</th> <th>Billed Tax</th> </tr> </thead> <tbody> <tr><td>2025</td><td>2025-660091197</td><td>WARD, CHRISTOPHER &</td><td>7</td><td>1,038,871</td><td>1000</td><td>41,267</td><td>4,490.00</td></tr> <tr><td>2024</td><td>2024-660091197</td><td>WARD, CHRISTOPHER &</td><td>7</td><td>1,068,689</td><td>1000</td><td>40,035</td><td>4,432.00</td></tr> <tr><td>2023</td><td>2023-660091197</td><td>WARD, CHRISTOPHER &</td><td>7</td><td>1,004,025</td><td>1000</td><td>38,840</td><td>4,209.00</td></tr> <tr><td>2022</td><td>2022-660091197</td><td>WARD, CHRISTOPHER &</td><td>7</td><td>999,076</td><td>1000</td><td>37,680</td><td>4,244.00</td></tr> <tr><td>2021</td><td>2021-660091197</td><td>WARD, CHRISTOPHER &</td><td>7</td><td>973,741</td><td>1000</td><td>36,553</td><td>4,072.00</td></tr> <tr><td>2020</td><td>2020-660091197</td><td>WARD, CHRISTOPHER &</td><td>7</td><td>958,199</td><td>1000</td><td>35,459</td><td>3,946.00</td></tr> <tr><td>2019</td><td>2019-660091197</td><td>WARD, CHRISTOPHER &</td><td>7</td><td>908,039</td><td>1000</td><td>34,398</td><td>3,830.00</td></tr> <tr><td>2018</td><td>2018-660091197</td><td>WARD, CHRISTOPHER &</td><td>7</td><td>312,423</td><td>0</td><td>34,367</td><td>3,690.00</td></tr> <tr><td>2017</td><td>2017-660091197</td><td>WARD, CHRISTOPHER &</td><td>7</td><td>310,151</td><td>0</td><td>34,117</td><td>3,696.00</td></tr> <tr><td>2016</td><td>2016-660091197</td><td>WARD, CHRISTOPHER &</td><td>7</td><td>305,157</td><td>0</td><td>33,567</td><td>3,639.00</td></tr> <tr><td>2015</td><td>2015-660091197</td><td>WARD, CHRIS &</td><td>7</td><td>299,379</td><td>0</td><td>32,932</td><td>3,593.00</td></tr> <tr><td>2014</td><td>2014-660091197</td><td>WARD, CHRIS &</td><td>7</td><td>301,999</td><td>0</td><td>33,220</td><td>3,654.00</td></tr> <tr><td>2013</td><td>2013-660091197</td><td>WARD, CHRIS &</td><td>7</td><td>830,234</td><td>0</td><td>87,812</td><td>9,480.00</td></tr> </tbody> </table>										Tax Year	Statement Number	Billed Owner	Tax Area	Total Value	Exemptions	Taxable Value	Billed Tax	2025	2025-660091197	WARD, CHRISTOPHER &	7	1,038,871	1000	41,267	4,490.00	2024	2024-660091197	WARD, CHRISTOPHER &	7	1,068,689	1000	40,035	4,432.00	2023	2023-660091197	WARD, CHRISTOPHER &	7	1,004,025	1000	38,840	4,209.00	2022	2022-660091197	WARD, CHRISTOPHER &	7	999,076	1000	37,680	4,244.00	2021	2021-660091197	WARD, CHRISTOPHER &	7	973,741	1000	36,553	4,072.00	2020	2020-660091197	WARD, CHRISTOPHER &	7	958,199	1000	35,459	3,946.00	2019	2019-660091197	WARD, CHRISTOPHER &	7	908,039	1000	34,398	3,830.00	2018	2018-660091197	WARD, CHRISTOPHER &	7	312,423	0	34,367	3,690.00	2017	2017-660091197	WARD, CHRISTOPHER &	7	310,151	0	34,117	3,696.00	2016	2016-660091197	WARD, CHRISTOPHER &	7	305,157	0	33,567	3,639.00	2015	2015-660091197	WARD, CHRIS &	7	299,379	0	32,932	3,593.00	2014	2014-660091197	WARD, CHRIS &	7	301,999	0	33,220	3,654.00	2013	2013-660091197	WARD, CHRIS &	7	830,234	0	87,812	9,480.00
Tax Year	Statement Number	Billed Owner	Tax Area	Total Value	Exemptions	Taxable Value	Billed Tax																																																																																																																		
2025	2025-660091197	WARD, CHRISTOPHER &	7	1,038,871	1000	41,267	4,490.00																																																																																																																		
2024	2024-660091197	WARD, CHRISTOPHER &	7	1,068,689	1000	40,035	4,432.00																																																																																																																		
2023	2023-660091197	WARD, CHRISTOPHER &	7	1,004,025	1000	38,840	4,209.00																																																																																																																		
2022	2022-660091197	WARD, CHRISTOPHER &	7	999,076	1000	37,680	4,244.00																																																																																																																		
2021	2021-660091197	WARD, CHRISTOPHER &	7	973,741	1000	36,553	4,072.00																																																																																																																		
2020	2020-660091197	WARD, CHRISTOPHER &	7	958,199	1000	35,459	3,946.00																																																																																																																		
2019	2019-660091197	WARD, CHRISTOPHER &	7	908,039	1000	34,398	3,830.00																																																																																																																		
2018	2018-660091197	WARD, CHRISTOPHER &	7	312,423	0	34,367	3,690.00																																																																																																																		
2017	2017-660091197	WARD, CHRISTOPHER &	7	310,151	0	34,117	3,696.00																																																																																																																		
2016	2016-660091197	WARD, CHRISTOPHER &	7	305,157	0	33,567	3,639.00																																																																																																																		
2015	2015-660091197	WARD, CHRIS &	7	299,379	0	32,932	3,593.00																																																																																																																		
2014	2014-660091197	WARD, CHRIS &	7	301,999	0	33,220	3,654.00																																																																																																																		
2013	2013-660091197	WARD, CHRIS &	7	830,234	0	87,812	9,480.00																																																																																																																		



Rogers

Assessment Property Record Card for Tax Year 2026

Data provided by LISA DELOZIER County Assessor

Date 04/18/2026
Time 06:56:21
Page 2

Lot Data		Square-Foot - NBHD 6110 #1		Primary Image				
Lot Size				<p>\\tsclient\C\Users\Randy Necessary\Pictures\101_0511\IMG_0006. 5/11/2022</p>				
Lot Count								
Units Buildable	10.98							
Non-Ag Acres	10.9227							
Topography								
Street Access								
Utilities								
Amenities	LAND QUALITY	0						
		0						
Method	Square-Foot							
Base Lot Value	475,793.00 x .33 = 157,984			GRM Approach				
Factor Value				GRM Code				
Adjustments	1.0000			Gross Rent 0.00				
Lot Value	157,984			Indicated Value				
Residential Data				Multiple Regression				
Type	1 Single Family Residence			MRA Code 1 Test				
Condition	3 - Average			Adusted R 0.8445				
Quality	6 - Excellent			Indicated Value 998,422 194.28 Per SqFt				
Architecture				Direct Comparables				
Style	100% 1 1/2 Story Finished			Selection Model 1 Res				
Exterior Wall	90% Frame, Stucco 10% Veneer, Stone			Adjustment Model A2 AO Test				
Base/Total Area	3,451 / 5,139			Comparables				
Style	100% 1 1/2 Story Finished			Indicated Value				
HVAC	100% Warmed & Cooled Air			Value Reconciliation				
Roof Cover	1 Composition Shingle			Selected Approach Cost Approach				
Area on Slab	3,451			Improvements 841,287				
Fixture/RghIn	22 /			Lot Value 157,984				
Bed/F/H Bath	6 / 5.0 /			Indicated Value 999,271 194.45 Per SqFt				
Basement Area				Agland Value				
Garage Type	968 Attached Garage - Unfinished			Site Improvements 91,096				
Remodel				Total Value 1,090,367 212.17 Total Value Per SqFt				
Year/Eff Age	2011 / 11							
Cost Approach		Manual : 01/2025						
Base Cost	112.04	Total Misc Impr	+ 81,439					
Roofing Adj	+ 4.97	Garage Cost	+ 78,156					
Subfloor Adj	+ -5.78	Total RCN	= 894,986					
Heat/Cool Adj	+ 21.74	Depreciation (6%)	- 53,699					
Plumbing Adj	+ 10.13	Lump Sums	+ 0					
Basement Adj	+ 0.00	RCNLD	= 841,287					
Adj Base Cost	= 143.10	Lot Value	+ 157,984					
Total Area	x 5,139	Indicated Value	= 999,271					
Adjusted Cost	= 735,391	Value Per SqFt	194.45					
Miscellaneous Improvements								
Code	Description	Sketch ID	Size	Year	Units	Unit Cost	Depr	Value
FPR1	FIREPLACE - RESIDENTIAL 1 STORY	0		2	2	9,658.49		19,317
PRCH	SLAB PORCH - COVERED	110726		744	744	43.17		32,118
PRCH	SLAB PORCH - COVERED	110727		533	533	44.13		23,521
PRCH	SLAB PORCH - COVERED	110730		14x10	140	46.31		6,483



Rogers
Assessment Property Record Card for Tax Year 2026
 Data provided by LISA DELOZIER County Assessor

Date 04/18/2026
 Time 06:56:21
 Page 3

Sketch Image

660091197

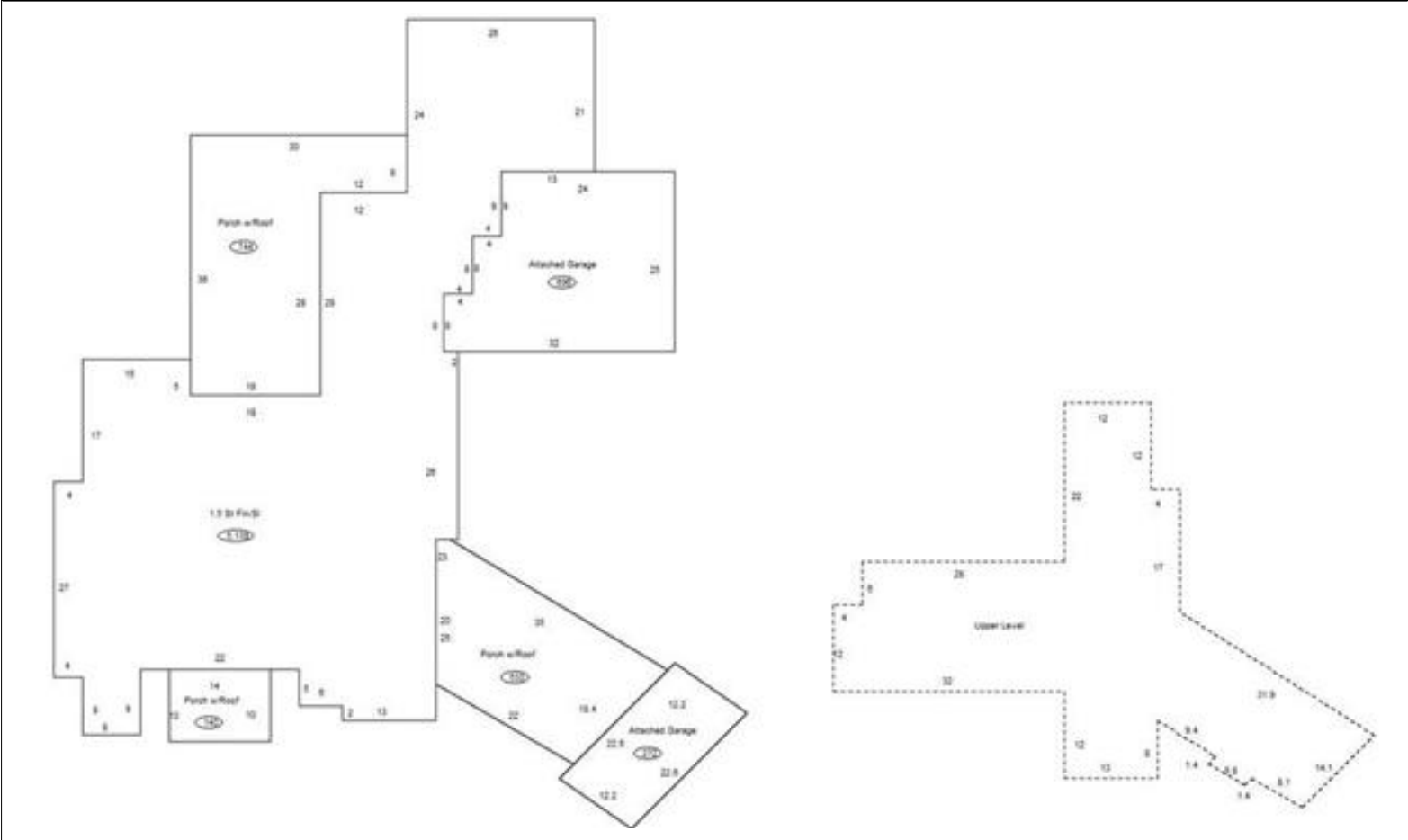

Sketch Vector Information

Sequence	Code	Type	Built Over	Scale	Section Label	Base Area	Multiplier	Total Area
1	R	5	Slab	13	1.5 St Fin/SI	3,451	1.489	5,139
2	U	^UL	Overhang	13	Upper Level	1,688	1.000	1,688
3	G	1		13	Attached Garage	696	1.000	696
4	M	PRCH		13	SLBC	744	1.000	744
5	M	PRCH		13	SLBC	533	1.000	533
6	G	1		13	Attached Garage	272	1.000	272
7	M	PRCH		13	SLBC	140	1.000	140
Total Building Area						3,451		5,139



Rogers



Assessment Property Record Card for Tax Year 2026

Data provided by LISA DELOZIER County Assessor

Date 04/18/2026
 Time 06:56:21
 Page 4

660091197

Outbuildings/Site Improvements

Building Image	Code	Description	Dimensions	Floor	Roofing	Total Units
	SG	SWIM-GUNITE	0x0x0			1
	Qual 5	Cond 5	Year 2011	Eff Age		
	Valuation Summary Base Cost (30,000.00 x 1) 30,000		Modifier Total	RCN 30,000	Depr (1% Phys/ % Func) 300	RCNLD 29,700
	UTIL	SHOP BUILDING	0x0x0			2,400
	Qual 2	Cond 3	Year	Eff Age		
	Valuation Summary Base Cost (25.84 x 2,400) 62,016		Modifier Total	RCN 62,016	Depr (1% Phys/ % Func) 620	RCNLD 61,396