



Rogers

Assessment Property Record Card for Tax Year 2026

Data provided by LISA DELOZIER County Assessor

Date 04/17/2026
 Time 17:14:37
 Page 1

Assessment Data					Primary Image																																																																																																																				
Account 660091329 Parcel ID 000000-00-0-00151-003-0007 Cadastral ID 31-22-16-02670 Property Type REAL - Real Property Property Class RRP VI Area 1 Tax Area 10 - OOLOGAH RURAL/NW FIRE Name ID 348558 FRENETTE FAMILY REVOCABLE TRUST 10085 RATLIFF DR CLAREMORE OK 74017-0000 Parcel Location Situs 10085 E RATLIFF DR Subdivision CEDAR SPRINGS Lot/Block 0007 / 0003 Parcel Size 2 - Lots Sec/Twn/Rng 31 / 22 / 16 / 5 Neighborhood 1114 - R-V01,4-NW OOLOGAH School District S004 - OOLOGAH SCHOOLS																																																																																																																									
Legal Description Lat/Long: 36.34824707 -95.64896193																																																																																																																									
LOT 6 & 7 BLOCK 3 CEDAR SPRINGS					Building Permits <table border="1"> <thead> <tr> <th>Number</th> <th>Description</th> <th>Opened</th> <th>Closed</th> <th>Amount</th> </tr> </thead> <tbody> <tr> <td>R25 013</td> <td>NEW DTCH ACC BLDG 40X60</td> <td>01/2025</td> <td>10/2025</td> <td>60,000</td> </tr> <tr> <td>WP 2016 11 13R18-</td> <td>NEW POOL</td> <td>11/2016</td> <td>12/2016</td> <td>27,000</td> </tr> <tr> <td>R2016 05 9</td> <td>R17-NEW 3150 SQ FT SFR</td> <td>05/2016</td> <td>12/2016</td> <td>299,465</td> </tr> </tbody> </table>					Number	Description	Opened	Closed	Amount	R25 013	NEW DTCH ACC BLDG 40X60	01/2025	10/2025	60,000	WP 2016 11 13R18-	NEW POOL	11/2016	12/2016	27,000	R2016 05 9	R17-NEW 3150 SQ FT SFR	05/2016	12/2016	299,465																																																																																												
Number	Description	Opened	Closed	Amount																																																																																																																					
R25 013	NEW DTCH ACC BLDG 40X60	01/2025	10/2025	60,000																																																																																																																					
WP 2016 11 13R18-	NEW POOL	11/2016	12/2016	27,000																																																																																																																					
R2016 05 9	R17-NEW 3150 SQ FT SFR	05/2016	12/2016	299,465																																																																																																																					
Exemptions <table border="1"> <thead> <tr> <th>Code</th> <th>Type</th> <th>Active</th> <th>Maximum</th> <th>Exemption</th> </tr> </thead> <tbody> <tr> <td>H</td> <td>Homestead</td> <td>Yes</td> <td>1,000</td> <td>1,000</td> </tr> </tbody> </table>					Code	Type	Active	Maximum	Exemption	H	Homestead	Yes	1,000	1,000	Sale History <table border="1"> <thead> <tr> <th>Bk/Pg</th> <th>Grantor</th> <th>Date</th> <th>Price</th> <th>Code</th> </tr> </thead> <tbody> <tr> <td>/</td> <td>FRENETTE, DAN & ANN</td> <td>10/08/2025</td> <td>0</td> <td>4</td> </tr> <tr> <td>/</td> <td>SHIRES, NATHAN D &</td> <td>04/10/2024</td> <td>600,000</td> <td>WG</td> </tr> <tr> <td>/</td> <td>BISCEGLIA, JEREMY & ERINN &</td> <td>10/31/2018</td> <td>358,000</td> <td>YES</td> </tr> <tr> <td>2548/196</td> <td>CLEAR CREEK LAND &</td> <td>05/06/2016</td> <td>36,500</td> <td>17</td> </tr> </tbody> </table>					Bk/Pg	Grantor	Date	Price	Code	/	FRENETTE, DAN & ANN	10/08/2025	0	4	/	SHIRES, NATHAN D &	04/10/2024	600,000	WG	/	BISCEGLIA, JEREMY & ERINN &	10/31/2018	358,000	YES	2548/196	CLEAR CREEK LAND &	05/06/2016	36,500	17																																																																													
Code	Type	Active	Maximum	Exemption																																																																																																																					
H	Homestead	Yes	1,000	1,000																																																																																																																					
Bk/Pg	Grantor	Date	Price	Code																																																																																																																					
/	FRENETTE, DAN & ANN	10/08/2025	0	4																																																																																																																					
/	SHIRES, NATHAN D &	04/10/2024	600,000	WG																																																																																																																					
/	BISCEGLIA, JEREMY & ERINN &	10/31/2018	358,000	YES																																																																																																																					
2548/196	CLEAR CREEK LAND &	05/06/2016	36,500	17																																																																																																																					
Parcel Valuation <table border="1"> <thead> <tr> <th>Source</th> <th>REAL</th> <th>Fair Cash</th> <th>Capped</th> <th>Asmnt Level</th> <th>Assessed</th> <th>Levy Rate</th> <th>108.182</th> <th>Current Tax</th> </tr> </thead> <tbody> <tr> <td>Remove Cap</td> <td>2025</td> <td>Land Value 131,003</td> <td>131,003</td> <td>11%</td> <td>14,410</td> <td>Assessed</td> <td>80,938</td> <td>8,756.00</td> </tr> <tr> <td>Year Frozen</td> <td>0</td> <td>Improvements 604,797</td> <td>604,797</td> <td></td> <td>66,528</td> <td>Penalty</td> <td>0</td> <td></td> </tr> <tr> <td>Uncapped Value</td> <td>122,564</td> <td>Mobile Home 0</td> <td>0</td> <td></td> <td>0</td> <td>Exemption</td> <td>1,000</td> <td>-94.00</td> </tr> <tr> <td>TIF Project ID</td> <td>0</td> <td>Total Value 735,800</td> <td>735,800</td> <td></td> <td>80,938</td> <td>Total Taxable</td> <td>79,938</td> <td>8,662.00</td> </tr> </tbody> </table>										Source	REAL	Fair Cash	Capped	Asmnt Level	Assessed	Levy Rate	108.182	Current Tax	Remove Cap	2025	Land Value 131,003	131,003	11%	14,410	Assessed	80,938	8,756.00	Year Frozen	0	Improvements 604,797	604,797		66,528	Penalty	0		Uncapped Value	122,564	Mobile Home 0	0		0	Exemption	1,000	-94.00	TIF Project ID	0	Total Value 735,800	735,800		80,938	Total Taxable	79,938	8,662.00																																																																			
Source	REAL	Fair Cash	Capped	Asmnt Level	Assessed	Levy Rate	108.182	Current Tax																																																																																																																	
Remove Cap	2025	Land Value 131,003	131,003	11%	14,410	Assessed	80,938	8,756.00																																																																																																																	
Year Frozen	0	Improvements 604,797	604,797		66,528	Penalty	0																																																																																																																		
Uncapped Value	122,564	Mobile Home 0	0		0	Exemption	1,000	-94.00																																																																																																																	
TIF Project ID	0	Total Value 735,800	735,800		80,938	Total Taxable	79,938	8,662.00																																																																																																																	
Assessment History <table border="1"> <thead> <tr> <th>Tax Year</th> <th>Statement Number</th> <th>Billed Owner</th> <th>Tax Area</th> <th>Total Value</th> <th>Exemptions</th> <th>Taxable Value</th> <th>Billed Tax</th> </tr> </thead> <tbody> <tr><td>2025</td><td>2025-660091329</td><td>FRENETTE, DAN & ANN</td><td>10</td><td>600,000</td><td>1000</td><td>65,000</td><td>7,046.00</td></tr> <tr><td>2024</td><td>2024-660091329</td><td>FRENETTE, DAN & ANN</td><td>10</td><td>574,559</td><td>0</td><td>49,086</td><td>5,141.00</td></tr> <tr><td>2023</td><td>2023-660091329</td><td>SHIRES, GURPREET K &</td><td>10</td><td>441,323</td><td>0</td><td>46,749</td><td>4,861.00</td></tr> <tr><td>2022</td><td>2022-660091329</td><td>SHIRES, GURPREET K &</td><td>10</td><td>431,194</td><td>0</td><td>44,523</td><td>4,609.00</td></tr> <tr><td>2021</td><td>2021-660091329</td><td>SHIRES, GURPREET K &</td><td>10</td><td>385,477</td><td>0</td><td>42,402</td><td>4,421.00</td></tr> <tr><td>2020</td><td>2020-660091329</td><td>SHIRES, GURPREET K &</td><td>10</td><td>378,960</td><td>0</td><td>41,495</td><td>4,389.00</td></tr> <tr><td>2019</td><td>2019-660091329</td><td>SHIRES, GURPREET K &</td><td>10</td><td>359,263</td><td>0</td><td>39,519</td><td>4,102.00</td></tr> <tr><td>2018</td><td>2018-660091329</td><td>BISCEGLIA, JEREMY & ERINN &</td><td>10</td><td>436,298</td><td>1000</td><td>46,993</td><td>5,061.00</td></tr> <tr><td>2017</td><td>2017-660091329</td><td>BISCEGLIA, JEREMY & ERINN &</td><td>10</td><td>431,805</td><td>1000</td><td>46,499</td><td>5,301.00</td></tr> <tr><td>2016</td><td>2016-660091329</td><td>BISCEGLIA, JEREMY & ERINN &</td><td>10</td><td>150</td><td>0</td><td>17</td><td>2.00</td></tr> <tr><td>2015</td><td>2015-660091329</td><td>CLEAR CREEK LAND &</td><td>10</td><td>150</td><td>0</td><td>17</td><td>1.00</td></tr> <tr><td>2014</td><td>2014-660091329</td><td>CLEAR CREEK LAND &</td><td>10</td><td>150</td><td>0</td><td>17</td><td>1.00</td></tr> <tr><td>2013</td><td>2013-660091329</td><td>CLEAR CREEK LAND &</td><td>10</td><td>150</td><td>0</td><td>17</td><td>1.00</td></tr> </tbody> </table>										Tax Year	Statement Number	Billed Owner	Tax Area	Total Value	Exemptions	Taxable Value	Billed Tax	2025	2025-660091329	FRENETTE, DAN & ANN	10	600,000	1000	65,000	7,046.00	2024	2024-660091329	FRENETTE, DAN & ANN	10	574,559	0	49,086	5,141.00	2023	2023-660091329	SHIRES, GURPREET K &	10	441,323	0	46,749	4,861.00	2022	2022-660091329	SHIRES, GURPREET K &	10	431,194	0	44,523	4,609.00	2021	2021-660091329	SHIRES, GURPREET K &	10	385,477	0	42,402	4,421.00	2020	2020-660091329	SHIRES, GURPREET K &	10	378,960	0	41,495	4,389.00	2019	2019-660091329	SHIRES, GURPREET K &	10	359,263	0	39,519	4,102.00	2018	2018-660091329	BISCEGLIA, JEREMY & ERINN &	10	436,298	1000	46,993	5,061.00	2017	2017-660091329	BISCEGLIA, JEREMY & ERINN &	10	431,805	1000	46,499	5,301.00	2016	2016-660091329	BISCEGLIA, JEREMY & ERINN &	10	150	0	17	2.00	2015	2015-660091329	CLEAR CREEK LAND &	10	150	0	17	1.00	2014	2014-660091329	CLEAR CREEK LAND &	10	150	0	17	1.00	2013	2013-660091329	CLEAR CREEK LAND &	10	150	0	17	1.00
Tax Year	Statement Number	Billed Owner	Tax Area	Total Value	Exemptions	Taxable Value	Billed Tax																																																																																																																		
2025	2025-660091329	FRENETTE, DAN & ANN	10	600,000	1000	65,000	7,046.00																																																																																																																		
2024	2024-660091329	FRENETTE, DAN & ANN	10	574,559	0	49,086	5,141.00																																																																																																																		
2023	2023-660091329	SHIRES, GURPREET K &	10	441,323	0	46,749	4,861.00																																																																																																																		
2022	2022-660091329	SHIRES, GURPREET K &	10	431,194	0	44,523	4,609.00																																																																																																																		
2021	2021-660091329	SHIRES, GURPREET K &	10	385,477	0	42,402	4,421.00																																																																																																																		
2020	2020-660091329	SHIRES, GURPREET K &	10	378,960	0	41,495	4,389.00																																																																																																																		
2019	2019-660091329	SHIRES, GURPREET K &	10	359,263	0	39,519	4,102.00																																																																																																																		
2018	2018-660091329	BISCEGLIA, JEREMY & ERINN &	10	436,298	1000	46,993	5,061.00																																																																																																																		
2017	2017-660091329	BISCEGLIA, JEREMY & ERINN &	10	431,805	1000	46,499	5,301.00																																																																																																																		
2016	2016-660091329	BISCEGLIA, JEREMY & ERINN &	10	150	0	17	2.00																																																																																																																		
2015	2015-660091329	CLEAR CREEK LAND &	10	150	0	17	1.00																																																																																																																		
2014	2014-660091329	CLEAR CREEK LAND &	10	150	0	17	1.00																																																																																																																		
2013	2013-660091329	CLEAR CREEK LAND &	10	150	0	17	1.00																																																																																																																		



Rogers

Assessment Property Record Card for Tax Year 2026

Data provided by LISA DELOZIER County Assessor

Date 04/17/2026
 Time 17:14:37
 Page 2

Lot Data		Square-Foot - NBHD 1114 #1
Lot Size		
Lot Count	0	
Units Buildable		
Non-Ag Acres	0	
Topography		
Street Access		
Utilities		
Amenities	LAND VALUE	0
		0
Method	Square-Foot	
Base Lot Value	117,239.00 x .76 = 88,626	
Factor Value		
Adjustments	1,4782	
Lot Value	131,003	



\\tsclient\T\TOMMY DUNLAP\New folder (115)\IMG_0102.JPG 11/23/2022

Residential Data	
Type	1 Single Family Residence
Condition	3 - Average
Quality	4 - Good
Architecture	
Style	66% 1 1/2 Story Finished 34% One Story
Exterior Wall	95% Veneer, Masonry 5% Veneer, Stone
Base/Total Area	2,703 / 3,223
Style	66% 1 1/2 Story Finished - 34% One Story
HVAC	100% Warmed & Cooled Air
Roof Cover	1 Composition Shingle
Area on Slab	2,703
Fixture/RghIn	16 /
Bed/F/H Bath	5 / 3.5 /
Basement Area	
Garage Type	1,139 Attached Garage - Unfinished
Remodel	
Year/Eff Age	2016 / 8

GRM Approach

GRM Code	
Gross Rent	0.00
Indicated Value	

Multiple Regression

MRA Code	1 Test
Adusted R	0.8445
Indicated Value	644,056 199.83 Per SqFt

Direct Comparables

Selection Model	A Adam Test
Adjustment Model	1 2022 Residential
Comparables	1
Indicated Value	261,620 Per SqFt

Value Reconciliation

Selected Approach	Cost Approach
Improvements	452,233
Lot Value	131,003
Indicated Value	583,236 180.96 Per SqFt
Agland Value	
Site Improvements	152,564
Total Value	735,800 228.30 Total Value Per SqFt

Cost Approach		Manual : 01/2025	
Base Cost	103.59	Total Misc Impr	+ 21,318
Roofing Adj	+ 4.81	Garage Cost	+ 51,733
Subfloor Adj	+ -3.75	Total RCN	= 491,558
Heat/Cool Adj	+ 16.31	Depreciation (8%)	- 39,325
Plumbing Adj	+ 8.89	Lump Sums	+ 0
Basement Adj	+ 0.00	RCNLD	= 452,233
Adj Base Cost	= 129.85	Lot Value	+ 131,003
Total Area	x 3,223	Indicated Value	= 583,236
Adjusted Cost	= 418,507	Value Per SqFt	180.96

Miscellaneous Improvements

Code	Description	Sketch ID	Size	Year	Units	Unit Cost	Depr	Value
PRCH	SLAB PORCH - COVERED	130564	128		128	32.70		4,186
PRCH	SLAB PORCH - COVERED	130567	66		66	32.99		2,177
PRCH	SLAB PORCH - COVERED	130568	16x15		240	32.13		7,711
FPR1	FIREPLACE - RESIDENTIAL 1 STORY		1		1	7,243.87		7,244



Rogers

Assessment Property Record Card for Tax Year 2026

Data provided by LISA DELOZIER County Assessor

Date 04/17/2026

Time 17:14:37

Page 3

Sketch Image

660091329

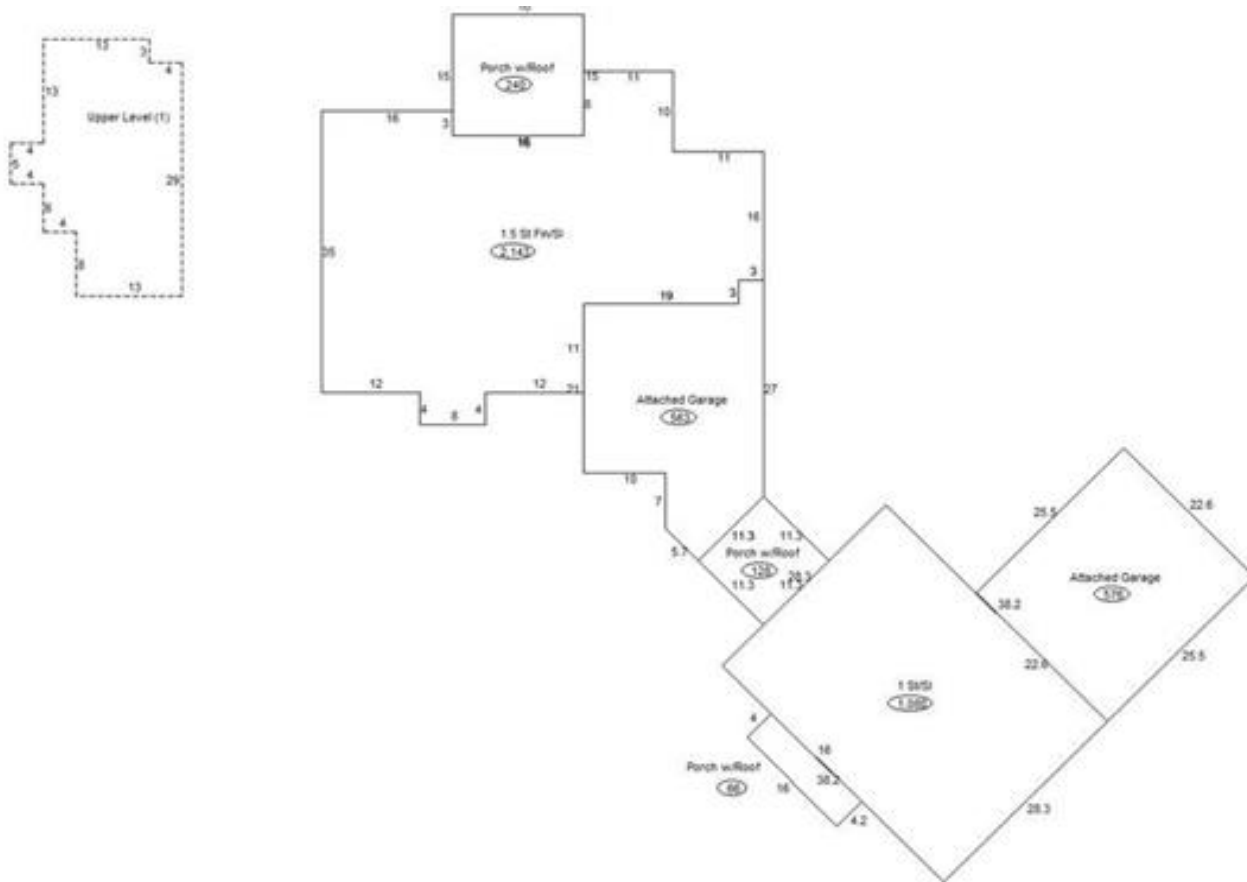

Sketch Vector Information

Sequence	Code	Type	Built Over	Scale	Section Label	Base Area	Multiplier	Total Area
1	R	5	Slab	13	1.5 St Fin/SI	1,623	1.320	2,143
2	U	^UL		13	Upper Level (1)	520	1.000	520
3	G	1		13	Attached Garage	563	1.000	563
4	M	PRCH		13	SLBC	128	1.000	128
5	R	1	Slab	13	1 St/SI	1,080	1.000	1,080
6	G	1		13	Attached Garage	576	1.000	576
7	M	PRCH		13	SLBC	66	1.000	66
8	M	PRCH		13	SLBC	240	1.000	240
Total Building Area						2,703		3,223



Rogers

Assessment Property Record Card for Tax Year 2026

Data provided by LISA DELOZIER County Assessor

Date 04/17/2026

Time 17:14:37

Page 4

660091329

Outbuildings/Site Improvements

Building Image	Code	Description	Dimensions	Floor	Roofing	Total Units
	UTIL	Utility Building	40x60x12	Concrete	Composition Shingle	2,400
	Qual	4	Cond 3	Year 2025	Eff Age 1	
	Valuation Summary		Modifier Total	RCN	Depr (1% Phys/ % Func)	RCNLD
	Base Cost (35.35 x 2,400)		84,840	84,840	848	83,992
	PATC	Patio - Covered	10x76x10	Concrete	Composition Shingle	1,400
	Qual	3	Cond 3	Year 2025	Eff Age 1	
	Valuation Summary		Modifier Total	RCN	Depr (5% Phys/ % Func)	RCNLD
	Base Cost (14.30 x 1,400)		20,020	20,020	1,001	19,019
	GZBO	Gazebo	16x24x10	Concrete	Composition Shingle	384
	Qual	5	Cond 3	Year 2025	Eff Age 1	
	Valuation Summary		Modifier Total	RCN	Depr (5% Phys/ % Func)	RCNLD
	Base Cost (38.52 x 384)		14,792	14,792	740	14,052
	ODFP	ODFP	0x0x0	Concrete		1
	Qual	3	Cond 3	Year 2025	Eff Age 1	
	Valuation Summary		Modifier Total	RCN	Depr (6% Phys/ % Func)	RCNLD
	Base Cost (2,751.55 x 1)		2,752	2,752	165	2,587
	ODRK	ODRK	0x0x0	Concrete		1
	Qual	3	Cond 3	Year 2025	Eff Age 1	
	Valuation Summary		Modifier Total	RCN	Depr (6% Phys/ % Func)	RCNLD
	Base Cost (3,100.00 x 1)		3,100	3,100	186	2,914
	SG	SWIM-GUNITE	0x0x0			1
	Qual		Cond	Year 2016	Eff Age	
	Valuation Summary		Modifier Total	RCN	Depr (0% Phys/ % Func)	RCNLD
	Base Cost (30,000.00 x 1)		30,000	30,000		30,000