



Rogers

Assessment Property Record Card for Tax Year 2026

Data provided by LISA DELOZIER County Assessor

Date 04/18/2026
Time 08:02:41
Page 1

Assessment Data					Primary Image																																																																																																																				
Account 660091355 Parcel ID 000000-00-0-00745-001-0004 Cadastral ID 13-21-15-04730 Property Type REAL - Real Property Property Class RRP VI Area 4 Tax Area 18 - CLAREMORE RURAL/W/O FIRE Name ID 308403 MARLOW, JANICE L TRUST 9175 E PAMELA RD CLAREMORE OK 74019-0000 Parcel Location Situs 09175 E PAMELA RD Subdivision SHILOH ESTATES III Lot/Block 0004 / 0001 Parcel Size 1 - Lots Sec/Twn/Rng 13 / 21 / 15 / 5 Neighborhood 1089 - R-V03,4-SE CLAREMORE School District S001 - CLAREMORE SCHOOLS					<p>\\tsclient\C\Users\Randy Necessary\Pictures\101_0805\IMG_0013. 8/5/2022</p>																																																																																																																				
Legal Description Lat/Long: 36.30700720 -95.66508929																																																																																																																									
Legal Description LOT 4 BLOCK 1 SHILOH ESTATES III.					Building Permits																																																																																																																				
					<table border="1"> <thead> <tr> <th>Number</th> <th>Description</th> <th>Opened</th> <th>Closed</th> <th>Amount</th> </tr> </thead> <tbody> <tr> <td>R2012 06 3</td> <td>R13-NEW 1463 SQ FT SFR</td> <td>06/2012</td> <td>09/2012</td> <td>100,000</td> </tr> </tbody> </table>					Number	Description	Opened	Closed	Amount	R2012 06 3	R13-NEW 1463 SQ FT SFR	06/2012	09/2012	100,000																																																																																																						
Number	Description	Opened	Closed	Amount																																																																																																																					
R2012 06 3	R13-NEW 1463 SQ FT SFR	06/2012	09/2012	100,000																																																																																																																					
Exemptions					Sale History																																																																																																																				
<table border="1"> <thead> <tr> <th>Code</th> <th>Type</th> <th>Active</th> <th>Maximum</th> <th>Exemption</th> </tr> </thead> <tbody> <tr> <td>H</td> <td>Homestead</td> <td>Yes</td> <td>1,000</td> <td>1,000</td> </tr> </tbody> </table>					Code	Type	Active	Maximum	Exemption	H	Homestead	Yes	1,000	1,000	<table border="1"> <thead> <tr> <th>Bk/Pg</th> <th>Grantor</th> <th>Date</th> <th>Price</th> <th>Code</th> </tr> </thead> <tbody> <tr> <td>2589/840</td> <td>MARLOW, JANICE L</td> <td>10/28/2016</td> <td>0</td> <td>4</td> </tr> <tr> <td>2280/91</td> <td>DAKE PROPERTIES INC</td> <td>10/19/2012</td> <td>141,000</td> <td>YES</td> </tr> <tr> <td>2254/712</td> <td>J D BASLER AND ASSOCIATES, INC</td> <td>06/29/2012</td> <td>72,000</td> <td>18</td> </tr> </tbody> </table>					Bk/Pg	Grantor	Date	Price	Code	2589/840	MARLOW, JANICE L	10/28/2016	0	4	2280/91	DAKE PROPERTIES INC	10/19/2012	141,000	YES	2254/712	J D BASLER AND ASSOCIATES, INC	06/29/2012	72,000	18																																																																																		
Code	Type	Active	Maximum	Exemption																																																																																																																					
H	Homestead	Yes	1,000	1,000																																																																																																																					
Bk/Pg	Grantor	Date	Price	Code																																																																																																																					
2589/840	MARLOW, JANICE L	10/28/2016	0	4																																																																																																																					
2280/91	DAKE PROPERTIES INC	10/19/2012	141,000	YES																																																																																																																					
2254/712	J D BASLER AND ASSOCIATES, INC	06/29/2012	72,000	18																																																																																																																					
Parcel Valuation																																																																																																																									
<table border="1"> <thead> <tr> <th>Source</th> <th>REAL</th> <th>Fair Cash</th> <th>Capped</th> <th>Asmnt Level</th> <th>Assessed</th> <th>Levy Rate</th> <th>92.430</th> <th>Current Tax</th> </tr> </thead> <tbody> <tr> <td>Remove Cap</td> <td>2013</td> <td>Land Value 32,151</td> <td>22,106</td> <td>11%</td> <td>2,432</td> <td>Assessed</td> <td>16,332</td> <td>1,509.57</td> </tr> <tr> <td>Year Frozen</td> <td>2016</td> <td>Improvements 183,777</td> <td>126,362</td> <td></td> <td>13,900</td> <td>Penalty</td> <td>0</td> <td></td> </tr> <tr> <td>Uncapped Value</td> <td>0</td> <td>Mobile Home 0</td> <td>0</td> <td></td> <td>0</td> <td>Exemption</td> <td>1,000</td> <td>-93.00</td> </tr> <tr> <td>TIF Project ID</td> <td>0</td> <td>Total Value 215,928</td> <td>148,468</td> <td></td> <td>16,332</td> <td>Total Taxable</td> <td>15,332</td> <td>1,417.00</td> </tr> </tbody> </table>		Source	REAL	Fair Cash	Capped	Asmnt Level	Assessed	Levy Rate	92.430	Current Tax	Remove Cap	2013	Land Value 32,151	22,106	11%	2,432	Assessed	16,332	1,509.57	Year Frozen	2016	Improvements 183,777	126,362		13,900	Penalty	0		Uncapped Value	0	Mobile Home 0	0		0	Exemption	1,000	-93.00	TIF Project ID	0	Total Value 215,928	148,468		16,332	Total Taxable	15,332	1,417.00																																																																											
Source	REAL	Fair Cash	Capped	Asmnt Level	Assessed	Levy Rate	92.430	Current Tax																																																																																																																	
Remove Cap	2013	Land Value 32,151	22,106	11%	2,432	Assessed	16,332	1,509.57																																																																																																																	
Year Frozen	2016	Improvements 183,777	126,362		13,900	Penalty	0																																																																																																																		
Uncapped Value	0	Mobile Home 0	0		0	Exemption	1,000	-93.00																																																																																																																	
TIF Project ID	0	Total Value 215,928	148,468		16,332	Total Taxable	15,332	1,417.00																																																																																																																	
Assessment History																																																																																																																									
<table border="1"> <thead> <tr> <th>Tax Year</th> <th>Statement Number</th> <th>Billed Owner</th> <th>Tax Area</th> <th>Total Value</th> <th>Exemptions</th> <th>Taxable Value</th> <th>Billed Tax</th> </tr> </thead> <tbody> <tr><td>2025</td><td>2025-660091355</td><td>MARLOW, JANICE L</td><td>18</td><td>210,464</td><td>1000</td><td>15,332</td><td>1,417.00</td></tr> <tr><td>2024</td><td>2024-660091355</td><td>MARLOW, JANICE L</td><td>18</td><td>235,312</td><td>1000</td><td>15,331</td><td>1,417.00</td></tr> <tr><td>2023</td><td>2023-660091355</td><td>MARLOW, JANICE L</td><td>18</td><td>184,982</td><td>1000</td><td>15,331</td><td>1,404.00</td></tr> <tr><td>2022</td><td>2022-660091355</td><td>MARLOW, JANICE L</td><td>18</td><td>184,974</td><td>1000</td><td>15,331</td><td>1,419.00</td></tr> <tr><td>2021</td><td>2021-660091355</td><td>MARLOW, JANICE L</td><td>18</td><td>158,567</td><td>1000</td><td>15,332</td><td>1,354.00</td></tr> <tr><td>2020</td><td>2020-660091355</td><td>MARLOW, JANICE L</td><td>18</td><td>157,406</td><td>1000</td><td>15,332</td><td>1,404.00</td></tr> <tr><td>2019</td><td>2019-660091355</td><td>MARLOW, JANICE L</td><td>18</td><td>149,774</td><td>1000</td><td>15,331</td><td>1,420.00</td></tr> <tr><td>2018</td><td>2018-660091355</td><td>MARLOW, JANICE L</td><td>18</td><td>153,515</td><td>1000</td><td>15,332</td><td>1,417.00</td></tr> <tr><td>2017</td><td>2017-660091355</td><td>MARLOW, JANICE L</td><td>18</td><td>152,292</td><td>1000</td><td>15,332</td><td>1,406.00</td></tr> <tr><td>2016</td><td>2016-660091355</td><td>MARLOW, JANICE L</td><td>18</td><td>148,468</td><td>1000</td><td>15,331</td><td>1,437.00</td></tr> <tr><td>2015</td><td>2015-660091355</td><td>MARLOW, JANICE L</td><td>18</td><td>144,264</td><td>1000</td><td>14,869</td><td>1,339.00</td></tr> <tr><td>2014</td><td>2014-660091355</td><td>MARLOW, JANICE L</td><td>18</td><td>146,649</td><td>1000</td><td>15,131</td><td>1,403.00</td></tr> <tr><td>2013</td><td>2013-660091355</td><td>MARLOW, JANICE L</td><td>18</td><td>143,757</td><td>1000</td><td>14,813</td><td>1,356.00</td></tr> </tbody> </table>										Tax Year	Statement Number	Billed Owner	Tax Area	Total Value	Exemptions	Taxable Value	Billed Tax	2025	2025-660091355	MARLOW, JANICE L	18	210,464	1000	15,332	1,417.00	2024	2024-660091355	MARLOW, JANICE L	18	235,312	1000	15,331	1,417.00	2023	2023-660091355	MARLOW, JANICE L	18	184,982	1000	15,331	1,404.00	2022	2022-660091355	MARLOW, JANICE L	18	184,974	1000	15,331	1,419.00	2021	2021-660091355	MARLOW, JANICE L	18	158,567	1000	15,332	1,354.00	2020	2020-660091355	MARLOW, JANICE L	18	157,406	1000	15,332	1,404.00	2019	2019-660091355	MARLOW, JANICE L	18	149,774	1000	15,331	1,420.00	2018	2018-660091355	MARLOW, JANICE L	18	153,515	1000	15,332	1,417.00	2017	2017-660091355	MARLOW, JANICE L	18	152,292	1000	15,332	1,406.00	2016	2016-660091355	MARLOW, JANICE L	18	148,468	1000	15,331	1,437.00	2015	2015-660091355	MARLOW, JANICE L	18	144,264	1000	14,869	1,339.00	2014	2014-660091355	MARLOW, JANICE L	18	146,649	1000	15,131	1,403.00	2013	2013-660091355	MARLOW, JANICE L	18	143,757	1000	14,813	1,356.00
Tax Year	Statement Number	Billed Owner	Tax Area	Total Value	Exemptions	Taxable Value	Billed Tax																																																																																																																		
2025	2025-660091355	MARLOW, JANICE L	18	210,464	1000	15,332	1,417.00																																																																																																																		
2024	2024-660091355	MARLOW, JANICE L	18	235,312	1000	15,331	1,417.00																																																																																																																		
2023	2023-660091355	MARLOW, JANICE L	18	184,982	1000	15,331	1,404.00																																																																																																																		
2022	2022-660091355	MARLOW, JANICE L	18	184,974	1000	15,331	1,419.00																																																																																																																		
2021	2021-660091355	MARLOW, JANICE L	18	158,567	1000	15,332	1,354.00																																																																																																																		
2020	2020-660091355	MARLOW, JANICE L	18	157,406	1000	15,332	1,404.00																																																																																																																		
2019	2019-660091355	MARLOW, JANICE L	18	149,774	1000	15,331	1,420.00																																																																																																																		
2018	2018-660091355	MARLOW, JANICE L	18	153,515	1000	15,332	1,417.00																																																																																																																		
2017	2017-660091355	MARLOW, JANICE L	18	152,292	1000	15,332	1,406.00																																																																																																																		
2016	2016-660091355	MARLOW, JANICE L	18	148,468	1000	15,331	1,437.00																																																																																																																		
2015	2015-660091355	MARLOW, JANICE L	18	144,264	1000	14,869	1,339.00																																																																																																																		
2014	2014-660091355	MARLOW, JANICE L	18	146,649	1000	15,131	1,403.00																																																																																																																		
2013	2013-660091355	MARLOW, JANICE L	18	143,757	1000	14,813	1,356.00																																																																																																																		



Rogers

Assessment Property Record Card for Tax Year 2026

Data provided by LISA DELOZIER County Assessor

Date 04/18/2026
 Time 08:02:41
 Page 2

Lot Data		Square-Foot - NBHD 1089 #1	
Lot Size			
Lot Count			
Units Buildable	1		
Non-Ag Acres	0.509		
Topography			
Street Access			
Utilities			
Amenities	LAND QUALITY	0	0
Method	Square-Foot		
Base Lot Value	22,173.00 x 1.45 = 32,151		
Factor Value			
Adjustments	1.0000		
Lot Value	32,151		



\\tsclient\C\Users\Randy Necessary\Pictures\101_0805\IMG_0013. 8/5/2022

Residential Data	
Type	1 Single Family Residence
Condition	3 - Average
Quality	2.5 - Fair
Architecture	
Style	100% One Story
Exterior Wall	80% Veneer, Masonry 20% Frame, Siding, Wood
Base/Total Area	1,464 / 1,464
Style	100% One Story
HVAC	100% Warmed & Cooled Air
Roof Cover	1 Composition Shingle
Area on Slab	1,464
Fixture/RghIn	11 /
Bed/F/H Bath	3 / 2.0 /
Basement Area	
Garage Type	440 Attached Garage - Unfinished
Remodel	
Year/Eff Age	2012 / 11

GRM Approach	
GRM Code	
Gross Rent	0.00
Indicated Value	

Multiple Regression			
MRA Code	1	Test	
Adjusted R	0.8445		
Indicated Value	195,023	133.21	Per SqFt

Direct Comparables	
Selection Model	A Adam Test
Adjustment Model	1 2022 Residential
Comparables	4
Indicated Value	180,080 Per SqFt

Cost Approach				Manual : 01/2025			
Base Cost	105.80	Total Misc Impr	+ 5,665				
Roofing Adj	+ 4.55	Garage Cost	+ 12,487				
Subfloor Adj	+ -1.18	Total RCN	= 208,838				
Heat/Cool Adj	+ 11.47	Depreciation (12%)	- 25,061				
Plumbing Adj	+ 9.61	Lump Sums	+ 0				
Basement Adj	+ 0.00	RCNLD	= 183,777				
Adj Base Cost	= 130.25	Lot Value	+ 32,151				
Total Area	x 1,464	Indicated Value	= 215,928				
Adjusted Cost	= 190,686	Value Per SqFt	147.49				

Value Reconciliation			
Selected Approach	Cost Approach		
Improvements	183,777		
Lot Value	32,151		
Indicated Value	215,928	147.49	Per SqFt
Agland Value			
Site Improvements			
Total Value	215,928	147.49	Total Value Per SqFt

Miscellaneous Improvements								
Code	Description	Sketch ID	Size	Year	Units	Unit Cost	Depr	Value
PRCH	SLAB PORCH - COVERED	115678	19x10		190	23.60		4,484
PRCH	SLAB PORCH - COVERED	115680	7x7		49	24.11		1,181



Rogers
Assessment Property Record Card for Tax Year 2026

Data provided by LISA DELOZIER County Assessor

Date 04/18/2026
 Time 08:02:41
 Page 3

Sketch Image

660091355

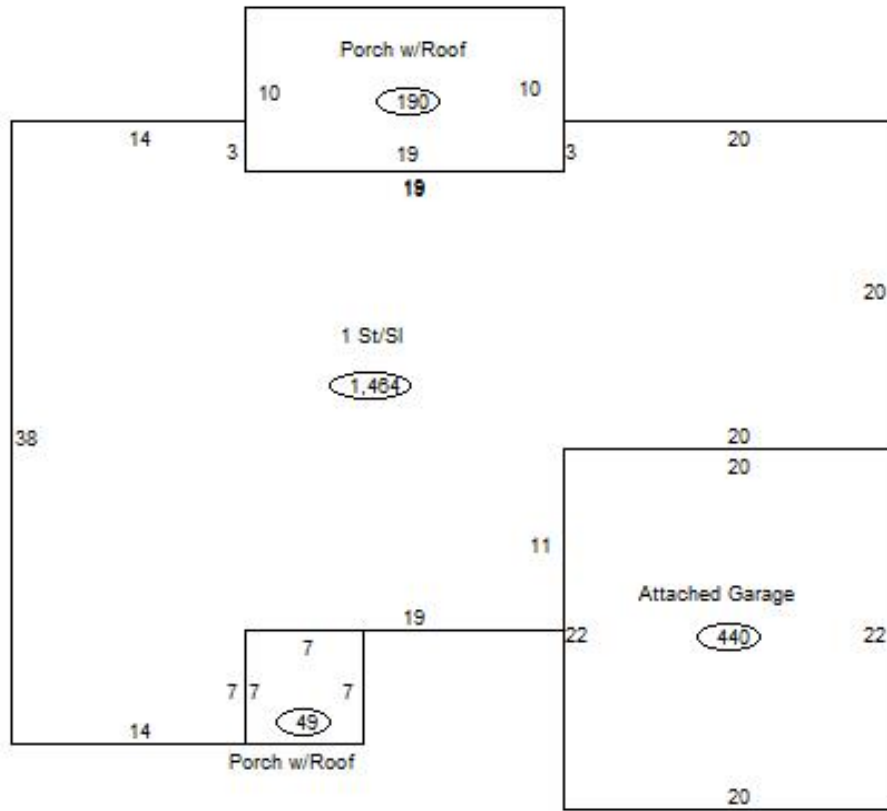

Sketch Vector Information

Sequence	Code	Type	Built Over	Scale	Section Label	Base Area	Multiplier	Total Area
1	R	1	Slab	13	1 St/Sl	1,464	1.000	1,464
2	M	PRCH		13	SLBC	190	1.000	190
3	G	1		13	Attached Garage	440	1.000	440
4	M	PRCH		13	SLBC	49	1.000	49
Total Building Area						1,464		1,464



Rogers

Assessment Property Record Card for Tax Year 2026

Data provided by LISA DELOZIER County Assessor

Date 04/18/2026
Time 08:02:41
Page 4

660091355

Outbuildings/Site Improvements

Building Image	Code	Description	Dimensions	Floor	Roofing	Total Units
	STF	STG FAIR	0x0x0			
	Qual	2	Cond 3	Year	Eff Age	1520
Valuation Summary		Modifier Total	RCN	Depr (100% Phys/ % Func)	RCNLD	
Base Cost (4.68 x)						