



Rogers

Assessment Property Record Card for Tax Year 2026

Data provided by LISA DELOZIER County Assessor

Date 04/18/2026
 Time 08:02:45
 Page 1

Assessment Data					Primary Image																																		
Account 660091357 Parcel ID 000000-00-0-00745-001-0006 Cadastral ID 13-21-15-04750 Property Type REAL - Real Property Property Class RRP VI Area 4 Tax Area 18 - CLAREMORE RURAL/W/O FIRE Name ID 322999 COPP'S ENTERPRISES INC 20085 S 4120 RD CLAREMORE OK 74019-0000 Parcel Location Situs 09145 E PAMELA RD Subdivision SHILOH ESTATES III Lot/Block 0006 / 0001 Parcel Size 1 - Lots Sec/Twn/Rng 13 / 21 / 15 / 5 Neighborhood 1089 - R-V03,4-SE CLAREMORE School District S001 - CLAREMORE SCHOOLS																																							
Legal Description Lot/Long: 36.30699890 -95.66592235																																							
Building Permits					<table border="1"> <thead> <tr> <th>Number</th> <th>Description</th> <th>Opened</th> <th>Closed</th> <th>Amount</th> </tr> </thead> <tbody> <tr> <td>R2014 08 20</td> <td>R15-NEW 1438 SQ FT SFR</td> <td>08/2014</td> <td>12/2014</td> <td>100,000</td> </tr> </tbody> </table>					Number	Description	Opened	Closed	Amount	R2014 08 20	R15-NEW 1438 SQ FT SFR	08/2014	12/2014	100,000																				
Number	Description	Opened	Closed	Amount																																			
R2014 08 20	R15-NEW 1438 SQ FT SFR	08/2014	12/2014	100,000																																			
Exemptions					Sale History																																		
<table border="1"> <thead> <tr> <th>Code</th> <th>Type</th> <th>Active</th> <th>Maximum</th> <th>Exemption</th> </tr> </thead> <tbody> <tr> <td colspan="5"> </td> </tr> </tbody> </table>					Code	Type	Active	Maximum	Exemption						<table border="1"> <thead> <tr> <th>Bk/Pg</th> <th>Grantor</th> <th>Date</th> <th>Price</th> <th>Code</th> </tr> </thead> <tbody> <tr> <td>2672/495</td> <td>STOUT HOLDINGS LLC</td> <td>10/31/2017</td> <td>140,000</td> <td>YES</td> </tr> <tr> <td>2480/889</td> <td>DAKE PROPERTIES INC</td> <td>06/23/2015</td> <td>140,000</td> <td>YES</td> </tr> <tr> <td>2420/42</td> <td>J D BASLER AND ASSOCIATES, INC</td> <td>08/15/2014</td> <td>18,000</td> <td>15</td> </tr> </tbody> </table>					Bk/Pg	Grantor	Date	Price	Code	2672/495	STOUT HOLDINGS LLC	10/31/2017	140,000	YES	2480/889	DAKE PROPERTIES INC	06/23/2015	140,000	YES	2420/42	J D BASLER AND ASSOCIATES, INC	08/15/2014	18,000	15
Code	Type	Active	Maximum	Exemption																																			
Bk/Pg	Grantor	Date	Price	Code																																			
2672/495	STOUT HOLDINGS LLC	10/31/2017	140,000	YES																																			
2480/889	DAKE PROPERTIES INC	06/23/2015	140,000	YES																																			
2420/42	J D BASLER AND ASSOCIATES, INC	08/15/2014	18,000	15																																			
Parcel Valuation																																							
Source	REAL		Fair Cash	Capped	Asmnt Level	Assessed	Levy Rate	92.430	Current Tax																														
Remove Cap	2018	Land Value	44,827	31,662	11%	3,483	Assessed	20,325	1,878.64																														
Year Frozen	0	Improvements	167,088	153,108		16,842	Penalty	0																															
Uncapped Value	0	Mobile Home	0	0		0	Exemption	0	0.00																														
TIF Project ID	0	Total Value	211,915	184,770		20,325	Total Taxable	20,325	1,879.00																														
Assessment History																																							
Tax Year	Statement Number	Billed Owner			Tax Area	Total Value	Exemptions	Taxable Value	Billed Tax																														
2025	2025-660091357	COPP'S ENTERPRISES INC			18	205,353	0	19,357	1,789.00																														
2024	2024-660091357	COPP'S ENTERPRISES INC			18	230,035	0	18,435	1,704.00																														
2023	2023-660091357	COPP'S ENTERPRISES INC			18	170,844	0	17,557	1,608.00																														
2022	2022-660091357	COPP'S ENTERPRISES INC			18	172,497	0	16,721	1,548.00																														
2021	2021-660091357	COPP'S ENTERPRISES INC			18	144,775	0	15,925	1,406.00																														
2020	2020-660091357	COPP'S ENTERPRISES INC			18	143,812	0	15,818	1,448.00																														
2019	2019-660091357	COPP'S ENTERPRISES INC			18	136,949	0	15,064	1,395.00																														
2018	2018-660091357	COPP'S ENTERPRISES INC			18	145,457	0	16,000	1,478.00																														
2017	2017-660091357	STOUT HOLDINGS LLC			18	150,631	0	16,569	1,520.00																														
2016	2016-660091357	STOUT HOLDINGS LLC			18	146,897	0	16,159	1,515.00																														
2015	2015-660091357	STOUT HOLDINGS LLC			18	60,658	0	6,673	601.00																														
2014	2014-660091357	DAKE PROPERTIES INC			18	9,523	0	1,048	97.00																														
2013	2013-660091357	J D BASLER AND ASSOCIATES, INC			18	9,523	0	1,048	96.00																														



Rogers

Assessment Property Record Card for Tax Year 2026

Data provided by LISA DELOZIER County Assessor

Date 04/18/2026
Time 08:02:45
Page 2

Lot Data		Square-Foot - NBHD 1089 #1		Primary Image				
Lot Size								
Lot Count								
Units Buildable	1							
Non-Ag Acres	0.7097							
Topography								
Street Access								
Utilities								
Amenities	LAND QUALITY	0	0					
Method	Square-Foot							
Base Lot Value	30,915.00 x 1.45 = 44,827							
Factor Value								
Adjustments	1.0000							
Lot Value	44,827							
Residential Data								
Type	1 Single Family Residence							
Condition	3 - Average							
Quality	2.5 - Fair							
Architecture								
Style	100% One Story							
Exterior Wall	20% Veneer, Masonry 80% Frame, Siding, Wood							
Base/Total Area	1,446 / 1,446							
Style	100% One Story							
HVAC	100% Warmed & Cooled Air							
Roof Cover	1 Composition Shingle							
Area on Slab	1,446							
Fixture/RghIn	11 /							
Bed/F/H Bath	3 / 2.0 /							
Basement Area								
Garage Type	462 Attached Garage - Unfinished							
Remodel								
Year/Eff Age	2014 / 9							
Cost Approach								
Manual : 01/2025								
Base Cost	100.79	Total Misc Impr	+	2,358				
Roofing Adj	+ 4.56	Garage Cost	+	12,931				
Subfloor Adj	+ -1.19	Total RCN	=	196,574				
Heat/Cool Adj	+ 11.47	Depreciation (15%)	-	29,486				
Plumbing Adj	+ 9.74	Lump Sums	+	0				
Basement Adj	+ 0.00	RCNLD	=	167,088				
Adj Base Cost	= 125.37	Lot Value	+	44,827				
Total Area	x 1,446	Indicated Value	=	211,915				
Adjusted Cost	= 181,285	Value Per SqFt		146.55				
GRM Approach								
GRM Code								
Gross Rent	0.00							
Indicated Value								
Multiple Regression								
MRA Code	1 Test							
Adusted R	0.8445							
Indicated Value	199,459	137.94	Per SqFt					
Direct Comparables								
Selection Model	A Adam Test							
Adjustment Model	1 2022 Residential							
Comparables	3							
Indicated Value	199,730	Per SqFt						
Value Reconciliation								
Selected Approach	Cost Approach							
Improvements	167,088							
Lot Value	44,827							
Indicated Value	211,915	146.55	Per SqFt					
Agland Value								
Site Improvements								
Total Value	211,915	146.55	Total Value Per SqFt					
Miscellaneous Improvements								
Code	Description	Sketch ID	Size	Year	Units	Unit Cost	Depr	Value
PRCH	SLAB PORCH - COVERED	121634	13x6		78	24.02		1,874
PRCH	SLAB PORCH - COVERED	121635	5x4		20	24.21		484

\\tsclient\C\Users\Randy Necessary\Pictures\101_0805\IMG_0011. 8/5/2022



Rogers

Assessment Property Record Card for Tax Year 2026

Data provided by LISA DELOZIER County Assessor

Date 04/18/2026

Time 08:02:45

Page 3

Sketch Image

660091357

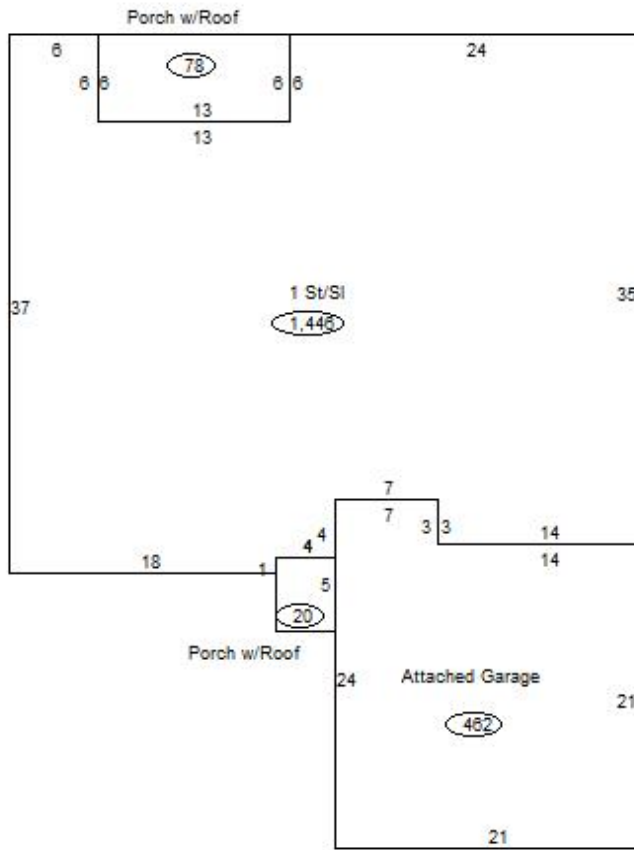

Sketch Vector Information

Sequence	Code	Type	Built Over	Scale	Section Label	Base Area	Multiplier	Total Area
1	R	1	Slab	13	1 St/Sl	1,446	1.000	1,446
2	G	1		13	Attached Garage	462	1.000	462
3	M	PRCH		13	SLBC	78	1.000	78
4	M	PRCH		13	SLBC	20	1.000	20
Total Building Area						1,446		1,446