



# Rogers

## Assessment Property Record Card for Tax Year 2026

Data provided by LISA DELOZIER County Assessor

Date 04/18/2026  
 Time 08:02:56  
 Page 1

Assessment Data					Primary Image																																																																																																																				
<b>Account</b> 660091363 <b>Parcel ID</b> 000000-00-0-00745-001-0012 <b>Cadastral ID</b> 13-21-15-04810 <b>Property Type</b> REAL - Real Property <b>Property Class</b> RRP VI Area 4 <b>Tax Area</b> 18 - CLAREMORE RURAL/W/O FIRE <b>Name ID</b> 334259 CASTRO, JOSE ANTONIO RODRIGUEZ & ABRIL JOCELIN DIAZ CABRERA  21142 S ANDREAS RD CLAREMORE OK 74019-0000  <b>Parcel Location</b> <b>Situs</b> 21142 S ANDREA'S RD <b>Subdivision</b> SHILOH ESTATES III <b>Lot/Block</b> 0012 / 0001 <b>Parcel Size</b> 1 - Lots <b>Sec/Twn/Rng</b> 13 / 21 / 15 / 5 <b>Neighborhood</b> 1089 - R-V03,4-SE CLAREMORE <b>School District</b> S001 - CLAREMORE SCHOOLS																																																																																																																									
<b>Legal Description</b> Lot/Long: 36.30529645 -95.66567075																																																																																																																									
<b>Building Permits</b>					<table border="1"> <thead> <tr> <th>Number</th> <th>Description</th> <th>Opened</th> <th>Closed</th> <th>Amount</th> </tr> </thead> <tbody> <tr> <td>R 2012 10 19 R14-NEW SFR 1490 SQ FT</td> <td></td> <td>10/2012</td> <td>03/2013</td> <td>100,000</td> </tr> </tbody> </table>					Number	Description	Opened	Closed	Amount	R 2012 10 19 R14-NEW SFR 1490 SQ FT		10/2012	03/2013	100,000																																																																																																						
Number	Description	Opened	Closed	Amount																																																																																																																					
R 2012 10 19 R14-NEW SFR 1490 SQ FT		10/2012	03/2013	100,000																																																																																																																					
<b>Exemptions</b>					<b>Sale History</b>																																																																																																																				
<table border="1"> <thead> <tr> <th>Code</th> <th>Type</th> <th>Active</th> <th>Maximum</th> <th>Exemption</th> </tr> </thead> <tbody> <tr> <td>H</td> <td>Homestead</td> <td>No</td> <td>1,000</td> <td></td> </tr> </tbody> </table>					Code	Type	Active	Maximum	Exemption	H	Homestead	No	1,000		<table border="1"> <thead> <tr> <th>Bk/Pg</th> <th>Grantor</th> <th>Date</th> <th>Price</th> <th>Code</th> </tr> </thead> <tbody> <tr> <td>/</td> <td>DEAL, KEATON ALEXANDER &amp; HENDRIX, LAURA E &amp; CRAIG A</td> <td>04/23/2021</td> <td>195,000</td> <td>YES</td> </tr> <tr> <td>2638/698</td> <td>HENDRIX, LAURA E &amp; CRAIG A</td> <td>04/14/2017</td> <td>153,000</td> <td>YES</td> </tr> <tr> <td>2341/130</td> <td>DAKE PROPERTIES INC</td> <td>07/09/2013</td> <td>145,000</td> <td>YES</td> </tr> <tr> <td>2286/874</td> <td>J D BASLER AND ASSOCIATES, INC</td> <td>11/05/2012</td> <td>18,000</td> <td>15</td> </tr> </tbody> </table>					Bk/Pg	Grantor	Date	Price	Code	/	DEAL, KEATON ALEXANDER & HENDRIX, LAURA E & CRAIG A	04/23/2021	195,000	YES	2638/698	HENDRIX, LAURA E & CRAIG A	04/14/2017	153,000	YES	2341/130	DAKE PROPERTIES INC	07/09/2013	145,000	YES	2286/874	J D BASLER AND ASSOCIATES, INC	11/05/2012	18,000	15																																																																													
Code	Type	Active	Maximum	Exemption																																																																																																																					
H	Homestead	No	1,000																																																																																																																						
Bk/Pg	Grantor	Date	Price	Code																																																																																																																					
/	DEAL, KEATON ALEXANDER & HENDRIX, LAURA E & CRAIG A	04/23/2021	195,000	YES																																																																																																																					
2638/698	HENDRIX, LAURA E & CRAIG A	04/14/2017	153,000	YES																																																																																																																					
2341/130	DAKE PROPERTIES INC	07/09/2013	145,000	YES																																																																																																																					
2286/874	J D BASLER AND ASSOCIATES, INC	11/05/2012	18,000	15																																																																																																																					
<b>Parcel Valuation</b>																																																																																																																									
<table border="1"> <thead> <tr> <th>Source</th> <th>REAL</th> <th>Fair Cash</th> <th>Capped</th> <th>Asmnt Level</th> <th>Assessed</th> <th>Levy Rate</th> <th>92.430</th> <th>Current Tax</th> </tr> </thead> <tbody> <tr> <td>Remove Cap</td> <td>2022</td> <td>Land Value 30,985</td> <td>30,985</td> <td>11%</td> <td>3,408</td> <td>Assessed</td> <td>24,114</td> <td>2,228.86</td> </tr> <tr> <td>Year Frozen</td> <td>0</td> <td>Improvements 188,237</td> <td>188,237</td> <td></td> <td>20,706</td> <td>Penalty</td> <td>0</td> <td></td> </tr> <tr> <td>Uncapped Value</td> <td>0</td> <td>Mobile Home 0</td> <td>0</td> <td></td> <td>0</td> <td>Exemption</td> <td>0</td> <td>0.00</td> </tr> <tr> <td>TIF Project ID</td> <td>0</td> <td>Total Value 219,222</td> <td>219,222</td> <td></td> <td>24,114</td> <td>Total Taxable</td> <td>24,114</td> <td>2,229.00</td> </tr> </tbody> </table>		Source	REAL	Fair Cash	Capped	Asmnt Level	Assessed	Levy Rate	92.430	Current Tax	Remove Cap	2022	Land Value 30,985	30,985	11%	3,408	Assessed	24,114	2,228.86	Year Frozen	0	Improvements 188,237	188,237		20,706	Penalty	0		Uncapped Value	0	Mobile Home 0	0		0	Exemption	0	0.00	TIF Project ID	0	Total Value 219,222	219,222		24,114	Total Taxable	24,114	2,229.00																																																																											
Source	REAL	Fair Cash	Capped	Asmnt Level	Assessed	Levy Rate	92.430	Current Tax																																																																																																																	
Remove Cap	2022	Land Value 30,985	30,985	11%	3,408	Assessed	24,114	2,228.86																																																																																																																	
Year Frozen	0	Improvements 188,237	188,237		20,706	Penalty	0																																																																																																																		
Uncapped Value	0	Mobile Home 0	0		0	Exemption	0	0.00																																																																																																																	
TIF Project ID	0	Total Value 219,222	219,222		24,114	Total Taxable	24,114	2,229.00																																																																																																																	
<b>Assessment History</b>																																																																																																																									
<table border="1"> <thead> <tr> <th>Tax Year</th> <th>Statement Number</th> <th>Billed Owner</th> <th>Tax Area</th> <th>Total Value</th> <th>Exemptions</th> <th>Taxable Value</th> <th>Billed Tax</th> </tr> </thead> <tbody> <tr><td>2025</td><td>2025-660091363</td><td>CASTRO, JOSE ANTONIO RODRIGUEZ &amp;</td><td>18</td><td>213,567</td><td>0</td><td>23,492</td><td>2,171.00</td></tr> <tr><td>2024</td><td>2024-660091363</td><td>CASTRO, JOSE ANTONIO RODRIGUEZ &amp;</td><td>18</td><td>238,334</td><td>0</td><td>22,523</td><td>2,082.00</td></tr> <tr><td>2023</td><td>2023-660091363</td><td>CASTRO, JOSE ANTONIO RODRIGUEZ &amp;</td><td>18</td><td>195,000</td><td>0</td><td>21,450</td><td>1,965.00</td></tr> <tr><td>2022</td><td>2022-660091363</td><td>CASTRO, JOSE ANTONIO RODRIGUEZ &amp;</td><td>18</td><td>195,000</td><td>0</td><td>21,450</td><td>1,986.00</td></tr> <tr><td>2021</td><td>2021-660091363</td><td>CASTRO, JOSE ANTONIO RODRIGUEZ &amp;</td><td>18</td><td>173,712</td><td>0</td><td>19,108</td><td>1,687.00</td></tr> <tr><td>2020</td><td>2020-660091363</td><td>DEAL, KEATON ALEXANDER &amp;</td><td>18</td><td>170,913</td><td>0</td><td>18,800</td><td>1,722.00</td></tr> <tr><td>2019</td><td>2019-660091363</td><td>DEAL, KEATON ALEXANDER &amp;</td><td>18</td><td>163,919</td><td>0</td><td>18,031</td><td>1,670.00</td></tr> <tr><td>2018</td><td>2018-660091363</td><td>DEAL, KEATON ALEXANDER &amp;</td><td>18</td><td>156,596</td><td>0</td><td>17,226</td><td>1,592.00</td></tr> <tr><td>2017</td><td>2017-660091363</td><td>DEAL, KEATON ALEXANDER &amp;</td><td>18</td><td>155,338</td><td>1000</td><td>16,087</td><td>1,476.00</td></tr> <tr><td>2016</td><td>2016-660091363</td><td>HENDRIX, LAURA E &amp; CRAIG A</td><td>18</td><td>151,426</td><td>1000</td><td>15,657</td><td>1,468.00</td></tr> <tr><td>2015</td><td>2015-660091363</td><td>HENDRIX, LAURA E &amp; CRAIG A</td><td>18</td><td>147,132</td><td>0</td><td>16,185</td><td>1,457.00</td></tr> <tr><td>2014</td><td>2014-660091363</td><td>HENDRIX, LAURA E &amp; CRAIG A</td><td>18</td><td>148,319</td><td>0</td><td>16,315</td><td>1,513.00</td></tr> <tr><td>2013</td><td>2013-660091363</td><td>HENDRIX, LAURA E &amp; CRAIG A</td><td>18</td><td>30,000</td><td>0</td><td>3,300</td><td>302.00</td></tr> </tbody> </table>										Tax Year	Statement Number	Billed Owner	Tax Area	Total Value	Exemptions	Taxable Value	Billed Tax	2025	2025-660091363	CASTRO, JOSE ANTONIO RODRIGUEZ &	18	213,567	0	23,492	2,171.00	2024	2024-660091363	CASTRO, JOSE ANTONIO RODRIGUEZ &	18	238,334	0	22,523	2,082.00	2023	2023-660091363	CASTRO, JOSE ANTONIO RODRIGUEZ &	18	195,000	0	21,450	1,965.00	2022	2022-660091363	CASTRO, JOSE ANTONIO RODRIGUEZ &	18	195,000	0	21,450	1,986.00	2021	2021-660091363	CASTRO, JOSE ANTONIO RODRIGUEZ &	18	173,712	0	19,108	1,687.00	2020	2020-660091363	DEAL, KEATON ALEXANDER &	18	170,913	0	18,800	1,722.00	2019	2019-660091363	DEAL, KEATON ALEXANDER &	18	163,919	0	18,031	1,670.00	2018	2018-660091363	DEAL, KEATON ALEXANDER &	18	156,596	0	17,226	1,592.00	2017	2017-660091363	DEAL, KEATON ALEXANDER &	18	155,338	1000	16,087	1,476.00	2016	2016-660091363	HENDRIX, LAURA E & CRAIG A	18	151,426	1000	15,657	1,468.00	2015	2015-660091363	HENDRIX, LAURA E & CRAIG A	18	147,132	0	16,185	1,457.00	2014	2014-660091363	HENDRIX, LAURA E & CRAIG A	18	148,319	0	16,315	1,513.00	2013	2013-660091363	HENDRIX, LAURA E & CRAIG A	18	30,000	0	3,300	302.00
Tax Year	Statement Number	Billed Owner	Tax Area	Total Value	Exemptions	Taxable Value	Billed Tax																																																																																																																		
2025	2025-660091363	CASTRO, JOSE ANTONIO RODRIGUEZ &	18	213,567	0	23,492	2,171.00																																																																																																																		
2024	2024-660091363	CASTRO, JOSE ANTONIO RODRIGUEZ &	18	238,334	0	22,523	2,082.00																																																																																																																		
2023	2023-660091363	CASTRO, JOSE ANTONIO RODRIGUEZ &	18	195,000	0	21,450	1,965.00																																																																																																																		
2022	2022-660091363	CASTRO, JOSE ANTONIO RODRIGUEZ &	18	195,000	0	21,450	1,986.00																																																																																																																		
2021	2021-660091363	CASTRO, JOSE ANTONIO RODRIGUEZ &	18	173,712	0	19,108	1,687.00																																																																																																																		
2020	2020-660091363	DEAL, KEATON ALEXANDER &	18	170,913	0	18,800	1,722.00																																																																																																																		
2019	2019-660091363	DEAL, KEATON ALEXANDER &	18	163,919	0	18,031	1,670.00																																																																																																																		
2018	2018-660091363	DEAL, KEATON ALEXANDER &	18	156,596	0	17,226	1,592.00																																																																																																																		
2017	2017-660091363	DEAL, KEATON ALEXANDER &	18	155,338	1000	16,087	1,476.00																																																																																																																		
2016	2016-660091363	HENDRIX, LAURA E & CRAIG A	18	151,426	1000	15,657	1,468.00																																																																																																																		
2015	2015-660091363	HENDRIX, LAURA E & CRAIG A	18	147,132	0	16,185	1,457.00																																																																																																																		
2014	2014-660091363	HENDRIX, LAURA E & CRAIG A	18	148,319	0	16,315	1,513.00																																																																																																																		
2013	2013-660091363	HENDRIX, LAURA E & CRAIG A	18	30,000	0	3,300	302.00																																																																																																																		



# Rogers

## Assessment Property Record Card for Tax Year 2026

Data provided by LISA DELOZIER County Assessor

Date 04/18/2026  
Time 08:02:56  
Page 2

Lot Data		Square-Foot - NBHD 1089 #1		Primary Image				
Lot Size								
Lot Count								
Units Buildable	1							
Non-Ag Acres	0.4906							
Topography								
Street Access								
Utilities								
Amenities	LAND QUALITY	0						
		0						
Method	Square-Foot							
Base Lot Value	21,369.00 x 1.45 = 30,985							
Factor Value								
Adjustments	1.0000							
Lot Value	30,985							
<b>Residential Data</b>				\\tsclient\C\Users\Randy Necessary\Pictures\101_0802\IMG_0071. 8/5/2022				
Type	1 Single Family Residence			<b>GRM Approach</b>				
Condition	3 - Average			GRM Code				
Quality	2.5 - Fair			Gross Rent 0.00				
Architecture				Indicated Value				
Style	100% One Story			<b>Multiple Regression</b>				
Exterior Wall	80% Veneer, Masonry 20% Frame, Siding, Wood			MRA Code 1 Test				
Base/Total Area	1,488 / 1,488			Adusted R 0.8445				
Style	100% One Story			Indicated Value 198,248 133.23 Per SqFt				
HVAC	100% Warmed & Cooled Air			<b>Direct Comparables</b>				
Roof Cover	1 Composition Shingle			Selection Model A Adam Test				
Area on Slab	1,488			Adjustment Model 1 2022 Residential				
Fixture/RghIn	11 /			Comparables 3				
Bed/F/H Bath	3 / 2.0 /			Indicated Value 222,820 Per SqFt				
Basement Area				<b>Value Reconciliation</b>				
Garage Type	440 Attached Garage - Unfinished			Selected Approach Cost Approach				
Remodel				Improvements 188,237				
Year/Eff Age	2013 / 10			Lot Value 30,985				
<b>Cost Approach</b>		<b>Manual : 01/2025</b>		Indicated Value 219,222 147.33 Per SqFt				
Base Cost	105.35	Total Misc Impr	+ 6,096	Agland Value				
Roofing Adj	+ 4.52	Garage Cost	+ 12,487	Site Improvements				
Subfloor Adj	+ -1.16	Total RCN	= 211,502	Total Value 219,222 147.33 Total Value Per SqFt				
Heat/Cool Adj	+ 11.47	Depreciation ( 11%)	- 23,265					
Plumbing Adj	+ 9.47	Lump Sums	+ 0					
Basement Adj	+ 0.00	RCNLD	= 188,237					
Adj Base Cost	= 129.65	Lot Value	+ 30,985					
Total Area	x 1,488	Indicated Value	= 219,222					
Adjusted Cost	= 192,919	Value Per SqFt	147.33					
<b>Miscellaneous Improvements</b>								
Code	Description	Sketch ID	Size	Year	Units	Unit Cost	Depr	Value
PRCH	SLAB PORCH - COVERED	117218	12x8		96	23.97		2,301
PRCH	SLAB PORCH - COVERED	117219	20x8		160	23.72		3,795



**Rogers**  
**Assessment Property Record Card for Tax Year 2026**

Data provided by LISA DELOZIER County Assessor

Date 04/18/2026  
 Time 08:02:56  
 Page 3

Sketch Image

660091363

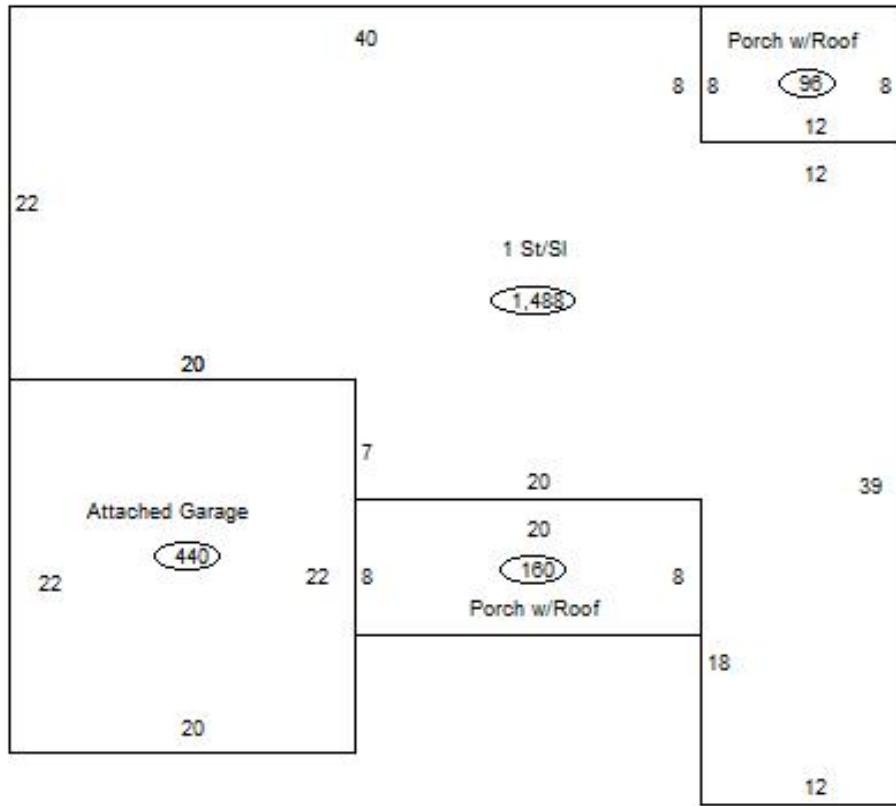

**Sketch Vector Information**

Sequence	Code	Type	Built Over	Scale	Section Label	Base Area	Multiplier	Total Area
1	R	1	Slab	13	1 St/Sl	1,488	1.000	1,488
2	G	1		13	Attached Garage	440	1.000	440
3	M	PRCH		13	SLBC	96	1.000	96
4	M	PRCH		13	SLBC	160	1.000	160
<b>Total Building Area</b>						<b>1,488</b>		<b>1,488</b>