



# Rogers

## Assessment Property Record Card for Tax Year 2026

Data provided by LISA DELOZIER County Assessor

Date 04/18/2026  
 Time 06:59:00  
 Page 1

Assessment Data					Primary Image																																																																																																																				
<b>Account</b> 660091441 <b>Parcel ID</b> 000000-00-0-00808-002-0005 <b>Cadastral ID</b> 36-21-14-01560 <b>Property Type</b> REAL - Real Property <b>Property Class</b> RRP VI Area 4 <b>Tax Area</b> 7 - OWASSO/LIMESTONE FIRE <b>Name ID</b> 330542 DENTON, MICHAEL & MOLLY  6924 HIDDEN ACRE TRAIL OWASSO OK 74055-0000  <b>Parcel Location</b> <b>Situs</b> 06924 N HIDDEN ACRE TRL <b>Subdivision</b> TANGLEWOOD AT STONE CANYON <b>Lot/Block</b> 0005 / 0002 Parcel Size 1 - Lots <b>Sec/Twn/Rng</b> 36 / 21 / 14 / 5 <b>Neighborhood</b> 1041 - R-V01,4-SW OWASSO <b>School District</b> S021 - OWASSO SCHOOLS																																																																																																																									
<b>Legal Description</b> Lat/Long: 36.25154725 -95.76493105 LOT 5 BLOCK 2 TANGLEWOOD AT STONE CANYON.																																																																																																																									
<b>Exemptions</b> <table border="1"> <thead> <tr> <th>Code</th> <th>Type</th> <th>Active</th> <th>Maximum</th> <th>Exemption</th> </tr> </thead> <tbody> <tr> <td>H</td> <td>Homestead</td> <td>Yes</td> <td>1,000</td> <td>1,000</td> </tr> </tbody> </table>					Code	Type	Active	Maximum	Exemption	H	Homestead	Yes	1,000	1,000	<b>Building Permits</b> <table border="1"> <thead> <tr> <th>Number</th> <th>Description</th> <th>Opened</th> <th>Closed</th> <th>Amount</th> </tr> </thead> <tbody> <tr> <td>R26 121</td> <td>NEW DTCH ACC BLDG 36X55</td> <td>04/2026</td> <td></td> <td>120,000</td> </tr> </tbody> </table>					Number	Description	Opened	Closed	Amount	R26 121	NEW DTCH ACC BLDG 36X55	04/2026		120,000																																																																																												
Code	Type	Active	Maximum	Exemption																																																																																																																					
H	Homestead	Yes	1,000	1,000																																																																																																																					
Number	Description	Opened	Closed	Amount																																																																																																																					
R26 121	NEW DTCH ACC BLDG 36X55	04/2026		120,000																																																																																																																					
<b>Parcel Valuation</b> <table border="1"> <thead> <tr> <th>Source</th> <th>REAL</th> <th>Fair Cash</th> <th>Capped</th> <th>Asmnt Level</th> <th>Assessed</th> <th>Levy Rate</th> <th>108.538</th> <th>Current Tax</th> </tr> </thead> <tbody> <tr> <td>Remove Cap</td> <td>2021</td> <td>Land Value</td> <td>182,000</td> <td>177,407</td> <td>11%</td> <td>19,515</td> <td>Assessed</td> <td>69,749 7,570.42</td> </tr> <tr> <td>Year Frozen</td> <td>0</td> <td>Improvements</td> <td>485,524</td> <td>456,667</td> <td></td> <td>50,234</td> <td>Penalty</td> <td>0</td> </tr> <tr> <td>Uncapped Value</td> <td>0</td> <td>Mobile Home</td> <td>0</td> <td>0</td> <td></td> <td>0</td> <td>Exemption</td> <td>1,000 -97.00</td> </tr> <tr> <td>TIF Project ID</td> <td>0</td> <td>Total Value</td> <td>667,524</td> <td>634,074</td> <td></td> <td>69,749</td> <td>Total Taxable</td> <td>68,749 7,473.00</td> </tr> </tbody> </table>					Source	REAL	Fair Cash	Capped	Asmnt Level	Assessed	Levy Rate	108.538	Current Tax	Remove Cap	2021	Land Value	182,000	177,407	11%	19,515	Assessed	69,749 7,570.42	Year Frozen	0	Improvements	485,524	456,667		50,234	Penalty	0	Uncapped Value	0	Mobile Home	0	0		0	Exemption	1,000 -97.00	TIF Project ID	0	Total Value	667,524	634,074		69,749	Total Taxable	68,749 7,473.00	<b>Sale History</b> <table border="1"> <thead> <tr> <th>Bk/Pg</th> <th>Grantor</th> <th>Date</th> <th>Price</th> <th>Code</th> </tr> </thead> <tbody> <tr> <td>/</td> <td>MITCHELL, THOMAS J &amp; CHRISTINE L</td> <td>04/08/2020</td> <td>545,000</td> <td>YES</td> </tr> <tr> <td>2341/110</td> <td>SWIFT, HARVEY C &amp;</td> <td>07/10/2013</td> <td>477,000</td> <td>YES</td> </tr> <tr> <td>2167/935</td> <td>MYERS, MARK &amp;</td> <td>04/11/2011</td> <td>430,000</td> <td>YES</td> </tr> <tr> <td>2054/2</td> <td>JEPSON, PETER B &amp;</td> <td>09/04/2009</td> <td>75,000</td> <td>YES</td> </tr> <tr> <td>1960/783</td> <td>C.A.B.O. DEVELOPMENT-COMPANY L</td> <td>06/04/2008</td> <td>78,000</td> <td>YES</td> </tr> </tbody> </table>					Bk/Pg	Grantor	Date	Price	Code	/	MITCHELL, THOMAS J & CHRISTINE L	04/08/2020	545,000	YES	2341/110	SWIFT, HARVEY C &	07/10/2013	477,000	YES	2167/935	MYERS, MARK &	04/11/2011	430,000	YES	2054/2	JEPSON, PETER B &	09/04/2009	75,000	YES	1960/783	C.A.B.O. DEVELOPMENT-COMPANY L	06/04/2008	78,000	YES																																					
Source	REAL	Fair Cash	Capped	Asmnt Level	Assessed	Levy Rate	108.538	Current Tax																																																																																																																	
Remove Cap	2021	Land Value	182,000	177,407	11%	19,515	Assessed	69,749 7,570.42																																																																																																																	
Year Frozen	0	Improvements	485,524	456,667		50,234	Penalty	0																																																																																																																	
Uncapped Value	0	Mobile Home	0	0		0	Exemption	1,000 -97.00																																																																																																																	
TIF Project ID	0	Total Value	667,524	634,074		69,749	Total Taxable	68,749 7,473.00																																																																																																																	
Bk/Pg	Grantor	Date	Price	Code																																																																																																																					
/	MITCHELL, THOMAS J & CHRISTINE L	04/08/2020	545,000	YES																																																																																																																					
2341/110	SWIFT, HARVEY C &	07/10/2013	477,000	YES																																																																																																																					
2167/935	MYERS, MARK &	04/11/2011	430,000	YES																																																																																																																					
2054/2	JEPSON, PETER B &	09/04/2009	75,000	YES																																																																																																																					
1960/783	C.A.B.O. DEVELOPMENT-COMPANY L	06/04/2008	78,000	YES																																																																																																																					
<b>Assessment History</b> <table border="1"> <thead> <tr> <th>Tax Year</th> <th>Statement Number</th> <th>Billed Owner</th> <th>Tax Area</th> <th>Total Value</th> <th>Exemptions</th> <th>Taxable Value</th> <th>Billed Tax</th> </tr> </thead> <tbody> <tr><td>2025</td><td>2025-660091441</td><td>DENTON, MICHAEL &amp; MOLLY</td><td>7</td><td>652,788</td><td>1000</td><td>66,717</td><td>7,252.00</td></tr> <tr><td>2024</td><td>2024-660091441</td><td>DENTON, MICHAEL &amp; MOLLY</td><td>7</td><td>653,649</td><td>1000</td><td>64,745</td><td>7,159.00</td></tr> <tr><td>2023</td><td>2023-660091441</td><td>DENTON, MICHAEL &amp; MOLLY</td><td>7</td><td>592,750</td><td>1000</td><td>62,830</td><td>6,799.00</td></tr> <tr><td>2022</td><td>2022-660091441</td><td>DENTON, MICHAEL &amp; MOLLY</td><td>7</td><td>583,984</td><td>1000</td><td>60,970</td><td>6,858.00</td></tr> <tr><td>2021</td><td>2021-660091441</td><td>DENTON, MICHAEL &amp; MOLLY</td><td>7</td><td>546,959</td><td>1000</td><td>59,165</td><td>6,583.00</td></tr> <tr><td>2020</td><td>2020-660091441</td><td>DENTON, MICHAEL &amp; MOLLY</td><td>7</td><td>538,288</td><td>0</td><td>59,165</td><td>6,560.00</td></tr> <tr><td>2019</td><td>2019-660091441</td><td>MITCHELL, THOMAS J &amp; CHRISTINE L</td><td>7</td><td>512,249</td><td>0</td><td>56,347</td><td>6,252.00</td></tr> <tr><td>2018</td><td>2018-660091441</td><td>MITCHELL, THOMAS J &amp; CHRISTINE L</td><td>7</td><td>527,050</td><td>0</td><td>57,976</td><td>6,224.00</td></tr> <tr><td>2017</td><td>2017-660091441</td><td>MITCHELL, THOMAS J &amp; CHRISTINE L</td><td>7</td><td>522,094</td><td>0</td><td>57,430</td><td>6,222.00</td></tr> <tr><td>2016</td><td>2016-660091441</td><td>MITCHELL, THOMAS J &amp; CHRISTINE L</td><td>7</td><td>509,524</td><td>0</td><td>56,048</td><td>6,077.00</td></tr> <tr><td>2015</td><td>2015-660091441</td><td>MITCHELL, THOMAS J &amp; CHRISTINE L</td><td>7</td><td>494,852</td><td>0</td><td>54,434</td><td>5,939.00</td></tr> <tr><td>2014</td><td>2014-660091441</td><td>MITCHELL, THOMAS J &amp; CHRISTINE L</td><td>7</td><td>477,681</td><td>0</td><td>52,545</td><td>5,780.00</td></tr> <tr><td>2013</td><td>2013-660091441</td><td>MITCHELL, THOMAS J &amp; CHRISTINE L</td><td>7</td><td>449,490</td><td>1000</td><td>47,719</td><td>5,166.00</td></tr> </tbody> </table>										Tax Year	Statement Number	Billed Owner	Tax Area	Total Value	Exemptions	Taxable Value	Billed Tax	2025	2025-660091441	DENTON, MICHAEL & MOLLY	7	652,788	1000	66,717	7,252.00	2024	2024-660091441	DENTON, MICHAEL & MOLLY	7	653,649	1000	64,745	7,159.00	2023	2023-660091441	DENTON, MICHAEL & MOLLY	7	592,750	1000	62,830	6,799.00	2022	2022-660091441	DENTON, MICHAEL & MOLLY	7	583,984	1000	60,970	6,858.00	2021	2021-660091441	DENTON, MICHAEL & MOLLY	7	546,959	1000	59,165	6,583.00	2020	2020-660091441	DENTON, MICHAEL & MOLLY	7	538,288	0	59,165	6,560.00	2019	2019-660091441	MITCHELL, THOMAS J & CHRISTINE L	7	512,249	0	56,347	6,252.00	2018	2018-660091441	MITCHELL, THOMAS J & CHRISTINE L	7	527,050	0	57,976	6,224.00	2017	2017-660091441	MITCHELL, THOMAS J & CHRISTINE L	7	522,094	0	57,430	6,222.00	2016	2016-660091441	MITCHELL, THOMAS J & CHRISTINE L	7	509,524	0	56,048	6,077.00	2015	2015-660091441	MITCHELL, THOMAS J & CHRISTINE L	7	494,852	0	54,434	5,939.00	2014	2014-660091441	MITCHELL, THOMAS J & CHRISTINE L	7	477,681	0	52,545	5,780.00	2013	2013-660091441	MITCHELL, THOMAS J & CHRISTINE L	7	449,490	1000	47,719	5,166.00
Tax Year	Statement Number	Billed Owner	Tax Area	Total Value	Exemptions	Taxable Value	Billed Tax																																																																																																																		
2025	2025-660091441	DENTON, MICHAEL & MOLLY	7	652,788	1000	66,717	7,252.00																																																																																																																		
2024	2024-660091441	DENTON, MICHAEL & MOLLY	7	653,649	1000	64,745	7,159.00																																																																																																																		
2023	2023-660091441	DENTON, MICHAEL & MOLLY	7	592,750	1000	62,830	6,799.00																																																																																																																		
2022	2022-660091441	DENTON, MICHAEL & MOLLY	7	583,984	1000	60,970	6,858.00																																																																																																																		
2021	2021-660091441	DENTON, MICHAEL & MOLLY	7	546,959	1000	59,165	6,583.00																																																																																																																		
2020	2020-660091441	DENTON, MICHAEL & MOLLY	7	538,288	0	59,165	6,560.00																																																																																																																		
2019	2019-660091441	MITCHELL, THOMAS J & CHRISTINE L	7	512,249	0	56,347	6,252.00																																																																																																																		
2018	2018-660091441	MITCHELL, THOMAS J & CHRISTINE L	7	527,050	0	57,976	6,224.00																																																																																																																		
2017	2017-660091441	MITCHELL, THOMAS J & CHRISTINE L	7	522,094	0	57,430	6,222.00																																																																																																																		
2016	2016-660091441	MITCHELL, THOMAS J & CHRISTINE L	7	509,524	0	56,048	6,077.00																																																																																																																		
2015	2015-660091441	MITCHELL, THOMAS J & CHRISTINE L	7	494,852	0	54,434	5,939.00																																																																																																																		
2014	2014-660091441	MITCHELL, THOMAS J & CHRISTINE L	7	477,681	0	52,545	5,780.00																																																																																																																		
2013	2013-660091441	MITCHELL, THOMAS J & CHRISTINE L	7	449,490	1000	47,719	5,166.00																																																																																																																		



# Rogers

## Assessment Property Record Card for Tax Year 2026

Data provided by LISA DELOZIER County Assessor

Date 04/18/2026  
Time 06:59:00  
Page 2

Lot Data		Square-Foot - NBHD 1041 #1
Lot Size		
Lot Count	1	
Units Buildable	1	
Non-Ag Acres	1.0235	
Topography		
Street Access		
Utilities		
Amenities	LOT TYPE	0
	GATED	0
Method	Square-Foot	
Base Lot Value	44,583.00 x 4.14 = 184,541	
Factor Value		
Adjustments	0.9862	
Lot Value	182,000	



\\tsclient\TCASEY\CASEY BOOTH RESIDENTIAL VI\2022-6-16\ 6/16/2022

Residential Data	
Type	1 Single Family Residence
Condition	5 - Very Good
Quality	4.5 - Good
Architecture	R1 Res Nbhd 1
Style	100% 1 1/2 Story Finished
Exterior Wall	90% Veneer, Masonry 10% Frame, Siding, Wood
Base/Total Area	2,257 / 3,451
Style	100% 1 1/2 Story Finished
HVAC	100% Warmed & Cooled Air
Roof Cover	1 Composition Shingle
Area on Slab	2,257
Fixture/RghIn	16 /
Bed/F/H Bath	4 / 3.5 /
Basement Area	
Garage Type	830 Attached Garage - Unfinished
Remodel	
Year/Eff Age	2010 / 12

GRM Approach	
GRM Code	
Gross Rent	0.00
Indicated Value	

Multiple Regression			
MRA Code	AO3	Residential	
Adusted R	0.8747		
Indicated Value	643,055	186.34	Per SqFt

Direct Comparables			
Selection Model	A	Adam Test	
Adjustment Model	1	2022 Residential	
Comparables	6		
Indicated Value	705,400		Per SqFt

Cost Approach		Manual : 01/2025	
Base Cost	104,54	Total Misc Impr	+ 35,742
Roofing Adj	+ 4.11	Garage Cost	+ 40,180
Subfloor Adj	+ -3.02	Total RCN	= 530,936
Heat/Cool Adj	+ 17.38	Depreciation ( 12%)	- 63,712
Plumbing Adj	+ 8.84	Lump Sums	+ 0
Basement Adj	+ 0.00	RCNLD	= 467,224
Adj Base Cost	= 131.85	Lot Value	+ 182,000
Total Area	x 3,451	Indicated Value	= 649,224
Adjusted Cost	= 455,014	Value Per SqFt	188.13

Value Reconciliation			
Selected Approach	Cost Approach		
Improvements	467,224		
Lot Value	182,000		
Indicated Value	649,224	188.13	Per SqFt
Agland Value			
Site Improvements	18,300		
Total Value	667,524	193.43	Total Value Per SqFt

Miscellaneous Improvements								
Code	Description	Sketch ID	Size	Year	Units	Unit Cost	Depr	Value
FPR1	FIREPLACE - RESIDENTIAL 1 STORY	0		1	1	7,721.18		7,721
PRCH	SLAB PORCH - COVERED	110895		330	330	35.09		11,580
PRCH	SLAB PORCH - COVERED	110897		347	347	35.04		12,159
PATO	SLAB PORCH - OPEN	122490		31x12	372	11.51		4,282



# Rogers

## Assessment Property Record Card for Tax Year 2026

Data provided by LISA DELOZIER County Assessor

Date 04/18/2026

Time 06:59:00

Page 3

### Sketch Image

660091441

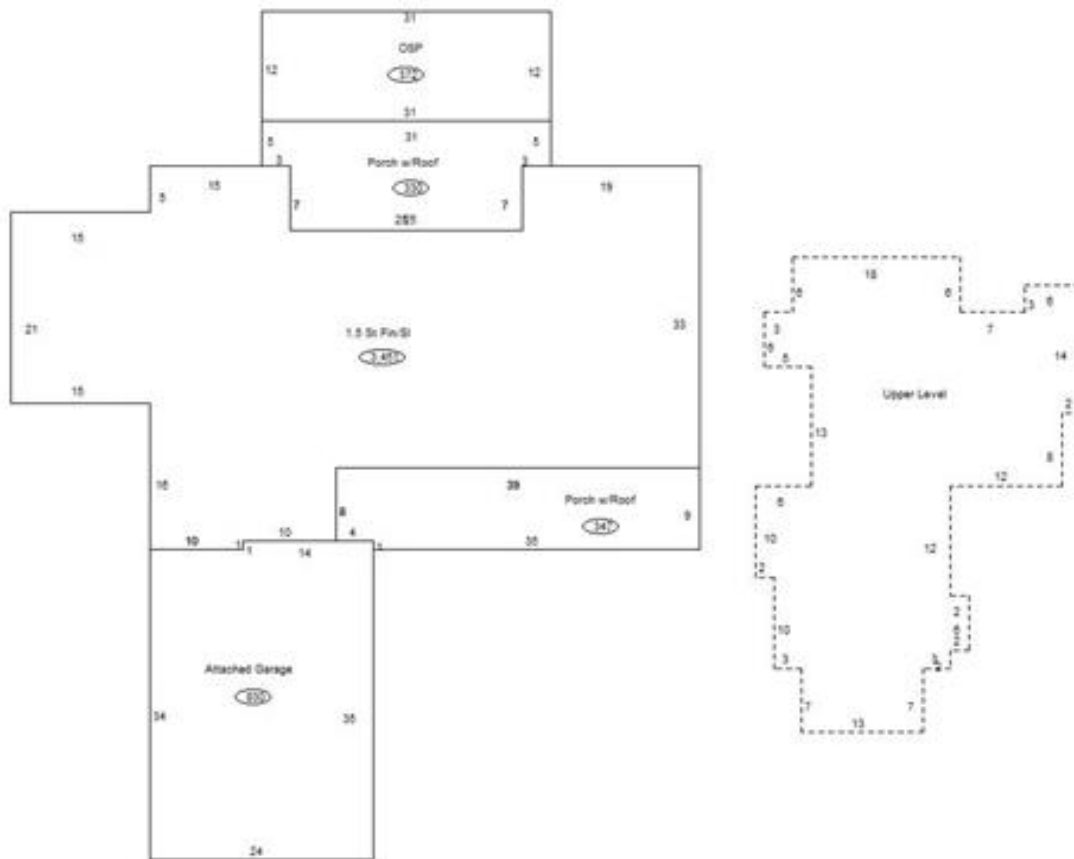

### Sketch Vector Information

Sequence	Code	Type	Built Over	Scale	Section Label	Base Area	Multiplier	Total Area
1	R	5	Slab	13	1.5 St Fin/SI	2,257	1.529	3,451
2	U	^UL	Overhang	13	Upper Level	1,194	1.000	1,194
3	M	PRCH		13	SLBC	330	1.000	330
4	G	1		13	Attached Garage	830	1.000	830
5	M	PRCH		13	SLBC	347	1.000	347
6	M	PATO		13	Open Slab	372	1.000	372
<b>Total Building Area</b>						<b>2,257</b>		<b>3,451</b>



# Rogers

## Assessment Property Record Card for Tax Year 2026

Data provided by LISA DELOZIER County Assessor

Date 04/18/2026  
Time 06:59:01  
Page 4

660091441

### Outbuildings/Site Improvements

Building Image	Code	Description	Dimensions	Floor	Roofing	Total Units
	SG	SWIM-GUNITE	0x0x0			1
	Qual	4	Cond 4	Year 2015	Eff Age 7	
		<b>Valuation Summary</b>	<b>Modifier Total</b>	<b>RCN</b>	<b>Depr (39% Phys/ % Func)</b>	<b>RCNLD</b>
		Base Cost (30,000.00 x 1)	30,000	30,000	11,700	18,300