



# Rogers

## Assessment Property Record Card for Tax Year 2026

Data provided by LISA DELOZIER County Assessor

Date 04/18/2026

Time 07:33:02

Page 1

Assessment Data					Primary Image				
<b>Account</b>	660091684								
<b>Parcel ID</b>	000000-00-0-00449-013-0016								
<b>Cadastral ID</b>	10-21-14-04030								
<b>Property Type</b>	REAL - Real Property								
<b>Property Class</b>	URP	VI Area 4							
<b>Tax Area</b>	40 - OWASSO CITY								
<b>Name ID</b>	305557								
LYLE, KARI A &									
MARCUS R									
10736 N 153RD E AVE									
OWASSO OK 74055-0000									
<b>Parcel Location</b>									
<b>Situs</b>	10736 N 153RD E AVE								
<b>Subdivision</b>	LAKE VALLEY III								
<b>Lot/Block</b>	0016 / 0013	<b>Parcel Size</b> 1 - Lots							
<b>Sec/Twn/Rng</b>	10 / 21 / 14 / 5								
<b>Neighborhood</b>	1059 - R-V04-SW OWASSO								
<b>School District</b>	S021 - OWASSO SCHOOLS								
<b>Legal Description</b> Lat/Long: 36.30981878 -95.80603878									
<b>Building Permits</b>									
LOT 16 BLOCK 13 LAKE VALLEY III.									
<b>Number</b>	<b>Description</b>	<b>Opened</b>	<b>Closed</b>	<b>Amount</b>					
16-0714X	R17-NEW 192 SQ FT ADDITION	08/2016	11/2016	10,000					
16-0507X	R17-NEW 84 SQ FT LIVING SPACE ADI	06/2016	11/2016	7,000					
11-0524X	R12-NEW 1522 SQ FT SFR	07/2011	08/2011	91,320					
<b>Exemptions</b>									
<b>Code</b>	<b>Type</b>	<b>Active</b>	<b>Maximum</b>	<b>Exemption</b>					
H	Homestead	Yes	1,000	1,000					
<b>Sale History</b>									
<b>Bk/Pg</b>	<b>Grantor</b>	<b>Date</b>	<b>Price</b>	<b>Code</b>					
2195/586	SIMMONS HOMES RESIDENTIAL	09/15/2011	141,000	YES					
2110/417	LAKE VALLEY INVESTMENT-GROUP I	06/28/2010	0	4					
<b>Parcel Valuation</b>									
<b>Source</b>	<b>REAL</b>	<b>Fair Cash</b>	<b>Capped</b>	<b>Asmnt Level</b>	<b>Assessed</b>	<b>Levy Rate</b>	97.960	<b>Current Tax</b>	
Remove Cap	0	Land Value 32,224	32,224	11%	3,545	Assessed	21,882	2,143.56	
Year Frozen	0	Improvements 202,456	166,698		18,337	Penalty	0		
Uncapped Value	0	Mobile Home 0	0		0	Exemption	1,000	-98.00	
TIF Project ID	0	Total Value 234,680	198,922		21,882	Total Taxable	20,882	2,046.00	
<b>Assessment History</b>									
<b>Tax Year</b>	<b>Statement Number</b>	<b>Billed Owner</b>	<b>Tax Area</b>	<b>Total Value</b>	<b>Exemptions</b>	<b>Taxable Value</b>	<b>Billed Tax</b>		
2025	2025-660091684	LYLE, KARI A &	40	226,677	1000	20,245	1,983.00		
2024	2024-660091684	LYLE, KARI A &	40	243,099	1000	19,625	1,885.00		
2023	2023-660091684	LYLE, KARI A &	40	219,271	1000	19,025	1,783.00		
2022	2022-660091684	LYLE, KARI A &	40	211,118	1000	18,442	1,807.00		
2021	2021-660091684	LYLE, KARI A &	40	178,661	1000	17,875	1,729.00		
2020	2020-660091684	LYLE, KARI A &	40	169,638	1000	17,326	1,676.00		
2019	2019-660091684	LYLE, KARI A &	40	161,745	1000	16,792	1,626.00		
2018	2018-660091684	LYLE, KARI A &	40	161,511	1000	16,766	1,563.00		
2017	2017-660091684	LYLE, KARI A &	40	160,269	1000	16,630	1,565.00		
2016	2016-660091684	LYLE, KARI A &	40	152,494	0	16,774	1,585.00		
2015	2015-660091684	LYLE, KARI A &	40	155,854	0	17,144	1,635.00		
2014	2014-660091684	LYLE, KARI A &	40	155,618	0	16,965	1,634.00		
2013	2013-660091684	LYLE, KARI A &	40	146,880	0	16,157	1,523.00		



# Rogers

## Assessment Property Record Card for Tax Year 2026

Data provided by LISA DELOZIER County Assessor

Date 04/18/2026  
 Time 07:33:02  
 Page 2

Lot Data	Square-Foot - NBHD 1059 #1	Primary Image
Lot Size		
Lot Count	1	
Units Buildable	1	
Non-Ag Acres	0.1396	
Topography		
Street Access		
Utilities		
Amenities	0	
	0	
Method	Square-Foot	
Base Lot Value	6,080.00 x 5.30 = 32,224	
Factor Value		
Adjustments	1.0000	
Lot Value	32,224	

Residential Data	
Type	1 Single Family Residence
Condition	3 - Average
Quality	3 - Average
Architecture	
Style	100% One Story
Exterior Wall	10% Veneer, Masonry 90% Frame, Siding, Wood
Base/Total Area	1,588 / 1,588
Style	100% One Story
HVAC	100% Warmed & Cooled Air
Roof Cover	1 Composition Shingle
Area on Slab	1,588
Fixture/RghIn	11 /
Bed/F/H Bath	3 / 2.0 /
Basement Area	
Garage Type	400 Attached Garage - Unfinished
Remodel	RMA -
Year/Eff Age	2011 / 8



GRM Approach	
GRM Code	
Gross Rent	0.00
Indicated Value	

Multiple Regression			
MRA Code	1	Test	
Adjusted R	0.8445		
Indicated Value	216,847	136.55	Per SqFt

Direct Comparables			
Selection Model	A	Adam Test	
Adjustment Model	1	2022 Residential	
Comparables	8		
Indicated Value	233,150		Per SqFt

Cost Approach				Manual : 01/2025	
Base Cost	104.80	Total Misc Impr	+	323	
Roofing Adj	+ 4.92	Garage Cost	+	13,584	
Subfloor Adj	+ -2.31	Total RCN	=	220,061	
Heat/Cool Adj	+ 12.64	Depreciation ( 8%)	-	17,605	
Plumbing Adj	+ 9.77	Lump Sums	+	0	
Basement Adj	+ 0.00	RCNLD	=	202,456	
Adj Base Cost	= 129.82	Lot Value	+	32,224	
Total Area	x 1,588	Indicated Value	=	234,680	
Adjusted Cost	= 206,154	Value Per SqFt		147.78	

Value Reconciliation			
Selected Approach	Cost Approach		
Improvements	202,456		
Lot Value	32,224		
Indicated Value	234,680	147.78	Per SqFt
Agland Value			
Site Improvements			
Total Value	234,680	147.78	Total Value Per SqFt

Miscellaneous Improvements							
Code	Description	Sketch ID	Size	Year	Units	Unit Cost	Depr Value
PRCH	SLAB PORCH - COVERED	111626	6x2		12	26.89	323



# Rogers

## Assessment Property Record Card for Tax Year 2026

Data provided by LISA DELOZIER County Assessor

Date 04/18/2026

Time 07:33:03

Page 3

### Sketch Image

660091684

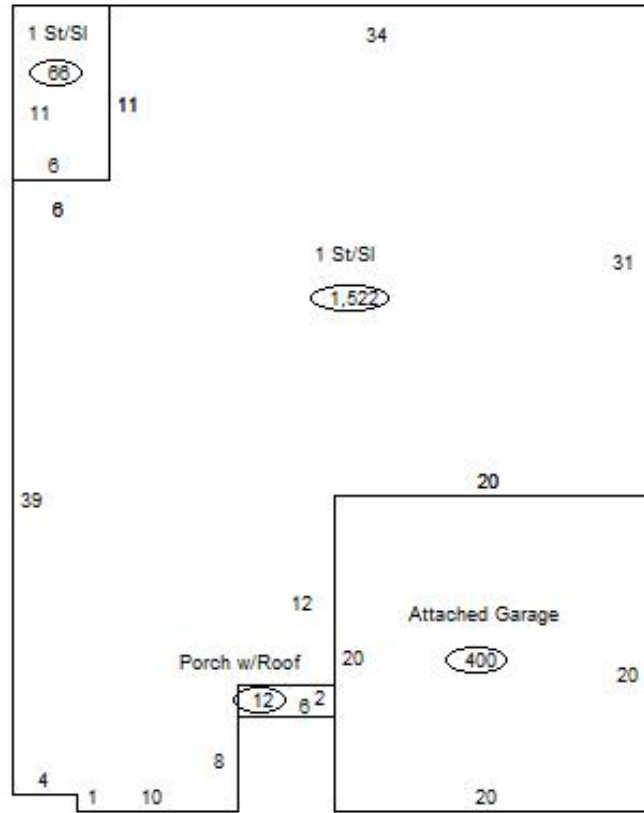

### Sketch Vector Information

Sequence	Code	Type	Built Over	Scale	Section Label	Base Area	Multiplier	Total Area
1	R	1	Slab	13	1 St/Sl	1,522	1.000	1,522
2	R	1	Slab	13	1 St/Sl	66	1.000	66
3	G	1		13	Attached Garage	400	1.000	400
4	M	PRCH		13	SLBC	12	1.000	12
<b>Total Building Area</b>						<b>1,588</b>		<b>1,588</b>