



# Rogers

## Assessment Property Record Card for Tax Year 2026

Data provided by LISA DELOZIER County Assessor

Date 04/18/2026  
Time 06:44:57  
Page 1

Assessment Data					Primary Image																																																																																																																				
<b>Account</b> 660092121 <b>Parcel ID</b> 22N15E-24-1-00000-000-0000 <b>Cadastral ID</b> 24-22-15-00610 <b>Property Type</b> REAL - Real Property <b>Property Class</b> RA VI Area 4 <b>Tax Area</b> 10 - OOLOGAH RURAL/NW FIRE <b>Name ID</b> 300621 ANDEREGG, DONALD & STACY REVOCABLE LIVING TRUST  16274 S 4130 RD CLAREMORE OK 74017-0000  <b>Parcel Location</b> <b>Situs</b> 16274 S 4130 RD <b>Subdivision</b> <b>Lot/Block</b> / <b>Parcel Size</b> 3 - Acres <b>Sec/Twn/Rng</b> 24 / 22 / 15 / 1 <b>Neighborhood</b> 6030 - UNPLATTED <b>School District</b> S004 - OOLOGAH SCHOOLS					<p>\\tsclient\T\TOMMY DUNLAP\061721(73)\IMG_0001.JPG 6/17/2022</p>																																																																																																																				
<b>Legal Description</b> Lat/Long: 36.37541089 -95.65162312 TR DESC 2023-012209 AS: N 247.5' OF S 495' OF E 352' OF N/2 SE/4 NE/4. & W 176' E 528' N 247.5' S 495' N2 SE NE.																																																																																																																									
<b>Exemptions</b> <table border="1"> <thead> <tr> <th>Code</th> <th>Type</th> <th>Active</th> <th>Maximum</th> <th>Exemption</th> </tr> </thead> <tbody> <tr> <td>H</td> <td>Homestead</td> <td>Yes</td> <td>1,000</td> <td>1,000</td> </tr> </tbody> </table>					Code	Type	Active	Maximum	Exemption	H	Homestead	Yes	1,000	1,000	<b>Building Permits</b> <table border="1"> <thead> <tr> <th>Number</th> <th>Description</th> <th>Opened</th> <th>Closed</th> <th>Amount</th> </tr> </thead> <tbody> <tr> <td>R23 292</td> <td>R24 NEW DTCH ACC BLDG 40X60</td> <td>09/2023</td> <td>01/2024</td> <td>112,000</td> </tr> </tbody> </table>					Number	Description	Opened	Closed	Amount	R23 292	R24 NEW DTCH ACC BLDG 40X60	09/2023	01/2024	112,000																																																																																												
Code	Type	Active	Maximum	Exemption																																																																																																																					
H	Homestead	Yes	1,000	1,000																																																																																																																					
Number	Description	Opened	Closed	Amount																																																																																																																					
R23 292	R24 NEW DTCH ACC BLDG 40X60	09/2023	01/2024	112,000																																																																																																																					
<b>Parcel Valuation</b> <table border="1"> <thead> <tr> <th>Source</th> <th>REAL</th> <th>Fair Cash</th> <th>Capped</th> <th>Asmnt Level</th> <th>Assessed</th> <th>Levy Rate</th> <th>108.182</th> <th>Current Tax</th> </tr> </thead> <tbody> <tr> <td>Remove Cap</td> <td>0</td> <td>Land Value 412</td> <td>412</td> <td>11%</td> <td>45</td> <td>Assessed</td> <td>24,527</td> <td>2,653.37</td> </tr> <tr> <td>Year Frozen</td> <td>0</td> <td>Improvements 229,033</td> <td>222,560</td> <td></td> <td>24,482</td> <td>Penalty</td> <td>0</td> <td></td> </tr> <tr> <td>Uncapped Value</td> <td>0</td> <td>Mobile Home 0</td> <td>0</td> <td></td> <td>0</td> <td>Exemption</td> <td>1,000</td> <td>-94.00</td> </tr> <tr> <td>TIF Project ID</td> <td>0</td> <td>Total Value 229,445</td> <td>222,972</td> <td></td> <td>24,527</td> <td>Total Taxable</td> <td>23,527</td> <td>2,559.00</td> </tr> </tbody> </table>					Source	REAL	Fair Cash	Capped	Asmnt Level	Assessed	Levy Rate	108.182	Current Tax	Remove Cap	0	Land Value 412	412	11%	45	Assessed	24,527	2,653.37	Year Frozen	0	Improvements 229,033	222,560		24,482	Penalty	0		Uncapped Value	0	Mobile Home 0	0		0	Exemption	1,000	-94.00	TIF Project ID	0	Total Value 229,445	222,972		24,527	Total Taxable	23,527	2,559.00	<b>Sale History</b> <table border="1"> <thead> <tr> <th>Bk/Pg</th> <th>Grantor</th> <th>Date</th> <th>Price</th> <th>Code</th> </tr> </thead> <tbody> <tr> <td>/</td> <td>ANDEREGG, DONALD &amp; STACY</td> <td>09/13/2023</td> <td>0</td> <td>4</td> </tr> <tr> <td>/</td> <td>FORBES, JAMES RAY &amp;</td> <td>09/08/2023</td> <td>0</td> <td>4</td> </tr> <tr> <td>2031/254</td> <td>FORBES, JAMES RAY &amp;</td> <td>06/04/2009</td> <td>0</td> <td>11</td> </tr> </tbody> </table>					Bk/Pg	Grantor	Date	Price	Code	/	ANDEREGG, DONALD & STACY	09/13/2023	0	4	/	FORBES, JAMES RAY &	09/08/2023	0	4	2031/254	FORBES, JAMES RAY &	06/04/2009	0	11																																															
Source	REAL	Fair Cash	Capped	Asmnt Level	Assessed	Levy Rate	108.182	Current Tax																																																																																																																	
Remove Cap	0	Land Value 412	412	11%	45	Assessed	24,527	2,653.37																																																																																																																	
Year Frozen	0	Improvements 229,033	222,560		24,482	Penalty	0																																																																																																																		
Uncapped Value	0	Mobile Home 0	0		0	Exemption	1,000	-94.00																																																																																																																	
TIF Project ID	0	Total Value 229,445	222,972		24,527	Total Taxable	23,527	2,559.00																																																																																																																	
Bk/Pg	Grantor	Date	Price	Code																																																																																																																					
/	ANDEREGG, DONALD & STACY	09/13/2023	0	4																																																																																																																					
/	FORBES, JAMES RAY &	09/08/2023	0	4																																																																																																																					
2031/254	FORBES, JAMES RAY &	06/04/2009	0	11																																																																																																																					
<b>Assessment History</b> <table border="1"> <thead> <tr> <th>Tax Year</th> <th>Statement Number</th> <th>Billed Owner</th> <th>Tax Area</th> <th>Total Value</th> <th>Exemptions</th> <th>Taxable Value</th> <th>Billed Tax</th> </tr> </thead> <tbody> <tr><td>2025</td><td>2025-660092121</td><td>ANDEREGG, DONALD &amp; STACY</td><td>10</td><td>221,021</td><td>1000</td><td>22,812</td><td>2,482.00</td></tr> <tr><td>2024</td><td>2024-660092121</td><td>ANDEREGG, DONALD &amp; STACY</td><td>10</td><td>230,188</td><td>1000</td><td>22,119</td><td>2,331.00</td></tr> <tr><td>2023</td><td>2023-660092121</td><td>ANDEREGG, DONALD &amp; STACY</td><td>10</td><td>170,015</td><td>1000</td><td>16,990</td><td>1,781.00</td></tr> <tr><td>2022</td><td>2022-660092121</td><td>ANDEREGG, STACY D &amp;</td><td>10</td><td>187,714</td><td>1000</td><td>16,466</td><td>1,718.00</td></tr> <tr><td>2021</td><td>2021-660092121</td><td>ANDEREGG, STACY D &amp;</td><td>10</td><td>161,432</td><td>1000</td><td>15,957</td><td>1,678.00</td></tr> <tr><td>2020</td><td>2020-660092121</td><td>ANDEREGG, STACY D &amp;</td><td>10</td><td>156,945</td><td>1000</td><td>15,464</td><td>1,650.00</td></tr> <tr><td>2019</td><td>2019-660092121</td><td>ANDEREGG, STACY D &amp;</td><td>10</td><td>145,308</td><td>1000</td><td>14,984</td><td>1,570.00</td></tr> <tr><td>2018</td><td>2018-660092121</td><td>ANDEREGG, STACY D &amp;</td><td>10</td><td>149,037</td><td>1000</td><td>14,657</td><td>1,588.00</td></tr> <tr><td>2017</td><td>2017-660092121</td><td>ANDEREGG, STACY D &amp;</td><td>10</td><td>147,805</td><td>1000</td><td>14,202</td><td>1,628.00</td></tr> <tr><td>2016</td><td>2016-660092121</td><td>ANDEREGG, STACY D &amp;</td><td>10</td><td>144,020</td><td>1000</td><td>13,759</td><td>1,439.00</td></tr> <tr><td>2015</td><td>2015-660092121</td><td>ANDEREGG, STACY D &amp;</td><td>10</td><td>139,499</td><td>1000</td><td>13,329</td><td>1,319.00</td></tr> <tr><td>2014</td><td>2014-660092121</td><td>ANDEREGG, STACY D &amp;</td><td>10</td><td>140,636</td><td>1000</td><td>12,912</td><td>1,275.00</td></tr> <tr><td>2013</td><td>2013-660092121</td><td>ANDEREGG, STACY D &amp;</td><td>10</td><td>132,148</td><td>1000</td><td>12,507</td><td>1,195.00</td></tr> </tbody> </table>										Tax Year	Statement Number	Billed Owner	Tax Area	Total Value	Exemptions	Taxable Value	Billed Tax	2025	2025-660092121	ANDEREGG, DONALD & STACY	10	221,021	1000	22,812	2,482.00	2024	2024-660092121	ANDEREGG, DONALD & STACY	10	230,188	1000	22,119	2,331.00	2023	2023-660092121	ANDEREGG, DONALD & STACY	10	170,015	1000	16,990	1,781.00	2022	2022-660092121	ANDEREGG, STACY D &	10	187,714	1000	16,466	1,718.00	2021	2021-660092121	ANDEREGG, STACY D &	10	161,432	1000	15,957	1,678.00	2020	2020-660092121	ANDEREGG, STACY D &	10	156,945	1000	15,464	1,650.00	2019	2019-660092121	ANDEREGG, STACY D &	10	145,308	1000	14,984	1,570.00	2018	2018-660092121	ANDEREGG, STACY D &	10	149,037	1000	14,657	1,588.00	2017	2017-660092121	ANDEREGG, STACY D &	10	147,805	1000	14,202	1,628.00	2016	2016-660092121	ANDEREGG, STACY D &	10	144,020	1000	13,759	1,439.00	2015	2015-660092121	ANDEREGG, STACY D &	10	139,499	1000	13,329	1,319.00	2014	2014-660092121	ANDEREGG, STACY D &	10	140,636	1000	12,912	1,275.00	2013	2013-660092121	ANDEREGG, STACY D &	10	132,148	1000	12,507	1,195.00
Tax Year	Statement Number	Billed Owner	Tax Area	Total Value	Exemptions	Taxable Value	Billed Tax																																																																																																																		
2025	2025-660092121	ANDEREGG, DONALD & STACY	10	221,021	1000	22,812	2,482.00																																																																																																																		
2024	2024-660092121	ANDEREGG, DONALD & STACY	10	230,188	1000	22,119	2,331.00																																																																																																																		
2023	2023-660092121	ANDEREGG, DONALD & STACY	10	170,015	1000	16,990	1,781.00																																																																																																																		
2022	2022-660092121	ANDEREGG, STACY D &	10	187,714	1000	16,466	1,718.00																																																																																																																		
2021	2021-660092121	ANDEREGG, STACY D &	10	161,432	1000	15,957	1,678.00																																																																																																																		
2020	2020-660092121	ANDEREGG, STACY D &	10	156,945	1000	15,464	1,650.00																																																																																																																		
2019	2019-660092121	ANDEREGG, STACY D &	10	145,308	1000	14,984	1,570.00																																																																																																																		
2018	2018-660092121	ANDEREGG, STACY D &	10	149,037	1000	14,657	1,588.00																																																																																																																		
2017	2017-660092121	ANDEREGG, STACY D &	10	147,805	1000	14,202	1,628.00																																																																																																																		
2016	2016-660092121	ANDEREGG, STACY D &	10	144,020	1000	13,759	1,439.00																																																																																																																		
2015	2015-660092121	ANDEREGG, STACY D &	10	139,499	1000	13,329	1,319.00																																																																																																																		
2014	2014-660092121	ANDEREGG, STACY D &	10	140,636	1000	12,912	1,275.00																																																																																																																		
2013	2013-660092121	ANDEREGG, STACY D &	10	132,148	1000	12,507	1,195.00																																																																																																																		



# Rogers

## Assessment Property Record Card for Tax Year 2026

Data provided by LISA DELOZIER County Assessor

Date 04/18/2026  
 Time 06:44:57  
 Page 2

Lot Data	Square-Foot - UNPLATTED (ACRES)	Primary Image
Lot Size		
Lot Count		
Units Buildable		
Non-Ag Acres	0	
Topography		
Street Access		
Utilities		
Amenities	LAND QUALITY	
Method	Square-Foot	
Base Lot Value		
Factor Value		
Adjustments		
Lot Value		

Residential Data	
Type	1 Single Family Residence
Condition	3 - Average
Quality	2.5 - Fair
Architecture	
Style	100% One Story
Exterior Wall	100% Veneer, Masonry
Base/Total Area	1,313 / 1,313
Style	100% One Story
HVAC	100% Warmed & Cooled Air
Roof Cover	1 Composition Shingle
Area on Slab	1,313
Fixture/RghIn	11 /
Bed/F/H Bath	3 / 2.0 /
Basement Area	
Garage Type	400 Attached Garage - Unfinished
Remodel	
Year/Eff Age	2010 / 12



\\tsclient\T\TOMMY DUNLAP\061721(73)\IMG\_0001.JPG 6/17/2022

GRM Approach	
GRM Code	
Gross Rent	0.00
Indicated Value	

Multiple Regression			
MRA Code	1	Test	
Adusted R	0.8445		
Indicated Value	240,876	183.45	Per SqFt

Direct Comparables	
Selection Model	1 Res
Adjustment Model	A2 AO Test
Comparables	
Indicated Value	

Cost Approach				Manual : 01/2025	
Base Cost	110.05	Total Misc Impr	+	4,342	
Roofing Adj	+ 4.65	Garage Cost	+	11,700	
Subfloor Adj	+ -1.21	Total RCN	=	194,203	
Heat/Cool Adj	+ 11.47	Depreciation ( 14%)	-	27,188	
Plumbing Adj	+ 10.73	Lump Sums	+	0	
Basement Adj	+ 0.00	RCNLD	=	167,015	
Adj Base Cost	= 135.69	Lot Value	+		
Total Area	x 1,313	Indicated Value	=	167,015	
Adjusted Cost	= 178,161	Value Per SqFt		127.20	

Value Reconciliation			
Selected Approach	Cost Approach		
Improvements	167,015		
Lot Value			
Indicated Value	167,015	127.20	Per SqFt
Agland Value	412		
Site Improvements	62,018		
Total Value	229,445	174.75	Total Value Per SqFt

Miscellaneous Improvements								
Code	Description	Sketch ID	Size	Year	Units	Unit Cost	Depr	Value
SHLT	STORM SHELTER	0		1	2014	1	0.00	
PRCH	SLAB PORCH - COVERED	111836		38		38	24.15	918
PRCH	SLAB PORCH - COVERED	111837	18x8			144	23.78	3,424



Sketch Image

660092121

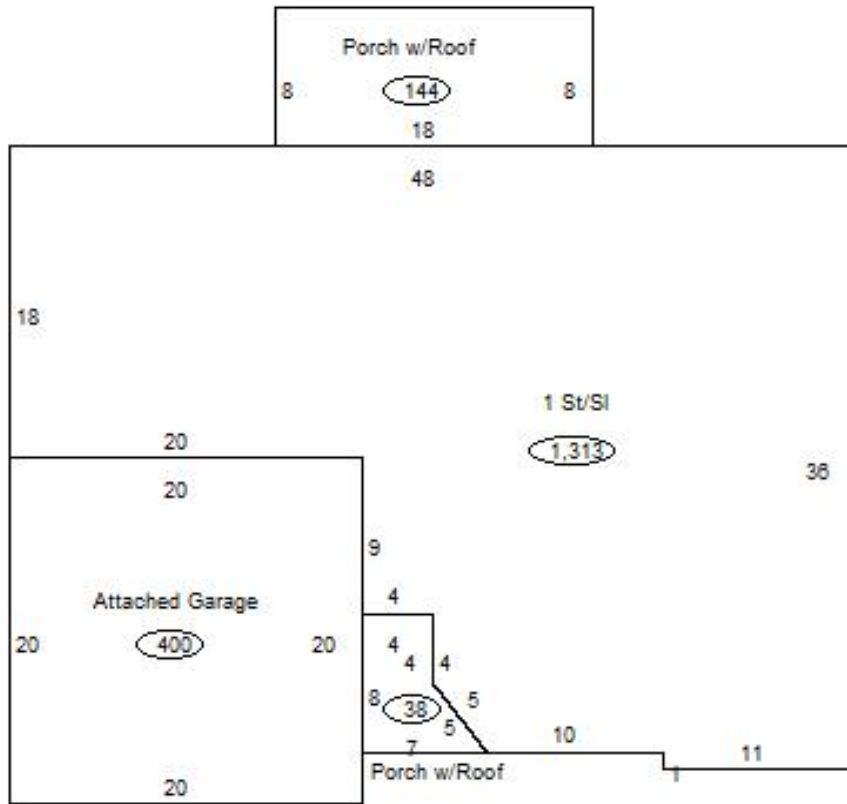

Sketch Vector Information

Sequence	Code	Type	Built Over	Scale	Section Label	Base Area	Multiplier	Total Area
1	R	1	Slab	13	1 St/Sl	1,313	1.000	1,313
2	G	1		13	Attached Garage	400	1.000	400
3	M	PRCH		13	SLBC	38	1.000	38
4	M	PRCH		13	SLBC	144	1.000	144
<b>Total Building Area</b>						1,313		1,313



# Rogers



## Assessment Property Record Card for Tax Year 2026

Data provided by LISA DELOZIER County Assessor

Date 04/18/2026  
 Time 06:44:57  
 Page 4

660092121

### Outbuildings/Site Improvements

Building Image	Code	Description	Dimensions	Floor	Roofing	Total Units
	UTIL	Shop Building	40x60x12	Concrete	Formed Metal	2,400
	Qual	3	Cond 3	Year 2023	Eff Age 2	
	<b>Valuation Summary</b>		<b>Modifier Total</b>	<b>RCN</b>	<b>Depr (3% Phys/ % Func)</b>	<b>RCNLD</b>
	Base Cost (26.64 x 2,400)		63,936	63,936	1,918	62,018
	STF	STG FAIR	0x0x0			
	Qual	Cond	Year	Eff Age		
	<b>Valuation Summary</b>		<b>Modifier Total</b>	<b>RCN</b>	<b>Depr (100% Phys/ % Func)</b>	<b>RCNLD</b>
	Base Cost (4.68 x )					



# Rogers

## Assessment Property Record Card for Tax Year 2026

Data provided by LISA DELOZIER County Assessor

Date 04/18/2026  
Time 06:44:57  
Page 5

### Agland Inventory

660092121

Soi	Description	Land Use	LPI	Adj Type	Adj Code	Acres	Use/Acre	Mkt/Acre	Use Value	Market Value
NAB	NEWTONIA SILT LOAM 1-3% S	IMP PST	80			1.840	224	224	412	412
<b>IMP PST Totals</b>						1.840			412	412
<b>Total Agland</b>						1.840			412	412