



Rogers

Assessment Property Record Card for Tax Year 2026

Data provided by LISA DELOZIER County Assessor

Date 04/18/2026
 Time 06:48:49
 Page 1

Assessment Data					Primary Image																																																																																																																				
Account 660092381 Parcel ID 23N15E-07-1-00000-000-0000 Cadastral ID 07-23-15-00126 Property Type REAL - Real Property Property Class RA VI Area 2 Tax Area 10 - OOLOGAH RURAL/NW FIRE Name ID 329279 JOHNSON, DANIEL ALLEN & MYSTI RAINE 4000 BIG SKY LN TALALA OK 74080-0000 Parcel Location Situs 04000 E BIG SKY LN Subdivision Lot/Block / Parcel Size 24.87 - Acres Sec/Twn/Rng 7 / 23 / 15 / 1 Neighborhood 4030 - OOLOGAH RURAL School District S004 - OOLOGAH SCHOOLS																																																																																																																									
Legal Description Lat/Long: 36.48370642 -95.75724843										Building Permits <table border="1"> <thead> <tr> <th>Number</th> <th>Description</th> <th>Opened</th> <th>Closed</th> <th>Amount</th> </tr> </thead> <tbody> <tr> <td>R12</td> <td>R12-NEW BARN</td> <td>09/2011</td> <td>09/2011</td> <td></td> </tr> </tbody> </table>					Number	Description	Opened	Closed	Amount	R12	R12-NEW BARN	09/2011	09/2011																																																																																																		
Number	Description	Opened	Closed	Amount																																																																																																																					
R12	R12-NEW BARN	09/2011	09/2011																																																																																																																						
Exemptions <table border="1"> <thead> <tr> <th>Code</th> <th>Type</th> <th>Active</th> <th>Maximum</th> <th>Exemption</th> </tr> </thead> <tbody> <tr> <td>HV</td> <td>Veteran</td> <td>Yes</td> <td>999,999</td> <td>42,516</td> </tr> </tbody> </table>					Code	Type	Active	Maximum	Exemption	HV	Veteran	Yes	999,999	42,516	Sale History <table border="1"> <thead> <tr> <th>Bk/Pg</th> <th>Grantor</th> <th>Date</th> <th>Price</th> <th>Code</th> </tr> </thead> <tbody> <tr> <td>/</td> <td>MILLER, MICHAEL RAY &</td> <td>11/04/2019</td> <td>465,000</td> <td>YES</td> </tr> <tr> <td>2116/705</td> <td>CRAIG BOOS BUILDERS LLC</td> <td>07/23/2010</td> <td>311,500</td> <td>YES</td> </tr> <tr> <td>2095/894</td> <td>MILLER, MICHAEL RAY &</td> <td>04/07/2010</td> <td>54,000</td> <td>YES</td> </tr> <tr> <td>2051/174</td> <td>HAYNES FAMILY TRUST</td> <td>08/13/2009</td> <td>62,500</td> <td>11</td> </tr> <tr> <td>2051/175</td> <td>BESGROVE, JOHN &</td> <td>08/12/2009</td> <td>72,500</td> <td></td> </tr> </tbody> </table>					Bk/Pg	Grantor	Date	Price	Code	/	MILLER, MICHAEL RAY &	11/04/2019	465,000	YES	2116/705	CRAIG BOOS BUILDERS LLC	07/23/2010	311,500	YES	2095/894	MILLER, MICHAEL RAY &	04/07/2010	54,000	YES	2051/174	HAYNES FAMILY TRUST	08/13/2009	62,500	11	2051/175	BESGROVE, JOHN &	08/12/2009	72,500																																																																									
Code	Type	Active	Maximum	Exemption																																																																																																																					
HV	Veteran	Yes	999,999	42,516																																																																																																																					
Bk/Pg	Grantor	Date	Price	Code																																																																																																																					
/	MILLER, MICHAEL RAY &	11/04/2019	465,000	YES																																																																																																																					
2116/705	CRAIG BOOS BUILDERS LLC	07/23/2010	311,500	YES																																																																																																																					
2095/894	MILLER, MICHAEL RAY &	04/07/2010	54,000	YES																																																																																																																					
2051/174	HAYNES FAMILY TRUST	08/13/2009	62,500	11																																																																																																																					
2051/175	BESGROVE, JOHN &	08/12/2009	72,500																																																																																																																						
Parcel Valuation <table border="1"> <thead> <tr> <th>Source</th> <th>REAL</th> <th>Fair Cash</th> <th>Capped</th> <th>Asmnt Level</th> <th>Assessed</th> <th>Levy Rate</th> <th>108.182</th> <th>Current Tax</th> </tr> </thead> <tbody> <tr> <td>Remove Cap</td> <td>2020</td> <td>Land Value 3,581</td> <td>3,581</td> <td>11%</td> <td>394</td> <td>Assessed</td> <td>42,516</td> <td>4,599.45</td> </tr> <tr> <td>Year Frozen</td> <td>0</td> <td>Improvements 426,967</td> <td>382,930</td> <td></td> <td>42,122</td> <td>Penalty</td> <td>0</td> <td></td> </tr> <tr> <td>Uncapped Value</td> <td>0</td> <td>Mobile Home 0</td> <td>0</td> <td></td> <td>0</td> <td>Exemption</td> <td>42,516</td> <td>-4,003.00</td> </tr> <tr> <td>TIF Project ID</td> <td>0</td> <td>Total Value 430,548</td> <td>386,511</td> <td></td> <td>42,516</td> <td>Total Taxable</td> <td>0</td> <td>596.00</td> </tr> </tbody> </table>										Source	REAL	Fair Cash	Capped	Asmnt Level	Assessed	Levy Rate	108.182	Current Tax	Remove Cap	2020	Land Value 3,581	3,581	11%	394	Assessed	42,516	4,599.45	Year Frozen	0	Improvements 426,967	382,930		42,122	Penalty	0		Uncapped Value	0	Mobile Home 0	0		0	Exemption	42,516	-4,003.00	TIF Project ID	0	Total Value 430,548	386,511		42,516	Total Taxable	0	596.00																																																																			
Source	REAL	Fair Cash	Capped	Asmnt Level	Assessed	Levy Rate	108.182	Current Tax																																																																																																																	
Remove Cap	2020	Land Value 3,581	3,581	11%	394	Assessed	42,516	4,599.45																																																																																																																	
Year Frozen	0	Improvements 426,967	382,930		42,122	Penalty	0																																																																																																																		
Uncapped Value	0	Mobile Home 0	0		0	Exemption	42,516	-4,003.00																																																																																																																	
TIF Project ID	0	Total Value 430,548	386,511		42,516	Total Taxable	0	596.00																																																																																																																	
Assessment History <table border="1"> <thead> <tr> <th>Tax Year</th> <th>Statement Number</th> <th>Billed Owner</th> <th>Tax Area</th> <th>Total Value</th> <th>Exemptions</th> <th>Taxable Value</th> <th>Billed Tax</th> </tr> </thead> <tbody> <tr><td>2025</td><td>2025-660092381</td><td>JOHNSON, DANIEL ALLEN &</td><td>10</td><td>414,360</td><td>41278</td><td></td><td>578.00</td></tr> <tr><td>2024</td><td>2024-660092381</td><td>JOHNSON, DANIEL ALLEN &</td><td>10</td><td>412,481</td><td>1000</td><td>39,076</td><td>4,107.00</td></tr> <tr><td>2023</td><td>2023-660092381</td><td>JOHNSON, DANIEL ALLEN &</td><td>10</td><td>386,814</td><td>1000</td><td>37,909</td><td>3,956.00</td></tr> <tr><td>2022</td><td>2022-660092381</td><td>JOHNSON, DANIEL ALLEN &</td><td>10</td><td>390,492</td><td>1000</td><td>36,775</td><td>3,820.00</td></tr> <tr><td>2021</td><td>2021-660092381</td><td>JOHNSON, DANIEL ALLEN &</td><td>10</td><td>333,410</td><td>1000</td><td>35,675</td><td>3,733.00</td></tr> <tr><td>2020</td><td>2020-660092381</td><td>JOHNSON, DANIEL ALLEN &</td><td>10</td><td>330,974</td><td>0</td><td>36,407</td><td>3,851.00</td></tr> <tr><td>2019</td><td>2019-660092381</td><td>MILLER, MICHAEL RAY &</td><td>10</td><td>271,414</td><td>1000</td><td>28,856</td><td>3,009.00</td></tr> <tr><td>2018</td><td>2018-660092381</td><td>MILLER, MICHAEL RAY &</td><td>10</td><td>280,008</td><td>1000</td><td>29,801</td><td>3,215.00</td></tr> <tr><td>2017</td><td>2017-660092381</td><td>MILLER, MICHAEL RAY &</td><td>10</td><td>277,163</td><td>1000</td><td>29,322</td><td>3,347.00</td></tr> <tr><td>2016</td><td>2016-660092381</td><td>MILLER, MICHAEL RAY &</td><td>10</td><td>269,216</td><td>1000</td><td>28,439</td><td>2,959.00</td></tr> <tr><td>2015</td><td>2015-660092381</td><td>MILLER, MICHAEL RAY &</td><td>10</td><td>259,828</td><td>1000</td><td>27,581</td><td>2,715.00</td></tr> <tr><td>2014</td><td>2014-660092381</td><td>MILLER, MICHAEL RAY &</td><td>10</td><td>262,876</td><td>1000</td><td>26,791</td><td>2,633.00</td></tr> <tr><td>2013</td><td>2013-660092381</td><td>MILLER, MICHAEL RAY &</td><td>10</td><td>245,284</td><td>1000</td><td>25,981</td><td>2,470.00</td></tr> </tbody> </table>										Tax Year	Statement Number	Billed Owner	Tax Area	Total Value	Exemptions	Taxable Value	Billed Tax	2025	2025-660092381	JOHNSON, DANIEL ALLEN &	10	414,360	41278		578.00	2024	2024-660092381	JOHNSON, DANIEL ALLEN &	10	412,481	1000	39,076	4,107.00	2023	2023-660092381	JOHNSON, DANIEL ALLEN &	10	386,814	1000	37,909	3,956.00	2022	2022-660092381	JOHNSON, DANIEL ALLEN &	10	390,492	1000	36,775	3,820.00	2021	2021-660092381	JOHNSON, DANIEL ALLEN &	10	333,410	1000	35,675	3,733.00	2020	2020-660092381	JOHNSON, DANIEL ALLEN &	10	330,974	0	36,407	3,851.00	2019	2019-660092381	MILLER, MICHAEL RAY &	10	271,414	1000	28,856	3,009.00	2018	2018-660092381	MILLER, MICHAEL RAY &	10	280,008	1000	29,801	3,215.00	2017	2017-660092381	MILLER, MICHAEL RAY &	10	277,163	1000	29,322	3,347.00	2016	2016-660092381	MILLER, MICHAEL RAY &	10	269,216	1000	28,439	2,959.00	2015	2015-660092381	MILLER, MICHAEL RAY &	10	259,828	1000	27,581	2,715.00	2014	2014-660092381	MILLER, MICHAEL RAY &	10	262,876	1000	26,791	2,633.00	2013	2013-660092381	MILLER, MICHAEL RAY &	10	245,284	1000	25,981	2,470.00
Tax Year	Statement Number	Billed Owner	Tax Area	Total Value	Exemptions	Taxable Value	Billed Tax																																																																																																																		
2025	2025-660092381	JOHNSON, DANIEL ALLEN &	10	414,360	41278		578.00																																																																																																																		
2024	2024-660092381	JOHNSON, DANIEL ALLEN &	10	412,481	1000	39,076	4,107.00																																																																																																																		
2023	2023-660092381	JOHNSON, DANIEL ALLEN &	10	386,814	1000	37,909	3,956.00																																																																																																																		
2022	2022-660092381	JOHNSON, DANIEL ALLEN &	10	390,492	1000	36,775	3,820.00																																																																																																																		
2021	2021-660092381	JOHNSON, DANIEL ALLEN &	10	333,410	1000	35,675	3,733.00																																																																																																																		
2020	2020-660092381	JOHNSON, DANIEL ALLEN &	10	330,974	0	36,407	3,851.00																																																																																																																		
2019	2019-660092381	MILLER, MICHAEL RAY &	10	271,414	1000	28,856	3,009.00																																																																																																																		
2018	2018-660092381	MILLER, MICHAEL RAY &	10	280,008	1000	29,801	3,215.00																																																																																																																		
2017	2017-660092381	MILLER, MICHAEL RAY &	10	277,163	1000	29,322	3,347.00																																																																																																																		
2016	2016-660092381	MILLER, MICHAEL RAY &	10	269,216	1000	28,439	2,959.00																																																																																																																		
2015	2015-660092381	MILLER, MICHAEL RAY &	10	259,828	1000	27,581	2,715.00																																																																																																																		
2014	2014-660092381	MILLER, MICHAEL RAY &	10	262,876	1000	26,791	2,633.00																																																																																																																		
2013	2013-660092381	MILLER, MICHAEL RAY &	10	245,284	1000	25,981	2,470.00																																																																																																																		



Rogers

Assessment Property Record Card for Tax Year 2026

Data provided by LISA DELOZIER County Assessor

Date 04/18/2026
 Time 06:48:49
 Page 2

Lot Data	Square-Foot - NBHD 4030 #1	Primary Image
Lot Size		
Lot Count		
Units Buildable		
Non-Ag Acres	0	
Topography		
Street Access		
Utilities		
Amenities	LAND QUALITY	
Method	Square-Foot	
Base Lot Value		
Factor Value		\\tsclient\C\Users\CB\Pictures\2020-05-14\IMG_0144.JPG 5/15/2020
Adjustments		
Lot Value		

Residential Data	
Type	1 Single Family Residence
Condition	3 - Average
Quality	4 - Good
Architecture	TRAD TRADITIONAL
Style	100% 1 1/2 Story Finished
Exterior Wall	90% Veneer, Masonry 10% Veneer, Stone
Base/Total Area	2,452 / 2,850
Style	100% 1 1/2 Story Finished
HVAC	100% Warmed & Cooled Air
Roof Cover	1 Composition Shingle
Area on Slab	2,452
Fixture/RghIn	18 /
Bed/F/H Bath	3 / 2.0 /
Basement Area	
Garage Type	808 Attached Garage - Finished
Remodel	
Year/Eff Age	2010 / 12

Cost Approach				Manual : 01/2025			
Base Cost	103.56	Total Misc Impr	+ 21,904	Roofing Adj	+ 5.02	Garage Cost	+ 45,983
Subfloor Adj	+ -3.96	Total RCN	= 444,629	Heat/Cool Adj	+ 16.31	Depreciation (12%)	- 53,355
Plumbing Adj	+ 11.26	Lump Sums	+ 0	Basement Adj	+ 0.00	RCNLD	= 391,274
Adj Base Cost	= 132.19	Lot Value	+ 391,274	Total Area	x 2,850	Indicated Value	= 391,274
		Value Per SqFt	137.29	Adjusted Cost	= 376,742		

GRM Approach	
GRM Code	
Gross Rent	0.00
Indicated Value	

Multiple Regression	
MRA Code	
Adusted R	
Indicated Value	

Direct Comparables	
Selection Model	A Adam Test
Adjustment Model	A2 AO Test
Comparables	
Indicated Value	

Value Reconciliation	
Selected Approach	Cost Approach
Improvements	391,274
Lot Value	
Indicated Value	391,274
Agland Value	3,581
Site Improvements	35,693
Total Value	430,548
	137.29 Per SqFt
	151.07 Total Value Per SqFt

Miscellaneous Improvements								
Code	Description	Sketch ID	Size	Year	Units	Unit Cost	Depr	Value
FPR1	FIREPLACE - RESIDENTIAL 1 STORY	0		1	1	7,243.87		7,244
PRCH	SLAB PORCH - COVERED	111946		186	186	32.34		6,015
PATO	SLAB PORCH - OPEN	111947	19x10		190	13.35		2,537
PRCH	SLAB PORCH - COVERED	111948	27x7		189	32.32		6,108



Rogers

Assessment Property Record Card for Tax Year 2026

Data provided by LISA DELOZIER County Assessor

Date 04/18/2026

Time 06:48:49

Page 3

Sketch Image

660092381

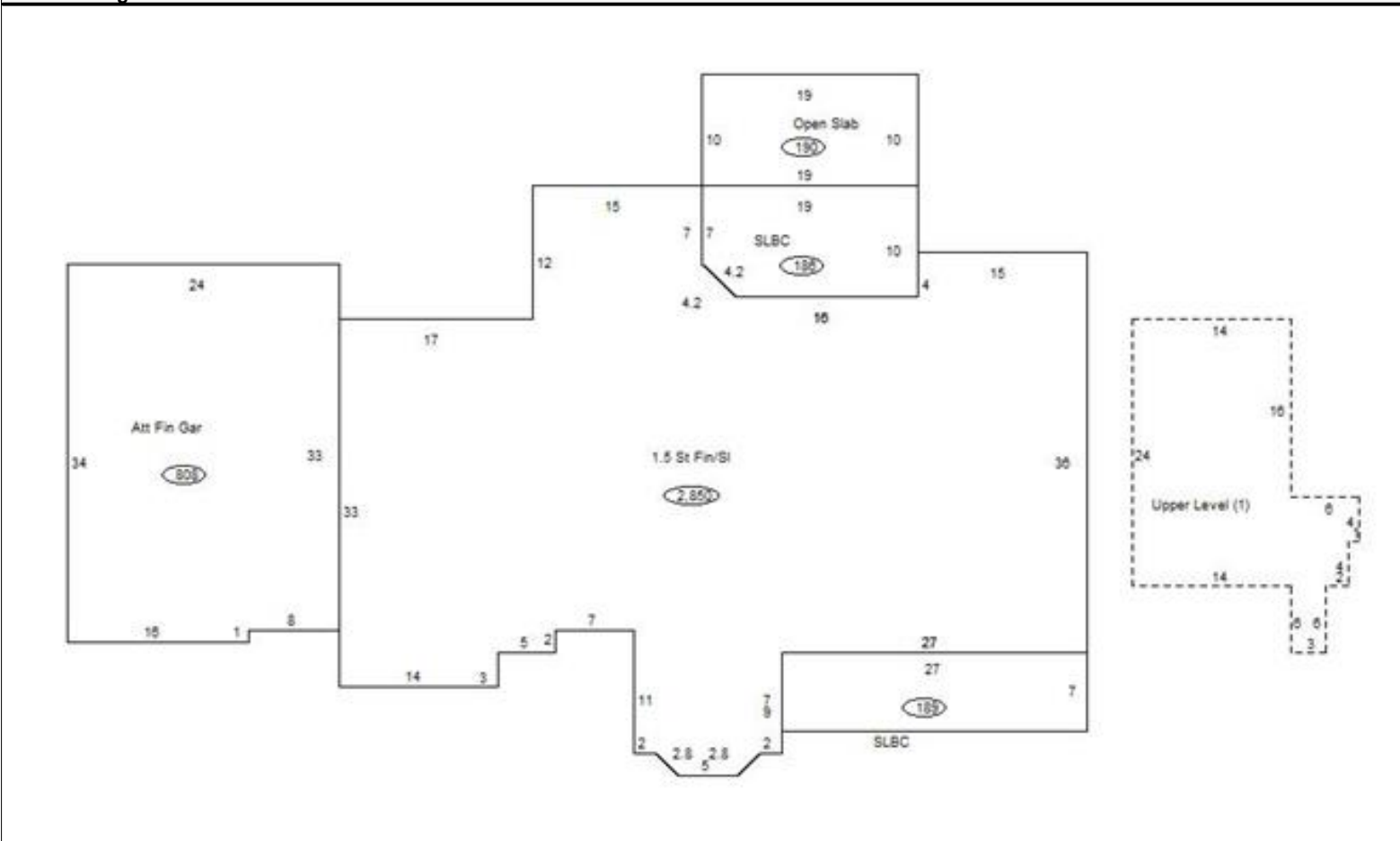

Sketch Vector Information

Sequence	Code	Type	Built Over	Scale	Section Label	Base Area	Multiplier	Total Area
1	R	5	Slab	13	1.5 St Fin/Sl	2,452	1.162	2,850
2	M	PRCH		13	SLBC	186	1.000	186
3	M	PATO		13	Open Slab	190	1.000	190
4	M	PRCH		13	SLBC	189	1.000	189
5	G	5		13	Att Fin Gar	808	1.000	808
6	U	^UL		13	Upper Level (1)	398	1.000	398
Total Building Area						2,452		2,850



Rogers

Assessment Property Record Card for Tax Year 2026

Data provided by LISA DELOZIER County Assessor

Date 04/18/2026
Time 06:48:50
Page 4

660092381

Outbuildings/Site Improvements

Building Image	Code	Description	Dimensions	Floor	Roofing	Total Units
	BNGP	Barn - General Purpose	60x38x10	Dirt	Formed Metal	2,280
	Qual 3	Cond 3	Year 2011	Eff Age 11		
		Valuation Summary	Modifier Total	RCN	Depr (22% Phys/ % Func)	RCNLD
		Base Cost (20.07 x 2,280)	45,760	45,760	10,067	35,693



Rogers

Assessment Property Record Card for Tax Year 2026

Data provided by LISA DELOZIER County Assessor

Date 04/18/2026
Time 06:48:50
Page 5

Agland Inventory

660092381

Soi	Description	Land Use	LPI	Adj Type	Adj Code	Acres	Use/Acre	Mkt/Acre	Use Value	Market Value
DBC	DENNIS-BATES COMPLEX 2-5%	NTV PST	60			24.870	144	144	3,581	3,581
NTV PST Totals						24.870			3,581	3,581
Total Agland						24.870			3,581	3,581