



Rogers

Assessment Property Record Card for Tax Year 2026

Data provided by LISA DELOZIER County Assessor

Date 04/18/2026
Time 06:47:30
Page 1

Assessment Data					Primary Image																																																																																																																				
Account 660092933 Parcel ID 000000-00-0-00454-008-0007 Cadastral ID 10-21-14-05400 Property Type REAL - Real Property Property Class URP VI Area 4 Tax Area 40 - OWASSO CITY Name ID 337231 LUO, JONATHAN 15204 E 109TH ST N OWASSO OK 74055-0000 Parcel Location Situs 15204 E 109TH ST N Subdivision LAKE VALLEY IV Lot/Block 0007 / 0008 Parcel Size 1 - Lots Sec/Twn/Rng 10 / 21 / 14 / 5 Neighborhood 1059 - R-V04-SW OWASSO School District S021 - OWASSO SCHOOLS																																																																																																																									
Legal Description Lot/Long: 36.31184564 -95.80429775																																																																																																																									
Building Permits					<table border="1"> <thead> <tr> <th>Number</th> <th>Description</th> <th>Opened</th> <th>Closed</th> <th>Amount</th> </tr> </thead> <tbody> <tr> <td>10-1018X</td> <td>R12-NEW 1670 SQ FT SFR</td> <td>11/2010</td> <td>03/2011</td> <td>86,250</td> </tr> </tbody> </table>					Number	Description	Opened	Closed	Amount	10-1018X	R12-NEW 1670 SQ FT SFR	11/2010	03/2011	86,250																																																																																																						
Number	Description	Opened	Closed	Amount																																																																																																																					
10-1018X	R12-NEW 1670 SQ FT SFR	11/2010	03/2011	86,250																																																																																																																					
Exemptions					Sale History																																																																																																																				
<table border="1"> <thead> <tr> <th>Code</th> <th>Type</th> <th>Active</th> <th>Maximum</th> <th>Exemption</th> </tr> </thead> <tbody> <tr> <td></td> <td></td> <td></td> <td></td> <td></td> </tr> </tbody> </table>					Code	Type	Active	Maximum	Exemption						<table border="1"> <thead> <tr> <th>Bk/Pg</th> <th>Grantor</th> <th>Date</th> <th>Price</th> <th>Code</th> </tr> </thead> <tbody> <tr> <td>/</td> <td>RHOADES, JING LIU</td> <td>01/10/2022</td> <td>233,000</td> <td>YES</td> </tr> <tr> <td>2160/29</td> <td>CAPITAL HOMES RES GROUP-LLC</td> <td>02/11/2011</td> <td>149,000</td> <td>YES</td> </tr> <tr> <td>2124/602</td> <td>LAKE VALLEY INVESTMENT-GROUP I</td> <td>07/28/2010</td> <td>0</td> <td>4</td> </tr> </tbody> </table>					Bk/Pg	Grantor	Date	Price	Code	/	RHOADES, JING LIU	01/10/2022	233,000	YES	2160/29	CAPITAL HOMES RES GROUP-LLC	02/11/2011	149,000	YES	2124/602	LAKE VALLEY INVESTMENT-GROUP I	07/28/2010	0	4																																																																																		
Code	Type	Active	Maximum	Exemption																																																																																																																					
Bk/Pg	Grantor	Date	Price	Code																																																																																																																					
/	RHOADES, JING LIU	01/10/2022	233,000	YES																																																																																																																					
2160/29	CAPITAL HOMES RES GROUP-LLC	02/11/2011	149,000	YES																																																																																																																					
2124/602	LAKE VALLEY INVESTMENT-GROUP I	07/28/2010	0	4																																																																																																																					
Parcel Valuation																																																																																																																									
<table border="1"> <thead> <tr> <th>Source</th> <th>REAL</th> </tr> </thead> <tbody> <tr> <td>Remove Cap</td> <td>2023</td> </tr> <tr> <td>Year Frozen</td> <td>0</td> </tr> <tr> <td>Uncapped Value</td> <td>0</td> </tr> <tr> <td>TIF Project ID</td> <td>0</td> </tr> </tbody> </table>		Source	REAL	Remove Cap	2023	Year Frozen	0	Uncapped Value	0	TIF Project ID	0	<table border="1"> <thead> <tr> <th>Fair Cash</th> <th>Capped</th> <th>Asmnt Level</th> <th>Assessed</th> </tr> </thead> <tbody> <tr> <td>Land Value</td> <td>32,362</td> <td>32,362</td> <td>3,560</td> </tr> <tr> <td>Improvements</td> <td>207,387</td> <td>207,387</td> <td>22,813</td> </tr> <tr> <td>Mobile Home</td> <td>0</td> <td>0</td> <td>0</td> </tr> <tr> <td>Total Value</td> <td>239,749</td> <td>239,749</td> <td>26,373</td> </tr> </tbody> </table>			Fair Cash	Capped	Asmnt Level	Assessed	Land Value	32,362	32,362	3,560	Improvements	207,387	207,387	22,813	Mobile Home	0	0	0	Total Value	239,749	239,749	26,373	<table border="1"> <thead> <tr> <th>Levy Rate</th> <th>Current Tax</th> </tr> </thead> <tbody> <tr> <td>97.960</td> <td></td> </tr> <tr> <td>Assessed</td> <td>26,373</td> </tr> <tr> <td>Penalty</td> <td>0</td> </tr> <tr> <td>Exemption</td> <td>0</td> </tr> <tr> <td>Total Taxable</td> <td>26,373</td> </tr> </tbody> </table>		Levy Rate	Current Tax	97.960		Assessed	26,373	Penalty	0	Exemption	0	Total Taxable	26,373																																																																									
Source	REAL																																																																																																																								
Remove Cap	2023																																																																																																																								
Year Frozen	0																																																																																																																								
Uncapped Value	0																																																																																																																								
TIF Project ID	0																																																																																																																								
Fair Cash	Capped	Asmnt Level	Assessed																																																																																																																						
Land Value	32,362	32,362	3,560																																																																																																																						
Improvements	207,387	207,387	22,813																																																																																																																						
Mobile Home	0	0	0																																																																																																																						
Total Value	239,749	239,749	26,373																																																																																																																						
Levy Rate	Current Tax																																																																																																																								
97.960																																																																																																																									
Assessed	26,373																																																																																																																								
Penalty	0																																																																																																																								
Exemption	0																																																																																																																								
Total Taxable	26,373																																																																																																																								
Assessment History																																																																																																																									
<table border="1"> <thead> <tr> <th>Tax Year</th> <th>Statement Number</th> <th>Billed Owner</th> <th>Tax Area</th> <th>Total Value</th> <th>Exemptions</th> <th>Taxable Value</th> <th>Billed Tax</th> </tr> </thead> <tbody> <tr><td>2025</td><td>2025-660092933</td><td>LUO, JONATHAN</td><td>40</td><td>231,490</td><td>0</td><td>25,464</td><td>2,494.00</td></tr> <tr><td>2024</td><td>2024-660092933</td><td>LUO, JONATHAN</td><td>40</td><td>247,423</td><td>0</td><td>26,911</td><td>2,585.00</td></tr> <tr><td>2023</td><td>2023-660092933</td><td>LUO, JONATHAN</td><td>40</td><td>233,000</td><td>0</td><td>25,630</td><td>2,402.00</td></tr> <tr><td>2022</td><td>2022-660092933</td><td>LUO, JONATHAN</td><td>40</td><td>215,765</td><td>0</td><td>21,303</td><td>2,087.00</td></tr> <tr><td>2021</td><td>2021-660092933</td><td>RHOADES, SIDNEY E &</td><td>40</td><td>184,439</td><td>0</td><td>20,288</td><td>1,963.00</td></tr> <tr><td>2020</td><td>2020-660092933</td><td>RHOADES, SIDNEY E &</td><td>40</td><td>179,624</td><td>0</td><td>19,759</td><td>1,911.00</td></tr> <tr><td>2019</td><td>2019-660092933</td><td>RHOADES, SIDNEY E &</td><td>40</td><td>172,615</td><td>0</td><td>18,988</td><td>1,839.00</td></tr> <tr><td>2018</td><td>2018-660092933</td><td>RHOADES, SIDNEY E &</td><td>40</td><td>172,230</td><td>0</td><td>18,945</td><td>1,767.00</td></tr> <tr><td>2017</td><td>2017-660092933</td><td>RHOADES, SIDNEY E &</td><td>40</td><td>170,890</td><td>0</td><td>18,798</td><td>1,769.00</td></tr> <tr><td>2016</td><td>2016-660092933</td><td>RHOADES, SIDNEY E &</td><td>40</td><td>166,563</td><td>0</td><td>18,322</td><td>1,732.00</td></tr> <tr><td>2015</td><td>2015-660092933</td><td>RHOADES, SIDNEY E &</td><td>40</td><td>163,180</td><td>0</td><td>17,950</td><td>1,711.00</td></tr> <tr><td>2014</td><td>2014-660092933</td><td>RHOADES, SIDNEY E &</td><td>40</td><td>164,448</td><td>0</td><td>18,089</td><td>1,743.00</td></tr> <tr><td>2013</td><td>2013-660092933</td><td>RHOADES, SIDNEY E &</td><td>40</td><td>159,910</td><td>0</td><td>17,560</td><td>1,655.00</td></tr> </tbody> </table>										Tax Year	Statement Number	Billed Owner	Tax Area	Total Value	Exemptions	Taxable Value	Billed Tax	2025	2025-660092933	LUO, JONATHAN	40	231,490	0	25,464	2,494.00	2024	2024-660092933	LUO, JONATHAN	40	247,423	0	26,911	2,585.00	2023	2023-660092933	LUO, JONATHAN	40	233,000	0	25,630	2,402.00	2022	2022-660092933	LUO, JONATHAN	40	215,765	0	21,303	2,087.00	2021	2021-660092933	RHOADES, SIDNEY E &	40	184,439	0	20,288	1,963.00	2020	2020-660092933	RHOADES, SIDNEY E &	40	179,624	0	19,759	1,911.00	2019	2019-660092933	RHOADES, SIDNEY E &	40	172,615	0	18,988	1,839.00	2018	2018-660092933	RHOADES, SIDNEY E &	40	172,230	0	18,945	1,767.00	2017	2017-660092933	RHOADES, SIDNEY E &	40	170,890	0	18,798	1,769.00	2016	2016-660092933	RHOADES, SIDNEY E &	40	166,563	0	18,322	1,732.00	2015	2015-660092933	RHOADES, SIDNEY E &	40	163,180	0	17,950	1,711.00	2014	2014-660092933	RHOADES, SIDNEY E &	40	164,448	0	18,089	1,743.00	2013	2013-660092933	RHOADES, SIDNEY E &	40	159,910	0	17,560	1,655.00
Tax Year	Statement Number	Billed Owner	Tax Area	Total Value	Exemptions	Taxable Value	Billed Tax																																																																																																																		
2025	2025-660092933	LUO, JONATHAN	40	231,490	0	25,464	2,494.00																																																																																																																		
2024	2024-660092933	LUO, JONATHAN	40	247,423	0	26,911	2,585.00																																																																																																																		
2023	2023-660092933	LUO, JONATHAN	40	233,000	0	25,630	2,402.00																																																																																																																		
2022	2022-660092933	LUO, JONATHAN	40	215,765	0	21,303	2,087.00																																																																																																																		
2021	2021-660092933	RHOADES, SIDNEY E &	40	184,439	0	20,288	1,963.00																																																																																																																		
2020	2020-660092933	RHOADES, SIDNEY E &	40	179,624	0	19,759	1,911.00																																																																																																																		
2019	2019-660092933	RHOADES, SIDNEY E &	40	172,615	0	18,988	1,839.00																																																																																																																		
2018	2018-660092933	RHOADES, SIDNEY E &	40	172,230	0	18,945	1,767.00																																																																																																																		
2017	2017-660092933	RHOADES, SIDNEY E &	40	170,890	0	18,798	1,769.00																																																																																																																		
2016	2016-660092933	RHOADES, SIDNEY E &	40	166,563	0	18,322	1,732.00																																																																																																																		
2015	2015-660092933	RHOADES, SIDNEY E &	40	163,180	0	17,950	1,711.00																																																																																																																		
2014	2014-660092933	RHOADES, SIDNEY E &	40	164,448	0	18,089	1,743.00																																																																																																																		
2013	2013-660092933	RHOADES, SIDNEY E &	40	159,910	0	17,560	1,655.00																																																																																																																		



Rogers

Assessment Property Record Card for Tax Year 2026

Data provided by LISA DELOZIER County Assessor

Date 04/18/2026
Time 06:47:30
Page 2

Lot Data		Square-Foot - NBHD 1059 #1	
Lot Size			
Lot Count	1		
Units Buildable	1		
Non-Ag Acres	0.1402		
Topography			
Street Access			
Utilities			
Amenities		0	
		0	
Method	Square-Foot		
Base Lot Value	6,106.00 x 5.30 = 32,362		
Factor Value			
Adjustments	1.0000		
Lot Value	32,362		



\\tsclient\T\LOGAN\LOGAN RESIDENTIAL VI\2022-8-10\IMG_002! 8/10/2022

Residential Data	
Type	1 Single Family Residence
Condition	3 - Average
Quality	3 - Average
Architecture	
Style	100% One Story
Exterior Wall	10% Veneer, Masonry 90% Frame, Siding, Wood
Base/Total Area	1,680 / 1,680
Style	100% One Story
HVAC	100% Warmed & Cooled Air
Roof Cover	1 Composition Shingle
Area on Slab	1,680
Fixture/RghIn	11 /
Bed/F/H Bath	3 / 2.0 /
Basement Area	
Garage Type	400 Attached Garage - Unfinished
Remodel	
Year/Eff Age	2011 / 11

GRM Approach	
GRM Code	
Gross Rent	0.00
Indicated Value	

Multiple Regression			
MRA Code	1	Test	
Adusted R	0.8445		
Indicated Value	223,620	133.11	Per SqFt

Direct Comparables			
Selection Model	A	Adam Test	
Adjustment Model	1	2022 Residential	
Comparables	8		
Indicated Value	241,100		Per SqFt

Cost Approach		Manual : 01/2025	
Base Cost	103.74	Total Misc Impr	+ 4,109
Roofing Adj	+ 4.87	Garage Cost	+ 13,584
Subfloor Adj	+ -2.31	Total RCN	= 233,019
Heat/Cool Adj	+ 12.64	Depreciation (11%)	- 25,632
Plumbing Adj	+ 9.23	Lump Sums	+ 0
Basement Adj	+ 0.00	RCNLD	= 207,387
Adj Base Cost	= 128.17	Lot Value	+ 32,362
Total Area	x 1,680	Indicated Value	= 239,749
Adjusted Cost	= 215,326	Value Per SqFt	142.71

Value Reconciliation			
Selected Approach	Cost Approach		
Improvements	207,387		
Lot Value	32,362		
Indicated Value	239,749	142.71	Per SqFt
Agland Value			
Site Improvements			
Total Value	239,749	142.71	Total Value Per SqFt

Miscellaneous Improvements								
Code	Description	Sketch ID	Size	Year	Units	Unit Cost	Depr	Value
PRCH	SLAB PORCH - COVERED	112289	12x6		72	26.70		1,922
PRCH	SLAB PORCH - COVERED	112291	82		82	26.67		2,187



Rogers

Assessment Property Record Card for Tax Year 2026

Data provided by LISA DELOZIER County Assessor

Date 04/18/2026

Time 06:47:30

Page 3

Sketch Image

660092933

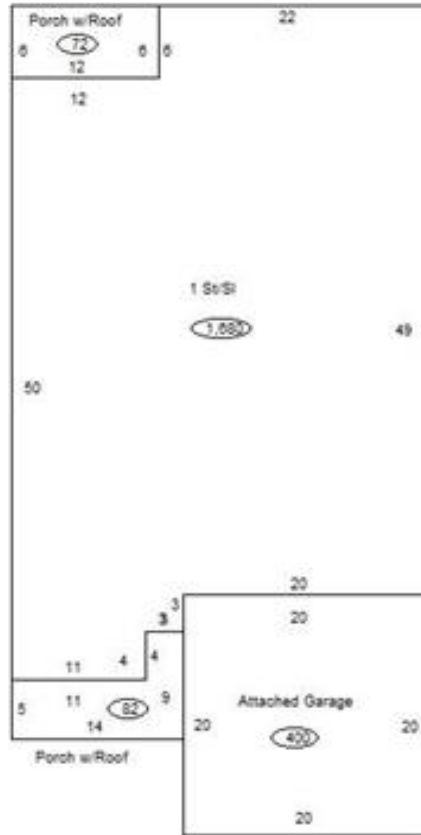

Sketch Vector Information

Sequence	Code	Type	Built Over	Scale	Section Label	Base Area	Multiplier	Total Area
1	R	1	Slab	13	1 St/SI	1,680	1.000	1,680
2	M	PRCH		13	SLBC	72	1.000	72
3	G	1		13	Attached Garage	400	1.000	400
4	M	PRCH		13	SLBC	82	1.000	82
Total Building Area						1,680		1,680