



# Rogers

## Assessment Property Record Card for Tax Year 2026

Data provided by LISA DELOZIER County Assessor

Date 04/18/2026  
Time 06:53:38  
Page 1

Assessment Data					Primary Image																																																																																																																				
<b>Account</b> 660092940 <b>Parcel ID</b> 000000-00-0-00454-009-0005 <b>Cadastral ID</b> 10-21-14-05470 <b>Property Type</b> REAL - Real Property <b>Property Class</b> URP VI Area 4 <b>Tax Area</b> 40 - OWASSO CITY <b>Name ID</b> 304584 SOLIS, JOSEPH L &  MELINDA R 10913 N 154TH E AVE OWASSO OK 74055-0000																																																																																																																									
<b>Parcel Location</b> <b>Situs</b> 10913 N 154TH E AVE <b>Subdivision</b> LAKE VALLEY IV <b>Lot/Block</b> 0005 / 0009 <b>Parcel Size</b> 1 - Lots <b>Sec/Twn/Rng</b> 10 / 21 / 14 / 5 <b>Neighborhood</b> 1059 - R-V04-SW OWASSO <b>School District</b> S021 - OWASSO SCHOOLS																																																																																																																									
<b>Legal Description</b> Lot/Long: 36.31266539 -95.80345076					<b>Building Permits</b> <table border="1"> <thead> <tr> <th>Number</th> <th>Description</th> <th>Opened</th> <th>Closed</th> <th>Amount</th> </tr> </thead> <tbody> <tr> <td>10-1207X</td> <td>R12-NEW 1527 SQ FT SFR</td> <td>01/2011</td> <td>05/2011</td> <td>91,620</td> </tr> </tbody> </table>					Number	Description	Opened	Closed	Amount	10-1207X	R12-NEW 1527 SQ FT SFR	01/2011	05/2011	91,620																																																																																																						
Number	Description	Opened	Closed	Amount																																																																																																																					
10-1207X	R12-NEW 1527 SQ FT SFR	01/2011	05/2011	91,620																																																																																																																					
<b>Exemptions</b> <table border="1"> <thead> <tr> <th>Code</th> <th>Type</th> <th>Active</th> <th>Maximum</th> <th>Exemption</th> </tr> </thead> <tbody> <tr> <td colspan="5">LOT 5 BLOCK 9 LAKE VALLEY IV</td> </tr> </tbody> </table>					Code	Type	Active	Maximum	Exemption	LOT 5 BLOCK 9 LAKE VALLEY IV					<b>Sale History</b> <table border="1"> <thead> <tr> <th>Bk/Pg</th> <th>Grantor</th> <th>Date</th> <th>Price</th> <th>Code</th> </tr> </thead> <tbody> <tr> <td>2164/529</td> <td>SIMMONS HOMES RESIDENTIAL</td> <td>03/24/2011</td> <td>137,500</td> <td>YES</td> </tr> <tr> <td>2129/859</td> <td>LAKE VALLEY INVESTMENT-GROUP I</td> <td>09/22/2010</td> <td>0</td> <td>4</td> </tr> </tbody> </table>					Bk/Pg	Grantor	Date	Price	Code	2164/529	SIMMONS HOMES RESIDENTIAL	03/24/2011	137,500	YES	2129/859	LAKE VALLEY INVESTMENT-GROUP I	09/22/2010	0	4																																																																																							
Code	Type	Active	Maximum	Exemption																																																																																																																					
LOT 5 BLOCK 9 LAKE VALLEY IV																																																																																																																									
Bk/Pg	Grantor	Date	Price	Code																																																																																																																					
2164/529	SIMMONS HOMES RESIDENTIAL	03/24/2011	137,500	YES																																																																																																																					
2129/859	LAKE VALLEY INVESTMENT-GROUP I	09/22/2010	0	4																																																																																																																					
<b>Parcel Valuation</b> <table border="1"> <thead> <tr> <th>Source</th> <th>REAL</th> <th>Fair Cash</th> <th>Capped</th> <th>Asmnt Level</th> <th>Assessed</th> <th>Levy Rate</th> <th>97.960</th> <th>Current Tax</th> </tr> </thead> <tbody> <tr> <td>Remove Cap</td> <td>0</td> <td>Land Value 31,376</td> <td>31,376</td> <td>11%</td> <td>3,451</td> <td>Assessed</td> <td>22,893</td> <td>2,242.60</td> </tr> <tr> <td>Year Frozen</td> <td>0</td> <td>Improvements 177,463</td> <td>176,744</td> <td></td> <td>19,442</td> <td>Penalty</td> <td>0</td> <td></td> </tr> <tr> <td>Uncapped Value</td> <td>0</td> <td>Mobile Home 0</td> <td>0</td> <td></td> <td>0</td> <td>Exemption</td> <td>0</td> <td>0.00</td> </tr> <tr> <td>TIF Project ID</td> <td>0</td> <td>Total Value 208,839</td> <td>208,120</td> <td></td> <td>22,893</td> <td>Total Taxable</td> <td>22,893</td> <td>2,243.00</td> </tr> </tbody> </table>										Source	REAL	Fair Cash	Capped	Asmnt Level	Assessed	Levy Rate	97.960	Current Tax	Remove Cap	0	Land Value 31,376	31,376	11%	3,451	Assessed	22,893	2,242.60	Year Frozen	0	Improvements 177,463	176,744		19,442	Penalty	0		Uncapped Value	0	Mobile Home 0	0		0	Exemption	0	0.00	TIF Project ID	0	Total Value 208,839	208,120		22,893	Total Taxable	22,893	2,243.00																																																																			
Source	REAL	Fair Cash	Capped	Asmnt Level	Assessed	Levy Rate	97.960	Current Tax																																																																																																																	
Remove Cap	0	Land Value 31,376	31,376	11%	3,451	Assessed	22,893	2,242.60																																																																																																																	
Year Frozen	0	Improvements 177,463	176,744		19,442	Penalty	0																																																																																																																		
Uncapped Value	0	Mobile Home 0	0		0	Exemption	0	0.00																																																																																																																	
TIF Project ID	0	Total Value 208,839	208,120		22,893	Total Taxable	22,893	2,243.00																																																																																																																	
<b>Assessment History</b> <table border="1"> <thead> <tr> <th>Tax Year</th> <th>Statement Number</th> <th>Billed Owner</th> <th>Tax Area</th> <th>Total Value</th> <th>Exemptions</th> <th>Taxable Value</th> <th>Billed Tax</th> </tr> </thead> <tbody> <tr><td>2025</td><td>2025-660092940</td><td>SOLIS, JOSEPH L &amp;</td><td>40</td><td>201,869</td><td>0</td><td>21,803</td><td>2,136.00</td></tr> <tr><td>2024</td><td>2024-660092940</td><td>SOLIS, JOSEPH L &amp;</td><td>40</td><td>216,317</td><td>0</td><td>20,765</td><td>1,995.00</td></tr> <tr><td>2023</td><td>2023-660092940</td><td>SOLIS, JOSEPH L &amp;</td><td>40</td><td>197,824</td><td>0</td><td>19,776</td><td>1,853.00</td></tr> <tr><td>2022</td><td>2022-660092940</td><td>SOLIS, JOSEPH L &amp;</td><td>40</td><td>189,600</td><td>0</td><td>18,834</td><td>1,845.00</td></tr> <tr><td>2021</td><td>2021-660092940</td><td>SOLIS, JOSEPH L &amp;</td><td>40</td><td>163,069</td><td>0</td><td>17,938</td><td>1,735.00</td></tr> <tr><td>2020</td><td>2020-660092940</td><td>SOLIS, JOSEPH L &amp;</td><td>40</td><td>158,645</td><td>0</td><td>17,451</td><td>1,688.00</td></tr> <tr><td>2019</td><td>2019-660092940</td><td>SOLIS, JOSEPH L &amp;</td><td>40</td><td>152,681</td><td>0</td><td>16,795</td><td>1,626.00</td></tr> <tr><td>2018</td><td>2018-660092940</td><td>SOLIS, JOSEPH L &amp;</td><td>40</td><td>153,229</td><td>0</td><td>16,855</td><td>1,572.00</td></tr> <tr><td>2017</td><td>2017-660092940</td><td>SOLIS, JOSEPH L &amp;</td><td>40</td><td>152,030</td><td>0</td><td>16,723</td><td>1,574.00</td></tr> <tr><td>2016</td><td>2016-660092940</td><td>SOLIS, JOSEPH L &amp;</td><td>40</td><td>148,347</td><td>0</td><td>16,318</td><td>1,542.00</td></tr> <tr><td>2015</td><td>2015-660092940</td><td>SOLIS, JOSEPH L &amp;</td><td>40</td><td>145,506</td><td>0</td><td>16,006</td><td>1,526.00</td></tr> <tr><td>2014</td><td>2014-660092940</td><td>SOLIS, JOSEPH L &amp;</td><td>40</td><td>146,607</td><td>0</td><td>16,127</td><td>1,554.00</td></tr> <tr><td>2013</td><td>2013-660092940</td><td>SOLIS, JOSEPH L &amp;</td><td>40</td><td>143,352</td><td>0</td><td>15,741</td><td>1,483.00</td></tr> </tbody> </table>										Tax Year	Statement Number	Billed Owner	Tax Area	Total Value	Exemptions	Taxable Value	Billed Tax	2025	2025-660092940	SOLIS, JOSEPH L &	40	201,869	0	21,803	2,136.00	2024	2024-660092940	SOLIS, JOSEPH L &	40	216,317	0	20,765	1,995.00	2023	2023-660092940	SOLIS, JOSEPH L &	40	197,824	0	19,776	1,853.00	2022	2022-660092940	SOLIS, JOSEPH L &	40	189,600	0	18,834	1,845.00	2021	2021-660092940	SOLIS, JOSEPH L &	40	163,069	0	17,938	1,735.00	2020	2020-660092940	SOLIS, JOSEPH L &	40	158,645	0	17,451	1,688.00	2019	2019-660092940	SOLIS, JOSEPH L &	40	152,681	0	16,795	1,626.00	2018	2018-660092940	SOLIS, JOSEPH L &	40	153,229	0	16,855	1,572.00	2017	2017-660092940	SOLIS, JOSEPH L &	40	152,030	0	16,723	1,574.00	2016	2016-660092940	SOLIS, JOSEPH L &	40	148,347	0	16,318	1,542.00	2015	2015-660092940	SOLIS, JOSEPH L &	40	145,506	0	16,006	1,526.00	2014	2014-660092940	SOLIS, JOSEPH L &	40	146,607	0	16,127	1,554.00	2013	2013-660092940	SOLIS, JOSEPH L &	40	143,352	0	15,741	1,483.00
Tax Year	Statement Number	Billed Owner	Tax Area	Total Value	Exemptions	Taxable Value	Billed Tax																																																																																																																		
2025	2025-660092940	SOLIS, JOSEPH L &	40	201,869	0	21,803	2,136.00																																																																																																																		
2024	2024-660092940	SOLIS, JOSEPH L &	40	216,317	0	20,765	1,995.00																																																																																																																		
2023	2023-660092940	SOLIS, JOSEPH L &	40	197,824	0	19,776	1,853.00																																																																																																																		
2022	2022-660092940	SOLIS, JOSEPH L &	40	189,600	0	18,834	1,845.00																																																																																																																		
2021	2021-660092940	SOLIS, JOSEPH L &	40	163,069	0	17,938	1,735.00																																																																																																																		
2020	2020-660092940	SOLIS, JOSEPH L &	40	158,645	0	17,451	1,688.00																																																																																																																		
2019	2019-660092940	SOLIS, JOSEPH L &	40	152,681	0	16,795	1,626.00																																																																																																																		
2018	2018-660092940	SOLIS, JOSEPH L &	40	153,229	0	16,855	1,572.00																																																																																																																		
2017	2017-660092940	SOLIS, JOSEPH L &	40	152,030	0	16,723	1,574.00																																																																																																																		
2016	2016-660092940	SOLIS, JOSEPH L &	40	148,347	0	16,318	1,542.00																																																																																																																		
2015	2015-660092940	SOLIS, JOSEPH L &	40	145,506	0	16,006	1,526.00																																																																																																																		
2014	2014-660092940	SOLIS, JOSEPH L &	40	146,607	0	16,127	1,554.00																																																																																																																		
2013	2013-660092940	SOLIS, JOSEPH L &	40	143,352	0	15,741	1,483.00																																																																																																																		



# Rogers

## Assessment Property Record Card for Tax Year 2026

Data provided by LISA DELOZIER County Assessor

Date 04/18/2026  
Time 06:53:38  
Page 2

Lot Data	Square-Foot - NBHD 1059 #1	Primary Image
Lot Size		
Lot Count	1	
Units Buildable	1	
Non-Ag Acres	0.1359	
Topography		
Street Access		
Utilities		
Amenities	0	
	0	
Method	Square-Foot	
Base Lot Value	5,920.00 x 5.30 = 31,376	
Factor Value		
Adjustments	1.0000	
Lot Value	31,376	

Residential Data	
Type	1 Single Family Residence
Condition	3 - Average
Quality	2.5 - Fair
Architecture	
Style	100% One Story
Exterior Wall	10% Veneer, Masonry 90% Frame, Siding, Wood
Base/Total Area	1,528 / 1,528
Style	100% One Story
HVAC	100% Warmed & Cooled Air
Roof Cover	1 Composition Shingle
Area on Slab	1,528
Fixture/RghIn	11 /
Bed/F/H Bath	3 / 2.0 /
Basement Area	
Garage Type	440 Attached Garage - Unfinished
Remodel	
Year/Eff Age	2011 / 11



\\tsclient\T\LOGAN\LOGAN RESIDENTIAL VI\2022-7-27\IMG\_001 7/27/2022

GRM Approach	
GRM Code	
Gross Rent	0.00
Indicated Value	

Multiple Regression			
MRA Code	1	Test	
Adusted R	0.8445		
Indicated Value	197,258	129.10	Per SqFt

Direct Comparables			
Selection Model	A	Adam Test	
Adjustment Model	1	2022 Residential	
Comparables	8		
Indicated Value	204,860		Per SqFt

Cost Approach				Manual : 01/2025			
Base Cost	98.55	Total Misc Impr	+	1,889			
Roofing Adj	+ 4.49	Garage Cost	+	12,487			
Subfloor Adj	+ -1.15	Total RCN	=	201,663			
Heat/Cool Adj	+ 11.47	Depreciation ( 12%)	-	24,200			
Plumbing Adj	+ 9.21	Lump Sums	+	0			
Basement Adj	+ 0.00	RCNLD	=	177,463			
Adj Base Cost	= 122.57	Lot Value	+	31,376			
Total Area	x 1,528	Indicated Value	=	208,839			
Adjusted Cost	= 187,287	Value Per SqFt		136.67			

Value Reconciliation			
Selected Approach	Cost Approach		
Improvements	177,463		
Lot Value	31,376		
Indicated Value	208,839	136.67	Per SqFt
Agland Value			
Site Improvements			
Total Value	208,839	136.67	Total Value Per SqFt

Miscellaneous Improvements								
Code	Description	Sketch ID	Size	Year	Units	Unit Cost	Depr	Value
PATO	SLAB PORCH - OPEN	112314	12x8		96	10.86		1,043
PRCH	SLAB PORCH - COVERED	112316	7x5		35	24.16		846



# Rogers

## Assessment Property Record Card for Tax Year 2026

Data provided by LISA DELOZIER County Assessor

Date 04/18/2026  
 Time 06:53:38  
 Page 3

Sketch Image

660092940

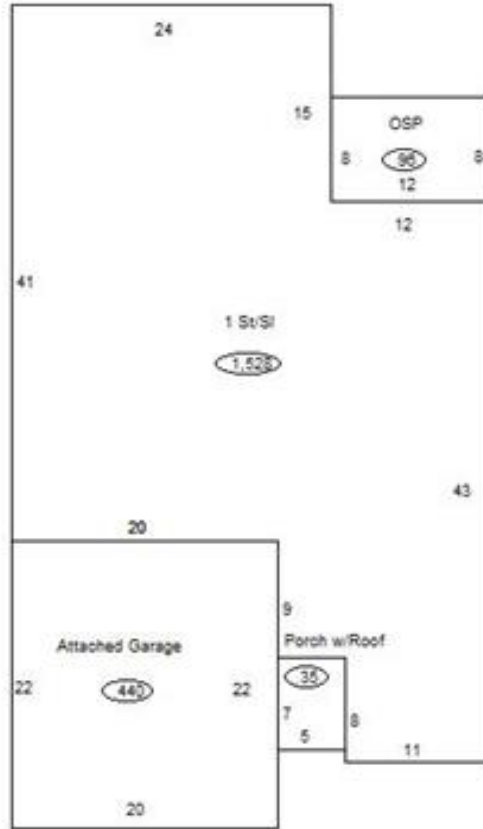

### Sketch Vector Information

Sequence	Code	Type	Built Over	Scale	Section Label	Base Area	Multiplier	Total Area
1	R	1	Slab	13	1 St/Sl	1,528	1.000	1,528
2	M	PATO		13	Open Slab	96	1.000	96
3	G	1		13	Attached Garage	440	1.000	440
4	M	PRCH		13	SLBC	35	1.000	35
<b>Total Building Area</b>						1,528		1,528