



Rogers

Assessment Property Record Card for Tax Year 2026

Data provided by LISA DELOZIER County Assessor

Date 04/18/2026
Time 08:06:01
Page 1

Assessment Data					Primary Image																																																																																																																				
Account 660093410 Parcel ID 24N15E-23-3-00000-000-0000 Cadastral ID 23-24-15-00510 Property Type REAL - Real Property Property Class RR VI Area 2 Tax Area 10 - OOLOGAH RURAL/NW FIRE Name ID 348462 CONTU, LINDA D AKA LINDA D TILLERY RICKY & LINDA CONTU TRUST PO BOX 1012 OOLOGAH OK 74053-0000																																																																																																																									
Parcel Location Situs 04919 S 4110 RD Subdivision Lot/Block / Parcel Size 1 - Acres Sec/Twn/Rng 23 / 24 / 15 / 3 Neighborhood 4040 - TALALA AREA WEST OF LAKE School District S004 - OOLOGAH SCHOOLS																																																																																																																									
Legal Description Lat/Long: 36.54045036 -95.68623210 W 290.4' S 150' N2 S2 SW SW.					Building Permits <table border="1"> <thead> <tr> <th>Number</th> <th>Description</th> <th>Opened</th> <th>Closed</th> <th>Amount</th> </tr> </thead> <tbody> <tr> <td>R2011 04 5</td> <td>R12-NEW 1364 SQ FT SFR</td> <td>04/2011</td> <td>11/2011</td> <td>85,000</td> </tr> </tbody> </table>					Number	Description	Opened	Closed	Amount	R2011 04 5	R12-NEW 1364 SQ FT SFR	04/2011	11/2011	85,000																																																																																																						
Number	Description	Opened	Closed	Amount																																																																																																																					
R2011 04 5	R12-NEW 1364 SQ FT SFR	04/2011	11/2011	85,000																																																																																																																					
Exemptions <table border="1"> <thead> <tr> <th>Code</th> <th>Type</th> <th>Active</th> <th>Maximum</th> <th>Exemption</th> </tr> </thead> <tbody> <tr> <td></td> <td></td> <td></td> <td></td> <td></td> </tr> </tbody> </table>					Code	Type	Active	Maximum	Exemption						Sale History <table border="1"> <thead> <tr> <th>Bk/Pg</th> <th>Grantor</th> <th>Date</th> <th>Price</th> <th>Code</th> </tr> </thead> <tbody> <tr> <td>/</td> <td>CONTU, RICKY R & LINDA D</td> <td>10/14/2025</td> <td></td> <td>4</td> </tr> <tr> <td>/</td> <td>CONTU, RICKY R &</td> <td>06/30/2021</td> <td>0</td> <td>WB</td> </tr> </tbody> </table>					Bk/Pg	Grantor	Date	Price	Code	/	CONTU, RICKY R & LINDA D	10/14/2025		4	/	CONTU, RICKY R &	06/30/2021	0	WB																																																																																							
Code	Type	Active	Maximum	Exemption																																																																																																																					
Bk/Pg	Grantor	Date	Price	Code																																																																																																																					
/	CONTU, RICKY R & LINDA D	10/14/2025		4																																																																																																																					
/	CONTU, RICKY R &	06/30/2021	0	WB																																																																																																																					
Parcel Valuation <table border="1"> <thead> <tr> <th>Source</th> <th>REAL</th> <th>Fair Cash</th> <th>Capped</th> <th>Asmnt Level</th> <th>Assessed</th> <th>Levy Rate</th> <th>108.182</th> <th>Current Tax</th> </tr> </thead> <tbody> <tr> <td>Remove Cap</td> <td>0</td> <td>Land Value 22,975</td> <td>22,975</td> <td>11%</td> <td>2,527</td> <td>Assessed</td> <td>20,362</td> <td>2,202.79</td> </tr> <tr> <td>Year Frozen</td> <td>0</td> <td>Improvements 162,134</td> <td>162,134</td> <td></td> <td>17,835</td> <td>Penalty</td> <td>0</td> <td></td> </tr> <tr> <td>Uncapped Value</td> <td>0</td> <td>Mobile Home 0</td> <td>0</td> <td></td> <td>0</td> <td>Exemption</td> <td>0</td> <td>0.00</td> </tr> <tr> <td>TIF Project ID</td> <td>0</td> <td>Total Value 185,109</td> <td>185,109</td> <td></td> <td>20,362</td> <td>Total Taxable</td> <td>20,362</td> <td>2,203.00</td> </tr> </tbody> </table>										Source	REAL	Fair Cash	Capped	Asmnt Level	Assessed	Levy Rate	108.182	Current Tax	Remove Cap	0	Land Value 22,975	22,975	11%	2,527	Assessed	20,362	2,202.79	Year Frozen	0	Improvements 162,134	162,134		17,835	Penalty	0		Uncapped Value	0	Mobile Home 0	0		0	Exemption	0	0.00	TIF Project ID	0	Total Value 185,109	185,109		20,362	Total Taxable	20,362	2,203.00																																																																			
Source	REAL	Fair Cash	Capped	Asmnt Level	Assessed	Levy Rate	108.182	Current Tax																																																																																																																	
Remove Cap	0	Land Value 22,975	22,975	11%	2,527	Assessed	20,362	2,202.79																																																																																																																	
Year Frozen	0	Improvements 162,134	162,134		17,835	Penalty	0																																																																																																																		
Uncapped Value	0	Mobile Home 0	0		0	Exemption	0	0.00																																																																																																																	
TIF Project ID	0	Total Value 185,109	185,109		20,362	Total Taxable	20,362	2,203.00																																																																																																																	
Assessment History <table border="1"> <thead> <tr> <th>Tax Year</th> <th>Statement Number</th> <th>Billed Owner</th> <th>Tax Area</th> <th>Total Value</th> <th>Exemptions</th> <th>Taxable Value</th> <th>Billed Tax</th> </tr> </thead> <tbody> <tr><td>2025</td><td>2025-660093410</td><td>CONTU, RICKY R & LINDA D</td><td>10</td><td>191,369</td><td>0</td><td>20,501</td><td>2,218.00</td></tr> <tr><td>2024</td><td>2024-660093410</td><td>CONTU, RICKY R & LINDA D</td><td>10</td><td>193,321</td><td>0</td><td>19,525</td><td>2,045.00</td></tr> <tr><td>2023</td><td>2023-660093410</td><td>CONTU, RICKY R & LINDA D</td><td>10</td><td>175,102</td><td>0</td><td>18,596</td><td>1,934.00</td></tr> <tr><td>2022</td><td>2022-660093410</td><td>CONTU, RICKY R & LINDA D</td><td>10</td><td>176,751</td><td>0</td><td>17,710</td><td>1,833.00</td></tr> <tr><td>2021</td><td>2021-660093410</td><td>CONTU, RICKY R & LINDA D</td><td>10</td><td>153,335</td><td>0</td><td>16,867</td><td>1,758.00</td></tr> <tr><td>2020</td><td>2020-660093410</td><td>CONTU, RICKY R &</td><td>10</td><td>147,909</td><td>0</td><td>16,093</td><td>1,702.00</td></tr> <tr><td>2019</td><td>2019-660093410</td><td>CONTU, RICKY R &</td><td>10</td><td>139,332</td><td>0</td><td>15,327</td><td>1,590.00</td></tr> <tr><td>2018</td><td>2018-660093410</td><td>CONTU, RICKY R &</td><td>10</td><td>134,825</td><td>0</td><td>14,831</td><td>1,593.00</td></tr> <tr><td>2017</td><td>2017-660093410</td><td>CONTU, RICKY R &</td><td>10</td><td>133,606</td><td>0</td><td>14,697</td><td>1,671.00</td></tr> <tr><td>2016</td><td>2016-660093410</td><td>CONTU, RICKY R &</td><td>10</td><td>129,824</td><td>0</td><td>14,281</td><td>1,479.00</td></tr> <tr><td>2015</td><td>2015-660093410</td><td>CONTU, RICKY R &</td><td>10</td><td>127,008</td><td>0</td><td>13,971</td><td>1,369.00</td></tr> <tr><td>2014</td><td>2014-660093410</td><td>CONTU, RICKY R &</td><td>10</td><td>128,108</td><td>0</td><td>13,648</td><td>1,336.00</td></tr> <tr><td>2013</td><td>2013-660093410</td><td>CONTU, RICKY R &</td><td>10</td><td>119,884</td><td>0</td><td>12,998</td><td>1,230.00</td></tr> </tbody> </table>										Tax Year	Statement Number	Billed Owner	Tax Area	Total Value	Exemptions	Taxable Value	Billed Tax	2025	2025-660093410	CONTU, RICKY R & LINDA D	10	191,369	0	20,501	2,218.00	2024	2024-660093410	CONTU, RICKY R & LINDA D	10	193,321	0	19,525	2,045.00	2023	2023-660093410	CONTU, RICKY R & LINDA D	10	175,102	0	18,596	1,934.00	2022	2022-660093410	CONTU, RICKY R & LINDA D	10	176,751	0	17,710	1,833.00	2021	2021-660093410	CONTU, RICKY R & LINDA D	10	153,335	0	16,867	1,758.00	2020	2020-660093410	CONTU, RICKY R &	10	147,909	0	16,093	1,702.00	2019	2019-660093410	CONTU, RICKY R &	10	139,332	0	15,327	1,590.00	2018	2018-660093410	CONTU, RICKY R &	10	134,825	0	14,831	1,593.00	2017	2017-660093410	CONTU, RICKY R &	10	133,606	0	14,697	1,671.00	2016	2016-660093410	CONTU, RICKY R &	10	129,824	0	14,281	1,479.00	2015	2015-660093410	CONTU, RICKY R &	10	127,008	0	13,971	1,369.00	2014	2014-660093410	CONTU, RICKY R &	10	128,108	0	13,648	1,336.00	2013	2013-660093410	CONTU, RICKY R &	10	119,884	0	12,998	1,230.00
Tax Year	Statement Number	Billed Owner	Tax Area	Total Value	Exemptions	Taxable Value	Billed Tax																																																																																																																		
2025	2025-660093410	CONTU, RICKY R & LINDA D	10	191,369	0	20,501	2,218.00																																																																																																																		
2024	2024-660093410	CONTU, RICKY R & LINDA D	10	193,321	0	19,525	2,045.00																																																																																																																		
2023	2023-660093410	CONTU, RICKY R & LINDA D	10	175,102	0	18,596	1,934.00																																																																																																																		
2022	2022-660093410	CONTU, RICKY R & LINDA D	10	176,751	0	17,710	1,833.00																																																																																																																		
2021	2021-660093410	CONTU, RICKY R & LINDA D	10	153,335	0	16,867	1,758.00																																																																																																																		
2020	2020-660093410	CONTU, RICKY R &	10	147,909	0	16,093	1,702.00																																																																																																																		
2019	2019-660093410	CONTU, RICKY R &	10	139,332	0	15,327	1,590.00																																																																																																																		
2018	2018-660093410	CONTU, RICKY R &	10	134,825	0	14,831	1,593.00																																																																																																																		
2017	2017-660093410	CONTU, RICKY R &	10	133,606	0	14,697	1,671.00																																																																																																																		
2016	2016-660093410	CONTU, RICKY R &	10	129,824	0	14,281	1,479.00																																																																																																																		
2015	2015-660093410	CONTU, RICKY R &	10	127,008	0	13,971	1,369.00																																																																																																																		
2014	2014-660093410	CONTU, RICKY R &	10	128,108	0	13,648	1,336.00																																																																																																																		
2013	2013-660093410	CONTU, RICKY R &	10	119,884	0	12,998	1,230.00																																																																																																																		



Rogers

Assessment Property Record Card for Tax Year 2026

Data provided by LISA DELOZIER County Assessor

Date 04/18/2026
Time 08:06:01
Page 2

Lot Data	Square-Foot - NBHD 4040 #1	Primary Image
Lot Size Lot Count Units Buildable 1 Non-Ag Acres 1.1097 Topography Street Access Utilities Amenities LAND QUALITY 0 0 Method Square-Foot Base Lot Value 48,340.00 x .48 = 22,975 Factor Value Adjustments 1.0000 Lot Value 22,975		

Residential Data	
Type	1 Single Family Residence
Condition	3 - Average
Quality	2.5 - Fair
Architecture	
Style	100% One Story
Exterior Wall	100% Frame, Siding, Wood
Base/Total Area	1,440 / 1,440
Style	100% One Story
HVAC	100% Warmed & Cooled Air
Roof Cover	1 Composition Shingle
Area on Slab	1,440
Fixture/RghIn	4 /
Bed/F/H Bath	2 / 1.0 /
Basement Area	
Garage Type	
Remodel	
Year/Eff Age	2011 / 11

GRM Approach
GRM Code Gross Rent 0.00 Indicated Value

Multiple Regression
MRA Code 1 Test Adusted R 0.8445 Indicated Value 152,537 105.93 Per SqFt

Direct Comparables
Selection Model 1 Res Adjustment Model A2 AO Test Comparables Indicated Value

Cost Approach				Manual : 01/2025			
Base Cost	90.73	Total Misc Impr	+ 27,499				
Roofing Adj	+ 4.18	Garage Cost	+ 184,243				
Subfloor Adj	+ -1.11	Total RCN	= 22,109				
Heat/Cool Adj	+ 11.24	Depreciation (12%)	- 0				
Plumbing Adj	+ 3.80	Lump Sums	+ 162,134				
Basement Adj	+ 0.00	RCNLD	= 22,975				
Adj Base Cost	= 108.85	Lot Value	+ 185,109				
Total Area	x 1,440	Indicated Value	= 128.55				
Adjusted Cost	= 156,744	Value Per SqFt					

Value Reconciliation
Selected Approach Cost Approach Improvements 162,134 Lot Value 22,975 Indicated Value 185,109 128.55 Per SqFt Agland Value Site Improvements Total Value 185,109 128.55 Total Value Per SqFt

Miscellaneous Improvements							
Code	Description	Sketch ID	Size	Year	Units	Unit Cost	Depr Value
SHLT	STORM SHELTER	0		1 2016	1	0.00	
PRCH	SLAB PORCH - COVERED	112529	33x8		264	22.89	6,043
PRCH	SLAB PORCH - COVERED	112530	24x24		576	22.17	12,770
PRCH	SLAB PORCH - COVERED	112531	48x8		384	22.62	8,686



Rogers

Assessment Property Record Card for Tax Year 2026

Data provided by LISA DELOZIER County Assessor

Date 04/18/2026
 Time 08:06:01
 Page 3

Sketch Image

660093410

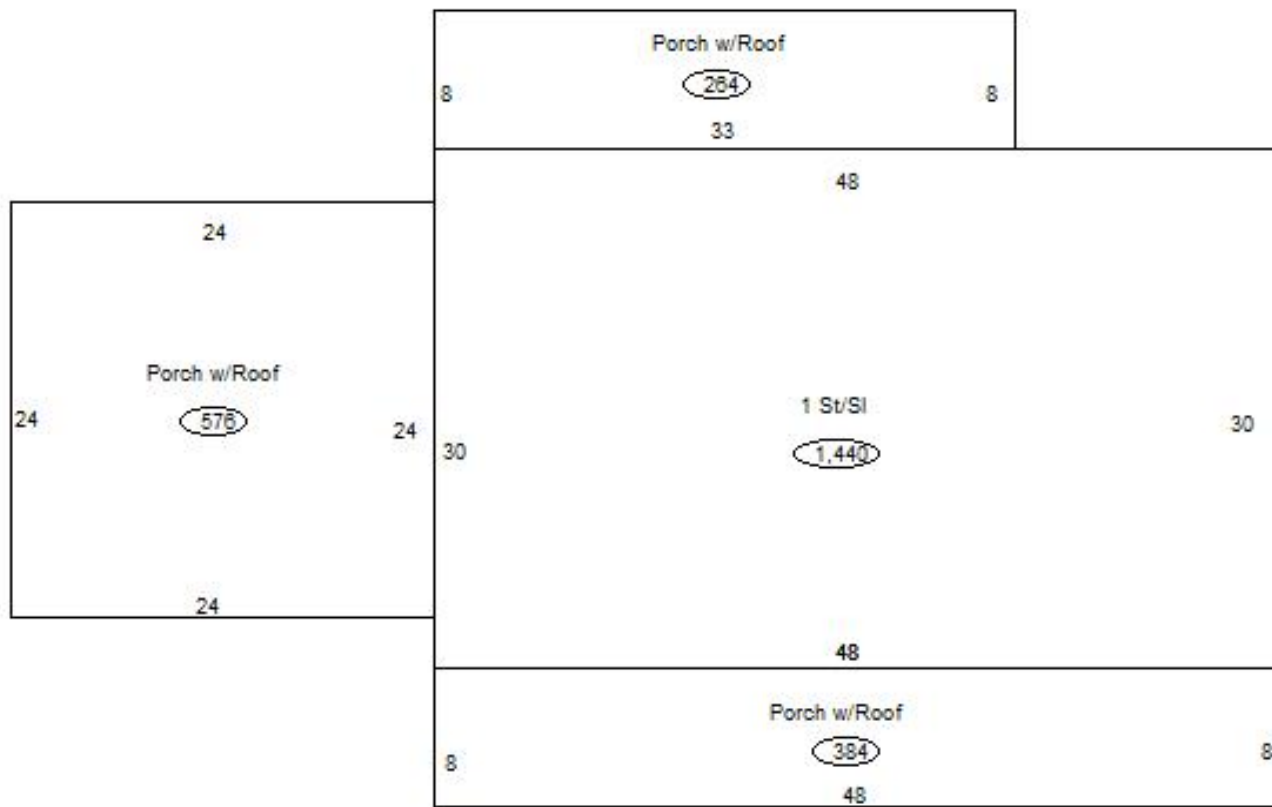

Sketch Vector Information

Sequence	Code	Type	Built Over	Scale	Section Label	Base Area	Multiplier	Total Area
1	R	1	Slab	13	1 St/Sl	1,440	1.000	1,440
2	M	PRCH		13	SLBC	264	1.000	264
3	M	PRCH		13	SLBC	576	1.000	576
4	M	PRCH		13	SLBC	384	1.000	384
Total Building Area						1,440		1,440



Rogers

Assessment Property Record Card for Tax Year 2026

Data provided by LISA DELOZIER County Assessor

Date 04/18/2026
Time 08:06:01
Page 4

660093410

Outbuildings/Site Improvements

Building Image	Code	Description	Dimensions	Floor	Roofing	Total Units
	SHLT	STORM SHELTER	0x0x0			
	Qual	Cond	Year	Eff Age		
			0			
			0			
			0			
Valuation Summary		Modifier Total	RCN	Depr (0% Phys/ % Func)	RCNLD	
Base Cost (0.00 x)						