



Rogers

Assessment Property Record Card for Tax Year 2026

Data provided by LISA DELOZIER County Assessor

Date 04/18/2026
Time 07:43:36
Page 1

Assessment Data					Primary Image				
Account	660093451								
Parcel ID	22N16E-13-3-00000-000-0000								
Cadastral ID	13-22-16-00411								
Property Type	REAL - Real Property								
Property Class	RC	VI Area	1						
Tax Area	75 - SEQUOYAH/FOYIL FD								
Name ID	304657								
LESTER, DONNY & SHANNON									
DBA CENTRAL VALVE BODIES									
15551 S HWY 66 CLAREMORE OK 74017-0000									
Parcel Location									
Situs									
Subdivision									
Lot/Block	/	Parcel Size	.52 - Acres						
Sec/Twn/Rng	13 / 22 / 16 / 3								
Neighborhood	5001 - TASC 2016								
School District	S006 - SEQUOYAH SCHOOLS								
Legal Description					Building Permits				
Lat/Long: 36.38655026 -95.55272630					Number	Description	Opened	Closed	Amount
TR IN N2 NE NE SW DESC AS: COMM NE/C, S00-01-27E ON E/LINE 329.27' TO POB; S89-55-38W ON S/LINE 22.51'; N63-22-06W 469.55 TO ELY ROW HWY 66; N 27-29-04E ON ROW 46.91'L S63-31-50E 469.83' TO E/L OF SAID N2; TH S00-01-27E 42.65' TO POB.					R12	POSSIBLE NEW CONSTRUCTION?	11/2011	03/2012	
Exemptions					Sale History				
Code	Type	Active	Maximum	Exemption	Bk/Pg	Grantor	Date	Price	Code
					2149/826	MCKNIGHT, MICHAEL D &	12/29/2010	50,000	YES
Parcel Valuation									
Source	REAL		Fair Cash	Capped	Asmnt Level	Assessed	Levy Rate	101.310	Current Tax
Remove Cap	2011	Land Value	28,498	28,498	11%	3,135	Assessed	8,262	837.02
Year Frozen	0	Improvements	99,932	46,608		5,127	Penalty	0	
Uncapped Value	0	Mobile Home	0	0		0	Exemption	0	0.00
TIF Project ID	0	Total Value	128,430	75,106		8,262	Total Taxable	8,262	837.00
Assessment History									
Tax Year	Statement Number	Billed Owner			Tax Area	Total Value	Exemptions	Taxable Value	Billed Tax
2025	2025-660093451	LESTER, DONNY & SHANNON			75	134,357	0	7,869	797.00
2024	2024-660093451	LESTER, DONNY & SHANNON			75	68,124	0	7,494	764.00
2023	2023-660093451	LESTER, DONNY & SHANNON			75	132,803	0	8,088	842.00
2022	2022-660093451	LESTER, DONNY & SHANNON			75	130,120	0	7,703	819.00
2021	2021-660093451	LESTER, DONNY & SHANNON			75	103,146	0	7,336	758.00
2020	2020-660093451	LESTER, DONNY & SHANNON			75	103,146	0	6,988	748.00
2019	2019-660093451	LESTER, DONNY & SHANNON			75	94,219	0	6,655	706.00
2018	2018-660093451	LESTER, DONNY & SHANNON			75	94,599	0	6,338	676.00
2017	2017-660093451	LESTER, DONNY & SHANNON			75	94,599	0	6,036	640.00
2016	2016-660093451	LESTER, DONNY & SHANNON			75	94,599	0	5,749	608.00
2015	2015-660093451	LESTER, DONNY & SHANNON			75	49,775	0	5,475	589.00
2014	2014-660093451	LESTER, DONNY & SHANNON			75	49,775	0	5,475	598.00
2013	2013-660093451	LESTER, DONNY & SHANNON			75	49,775	0	5,475	584.00



Rogers

Assessment Property Record Card for Tax Year 2026

Data provided by LISA DELOZIER County Assessor

Date 04/18/2026
 Time 07:43:36
 Page 2

Lot Data		Primary Image	
Lot Size	0 x 0		
Lot Count	0		
Units Buildable	0.52		
Non-Ag Acres	0.523		
Topography			
Street Access			
Utilities			
Amenities	0		
	0		
Value Model	1835 COMM		
Value Method	Square-Foot		
Base Lot Value	22,798.00 x 1.25 =	28,498	
Factor Value	0		
Adjustments			
Lot Value	28,498		
Cost Approach		Image Information	
Manual Date	01/2025	Image ID	1034075
Total Building Area	2,485	Image Date	10/19/2023
Total Base Value	213,508	Name	IMG_0006.JPG
Modifier Value		Description	REVAL 2024
Misc Improvements			
Replacement Cost New	213,508		
Phys/Func Depreciation Loss	()		
RCN Less Phys/Func	99,932		
Economic Depreciation			
RCNLD (All Sources)	99,932		
Depreciated Improvements			
Outbuilding Value			
Total Improvement Value	99,932		
Land Value	28,498		
Cost Approach Value	128,430	51.68/SqFt	
Income Approach		Value Reconciliation	
Potential Gross Income (PGI)		Selected Valuation Method	Cost Approach
Vacancy & Collection Loss		Total Improvement Value	
Miscellaneous Income		Land Value	28,498
Effective Gross Income (EGI)		Total Appraised Value	128,430 51.68/SqFt
Total Expenses			
Net Operating Income (NOI)			
Income Capitalization Rate			
Indicated Value	0.00		



Rogers

Assessment Property Record Card for Tax Year 2026

Data provided by LISA DELOZIER County Assessor

Date 04/18/2026

Time 07:43:36

Page 3

Sketch Image

660093451

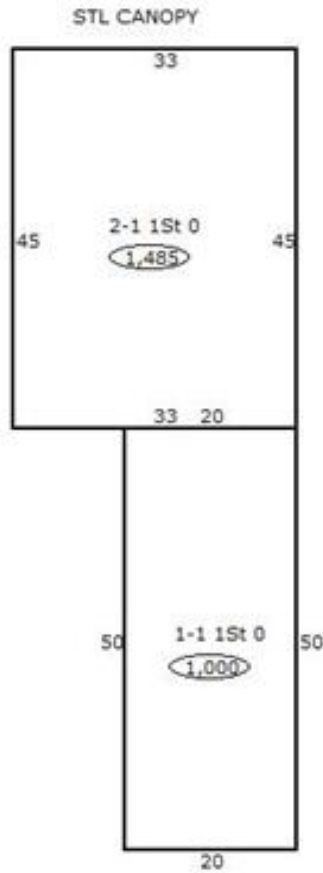

Sketch Vector Information

Sequence	Code	Type	Built Over	Scale	Section Label	Base Area	Multiplier	Total Area
1	C	406		20	2-1 1St 0	1,485	1.000	1,485
2	C	406		20	1-1 1St 0	1,000	1.000	1,000
3	N	0		20	STL CANOPY		0.000	
Total Building Area						2,485		2,485



Rogers

Assessment Property Record Card for Tax Year 2026

Data provided by LISA DELOZIER County Assessor

Date 04/18/2026
Time 07:43:36
Page 4

Account 660093451
Parcel ID 22N16E-13-3-00000-000-0000
Cadastral ID 13-22-16-00411

Tax Area Code 75
Property Class RC
Owners Name LESTER, DONNY & SHANNON

Building Data

Building ID 2782
Building Sequence 1
Occupancy 1 406 Storage Warehouse 100%
Occupancy 2
Occupancy 3
Total Floor Area 1,000
Average Perimeter 140
Number Of Storys 1.00
Average Wall Ht 12.00
Year Built 1980
Effective Age 30
Construction Class 3 - Unreinforced Masonry Walls, Wood Joists
Quality 1 - Low
Condition 2 - Fair
Exterior Wall 12 - Concrete Block
Heating/Cooling 7 - Package Unit
Roof Type Gable
Roof Cover

Basement Area
Basement Levels
Basement Finish
Finish Code - 1
Finish Area - 1
Finish Code - 2
Finish Area - 2

Building Image



Image Information

Image Name IMG_0006.JPG
Image Date 10/19/2023
Image Name IMG_0006.JPG
Description REVAL 2024

Cost Calculations

Appraisal Zone 1
Zone Description
Base Cost 39.47
Wall Cost 56.05
HVAC Cost 12.33
Basement Cost 0.00
Total Base Cost 107.85
Total Area 1,000
Base RCN 107,850
Misc Impr Value

Manual Date 01/2025
Base Year 2026
Modifier Value
Total Replacement Cost 107,850
Physical Depreciation 72%
Functional Depreciation
Total Depreciation 72% (77,652)
Total RCNLD 30,198
Lump Sums
Total Building Value 30,198 \$ 30.20 Per SqFt



Rogers

Assessment Property Record Card for Tax Year 2026

Data provided by LISA DELOZIER County Assessor

Date 04/18/2026
Time 07:43:36
Page 5

Account 660093451
Parcel ID 22N16E-13-3-00000-000-0000
Cadastral ID 13-22-16-00411

Tax Area Code 75
Property Class RC
Owners Name LESTER, DONNY & SHANNON

Building Data

Building ID 2783
Building Sequence 2
Occupancy 1 406 Storage Warehouse 100%
Occupancy 2
Occupancy 3
Total Floor Area 1,485
Average Perimeter 156
Number Of Storys 1.00
Average Wall Ht 14.00
Year Built 1991
Effective Age 18
Construction Class 7 - Pre-Engineered Steel Frame
Quality 2 - Fair
Condition 3 - Average
Exterior Wall 88 - Stud Metal Siding
Heating/Cooling 15 - No HVAC
Roof Type Gable
Roof Cover

Basement Area
Basement Levels
Basement Finish
Finish Code - 1
Finish Area - 1
Finish Code - 2
Finish Area - 2

Building Image



Image Information

Image Name IMG_0006.JPG
Image Date 10/19/2023
Image Name IMG_0006.JPG
Description REVAL 2024

Cost Calculations

Appraisal Zone 1
Zone Description
Base Cost 43.18
Wall Cost 27.97
HVAC Cost 0.00
Basement Cost 0.00
Total Base Cost 71.15
Total Area 1,485
Base RCN 105,658
Misc Impr Value

Manual Date 01/2025
Base Year 2026
Modifier Value
Total Replacement Cost 105,658
Physical Depreciation 34%
Functional Depreciation
Total Depreciation 34% (35,924)
Total RCNLD 69,734
Lump Sums
Total Building Value 69,734 \$ 46.96 Per SqFt