



Rogers

Assessment Property Record Card for Tax Year 2026

Data provided by LISA DELOZIER County Assessor

Date 04/18/2026
 Time 07:14:59
 Page 1

Assessment Data					Primary Image																																																																																																																				
Account 660093583 Parcel ID 21N17E-03-1-00000-000-0000 Cadastral ID 03-21-17-00221 Property Type REAL - Real Property Property Class RA VI Area 3 Tax Area 94 - SEQUOYAH/TRI-DISTRICT FI Name ID 305080 HARSHA, AURORA H PO BOX 163 PRYOR OK 74362-0000 Parcel Location Situs 19702 E 470 RD Subdivision Lot/Block / Parcel Size 5 - Acres Sec/Twn/Rng 3 / 21 / 17 / 1 Neighborhood 2117 - UNPLATTED School District S006 - SEQUOYAH SCHOOLS					 <p>660093583 06/11/25</p> <p>660093583_006.JPG 6/24/2025</p>																																																																																																																				
Legal Description Lat/Long: 36.33544974 -95.47640479																																																																																																																									
Building Permits <table border="1"> <thead> <tr> <th>Number</th> <th>Description</th> <th>Opened</th> <th>Closed</th> <th>Amount</th> </tr> </thead> <tbody> <tr> <td colspan="5"> </td> </tr> </tbody> </table>					Number	Description	Opened	Closed	Amount																																																																																																																
Number	Description	Opened	Closed	Amount																																																																																																																					
Exemptions <table border="1"> <thead> <tr> <th>Code</th> <th>Type</th> <th>Active</th> <th>Maximum</th> <th>Exemption</th> </tr> </thead> <tbody> <tr> <td>H</td> <td>Homestead</td> <td>Yes</td> <td>1,000</td> <td>1,000</td> </tr> </tbody> </table>					Code	Type	Active	Maximum	Exemption	H	Homestead	Yes	1,000	1,000	Sale History <table border="1"> <thead> <tr> <th>Bk/Pg</th> <th>Grantor</th> <th>Date</th> <th>Price</th> <th>Code</th> </tr> </thead> <tbody> <tr> <td>2165/425</td> <td>LORRA, MICHAEL A & REGINA</td> <td>03/30/2011</td> <td>165,000</td> <td>11</td> </tr> </tbody> </table>					Bk/Pg	Grantor	Date	Price	Code	2165/425	LORRA, MICHAEL A & REGINA	03/30/2011	165,000	11																																																																																												
Code	Type	Active	Maximum	Exemption																																																																																																																					
H	Homestead	Yes	1,000	1,000																																																																																																																					
Bk/Pg	Grantor	Date	Price	Code																																																																																																																					
2165/425	LORRA, MICHAEL A & REGINA	03/30/2011	165,000	11																																																																																																																					
Parcel Valuation <table border="1"> <thead> <tr> <th>Source</th> <th>REAL</th> <th>Fair Cash</th> <th>Capped</th> <th>Asmnt Level</th> <th>Assessed</th> <th>Levy Rate</th> <th>98.320</th> <th>Current Tax</th> </tr> </thead> <tbody> <tr> <td>Remove Cap</td> <td>0</td> <td>Land Value 717</td> <td>717</td> <td>11%</td> <td>79</td> <td>Assessed</td> <td>12,532</td> <td>1,232.15</td> </tr> <tr> <td>Year Frozen</td> <td>0</td> <td>Improvements 113,777</td> <td>113,213</td> <td></td> <td>12,453</td> <td>Penalty</td> <td>0</td> <td></td> </tr> <tr> <td>Uncapped Value</td> <td>0</td> <td>Mobile Home 0</td> <td>0</td> <td></td> <td>0</td> <td>Exemption</td> <td>1,000</td> <td>-88.00</td> </tr> <tr> <td>TIF Project ID</td> <td>0</td> <td>Total Value 114,494</td> <td>113,930</td> <td></td> <td>12,532</td> <td>Total Taxable</td> <td>11,532</td> <td>1,144.00</td> </tr> </tbody> </table>										Source	REAL	Fair Cash	Capped	Asmnt Level	Assessed	Levy Rate	98.320	Current Tax	Remove Cap	0	Land Value 717	717	11%	79	Assessed	12,532	1,232.15	Year Frozen	0	Improvements 113,777	113,213		12,453	Penalty	0		Uncapped Value	0	Mobile Home 0	0		0	Exemption	1,000	-88.00	TIF Project ID	0	Total Value 114,494	113,930		12,532	Total Taxable	11,532	1,144.00																																																																			
Source	REAL	Fair Cash	Capped	Asmnt Level	Assessed	Levy Rate	98.320	Current Tax																																																																																																																	
Remove Cap	0	Land Value 717	717	11%	79	Assessed	12,532	1,232.15																																																																																																																	
Year Frozen	0	Improvements 113,777	113,213		12,453	Penalty	0																																																																																																																		
Uncapped Value	0	Mobile Home 0	0		0	Exemption	1,000	-88.00																																																																																																																	
TIF Project ID	0	Total Value 114,494	113,930		12,532	Total Taxable	11,532	1,144.00																																																																																																																	
Assessment History <table border="1"> <thead> <tr> <th>Tax Year</th> <th>Statement Number</th> <th>Billed Owner</th> <th>Tax Area</th> <th>Total Value</th> <th>Exemptions</th> <th>Taxable Value</th> <th>Billed Tax</th> </tr> </thead> <tbody> <tr><td>2025</td><td>2025-660093583</td><td>HARSHA, AURORA H</td><td>94</td><td>110,612</td><td>1000</td><td>11,167</td><td>1,108.00</td></tr> <tr><td>2024</td><td>2024-660093583</td><td>HARSHA, AURORA H</td><td>94</td><td>117,001</td><td>1000</td><td>11,870</td><td>1,259.00</td></tr> <tr><td>2023</td><td>2023-660093583</td><td>HARSHA, AURORA H</td><td>94</td><td>113,884</td><td>1000</td><td>11,527</td><td>1,246.00</td></tr> <tr><td>2022</td><td>2022-660093583</td><td>HARSHA, AURORA H</td><td>94</td><td>153,167</td><td>1000</td><td>15,226</td><td>1,658.00</td></tr> <tr><td>2021</td><td>2021-660093583</td><td>HARSHA, AURORA H</td><td>94</td><td>148,548</td><td>1000</td><td>14,753</td><td>1,553.00</td></tr> <tr><td>2020</td><td>2020-660093583</td><td>HARSHA, AURORA H</td><td>94</td><td>146,492</td><td>1000</td><td>14,295</td><td>1,500.00</td></tr> <tr><td>2019</td><td>2019-660093583</td><td>HARSHA, AURORA H</td><td>94</td><td>134,993</td><td>1000</td><td>13,849</td><td>1,433.00</td></tr> <tr><td>2018</td><td>2018-660093583</td><td>HARSHA, AURORA H</td><td>94</td><td>138,479</td><td>1000</td><td>14,233</td><td>1,488.00</td></tr> <tr><td>2017</td><td>2017-660093583</td><td>HARSHA, AURORA H</td><td>94</td><td>135,414</td><td>1000</td><td>13,896</td><td>1,434.00</td></tr> <tr><td>2016</td><td>2016-660093583</td><td>HARSHA, AURORA H</td><td>94</td><td>132,591</td><td>1000</td><td>13,585</td><td>1,397.00</td></tr> <tr><td>2015</td><td>2015-660093583</td><td>HARSHA, AURORA H</td><td>94</td><td>129,529</td><td>1000</td><td>13,248</td><td>1,391.00</td></tr> <tr><td>2014</td><td>2014-660093583</td><td>HARSHA, AURORA H</td><td>94</td><td>131,559</td><td>1000</td><td>13,471</td><td>1,388.00</td></tr> <tr><td>2013</td><td>2013-660093583</td><td>HARSHA, AURORA H</td><td>94</td><td>128,778</td><td>1000</td><td>13,166</td><td>1,337.00</td></tr> </tbody> </table>										Tax Year	Statement Number	Billed Owner	Tax Area	Total Value	Exemptions	Taxable Value	Billed Tax	2025	2025-660093583	HARSHA, AURORA H	94	110,612	1000	11,167	1,108.00	2024	2024-660093583	HARSHA, AURORA H	94	117,001	1000	11,870	1,259.00	2023	2023-660093583	HARSHA, AURORA H	94	113,884	1000	11,527	1,246.00	2022	2022-660093583	HARSHA, AURORA H	94	153,167	1000	15,226	1,658.00	2021	2021-660093583	HARSHA, AURORA H	94	148,548	1000	14,753	1,553.00	2020	2020-660093583	HARSHA, AURORA H	94	146,492	1000	14,295	1,500.00	2019	2019-660093583	HARSHA, AURORA H	94	134,993	1000	13,849	1,433.00	2018	2018-660093583	HARSHA, AURORA H	94	138,479	1000	14,233	1,488.00	2017	2017-660093583	HARSHA, AURORA H	94	135,414	1000	13,896	1,434.00	2016	2016-660093583	HARSHA, AURORA H	94	132,591	1000	13,585	1,397.00	2015	2015-660093583	HARSHA, AURORA H	94	129,529	1000	13,248	1,391.00	2014	2014-660093583	HARSHA, AURORA H	94	131,559	1000	13,471	1,388.00	2013	2013-660093583	HARSHA, AURORA H	94	128,778	1000	13,166	1,337.00
Tax Year	Statement Number	Billed Owner	Tax Area	Total Value	Exemptions	Taxable Value	Billed Tax																																																																																																																		
2025	2025-660093583	HARSHA, AURORA H	94	110,612	1000	11,167	1,108.00																																																																																																																		
2024	2024-660093583	HARSHA, AURORA H	94	117,001	1000	11,870	1,259.00																																																																																																																		
2023	2023-660093583	HARSHA, AURORA H	94	113,884	1000	11,527	1,246.00																																																																																																																		
2022	2022-660093583	HARSHA, AURORA H	94	153,167	1000	15,226	1,658.00																																																																																																																		
2021	2021-660093583	HARSHA, AURORA H	94	148,548	1000	14,753	1,553.00																																																																																																																		
2020	2020-660093583	HARSHA, AURORA H	94	146,492	1000	14,295	1,500.00																																																																																																																		
2019	2019-660093583	HARSHA, AURORA H	94	134,993	1000	13,849	1,433.00																																																																																																																		
2018	2018-660093583	HARSHA, AURORA H	94	138,479	1000	14,233	1,488.00																																																																																																																		
2017	2017-660093583	HARSHA, AURORA H	94	135,414	1000	13,896	1,434.00																																																																																																																		
2016	2016-660093583	HARSHA, AURORA H	94	132,591	1000	13,585	1,397.00																																																																																																																		
2015	2015-660093583	HARSHA, AURORA H	94	129,529	1000	13,248	1,391.00																																																																																																																		
2014	2014-660093583	HARSHA, AURORA H	94	131,559	1000	13,471	1,388.00																																																																																																																		
2013	2013-660093583	HARSHA, AURORA H	94	128,778	1000	13,166	1,337.00																																																																																																																		



Rogers

Assessment Property Record Card for Tax Year 2026

Data provided by LISA DELOZIER County Assessor

Date 04/18/2026
Time 07:15:00
Page 2

Lot Data	Square-Foot - NBHD 2117 #1	Primary Image
Lot Size Lot Count Units Buildable Non-Ag Acres 0 Topography Street Access Utilities Amenities LAND QUALITY Method Square-Foot Base Lot Value Factor Value Adjustments Lot Value		 <p>660093583 06/11/25</p> <p>660093583_006.JPG 6/24/2025</p>

Residential Data	
Type	1 Single Family Residence
Condition	3 - Average
Quality	2 - Fair
Architecture	
Style	100% One Story
Exterior Wall	60% Veneer, Masonry 40% Frame, Siding, Vinyl
Base/Total Area	1,540 / 1,540
Style	100% One Story
HVAC	100% Warmed & Cooled Air
Roof Cover	1 Composition Shingle
Area on Slab	1,540
Fixture/RghIn	4 /
Bed/F/H Bath	3 / 1.0 /
Basement Area	
Garage Type	
Remodel	
Year/Eff Age	1986 / 30

GRM Approach	
GRM Code	
Gross Rent	0.00
Indicated Value	

Multiple Regression			
MRA Code	1	Test	
Adusted R	0.8445		
Indicated Value	116,344	75.55	Per SqFt

Direct Comparables	
Selection Model	1 Res
Adjustment Model	A2 AO Test
Comparables	
Indicated Value	

Cost Approach				Manual : 01/2025			
Base Cost	92.44	Total Misc Impr	+ 12,840				
Roofing Adj	+ 3.94	Garage Cost	+ 0				
Subfloor Adj	+ 0.00	Total RCN	= 182,132				
Heat/Cool Adj	+ 10.30	Depreciation (42%)	- 76,495				
Plumbing Adj	+ 3.25	Lump Sums	+ 0				
Basement Adj	+ 0.00	RCNLD	= 105,637				
Adj Base Cost	= 109.93	Lot Value	+ 0				
Total Area	x 1,540	Indicated Value	= 105,637				
Adjusted Cost	= 169,292	Value Per SqFt	68.60				

Value Reconciliation			
Selected Approach	Cost Approach		
Improvements	105,637		
Lot Value			
Indicated Value	105,637	68.60	Per SqFt
Agland Value	717		
Site Improvements	8,140		
Total Value	114,494	74.35	Total Value Per SqFt

Miscellaneous Improvements								
Code	Description	Sketch ID	Size	Year	Units	Unit Cost	Depr	Value
FPR1	FIREPLACE - RESIDENTIAL 1 STORY	0		1	1	4,576.55		4,577
PRCH	SLAB PORCH - COVERED	112602	44x5		220	20.60		4,532
PRCH	SLAB PORCH - COVERED	135263	18x10		180	20.73		3,731



Rogers

Assessment Property Record Card for Tax Year 2026

Data provided by LISA DELOZIER County Assessor

Date 04/18/2026
 Time 07:15:00
 Page 3

Sketch Image

660093583

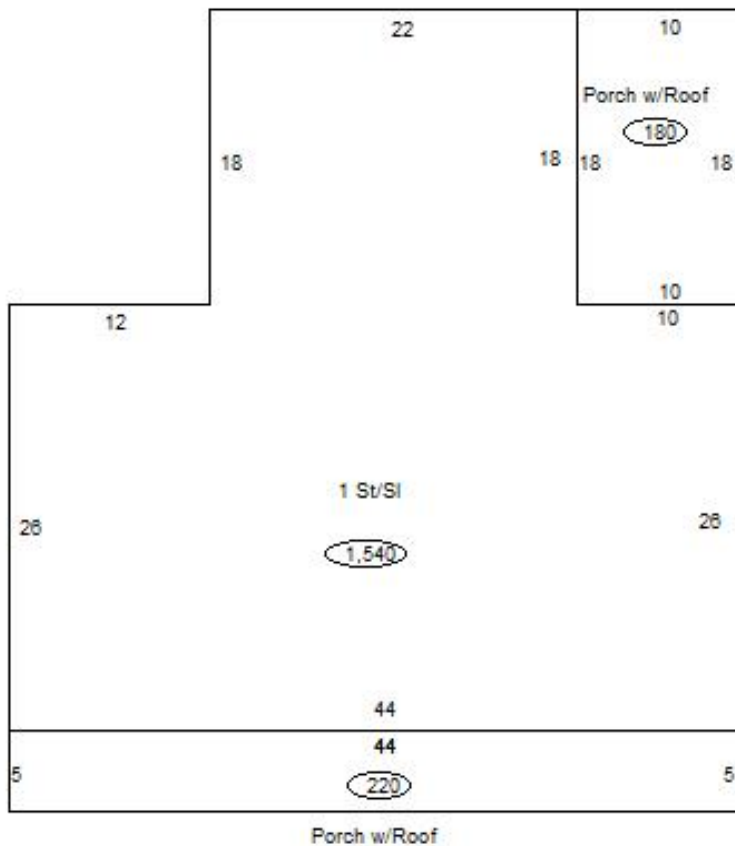

Sketch Vector Information

Sequence	Code	Type	Built Over	Scale	Section Label	Base Area	Multiplier	Total Area
1	M	PRCH		13	SLBC	220	1.000	220
2	R	1	Slab	13	1 St/Sl	1,540	1.000	1,540
3	M	PRCH		13	SLBC	180	1.000	180
Total Building Area						1,540		1,540



Rogers

Assessment Property Record Card for Tax Year 2026

Data provided by LISA DELOZIER County Assessor

Date 04/18/2026
Time 07:15:00
Page 4

660093583

Outbuildings/Site Improvements

Building Image	Code	Description	Dimensions	Floor	Roofing	Total Units
	BARN BARN		0x0x0			864
	Qual 3	Cond 3	Year	Eff Age		
Valuation Summary		Modifier Total		RCN	Depr (80% Phys/ % Func)	RCNLD
Base Cost (10.48 x 864)		9,055		9,055	7,244	1,811
	DTGF DETACHED GARAGE FAIR		0x0x0			575
	Qual 2	Cond 3	Year	Eff Age		
Valuation Summary		Modifier Total		RCN	Depr (40% Phys/ % Func)	RCNLD
Base Cost (16.00 x 575)		9,200		9,200	3,680	5,520
	STF STG FAIR		12x16x0			192
	Qual 2	Cond 3	Year	Eff Age 1520		
Valuation Summary		Modifier Total		RCN	Depr (10% Phys/ % Func)	RCNLD
Base Cost (4.68 x 192)		899		899	90	809
	CP Carport Dirt		0x0x0			
	Qual	Cond	Year	Eff Age		
Valuation Summary		Modifier Total		RCN	Depr (0% Phys/ % Func)	RCNLD
Base Cost (3.50 x)						
	CP Carport Dirt		0x0x0			
	Qual	Cond	Year	Eff Age		
Valuation Summary		Modifier Total		RCN	Depr (0% Phys/ % Func)	RCNLD
Base Cost (3.50 x)						
	CP Carport Dirt		0x0x0			
	Qual	Cond	Year	Eff Age		
Valuation Summary		Modifier Total		RCN	Depr (0% Phys/ % Func)	RCNLD
Base Cost (3.50 x)						
	CP Carport Dirt		0x0x0			
	Qual	Cond	Year	Eff Age		
Valuation Summary		Modifier Total		RCN	Depr (0% Phys/ % Func)	RCNLD
Base Cost (3.50 x)						



Rogers

Assessment Property Record Card for Tax Year 2026

Data provided by LISA DELOZIER County Assessor

Date 04/18/2026
Time 07:15:00
Page 5

660093583

Outbuildings/Site Improvements

Building Image	Code	Description	Dimensions	Floor	Roofing	Total Units
	SHDS	Shed - Small	0x0x0			
	Qual	Cond	Year	Eff Age		
Valuation Summary		Modifier Total	RCN	Depr (0% Phys/ % Func)	RCNLD	
Base Cost (39.31 x)						



Rogers

Assessment Property Record Card for Tax Year 2026

Data provided by LISA DELOZIER County Assessor

Date 04/18/2026
Time 07:15:00
Page 6

Agland Inventory

660093583

Soi	Description	Land Use	LPI	Adj Type	Adj Code	Acres	Use/Acre	Mkt/Acre	Use Value	Market Value
BC	BATES-COLLINSVILLE COMPLE	NTV PST	51			.190	122	122	23	23
DBC	DENNIS-BATES COMPLEX 2-5%	NTV PST	60			4.792	144	144	690	690
DNB	DENNIS SILT LOAM 1-3% SLO	NTV PST	80			.018	192	192	4	4
NTV PST Totals						5.000			717	717
Total Agland						5.000			717	717