



Rogers

Assessment Property Record Card for Tax Year 2026

Data provided by LISA DELOZIER County Assessor

Date 04/18/2026
Time 08:26:36
Page 1

Assessment Data					Primary Image																																																																																																																				
Account 660094970 Parcel ID 000000-00-0-00845-001-0007 Cadastral ID 01-20-14-00660 Property Type REAL - Real Property Property Class RRP VI Area 3 Tax Area 3 - OWASSO RURAL/NO FIRE Name ID 308508 FRANCIS, MATTHEW C & JOY M 6550 N DEER RIDGE CT OWASSO OK 74055-0000 Parcel Location Situs 06550 N DEER RIDGE CT Subdivision TWIN CREEKS II AT STONE CANYON Lot/Block 0007 / 0001 Parcel Size 1 - Lots Sec/Twn/Rng 1 / 20 / 14 / 5 Neighborhood 1039 - R-V04, SW OWASSO School District S021 - OWASSO SCHOOLS					<p>\\tsclient\T\LOGAN\LOGAN RESIDENTIAL VI\2021-7-15\IMG_002I 7/15/2021</p>																																																																																																																				
Legal Description Lat/Long: 36.24752760 -95.76580493 TWIN CREEKS II @ STONE CANYON BLOCK 1 LOT 7																																																																																																																									
Exemptions <table border="1"> <thead> <tr> <th>Code</th> <th>Type</th> <th>Active</th> <th>Maximum</th> <th>Exemption</th> </tr> </thead> <tbody> <tr> <td>H</td> <td>Homestead</td> <td>Yes</td> <td>1,000</td> <td>1,000</td> </tr> </tbody> </table>					Code	Type	Active	Maximum	Exemption	H	Homestead	Yes	1,000	1,000	Building Permits <table border="1"> <thead> <tr> <th>Number</th> <th>Description</th> <th>Opened</th> <th>Closed</th> <th>Amount</th> </tr> </thead> <tbody> <tr> <td>R2012 06 07 R13-NEW 3724 SQ FT SFR</td> <td></td> <td>11/2012</td> <td>11/2012</td> <td>290,000</td> </tr> </tbody> </table>					Number	Description	Opened	Closed	Amount	R2012 06 07 R13-NEW 3724 SQ FT SFR		11/2012	11/2012	290,000																																																																																												
Code	Type	Active	Maximum	Exemption																																																																																																																					
H	Homestead	Yes	1,000	1,000																																																																																																																					
Number	Description	Opened	Closed	Amount																																																																																																																					
R2012 06 07 R13-NEW 3724 SQ FT SFR		11/2012	11/2012	290,000																																																																																																																					
Parcel Valuation <table border="1"> <thead> <tr> <th>Source</th> <th>REAL</th> <th>Fair Cash</th> <th>Capped</th> <th>Asmnt Level</th> <th>Assessed</th> <th>Levy Rate</th> <th>97.960</th> <th>Current Tax</th> </tr> </thead> <tbody> <tr> <td>Remove Cap</td> <td>2013</td> <td>Land Value 117,393</td> <td>88,604</td> <td>11%</td> <td>9,746</td> <td>Assessed</td> <td>60,938</td> <td>5,969.49</td> </tr> <tr> <td>Year Frozen</td> <td>0</td> <td>Improvements 472,060</td> <td>465,383</td> <td></td> <td>51,192</td> <td>Penalty</td> <td>0</td> <td></td> </tr> <tr> <td>Uncapped Value</td> <td>0</td> <td>Mobile Home 0</td> <td>0</td> <td></td> <td>0</td> <td>Exemption</td> <td>1,000</td> <td>-97.00</td> </tr> <tr> <td>TIF Project ID</td> <td>0</td> <td>Total Value 589,453</td> <td>553,987</td> <td></td> <td>60,938</td> <td>Total Taxable</td> <td>59,938</td> <td>5,872.00</td> </tr> </tbody> </table>					Source	REAL	Fair Cash	Capped	Asmnt Level	Assessed	Levy Rate	97.960	Current Tax	Remove Cap	2013	Land Value 117,393	88,604	11%	9,746	Assessed	60,938	5,969.49	Year Frozen	0	Improvements 472,060	465,383		51,192	Penalty	0		Uncapped Value	0	Mobile Home 0	0		0	Exemption	1,000	-97.00	TIF Project ID	0	Total Value 589,453	553,987		60,938	Total Taxable	59,938	5,872.00	Sale History <table border="1"> <thead> <tr> <th>Bk/Pg</th> <th>Grantor</th> <th>Date</th> <th>Price</th> <th>Code</th> </tr> </thead> <tbody> <tr> <td>2283/360</td> <td>CRAIG BOOS BUILDERS LLC</td> <td>10/02/2012</td> <td>420,500</td> <td>YES</td> </tr> <tr> <td>2248/932</td> <td>C.A.B.O. DEVELOPMENT COMPANY LI</td> <td>06/04/2012</td> <td>57,000</td> <td>15</td> </tr> </tbody> </table>					Bk/Pg	Grantor	Date	Price	Code	2283/360	CRAIG BOOS BUILDERS LLC	10/02/2012	420,500	YES	2248/932	C.A.B.O. DEVELOPMENT COMPANY LI	06/04/2012	57,000	15																																																				
Source	REAL	Fair Cash	Capped	Asmnt Level	Assessed	Levy Rate	97.960	Current Tax																																																																																																																	
Remove Cap	2013	Land Value 117,393	88,604	11%	9,746	Assessed	60,938	5,969.49																																																																																																																	
Year Frozen	0	Improvements 472,060	465,383		51,192	Penalty	0																																																																																																																		
Uncapped Value	0	Mobile Home 0	0		0	Exemption	1,000	-97.00																																																																																																																	
TIF Project ID	0	Total Value 589,453	553,987		60,938	Total Taxable	59,938	5,872.00																																																																																																																	
Bk/Pg	Grantor	Date	Price	Code																																																																																																																					
2283/360	CRAIG BOOS BUILDERS LLC	10/02/2012	420,500	YES																																																																																																																					
2248/932	C.A.B.O. DEVELOPMENT COMPANY LI	06/04/2012	57,000	15																																																																																																																					
Assessment History <table border="1"> <thead> <tr> <th>Tax Year</th> <th>Statement Number</th> <th>Billed Owner</th> <th>Tax Area</th> <th>Total Value</th> <th>Exemptions</th> <th>Taxable Value</th> <th>Billed Tax</th> </tr> </thead> <tbody> <tr><td>2025</td><td>2025-660094970</td><td>FRANCIS, MATTHEW C & JOY M</td><td>3</td><td>569,222</td><td>1000</td><td>58,164</td><td>5,698.00</td></tr> <tr><td>2024</td><td>2024-660094970</td><td>FRANCIS, MATTHEW C & JOY M</td><td>3</td><td>586,765</td><td>1000</td><td>56,441</td><td>5,422.00</td></tr> <tr><td>2023</td><td>2023-660094970</td><td>FRANCIS, MATTHEW C & JOY M</td><td>3</td><td>566,852</td><td>1000</td><td>54,768</td><td>5,132.00</td></tr> <tr><td>2022</td><td>2022-660094970</td><td>FRANCIS, MATTHEW C & JOY M</td><td>3</td><td>547,390</td><td>1000</td><td>53,143</td><td>5,206.00</td></tr> <tr><td>2021</td><td>2021-660094970</td><td>FRANCIS, MATTHEW C & JOY M</td><td>3</td><td>477,876</td><td>1000</td><td>51,566</td><td>4,988.00</td></tr> <tr><td>2020</td><td>2020-660094970</td><td>FRANCIS, MATTHEW C & JOY M</td><td>3</td><td>491,521</td><td>1000</td><td>51,877</td><td>5,011.00</td></tr> <tr><td>2019</td><td>2019-660094970</td><td>FRANCIS, MATTHEW C & JOY M</td><td>3</td><td>466,703</td><td>1000</td><td>50,337</td><td>4,866.00</td></tr> <tr><td>2018</td><td>2018-660094970</td><td>FRANCIS, MATTHEW C & JOY M</td><td>3</td><td>470,498</td><td>1000</td><td>50,755</td><td>4,724.00</td></tr> <tr><td>2017</td><td>2017-660094970</td><td>FRANCIS, MATTHEW C & JOY M</td><td>3</td><td>487,934</td><td>1000</td><td>52,112</td><td>4,902.00</td></tr> <tr><td>2016</td><td>2016-660094970</td><td>FRANCIS, MATTHEW C & JOY M</td><td>3</td><td>475,182</td><td>1000</td><td>50,565</td><td>4,761.00</td></tr> <tr><td>2015</td><td>2015-660094970</td><td>FRANCIS, MATTHEW C & JOY M</td><td>3</td><td>460,385</td><td>1000</td><td>49,064</td><td>4,653.00</td></tr> <tr><td>2014</td><td>2014-660094970</td><td>FRANCIS, MATTHEW C & JOY M</td><td>3</td><td>461,468</td><td>1000</td><td>47,605</td><td>4,557.00</td></tr> <tr><td>2013</td><td>2013-660094970</td><td>FRANCIS, MATTHEW C & JOY M</td><td>3</td><td>428,999</td><td>1000</td><td>46,190</td><td>4,327.00</td></tr> </tbody> </table>										Tax Year	Statement Number	Billed Owner	Tax Area	Total Value	Exemptions	Taxable Value	Billed Tax	2025	2025-660094970	FRANCIS, MATTHEW C & JOY M	3	569,222	1000	58,164	5,698.00	2024	2024-660094970	FRANCIS, MATTHEW C & JOY M	3	586,765	1000	56,441	5,422.00	2023	2023-660094970	FRANCIS, MATTHEW C & JOY M	3	566,852	1000	54,768	5,132.00	2022	2022-660094970	FRANCIS, MATTHEW C & JOY M	3	547,390	1000	53,143	5,206.00	2021	2021-660094970	FRANCIS, MATTHEW C & JOY M	3	477,876	1000	51,566	4,988.00	2020	2020-660094970	FRANCIS, MATTHEW C & JOY M	3	491,521	1000	51,877	5,011.00	2019	2019-660094970	FRANCIS, MATTHEW C & JOY M	3	466,703	1000	50,337	4,866.00	2018	2018-660094970	FRANCIS, MATTHEW C & JOY M	3	470,498	1000	50,755	4,724.00	2017	2017-660094970	FRANCIS, MATTHEW C & JOY M	3	487,934	1000	52,112	4,902.00	2016	2016-660094970	FRANCIS, MATTHEW C & JOY M	3	475,182	1000	50,565	4,761.00	2015	2015-660094970	FRANCIS, MATTHEW C & JOY M	3	460,385	1000	49,064	4,653.00	2014	2014-660094970	FRANCIS, MATTHEW C & JOY M	3	461,468	1000	47,605	4,557.00	2013	2013-660094970	FRANCIS, MATTHEW C & JOY M	3	428,999	1000	46,190	4,327.00
Tax Year	Statement Number	Billed Owner	Tax Area	Total Value	Exemptions	Taxable Value	Billed Tax																																																																																																																		
2025	2025-660094970	FRANCIS, MATTHEW C & JOY M	3	569,222	1000	58,164	5,698.00																																																																																																																		
2024	2024-660094970	FRANCIS, MATTHEW C & JOY M	3	586,765	1000	56,441	5,422.00																																																																																																																		
2023	2023-660094970	FRANCIS, MATTHEW C & JOY M	3	566,852	1000	54,768	5,132.00																																																																																																																		
2022	2022-660094970	FRANCIS, MATTHEW C & JOY M	3	547,390	1000	53,143	5,206.00																																																																																																																		
2021	2021-660094970	FRANCIS, MATTHEW C & JOY M	3	477,876	1000	51,566	4,988.00																																																																																																																		
2020	2020-660094970	FRANCIS, MATTHEW C & JOY M	3	491,521	1000	51,877	5,011.00																																																																																																																		
2019	2019-660094970	FRANCIS, MATTHEW C & JOY M	3	466,703	1000	50,337	4,866.00																																																																																																																		
2018	2018-660094970	FRANCIS, MATTHEW C & JOY M	3	470,498	1000	50,755	4,724.00																																																																																																																		
2017	2017-660094970	FRANCIS, MATTHEW C & JOY M	3	487,934	1000	52,112	4,902.00																																																																																																																		
2016	2016-660094970	FRANCIS, MATTHEW C & JOY M	3	475,182	1000	50,565	4,761.00																																																																																																																		
2015	2015-660094970	FRANCIS, MATTHEW C & JOY M	3	460,385	1000	49,064	4,653.00																																																																																																																		
2014	2014-660094970	FRANCIS, MATTHEW C & JOY M	3	461,468	1000	47,605	4,557.00																																																																																																																		
2013	2013-660094970	FRANCIS, MATTHEW C & JOY M	3	428,999	1000	46,190	4,327.00																																																																																																																		



Rogers

Assessment Property Record Card for Tax Year 2026

Data provided by LISA DELOZIER County Assessor

Date 04/18/2026
Time 08:26:36
Page 2

Lot Data	Square-Foot - NBHD 1039 #1	Primary Image
Lot Size		
Lot Count	1	
Units Buildable	1	
Non-Ag Acres	0.493	
Topography		
Street Access		
Utilities		
Amenities	0	
	0	
Method	Square-Foot	
Base Lot Value	21,475.00 x 5.47 = 117,393	
Factor Value		
Adjustments	1.0000	
Lot Value	117,393	

Residential Data	
Type	1 Single Family Residence
Condition	3 - Average
Quality	4 - Good
Architecture	TRAD TRADITIONAL
Style	100% 1 1/2 Story Finished
Exterior Wall	100% Veneer, Masonry
Base/Total Area	2,578 / 3,818
Style	100% 1 1/2 Story Finished
HVAC	100% Warmed & Cooled Air
Roof Cover	1 Composition Shingle
Area on Slab	2,578
Fixture/RghIn	19 /
Bed/F/H Bath	5 / 4.5 /
Basement Area	
Garage Type	705 Attached Garage - Finished
Remodel	
Year/Eff Age	2012 / 11



\\tsclient\T\LOGAN\LOGAN RESIDENTIAL VI\2021-7-15\IMG_002I 7/15/2021

GRM Approach	
GRM Code	
Gross Rent	0.00
Indicated Value	

Multiple Regression			
MRA Code	1	Test	
Adusted R	0.8445		
Indicated Value	503,646	131.91	Per SqFt

Direct Comparables	
Selection Model	A Adam Test
Adjustment Model	1 2022 Residential
Comparables	6
Indicated Value	672,960 Per SqFt

Value Reconciliation			
Selected Approach	Cost Approach		
Improvements	472,060		
Lot Value	117,393		
Indicated Value	589,453	154.39	Per SqFt
Agland Value			
Site Improvements			
Total Value	589,453	154.39	Total Value Per SqFt

Cost Approach				Manual : 01/2025			
Base Cost	99.56	Total Misc Impr	+	10,792			
Roofing Adj	+ 3.91	Garage Cost	+	40,263			
Subfloor Adj	+ -3.09	Total RCN	=	530,405			
Heat/Cool Adj	+ 16.31	Depreciation (11%)	-	58,345			
Plumbing Adj	+ 8.86	Lump Sums	+	0			
Basement Adj	+ 0.00	RCNLD	=	472,060			
Adj Base Cost	= 125.55	Lot Value	+	117,393			
Total Area	x 3,818	Indicated Value	=	589,453			
Adjusted Cost	= 479,350	Value Per SqFt		154.39			

Miscellaneous Improvements								
Code	Description	Sketch ID	Size	Year	Units	Unit Cost	Depr	Value
PRCH	SLAB PORCH - COVERED	116095	248		248	32.10		7,961
PRCH	SLAB PORCH - COVERED	116096	86		86	32.92		2,831



Rogers
Assessment Property Record Card for Tax Year 2026
 Data provided by LISA DELOZIER County Assessor

Date 04/18/2026
 Time 08:26:36
 Page 3

Sketch Image

660094970

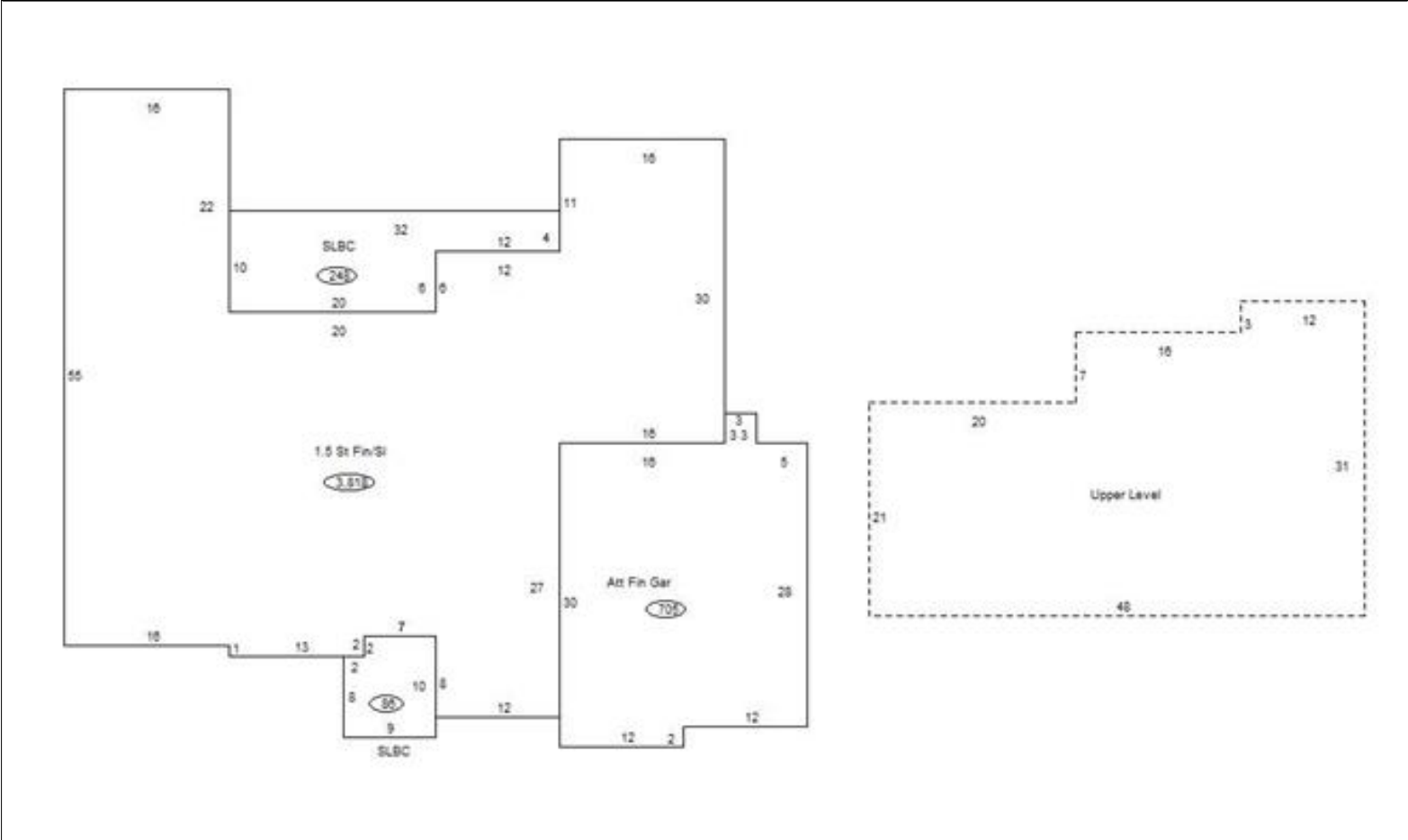

Sketch Vector Information

Sequence	Code	Type	Built Over	Scale	Section Label	Base Area	Multiplier	Total Area
1	R	5	Slab	13	1.5 St Fin/SI	2,578	1.481	3,818
2	U	^UL		13	Upper Level	1,240	1.000	1,240
3	M	PRCH		13	SLBC	248	1.000	248
4	M	PRCH		13	SLBC	86	1.000	86
5	G	5		13	Att Fin Gar	705	1.000	705
Total Building Area						2,578		3,818