



# Rogers

## Assessment Property Record Card for Tax Year 2026

Data provided by LISA DELOZIER County Assessor

Date 04/18/2026  
Time 08:28:30  
Page 1

Assessment Data					Primary Image																																																																																																																				
<b>Account</b> 660095216 <b>Parcel ID</b> 000000-00-0-10317-001-0017 <b>Cadastral ID</b> 16-21-16-19360 <b>Property Type</b> REAL - Real Property <b>Property Class</b> URP VI Area 1 <b>Tax Area</b> 17 - CLAREMORE OT <b>Name ID</b> 333520 RMH PROPERTIES LLC  200 W STONEBROOK PL CLAREMORE OK 74017-0000  <b>Parcel Location</b> <b>Situs</b> 00808 PARK CREST CT <b>Subdivision</b> PARK CREST II <b>Lot/Block</b> 0017 / 0001 <b>Parcel Size</b> 1 - Lots <b>Sec/Twn/Rng</b> 16 / 21 / 16 / 5 <b>Neighborhood</b> 1161 - R-V01-SW CLAREMORE <b>School District</b> S001 - CLAREMORE SCHOOLS																																																																																																																									
<b>Legal Description</b> Lat/Long: 36.30043885 -95.61054766 PARK CREST II LOT 17 BLOCK 1																																																																																																																									
<b>Exemptions</b>					<b>Building Permits</b>																																																																																																																				
<table border="1"> <thead> <tr> <th>Code</th> <th>Type</th> <th>Active</th> <th>Maximum</th> <th>Exemption</th> </tr> </thead> <tbody> <tr> <td></td> <td></td> <td></td> <td></td> <td></td> </tr> </tbody> </table>					Code	Type	Active	Maximum	Exemption						<table border="1"> <thead> <tr> <th>Number</th> <th>Description</th> <th>Opened</th> <th>Closed</th> <th>Amount</th> </tr> </thead> <tbody> <tr> <td>4216</td> <td>R13-NEW 1938 SQ F DUPLEX</td> <td>08/2012</td> <td>02/2013</td> <td></td> </tr> </tbody> </table>					Number	Description	Opened	Closed	Amount	4216	R13-NEW 1938 SQ F DUPLEX	08/2012	02/2013																																																																																													
Code	Type	Active	Maximum	Exemption																																																																																																																					
Number	Description	Opened	Closed	Amount																																																																																																																					
4216	R13-NEW 1938 SQ F DUPLEX	08/2012	02/2013																																																																																																																						
<table border="1"> <thead> <tr> <th>Code</th> <th>Type</th> <th>Active</th> <th>Maximum</th> <th>Exemption</th> </tr> </thead> <tbody> <tr> <td></td> <td></td> <td></td> <td></td> <td></td> </tr> </tbody> </table>					Code	Type	Active	Maximum	Exemption						<b>Sale History</b> <table border="1"> <thead> <tr> <th>Bk/Pg</th> <th>Grantor</th> <th>Date</th> <th>Price</th> <th>Code</th> </tr> </thead> <tbody> <tr> <td>/</td> <td>PARK CREST LLC</td> <td>02/05/2021</td> <td>5,310,500</td> <td>WG</td> </tr> </tbody> </table>					Bk/Pg	Grantor	Date	Price	Code	/	PARK CREST LLC	02/05/2021	5,310,500	WG																																																																																												
Code	Type	Active	Maximum	Exemption																																																																																																																					
Bk/Pg	Grantor	Date	Price	Code																																																																																																																					
/	PARK CREST LLC	02/05/2021	5,310,500	WG																																																																																																																					
<b>Parcel Valuation</b> <table border="1"> <thead> <tr> <th>Source</th> <th>REAL</th> <th>Fair Cash</th> <th>Capped</th> <th>Asmnt Level</th> <th>Assessed</th> <th>Levy Rate</th> <th>92.430</th> <th>Current Tax</th> </tr> </thead> <tbody> <tr> <td>Remove Cap</td> <td>2022</td> <td>Land Value 40,145</td> <td>13,998</td> <td>11%</td> <td>1,540</td> <td>Assessed</td> <td>25,002</td> <td>2,310.93</td> </tr> <tr> <td>Year Frozen</td> <td>0</td> <td>Improvements 233,634</td> <td>213,287</td> <td></td> <td>23,462</td> <td>Penalty</td> <td>0</td> <td></td> </tr> <tr> <td>Uncapped Value</td> <td>0</td> <td>Mobile Home 0</td> <td>0</td> <td></td> <td>0</td> <td>Exemption</td> <td>0</td> <td>0.00</td> </tr> <tr> <td>TIF Project ID</td> <td>0</td> <td>Total Value 273,779</td> <td>227,285</td> <td></td> <td>25,002</td> <td>Total Taxable</td> <td>25,002</td> <td>2,311.00</td> </tr> </tbody> </table>										Source	REAL	Fair Cash	Capped	Asmnt Level	Assessed	Levy Rate	92.430	Current Tax	Remove Cap	2022	Land Value 40,145	13,998	11%	1,540	Assessed	25,002	2,310.93	Year Frozen	0	Improvements 233,634	213,287		23,462	Penalty	0		Uncapped Value	0	Mobile Home 0	0		0	Exemption	0	0.00	TIF Project ID	0	Total Value 273,779	227,285		25,002	Total Taxable	25,002	2,311.00																																																																			
Source	REAL	Fair Cash	Capped	Asmnt Level	Assessed	Levy Rate	92.430	Current Tax																																																																																																																	
Remove Cap	2022	Land Value 40,145	13,998	11%	1,540	Assessed	25,002	2,310.93																																																																																																																	
Year Frozen	0	Improvements 233,634	213,287		23,462	Penalty	0																																																																																																																		
Uncapped Value	0	Mobile Home 0	0		0	Exemption	0	0.00																																																																																																																	
TIF Project ID	0	Total Value 273,779	227,285		25,002	Total Taxable	25,002	2,311.00																																																																																																																	
<b>Assessment History</b> <table border="1"> <thead> <tr> <th>Tax Year</th> <th>Statement Number</th> <th>Billed Owner</th> <th>Tax Area</th> <th>Total Value</th> <th>Exemptions</th> <th>Taxable Value</th> <th>Billed Tax</th> </tr> </thead> <tbody> <tr><td>2025</td><td>2025-660095216</td><td>RMH PROPERTIES LLC</td><td>17</td><td>269,455</td><td>0</td><td>23,810</td><td>2,201.00</td></tr> <tr><td>2024</td><td>2024-660095216</td><td>RMH PROPERTIES LLC</td><td>17</td><td>269,387</td><td>0</td><td>22,677</td><td>2,096.00</td></tr> <tr><td>2023</td><td>2023-660095216</td><td>RMH PROPERTIES LLC</td><td>17</td><td>225,049</td><td>0</td><td>21,597</td><td>1,978.00</td></tr> <tr><td>2022</td><td>2022-660095216</td><td>RMH PROPERTIES LLC</td><td>17</td><td>186,990</td><td>0</td><td>20,569</td><td>1,904.00</td></tr> <tr><td>2021</td><td>2021-660095216</td><td>RMH PROPERTIES LLC</td><td>17</td><td>174,458</td><td>0</td><td>19,190</td><td>1,694.00</td></tr> <tr><td>2020</td><td>2020-660095216</td><td>PARK CREST LLC</td><td>17</td><td>172,987</td><td>0</td><td>18,862</td><td>1,727.00</td></tr> <tr><td>2019</td><td>2019-660095216</td><td>PARK CREST LLC</td><td>17</td><td>163,310</td><td>0</td><td>17,964</td><td>1,664.00</td></tr> <tr><td>2018</td><td>2018-660095216</td><td>PARK CREST LLC</td><td>17</td><td>170,286</td><td>0</td><td>18,731</td><td>1,731.00</td></tr> <tr><td>2017</td><td>2017-660095216</td><td>PARK CREST LLC</td><td>17</td><td>168,623</td><td>0</td><td>18,540</td><td>1,703.00</td></tr> <tr><td>2016</td><td>2016-660095216</td><td>PARK CREST LLC</td><td>17</td><td>160,519</td><td>0</td><td>17,657</td><td>1,657.00</td></tr> <tr><td>2015</td><td>2015-660095216</td><td>PARK CREST LLC</td><td>17</td><td>154,831</td><td>0</td><td>17,031</td><td>1,536.00</td></tr> <tr><td>2014</td><td>2014-660095216</td><td>PARK CREST LLC</td><td>17</td><td>156,491</td><td>0</td><td>16,972</td><td>1,574.00</td></tr> <tr><td>2013</td><td>2013-660095216</td><td>PARK CREST LLC</td><td>17</td><td>146,947</td><td>0</td><td>16,164</td><td>1,479.00</td></tr> </tbody> </table>										Tax Year	Statement Number	Billed Owner	Tax Area	Total Value	Exemptions	Taxable Value	Billed Tax	2025	2025-660095216	RMH PROPERTIES LLC	17	269,455	0	23,810	2,201.00	2024	2024-660095216	RMH PROPERTIES LLC	17	269,387	0	22,677	2,096.00	2023	2023-660095216	RMH PROPERTIES LLC	17	225,049	0	21,597	1,978.00	2022	2022-660095216	RMH PROPERTIES LLC	17	186,990	0	20,569	1,904.00	2021	2021-660095216	RMH PROPERTIES LLC	17	174,458	0	19,190	1,694.00	2020	2020-660095216	PARK CREST LLC	17	172,987	0	18,862	1,727.00	2019	2019-660095216	PARK CREST LLC	17	163,310	0	17,964	1,664.00	2018	2018-660095216	PARK CREST LLC	17	170,286	0	18,731	1,731.00	2017	2017-660095216	PARK CREST LLC	17	168,623	0	18,540	1,703.00	2016	2016-660095216	PARK CREST LLC	17	160,519	0	17,657	1,657.00	2015	2015-660095216	PARK CREST LLC	17	154,831	0	17,031	1,536.00	2014	2014-660095216	PARK CREST LLC	17	156,491	0	16,972	1,574.00	2013	2013-660095216	PARK CREST LLC	17	146,947	0	16,164	1,479.00
Tax Year	Statement Number	Billed Owner	Tax Area	Total Value	Exemptions	Taxable Value	Billed Tax																																																																																																																		
2025	2025-660095216	RMH PROPERTIES LLC	17	269,455	0	23,810	2,201.00																																																																																																																		
2024	2024-660095216	RMH PROPERTIES LLC	17	269,387	0	22,677	2,096.00																																																																																																																		
2023	2023-660095216	RMH PROPERTIES LLC	17	225,049	0	21,597	1,978.00																																																																																																																		
2022	2022-660095216	RMH PROPERTIES LLC	17	186,990	0	20,569	1,904.00																																																																																																																		
2021	2021-660095216	RMH PROPERTIES LLC	17	174,458	0	19,190	1,694.00																																																																																																																		
2020	2020-660095216	PARK CREST LLC	17	172,987	0	18,862	1,727.00																																																																																																																		
2019	2019-660095216	PARK CREST LLC	17	163,310	0	17,964	1,664.00																																																																																																																		
2018	2018-660095216	PARK CREST LLC	17	170,286	0	18,731	1,731.00																																																																																																																		
2017	2017-660095216	PARK CREST LLC	17	168,623	0	18,540	1,703.00																																																																																																																		
2016	2016-660095216	PARK CREST LLC	17	160,519	0	17,657	1,657.00																																																																																																																		
2015	2015-660095216	PARK CREST LLC	17	154,831	0	17,031	1,536.00																																																																																																																		
2014	2014-660095216	PARK CREST LLC	17	156,491	0	16,972	1,574.00																																																																																																																		
2013	2013-660095216	PARK CREST LLC	17	146,947	0	16,164	1,479.00																																																																																																																		



# Rogers

## Assessment Property Record Card for Tax Year 2026

Data provided by LISA DELOZIER County Assessor

Date 04/18/2026  
Time 08:28:30  
Page 2

Lot Data	Square-Foot - NBHD 1161 #1	Primary Image
Lot Size		
Lot Count	1	
Units Buildable		
Non-Ag Acres	0.1676	
Topography		
Street Access		
Utilities		
Amenities	LAND QUALITY	
	0	
	0	
Method	Square-Foot	
Base Lot Value	7,299.00 x 5.50 = 40,145	
Factor Value		
Adjustments	1.0000	
Lot Value	40,145	

Residential Data	
Type	5 Duplex
Condition	3 - Average
Quality	2.5 - Fair
Architecture	R3 Res Nbhd 3
Style	100% One Story
Exterior Wall	90% Frame, Siding, Wood 10% Veneer, Stone
Base/Total Area	1,956 / 1,956
Style	100% One Story
HVAC	100% Warmed & Cooled Air
Roof Cover	1 Composition Shingle
Area on Slab	1,956
Fixture/RghIn	11 /
Bed/F/H Bath	4 / 2.0 /
Basement Area	
Garage Type	528 Attached Garage - Unfinished
Remodel	
Year/Eff Age	2012 / 11



\\tsclient\T\LOGAN\LOGAN RESIDENTIAL VI\2023-8-25\IMG\_001' 8/25/2023

GRM Approach	
GRM Code	
Gross Rent	0.00
Indicated Value	

Multiple Regression			
MRA Code	1	Test	
Adusted R	0.8445		
Indicated Value	233,070	119.16	Per SqFt

Direct Comparables	
Selection Model	A Adam Test
Adjustment Model	1 2022 Residential
Comparables	
Indicated Value	

Cost Approach				Manual : 01/2025	
Base Cost	107.17	Total Misc Impr	+	4,334	
Roofing Adj	+ 3.84	Garage Cost	+	18,459	
Subfloor Adj	+ -0.40	Total RCN	=	274,863	
Heat/Cool Adj	+ 11.22	Depreciation ( 15%)	-	41,229	
Plumbing Adj	+ 7.04	Lump Sums	+	0	
Basement Adj	+ 0.00	RCNLD	=	233,634	
Adj Base Cost	= 128.87	Lot Value	+	40,145	
Total Area	x 1,956	Indicated Value	=	273,779	
Adjusted Cost	= 252,070	Value Per SqFt		139.97	

Value Reconciliation			
Selected Approach	Cost Approach		
Improvements	233,634		
Lot Value	40,145		
Indicated Value	273,779	139.97	Per SqFt
Agland Value			
Site Improvements			
Total Value	273,779	139.97	Total Value Per SqFt

Miscellaneous Improvements								
Code	Description	Sketch ID	Size	Year	Units	Unit Cost	Depr	Value
PRCH	SLAB PORCH - COVERED	116846	14x6		84	25.80		2,167
PRCH	SLAB PORCH - COVERED	116847	14x6		84	25.80		2,167



**Rogers**  
**Assessment Property Record Card for Tax Year 2026**

Data provided by LISA DELOZIER County Assessor

Date 04/18/2026  
 Time 08:28:30  
 Page 3

Sketch Image

660095216

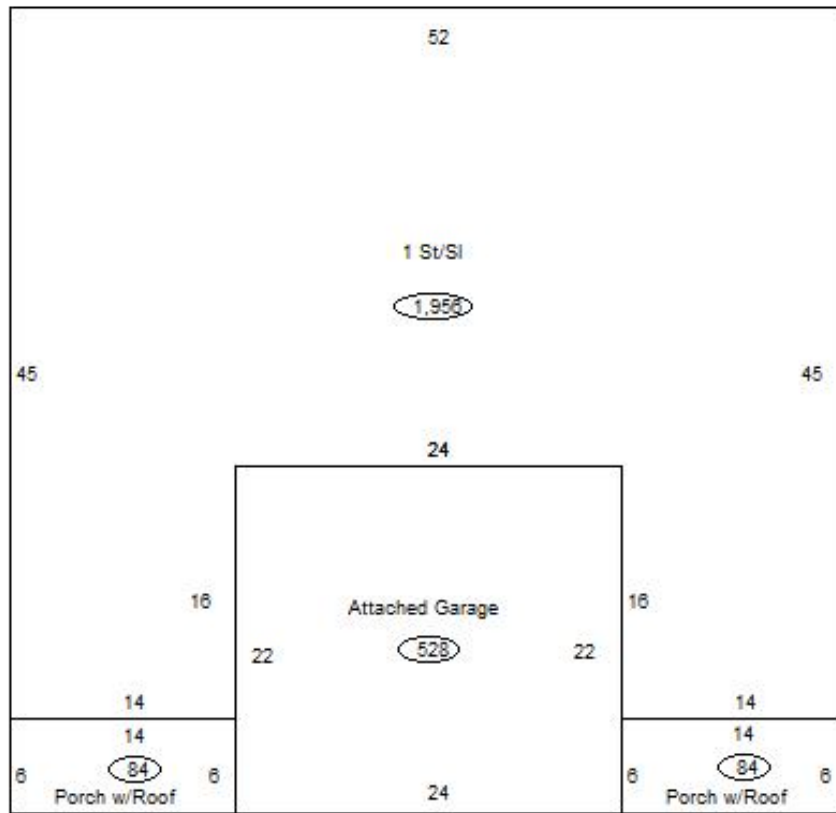

**Sketch Vector Information**

Sequence	Code	Type	Built Over	Scale	Section Label	Base Area	Multiplier	Total Area
1	R	1	Slab	13	1 St/Sl	1,956	1.000	1,956
2	G	1		13	Attached Garage	528	1.000	528
3	M	PRCH		13	SLBC	84	1.000	84
4	M	PRCH		13	SLBC	84	1.000	84
<b>Total Building Area</b>						1,956		1,956