



# Rogers

## Assessment Property Record Card for Tax Year 2026

Data provided by LISA DELOZIER County Assessor

Date 04/18/2026  
Time 08:30:50  
Page 1

Assessment Data					Primary Image																																																																																																																				
<b>Account</b> 660095469 <b>Parcel ID</b> 24N18E-34-4-00000-000-0003 <b>Cadastral ID</b> 34-24-18-00570 <b>Property Type</b> REAL - Real Property <b>Property Class</b> RA VI Area 2 <b>Tax Area</b> 14 - CHELSEA RURAL <b>Name ID</b> 291295 URIE, MICHAEL & JENI  6880 S 4290 RD CHELSEA OK 74016-5654  <b>Parcel Location</b> <b>Situs</b> 06880 S 4290 RD <b>Subdivision</b> <b>Lot/Block</b> / <b>Parcel Size</b> 36.01 - Acres <b>Sec/Twn/Rng</b> 34 / 24 / 18 / 4 <b>Neighborhood</b> 4050 - CHELSEA FOYIL RURAL <b>School District</b> S003 - CHELSEA SCHOOLS																																																																																																																									
<b>Legal Description</b> Lat/Long: 36.51198342 -95.36660785 E2 SE LESS N 1158.50' THEREOF & LESS S 624.11' OF N 1782.61' E 624.11' THEREOF.																																																																																																																									
<b>Exemptions</b> <table border="1"> <thead> <tr> <th>Code</th> <th>Type</th> <th>Active</th> <th>Maximum</th> <th>Exemption</th> </tr> </thead> <tbody> <tr> <td>H</td> <td>Homestead</td> <td>Yes</td> <td>1,000</td> <td>1,000</td> </tr> </tbody> </table>					Code	Type	Active	Maximum	Exemption	H	Homestead	Yes	1,000	1,000	<b>Building Permits</b> <table border="1"> <thead> <tr> <th>Number</th> <th>Description</th> <th>Opened</th> <th>Closed</th> <th>Amount</th> </tr> </thead> <tbody> <tr> <td></td> <td></td> <td></td> <td></td> <td></td> </tr> </tbody> </table>					Number	Description	Opened	Closed	Amount																																																																																																	
Code	Type	Active	Maximum	Exemption																																																																																																																					
H	Homestead	Yes	1,000	1,000																																																																																																																					
Number	Description	Opened	Closed	Amount																																																																																																																					
<b>Parcel Valuation</b> <table border="1"> <thead> <tr> <th>Source</th> <th>REAL</th> <th>Fair Cash</th> <th>Capped</th> <th>Asmnt Level</th> <th>Assessed</th> <th>Levy Rate</th> <th>82.750</th> <th>Current Tax</th> </tr> </thead> <tbody> <tr> <td>Remove Cap</td> <td>2014</td> <td>Land Value</td> <td>3,276</td> <td>3,276</td> <td>11%</td> <td>360</td> <td>Assessed</td> <td>53,836 4,454.93</td> </tr> <tr> <td>Year Frozen</td> <td>0</td> <td>Improvements</td> <td>500,062</td> <td>486,149</td> <td></td> <td>53,476</td> <td>Penalty</td> <td>0</td> </tr> <tr> <td>Uncapped Value</td> <td>0</td> <td>Mobile Home</td> <td>0</td> <td>0</td> <td></td> <td>0</td> <td>Exemption</td> <td>1,000 -83.00</td> </tr> <tr> <td>TIF Project ID</td> <td>0</td> <td>Total Value</td> <td>503,338</td> <td>489,425</td> <td></td> <td>53,836</td> <td>Total Taxable</td> <td>52,836 4,372.00</td> </tr> </tbody> </table>					Source	REAL	Fair Cash	Capped	Asmnt Level	Assessed	Levy Rate	82.750	Current Tax	Remove Cap	2014	Land Value	3,276	3,276	11%	360	Assessed	53,836 4,454.93	Year Frozen	0	Improvements	500,062	486,149		53,476	Penalty	0	Uncapped Value	0	Mobile Home	0	0		0	Exemption	1,000 -83.00	TIF Project ID	0	Total Value	503,338	489,425		53,836	Total Taxable	52,836 4,372.00	<b>Sale History</b> <table border="1"> <thead> <tr> <th>Bk/Pg</th> <th>Grantor</th> <th>Date</th> <th>Price</th> <th>Code</th> </tr> </thead> <tbody> <tr> <td>2304/642</td> <td>LEWIS, GEORGE K &amp; ETAL</td> <td>02/06/2013</td> <td>0</td> <td>4</td> </tr> <tr> <td>2304/646</td> <td>LEWIS, GEORGE KENNETH ESTATE</td> <td>01/28/2013</td> <td>50,000</td> <td>YES</td> </tr> </tbody> </table>					Bk/Pg	Grantor	Date	Price	Code	2304/642	LEWIS, GEORGE K & ETAL	02/06/2013	0	4	2304/646	LEWIS, GEORGE KENNETH ESTATE	01/28/2013	50,000	YES																																																				
Source	REAL	Fair Cash	Capped	Asmnt Level	Assessed	Levy Rate	82.750	Current Tax																																																																																																																	
Remove Cap	2014	Land Value	3,276	3,276	11%	360	Assessed	53,836 4,454.93																																																																																																																	
Year Frozen	0	Improvements	500,062	486,149		53,476	Penalty	0																																																																																																																	
Uncapped Value	0	Mobile Home	0	0		0	Exemption	1,000 -83.00																																																																																																																	
TIF Project ID	0	Total Value	503,338	489,425		53,836	Total Taxable	52,836 4,372.00																																																																																																																	
Bk/Pg	Grantor	Date	Price	Code																																																																																																																					
2304/642	LEWIS, GEORGE K & ETAL	02/06/2013	0	4																																																																																																																					
2304/646	LEWIS, GEORGE KENNETH ESTATE	01/28/2013	50,000	YES																																																																																																																					
<b>Assessment History</b> <table border="1"> <thead> <tr> <th>Tax Year</th> <th>Statement Number</th> <th>Billed Owner</th> <th>Tax Area</th> <th>Total Value</th> <th>Exemptions</th> <th>Taxable Value</th> <th>Billed Tax</th> </tr> </thead> <tbody> <tr><td>2025</td><td>2025-660095469</td><td>URIE, MICHAEL &amp; JENI</td><td>14</td><td>483,606</td><td>1000</td><td>51,269</td><td>4,243.00</td></tr> <tr><td>2024</td><td>2024-660095469</td><td>URIE, MICHAEL &amp; JENI</td><td>14</td><td>505,409</td><td>1000</td><td>49,747</td><td>4,199.00</td></tr> <tr><td>2023</td><td>2023-660095469</td><td>URIE, MICHAEL D &amp; JENI</td><td>14</td><td>484,540</td><td>1000</td><td>48,269</td><td>4,114.00</td></tr> <tr><td>2022</td><td>2022-660095469</td><td>URIE, MICHAEL D &amp; JENI</td><td>14</td><td>489,669</td><td>1000</td><td>46,834</td><td>3,963.00</td></tr> <tr><td>2021</td><td>2021-660095469</td><td>URIE, MICHAEL D &amp; JENI</td><td>14</td><td>422,185</td><td>1000</td><td>45,441</td><td>3,852.00</td></tr> <tr><td>2020</td><td>2020-660095469</td><td>URIE, MICHAEL D &amp; JENI</td><td>14</td><td>421,600</td><td>1000</td><td>44,949</td><td>3,812.00</td></tr> <tr><td>2019</td><td>2019-660095469</td><td>URIE, MICHAEL D &amp; JENI</td><td>14</td><td>405,548</td><td>1000</td><td>43,611</td><td>3,745.00</td></tr> <tr><td>2018</td><td>2018-660095469</td><td>URIE, MICHAEL D &amp; JENI</td><td>14</td><td>413,315</td><td>1000</td><td>43,681</td><td>3,731.00</td></tr> <tr><td>2017</td><td>2017-660095469</td><td>URIE, MICHAEL D &amp; JENI</td><td>14</td><td>409,410</td><td>1000</td><td>42,380</td><td>3,634.00</td></tr> <tr><td>2016</td><td>2016-660095469</td><td>URIE, MICHAEL D &amp; JENI</td><td>14</td><td>397,191</td><td>1000</td><td>41,117</td><td>3,583.00</td></tr> <tr><td>2015</td><td>2015-660095469</td><td>URIE, MICHAEL D &amp; JENI</td><td>14</td><td>383,505</td><td>1000</td><td>39,890</td><td>3,436.00</td></tr> <tr><td>2014</td><td>2014-660095469</td><td>URIE, MICHAEL D &amp;</td><td>14</td><td>3,331</td><td>0</td><td>366</td><td>33.00</td></tr> <tr><td>2013</td><td>2013-660095469</td><td>URIE, MICHAEL D &amp;</td><td>14</td><td>3,341</td><td>0</td><td>368</td><td>33.00</td></tr> </tbody> </table>										Tax Year	Statement Number	Billed Owner	Tax Area	Total Value	Exemptions	Taxable Value	Billed Tax	2025	2025-660095469	URIE, MICHAEL & JENI	14	483,606	1000	51,269	4,243.00	2024	2024-660095469	URIE, MICHAEL & JENI	14	505,409	1000	49,747	4,199.00	2023	2023-660095469	URIE, MICHAEL D & JENI	14	484,540	1000	48,269	4,114.00	2022	2022-660095469	URIE, MICHAEL D & JENI	14	489,669	1000	46,834	3,963.00	2021	2021-660095469	URIE, MICHAEL D & JENI	14	422,185	1000	45,441	3,852.00	2020	2020-660095469	URIE, MICHAEL D & JENI	14	421,600	1000	44,949	3,812.00	2019	2019-660095469	URIE, MICHAEL D & JENI	14	405,548	1000	43,611	3,745.00	2018	2018-660095469	URIE, MICHAEL D & JENI	14	413,315	1000	43,681	3,731.00	2017	2017-660095469	URIE, MICHAEL D & JENI	14	409,410	1000	42,380	3,634.00	2016	2016-660095469	URIE, MICHAEL D & JENI	14	397,191	1000	41,117	3,583.00	2015	2015-660095469	URIE, MICHAEL D & JENI	14	383,505	1000	39,890	3,436.00	2014	2014-660095469	URIE, MICHAEL D &	14	3,331	0	366	33.00	2013	2013-660095469	URIE, MICHAEL D &	14	3,341	0	368	33.00
Tax Year	Statement Number	Billed Owner	Tax Area	Total Value	Exemptions	Taxable Value	Billed Tax																																																																																																																		
2025	2025-660095469	URIE, MICHAEL & JENI	14	483,606	1000	51,269	4,243.00																																																																																																																		
2024	2024-660095469	URIE, MICHAEL & JENI	14	505,409	1000	49,747	4,199.00																																																																																																																		
2023	2023-660095469	URIE, MICHAEL D & JENI	14	484,540	1000	48,269	4,114.00																																																																																																																		
2022	2022-660095469	URIE, MICHAEL D & JENI	14	489,669	1000	46,834	3,963.00																																																																																																																		
2021	2021-660095469	URIE, MICHAEL D & JENI	14	422,185	1000	45,441	3,852.00																																																																																																																		
2020	2020-660095469	URIE, MICHAEL D & JENI	14	421,600	1000	44,949	3,812.00																																																																																																																		
2019	2019-660095469	URIE, MICHAEL D & JENI	14	405,548	1000	43,611	3,745.00																																																																																																																		
2018	2018-660095469	URIE, MICHAEL D & JENI	14	413,315	1000	43,681	3,731.00																																																																																																																		
2017	2017-660095469	URIE, MICHAEL D & JENI	14	409,410	1000	42,380	3,634.00																																																																																																																		
2016	2016-660095469	URIE, MICHAEL D & JENI	14	397,191	1000	41,117	3,583.00																																																																																																																		
2015	2015-660095469	URIE, MICHAEL D & JENI	14	383,505	1000	39,890	3,436.00																																																																																																																		
2014	2014-660095469	URIE, MICHAEL D &	14	3,331	0	366	33.00																																																																																																																		
2013	2013-660095469	URIE, MICHAEL D &	14	3,341	0	368	33.00																																																																																																																		



# Rogers

## Assessment Property Record Card for Tax Year 2026

Data provided by LISA DELOZIER County Assessor

Date 04/18/2026  
Time 08:30:50  
Page 2

Lot Data	Primary Image
<b>Units Buildable - CHELSEA FOYIL RURAL (UNITS BUILDABLE)</b> Lot Size Lot Count Units Buildable Non-Ag Acres 0 Topography Street Access Utilities Amenities LAND QUALITY  Method Units-Buildable Base Lot Value Factor Value Adjustments Lot Value	

Residential Data	
Type	1 Single Family Residence
Condition	3 - Average
Quality	4.5 - Good
Architecture	
Style	100% 1 1/2 Story Finished
Exterior Wall	60% Veneer, Masonry 40% Frame, Siding, Wood
Base/Total Area	1,979 / 3,592
Style	100% 1 1/2 Story Finished
HVAC	100% Warmed & Cooled Air
Roof Cover	1 Composition Shingle
Area on Slab	1,979
Fixture/RghIn	14 /
Bed/F/H Bath	4 / 2.5 /
Basement Area	
Garage Type	1,054 Attached Garage - Unfinished
Remodel	
Year/Eff Age	2014 / 9

GRM Approach
GRM Code
Gross Rent 0.00
Indicated Value

Multiple Regression
MRA Code
Adjusted R
Indicated Value

Direct Comparables
Selection Model 1 Res
Adjustment Model A2 AO Test
Comparables
Indicated Value

Cost Approach				Manual : 01/2025			
Base Cost	100.42	Total Misc Impr	+ 44,816	Roofing Adj	+ 3.49	Garage Cost	+ 50,004
Subfloor Adj	+ -2.50	Total RCN	= 546,550	Heat/Cool Adj	+ 17.03	Depreciation ( 9%)	- 49,189
Plumbing Adj	+ 7.32	Lump Sums	+ 0	Basement Adj	+ 0.00	RCNLD	= 497,361
Adj Base Cost	= 125.76	Lot Value	+ 497,361	Total Area	x 3,592	Indicated Value	= 497,361
Adjusted Cost	= 451,730	Value Per SqFt	138.46				

Value Reconciliation			
Selected Approach	Cost Approach		
Improvements	497,361		
Lot Value		497,361	138.46 Per SqFt
Indicated Value	497,361		
Agland Value	3,276		
Site Improvements	2,701		
Total Value	1,000,699	278.59	Total Value Per SqFt

Miscellaneous Improvements								
Code	Description	Sketch ID	Size	Year	Units	Unit Cost	Depr	Value
FPR1	FIREPLACE - RESIDENTIAL 1 STORY	0		2	2	7,566.76		15,134
PRCH	SLAB PORCH - COVERED	121618	34x8		272	34.61		9,414
PRCH	SLAB PORCH - COVERED	121619	605		605	33.50		20,268



# Rogers

## Assessment Property Record Card for Tax Year 2026

Data provided by LISA DELOZIER County Assessor

Date 04/18/2026

Time 08:30:50

Page 3

### Sketch Image

660095469

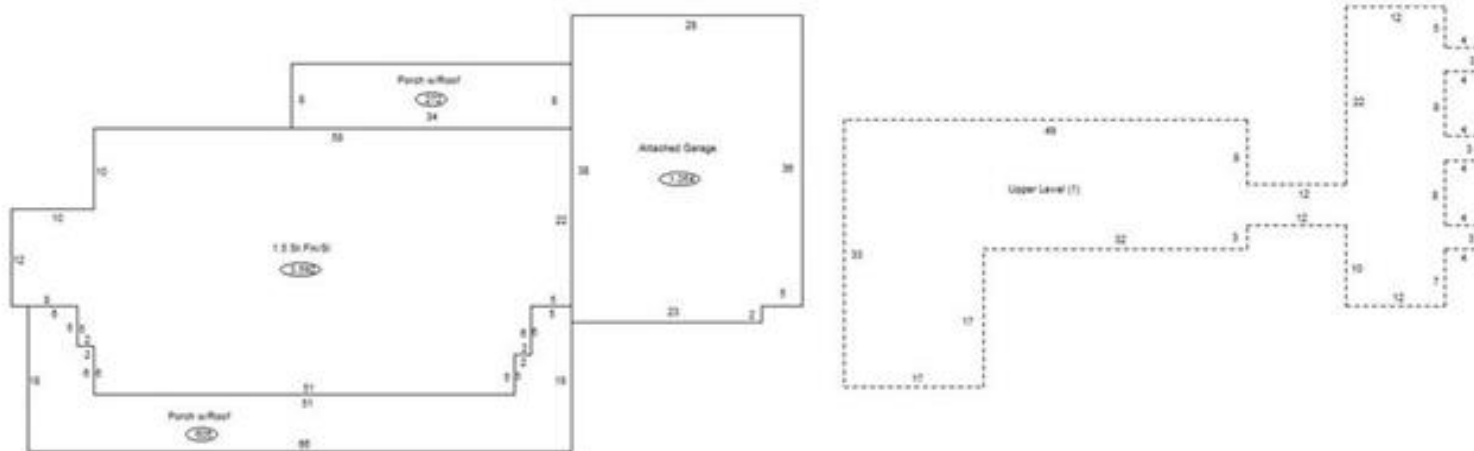

### Sketch Vector Information

Sequence	Code	Type	Built Over	Scale	Section Label	Base Area	Multiplier	Total Area
1	R	5	Slab	13	1.5 St Fin/SI	1,979	1.815	3,592
2	U	^UL		13	Upper Level (1)	1,613	1.000	1,613
3	G	1		13	Attached Garage	1,054	1.000	1,054
4	M	PRCH		13	SLBC	272	1.000	272
5	M	PRCH		13	SLBC	605	1.000	605
<b>Total Building Area</b>						1,979		3,592



# Rogers

## Assessment Property Record Card for Tax Year 2026

Data provided by LISA DELOZIER County Assessor

Date 04/18/2026  
Time 08:30:50  
Page 4

660095469

### Outbuildings/Site Improvements

Building Image	Code	Description	Dimensions	Floor	Roofing	Total Units	
	LF	LOAFING SHED	25x10x10			250	
	Qual	3	Cond	3	Year	2020	Eff Age
	<b>Valuation Summary</b>		<b>Modifier Total</b>		<b>RCN</b>	<b>Depr (0% Phys/ % Func)</b>	<b>RCNLD</b>
	Base Cost (4.26 x 250)		1,065		1,065	1,065	
	STF	STG FAIR	0x0x0				
	Qual	2	Cond		Year		Eff Age
	<b>Valuation Summary</b>		<b>Modifier Total</b>		<b>RCN</b>	<b>Depr (100% Phys/ % Func)</b>	<b>RCNLD</b>
	Base Cost (4.68 x )						
	STF	STG FAIR	0x0x0				
	Qual	2	Cond		Year		Eff Age
	<b>Valuation Summary</b>		<b>Modifier Total</b>		<b>RCN</b>	<b>Depr (100% Phys/ % Func)</b>	<b>RCNLD</b>
	Base Cost (4.68 x )						
	LF	LOAFING SHED	12x16x0			192	
	Qual	2	Cond	3	Year		Eff Age
	<b>Valuation Summary</b>		<b>Modifier Total</b>		<b>RCN</b>	<b>Depr (0% Phys/ % Func)</b>	<b>RCNLD</b>
	Base Cost (4.26 x 192)		818		818	818	
	LF	LOAFING SHED	12x16x0			192	
	Qual	2	Cond	3	Year		Eff Age
	<b>Valuation Summary</b>		<b>Modifier Total</b>		<b>RCN</b>	<b>Depr (0% Phys/ % Func)</b>	<b>RCNLD</b>
	Base Cost (4.26 x 192)		818		818	818	
	STF	STG FAIR	0x0x0				
	Qual		Cond		Year		Eff Age
	<b>Valuation Summary</b>		<b>Modifier Total</b>		<b>RCN</b>	<b>Depr (0% Phys/ % Func)</b>	<b>RCNLD</b>
	Base Cost (4.68 x )						



# Rogers

## Assessment Property Record Card for Tax Year 2026

Data provided by LISA DELOZIER County Assessor

Date 04/18/2026  
Time 08:30:50  
Page 5

### Agland Inventory

660095469

Soi	Description	Land Use	LPI	Adj Type	Adj Code	Acres	Use/Acre	Mkt/Acre	Use Value	Market Value
BC	BATES-COLLINSVILLE COMPLE	NTV PST	51			16.403	122	122	2,008	2,008
CO	COLLINSVILLE STONY LOAM	NTV PST	22			17.059	53	53	901	901
DBC	DENNIS-BATES COMPLEX 2-5%	NTV PST	60			2.548	144	144	367	367
<b>NTV PST Totals</b>						36.010			3,276	3,276
<b>Total Agland</b>						36.010			3,276	3,276