



# Rogers

## Assessment Property Record Card for Tax Year 2026

Data provided by LISA DELOZIER County Assessor

Date 04/18/2026  
 Time 08:34:47  
 Page 1

Assessment Data					Primary Image																																																																																																												
<b>Account</b> 660095778 <b>Parcel ID</b> 000000-00-0-00847-003-0007 <b>Cadastral ID</b> 06-20-15-01810 <b>Property Type</b> REAL - Real Property <b>Property Class</b> RRP VI Area 3 <b>Tax Area</b> 20 - CATOOSA RURAL <b>Name ID</b> 326925 RACHEL, ALLEN D & KASEY D  6314 N TWIN CREEKS DR OWASSO OK 74055-0000  <b>Parcel Location</b> <b>Situs</b> 06314 N TWIN CREEKS DR <b>Subdivision</b> TWIN CREEKS III AT STONE CANYON <b>Lot/Block</b> 0007 / 0003 Parcel Size 1 - Lots <b>Sec/Twn/Rng</b> 6 / 20 / 15 / 5 <b>Neighborhood</b> 1039 - R-V04, SW OWASSO <b>School District</b> S002 - CATOOSA SCHOOLS					<p>660095778_001.JPG 10/7/2025</p>																																																																																																												
<b>Legal Description</b> Lat/Long: 36.24484818 -95.76048709 TWIN CREEKS III @ STONE CANYON BLOCK 3 LOT 7																																																																																																																	
<b>Exemptions</b> <table border="1"> <thead> <tr> <th>Code</th> <th>Type</th> <th>Active</th> <th>Maximum</th> <th>Exemption</th> </tr> </thead> <tbody> <tr> <td>H</td> <td>Homestead</td> <td>Yes</td> <td>1,000</td> <td>1,000</td> </tr> <tr> <td>H</td> <td>Homestead</td> <td>No</td> <td>1,000</td> <td></td> </tr> </tbody> </table>					Code	Type	Active	Maximum	Exemption	H	Homestead	Yes	1,000	1,000	H	Homestead	No	1,000		<b>Building Permits</b> <table border="1"> <thead> <tr> <th>Number</th> <th>Description</th> <th>Opened</th> <th>Closed</th> <th>Amount</th> </tr> </thead> <tbody> <tr> <td>R2013 07 35</td> <td>R15-NEW 3584 SQ FT SFR</td> <td>09/2013</td> <td>04/2014</td> <td>325,000</td> </tr> </tbody> </table>					Number	Description	Opened	Closed	Amount	R2013 07 35	R15-NEW 3584 SQ FT SFR	09/2013	04/2014	325,000																																																																															
Code	Type	Active	Maximum	Exemption																																																																																																													
H	Homestead	Yes	1,000	1,000																																																																																																													
H	Homestead	No	1,000																																																																																																														
Number	Description	Opened	Closed	Amount																																																																																																													
R2013 07 35	R15-NEW 3584 SQ FT SFR	09/2013	04/2014	325,000																																																																																																													
<b>Parcel Valuation</b> <table border="1"> <thead> <tr> <th>Source</th> <th>REAL</th> <th>Fair Cash</th> <th>Capped</th> <th>Asmnt Level</th> <th>Assessed</th> <th>Levy Rate</th> <th>92.860</th> <th>Current Tax</th> </tr> </thead> <tbody> <tr> <td>Remove Cap</td> <td>2020</td> <td>Land Value 118,129</td> <td>86,659</td> <td>11%</td> <td>9,532</td> <td>Assessed</td> <td>54,621</td> <td>5,072.11</td> </tr> <tr> <td>Year Frozen</td> <td>0</td> <td>Improvements 465,790</td> <td>409,904</td> <td></td> <td>45,089</td> <td>Penalty</td> <td>0</td> <td></td> </tr> <tr> <td>Uncapped Value</td> <td>0</td> <td>Mobile Home 0</td> <td>0</td> <td></td> <td>0</td> <td>Exemption</td> <td>1,000</td> <td>-93.00</td> </tr> <tr> <td>TIF Project ID</td> <td>0</td> <td>Total Value 583,919</td> <td>496,563</td> <td></td> <td>54,621</td> <td>Total Taxable</td> <td>53,621</td> <td>4,979.00</td> </tr> </tbody> </table>					Source	REAL	Fair Cash	Capped	Asmnt Level	Assessed	Levy Rate	92.860	Current Tax	Remove Cap	2020	Land Value 118,129	86,659	11%	9,532	Assessed	54,621	5,072.11	Year Frozen	0	Improvements 465,790	409,904		45,089	Penalty	0		Uncapped Value	0	Mobile Home 0	0		0	Exemption	1,000	-93.00	TIF Project ID	0	Total Value 583,919	496,563		54,621	Total Taxable	53,621	4,979.00	<b>Sale History</b> <table border="1"> <thead> <tr> <th>Bk/Pg</th> <th>Grantor</th> <th>Date</th> <th>Price</th> <th>Code</th> </tr> </thead> <tbody> <tr> <td>/</td> <td>THORNTON, TIMOTHY J &amp;</td> <td>02/20/2019</td> <td>415,000</td> <td>YES</td> </tr> <tr> <td>2339/61</td> <td>C.A.B.O. DEVELOPMENT COMPANY LI</td> <td>06/27/2013</td> <td>61,500</td> <td>YES</td> </tr> </tbody> </table>					Bk/Pg	Grantor	Date	Price	Code	/	THORNTON, TIMOTHY J &	02/20/2019	415,000	YES	2339/61	C.A.B.O. DEVELOPMENT COMPANY LI	06/27/2013	61,500	YES																																												
Source	REAL	Fair Cash	Capped	Asmnt Level	Assessed	Levy Rate	92.860	Current Tax																																																																																																									
Remove Cap	2020	Land Value 118,129	86,659	11%	9,532	Assessed	54,621	5,072.11																																																																																																									
Year Frozen	0	Improvements 465,790	409,904		45,089	Penalty	0																																																																																																										
Uncapped Value	0	Mobile Home 0	0		0	Exemption	1,000	-93.00																																																																																																									
TIF Project ID	0	Total Value 583,919	496,563		54,621	Total Taxable	53,621	4,979.00																																																																																																									
Bk/Pg	Grantor	Date	Price	Code																																																																																																													
/	THORNTON, TIMOTHY J &	02/20/2019	415,000	YES																																																																																																													
2339/61	C.A.B.O. DEVELOPMENT COMPANY LI	06/27/2013	61,500	YES																																																																																																													
<b>Assessment History</b> <table border="1"> <thead> <tr> <th>Tax Year</th> <th>Statement Number</th> <th>Billed Owner</th> <th>Tax Area</th> <th>Total Value</th> <th>Exemptions</th> <th>Taxable Value</th> <th>Billed Tax</th> </tr> </thead> <tbody> <tr><td>2025</td><td>2025-660095778</td><td>RACHEL, ALLEN D &amp; KASEY D</td><td>20</td><td>516,094</td><td>1000</td><td>52,031</td><td>4,832.00</td></tr> <tr><td>2024</td><td>2024-660095778</td><td>RACHEL, ALLEN D &amp; KASEY D</td><td>20</td><td>531,859</td><td>1000</td><td>50,487</td><td>4,567.00</td></tr> <tr><td>2023</td><td>2023-660095778</td><td>RACHEL, ALLEN D &amp; KASEY D</td><td>20</td><td>509,691</td><td>1000</td><td>48,987</td><td>4,253.00</td></tr> <tr><td>2022</td><td>2022-660095778</td><td>RACHEL, ALLEN D &amp; KASEY D</td><td>20</td><td>480,465</td><td>1000</td><td>47,531</td><td>4,138.00</td></tr> <tr><td>2021</td><td>2021-660095778</td><td>RACHEL, ALLEN D &amp; KASEY D</td><td>20</td><td>428,342</td><td>0</td><td>47,118</td><td>4,145.00</td></tr> <tr><td>2020</td><td>2020-660095778</td><td>RACHEL, ALLEN D &amp; KASEY D</td><td>20</td><td>444,272</td><td>0</td><td>48,870</td><td>4,324.00</td></tr> <tr><td>2019</td><td>2019-660095778</td><td>RACHEL, ALLEN D &amp; KASEY D</td><td>20</td><td>422,441</td><td>1000</td><td>45,469</td><td>4,073.00</td></tr> <tr><td>2018</td><td>2018-660095778</td><td>THORNTON, TIMOTHY J &amp;</td><td>20</td><td>429,915</td><td>1000</td><td>46,291</td><td>4,120.00</td></tr> <tr><td>2017</td><td>2017-660095778</td><td>THORNTON, TIMOTHY J &amp;</td><td>20</td><td>445,521</td><td>1000</td><td>48,007</td><td>4,335.00</td></tr> <tr><td>2016</td><td>2016-660095778</td><td>THORNTON, TIMOTHY J &amp;</td><td>20</td><td>434,126</td><td>1000</td><td>46,754</td><td>4,158.00</td></tr> <tr><td>2015</td><td>2015-660095778</td><td>THORNTON, TIMOTHY J &amp;</td><td>20</td><td>242,991</td><td>1000</td><td>25,729</td><td>2,300.00</td></tr> <tr><td>2014</td><td>2014-660095778</td><td>THORNTON, TIMOTHY J &amp;</td><td>20</td><td>66,500</td><td>0</td><td>7,315</td><td>662.00</td></tr> </tbody> </table>										Tax Year	Statement Number	Billed Owner	Tax Area	Total Value	Exemptions	Taxable Value	Billed Tax	2025	2025-660095778	RACHEL, ALLEN D & KASEY D	20	516,094	1000	52,031	4,832.00	2024	2024-660095778	RACHEL, ALLEN D & KASEY D	20	531,859	1000	50,487	4,567.00	2023	2023-660095778	RACHEL, ALLEN D & KASEY D	20	509,691	1000	48,987	4,253.00	2022	2022-660095778	RACHEL, ALLEN D & KASEY D	20	480,465	1000	47,531	4,138.00	2021	2021-660095778	RACHEL, ALLEN D & KASEY D	20	428,342	0	47,118	4,145.00	2020	2020-660095778	RACHEL, ALLEN D & KASEY D	20	444,272	0	48,870	4,324.00	2019	2019-660095778	RACHEL, ALLEN D & KASEY D	20	422,441	1000	45,469	4,073.00	2018	2018-660095778	THORNTON, TIMOTHY J &	20	429,915	1000	46,291	4,120.00	2017	2017-660095778	THORNTON, TIMOTHY J &	20	445,521	1000	48,007	4,335.00	2016	2016-660095778	THORNTON, TIMOTHY J &	20	434,126	1000	46,754	4,158.00	2015	2015-660095778	THORNTON, TIMOTHY J &	20	242,991	1000	25,729	2,300.00	2014	2014-660095778	THORNTON, TIMOTHY J &	20	66,500	0	7,315	662.00
Tax Year	Statement Number	Billed Owner	Tax Area	Total Value	Exemptions	Taxable Value	Billed Tax																																																																																																										
2025	2025-660095778	RACHEL, ALLEN D & KASEY D	20	516,094	1000	52,031	4,832.00																																																																																																										
2024	2024-660095778	RACHEL, ALLEN D & KASEY D	20	531,859	1000	50,487	4,567.00																																																																																																										
2023	2023-660095778	RACHEL, ALLEN D & KASEY D	20	509,691	1000	48,987	4,253.00																																																																																																										
2022	2022-660095778	RACHEL, ALLEN D & KASEY D	20	480,465	1000	47,531	4,138.00																																																																																																										
2021	2021-660095778	RACHEL, ALLEN D & KASEY D	20	428,342	0	47,118	4,145.00																																																																																																										
2020	2020-660095778	RACHEL, ALLEN D & KASEY D	20	444,272	0	48,870	4,324.00																																																																																																										
2019	2019-660095778	RACHEL, ALLEN D & KASEY D	20	422,441	1000	45,469	4,073.00																																																																																																										
2018	2018-660095778	THORNTON, TIMOTHY J &	20	429,915	1000	46,291	4,120.00																																																																																																										
2017	2017-660095778	THORNTON, TIMOTHY J &	20	445,521	1000	48,007	4,335.00																																																																																																										
2016	2016-660095778	THORNTON, TIMOTHY J &	20	434,126	1000	46,754	4,158.00																																																																																																										
2015	2015-660095778	THORNTON, TIMOTHY J &	20	242,991	1000	25,729	2,300.00																																																																																																										
2014	2014-660095778	THORNTON, TIMOTHY J &	20	66,500	0	7,315	662.00																																																																																																										



# Rogers

## Assessment Property Record Card for Tax Year 2026

Data provided by LISA DELOZIER County Assessor

Date 04/18/2026  
Time 08:34:48  
Page 2

Lot Data		Square-Foot - NBHD 1039 #1	
Lot Size	0	0	
Lot Count	1		
Units Buildable			
Non-Ag Acres	0.5003		
Topography			
Street Access			
Utilities			
Amenities			0
			0
Method	Square-Foot		
Base Lot Value	21,795.00 x 5.42 = 118,129		
Factor Value			
Adjustments	1.0000		
Lot Value	118,129		



660095778\_001.JPG 10/7/2025

Residential Data	
Type	1 Single Family Residence
Condition	4 - Good
Quality	4 - Good
Architecture	TRAD TRADITIONAL
Style	100% 1 1/2 Story Finished
Exterior Wall	95% Veneer, Masonry 5% Veneer, Stone
Base/Total Area	2,162 / 3,386
Style	100% 1 1/2 Story Finished
HVAC	100% Warmed & Cooled Air
Roof Cover	1 Composition Shingle
Area on Slab	2,162
Fixture/RghIn	16 /
Bed/F/H Bath	3 / 3.0 / 1.0
Basement Area	
Garage Type	1,064 Attached Garage - Finished 4 Stalls
Remodel	
Year/Eff Age	2014 / 7

GRM Approach	
GRM Code	
Gross Rent	0.00
Indicated Value	

Multiple Regression			
MRA Code	1	Test	
Adusted R	0.8445		
Indicated Value	496,902	146.75	Per SqFt

Direct Comparables			
Selection Model	A	Adam Test	
Adjustment Model	1	2022 Residential	
Comparables	6		
Indicated Value	605,440		Per SqFt

Cost Approach				Manual : 01/2025			
Base Cost	100.32	Total Misc Impr	+	13,898			
Roofing Adj	+ 3.79	Garage Cost	+	60,552			
Subfloor Adj	+ -2.95	Total RCN	=	500,849			
Heat/Cool Adj	+ 16.31	Depreciation ( 7%)	-	35,059			
Plumbing Adj	+ 8.46	Lump Sums	+	0			
Basement Adj	+ 0.00	RCNLD	=	465,790			
Adj Base Cost	= 125.93	Lot Value	+	118,129			
Total Area	x 3,386	Indicated Value	=	583,919			
Adjusted Cost	= 426,399	Value Per SqFt		172.45			

Value Reconciliation			
Selected Approach	Cost Approach		
Improvements	465,790		
Lot Value	118,129		
Indicated Value	583,919	172.45	Per SqFt
Agland Value			
Site Improvements			
Total Value	583,919	172.45	Total Value Per SqFt

Miscellaneous Improvements								
Code	Description	Sketch ID	Size	Year	Units	Unit Cost	Depr	Value
FPR1	FIREPLACE - RESIDENTIAL 1 STORY	0		1	1	7,243.87		7,244
SHLT	STORM SHELTER	0		1	2014	0.00		
PRCH	SLAB PORCH - COVERED	121530	44		44	33.05		1,454
PRCH	SLAB PORCH - COVERED	121531	20x8		160	32.50		5,200



# Rogers

## Assessment Property Record Card for Tax Year 2026

Data provided by LISA DELOZIER County Assessor

Date 04/18/2026  
 Time 08:34:48  
 Page 3

### Sketch Image

660095778

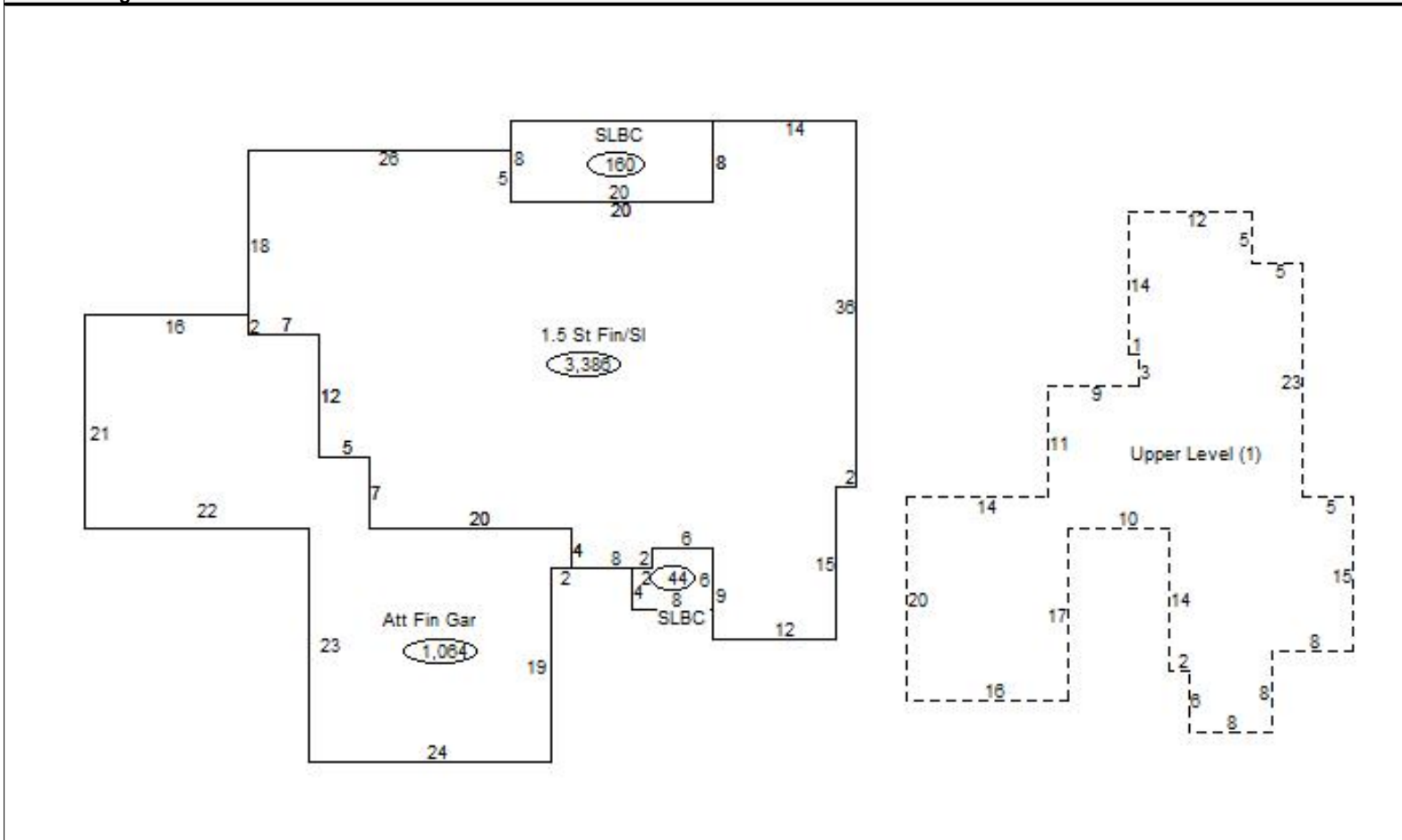

### Sketch Vector Information

Sequence	Code	Type	Built Over	Scale	Section Label	Base Area	Multiplier	Total Area
1	R	5	Slab	20	1.5 St Fin/Sl	2,162	1.566	3,386
2	U	^UL		20	Upper Level (1)	1,224	1.000	1,224
3	G	5		20	Att Fin Gar	1,064	1.000	1,064
4	M	PRCH		20	SLBC	44	1.000	44
5	M	PRCH		20	SLBC	160	1.000	160
<b>Total Building Area</b>						2,162		3,386