



Rogers

Assessment Property Record Card for Tax Year 2026

Data provided by LISA DELOZIER County Assessor

Date 04/18/2026
Time 08:36:19
Page 1

Assessment Data					Primary Image																																																																																																												
Account 660095833 Parcel ID 000000-00-0-00457-001-0024 Cadastral ID 10-21-14-05880 Property Type REAL - Real Property Property Class URP VI Area 4 Tax Area 40 - OWASSO CITY Name ID 345186 FULTZ, BRANDY LEA 10511 N 145TH E AVE OWASSO OK 74055-0000 Parcel Location Situs 14618 E 111TH PL N Subdivision LAKE VALLEY V PHASE I Lot/Block 0024 / 0001 Parcel Size 1 - Lots Sec/Twn/Rng 10 / 21 / 14 / 5 Neighborhood 1059 - R-V04-SW OWASSO School District S021 - OWASSO SCHOOLS																																																																																																																	
Legal Description Lat/Long: 36.31557031 -95.80895239																																																																																																																	
Legal Description LAKE VALLEY V - PHASE 1 BLOCK 1 LOT 24					Building Permits <table border="1"> <thead> <tr> <th>Number</th> <th>Description</th> <th>Opened</th> <th>Closed</th> <th>Amount</th> </tr> </thead> <tbody> <tr> <td>136-1105-X</td> <td>R15-NEW 1522 SQ FT SFR</td> <td>12/2013</td> <td>09/2014</td> <td>105,710</td> </tr> </tbody> </table>					Number	Description	Opened	Closed	Amount	136-1105-X	R15-NEW 1522 SQ FT SFR	12/2013	09/2014	105,710																																																																																														
Number	Description	Opened	Closed	Amount																																																																																																													
136-1105-X	R15-NEW 1522 SQ FT SFR	12/2013	09/2014	105,710																																																																																																													
Exemptions <table border="1"> <thead> <tr> <th>Code</th> <th>Type</th> <th>Active</th> <th>Maximum</th> <th>Exemption</th> </tr> </thead> <tbody> <tr> <td>H</td> <td>Homestead</td> <td>No</td> <td>1,000</td> <td></td> </tr> </tbody> </table>					Code	Type	Active	Maximum	Exemption	H	Homestead	No	1,000		Sale History <table border="1"> <thead> <tr> <th>Bk/Pg</th> <th>Grantor</th> <th>Date</th> <th>Price</th> <th>Code</th> </tr> </thead> <tbody> <tr> <td>/</td> <td>SENSINTAFFAR, JOSHUA K</td> <td>09/06/2024</td> <td>0</td> <td>WB</td> </tr> <tr> <td>/</td> <td>GARLAND, JAMES R &</td> <td>04/29/2020</td> <td>175,500</td> <td>YES</td> </tr> <tr> <td>2397/369</td> <td>SIMMONS HOMES RESIDENTIAL</td> <td>04/22/2014</td> <td>166,500</td> <td>YES</td> </tr> <tr> <td>2336/323</td> <td>LAKE VALLEY INVESTMENT</td> <td>06/19/2013</td> <td>0</td> <td>4</td> </tr> </tbody> </table>					Bk/Pg	Grantor	Date	Price	Code	/	SENSINTAFFAR, JOSHUA K	09/06/2024	0	WB	/	GARLAND, JAMES R &	04/29/2020	175,500	YES	2397/369	SIMMONS HOMES RESIDENTIAL	04/22/2014	166,500	YES	2336/323	LAKE VALLEY INVESTMENT	06/19/2013	0	4																																																																					
Code	Type	Active	Maximum	Exemption																																																																																																													
H	Homestead	No	1,000																																																																																																														
Bk/Pg	Grantor	Date	Price	Code																																																																																																													
/	SENSINTAFFAR, JOSHUA K	09/06/2024	0	WB																																																																																																													
/	GARLAND, JAMES R &	04/29/2020	175,500	YES																																																																																																													
2397/369	SIMMONS HOMES RESIDENTIAL	04/22/2014	166,500	YES																																																																																																													
2336/323	LAKE VALLEY INVESTMENT	06/19/2013	0	4																																																																																																													
Parcel Valuation <table border="1"> <thead> <tr> <th>Source</th> <th>REAL</th> <th>Fair Cash</th> <th>Capped</th> <th>Asmnt Level</th> <th>Assessed</th> <th>Levy Rate</th> <th>97.960</th> <th>Current Tax</th> </tr> </thead> <tbody> <tr> <td>Remove Cap</td> <td>2021</td> <td>Land Value 32,102</td> <td>32,102</td> <td>11%</td> <td>3,531</td> <td>Assessed</td> <td>25,502</td> <td>2,498.18</td> </tr> <tr> <td>Year Frozen</td> <td>0</td> <td>Improvements 206,765</td> <td>199,738</td> <td></td> <td>21,971</td> <td>Penalty</td> <td>0</td> <td></td> </tr> <tr> <td>Uncapped Value</td> <td>0</td> <td>Mobile Home 0</td> <td>0</td> <td></td> <td>0</td> <td>Exemption</td> <td>0</td> <td>0.00</td> </tr> <tr> <td>TIF Project ID</td> <td>0</td> <td>Total Value 238,867</td> <td>231,840</td> <td></td> <td>25,502</td> <td>Total Taxable</td> <td>25,502</td> <td>2,498.00</td> </tr> </tbody> </table>										Source	REAL	Fair Cash	Capped	Asmnt Level	Assessed	Levy Rate	97.960	Current Tax	Remove Cap	2021	Land Value 32,102	32,102	11%	3,531	Assessed	25,502	2,498.18	Year Frozen	0	Improvements 206,765	199,738		21,971	Penalty	0		Uncapped Value	0	Mobile Home 0	0		0	Exemption	0	0.00	TIF Project ID	0	Total Value 238,867	231,840		25,502	Total Taxable	25,502	2,498.00																																																											
Source	REAL	Fair Cash	Capped	Asmnt Level	Assessed	Levy Rate	97.960	Current Tax																																																																																																									
Remove Cap	2021	Land Value 32,102	32,102	11%	3,531	Assessed	25,502	2,498.18																																																																																																									
Year Frozen	0	Improvements 206,765	199,738		21,971	Penalty	0																																																																																																										
Uncapped Value	0	Mobile Home 0	0		0	Exemption	0	0.00																																																																																																									
TIF Project ID	0	Total Value 238,867	231,840		25,502	Total Taxable	25,502	2,498.00																																																																																																									
Assessment History <table border="1"> <thead> <tr> <th>Tax Year</th> <th>Statement Number</th> <th>Billed Owner</th> <th>Tax Area</th> <th>Total Value</th> <th>Exemptions</th> <th>Taxable Value</th> <th>Billed Tax</th> </tr> </thead> <tbody> <tr><td>2025</td><td>2025-660095833</td><td>FULTZ, BRANDY LEA</td><td>40</td><td>230,600</td><td>0</td><td>24,288</td><td>2,379.00</td></tr> <tr><td>2024</td><td>2024-660095833</td><td>FULTZ, BRANDY LEA</td><td>40</td><td>246,999</td><td>0</td><td>23,131</td><td>2,222.00</td></tr> <tr><td>2023</td><td>2023-660095833</td><td>SENSINTAFFAR, JOSHUA K</td><td>40</td><td>217,298</td><td>0</td><td>22,030</td><td>2,064.00</td></tr> <tr><td>2022</td><td>2022-660095833</td><td>SENSINTAFFAR, JOSHUA K</td><td>40</td><td>211,205</td><td>0</td><td>20,981</td><td>2,056.00</td></tr> <tr><td>2021</td><td>2021-660095833</td><td>SENSINTAFFAR, JOSHUA K</td><td>40</td><td>181,655</td><td>0</td><td>19,982</td><td>1,933.00</td></tr> <tr><td>2020</td><td>2020-660095833</td><td>SENSINTAFFAR, JOSHUA K</td><td>40</td><td>180,986</td><td>1000</td><td>18,536</td><td>1,793.00</td></tr> <tr><td>2019</td><td>2019-660095833</td><td>GARLAND, JAMES R &</td><td>40</td><td>172,424</td><td>1000</td><td>17,967</td><td>1,740.00</td></tr> <tr><td>2018</td><td>2018-660095833</td><td>GARLAND, JAMES R &</td><td>40</td><td>171,950</td><td>1000</td><td>17,915</td><td>1,671.00</td></tr> <tr><td>2017</td><td>2017-660095833</td><td>GARLAND, JAMES R &</td><td>40</td><td>170,590</td><td>1000</td><td>17,765</td><td>1,672.00</td></tr> <tr><td>2016</td><td>2016-660095833</td><td>GARLAND, JAMES R &</td><td>40</td><td>166,379</td><td>1000</td><td>17,302</td><td>1,635.00</td></tr> <tr><td>2015</td><td>2015-660095833</td><td>GARLAND, JAMES R &</td><td>40</td><td>168,400</td><td>0</td><td>18,524</td><td>1,766.00</td></tr> <tr><td>2014</td><td>2014-660095833</td><td>GARLAND, JAMES R &</td><td>40</td><td>6,985</td><td>0</td><td>768</td><td>74.00</td></tr> </tbody> </table>										Tax Year	Statement Number	Billed Owner	Tax Area	Total Value	Exemptions	Taxable Value	Billed Tax	2025	2025-660095833	FULTZ, BRANDY LEA	40	230,600	0	24,288	2,379.00	2024	2024-660095833	FULTZ, BRANDY LEA	40	246,999	0	23,131	2,222.00	2023	2023-660095833	SENSINTAFFAR, JOSHUA K	40	217,298	0	22,030	2,064.00	2022	2022-660095833	SENSINTAFFAR, JOSHUA K	40	211,205	0	20,981	2,056.00	2021	2021-660095833	SENSINTAFFAR, JOSHUA K	40	181,655	0	19,982	1,933.00	2020	2020-660095833	SENSINTAFFAR, JOSHUA K	40	180,986	1000	18,536	1,793.00	2019	2019-660095833	GARLAND, JAMES R &	40	172,424	1000	17,967	1,740.00	2018	2018-660095833	GARLAND, JAMES R &	40	171,950	1000	17,915	1,671.00	2017	2017-660095833	GARLAND, JAMES R &	40	170,590	1000	17,765	1,672.00	2016	2016-660095833	GARLAND, JAMES R &	40	166,379	1000	17,302	1,635.00	2015	2015-660095833	GARLAND, JAMES R &	40	168,400	0	18,524	1,766.00	2014	2014-660095833	GARLAND, JAMES R &	40	6,985	0	768	74.00
Tax Year	Statement Number	Billed Owner	Tax Area	Total Value	Exemptions	Taxable Value	Billed Tax																																																																																																										
2025	2025-660095833	FULTZ, BRANDY LEA	40	230,600	0	24,288	2,379.00																																																																																																										
2024	2024-660095833	FULTZ, BRANDY LEA	40	246,999	0	23,131	2,222.00																																																																																																										
2023	2023-660095833	SENSINTAFFAR, JOSHUA K	40	217,298	0	22,030	2,064.00																																																																																																										
2022	2022-660095833	SENSINTAFFAR, JOSHUA K	40	211,205	0	20,981	2,056.00																																																																																																										
2021	2021-660095833	SENSINTAFFAR, JOSHUA K	40	181,655	0	19,982	1,933.00																																																																																																										
2020	2020-660095833	SENSINTAFFAR, JOSHUA K	40	180,986	1000	18,536	1,793.00																																																																																																										
2019	2019-660095833	GARLAND, JAMES R &	40	172,424	1000	17,967	1,740.00																																																																																																										
2018	2018-660095833	GARLAND, JAMES R &	40	171,950	1000	17,915	1,671.00																																																																																																										
2017	2017-660095833	GARLAND, JAMES R &	40	170,590	1000	17,765	1,672.00																																																																																																										
2016	2016-660095833	GARLAND, JAMES R &	40	166,379	1000	17,302	1,635.00																																																																																																										
2015	2015-660095833	GARLAND, JAMES R &	40	168,400	0	18,524	1,766.00																																																																																																										
2014	2014-660095833	GARLAND, JAMES R &	40	6,985	0	768	74.00																																																																																																										



Rogers

Assessment Property Record Card for Tax Year 2026

Data provided by LISA DELOZIER County Assessor

Date 04/18/2026
 Time 08:36:19
 Page 2

Lot Data		Square-Foot - NBHD 1059 #1	
Lot Size	0	0	
Lot Count	1		
Units Buildable			
Non-Ag Acres	0.139		
Topography			
Street Access			
Utilities			
Amenities			0
			0
Method	Square-Foot		
Base Lot Value	6,057.00 x 5.30 = 32,102		
Factor Value			
Adjustments	1.0000		
Lot Value	32,102		



\\tsclient\T\LOGAN\LOGAN RESIDENTIAL VI\2022-7-13\IMG_001 7/18/2022

Residential Data	
Type	1 Single Family Residence
Condition	3 - Average
Quality	3 - Average
Architecture	
Style	100% One Story
Exterior Wall	100% Veneer, Masonry
Base/Total Area	1,522 / 1,522
Style	100% One Story
HVAC	100% Warmed & Cooled Air
Roof Cover	1 Composition Shingle
Area on Slab	1,522
Fixture/RghIn	11 /
Bed/F/H Bath	3 / 2.0 /
Basement Area	
Garage Type	400 Attached Garage - Unfinished
Remodel	
Year/Eff Age	2014 / 9

GRM Approach	
GRM Code	
Gross Rent	0.00
Indicated Value	

Multiple Regression			
MRA Code	1	Test	
Adusted R	0.8445		
Indicated Value	217,255	142.74	Per SqFt

Direct Comparables			
Selection Model	A	Adam Test	
Adjustment Model	1	2022 Residential	
Comparables	8		
Indicated Value	221,560		Per SqFt

Cost Approach		Manual : 01/2025	
Base Cost	113.52	Total Misc Impr	+ 2,087
Roofing Adj	+ 4.95	Garage Cost	+ 13,584
Subfloor Adj	+ -2.31	Total RCN	= 227,214
Heat/Cool Adj	+ 12.64	Depreciation (9%)	- 20,449
Plumbing Adj	+ 10.19	Lump Sums	+ 0
Basement Adj	+ 0.00	RCNLD	= 206,765
Adj Base Cost	= 138.99	Lot Value	+ 32,102
Total Area	x 1,522	Indicated Value	= 238,867
Adjusted Cost	= 211,543	Value Per SqFt	156.94

Value Reconciliation			
Selected Approach	Cost Approach		
Improvements	206,765		
Lot Value	32,102		
Indicated Value	238,867	156.94	Per SqFt
Agland Value			
Site Improvements			
Total Value	238,867	156.94	Total Value Per SqFt

Miscellaneous Improvements								
Code	Description	Sketch ID	Size	Year	Units	Unit Cost	Depr	Value
PRCH	SLAB PORCH - COVERED	120067	11x6		66	26.72		1,764
PRCH	SLAB PORCH - COVERED	120069	6x2		12	26.89		323



Rogers

Assessment Property Record Card for Tax Year 2026

Data provided by LISA DELOZIER County Assessor

Date 04/18/2026
 Time 08:36:19
 Page 3

Sketch Image

660095833

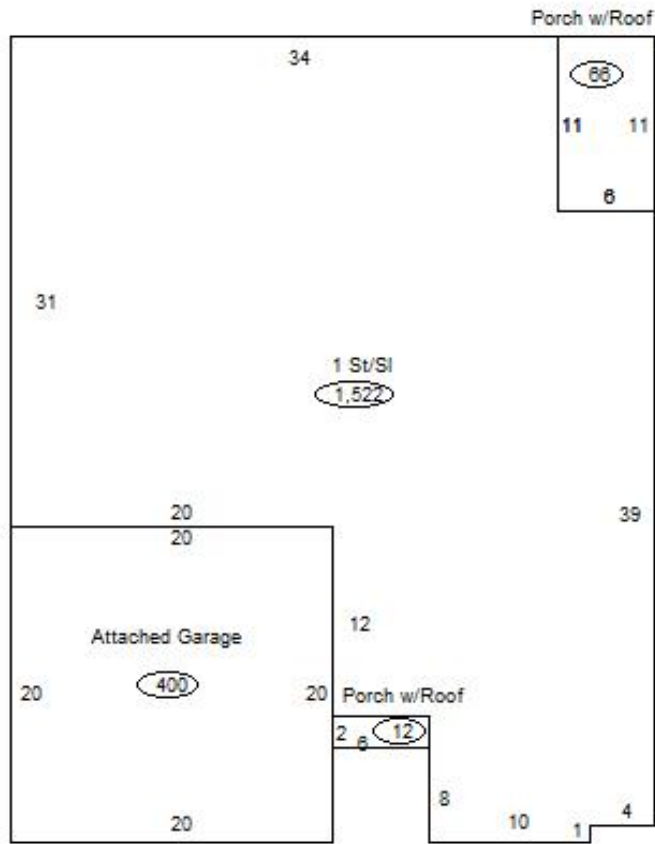

Sketch Vector Information

Sequence	Code	Type	Built Over	Scale	Section Label	Base Area	Multiplier	Total Area
1	R	1	Slab	13	1 St/SI	1,522	1.000	1,522
2	M	PRCH		13	SLBC	66	1.000	66
3	G	1		13	Attached Garage	400	1.000	400
4	M	PRCH		13	SLBC	12	1.000	12
Total Building Area						1,522		1,522