



Rogers

Assessment Property Record Card for Tax Year 2026

Data provided by LISA DELOZIER County Assessor

Date 04/18/2026
Time 08:36:24
Page 1

Assessment Data					Primary Image																																																																																																												
Account 660095836 Parcel ID 000000-00-0-00457-001-0027 Cadastral ID 10-21-14-05910 Property Type REAL - Real Property Property Class URP VI Area 4 Tax Area 40 - OWASSO CITY Name ID 327553 PROPERTYPROS LLC 10511 N 145TH E AVE OWASSO OK 74055-0000 Parcel Location Situs 11062 N 148TH E AVE Subdivision LAKE VALLEY V PHASE I Lot/Block 0027 / 0001 Parcel Size 1 - Lots Sec/Twn/Rng 10 / 21 / 14 / 5 Neighborhood 1059 - R-V04-SW OWASSO School District S021 - OWASSO SCHOOLS																																																																																																																	
Legal Description Lat/Long: 36.31520726 -95.80860503 LAKE VALLEY V - PHASE 1 BLOCK 1 LOT 27																																																																																																																	
Exemptions <table border="1"> <thead> <tr> <th>Code</th> <th>Type</th> <th>Active</th> <th>Maximum</th> <th>Exemption</th> </tr> </thead> <tbody> <tr> <td>H</td> <td>Homestead</td> <td>No</td> <td>1,000</td> <td></td> </tr> </tbody> </table>					Code	Type	Active	Maximum	Exemption	H	Homestead	No	1,000		Building Permits <table border="1"> <thead> <tr> <th>Number</th> <th>Description</th> <th>Opened</th> <th>Closed</th> <th>Amount</th> </tr> </thead> <tbody> <tr> <td>14-0117-X</td> <td>R15-NEW 1488 SQ FT SFR</td> <td>02/2014</td> <td>09/2014</td> <td>123,310</td> </tr> </tbody> </table>					Number	Description	Opened	Closed	Amount	14-0117-X	R15-NEW 1488 SQ FT SFR	02/2014	09/2014	123,310																																																																																				
Code	Type	Active	Maximum	Exemption																																																																																																													
H	Homestead	No	1,000																																																																																																														
Number	Description	Opened	Closed	Amount																																																																																																													
14-0117-X	R15-NEW 1488 SQ FT SFR	02/2014	09/2014	123,310																																																																																																													
Parcel Valuation <table border="1"> <thead> <tr> <th>Source</th> <th>REAL</th> <th>Fair Cash</th> <th>Capped</th> <th>Asmnt Level</th> <th>Assessed</th> <th>Levy Rate</th> <th>97.960</th> <th>Current Tax</th> </tr> </thead> <tbody> <tr> <td>Remove Cap</td> <td>2018</td> <td>Land Value 36,252</td> <td>36,252</td> <td>11%</td> <td>3,988</td> <td>Assessed</td> <td>25,888</td> <td>2,535.99</td> </tr> <tr> <td>Year Frozen</td> <td>0</td> <td>Improvements 212,908</td> <td>199,088</td> <td></td> <td>21,900</td> <td>Penalty</td> <td>0</td> <td></td> </tr> <tr> <td>Uncapped Value</td> <td>0</td> <td>Mobile Home 0</td> <td>0</td> <td></td> <td>0</td> <td>Exemption</td> <td>0</td> <td>0.00</td> </tr> <tr> <td>TIF Project ID</td> <td>0</td> <td>Total Value 249,160</td> <td>235,340</td> <td></td> <td>25,888</td> <td>Total Taxable</td> <td>25,888</td> <td>2,536.00</td> </tr> </tbody> </table>					Source	REAL	Fair Cash	Capped	Asmnt Level	Assessed	Levy Rate	97.960	Current Tax	Remove Cap	2018	Land Value 36,252	36,252	11%	3,988	Assessed	25,888	2,535.99	Year Frozen	0	Improvements 212,908	199,088		21,900	Penalty	0		Uncapped Value	0	Mobile Home 0	0		0	Exemption	0	0.00	TIF Project ID	0	Total Value 249,160	235,340		25,888	Total Taxable	25,888	2,536.00	Sale History <table border="1"> <thead> <tr> <th>Bk/Pg</th> <th>Grantor</th> <th>Date</th> <th>Price</th> <th>Code</th> </tr> </thead> <tbody> <tr> <td>/</td> <td>FULTZ, BRANDY LEA</td> <td>11/20/2024</td> <td>0</td> <td>4</td> </tr> <tr> <td>/</td> <td>SENSINTAFFAR, JOSHUA K</td> <td>09/06/2024</td> <td>0</td> <td>WB</td> </tr> <tr> <td>/</td> <td>SENSINTAFFAR, JOSH K</td> <td>05/07/2019</td> <td>0</td> <td>WB</td> </tr> <tr> <td>2610/673</td> <td>PATTERSON, TIMOTHY</td> <td>02/07/2017</td> <td>155,000</td> <td>19</td> </tr> <tr> <td>2403/278</td> <td>CAPITAL HOMES RES GROUP LLC</td> <td>05/28/2014</td> <td>175,500</td> <td>YES</td> </tr> <tr> <td>2336/752</td> <td>LAKE VALLEY INVESTMENT</td> <td>06/18/2013</td> <td>0</td> <td>4</td> </tr> </tbody> </table>					Bk/Pg	Grantor	Date	Price	Code	/	FULTZ, BRANDY LEA	11/20/2024	0	4	/	SENSINTAFFAR, JOSHUA K	09/06/2024	0	WB	/	SENSINTAFFAR, JOSH K	05/07/2019	0	WB	2610/673	PATTERSON, TIMOTHY	02/07/2017	155,000	19	2403/278	CAPITAL HOMES RES GROUP LLC	05/28/2014	175,500	YES	2336/752	LAKE VALLEY INVESTMENT	06/18/2013	0	4																								
Source	REAL	Fair Cash	Capped	Asmnt Level	Assessed	Levy Rate	97.960	Current Tax																																																																																																									
Remove Cap	2018	Land Value 36,252	36,252	11%	3,988	Assessed	25,888	2,535.99																																																																																																									
Year Frozen	0	Improvements 212,908	199,088		21,900	Penalty	0																																																																																																										
Uncapped Value	0	Mobile Home 0	0		0	Exemption	0	0.00																																																																																																									
TIF Project ID	0	Total Value 249,160	235,340		25,888	Total Taxable	25,888	2,536.00																																																																																																									
Bk/Pg	Grantor	Date	Price	Code																																																																																																													
/	FULTZ, BRANDY LEA	11/20/2024	0	4																																																																																																													
/	SENSINTAFFAR, JOSHUA K	09/06/2024	0	WB																																																																																																													
/	SENSINTAFFAR, JOSH K	05/07/2019	0	WB																																																																																																													
2610/673	PATTERSON, TIMOTHY	02/07/2017	155,000	19																																																																																																													
2403/278	CAPITAL HOMES RES GROUP LLC	05/28/2014	175,500	YES																																																																																																													
2336/752	LAKE VALLEY INVESTMENT	06/18/2013	0	4																																																																																																													
Assessment History <table border="1"> <thead> <tr> <th>Tax Year</th> <th>Statement Number</th> <th>Billed Owner</th> <th>Tax Area</th> <th>Total Value</th> <th>Exemptions</th> <th>Taxable Value</th> <th>Billed Tax</th> </tr> </thead> <tbody> <tr><td>2025</td><td>2025-660095836</td><td>PROPERTYPROS LLC</td><td>40</td><td>240,445</td><td>0</td><td>24,655</td><td>2,415.00</td></tr> <tr><td>2024</td><td>2024-660095836</td><td>FULTZ, BRANDY LEA</td><td>40</td><td>256,453</td><td>0</td><td>23,480</td><td>2,256.00</td></tr> <tr><td>2023</td><td>2023-660095836</td><td>PROPERTYPROS LLC</td><td>40</td><td>220,415</td><td>0</td><td>22,363</td><td>2,096.00</td></tr> <tr><td>2022</td><td>2022-660095836</td><td>PROPERTYPROS LLC</td><td>40</td><td>214,378</td><td>0</td><td>21,298</td><td>2,087.00</td></tr> <tr><td>2021</td><td>2021-660095836</td><td>PROPERTYPROS LLC</td><td>40</td><td>184,398</td><td>0</td><td>20,284</td><td>1,962.00</td></tr> <tr><td>2020</td><td>2020-660095836</td><td>PROPERTYPROS LLC</td><td>40</td><td>179,196</td><td>0</td><td>19,712</td><td>1,907.00</td></tr> <tr><td>2019</td><td>2019-660095836</td><td>PROPERTYPROS LLC</td><td>40</td><td>170,752</td><td>0</td><td>18,783</td><td>1,819.00</td></tr> <tr><td>2018</td><td>2018-660095836</td><td>SENSINTAFFAR, JOSHUA K</td><td>40</td><td>170,368</td><td>0</td><td>18,740</td><td>1,748.00</td></tr> <tr><td>2017</td><td>2017-660095836</td><td>SENSINTAFFAR, JOSHUA K</td><td>40</td><td>178,679</td><td>1000</td><td>18,655</td><td>1,755.00</td></tr> <tr><td>2016</td><td>2016-660095836</td><td>PATTERSON, TIMOTHY</td><td>40</td><td>174,302</td><td>1000</td><td>18,173</td><td>1,718.00</td></tr> <tr><td>2015</td><td>2015-660095836</td><td>PATTERSON, TIMOTHY</td><td>40</td><td>176,077</td><td>1000</td><td>18,368</td><td>1,751.00</td></tr> <tr><td>2014</td><td>2014-660095836</td><td>PATTERSON, TIMOTHY</td><td>40</td><td>6,985</td><td>0</td><td>768</td><td>74.00</td></tr> </tbody> </table>										Tax Year	Statement Number	Billed Owner	Tax Area	Total Value	Exemptions	Taxable Value	Billed Tax	2025	2025-660095836	PROPERTYPROS LLC	40	240,445	0	24,655	2,415.00	2024	2024-660095836	FULTZ, BRANDY LEA	40	256,453	0	23,480	2,256.00	2023	2023-660095836	PROPERTYPROS LLC	40	220,415	0	22,363	2,096.00	2022	2022-660095836	PROPERTYPROS LLC	40	214,378	0	21,298	2,087.00	2021	2021-660095836	PROPERTYPROS LLC	40	184,398	0	20,284	1,962.00	2020	2020-660095836	PROPERTYPROS LLC	40	179,196	0	19,712	1,907.00	2019	2019-660095836	PROPERTYPROS LLC	40	170,752	0	18,783	1,819.00	2018	2018-660095836	SENSINTAFFAR, JOSHUA K	40	170,368	0	18,740	1,748.00	2017	2017-660095836	SENSINTAFFAR, JOSHUA K	40	178,679	1000	18,655	1,755.00	2016	2016-660095836	PATTERSON, TIMOTHY	40	174,302	1000	18,173	1,718.00	2015	2015-660095836	PATTERSON, TIMOTHY	40	176,077	1000	18,368	1,751.00	2014	2014-660095836	PATTERSON, TIMOTHY	40	6,985	0	768	74.00
Tax Year	Statement Number	Billed Owner	Tax Area	Total Value	Exemptions	Taxable Value	Billed Tax																																																																																																										
2025	2025-660095836	PROPERTYPROS LLC	40	240,445	0	24,655	2,415.00																																																																																																										
2024	2024-660095836	FULTZ, BRANDY LEA	40	256,453	0	23,480	2,256.00																																																																																																										
2023	2023-660095836	PROPERTYPROS LLC	40	220,415	0	22,363	2,096.00																																																																																																										
2022	2022-660095836	PROPERTYPROS LLC	40	214,378	0	21,298	2,087.00																																																																																																										
2021	2021-660095836	PROPERTYPROS LLC	40	184,398	0	20,284	1,962.00																																																																																																										
2020	2020-660095836	PROPERTYPROS LLC	40	179,196	0	19,712	1,907.00																																																																																																										
2019	2019-660095836	PROPERTYPROS LLC	40	170,752	0	18,783	1,819.00																																																																																																										
2018	2018-660095836	SENSINTAFFAR, JOSHUA K	40	170,368	0	18,740	1,748.00																																																																																																										
2017	2017-660095836	SENSINTAFFAR, JOSHUA K	40	178,679	1000	18,655	1,755.00																																																																																																										
2016	2016-660095836	PATTERSON, TIMOTHY	40	174,302	1000	18,173	1,718.00																																																																																																										
2015	2015-660095836	PATTERSON, TIMOTHY	40	176,077	1000	18,368	1,751.00																																																																																																										
2014	2014-660095836	PATTERSON, TIMOTHY	40	6,985	0	768	74.00																																																																																																										



Rogers

Assessment Property Record Card for Tax Year 2026

Data provided by LISA DELOZIER County Assessor

Date 04/18/2026
 Time 08:36:24
 Page 2

Lot Data		Square-Foot - NBHD 1059 #1	
Lot Size	0	0	
Lot Count	1		
Units Buildable			
Non-Ag Acres	0.157		
Topography			
Street Access			
Utilities			
Amenities			0
			0
Method	Square-Foot		
Base Lot Value	6,840.00 x 5.30 = 36,252		
Factor Value			
Adjustments	1.0000		
Lot Value	36,252		



\\tsclient\T\LOGAN\LOGAN RESIDENTIAL VI\2022-7-13\IMG_0001 7/18/2022

Residential Data	
Type	1 Single Family Residence
Condition	3 - Average
Quality	3 - Average
Architecture	
Style	100% One Story
Exterior Wall	100% Veneer, Masonry
Base/Total Area	1,544 / 1,544
Style	100% One Story
HVAC	100% Warmed & Cooled Air
Roof Cover	1 Composition Shingle
Area on Slab	1,544
Fixture/RghIn	11 /
Bed/F/H Bath	3 / 2.0 /
Basement Area	
Garage Type	400 Attached Garage - Unfinished
Remodel	
Year/Eff Age	2014 / 9

GRM Approach	
GRM Code	
Gross Rent	0.00
Indicated Value	

Multiple Regression			
MRA Code	1	Test	
Adusted R	0.8445		
Indicated Value	218,874	141.76	Per SqFt

Direct Comparables			
Selection Model	A	Adam Test	
Adjustment Model	1	2022 Residential	
Comparables	8		
Indicated Value	225,610		Per SqFt

Cost Approach		Manual : 01/2025	
Base Cost	113.22	Total Misc Impr	+ 6,475
Roofing Adj	+ 4.94	Garage Cost	+ 13,584
Subfloor Adj	+ -2.31	Total RCN	= 233,965
Heat/Cool Adj	+ 12.64	Depreciation (9%)	- 21,057
Plumbing Adj	+ 10.05	Lump Sums	+ 0
Basement Adj	+ 0.00	RCNLD	= 212,908
Adj Base Cost	= 138.54	Lot Value	+ 36,252
Total Area	x 1,544	Indicated Value	= 249,160
Adjusted Cost	= 213,906	Value Per SqFt	161.37

Value Reconciliation			
Selected Approach	Cost Approach		
Improvements	212,908		
Lot Value	36,252		
Indicated Value	249,160	161.37	Per SqFt
Agland Value			
Site Improvements			
Total Value	249,160	161.37	Total Value Per SqFt

Miscellaneous Improvements								
Code	Description	Sketch ID	Size	Year	Units	Unit Cost	Depr	Value
PRCH	SLAB PORCH - COVERED	120122	144		144	26.48		3,813
PRCH	SLAB PORCH - COVERED	120124	100		100	26.62		2,662



Rogers

Assessment Property Record Card for Tax Year 2026

Data provided by LISA DELOZIER County Assessor

Date 04/18/2026
 Time 08:36:25
 Page 3

Sketch Image

660095836

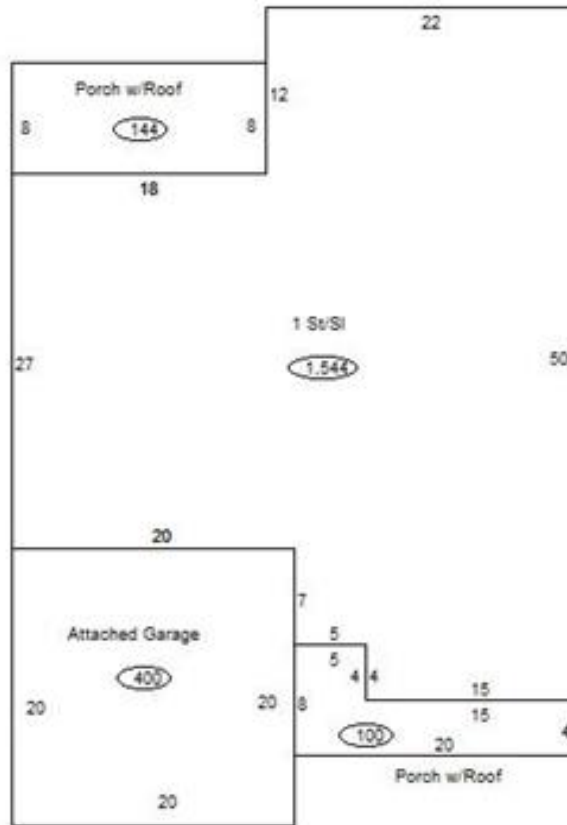

Sketch Vector Information

Sequence	Code	Type	Built Over	Scale	Section Label	Base Area	Multiplier	Total Area
1	R	1	Slab	13	1 St/Sl	1,544	1.000	1,544
2	M	PRCH		13	SLBC	144	1.000	144
3	G	1		13	Attached Garage	400	1.000	400
4	M	PRCH		13	SLBC	100	1.000	100
Total Building Area						1,544		1,544