



# Rogers

## Assessment Property Record Card for Tax Year 2026

Data provided by LISA DELOZIER County Assessor

Date 04/18/2026  
Time 08:36:59  
Page 1

Assessment Data					Primary Image				
Account	660095855				 <p>\\tsclient\T\LOGAN\LOGAN RESIDENTIAL VI\2022-7-20\IMG_000! 7/20/2022</p>				
Parcel ID	000000-00-0-00457-003-0007								
Cadastral ID	10-21-14-06100								
Property Type	REAL - Real Property								
Property Class	URP	VI Area	4						
Tax Area	40 - OWASSO CITY								
Name ID	336464								
LUO, JONATHAN									
200 E 94TH ST APT #1109 NEW YORK NY 10128-0000									
Parcel Location									
Situs	11117 N 145TH E PL								
Subdivision	LAKE VALLEY V PHASE I								
Lot/Block	0007 / 0003	Parcel Size	1 - Lots						
Sec/Twn/Rng	10 / 21 / 14 / 5								
Neighborhood	1059 - R-V04-SW OWASSO								
School District	S021 - OWASSO SCHOOLS								
Legal Description Lat/Long: 36.31630850 -95.81133743									
LAKE VALLEY V - PHASE 1 BLOCK 3 LOT 7									
Building Permits									
Number	Description	Opened	Closed	Amount					
13-1102-X	R15-NEW 1766 SQ FT SFR	12/2013	06/2014	125,510					
Exemptions									
Code	Type	Active	Maximum	Exemption					
H	Homestead	No	1,000						
H	Homestead	No	1,000						
Sale History									
Bk/Pg	Grantor	Date	Price	Code					
/	OCEAN SKY LAND LLC	11/02/2021	245,000	YES					
/	PRINCE, JUSTIN C &	07/23/2020	0	WB					
/	ATWELL, KELLI A	04/02/2020	198,500	YES					
2698/365	CAPITAL HOMES RES GROUP LLC	03/15/2018	199,500	YES					
2336/752	LAKE VALLEY INVESTMENT	06/18/2013	0	4					
Parcel Valuation									
Source	REAL	Fair Cash	Capped	Asmnt Level	Assessed	Levy Rate	97.960	Current Tax	
Remove Cap	2022	Land Value	33,231	33,231	11%	3,655	Assessed	29,167 2,857.20	
Year Frozen	0	Improvements	231,925	231,925		25,512	Penalty	0	
Uncapped Value	0	Mobile Home	0	0		0	Exemption	0 0.00	
TIF Project ID	0	Total Value	265,156	265,156		29,167	Total Taxable	29,167 2,857.00	
Assessment History									
Tax Year	Statement Number	Billed Owner	Tax Area	Total Value	Exemptions	Taxable Value	Billed Tax		
2025	2025-660095855	LUO, JONATHAN	40	255,718	0	28,129	2,756.00		
2024	2024-660095855	LUO, JONATHAN	40	273,090	0	28,297	2,718.00		
2023	2023-660095855	LUO, JONATHAN	40	245,000	0	26,950	2,525.00		
2022	2022-660095855	LUO, JONATHAN	40	245,000	0	26,950	2,640.00		
2021	2021-660095855	OCEAN SKY LAND LLC	40	205,422	1000	21,597	2,089.00		
2020	2020-660095855	OCEAN SKY LAND LLC	40	205,799	1000	21,187	2,049.00		
2019	2019-660095855	ATWELL, KELLI A	40	195,829	1000	20,541	1,989.00		
2018	2018-660095855	ATWELL, KELLI A	40	196,181	0	21,580	2,012.00		
2017	2017-660095855	CAPITAL HOMES RES GROUP LLC	40	194,592	0	21,405	2,014.00		
2016	2016-660095855	CAPITAL HOMES RES GROUP LLC	40	94,524	0	4,438	419.00		
2015	2015-660095855	CAPITAL HOMES RES GROUP LLC	40	68,089	0	4,226	403.00		
2014	2014-660095855	CAPITAL HOMES RES GROUP LLC	40	6,985	0	768	74.00		



# Rogers

## Assessment Property Record Card for Tax Year 2026

Data provided by LISA DELOZIER County Assessor

Date 04/18/2026  
 Time 08:37:00  
 Page 2

Lot Data		Square-Foot - NBHD 1059 #1	
Lot Size	0	0	
Lot Count	1		
Units Buildable			
Non-Ag Acres	0.144		
Topography			
Street Access			
Utilities			
Amenities			0
			0
Method	Square-Foot		
Base Lot Value	6,270.00 x 5.30 = 33,231		
Factor Value			
Adjustments	1.0000		
Lot Value	33,231		



\\tsclient\T\LOGAN\LOGAN RESIDENTIAL VI\2022-7-20\IMG\_000! 7/20/2022

Residential Data	
Type	1 Single Family Residence
Condition	3 - Average
Quality	3 - Average
Architecture	
Style	100% One Story
Exterior Wall	100% Veneer, Masonry
Base/Total Area	1,770 / 1,770
Style	100% One Story
HVAC	100% Warmed & Cooled Air
Roof Cover	1 Composition Shingle
Area on Slab	1,770
Fixture/RghIn	11 /
Bed/F/H Bath	4 / 2.5 /
Basement Area	
Garage Type	504 Attached Garage - Unfinished
Remodel	
Year/Eff Age	2014 / 9

GRM Approach	
GRM Code	
Gross Rent	0.00
Indicated Value	

Multiple Regression			
MRA Code	1	Test	
Adusted R	0.8445		
Indicated Value	244,806	138.31	Per SqFt

Direct Comparables			
Selection Model	A	Adam Test	
Adjustment Model	1	2022 Residential	
Comparables	8		
Indicated Value	245,410		Per SqFt

Cost Approach		Manual : 01/2025	
Base Cost	107.85	Total Misc Impr	+ 5,952
Roofing Adj	+ 4.71	Garage Cost	+ 16,032
Subfloor Adj	+ -2.39	Total RCN	= 254,863
Heat/Cool Adj	+ 12.64	Depreciation ( 9%)	- 22,938
Plumbing Adj	+ 8.76	Lump Sums	+ 0
Basement Adj	+ 0.00	RCNLD	= 231,925
Adj Base Cost	= 131.57	Lot Value	+ 33,231
Total Area	x 1,770	Indicated Value	= 265,156
Adjusted Cost	= 232,879	Value Per SqFt	149.81

Value Reconciliation			
Selected Approach	Cost Approach		
Improvements	231,925		
Lot Value	33,231		
Indicated Value	265,156	149.81	Per SqFt
Agland Value			
Site Improvements			
Total Value	265,156	149.81	Total Value Per SqFt

Miscellaneous Improvements								
Code	Description	Sketch ID	Size	Year	Units	Unit Cost	Depr	Value
PRCH	SLAB PORCH - COVERED	120755	16x8		128	26.53		3,396
PRCH	SLAB PORCH - COVERED	120757	96		96	26.63		2,556



# Rogers

## Assessment Property Record Card for Tax Year 2026

Data provided by LISA DELOZIER County Assessor

Date 04/18/2026

Time 08:37:00

Page 3

Sketch Image

660095855

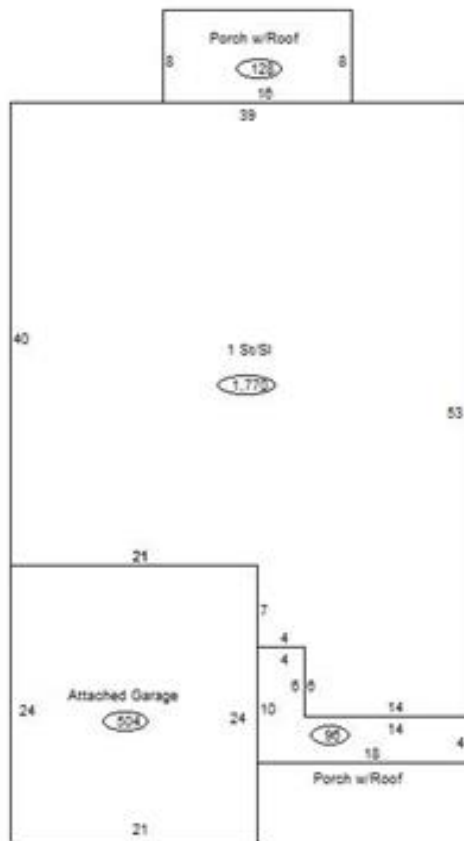

### Sketch Vector Information

Sequence	Code	Type	Built Over	Scale	Section Label	Base Area	Multiplier	Total Area
1	R	1	Slab	13	1 St/Sl	1,770	1.000	1,770
2	M	PRCH		13	SLBC	128	1.000	128
3	G	1		13	Attached Garage	504	1.000	504
4	M	PRCH		13	SLBC	96	1.000	96
<b>Total Building Area</b>						<b>1,770</b>		<b>1,770</b>