



Rogers

Assessment Property Record Card for Tax Year 2026

Data provided by LISA DELOZIER County Assessor

Date 04/18/2026
Time 08:37:33
Page 1

Assessment Data					Primary Image														
Account	660095873				<p>\\tsclient\T\LOGAN\LOGAN RESIDENTIAL VI\2022-7-20\IMG_002 7/20/2022</p>														
Parcel ID	000000-00-0-00457-004-0013																		
Cadastral ID	10-21-14-06280																		
Property Type	REAL - Real Property																		
Property Class	URP	VI Area	4																
Tax Area	40 - OWASSO CITY																		
Name ID	325072																		
DAY, MARY																			
14621 E 111TH PL N																			
OWASSO	OK 74055-0000																		
Parcel Location																			
Situs	14621 E 111TH PL N																		
Subdivision	LAKE VALLEY V PHASE I																		
Lot/Block	0013 / 0004	Parcel Size	1 - Lots																
Sec/Twn/Rng	10 / 21 / 14 / 5																		
Neighborhood	1059 - R-V04-SW OWASSO																		
School District	S021 - OWASSO SCHOOLS																		
Legal Description					Building Permits														
LAKE VALLEY V - PHASE 1 BLOCK 4 LOT 13					<table border="1"> <thead> <tr> <th>Number</th> <th>Description</th> <th>Opened</th> <th>Closed</th> <th>Amount</th> </tr> </thead> <tbody> <tr> <td>16-0605-X</td> <td>R16-NEW 1766 SQ FT SFR</td> <td>07/2015</td> <td>11/2015</td> <td>120,230</td> </tr> </tbody> </table>					Number	Description	Opened	Closed	Amount	16-0605-X	R16-NEW 1766 SQ FT SFR	07/2015	11/2015	120,230
Number	Description	Opened	Closed	Amount															
16-0605-X	R16-NEW 1766 SQ FT SFR	07/2015	11/2015	120,230															
Lat/Long: 36.31598137 -95.80864735																			
Exemptions					Sale History														
Code	Type	Active	Maximum	Exemption	Bk/Pg	Grantor	Date	Price	Code										
H	Homestead	Yes	1,000	1,000	2723/471	WILLIAMS, CHASE M	06/25/2018	195,000	YES										
					2515/230	CAPITAL HOMES RES GROUP LLC	11/30/2015	183,500	YES										
					2336/752	LAKE VALLEY INVESTMENT	06/18/2013	0	4										
Parcel Valuation																			
Source	REAL	Fair Cash	Capped	Asmnt Level	Assessed	Levy Rate	97.960	Current Tax											
Remove Cap	2019	Land Value	32,160	32,160	11%	Assessed	26,661	2,611.71											
Year Frozen	0	Improvements	233,448	210,206		Penalty	0												
Uncapped Value	0	Mobile Home	0	0		Exemption	1,000	-98.00											
TIF Project ID	0	Total Value	265,608	242,366		Total Taxable	25,661	2,514.00											
Assessment History																			
Tax Year	Statement Number	Billed Owner	Tax Area	Total Value	Exemptions	Taxable Value	Billed Tax												
2025	2025-660095873	DAY, MARY	40	256,605	1000	24,884	2,438.00												
2024	2024-660095873	DAY, MARY	40	273,409	1000	24,130	2,318.00												
2023	2023-660095873	DAY, MARY	40	247,041	1000	23,398	2,193.00												
2022	2022-660095873	DAY, MARY	40	241,181	1000	22,687	2,223.00												
2021	2021-660095873	DAY, MARY	40	210,412	1000	21,997	2,128.00												
2020	2020-660095873	DAY, MARY	40	203,146	0	22,328	2,160.00												
2019	2019-660095873	DAY, MARY	40	193,314	0	21,265	2,059.00												
2018	2018-660095873	DAY, MARY	40	189,949	0	20,894	1,948.00												
2017	2017-660095873	WILLIAMS, CHASE M	40	188,414	0	20,726	1,950.00												
2016	2016-660095873	WILLIAMS, CHASE M	40	183,559	0	20,191	1,908.00												
2015	2015-660095873	CAPITAL HOMES RES GROUP LLC	40	37,000	0	807	77.00												
2014	2014-660095873	CAPITAL HOMES RES GROUP LLC	40	6,985	0	768	74.00												



Rogers

Assessment Property Record Card for Tax Year 2026

Data provided by LISA DELOZIER County Assessor

Date 04/18/2026
 Time 08:37:34
 Page 2

Lot Data		Square-Foot - NBHD 1059 #1	
Lot Size	0	0	
Lot Count	1		
Units Buildable			
Non-Ag Acres	0.1393		
Topography			
Street Access			
Utilities			
Amenities			0
			0
Method	Square-Foot		
Base Lot Value	6,068.00 x 5.30 = 32,160		
Factor Value			
Adjustments	1.0000		
Lot Value	32,160		



\\tsclient\T\LOGAN\LOGAN RESIDENTIAL VI\2022-7-20\IMG_002 7/20/2022

Residential Data	
Type	1 Single Family Residence
Condition	3 - Average
Quality	3 - Average
Architecture	
Style	100% One Story
Exterior Wall	10% Veneer, Masonry 90% Frame, Siding, Wood
Base/Total Area	1,770 / 1,770
Style	100% One Story
HVAC	100% Warmed & Cooled Air
Roof Cover	1 Composition Shingle
Area on Slab	1,770
Fixture/RghIn	20 /
Bed/F/H Bath	4 / 2.0 /
Basement Area	
Garage Type	504 Attached Garage - Unfinished
Remodel	
Year/Eff Age	2015 / 8

GRM Approach	
GRM Code	
Gross Rent	0.00
Indicated Value	

Multiple Regression			
MRA Code	1	Test	
Adusted R	0.8445		
Indicated Value	246,705	139.38	Per SqFt

Direct Comparables			
Selection Model	A	Adam Test	
Adjustment Model	1	2022 Residential	
Comparables	8		
Indicated Value	251,970		Per SqFt

Cost Approach		Manual : 01/2025	
Base Cost	100.41	Total Misc Impr	+ 5,952
Roofing Adj	+ 4.71	Garage Cost	+ 16,032
Subfloor Adj	+ -2.39	Total RCN	= 253,748
Heat/Cool Adj	+ 12.64	Depreciation (8%)	- 20,300
Plumbing Adj	+ 15.57	Lump Sums	+ 0
Basement Adj	+ 0.00	RCNLD	= 233,448
Adj Base Cost	= 130.94	Lot Value	+ 32,160
Total Area	x 1,770	Indicated Value	= 265,608
Adjusted Cost	= 231,764	Value Per SqFt	150.06

Value Reconciliation			
Selected Approach	Cost Approach		
Improvements	233,448		
Lot Value	32,160		
Indicated Value	265,608	150.06	Per SqFt
Agland Value			
Site Improvements			
Total Value	265,608	150.06	Total Value Per SqFt

Miscellaneous Improvements								
Code	Description	Sketch ID	Size	Year	Units	Unit Cost	Depr	Value
PRCH	SLAB PORCH - COVERED	125936	16x8		128	26.53		3,396
PRCH	SLAB PORCH - COVERED	125938	96		96	26.63		2,556



Rogers

Assessment Property Record Card for Tax Year 2026

Data provided by LISA DELOZIER County Assessor

Date 04/18/2026
 Time 08:37:34
 Page 3

Sketch Image

660095873

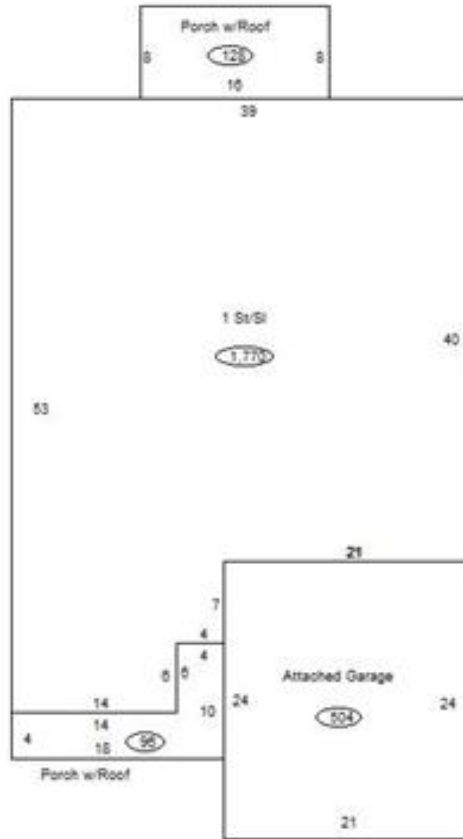

Sketch Vector Information

Sequence	Code	Type	Built Over	Scale	Section Label	Base Area	Multiplier	Total Area
1	R	1	Slab	13	1 St/Sl	1,770	1.000	1,770
2	M	PRCH		13	SLBC	128	1.000	128
3	G	1		13	Attached Garage	504	1.000	504
4	M	PRCH		13	SLBC	96	1.000	96
Total Building Area						1,770		1,770